

TABLE 1
SUMMARY OF VOLATILE ORGANIC SOIL CHEMISTRY DATA
PDC 69175
GUS LD PAD, ADAMS COUNTY, COLORADO
REM #

Sample ID	Sample Date	Depth (ft)	Benzene (mg/kg)	Toluene (mg/kg)	Ethyl-Benzene (mg/kg)	Xylenes (mg/kg)	1,2,4-Trimethyl-Benzene (mg/kg)	1,3,5-Trimethyl-Benzene (mg/kg)	Naphthalene (mg/kg)	TPH (mg/kg)	TPH GRO (mg/kg)	TPH DRO (mg/kg)	TPH ORO (mg/kg)
ECMC Table 915-1 Limits (Residential SSL)			1.2	490	5.8	58	30	27	2	500	500**		
ECMC Table 915-1 Limits (Protection of Groundwater SSL)			0.0026	0.69	0.78	9.9	0.0081	0.0087	0.0038	500	500**		
Waste Char	5/30/2024	0.2	<0.20	0.87	<0.50	3.3	6.4	<0.50	1.3	4,210	210	3000	1000
FS-01	06/03/2024	1.5	<0.00200	<0.00200	<0.00200	<0.00200	<0.00200	<0.00200	<0.002	<125.2	<0.200	<25.0	<100
FS-02	06/03/2024	1.5	<0.00200	<0.00200	<0.00200	<0.00200	<0.00200	<0.00200	<0.002	<125.2	<0.200	<25.0	<100
FS-03	06/03/2024	1.5	<0.00200	<0.00200	<0.00200	<0.00200	<0.00200	<0.00200	<0.002	<125.2	<0.200	<25.0	<100
FS-04	06/03/2024	1	<0.00200	<0.00200	<0.00200	<0.00200	<0.00200	<0.00200	<0.002	<125.2	<0.200	<25.0	<100
FS-05	06/03/2024	0.5	<0.00200	<0.00200	<0.00200	<0.00200	<0.00200	<0.00200	<0.002	<125.2	<0.200	<25.0	<100
FS-06	06/03/2024	0.5	<0.00200	<0.00200	<0.00200	<0.00200	<0.00200	<0.00200	<0.002	<125.2	<0.200	<25.0	<100
FS-07	06/03/2024	0.5	<0.00200	<0.00200	<0.00200	<0.00200	<0.00200	<0.00200	<0.002	<125.2	<0.200	<25.0	<100
FS-08	06/03/2024	0.5	<0.00200	<0.00200	<0.00200	<0.00200	<0.00200	<0.00200	<0.002	<125.2	<0.200	<25.0	<100
FS-09	06/03/2024	0.5	<0.00200	<0.00200	<0.00200	<0.00200	<0.00200	<0.00200	<0.002	<125.2	<0.200	<25.0	<100
SS-01	06/03/2024	1	<0.00200	<0.00200	<0.00200	<0.00200	<0.00200	<0.00200	<0.002	<125.2	<0.200	<25.0	<100
SS-02	06/03/2024	1	<0.00200	<0.00200	<0.00200	<0.00200	<0.00200	<0.00200	<0.002	<125.2	<0.200	<25.0	<100
FS-02(2)	11/25/2004	2	<0.0020	<0.0050	<0.0050	<0.010	<0.0050	<0.0050	<0.0038	<100.5	<0.50	<50	<50
FS02(3)	1/29/2025	2	pending	pending	pending	pending	pending	pending	pending	pending	pending	pending	pending

1. Bold values exceed the ECMC Table 915-1 limit(s)
2. Red & blue highlighted soil analytical values indicate an exceedance of the referenced soil screening level (SSL)
3. * Indicates laboratory minimum detection limit in excess of SSL
4. ** Summation of GRO+DRO+ORO must be less than 500 mg/kg

NA - Not analyzed

= Source material characterization sample, excavated and transported off site for disposal.
 = Material excavated and transported off site for disposal.

TABLE 2
SUMMARY OF POLYCYCLIC AROMATIC HYDROCARBON SOIL CHEMISTRY DATA
PDC 69175
GUS LD PAD, ADAMS COUNTY, COLORADO
REM #

Sample ID	Sample Date	Depth (ft)	Acenaphthene (mg/kg)	Anthracene (mg/kg)	Benzo (a) Anthracene (mg/kg)	Benzo (a) Pyrene (mg/kg)	Benzo (b) Fluoranthene (mg/kg)	Benzo (k) Fluoranthene (mg/kg)	Chrysene (mg/kg)	Dibenzo (a,h) Anthracene (mg/kg)	Fluoranthene (mg/kg)	Fluorene (mg/kg)	Indeno (1,2,3-cd) Pyrene (mg/kg)	Pyrene (mg/kg)	1-Methyl - Naphthalene (mg/kg)	2-Methyl- Naphthalene (mg/kg)
ECMC Table 915-1 Limits (Residential SSL)			360	1800	1.1	0.11	1.1	11	110	0.11	240	240	1.1	180	18	24
ECMC Table 915-1 Limits (Protection of Groundwater SSL)			0.55	5.8	0.011	0.24	0.3	2.9	9	0.096	8.9	0.54	0.98	1.3	0.006	0.019
Waste Char	5/30/2024	0.2	<0.020	<0.020	<0.005	<0.020	<0.020	<0.020	<0.020	<0.020	<0.020	<0.020	<0.020	<0.020	<0.002	<0.002
FS-01	06/03/2024	1.5	<0.020	<0.020	<0.005	<0.020	<0.020	<0.020	<0.020	<0.020	<0.020	<0.020	<0.020	<0.020	<0.002	<0.002
FS-02	06/03/2024	1.5	<0.020	<0.020	<0.005	<0.020	<0.020	<0.020	<0.020	<0.020	<0.020	<0.020	<0.020	<0.020	<0.002	<0.002
FS-03	06/03/2024	1.5	<0.020	<0.020	<0.005	<0.020	<0.020	<0.020	<0.020	<0.020	<0.020	<0.020	<0.020	<0.020	<0.002	<0.002
FS-04	06/03/2024	1	<0.020	<0.020	<0.005	<0.020	<0.020	<0.020	<0.020	<0.020	<0.020	<0.020	<0.020	<0.020	<0.002	<0.002
FS-05	06/03/2024	0.5	<0.020	<0.020	<0.005	<0.020	<0.020	<0.020	<0.020	<0.020	<0.020	<0.020	<0.020	<0.020	<0.002	<0.002
FS-06	06/03/2024	0.5	<0.020	<0.020	<0.005	<0.020	<0.020	<0.020	<0.020	<0.020	<0.020	<0.020	<0.020	<0.020	<0.002	<0.002
FS-07	06/03/2024	0.5	<0.020	<0.020	<0.005	<0.020	<0.020	<0.020	<0.020	<0.020	<0.020	<0.020	<0.020	<0.020	<0.002	<0.002
FS-08	06/03/2024	0.5	<0.020	<0.020	<0.005	<0.020	<0.020	<0.020	<0.020	<0.020	<0.020	<0.020	<0.020	<0.020	<0.002	<0.002
FS-09	06/03/2024	0.5	<0.020	<0.020	<0.005	<0.020	<0.020	<0.020	<0.020	<0.020	<0.020	<0.020	<0.020	<0.020	<0.002	<0.002
SS-01	06/03/2024	1	<0.020	<0.020	<0.005	<0.020	<0.020	<0.020	<0.020	<0.020	<0.020	<0.020	<0.020	<0.020	<0.002	<0.002
SS-02	06/03/2024	1	<0.020	<0.020	<0.005	<0.020	<0.020	<0.020	<0.020	<0.020	<0.020	<0.020	<0.020	<0.020	<0.002	<0.002
FS-02(2)	11/25/2004	2	<0.00500	<0.00500	<0.00500	<0.00500	<0.00500	<0.00500	<0.00500	<0.00500	<0.00500	<0.00500	<0.00500	<0.00500	<0.00500	<0.00500
FS02(3)	1/29/2025	2	pending	pending	pending	pending	pending	pending	pending	pending	pending	pending	pending	pending	pending	pending

1. Bold values exceed the ECMC Table 915-1 limit(s)

2. Red & blue highlighted soil analytical values indicate an exceedance of the referenced soil screening level (SSL)

3. * Indicates laboratory minimum detection limit in excess of SSL

NA - Not analyzed

 = Source material characterization sample, excavated and transported off site for disposal.

 = Material excavated and transported off site for disposal.

TABLE 3
SUMMARY OF SOIL SUITABILITY FOR RECLAMATION
PDC 69175
GUS LD PAD, ADAMS COUNTY, COLORADO
REM #

Sample ID	Sample Date	Depth (ft)	pH (Standard Units)	EC (mmhos/cm)	SAR (Standard Units)	Boron (mg/L)
ECMC Table 915-1 Soil Suitability Limits			6 - 8.3	<4	<6	2
Waste Char	5/30/2024	0.2	8.27	8.36	37.5	6.59
FS-01	06/03/2024	1.5	8.09	4.72	28.7	<0.0983
FS-02	06/03/2024	1.5	8.08	5.82	26.0	<0.101
FS-03	06/03/2024	1.5	8.19	3.69	12.7	0.212
FS-04	06/03/2024	1	8.34	2.22	7.91	0.247
FS-05	06/03/2024	0.5	8.51	2.04	14.7	0.279
FS-06	06/03/2024	0.5	8.19	2.65	3.38	0.391
FS-07	06/03/2024	0.5	8.26	4.90	14.0	0.815
FS-08	06/03/2024	0.5	7.96	11.30	15.0	1.47
FS-09	06/03/2024	0.5	8.40	2.43	10.5	0.413
SS-01	06/03/2024	1	8.06	8.65	22.7	3.71
SS-02	06/03/2024	1	8.26	2.30	14.6	<0.0996
BG-NE-IN	8/22/2024	1	9.23	1.07	5.89	<2.00
BG-SE-IN	8/22/2024	1	8.84	1.02	11.0	<2.00
BG-SE-OFF	8/22/2024	1	8.34	0.15	0.266	<2.00
BG-S-C	8/22/2024	1	7.68	2.78	0.199	<2.00
BG-S-W	8/22/2024	1	7.16	1.04	0.22	<2.00
BG-NE-ON 2 Ft	11/8/2024	2	9.19	1.03	7.06	<2.00
BG-NW-ON 2 Ft	11/8/2024	2	8.31	1.65	10.1	<2.00
BG-NN-ON 2 Ft	11/8/2024	2	9.03	1.26	17.4	<2.00
BG-SE-ON 1 Ft	11/8/2024	1	9.31	2.00	12.0	<2.00
BG-SW-ON 1 Ft	11/8/2024	1	9.39	1.01	8.32	<2.00
SS-01(2) 1 Ft	11/8/2024	1	8.82	0.68	2.65	<2.00
SS-01(2) 2 Ft	11/8/2024	2	9.10	0.63	5.26	<2.00
FS-02(2)	11/25/2024	2	8.04	1.33	4.44	<2.00
FS02(3)	1/29/2025	2	pending	pending	pending	pending
			Revolved BG	Not resolved	Not resolved	Resolved
Maximum Root Background Concentration (0 - 3 ft)			9.39	2.78	17.4	<2.00

1. Bold faced values exceed the ECMC Table 915-1 limit(s)
2. Blue highlighted soil analytical values indicate a regulatory exceedance

NA - Not analyzed

 = Source material characterization sample, excavated and transported off site for disposal.

 = Material excavated and transported off site for disposal.

 = Boron resolved via confirmation samples at 1 Ft and 2 Ft

TABLE 4
SUMMARY OF METALS IN SOIL CHEMISTRY DATA
PDC 69175
GUS LD PAD, ADAMS COUNTY, COLORADO
REM #

Sample ID	Sample Date	Depth (ft)	Arsenic (mg/kg)	Barium (mg/kg)	Cadmium (mg/kg)	Chromium (VI) (mg/kg)	Copper (mg/kg)	Lead (mg/kg)	Nickel (mg/kg)	Selenium (mg/kg)	Silver (mg/kg)	Zinc (mg/kg)
ECMC Table 915-1 Limits (Residential SSL)			0.68	15000	71	0.3	3100	400	1500	390	390	23000
ECMC Table 915-1 Limits (Protection of Groundwater SSL)			0.29	82	0.38	0.00067	46	14	26	0.26	0.8	370
Waste Char	5/30/2024	0.2	3.28	69.2	<0.200	<0.30	3.91	4.66	3.99	<0.260	<0.0200	14.6
FS-01	06/03/2024	1.5	2.39	27.2	0.211	<0.276	10.5	10.8	9.59	<0.247	<0.0952	<35.2
FS-02	06/03/2024	1.5	4.22	22.4	0.157	<0.374	11.2	10.6	9.28	0.27	<0.0853	40.0
FS-03	06/03/2024	1.5	4.14	52.4	0.311	<0.342	11.2	11.5	13.1	<0.234	<0.0899	42.7
FS-04	06/03/2024	1	5.44	60.7	0.418	<0.368	15.5	27.6	14.1	<0.243	<0.0933	52.7
FS-05	06/03/2024	0.5	3.16	171	0.132	0.568	<9.11	7.17	7.46	<0.237	<0.0911	33.7
FS-06	06/03/2024	0.5	3.31	101	0.125	<0.296	<9.74	7.19	7.48	<0.253	<0.0974	<36.0
FS-07	06/03/2024	0.5	3.26	164	0.117	<0.265	10.7	7.16	7.54	<0.241	<0.0928	34.8
FS-08	06/03/2024	0.5	2.68	60.6	0.0901	<0.282	<8.58	5.58	6.61	<0.223	<0.0858	<31.7
FS-09	06/03/2024	0.5	2.94	149	0.101	<0.354	<9.38	6.41	7.11	<0.244	<0.0938	<34.7
SS-01	06/03/2024	1	3.81	127	0.127	<0.348	9.53	8.06	8.45	<0.243	<0.0935	35.1
SS-02	06/03/2024	1	2.79	25.3	0.173	<0.296	12.1	13.9	8.84	<0.253	<0.0974	37.1
BG-NE-IN	8/22/2024	1	3.91	116	0.400	<0.30	6.3	7.57	6.04	<0.260	0.0391	22.1
BG-SE-IN	8/22/2024	1	1.92	45.5	<0.200	<0.30	4.06	3.73	3.86	<0.260	0.0443	12.5
BG-SE-OFF	8/22/2024	1	7.30	47.1	0.24	<0.30	5.65	7.87	5.89	<0.234	0.0246	19.8
BG-S-C	8/22/2024	1	4.08	9.23	<0.200	<0.30	6.37	12.3	3.21	<0.260	0.0211	17.7
BG-S-W	8/22/2024	1	1.08	6.26	<0.200	<0.30	6.46	9.54	3.29	<0.260	0.0333	10.8
BG-NE-ON 2 Ft	11/8/2024	2	6.12	12.3	<0.200	<0.30	8.08	11.7	4.54	<0.260	0.0221	16.7
BG-NW-ON 2 Ft	11/8/2024	2	4.68	9.42	<0.200	<0.30	5.16	5.78	5.48	<0.260	<0.0200	17
BG-NN-ON 2 Ft	11/8/2024	2	3.98	62.9	0.406	<0.30	9.39	15.0	7.51	0.396	0.0397	28.9
BG-SE-ON 1 Ft	11/8/2024	1	5.12	70.4	0.362	<0.30	19.5	11.2	7.19	0.274	0.0356	27.3
BG-SW-ON 1 Ft	11/8/2024	1	2.62	61.2	<0.200	<0.30	5.54	5.05	5.07	<0.260	0.0223	16.6
SS-01(2) 1 Ft	11/8/2024	1	2.59	167	0.212	<0.30	5.91	6.58	4.7	<0.260	0.0486	19.8
SS-01(2) 2 Ft	11/8/2024	2	3.17	61.1	0.422	<0.30	8.3	11.3	7.85	<0.260	0.0339	27.4
FS-02(2)	11/25/2024	2	1.07	48.4	<0.200	<0.30	3.95	10.2	3.29	<0.260	0.0277	11.8
FS02(3)	1/29/2025	2	pending	pending	pending	pending	pending	pending	pending	pending	pending	pending
			Resolved via PW	Resolved via PW	Resolved via PW	Resolved via PW	Resolved via PW	Resolved via PW	Resolved via PW	Resolved via PW		
Maximum Root Zone Background Concentration (0 - 3 ft)			7.30	116	0.406	<0.30	6.46	12.3	6.04	0.396	0.0443	22.1
125% Average Root Zone Background Concentration (0 - 3 ft)			9.13	145	0.508	0.38	8.08	15.38	7.55	0.495	0.0554	27.6

1. Bold values exceed the ECMC Table 915-1 limit(s)
2. Red & blue highlighted soil analytical values indicate an exceedance of the referenced soil screening level (SSL)

Sample ID	Sample Date	Depth (ft)	Arsenic (mg/kg)	Barium (mg/kg)	Cadmium (mg/kg)	Chromium (VI) (mg/kg)	Copper (mg/kg)	Lead (mg/kg)	Nickel (mg/kg)	Selenium (mg/kg)	Silver (mg/kg)	Zinc (mg/kg)
ECMC Table 915-1 Limits (Residential SSL)			0.68	15000	71	0.3	3100	400	1500	390	390	23000
ECMC Table 915-1 Limits (Protection of Groundwater SSL)			0.29	82	0.38	0.00067	46	14	26	0.26	0.8	370

* Indicates laboratory minimum detection limit in excess of SSL

NA - Not analyzed

 = Source material characterization sample, excavated and transported off site for disposal.

 = Material excavated and transported off site for disposal.

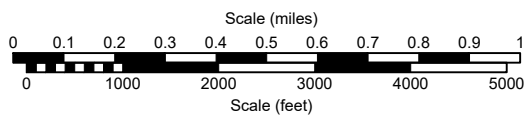
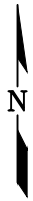

USGS 7.5 MINUTE SERIES (TOPOGRAPHIC)

Figure 1
SITE LOCATION MAP





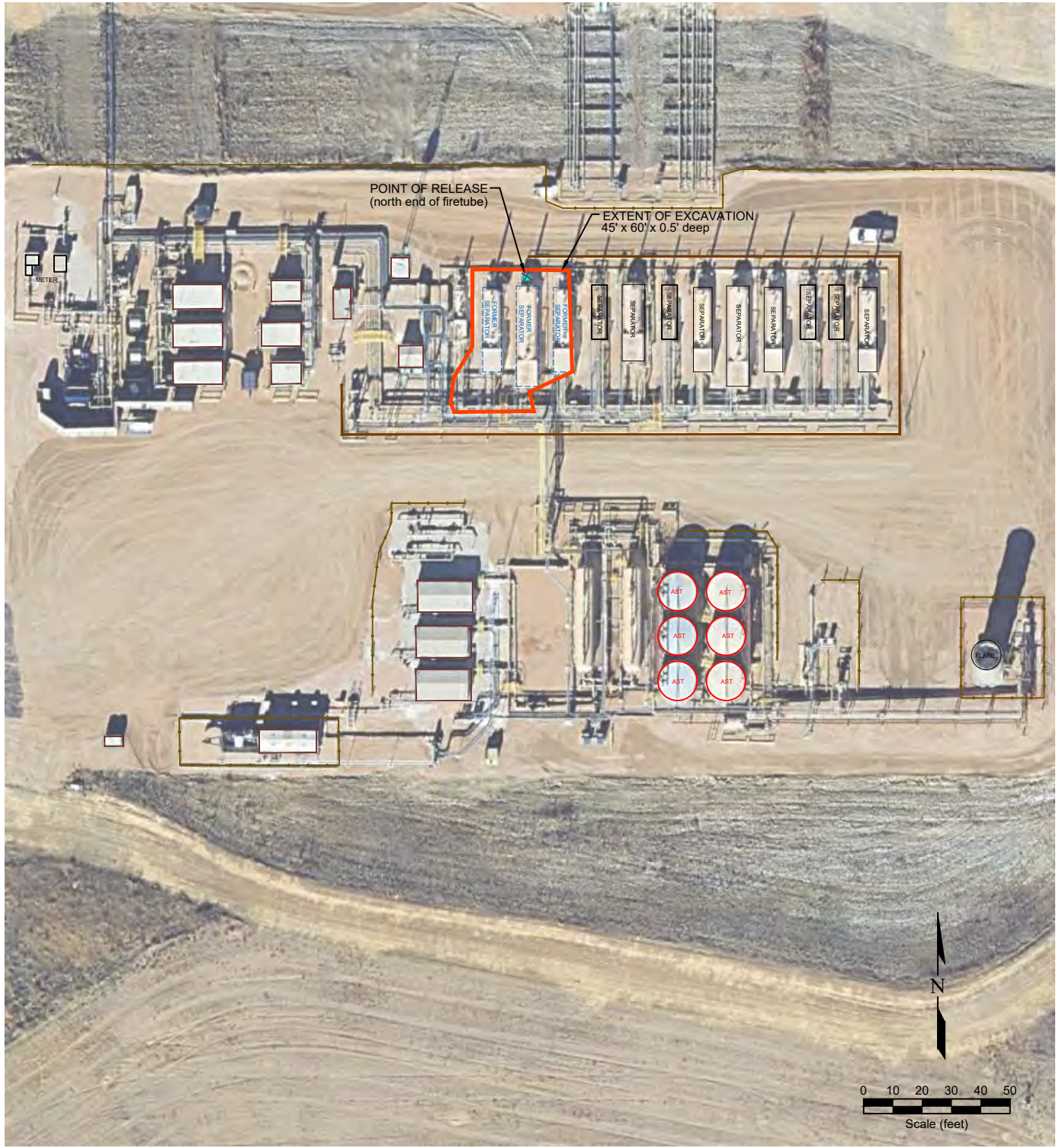

PDC Energy, Inc. ~ Gus LD Pad
 SENE Sec. 21, T1S, R67W, 6th PM
 Adams County, Colorado
 39.952212°, -104.885496°

Project # C024-122	API #	Facility #
Date 2/12/25	Remediation #	Filename 24122T





LEGEND

-  POINT OF RELEASE
-  ABOVE GROUND STORAGE TANK
-  FORMER FACILITY
-  BUILDING
-  EXTENT OF EXCAVATION
-  FENCE LINE
-  CONTAINMENT BERM
-  CONTAINMENT WALL

**Figure 2
SITE MAP**

PDC Energy, Inc. ~ Gus LD Pad
 SENE Sec. 21, T1S, R67W, 6th PM
 Adams County, Colorado
 39.952212°, -104.885496°

Project No. C024-122	API #	Facility #
Date 2/12/25	Remediation #	Filename 24122Q1



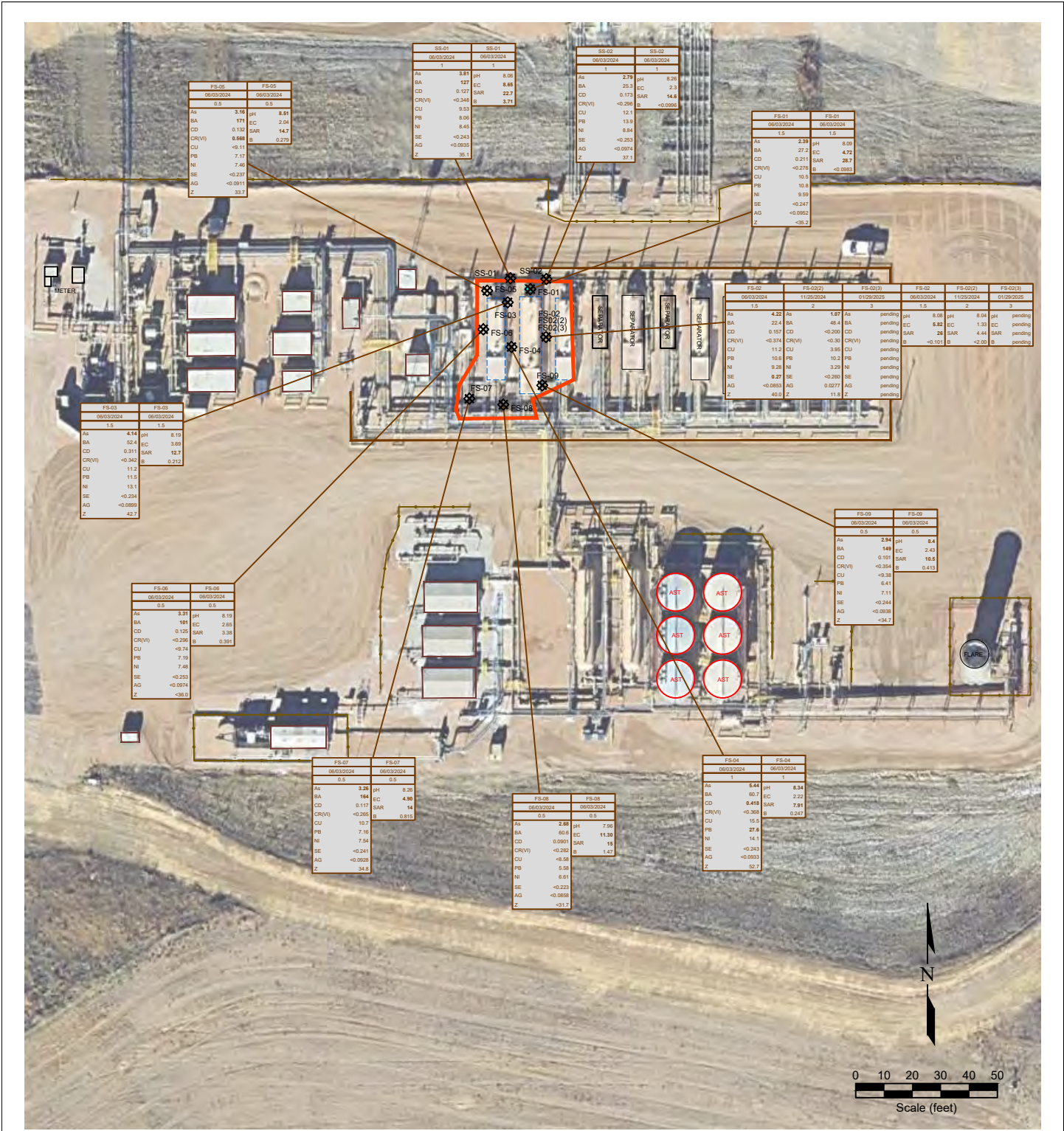

LEGEND

- POINT OF RELEASE
- ABOVE GROUND STORAGE TANK
- SOIL SAMPLE LOCATION
- FORMER FACILITY
- BUILDING
- EXTENT OF EXCAVATION
- FENCE LINE
- CONTAINMENT BERM
- CONTAINMENT WALL

SAMPLE DATE	SAMPLE ID	DATE SAMPLED	DEPTH (ft)	SAMPLE DATE	SAMPLE ID	DATE SAMPLED	DEPTH (ft)
As	<0.01	ARSENIC (mg/kg)	pH	<50	pH (unitless)		
BA	<0.01	BARIIUM (mg/kg)	EC	7.00	EC (microhm/cm)		
CD	<0.01	CADMIUM (mg/kg)	SAR	<1	SAR (unitless)		
CR(V)	<0.01	CHROMIUM (mg/kg)	B	<1	BORDON (mg/L)		
CU	<0.01	COPPER (mg/kg)					
PB	<0.01	LEAD (mg/kg)					
NI	<0.01	NICKEL (mg/kg)					
SE	<0.01	SELENIUM (mg/kg)					
AG	<0.01	SILVER (mg/kg)					
Z	<0.01	ZINC (mg/kg)					

**Figure 4
METALS AND INORGANIC SOIL CHEMISTRY MAP**

PDC Energy, Inc. ~ Gus LD Pad
SENE Sec. 21, T1S, R67W, 6th PM
Adams County, Colorado
39.952212°N, -104.885496°W

Project No. C024-122	API #	Facility #	
Date 2/12/25	Remediation #	Filename 24122Q1	

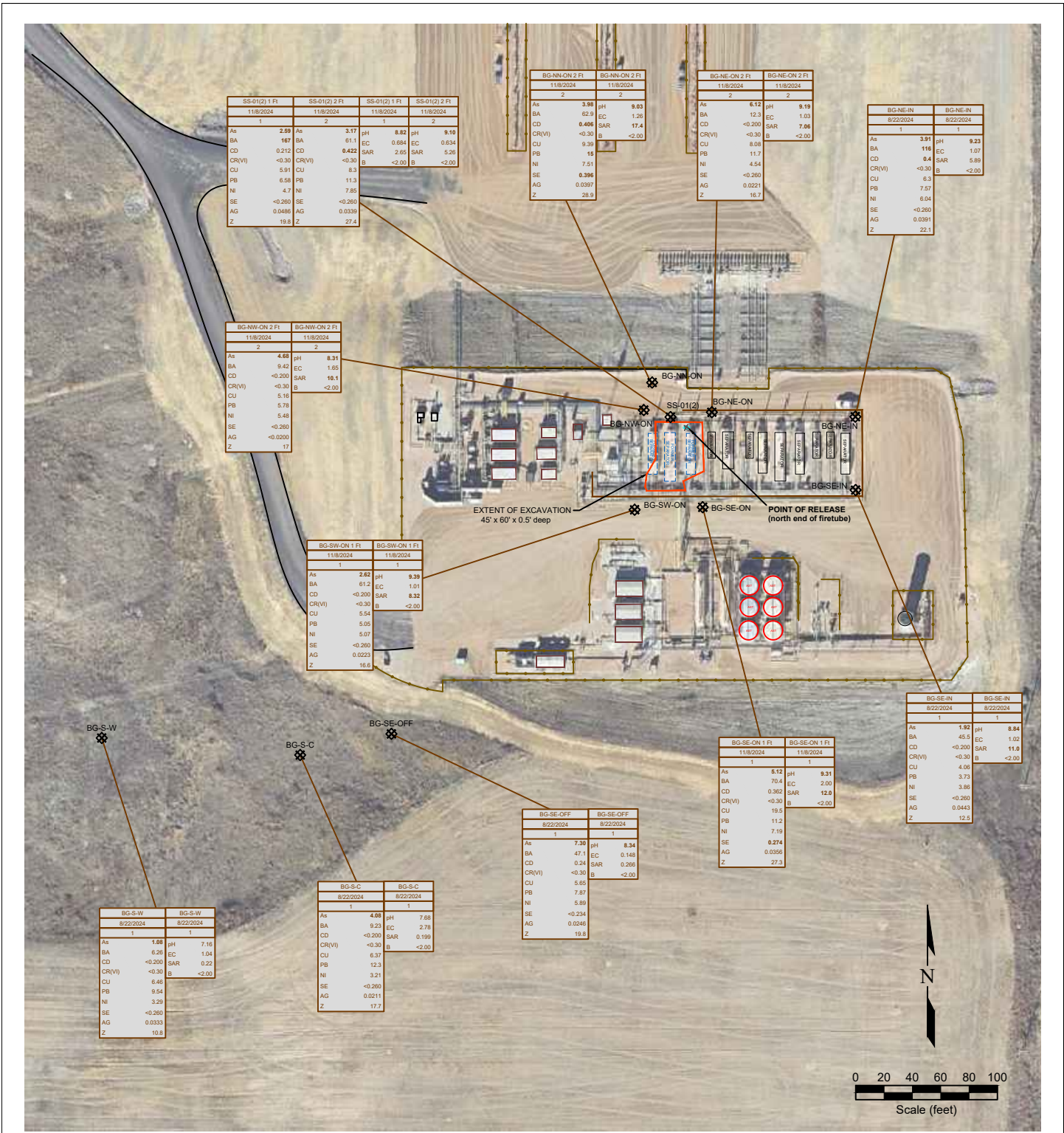

- POINT OF RELEASE
- ABOVE GROUND STORAGE TANK
- FORMER FACILITY
- EXTENT OF EXCAVATION
- FENCE LINE
- CONTAINMENT BERM
- CONTAINMENT WALL
- SOIL SAMPLE LOCATION
- BUILDING
- BUILDING

SAMPLE DATE	SAMPLE ID	DATE SAMPLED	SAMPLE ID	DATE SAMPLED
As	<0.01	ARSENIC (mg/kg)	pH	<5.01
BA	<0.01	BARIUM (mg/kg)	EC	7.01
CD	<0.01	CADMIUM (mg/kg)	SAR	<1
CR(VI)	<0.01	CHROMIUM (mg/kg)	B	<2.00
CU	<0.01	COPPER (mg/kg)		
PB	<0.01	LEAD (mg/kg)		
Ni	<0.01	NICKEL (mg/kg)		
SE	<0.01	SELENIUM (mg/kg)		
AG	<0.01	SILVER (mg/kg)		
Z	<0.01	ZINC (mg/kg)		

Figure 5
BACKGROUND SAMPLE SOIL CHEMISTRY MAP

PDC Energy, Inc. ~ Gus LD Pad
SENE Sec. 21, T1S, R67W, 6th PM
Adams County, Colorado
39.952212°, -104.885496°

Project No. C024-122	API #	Facility #	
Date 2/12/25	Remediation #	Filename 24122QBKG	

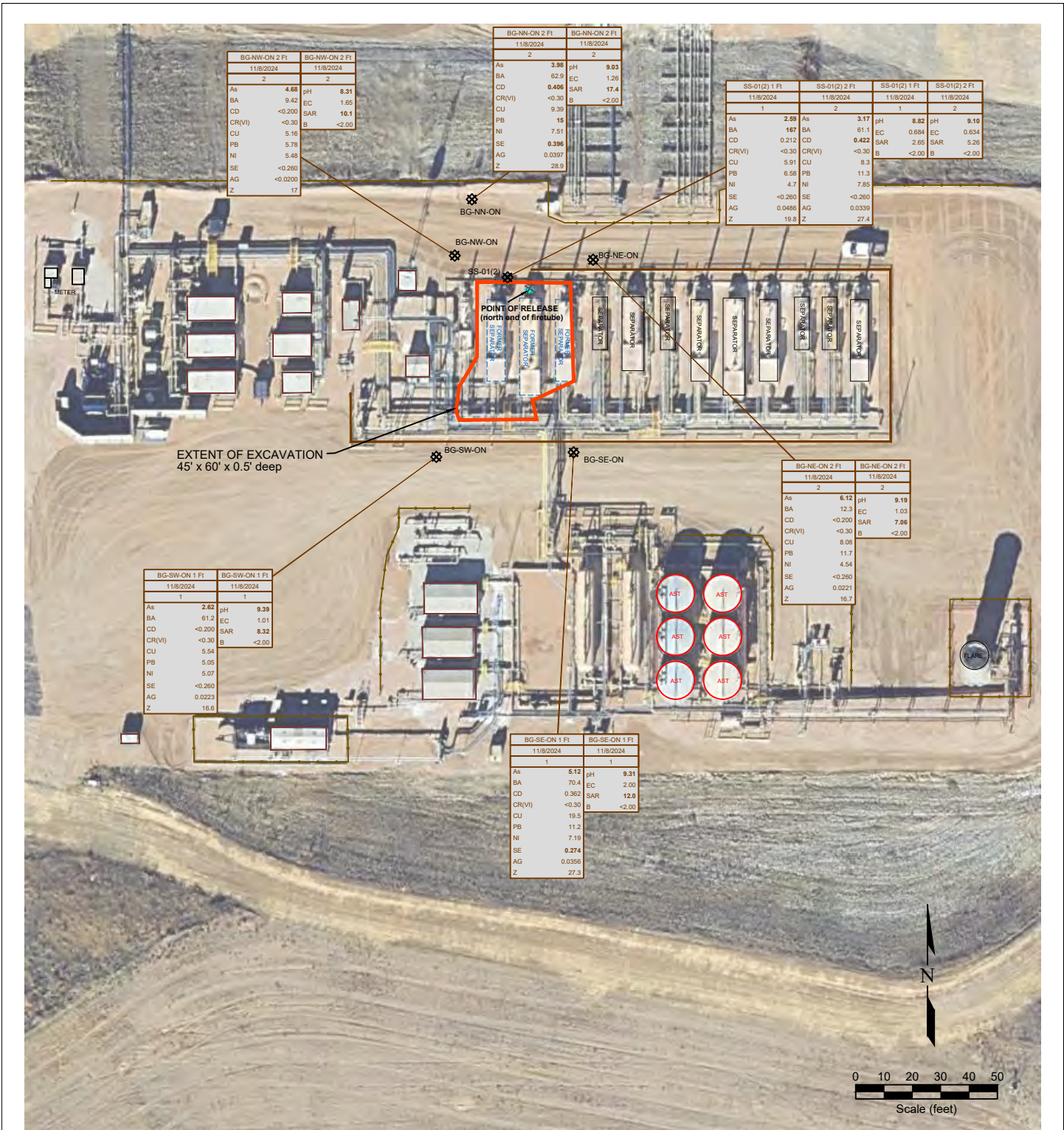

Figure 6
BACKGROUND SAMPLE SOIL CHEMISTRY MAP

PDC Energy, Inc. ~ Gus LD Pad
SENE Sec. 21, T1S, R67W, 6th PM
Adams County, Colorado
39.952212°, -104.885496°

Project No. C024-122	API #	Facility #
Date 2/12/25	Remediation #	Filename 24122QBKG2



SAMPLE DATE	SAMPLE ID	DEPTH (ft)	ANALYSIS	DATE SAMPLED	SAMPLE ID	DEPTH (ft)	ANALYSIS
11/8/2024	As	2	ARSENIC (mg/kg)	11/8/2024	As	1	ARSENIC (mg/kg)
11/8/2024	BA	2	BARIUM (mg/kg)	11/8/2024	BA	1	BARIUM (mg/kg)
11/8/2024	CD	2	CADMIUM (mg/kg)	11/8/2024	CD	1	CADMIUM (mg/kg)
11/8/2024	CR(VI)	2	CHROMIUM (mg/kg)	11/8/2024	CR(VI)	1	CHROMIUM (mg/kg)
11/8/2024	CU	2	COPPER (mg/kg)	11/8/2024	CU	1	COPPER (mg/kg)
11/8/2024	PB	2	LEAD (mg/kg)	11/8/2024	PB	1	LEAD (mg/kg)
11/8/2024	NI	2	NICKEL (mg/kg)	11/8/2024	NI	1	NICKEL (mg/kg)
11/8/2024	SE	2	SELENIUM (mg/kg)	11/8/2024	SE	1	SELENIUM (mg/kg)
11/8/2024	AG	2	SILVER (mg/kg)	11/8/2024	AG	1	SILVER (mg/kg)
11/8/2024	Z	2	ZINC (mg/kg)	11/8/2024	Z	1	ZINC (mg/kg)