



Remediation Soil & Groundwater Sampling Fieldsheet

* * * Facility Information * * *

O&G Site Name	Labrisa 11-35HZ Facility	Client	Oxy	REM Project #	488519
Weather	Cloudy 53F	Surface Flow Direction	E-SE		
API/TB#	485208	Liner present?	N/A	Site Coordinates	40.090250°N -104.631710°W

Directions to Well: Intersection of Highway 76 and County Road 47, immediate left parallelling frontage road 2/3 mile west/ southwest into.

* * * Sampling Information * * *

Sample Date	11/5/2024
Sampler(s)	JC / TS

Sample ID	Time	Date	Lab?	PID (ppm)	Location Description	Staining/ Odor	Color/ Lithology
WC01@3"	1:15 PM	11/5/2024	Yes	1460	8' N of Pump Source	Yes	DK BRN SAND
BG01@3"	1:35 PM	11/5/2024	Yes	0.9	NW-W Corner of Facility	No	BRN LOAMY SAND
BG02@3"	1:37 PM	11/5/2024	Yes	0.0	NW-N Corner of Facility	No	BRN LOAMY SAND
BG03@3"	1:39 PM	11/5/2024	Yes	0.4	NE-N Corner of Facility	No	BRN LOAMY SAND
BG04@3"	1:40 PM	11/5/2024	Yes	0.7	E of Facility	No	BRN LOAMY SAND
BG05@3"	1:42 PM	11/5/2024	Yes	0.9	N of Facility	No	Lt BRN SAND
BG06@3"	1:45 PM	11/5/2024	Yes	0.6	E of Facility	No	Lt BRN SAND
REL-B01@1'	9:50	11/21/2024	Yes	50	W Half of Dig Area	Faint	BRN LOAMY SAND
REL-B02@1'	9:55	11/21/2024	Yes	46	E Half of Dig Area	Faint	BRN LOAMY SAND
REL-B03@4'	14:00	12/12/2024	Yes	1.9	W Half of Dig Area	No	BRN LOAMY SAND
REL-B04@4'	14:05	12/12/2024	Yes	2.5	E Half of Dig Area	No	BRN LOAMY SAND
REL-N01@2'	14:10	12/12/2024	Yes	1.3	N Sidewall of Dig Area	No	BRN LOAMY SAND
REL-N02@2'	14:15	12/12/2024	Yes	1.1	N Sidewall of Dig Area	No	BRN LOAMY SAND
REL-E01@2'	14:20	12/12/2024	Yes	6.8	E Sidewall of Dig Area	No	BRN LOAMY SAND
REL-E02@2'	14:25	12/12/2024	Yes	13.2	E Sidewall of Dig Area	Faint	BRN LOAMY SAND
REL-S01@2'	14:30	12/12/2024	Yes	0.8	S Sidewall of Dig Area	No	BRN LOAMY SAND
REL-W01@2'	14:35	12/12/2024	Yes	2.2	W Sidewall of Dig Area	No	BRN LOAMY SAND
REL-E03@2'	14:00	1/21/2025	Yes	2.3	E Sidewall of Dig Area	No	BRN LOAMY SAND

Decon Methods: Alconox & DI Water	Depth GW observed: None
-----------------------------------	-------------------------

GW Sampling									
Sample ID	Date	Time	Odor?	Sheen?	Sample ID	Date	Time	Odor?	Sheen?

Site Comments: Active facility



Sampling Photographic Log

Labrisa 11-35 HZ Facility



Description:

WC01@3"



11/05/2024 13:11
+40.090268,-104.631780
Labrisa 11-35HZ Facility

Description:

Waste Characterization
Photo 2, W. Boundary



Description:

Waste Characterization
Photo 3, SW boundary



11/05/2024 13:12
+40.090268,-104.631780
Labrisa 11-35HZ Facility

Description:

Waste Characterization
Photo 4, S. Boundary



Description:

Waste Characterization
Photo 5, S. boundary





Description:

Waste Characterization
Photo 7, ESE boundary



Description:

Waste Characterization
Photo 8, E. boundary



Description:

Waste Characterization
Photo 9, ENE boundary

11/05/2024 13:13
+40.090223,-104.631662
Labrisa 11-35HZ Facility



Description:

WC01@3"

Waste Characterization

Photo 10, N. Boundary

11/05/2024 14:00
+40.090654,-104.632173
Labrisa 11-35HZ Facility



Description:

BG01@3"

11/05/2024 14:01
+40.090964,-104.632042
Labrisa 11-35HZ Facility



Description:

BG02@3"



Description:

BG03@3"



Description:

BG04@3"

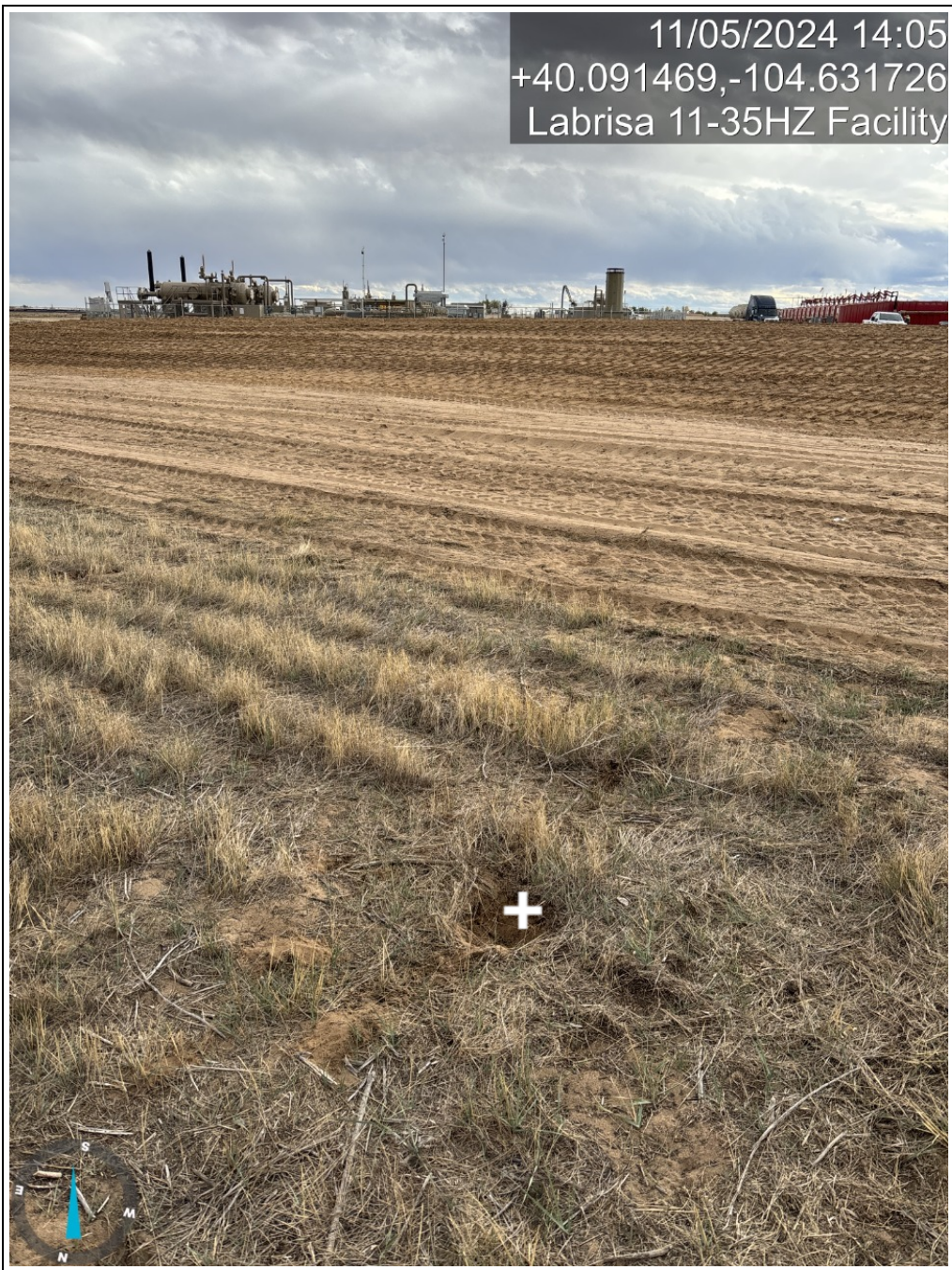

11/05/2024 14:05
+40.091469,-104.631726
Labrisa 11-35HZ Facility

Description:

BG05@3"



Description:

BG06@3"



Description:

REL-B02@1'



Description:

REL-B01@1'

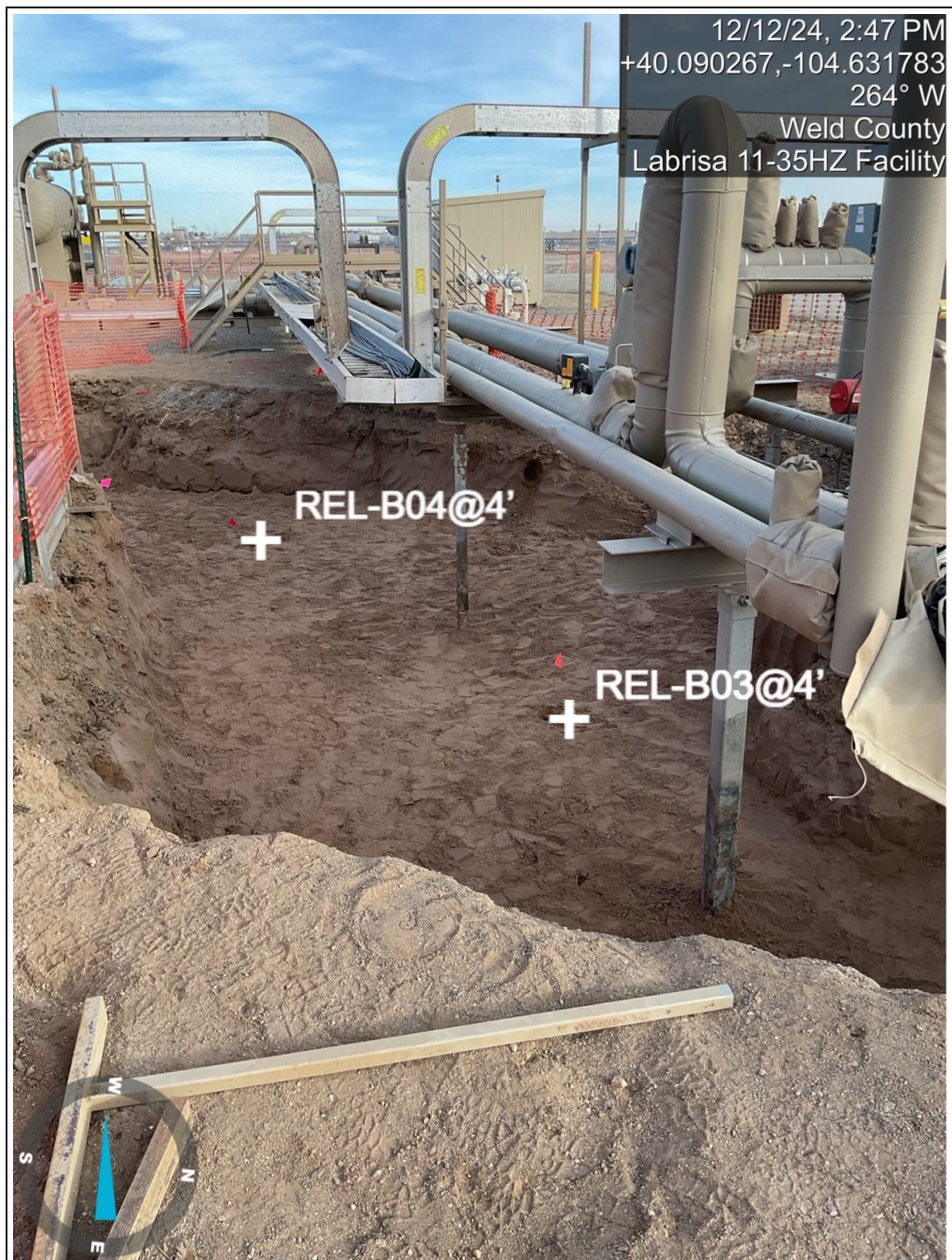

12/12/24, 2:47 PM
+40.090267,-104.631783
264° W
Weld County
Labrisa 11-35HZ Facility

Description:

REL-B03@4'
REL-B04@4'



Description:

REL-N01@2'



Description:

REL-N02@2'



Description:

REL-E01@2'

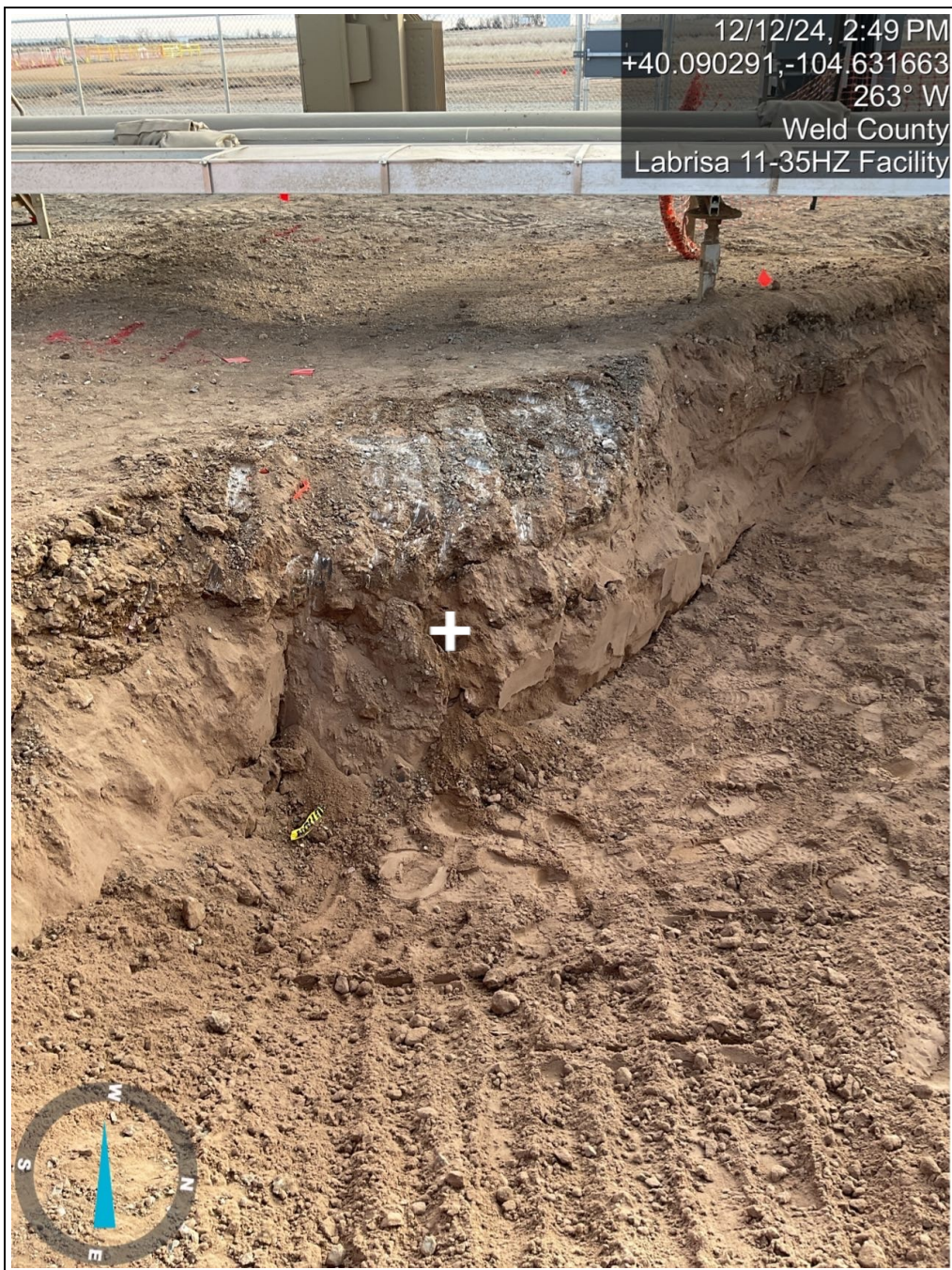

Description:

REL-E02@2'



Description:

REL-S01@2'



Description:

REL-W01@2'



Description:

E View of Pit



Description:

W View of Pit



Description:

NE Entrance to Pit



Description:

REL-E03@2'