



FORM F-106



00048457

R. 56W

RECEIVED

JAN 19 1978

OIL & GAS CONS. COM.

N

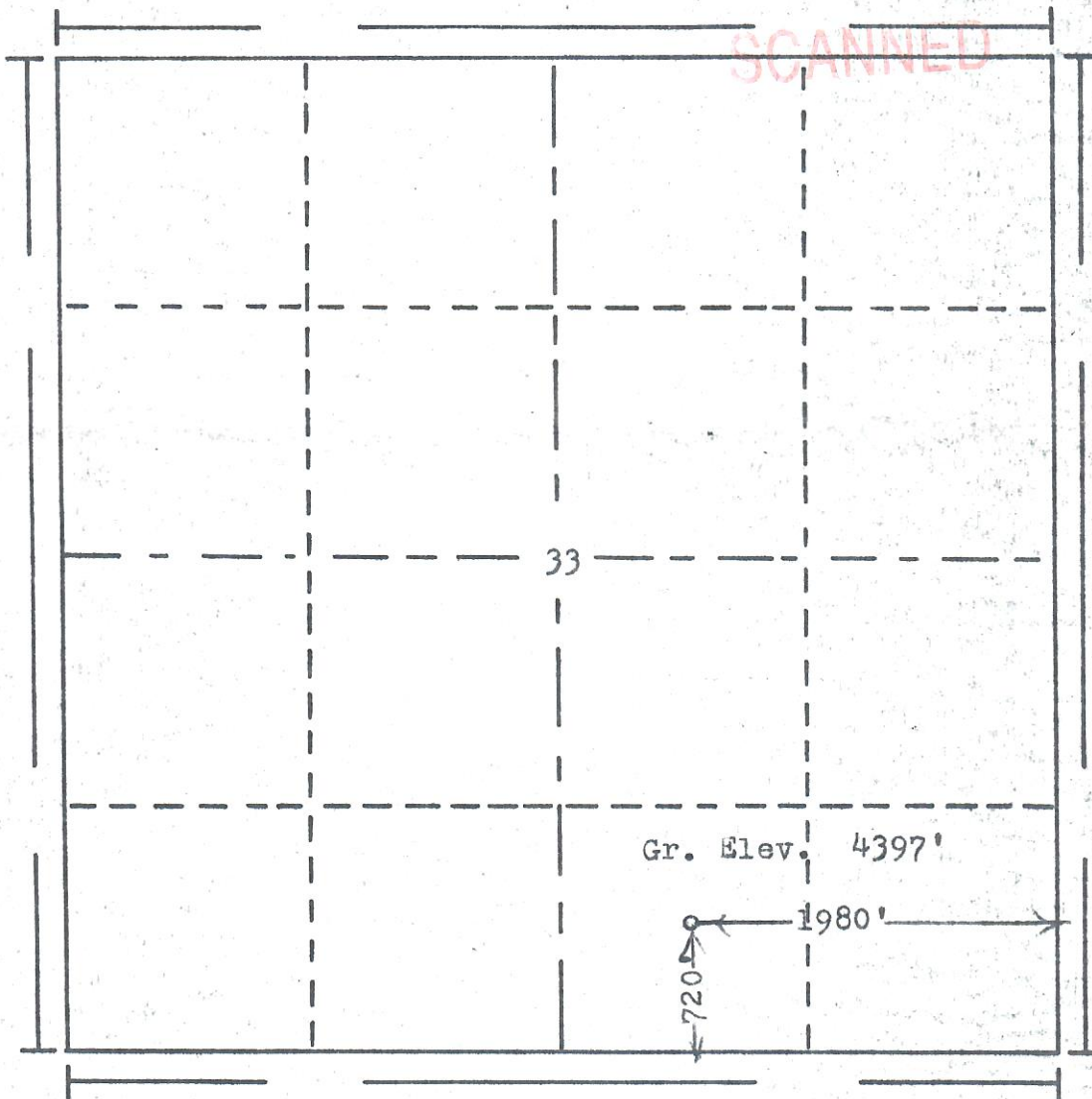
T.
2
N

Scale... 1" = 1000'

Powers Elevation Company, Inc. of Denver, Colorado
has in accordance with a request from Mr. Murphree
for Okmar Oil Co.
determined the location of No. 1 Peterson "A"
to be 720' FS & 1980' FE Section 33 Township 2N
Range 56W of the 6th Principal Meridian
Morgan County, Colorado

I hereby certify that this plat is an
accurate representation of a correct
survey showing the location of

Date: 10-2-77

Billy G. Henry
Licensed Land Surveyor No. 2853
State of Colorado