

# Inspection Photos

12/18/2024

**Operator:** CAERUS PICEANCE LLC 10456  
(QB ENERGY OPERATING LLC - 10844)

**Location ID:** 418660

**Inspection Doc:** 718100131

Mesa County, CO

Aaron Trujillo

Western Reclamation Work Lead

ECMC



**COLORADO**

**Energy & Carbon Management  
Commission**

Department of Natural Resources

## Inspection Photos

Operator Name: CAERUS PICEANCE LLC 10456 (QB ENERGY OPERATING LLC - 10844)

Location ID: 418660



**Photo 1:** Photos 1-2 taken from the south end of the Location. Photos provide an overview of the Location from east, southeast, southwest to west. Photos show reclamation of areas not necessary for production have not been performed in accordance with 1003 requirements.



**COLORADO**

**Energy & Carbon Management  
Commission**

Department of Natural Resources



## Inspection Photos

Operator Name: CAERUS PICEANCE LLC 10456 (QB ENERGY OPERATING LLC - 10844)

Location ID: 418660



**Photo 2:** See comments under photo 1.



**COLORADO**

**Energy & Carbon Management  
Commission**

Department of Natural Resources



## Inspection Photos

Operator Name: CAERUS PICEANCE LLC 10456 (QB ENERGY OPERATING LLC - 10844)

Location ID: 418660



**Photo 3:** Photos 3-4 taken from the west end of the Location. Photos provide an overview of the Location from northwest, north, east to southeast. Photos show reclamation of areas not necessary for production have not been performed in accordance with 1003 requirements.



**COLORADO**

**Energy & Carbon Management  
Commission**

Department of Natural Resources



## Inspection Photos

Operator Name: CAERUS PICEANCE LLC 10456 (QB ENERGY OPERATING LLC - 10844)

Location ID: 418660



**Photo 4:** See comments under photo 3.



**COLORADO**

**Energy & Carbon Management  
Commission**

Department of Natural Resources

## Inspection Photos

Operator Name: CAERUS PICEANCE LLC 10456 (QB ENERGY OPERATING LLC - 10844)

Location ID: 418660



**Photo 5:** 2022 Google Earth aerial imagery. Photo provides an overview of the Stewart #36-13H Location (#418660). Production facilities (not including the well) have not been installed on the Location, rather, produced fluids travel via Off-Location flowline to the Stewart Compressor/(PL36SW) Location north. Red polygons represent approximate areas of the Location that are not necessary for production, and are subject to 1003.b reclamation requirements.



**COLORADO**

**Energy & Carbon Management  
Commission**

Department of Natural Resources

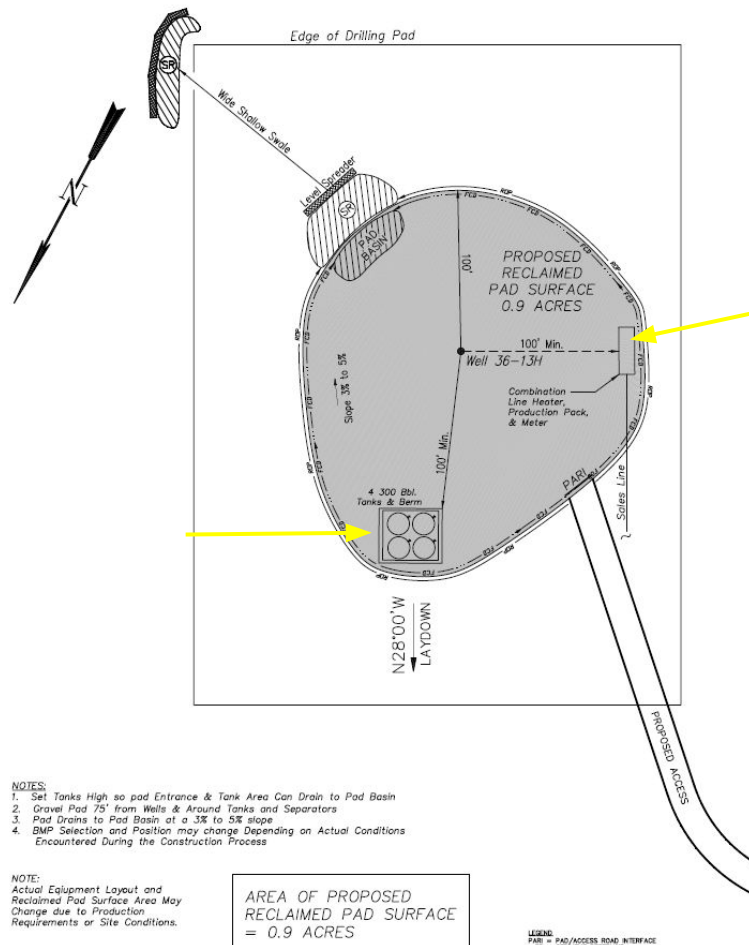

**Photo 6:** Figure taken from the Form 2A Layout Drawing (#400062072). Image shows production areas were to be reduced to ~0.9 acres. Note- tank and other production facilities (arrow) were not installed, resulting in additional areas (~75 foot buffer beyond the well) not necessary for production at this Location, requiring reclamation.