

## Wellhead Closure Checklist

### COGCC Rule 911.a.(4) Environmental Site Closure Assessment Field Form

Additional attachments (optional): <u>—</u>	Pit Closure <u>—</u>	Tank Battery Closure <u>—</u>	Flowline Closure <u>—</u>	Partially Buried Vault Closure <u>—</u>
Site Name & COGCC Facility Number: <u>Stephens J #31-9</u>		Date: <u>4/21/22</u>		Remediation Project #: <u>22242</u>
Associated Wells: <u>05-123-23297</u>		Age of Site: <u>Years</u>		Number of Photos Attached: <u>1</u>
Location: (GPS coordinates of wellhead or southeastern most wellhead for multiple) <u>40.354071 / -104.815566</u>				Estimated Facility Size (acres): <u>—</u>

General Condition of Site: (General observations regarding housekeeping, corrosion, waste management, etc.)  
Good

USCS Soil Type: SC Estimated Depth to Groundwater: ~10-15'

Hydrocarbon Impacted Soils / Spills: (Note estimated size and if impact appears to be surficial or extends to an unknown depth)  
None observed

Salt Crusted Soils or Impacted Vegetation: (Note estimated size and if impact appears to be surficial or extends to an unknown depth)  
None observed

Wellhead(s)						
Well API	<u>05-123-23297</u>					
Age	<u>Years</u>					
Condition of surface around wellhead	<u>Good per crew</u>					
PID Readings	<u>N/A - Excavated upon arrival</u>					
Condition of subsurface (at minimum, minimum PID Readings)	<u>Good</u>					
PID Readings	<u>2.2</u>	<u>2.0</u>	<u>1.9</u>	<u>1.9</u>	<u>2.7</u>	
Sample taken? Location/Sample ID#	<u>WH-SS-01</u>	<u>WH-SS-02</u>	<u>WH-SS-03</u>	<u>WH-SS-04</u>	<u>WH-FS-01</u>	
Photo Number(s)	<u>See photo log</u>					

Other observations regarding wellheads:  
Well casing cut/capped following assessment

#### Summary

Was impacted soil identified? <u>No</u> Yes - less than 10 cubic yards Yes - more than 10 cubic yards		
Total number of samples field screened: <u>5</u>	Total number of samples collected: <u>5</u>	
Highest PID Reading: <u>2.7</u>	Total number of samples submitted to lab for analysis: <u>1</u>	
If more than 10 cubic yards of impacted soil were observed:		
Vertical extent:	Estimated spill volume:	
Lateral extent: <u>N/A</u>	Volume of soil removed:	
Is additional investigation required?		
Was groundwater encountered during the investigation? <u>No</u> Yes - not impacted or in contact with impacted soils Yes - groundwater impacted and/or in contact with impacted soils		
Measured depth to groundwater:	Was remedial groundwater removal conducted? Yes No	
Date Groundwater was encountered:	Commencement date of removal:	
Sheen on groundwater? Yes No	Volume of groundwater removed prior to sampling:	
Free product observed? Yes No	Volume of groundwater removed post sampling:	
Total number of samples collected:	Total Volume of groundwater removed:	
Total number of samples submitted to lab for analysis:		



## **FIGURES**

**Figure 1: Topographic Site Location Map**

**Figure 2: Aerial Site Location Map**

**Figure 3: Soil Analytical Map**

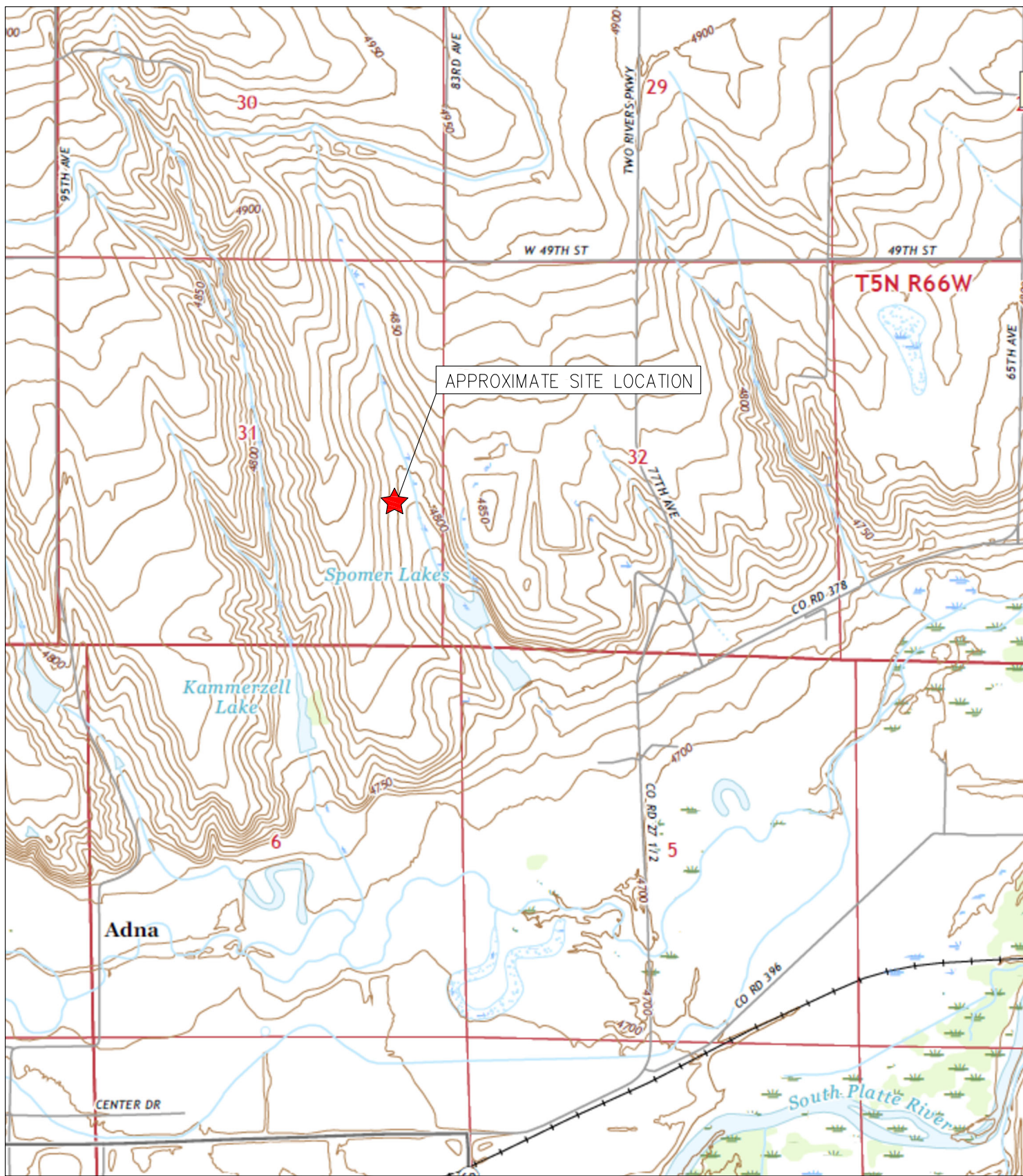

TOPOGRAPHIC SITE LOCATION MAP  
 STEPHENS J #31-9  
 CLOSURE ASSESSMENT  
 40.354071 / -104.815566  
 NE¼ SE¼ SEC.31 T5N R66W 6PM  
 WELD COUNTY, COLORADO  
 API # 05-123-23297  
 REMEDIATION # 22242



**EAGLE**  
 ENVIRONMENTAL  
 CONSULTING, LLC

8000 W 44th Ave, Wheat Ridge, CO 80033  
 Ph: 303-433-0479 • F: 303-325-5449





**LEGEND**

- FORMER STEPHENS J #31-9 WELLHEAD (PLUGGED AND ABANDONED)
- ASSOCIATED SEPARATOR
- APPROXIMATE FLOWLINE LOCATION

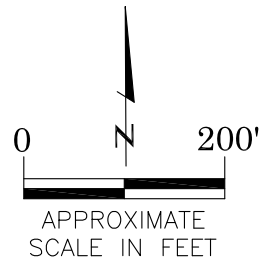

AERIAL SITE LOCATION MAP  
 STEPHENS J #31-9  
 CLOSURE ASSESSMENT  
 40.354071 / -104.815566  
 NE¼ SE¼ SEC.31 T5N R66W 6PM  
 WELD COUNTY, COLORADO  
 API # 05-123-23297  
 REMEDIATION # 22242

DRAWN BY:  
 RH

FIGURE NO.  
 2



**EAGLE**  
 ENVIRONMENTAL  
 CONSULTING, LLC  
 8000 W 44th Ave, Wheat Ridge, CO 80033  
 Ph: 303-433-0479 • F: 303-325-5449



**LEGEND**

- WELLHEAD ASSESSMENT BOUNDARIES
- SS-02 APPROXIMATE LOCATION OF SOIL SAMPLES FIELD SCREENED, ONLY, WITH PHOTOIONIZATION DETECTOR
- APPROXIMATE LOCATION OF SOIL SAMPLES SUBMITTED FOR LABORATORY ANALYSIS

**PARAMETERS**

SAMPLE LOCATION
DATE
DEPTH (FEET)
B = BENZENE (mg/kg)
T = TOLUENE (mg/kg)
E = ETHYLBENZENE (mg/kg)
X = TOTAL XYLENES (mg/kg)
G = TPH-GRO (mg/kg)
D = TPH-DRO (mg/kg)
R = TPH-RRO (mg/kg)
1,2,4-TMB = 1,2,4 TRIMETHYLBENZENE (mg/kg)
1,3,5-TMB = 1,3,5 TRIMETHYLBENZENE (mg/kg)
Brn= BORON (mg/L)
EC = SPECIFIC CONDUCTANCE (mmhos/cm)
SAR= SODIUM ADSORPTION RATIO
pH = pH (pH UNITS)
POLYCYCLIC AROMATIC HYDROCARBONS (PAHs) (mg/kg)

mg/kg = MILLIGRAMS PER KILOGRAM  
 mg/L = MILLIGRAMS PER LITER  
 mmhos/cm = MILLIMHOS PER CENTIMETER

TPH-GRO = TOTAL PETROLEUM HYDROCARBONS – GASOLINE RANGE ORGANICS  
 TPH-DRO = TOTAL PETROLEUM HYDROCARBONS – DIESEL RANGE ORGANICS  
 TPH-RRO = TOTAL PETROLEUM HYDROCARBONS – RESIDUAL RANGE ORGANICS

(BRL) = ALL CONCENTRATIONS/VALUES BELOW REGULATORY LIMITS

NOTES:  
 VALUES PRESENTED IN **BOLD** EXCEED COGCC TABLE 915-1 REGULATORY LIMITS.

COGCC = COLORADO OIL AND GAS CONSERVATION COMMISSION

SOIL ANALYTICAL MAP  
 STEPHENS J #31-9  
 CLOSURE ASSESSMENT  
 40.354071 / -104.815566  
 NE¼ SE¼ SEC.31 T5N R66W 6PM  
 WELD COUNTY, COLORADO  
 API # 05-123-23297  
 REMEDIATION # 22242

FIGURE NO.  
 3  
 DRAWN BY:  
 GK

**EAGLE**  
 ENVIRONMENTAL  
 CONSULTING, LLC  
 8000 W 44th Ave, Wheat Ridge, CO 80033  
 Ph: 303-433-0479 • F: 303-325-5449

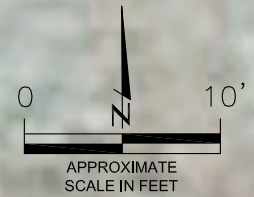



## **TABLES**

**Table 1: Photoionization Detector Reading Summary**

**Table 2: Soil Analytical Results Summary**

**TABLE 1**  
**PHOTOIONIZATION DETECTOR READING SUMMARY**  
**STEPHENS J #31-9**  
**CLOSURE ASSESSMENT**  
**40.354071 / -104.815566**  
**NE¼ SE¼ SEC.31 T5N R66W 6PM**  
**WELD COUNTY, COLORADO**  
**API # 05-123-23297**  
**REMEDATION # 22242**

Sample Location (Latitude/Longitude)	Date	Approximate Depth (feet)	PID Reading (ppm-v)	Lab Submission (Y/N)
WH-SS-01 @ 5' (40.354087 / -104.815559)	04/21/22	5	2.2	N
WH-SS-02 @ 5' (40.354078 / -104.815553)	04/21/22	5	2.0	N
WH-SS-03 @ 5' (40.354062 / -104.815560)	04/21/22	5	1.9	N
WH-SS-04 @ 5' (40.354075 / -104.815589)	04/21/22	5	1.9	N
WH-FS-01 @ 6' (40.354076 / -104.815561)	04/21/22	6	2.7	Y
(Y/N) = Yes or No ppm-v = parts per million by volume PID = Photoionization Detector				

TABLE 2  
SOIL ANALYTICAL RESULTS SUMMARY  
STEPHENS J #31-9  
CLOSURE ASSESSMENT  
40.354071 / -104.815566  
NE¼ SE¼ SEC.31 T5N R66W 6PM  
WELD COUNTY, COLORADO  
API # 05-123-23297  
REMEDATION # 22242

Sample Location		WH-FS-01 @ 6'		
(Latitude / Longitude)		(40.354076 / -104.815561)		
Sample Date		4/21/2022		
Sample Depth		6'		
PID Reading (ppm-v)		2.7		
Regulatory Limits				
Chemical of Concern	Units	COGCC Table 915-1 RSSLs	COGCC Table 915-1 GSSLs	
<b>VOCs</b>				
Benzene	mg/kg	1.2	0.0026	<0.00200
Toluene	mg/kg	490	0.69	<0.00200
Ethylbenzene	mg/kg	5.8	0.78	<0.00200
Total Xylenes	mg/kg	58	9.9	<0.00200
1,2,4-Trimethylbenzene	mg/kg	30	0.0081	<0.00200
1,3,5-Trimethylbenzene	mg/kg	27	0.0087	<0.00200
<b>TOTAL PETROLEUM HYDROCARBONS</b>				
TPH-GRO	mg/kg	500	--	<0.200
TPH-DRO	mg/kg	500	--	<25.0
TPH-RRO	mg/kg	500	--	<100
<b>POLYCYCLIC AROMATIC HYDROCARBONS</b>				
1-Methyl-naphthalene	mg/kg	18	0.006	<0.00067
2-Methyl-naphthalene	mg/kg	24	0.019	<0.00067
Acenaphthene	mg/kg	360	0.55	<0.00067
Anthracene	mg/kg	1800	5.8	<0.00067
Benzo(a)-anthracene	mg/kg	1.1	0.011	<0.00067
Benzo(a)-pyrene	mg/kg	0.11	0.24	0.000488
Benzo(b)-fluoranthene	mg/kg	1.1	0.3	<0.00067
Benzo(k)-fluoranthene	mg/kg	11	2.9	<0.00067
Chrysene	mg/kg	110	9	<0.00067
Dibenzo(a,h)-anthracene	mg/kg	0.11	0.096	<0.00067
Fluoranthene	mg/kg	240	8.9	0.00043
Fluorene	mg/kg	240	0.54	<0.00067
Indeno(1,2,3-cd)-pyrene	mg/kg	1.1	0.98	<0.00067
Naphthalene	mg/kg	2	0.0038	<0.00067
Pyrene	mg/kg	180	1.3	<0.00067
<b>SOIL SUITABILITY (Inorganics)</b>				
Boron	mg/L	2	--	0.417
pH	standard unit	6-8.3	--	8.15
Sodium Adsorption Ratio (SAR)	--	<6	--	0.755
Specific Conductance (EC)	mmhos/cm	<4	--	0.625
COGCC = Colorado Oil and Gas Conservation Commission mg/kg = milligrams per kilogram mmhos/cm = millimhos per centimeter PID = Photoionization Detector ppm-v = parts per million by volume mg/L = milligrams per liter SAR = Sodium Adsorption Ratio Notes: Values presented with a less than symbol (<) did not contain concentrations at or above the laboratory reporting limit and/or minimum detection limit. Values presented in <b>BOLD</b> exceed COGCC Table 915-1 Regulatory Limits.				



## **ATTACHMENT A**

### **Photo Log**

Stephens J #31-9  
API # 05-123-23297  
Remediation # 22242

Closure Assessment

April 2022



# Wellhead Excavation – 04/21/22

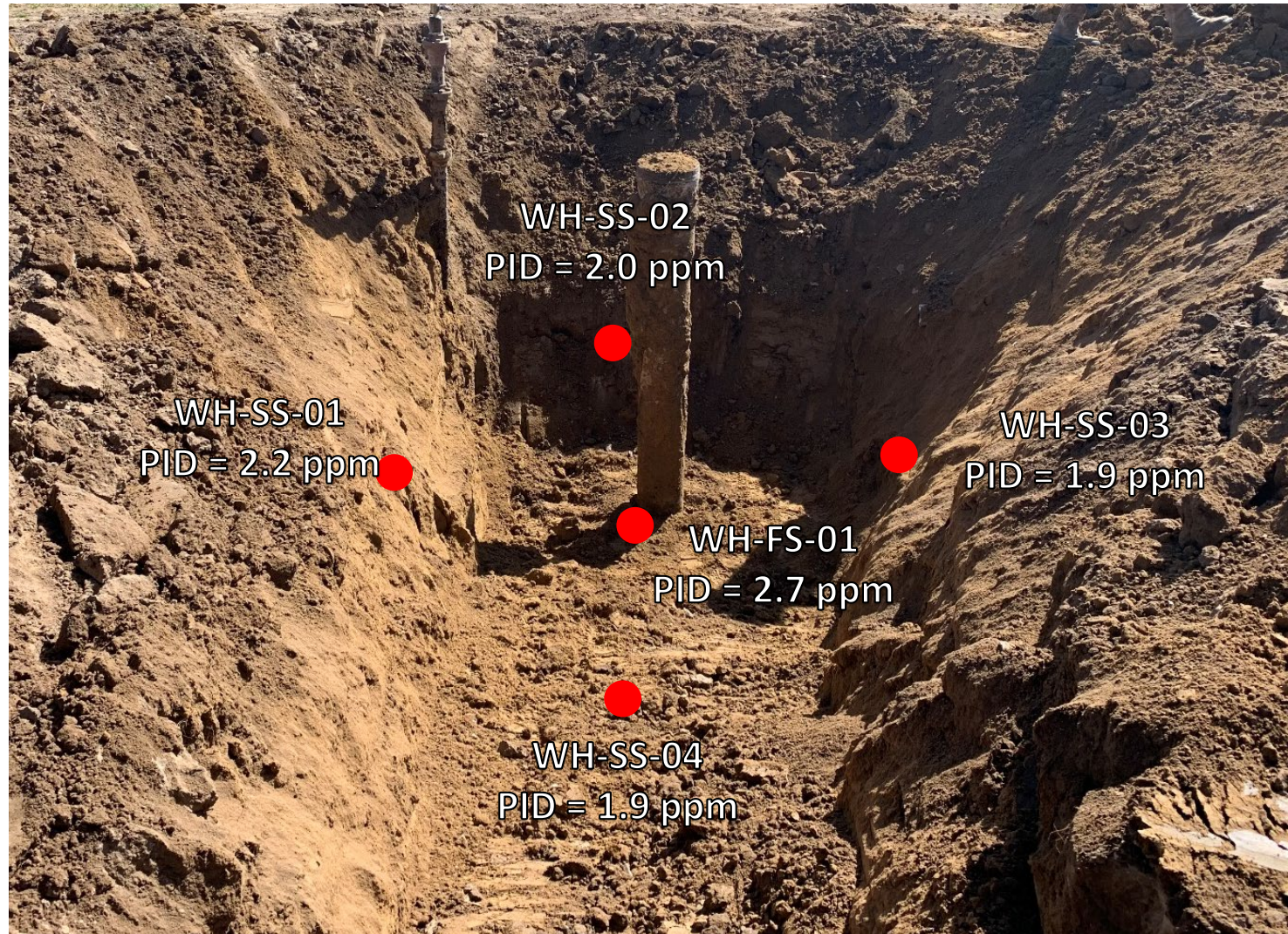

Looking east

No petroleum hydrocarbon staining or odor observed



## **ATTACHMENT B**

### **Laboratory Analytical Report**

May 03, 2022

Eagle Environmental Consulting, Inc.

Martin C Eckert III

8000 W 44th Ave

Wheat Ridge CO 80033

Project Name - Noble - Stephens J #31-9

Project Number - [none]

Attached are your analytical results for Noble - Stephens J #31-9 received by Origins Laboratory, Inc. April 21, 2022. This project is associated with Origins project number Y204502-01.

The analytical results in the following report were analyzed under the guidelines of EPA Methods. These methods are identified as follows; "SW" are defined in SW-846, "EPA" are defined in 40CFR part 136 and "SM" are defined in the most current revision of Standard Methods For the Examination of Water and Wastewater.

The analytical results apply specifically to the samples and analyses specified per the attached Chain of Custody. As such, this report shall not be reproduced except in full, without the written approval of Origin's laboratory.

Unless otherwise noted, the analytical results for all soil samples are reported on a wet weight basis. All analytical analyses were performed under NELAP guidelines unless noted by a data qualifier.

Any holding time exceedances, deviations from the method specifications or deviations from Origins Laboratory's Standard Operating Procedures are outlined in the case narrative.

Thank you for selecting Origins for your analytical needs. Please contact us with any questions concerning this report, or if we can help with anything at all.

Origins Laboratory, Inc.  
303.433.1322  
o-squad@oelabinc.com



Eagle Environmental Consulting, Inc.  
8000 W 44th Ave  
Wheat Ridge CO 80033

Martin C Eckert III  
Project Number: [none]  
Project: Noble - Stephens J #31-9

CROSS REFERENCE REPORT

Sample ID	Laboratory ID	Matrix	Date Sampled	Date Received
WH-FS-01@6'	Y204502-01	Soil	April 21, 2022 10:08	04/21/2022 15:44

Origins Laboratory, Inc.



*The results in this report apply to the samples analyzed in accordance with the chain of custody document. This analytical report must be reproduced in its entirety.*



Eagle Environmental Consulting, Inc.  
 8000 W 44th Ave  
 Wheat Ridge CO 80033

Martin C Eckert III  
 Project Number: [none]  
 Project: Noble - Stephens J #31-9

Origins Laboratory: F-012207-01-R1  
Effective Date: 01/09/12

**Sample Receipt Checklist**

Origins Work Order: Y204502 Client: Eagle  
 Checklist Completed by: JG Client Project ID: Stephens J 31-9  
 Date/time completed: 4/22/22 Shipped Via: HD  
 (UPS, FedEx, Hand Delivered, Pick-up, etc.)  
 Airbill #: N/A  
 Matrix(s) Received: (Check all that apply):  Soil/Solid  Water  Other: \_\_\_\_\_  
 Cooler Number/Temperature: 1 / 4.5 °C  / \_\_\_\_\_ °C  / \_\_\_\_\_ °C (Describe) \_\_\_\_\_ °C  
 Thermometer ID: T004

Requirement Description	Yes	No	N/A	Comments (if any)
If samples require cooling, was the temperature between 0°C to ≤ 6°C <sup>(1)</sup> ?	<input checked="" type="checkbox"/>			
Is there ice present (document if blue ice is used)	<input checked="" type="checkbox"/>			
Are custody seals present on cooler? (if so, document in comments if they are signed and dated, broken or intact)		<input checked="" type="checkbox"/>		
Are custody seals present on each sample container? (if so, document in comments if they are signed and dated, broken or intact)		<input checked="" type="checkbox"/>		
Were all samples received intact <sup>(1)</sup> ?	<input checked="" type="checkbox"/>			
Was adequate sample volume provided <sup>(1)</sup> ?	<input checked="" type="checkbox"/>			
Are short holding time analytes or samples with HTs due within 48 hours present <sup>(1)</sup> ?		<input checked="" type="checkbox"/>		
Is a chain-of-custody (COC) present and filled out completely <sup>(1)</sup> ?	<input checked="" type="checkbox"/>			
Does the COC agree with the number and type of sample bottles received <sup>(1)</sup> ?	<input checked="" type="checkbox"/>			
Do the sample IDs on the bottle labels match the COC <sup>(1)</sup> ?	<input checked="" type="checkbox"/>			
Is the COC properly relinquished by the client with date and time recorded <sup>(1)</sup> ?	<input checked="" type="checkbox"/>			
For volatiles in water – is there headspace (> ¼ inch bubble) present? <b>If yes, contact client and note in narrative.</b>			<input checked="" type="checkbox"/>	
Are samples preserved that require preservation and was it checked <sup>(1)</sup> ? (note ID of confirmation instrument used in comments) / (preservation is not confirmed for subcontracted analyses in order to insure sample integrity)/(pH <2 for samples preserved with HNO <sub>3</sub> , HCL, H <sub>2</sub> SO <sub>4</sub> ) / ( pH > 10 for samples preserved with NaAsO <sub>2</sub> +NaOH, ZnAc+NaOH)			<input checked="" type="checkbox"/>	
Additional Comments (if any):				

<sup>(1)</sup>If NO, then contact the client before proceeding with analysis and note date/time and person contacted as well as the corrective action to in the additional comments (above) and the case narrative.

Reviewed by: JG (Project Manager) Date/Time Reviewed: 4-25-22

Origins Laboratory, Inc.



The results in this report apply to the samples analyzed in accordance with the chain of custody document. This analytical report must be reproduced in its entirety.

Eagle Environmental Consulting, Inc.  
 8000 W 44th Ave  
 Wheat Ridge CO 80033

Martin C Eckert III  
 Project Number: [none]  
 Project: Noble - Stephens J #31-9

**WH-FS-01@6'**

**4/21/2022 10:08:00AM**

Analyte	Result	Min Detection Limit	Reporting Limit	Units	Dilution	Batch	Prepared	Analyzed	Notes
---------	--------	---------------------	-----------------	-------	----------	-------	----------	----------	-------

**Origins Laboratory, Inc.**  
**Y204502-01 (Soil)**

**Boron (DTPA Sorbitol)**

Boron	0.417		0.0994	mg/L	1	B2D2213	04/22/2022	04/26/2022	
-------	-------	--	--------	------	---	---------	------------	------------	--

**DRO/ORO by EPA 8015D**

Diesel (C10-C28)	ND		25.0	mg/kg	1	B2D2612	04/26/2022	04/28/2022	U
Residual Range Organics (C28-C40)	ND		100	"	"	"	"	"	U

Surrogate: o-Terphenyl	77.4 %		50-150			"	"	"	
------------------------	--------	--	--------	--	--	---	---	---	--

**GBTEX+TMBs by 8260D**

1,2,4-Trimethylbenzene	ND		0.00200	mg/kg	1	B2D2308	04/25/2022	04/25/2022	U
1,3,5-Trimethylbenzene	ND		0.00200	"	"	"	"	"	U
Benzene	ND		0.00200	"	"	"	"	"	U
Ethylbenzene	ND		0.00200	"	"	"	"	"	U
Toluene	ND		0.00200	"	"	"	"	"	U
Xylenes, total	ND		0.00200	"	"	"	"	"	U
Gasoline Range Hydrocarbons	ND		0.200	"	"	"	"	"	U

Surrogate: 1,2-Dichloroethane-d4	110 %		70-130			"	"	"	
----------------------------------	-------	--	--------	--	--	---	---	---	--

Origins Laboratory, Inc.



The results in this report apply to the samples analyzed in accordance with the chain of custody document. This analytical report must be reproduced in its entirety.

Eagle Environmental Consulting, Inc.  
 8000 W 44th Ave  
 Wheat Ridge CO 80033

Martin C Eckert III  
 Project Number: [none]  
 Project: Noble - Stephens J #31-9

**WH-FS-01@6'**

**4/21/2022 10:08:00AM**

Analyte	Result	Min Detection Limit	Reporting Limit	Units	Dilution	Batch	Prepared	Analyzed	Notes
---------	--------	---------------------	-----------------	-------	----------	-------	----------	----------	-------

**Origins Laboratory, Inc.**  
**Y204502-01 (Soil)**

**GBTEX+TMBs by 8260D**

Surrogate: Toluene-d8	96.5 %		70-130			B2D23 08	04/25/2022	04/25/2022	
Surrogate: 4-Bromofluorobenzene	101 %		70-130			"	"	"	

**Metals by Saturated Paste by EPA 6010**

Calcium	3.17		0.499	meq/L	10	[CALC]	04/25/2022	04/26/2022	
Magnesium	1.28		0.823	"	"	"	"	"	
Sodium	1.13		0.435	"	"	"	"	"	

**PAH by 8270D SIM**

1-Methylnaphthalene	ND	0.000364	0.00067	mg/Kg	1	L612469	04/25/2022	04/27/2022	
2-Methylnaphthalene	ND	0.000645	0.00067	"	"	"	"	"	
Acenaphthene	ND	0.000304	0.00067	"	"	"	"	"	
Anthracene	ND	0.000334	0.00067	"	"	"	"	"	
Benzo(a)anthracene	ND	0.000493	0.00067	"	"	"	"	"	
Benzo(a)pyrene	0.000488	0.000468	0.00067	"	"	"	"	"	J
Benzo(b)fluoranthene	ND	0.000585	0.00067	"	"	"	"	"	
Benzo(k)fluoranthene	ND	0.000437	0.00067	"	"	"	"	"	
Chrysene	ND	0.000624	0.00067	"	"	"	"	"	
Dibenz(a,h)anthracene	ND	0.000614	0.00067	"	"	"	"	"	
Fluoranthene	0.00043	0.000394	0.00067	"	"	"	"	"	J

Origins Laboratory, Inc.



The results in this report apply to the samples analyzed in accordance with the chain of custody document. This analytical report must be reproduced in its entirety.

Eagle Environmental Consulting, Inc.  
 8000 W 44th Ave  
 Wheat Ridge CO 80033

Martin C Eckert III  
 Project Number: [none]  
 Project: Noble - Stephens J #31-9

**WH-FS-01@6'**

**4/21/2022 10:08:00AM**

Analyte	Result	Min Detection Limit	Reporting Limit	Units	Dilution	Batch	Prepared	Analyzed	Notes
---------	--------	---------------------	-----------------	-------	----------	-------	----------	----------	-------

**Waypoint Analytical, Inc.**  
**Y204502-01 (Soil)**

**PAH by 8270D SIM**

Fluorene	ND	0.000286	0.00067	mg/Kg	1	L612469	04/25/2022	04/27/2022	
Indeno(1,2,3-cd)pyrene	ND	0.000627	0.00067	"	"	"	"	"	
Naphthalene	ND	0.000484	0.00067	"	"	"	"	"	
Pyrene	ND	0.000643	0.00067	"	"	"	"	"	

Surrogate: 2-Fluorobiphenyl	54.3 %		33-115			"	"	"	
Surrogate: 4-Terphenyl-d14	66.5 %		33-122			"	"	"	
Surrogate: Nitrobenzene-d5	61.6 %		29-110			"	"	"	

**pH in Soil by 9045D**

pH	8.15			pH Units	1	B2D2507	04/25/2022	04/26/2022	
----	------	--	--	----------	---	---------	------------	------------	--

**SAR by 20B Saturated Paste**

SAR	0.755			SAR	1	B2D2501	04/25/2022	04/26/2022	
-----	-------	--	--	-----	---	---------	------------	------------	--

**Specific Conductance Mod. 9050A**

Specific Conductance (EC)	0.625		0.00500	mmhos/cm	1	B2D2505	04/25/2022	04/26/2022	
---------------------------	-------	--	---------	----------	---	---------	------------	------------	--

Origins Laboratory, Inc.



The results in this report apply to the samples analyzed in accordance with the chain of custody document. This analytical report must be reproduced in its entirety.

Eagle Environmental Consulting, Inc.  
 8000 W 44th Ave  
 Wheat Ridge CO 80033

Martin C Eckert III  
 Project Number: [none]  
 Project: Noble - Stephens J #31-9

**Volatile Organic Compounds by GC/MS SW846 8260D - Quality Control**  
**Origins Laboratory, Inc.**

Analyte	Result	Reporting Limit	Units	Spike Level	Source Result	%REC	%REC Limits	RPD	RPD Limit	Notes
---------	--------	-----------------	-------	-------------	---------------	------	-------------	-----	-----------	-------

**Batch B2D2308 - EPA 5030 (soil)**

**Blank (B2D2308-BLK1)**

Prepared: 04/23/2022 Analyzed: 04/25/2022

1,2,4-Trimethylbenzene	ND	0.00200	mg/kg							U
1,3,5-Trimethylbenzene	ND	0.00200	"							U
Benzene	ND	0.00200	"							U
Ethylbenzene	ND	0.00200	"							U
Naphthalene	ND	0.0100	"							U
Toluene	ND	0.00200	"							U
Xylenes, total	ND	0.00200	"							U
Gasoline Range Hydrocarbons	ND	0.200	"							U
Surrogate: 1,2-Dichloroethane-d4	0.12		"	0.125	99.5		70-130			
Surrogate: Toluene-d8	0.13		"	0.125	102		70-130			
Surrogate: 4-Bromofluorobenzene	0.12		"	0.125	93.4		70-130			

Origins Laboratory, Inc.



*The results in this report apply to the samples analyzed in accordance with the chain of custody document. This analytical report must be reproduced in its entirety.*

Eagle Environmental Consulting, Inc.  
 8000 W 44th Ave  
 Wheat Ridge CO 80033

Martin C Eckert III  
 Project Number: [none]  
 Project: Noble - Stephens J #31-9

**Volatile Organic Compounds by GC/MS SW846 8260D - Quality Control**  
**Origins Laboratory, Inc.**

Analyte	Result	Reporting Limit	Units	Spike Level	Source Result	%REC	%REC Limits	RPD	RPD Limit	Notes
---------	--------	-----------------	-------	-------------	---------------	------	-------------	-----	-----------	-------

**Batch B2D2308 - EPA 5030 (soil)**

**LCS (B2D2308-BS1)**

Prepared: 04/23/2022 Analyzed: 04/25/2022

1,2,4-Trimethylbenzene	0.105	0.00200	mg/kg	0.100		105	70-130			
1,3,5-Trimethylbenzene	0.105	0.00200	"	0.100		105	70-130			
Benzene	0.102	0.00200	"	0.100		102	70-130			
Ethylbenzene	0.105	0.00200	"	0.100		105	70-130			
Naphthalene	0.101	0.0100	"	0.100		101	70-130			
Toluene	0.112	0.00200	"	0.100		112	70-130			
o-Xylene	0.103	0.00200	"	0.100		103	70-130			
m,p-Xylene	0.210	0.00400	"	0.200		105	70-130			
Surrogate: 1,2-Dichloroethane-d4	0.12		"	0.125		97.0	70-130			
Surrogate: Toluene-d8	0.12		"	0.125		99.5	70-130			
Surrogate: 4-Bromofluorobenzene	0.13		"	0.125		101	70-130			

Origins Laboratory, Inc.



*The results in this report apply to the samples analyzed in accordance with the chain of custody document. This analytical report must be reproduced in its entirety.*

Eagle Environmental Consulting, Inc.  
 8000 W 44th Ave  
 Wheat Ridge CO 80033

Martin C Eckert III  
 Project Number: [none]  
 Project: Noble - Stephens J #31-9

**Volatile Organic Compounds by GC/MS SW846 8260D - Quality Control**  
**Origins Laboratory, Inc.**

Analyte	Result	Reporting Limit	Units	Spike Level	Source Result	%REC	%REC Limits	RPD	RPD Limit	Notes
---------	--------	-----------------	-------	-------------	---------------	------	-------------	-----	-----------	-------

Batch B2D2308 - EPA 5030 (soil)

Matrix Spike (B2D2308-MS1)	Source: Y204499-01			Prepared: 04/23/2022 Analyzed: 04/25/2022						
1,2,4-Trimethylbenzene	0.103	0.00200	mg/kg	0.100	0.000560	103	70-130			
1,3,5-Trimethylbenzene	0.102	0.00200	"	0.100	ND	102	70-130			
Benzene	0.102	0.00200	"	0.100	ND	102	70-130			
Ethylbenzene	0.103	0.00200	"	0.100	ND	103	70-130			
Naphthalene	0.106	0.0100	"	0.100	0.00234	103	70-130			
Toluene	0.112	0.00200	"	0.100	ND	112	70-130			
o-Xylene	0.103	0.00200	"	0.100	ND	103	70-130			
m,p-Xylene	0.205	0.00400	"	0.200	0.000560	102	70-130			
Surrogate: 1,2-Dichloroethane-d4	0.13		"	0.125		103	70-130			
Surrogate: Toluene-d8	0.12		"	0.125		99.2	70-130			
Surrogate: 4-Bromofluorobenzene	0.13		"	0.125		101	70-130			

Origins Laboratory, Inc.



The results in this report apply to the samples analyzed in accordance with the chain of custody document. This analytical report must be reproduced in its entirety.

Eagle Environmental Consulting, Inc.  
 8000 W 44th Ave  
 Wheat Ridge CO 80033

Martin C Eckert III  
 Project Number: [none]  
 Project: Noble - Stephens J #31-9

**Volatile Organic Compounds by GC/MS SW846 8260D - Quality Control**  
**Origins Laboratory, Inc.**

Analyte	Result	Reporting Limit	Units	Spike Level	Source Result	%REC	%REC Limits	RPD	RPD Limit	Notes
---------	--------	-----------------	-------	-------------	---------------	------	-------------	-----	-----------	-------

Batch B2D2308 - EPA 5030 (soil)

Matrix Spike Dup (B2D2308-MSD1)	Source: Y204499-01			Prepared: 04/23/2022 Analyzed: 04/25/2022						
1,2,4-Trimethylbenzene	0.101	0.00200	mg/kg	0.100	0.000560	101	70-130	1.88	20	
1,3,5-Trimethylbenzene	0.101	0.00200	"	0.100	ND	101	70-130	1.73	20	
Benzene	0.101	0.00200	"	0.100	ND	101	70-130	1.18	20	
Ethylbenzene	0.100	0.00200	"	0.100	ND	100	70-130	2.74	20	
Naphthalene	0.105	0.0100	"	0.100	0.00234	103	70-130	0.227	20	
Toluene	0.108	0.00200	"	0.100	ND	108	70-130	2.82	20	
o-Xylene	0.0997	0.00200	"	0.100	ND	99.7	70-130	2.87	20	
m,p-Xylene	0.200	0.00400	"	0.200	0.000560	99.7	70-130	2.53	20	
Surrogate: 1,2-Dichloroethane-d4	0.13		"	0.125		102	70-130			
Surrogate: Toluene-d8	0.12		"	0.125		98.3	70-130			
Surrogate: 4-Bromofluorobenzene	0.13		"	0.125		101	70-130			

Origins Laboratory, Inc.



The results in this report apply to the samples analyzed in accordance with the chain of custody document. This analytical report must be reproduced in its entirety.

Eagle Environmental Consulting, Inc.  
 8000 W 44th Ave  
 Wheat Ridge CO 80033

Martin C Eckert III  
 Project Number: [none]  
 Project: Noble - Stephens J #31-9

**Volatile Organic Compounds by GC/MS SW846 8260D - Quality Control**  
**Origins Laboratory, Inc.**

Analyte	Result	Reporting Limit	Units	Spike Level	Source Result	%REC	%REC Limits	RPD	RPD Limit	Notes
<b>Batch B2D2612 - EPA 3550B</b>										
<b>Blank (B2D2612-BLK1)</b>										
					Prepared: 04/26/2022 Analyzed: 04/28/2022					
Diesel (C10-C28)	ND	25.0	mg/kg							U
Residual Range Organics (C28-C40)	ND	100	"							U
Surrogate: o-Terphenyl	20		"	24.9		80.8	50-150			

Origins Laboratory, Inc.



*The results in this report apply to the samples analyzed in accordance with the chain of custody document. This analytical report must be reproduced in its entirety.*

Eagle Environmental Consulting, Inc.  
 8000 W 44th Ave  
 Wheat Ridge CO 80033

Martin C Eckert III  
 Project Number: [none]  
 Project: Noble - Stephens J #31-9

**Extractable Petroleum Hydrocarbons by 8015D - Quality Control**  
**Origins Laboratory, Inc.**

Analyte	Result	Reporting Limit	Units	Spike Level	Source Result	%REC	%REC Limits	RPD	RPD Limit	Notes
---------	--------	-----------------	-------	-------------	---------------	------	-------------	-----	-----------	-------

**Batch B2D2612 - EPA 3550B**

**LCS (B2D2612-BS1)**

Prepared: 04/26/2022 Analyzed: 04/28/2022

Diesel (C10-C28)	793	50.0	mg/kg	1000		79.3	70-130			
Residual Range Organics (C28-C40)	763	200	"	1000		76.3	70-130			
Surrogate: o-Terphenyl	35		"	49.8		69.9	50-150			

Origins Laboratory, Inc.



*The results in this report apply to the samples analyzed in accordance with the chain of custody document. This analytical report must be reproduced in its entirety.*

Eagle Environmental Consulting, Inc.  
 8000 W 44th Ave  
 Wheat Ridge CO 80033

Martin C Eckert III  
 Project Number: [none]  
 Project: Noble - Stephens J #31-9

**Extractable Petroleum Hydrocarbons by 8015D - Quality Control**  
**Origins Laboratory, Inc.**

Analyte	Result	Reporting Limit	Units	Spike Level	Source Result	%REC	%REC Limits	RPD	RPD Limit	Notes
---------	--------	-----------------	-------	-------------	---------------	------	-------------	-----	-----------	-------

**Batch B2D2612 - EPA 3550B**

<b>Matrix Spike (B2D2612-MS1)</b>	<b>Source: Y204548-01</b>			Prepared: 04/26/2022 Analyzed: 04/28/2022						
Diesel (C10-C28)	831	50.0	mg/kg	1000	119	71.2	70-130			
Residual Range Organics (C28-C40)	1230	200	"	1000	407	82.4	70-130			
Surrogate: o-Terphenyl	36		"	49.8		73.3	50-150			

Origins Laboratory, Inc.



*The results in this report apply to the samples analyzed in accordance with the chain of custody document. This analytical report must be reproduced in its entirety.*

Eagle Environmental Consulting, Inc.  
 8000 W 44th Ave  
 Wheat Ridge CO 80033

Martin C Eckert III  
 Project Number: [none]  
 Project: Noble - Stephens J #31-9

**Extractable Petroleum Hydrocarbons by 8015D - Quality Control**  
**Origins Laboratory, Inc.**

Analyte	Result	Reporting Limit	Units	Spike Level	Source Result	%REC	%REC Limits	RPD	RPD Limit	Notes
---------	--------	-----------------	-------	-------------	---------------	------	-------------	-----	-----------	-------

**Batch B2D2612 - EPA 3550B**

<b>Matrix Spike Dup (B2D2612-MSD1)</b>	<b>Source: Y204548-01</b>			Prepared: 04/26/2022 Analyzed: 04/28/2022						
Diesel (C10-C28)	765	50.0	mg/kg	1000	119	64.7	70-130	8.20	35	QM-07
Residual Range Organics (C28-C40)	1070	200	"	1000	407	66.5	70-130	13.8	35	QM-07
Surrogate: o-Terphenyl	42		"	49.8		83.8	50-150			

Origins Laboratory, Inc.



*The results in this report apply to the samples analyzed in accordance with the chain of custody document. This analytical report must be reproduced in its entirety.*

Eagle Environmental Consulting, Inc.  
 8000 W 44th Ave  
 Wheat Ridge CO 80033

Martin C Eckert III  
 Project Number: [none]  
 Project: Noble - Stephens J #31-9

**Extractable Petroleum Hydrocarbons by 8015D - Quality Control**  
**Origins Laboratory, Inc.**

Analyte	Result	Reporting Limit	Units	Spike Level	Source Result	%REC	%REC Limits	RPD	RPD Limit	Notes
---------	--------	-----------------	-------	-------------	---------------	------	-------------	-----	-----------	-------

**Saturated Paste - Quality Control**  
**Origins Laboratory, Inc.**

Analyte	Result	Reporting Limit	Units	Spike Level	Source Result	%REC	%REC Limits	RPD	RPD Limit	Notes
---------	--------	-----------------	-------	-------------	---------------	------	-------------	-----	-----------	-------

**Batch B2D2505 - NO PREP**

**Blank (B2D2505-BLK1)**

Prepared: 04/25/2022 Analyzed: 04/26/2022

Specific Conductance (EC) 0.00240 0.00500 mmhos/cm

**Duplicate (B2D2505-DUP1)**

**Source: Y204358-01**

Prepared: 04/25/2022 Analyzed: 04/26/2022

Specific Conductance (EC) 0.330 0.00500 mmhos/cm

0.350

5.94

25

**Batch B2D2507 - NO PREP**

**Duplicate (B2D2507-DUP1)**

**Source: Y204358-01**

Prepared: 04/25/2022 Analyzed: 04/26/2022

pH 7.71 pH Units

7.64

0.912

25

Origins Laboratory, Inc.



*The results in this report apply to the samples analyzed in accordance with the chain of custody document. This analytical report must be reproduced in its entirety.*

Eagle Environmental Consulting, Inc.  
 8000 W 44th Ave  
 Wheat Ridge CO 80033

Martin C Eckert III  
 Project Number: [none]  
 Project: Noble - Stephens J #31-9

**PAH by 8270D SIM - Quality Control**  
**Waypoint Analytical, Inc.**

Analyte	Result	Reporting Limit	Units	Spike Level	Source Result	%REC	%REC Limits	RPD	RPD Limit	Notes
---------	--------	-----------------	-------	-------------	---------------	------	-------------	-----	-----------	-------

**Batch L612469 - 3550B**

<b>MSD (L 91319-MSD-L612469)</b>		<b>Source: 91319</b>			Prepared: 04/25/2022 Analyzed: 04/27/2022					
Benzo(b)fluoranthene	0.0857	0.000585	mg/Kg	0.164	0.00252	50.7	30-130	6	30	
Pyrene	0.111	0.000643	"	0.164	0.00954	61.8	30-130	0.8	30	
Naphthalene	0.101	0.000484	"	0.164	0.000792	61.1	30-130	2	30	
Indeno(1,2,3-cd)pyrene	0.0946	0.000627	"	0.164	0.00104	57	30-130	9.7	30	
Fluorene	0.108	0.000286	"	0.164	0.00135	65	30-130	1.8	30	
Fluoranthene	0.114	0.000394	"	0.164	0.0126	61.8	30-130	0.8	30	
Dibenz(a,h)anthracene	0.117	0.000614	"	0.164	91319	71.3	30-130	7	30	
Acenaphthene	0.101	0.000304	"	0.164	0.000992	60.9	30-130	0	30	
Benzo(k)fluoranthene	0.0869	0.000437	"	0.164	0.00211	51.7	30-130	9.2	30	
Benzo(a)pyrene	0.116	0.000468	"	0.164	0.00273	69	30-130	4.2	30	
1-Methylnaphthalene	0.0995	0.000364	"	0.164	0.00196	59.4	30-130	1	30	
Benzo(a)anthracene	0.113	0.000493	"	0.164	0.00339	66.8	30-130	3.4	30	
Anthracene	0.104	0.000334	"	0.164	0.0025	61.8	30-130	0.9	30	
2-Methylnaphthalene	0.101	0.000645	"	0.164	0.00338	59.5	30-130	1.6	30	
Chrysene	0.113	0.000624	"	0.164	0.00464	66	30-130	0.8	30	
Surrogate: Nitrobenzene-d5	68.3		"	0.329	224	68.3	29-110			
Surrogate: 2-Fluorobiphenyl	61		"	0.329	198	61	33-115			
Surrogate: 4-Terphenyl-d14	71.4		"	0.329	232	71.4	33-122			

<b>MS (L 91319-MS-L612469)</b>		<b>Source: 91319</b>			Prepared: 04/25/2022 Analyzed: 04/27/2022					
Naphthalene	0.099	0.000484	mg/Kg	0.164	0.000792	59.8	30-130			
1-Methylnaphthalene	0.0985	0.000364	"	0.164	0.00196	58.8	30-130			
Fluoranthene	0.115	0.000394	"	0.164	0.0126	62.4	30-130			
Fluorene	0.106	0.000286	"	0.164	0.00135	63.8	30-130			
Pyrene	0.112	0.000643	"	0.164	0.00954	62.4	30-130			
Indeno(1,2,3-cd)pyrene	0.0858	0.000627	"	0.164	0.00104	51.6	30-130			
Dibenz(a,h)anthracene	0.109	0.000614	"	0.164	91319	66.4	30-130			

Origins Laboratory, Inc.



*The results in this report apply to the samples analyzed in accordance with the chain of custody document. This analytical report must be reproduced in its entirety.*

Eagle Environmental Consulting, Inc.  
 8000 W 44th Ave  
 Wheat Ridge CO 80033

Martin C Eckert III  
 Project Number: [none]  
 Project: Noble - Stephens J #31-9

**PAH by 8270D SIM - Quality Control**  
**Waypoint Analytical, Inc.**

Analyte	Result	Reporting Limit	Units	Spike Level	Source Result	%REC	%REC Limits	RPD	RPD Limit	Notes
---------	--------	-----------------	-------	-------------	---------------	------	-------------	-----	-----------	-------

**Batch L612469 - 3550B**

MS (L 91319-MS-L612469)	Source: 91319			Prepared: 04/25/2022 Analyzed: 04/27/2022						
Chrysene	0.114	0.000624	mg/Kg	0.164	0.00464	66.6	30-130			
Benzo(k)fluoranthene	0.0953	0.000437	"	0.164	0.00211	56.8	30-130			
Benzo(a)pyrene	0.121	0.000468	"	0.164	0.00273	72.1	30-130			
Benzo(a)anthracene	0.117	0.000493	"	0.164	0.00339	69.2	30-130			
2-Methylnaphthalene	0.0993	0.000645	"	0.164	0.00338	58.4	30-130			
Anthracene	0.105	0.000334	"	0.164	0.0025	62.5	30-130			
Acenaphthene	0.101	0.000304	"	0.164	0.000992	60.9	30-130			
Benzo(b)fluoranthene	0.0807	0.000585	"	0.164	0.00252	47.6	30-130			
Surrogate: 2-Fluorobiphenyl	62.3		"	0.329	198	62.3	33-115			
Surrogate: 4-Terphenyl-d14	72.6		"	0.329	232	72.6	33-122			
Surrogate: Nitrobenzene-d5	69.3		"	0.329	224	69.3	29-110			

LCS (LCS-L612469)	Prepared: 04/25/2022 Analyzed: 04/27/2022									
Pyrene	0.111	0.000643	mg/Kg	0.167		66.4	30-130			
Dibenz(a,h)anthracene	0.123	0.000614	"	0.167		73.6	30-130			
Fluorene	0.103	0.000286	"	0.167		61.6	30-130			
Indeno(1,2,3-cd)pyrene	0.0939	0.000627	"	0.167		56.2	30-130			
Benzo(k)fluoranthene	0.107	0.000437	"	0.167		64	30-130			
Chrysene	0.11	0.000624	"	0.167		65.8	30-130			
Naphthalene	0.0989	0.000484	"	0.167		59.2	30-130			
1-Methylnaphthalene	0.0964	0.000364	"	0.167		57.7	30-130			
Benzo(a)pyrene	0.115	0.000468	"	0.167		68.8	30-130			
Benzo(a)anthracene	0.114	0.000493	"	0.167		68.2	30-130			
Anthracene	0.109	0.000334	"	0.167		65.2	30-130			
Acenaphthene	0.0991	0.000304	"	0.167		59.3	30-130			
2-Methylnaphthalene	0.0942	0.000645	"	0.167		56.4	30-130			
Fluoranthene	0.112	0.000394	"	0.167		67	30-130			

Origins Laboratory, Inc.



The results in this report apply to the samples analyzed in accordance with the chain of custody document. This analytical report must be reproduced in its entirety.

Eagle Environmental Consulting, Inc.  
 8000 W 44th Ave  
 Wheat Ridge CO 80033

Martin C Eckert III  
 Project Number: [none]  
 Project: Noble - Stephens J #31-9

**PAH by 8270D SIM - Quality Control**  
**Waypoint Analytical, Inc.**

Analyte	Result	Reporting Limit	Units	Spike Level	Source Result	%REC	%REC Limits	RPD	RPD Limit	Notes
---------	--------	-----------------	-------	-------------	---------------	------	-------------	-----	-----------	-------

**Batch L612469 - 3550B**

**LCS (LCS-L612469)**

Prepared: 04/25/2022 Analyzed: 04/27/2022

Benzo(b)fluoranthene	0.098	0.000585	mg/Kg	0.167		58.6	30-130			
Surrogate: Nitrobenzene-d5	73.5		"	0.333		73.5	29-110			
Surrogate: 4-Terphenyl-d14	79.2		"	0.333		79.2	33-122			
Surrogate: 2-Fluorobiphenyl	63		"	0.333		63	33-115			

**LRB (LRB-L612469)**

Prepared: 04/25/2022 Analyzed: 04/27/2022

Dibenz(a,h)anthracene	ND	0.00067	mg/Kg				-			
Fluoranthene	ND	0.00067	"				-			
Fluorene	ND	0.00067	"				-			
Indeno(1,2,3-cd)pyrene	ND	0.00067	"				-			
Naphthalene	ND	0.00067	"				-			
Chrysene	ND	0.00067	"				-			
Pyrene	ND	0.00067	"				-			
Acenaphthene	ND	0.00067	"				-			
Benzo(k)fluoranthene	ND	0.00067	"				-			
Benzo(b)fluoranthene	ND	0.00067	"				-			
Benzo(a)pyrene	ND	0.00067	"				-			
Anthracene	ND	0.00067	"				-			
2-Methylnaphthalene	ND	0.00067	"				-			
1-Methylnaphthalene	ND	0.00067	"				-			
Benzo(a)anthracene	ND	0.00067	"				-			
Surrogate: Nitrobenzene-d5	72		"	0.333		72	29-110			
Surrogate: 4-Terphenyl-d14	78.9		"	0.333		78.9	33-122			
Surrogate: 2-Fluorobiphenyl	62.4		"	0.333		62.4	33-115			

Origins Laboratory, Inc.



The results in this report apply to the samples analyzed in accordance with the chain of custody document. This analytical report must be reproduced in its entirety.

Eagle Environmental Consulting, Inc.  
8000 W 44th Ave  
Wheat Ridge CO 80033

Martin C Eckert III  
Project Number: [none]  
Project: Noble - Stephens J #31-9

---

### Notes and Definitions

U Sample is Non-Detect.

QM-07 The spike recovery was outside acceptance limits for the MS and/or MSD. The batch was accepted based on acceptable LCS recovery.

J Estimated Value. Analyte below reported quantitation limit.

ND Analyte NOT DETECTED at or above the reporting limit

RPD Relative Percent Difference

All soil results are reported on a wet weight basis.

Origins Laboratory, Inc.



*The results in this report apply to the samples analyzed in accordance with the chain of custody document. This analytical report must be reproduced in its entirety.*