

Wellhead Closure Checklist

COGCC Rule 911.a.(4) Environmental Site Closure Assessment Field Form

Additional attachments (optional): <u> </u>		Pit Closure <u> </u>		Tank Battery Closure <u> </u>		Flowline Closure <u> </u>		Partially Buried Vault Closure <u> </u>
Site Name & COGCC Facility Number: Trebor #B11-15		Date: 10/09/23					Remediation Project #: 30734	
Associated Wells: 05-123-13522		Age of Site: years					Number of Photos Attached: 6	
Location: (GPS coordinates of wellhead or southeastern most wellhead for multiple)							40.408712 / -104.515210	
General Condition of Site: (General observations regarding housekeeping, corrosion, waste management, etc.)								
Good condition								
USCS Soil Type: Clayey Sand					Estimated Depth to Groundwater: >20'			
Hydrocarbon Impacted Soils / Spills: (Note estimated size and if impact appears to be surficial or extends to an unknown depth)								
None observed								
Salt Crusted Soils or Impacted Vegetation: (Note estimated size and if impact appears to be surficial or extends to an unknown depth)								
None observed								
Wellhead(s)								
Well API	05-123-13522							
Age	years							
Condition of surface around wellhead	Good - No odor/no staining							
PID Readings	WH-N: 0.1	WH-E: 0.3	WH-S: 0.4	WH-W: 0.1				
Condition of subsurface (staining present)	Good - No odor/no staining							
PID Readings	2.5	1.9	1.7	1.4	1.3			
Sample taken? Location/Sample ID#	WH-SS-01	WH-SS-02	WH-SS-03	WH-SS-04	WH-FS-01			
Photo Number(s)	See photo log							
Other observations regarding wellheads:								
Summary								
Was impacted soil identified?								
<input checked="" type="radio"/> No Yes - less than 10 cubic yards Yes - more than 10 cubic yards								
Total number of samples field screened: 9					Total number of samples collected: 9			
Highest PID Reading: 2.5					Total number of samples submitted to lab for analysis: 1			
If more than 10 cubic yards of impacted soil were observed:								
Vertical extent:					Estimated spill volume:			
Lateral extent:					Volume of soil removed:			
Is additional investigation required?								
Was groundwater encountered during the investigation?								
<input checked="" type="radio"/> No Yes - not impacted or in contact with impacted soils Yes - groundwater impacted and/or in contact with impacted soils								
Measured depth to groundwater:					Was remedial groundwater removal conducted? Yes No			
Date Groundwater was encountered:					Commencement date of removal:			
Sheen on groundwater? Yes No					Volume of groundwater removed prior to sampling:			
Free product observed? Yes No					Volume of groundwater removed post sampling:			
Total number of samples collected:					Total Volume of groundwater removed:			
Total number of samples submitted to lab for analysis:								



FIGURES

Figure 1: Topographic Site Location Map

Figure 2: Aerial Site Location Map

Figure 3: Soil Analytical Map

Figure 4: Metals in Soil Map

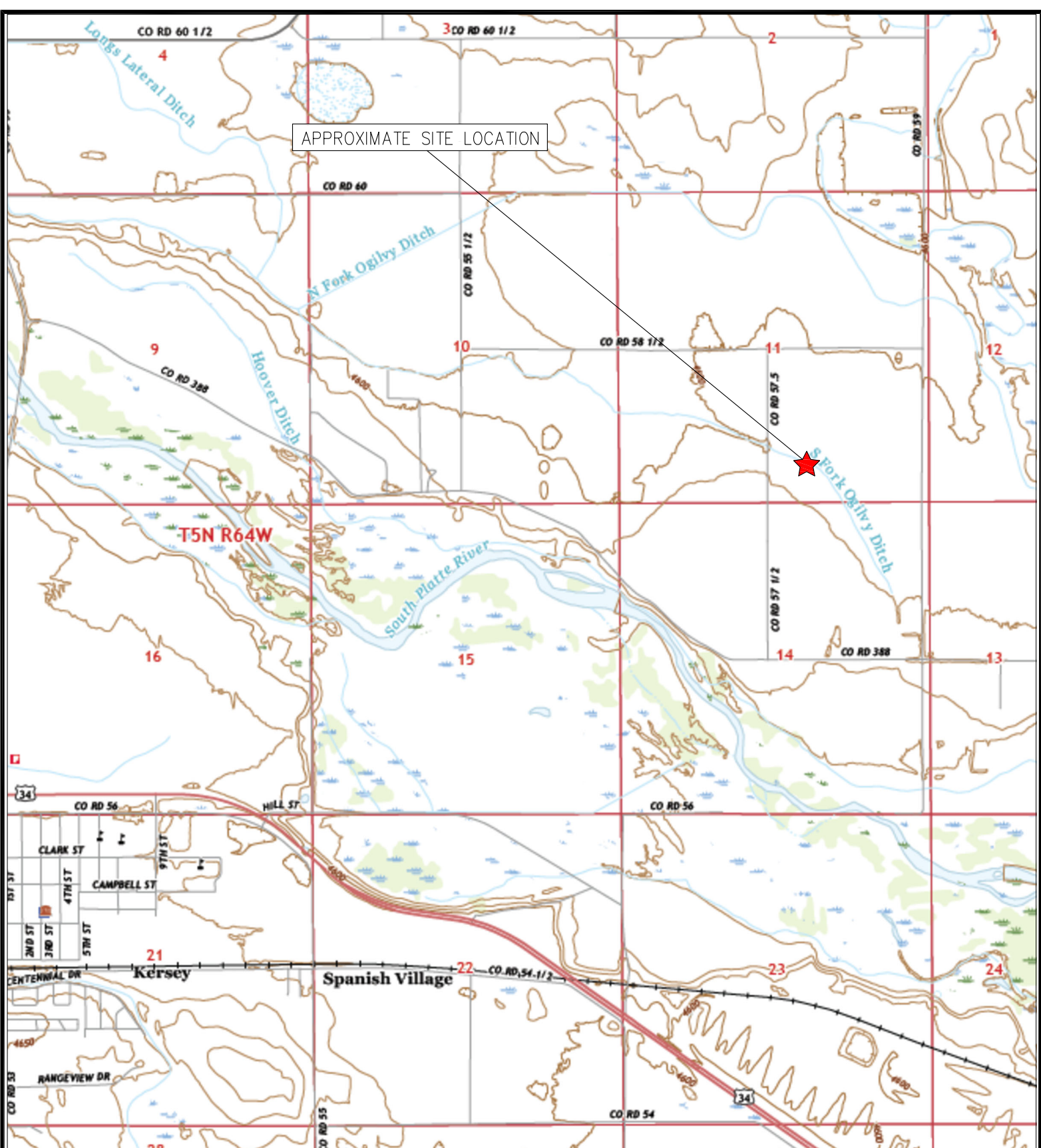

TOPOGRAPHIC SITE LOCATION MAP
 TREBOR #B11-15
 CLOSURE ASSESSMENT
 40.408712 / -104.515210
 SW¼ SE¼ SEC.11 T5N R64W 6PM
 WELD COUNTY, COLORADO
 API # 05-123-13522
 REMEDIATION # 30734





EAGLE
 ENVIRONMENTAL
 CONSULTING, LLC

8000 W 44th Ave, Wheat Ridge, CO 80033
 Ph: 303-433-0479 • F: 303-325-5449



LEGEND

-  FORMER TREBOR #B11-15 WELLHEAD (PLUGGED AND ABANDONED)
-  ASSOCIATED SEPARATOR
-  APPROXIMATE FLOWLINE LOCATION

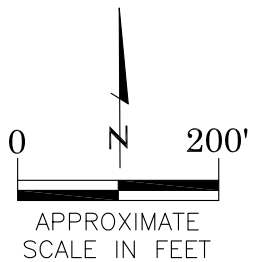

AERIAL SITE LOCATION MAP
TREBOR #B11-15
CLOSURE ASSESSMENT
40.408712 / -104.515210
SW¼ SE¼ SEC.11 T5N R64W 6PM
WELD COUNTY, COLORADO
API # 05-123-13522
REMEDATION # 30734

FIGURE NO.
2
DRAWN BY:
BB



EAGLE
ENVIRONMENTAL
CONSULTING, LLC
8000 W 44th Ave, Wheat Ridge, CO 80033
Ph: 303-433-0479 • F: 303-325-5449

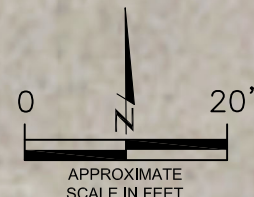
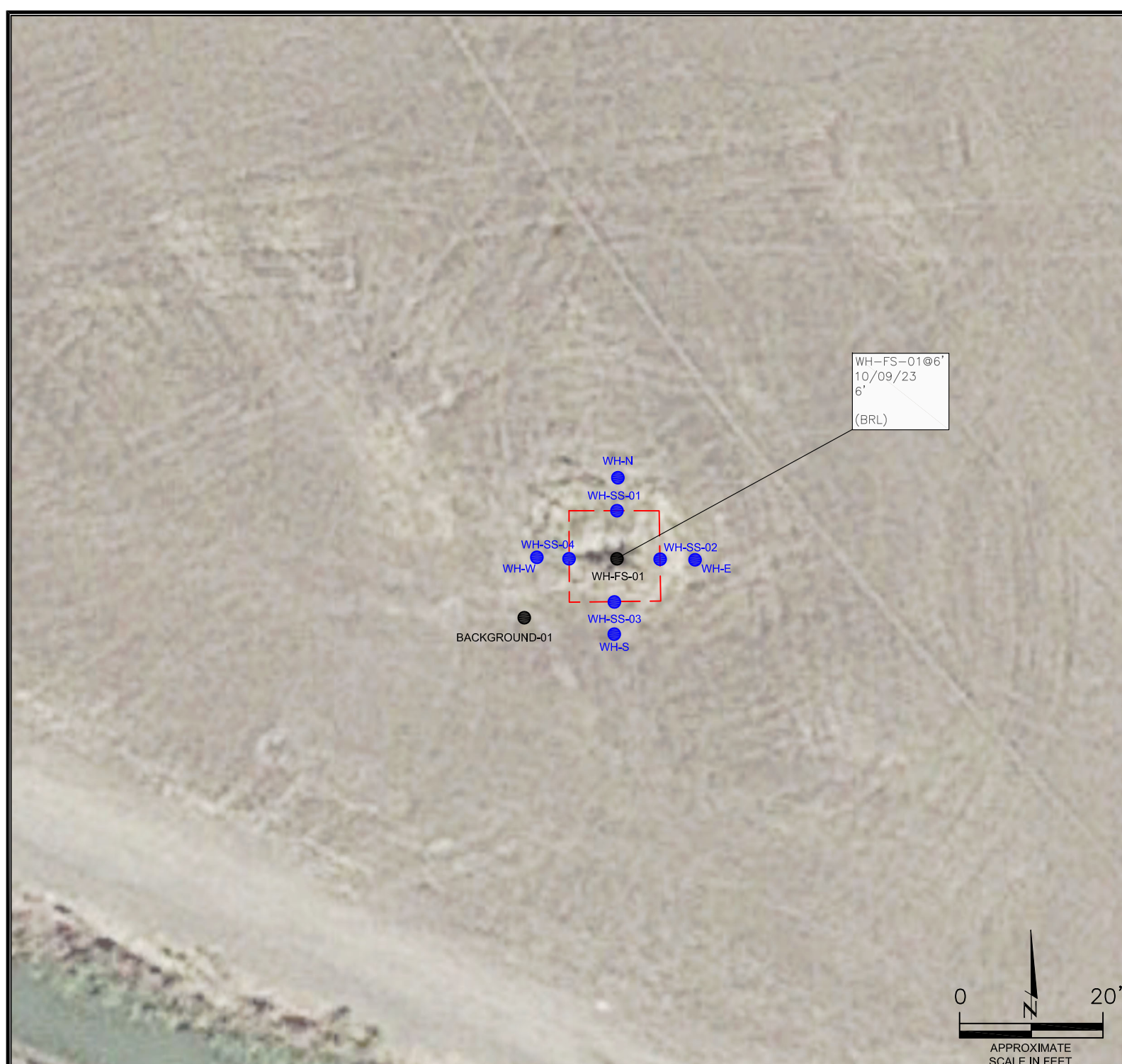

LEGEND

- WELLHEAD ASSESSMENT BOUNDARIES
- SS-02 APPROXIMATE LOCATION OF SOIL SAMPLES FIELD SCREENED, ONLY, WITH PHOTOIONIZATION DETECTOR
- SS-02 APPROXIMATE LOCATION OF SOIL SAMPLES SUBMITTED FOR LABORATORY ANALYSIS

PARAMETERS

SAMPLE LOCATION
DATE
DEPTH (FEET)
B = BENZENE (mg/kg)
T = TOLUENE (mg/kg)
E = ETHYLBENZENE (mg/kg)
X = TOTAL XYLENES (mg/kg)
N = NAPHTHALENE (mg/kg)
G = TPH-CRO (mg/kg)
D = TPH-DRO (mg/kg)
R = TPH-RRO (mg/kg)
1,2,4-TMB = 1,2,4 TRIMETHYLBENZENE (mg/kg)
1,3,5-TMB = 1,3,5 TRIMETHYLBENZENE (mg/kg)
Brn= BORON (mg/L)
EC = SPECIFIC CONDUCTANCE (mmhos/cm)
SAR= SODIUM ADSORPTION RATIO
pH = pH (pH UNITS)
POLYCYCLIC AROMATIC HYDROCARBONS (PAHs) (mg/kg)

mg/kg = MILLIGRAMS PER KILOGRAM
mg/L = MILLIGRAMS PER LITER
mmhos/cm = MILLIHOS PER CENTIMETER

(BRL) = ALL VALUES BELOW REGULATORY LIMITS

TPH-CRO = TOTAL PETROLEUM HYDROCARBONS - GASOLINE RANGE ORGANICS
TPH-DRO = TOTAL PETROLEUM HYDROCARBONS - DIESEL RANGE ORGANICS
TPH-RRO = TOTAL PETROLEUM HYDROCARBONS - RESIDUAL RANGE ORGANICS

NOTES:
VALUES PRESENTED IN **BOLD** EXCEED ECMC TABLE 915-1 REGULATORY LIMITS.

ECMC = ENERGY & CARBON MANAGEMENT COMMISSION

SOIL ANALYTICAL MAP
TREBOR #B11-15
CLOSURE ASSESSMENT
40.408712 / -104.515210
SW¼ SE¼ SEC.11 T5N R64W 6PM
WELD COUNTY, COLORADO
API # 05-123-13522
REMEDATION # 30734

FIGURE NO.
3

DRAWN BY:
BB

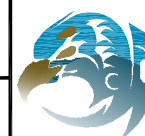

EAGLE
ENVIRONMENTAL
CONSULTING, LLC
8000 W 44th Ave, Wheat Ridge, CO 80033
Ph: 303-433-0479 • F: 303-325-5449

BACKGROUND-01@2'
10/09/23
2'

Arsenic = **3.26**
Barium = NA
Cadmium = NA
Chromium (VI) = NA
Copper = NA
Lead = NA
Nickel = NA
Selenium = NA
Silver = NA
Zinc = NA

WH-FS-01@6'
10/09/23
6'

Arsenic = 1.20
Barium = 57.3
Cadmium = <0.0932
Chromium (VI) = <0.251**
Copper = 11.0
Lead = <9.32
Nickel = <9.32
Selenium = <0.0932
Silver = <0.0932
Zinc = <93.2

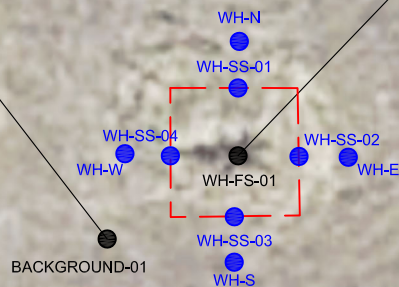

LEGEND

- WELLHEAD ASSESSMENT BOUNDARIES
- SS-02 APPROXIMATE LOCATION OF SOIL SAMPLES FIELD SCREENED, ONLY, WITH PHOTOIONIZATION DETECTOR
- SS-02 APPROXIMATE LOCATION OF SOIL SAMPLES SUBMITTED FOR LABORATORY ANALYSIS

PARAMETERS

SAMPLE LOCATION
DATE SAMPLE COLLECTED
APPROXIMATE DEPTH
Arsenic = (mg/kg)
Barium = (mg/kg)
Cadmium = (mg/kg)
Chromium (VI) = (mg/kg)
Copper = (mg/kg)
Lead = (mg/kg)
Nickel = (mg/kg)
Selenium = (mg/kg)
Silver = (mg/kg)
Zinc = (mg/kg)

mg/kg = MILLIGRAMS PER KILOGRAM

NA – NOT ANALYZED

NOTES:

VALUES PRESENTED WITH A LESS THAN SYMBOL (<) DID NOT CONTAIN CONCENTRATIONS AT/OR ABOVE LABORATORY REPORTING LIMITS AND/OR MINIMUM DETECTION LIMITS.

VALUES PRESENTED IN **BOLD** EXCEED ECMC TABLE 915-1 REGULATORY LIMITS.

*VALUES EXCEED ECMC TABLE 915-1 PROTECTION OF GROUNDWATER SOIL SCREENING LEVELS, ONLY.

**ACHIEVABLE PRACTICAL QUANTITATIVE LIMITS FOR HEXAVALENT CHROMIUM (Cr VI) IN SOILS IS IN THE RANGE OF 0.1 TO 1 mg/kg.

ELEVATED METALS ARE NATURALLY OCCURRING IN COLORADO. LOCAL CLEAN-UP LEVELS ARE 1.25*BACKGROUND WHERE APPLICABLE.

ECMC = ENERGY & CARBON MANAGEMENT COMMISSION

METALS IN SOIL MAP
TREBOR #B11-15
CLOSURE ASSESSMENT
40.408712 / -104.515210
SW¼ SE¼ SEC.11 T5N R64W 6PM
WELD COUNTY, COLORADO
API # 05-123-13522
REMEDATION # 30734

FIGURE NO.
4

DRAWN BY:
BB



EAGLE
ENVIRONMENTAL
CONSULTING, LLC
8000 W 44th Ave, Wheat Ridge, CO 80033
Ph: 303-433-0479 • F: 303-325-5449

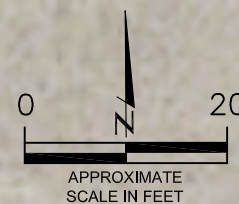

APPROXIMATE
SCALE IN FEET



TABLES

Table 1: Photoionization Detector Reading Summary

Table 2: Soil Analytical Results Summary

TABLE 1
PHOTOIONIZATION DETECTOR READING SUMMARY
TREBOR #B11-15
CLOSURE ASSESSMENT
40.408712 / -104.515210
SW¼ SE¼ SEC.11 T5N R64W 6PM
WELD COUNTY, COLORADO
API # 05-123-13522
REMEDIAION # 30734

Sample Location (Latitude/Longitude)	Date	Approximate Depth (feet)	PID Reading (ppm-v)	Lab Submission (Y/N)
WH-FS-01 @ 6' (40.408717 / -104.515199)	10/09/23	6	1.3	Y
WH-SS-01 @ 5' (40.408736 / -104.515201)	10/09/23	5	2.5	N
WH-SS-02 @ 5' (40.408179 / -104.515180)	10/09/23	5	1.9	N
WH-SS-03 @ 5' (40.408707 / -104.515199)	10/09/23	5	1.7	N
WH-SS-04 @ 5' (40.408179 / -104.515223)	10/09/23	5	1.4	N
WH-N @ 0.5' (40.408746 / -104.515199)	10/09/23	0.5	0.1	N
WH-E @ 0.5' (40.408718 / -104.515163)	10/09/23	0.5	0.3	N
WH-S @ 0.5' (40.408690 / -104.515201)	10/09/23	0.5	0.4	N
WH-W @ 0.5' (40.408720 / -104.515246)	10/09/23	0.5	0.1	N
Background-01 @ 2' (40.408692 / -104.515246)	10/09/23	2	0.2	Y
(Y/N) = Yes or No ppm-v = parts per million by volume PID = Photoionization Detector				



TABLE 2
SOIL ANALYTICAL RESULTS SUMMARY
TREBOR #B11-15
CLOSURE ASSESSMENT
40.408712 / -104.515210
SW¼ SE¼ SEC.11 T5N R64W 6PM
WELD COUNTY, COLORADO
API # 05-123-13522
REMEDIATION # 30734

Sample Location (Latitude / Longitude)				WH-FS-01 @ 6'		Background-01 @ 2'	
Sample Date				10/9/2023		10/9/2023	
Sample Depth				6		2	
PID Reading (ppm-v)				1.3		0.2	
Regulatory Limits							
Chemical of Concern	Units	ECMC Table 915-1 RSSLs	ECMC Table 915-1 GSSLs	Local Clean-Up Level			
VOCs							
Benzene	mg/kg	1.2	0.0026	--	<0.00200	NA	
Toluene	mg/kg	490	0.69	--	<0.00200	NA	
Ethylbenzene	mg/kg	5.8	0.78	--	<0.00200	NA	
Total Xylenes	mg/kg	58	9.9	--	<0.00200	NA	
Naphthalene	mg/kg	2	0.0038	--	<0.00380	NA	
1,2,4-Trimethylbenzene	mg/kg	30	0.0081	--	<0.00200	NA	
1,3,5-Trimethylbenzene	mg/kg	27	0.0087	--	<0.00200	NA	
TOTAL PETROLEUM HYDROCARBONS							
TPH-GRO	mg/kg	500	--	--	<0.200	NA	
TPH-DRO	mg/kg	500	--	--	<25.0	NA	
TPH-RRO	mg/kg	500	--	--	<100	NA	
POLYCYCLIC AROMATIC HYDROCARBONS							
1-Methyl-naphthalene	mg/kg	18	0.006	--	<0.002	NA	
2-Methyl-naphthalene	mg/kg	24	0.019	--	<0.002	NA	
Acenaphthene	mg/kg	360	0.55	--	<0.020	NA	
Anthracene	mg/kg	1800	5.8	--	<0.020	NA	
Benzo(a)-anthracene	mg/kg	1.1	0.011	--	<0.005	NA	
Benzo(a)-pyrene	mg/kg	0.11	0.24	--	<0.020	NA	
Benzo(b)-fluoranthene	mg/kg	1.1	0.3	--	<0.020	NA	
Benzo(k)-fluoranthene	mg/kg	11	2.9	--	<0.020	NA	
Chrysene	mg/kg	110	9	--	<0.020	NA	
Dibenzo(a,h)-anthracene	mg/kg	0.11	0.096	--	<0.020	NA	
Fluoranthene	mg/kg	240	8.9	--	<0.020	NA	
Fluorene	mg/kg	240	0.54	--	<0.020	NA	
Indeno(1,2,3-cd)-pyrene	mg/kg	1.1	0.98	--	<0.020	NA	
Pyrene	mg/kg	180	1.3	--	<0.020	NA	
SOIL SUITABILITY (Inorganics)							
Boron	mg/L	2	--	--	0.103	NA	
pH	standard unit	6-8.3	--	--	8.28	NA	
Sodium Adsorption Ratio (SAR)	--	<6	--	--	1.53	NA	
Specific Conductance (EC)	mmhos/cm	<4	--	--	0.364	NA	
METALS							
Arsenic	mg/kg	0.68	0.29	4.07	1.2	3.26	
Barium	mg/kg	15000	82	--	57.3	NA	
Cadmium	mg/kg	71	0.38	--	<0.0932	NA	
Copper	mg/kg	3100	46	--	<9.32	NA	
Lead	mg/kg	400	14	--	11.0	NA	
Nickel	mg/kg	1500	26	--	<9.32	NA	
Selenium	mg/kg	390	0.26	--	<0.0932	NA	
Silver	mg/kg	390	0.8	--	<0.0932	NA	
Zinc	mg/kg	23000	370	--	<93.2	NA	
Hexavalent Chromium	mg/kg	0.3**	0.00067**	0.1 to 1.0**	<0.251**	NA	

ECMC = Energy & Carbon Management Commission
mg/kg = milligrams per kilogram
mmhos/cm = millimhos per centimeter
PID = Photoionization Detector
ppm-v = parts per million by volume
mg/L = milligrams per liter
SAR = Sodium Adsoption Ratio

NA - Not Analyzed



RSSLs = Residential Soil Screening Levels
GSSLs = Protection of Groundwater Soil Screening Levels
TPH-GRO = Total Petroleum Hydrocarbons - Gasoline Range Organics
TPH-DRO = Total Petroleum Hydrocarbons - Diesel Range Organics
TPH-RRO = Total Petroleum Hydrocarbons - Residual Range Organics

Notes:Values presented with a less than symbol (<) did not contain concentrations at or above the laboratory reporting limit and/or minimum detection limit

Values presented in **BOLD** exceed ECMC Table 915-1 Regulatory Limits. Values presented with asterisk (*) exceed ECMC Table 915-1 GSSLs, only.

**Achievable practical quantitative limits for Hexavalent Chromium in soils is in the range of 0.1 to 1 mg/kg.

Elevated metals are naturally occurring in Colorado. Local clean-up is 1.25*Background where applicable.





ATTACHMENT A

Photo Log

Trebor #B11-15
API # 05-123-13522
Remediation # 30734

Closure Assessment

October 2023



Wellhead Excavation – 10/09/23

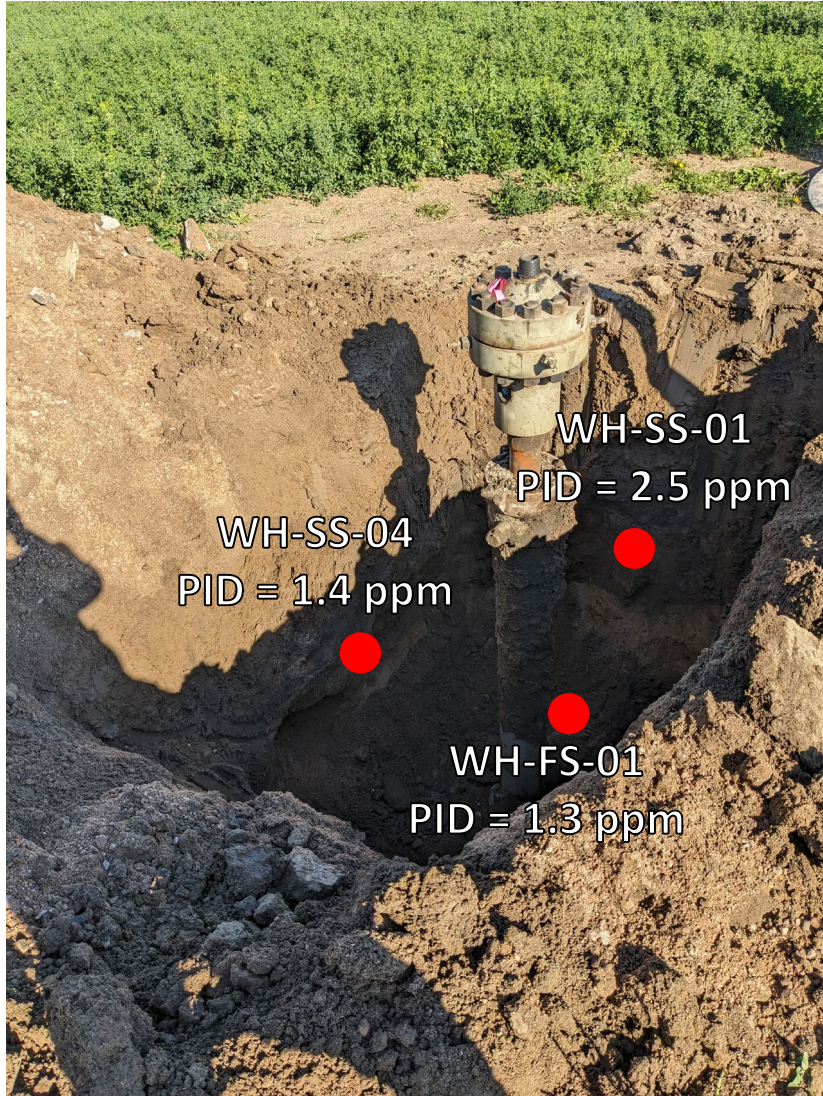

Looking northwest

No petroleum hydrocarbon staining or odor observed

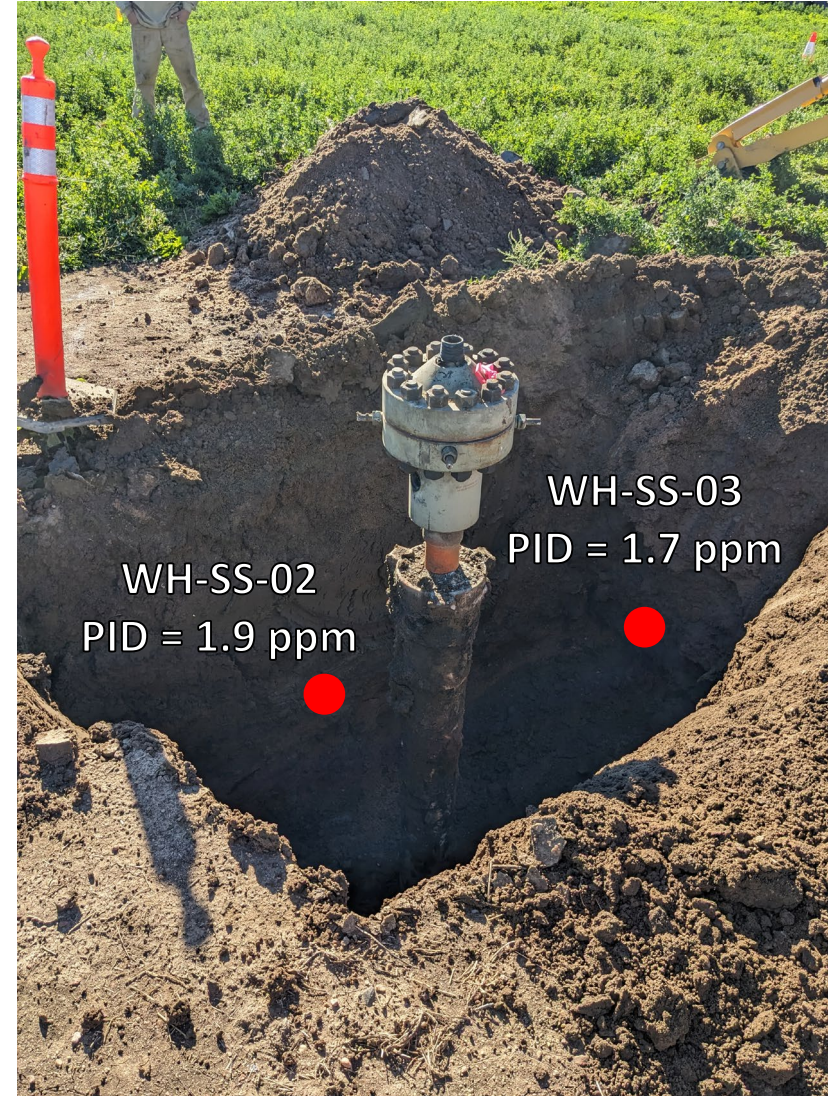

Looking southeast

No petroleum hydrocarbon staining or odor observed

Wellhead Surface – 10/09/23



Looking north

Site in good condition – no petroleum hydrocarbon staining or odor
Observed on surface around wellhead



Looking east

Site in good condition – no petroleum hydrocarbon staining or odor
Observed on surface around wellhead

Wellhead Surface – 10/09/23



WH-S
PID = 0.4 ppm

Looking east

Site in good condition – no petroleum hydrocarbon staining or odor
Observed on surface around wellhead



WH-W
PID = 0.1 ppm

Looking north

Site in good condition – no petroleum hydrocarbon staining or odor
Observed on surface around wellhead



ATTACHMENT B

Laboratory Analytical Report



October 25, 2023

Eagle Environmental Consulting, LLC

Martin C Eckert III

8000 W 44th Ave

Wheat Ridge CO 80033

Project Name - Noble - Trebor #B11-15

Project Number - [none]

Attached are your analytical results for Noble - Trebor #B11-15 received by Origins Laboratory, Inc. October 09, 2023. This project is associated with Origins project number Y310254-01.

The analytical results in the following report were analyzed under the guidelines of EPA Methods. These methods are identified as follows; "SW" are defined in SW-846, "EPA" are defined in 40CFR part 136 and "SM" are defined in the most current revision of Standard Methods For the Examination of Water and Wastewater.

The analytical results apply specifically to the samples and analyses specified per the attached Chain of Custody. As such, this report shall not be reproduced except in full, without the written approval of Origin's laboratory.

Unless otherwise noted, the analytical results for all soil samples are reported on a wet weight basis. All analytical analyses were performed under NELAP guidelines unless noted by a data qualifier.

Any holding time exceedances, deviations from the method specifications or deviations from Origins Laboratory's Standard Operating Procedures are outlined in the case narrative.

Thank you for selecting Origins for your analytical needs. Please contact us with any questions concerning this report, or if we can help with anything at all.

Origins Laboratory, Inc.
303.433.1322
o-squad@oelabinc.com



1725 Elk Place, Denver, CO 80211 | Phone: 303.433.1322 | Fax: 303.265.9645

Eagle Environmental Consulting, LLC
8000 W 44th Ave
Wheat Ridge CO 80033

Martin C Eckert III
Project Number: [none]
Project: Noble - Trebor #B11-15

CROSS REFERENCE REPORT

Sample ID	Laboratory ID	Matrix	Date Sampled	Date Received
WH-FS-01@6'	Y310254-01	Soil	October 9, 2023 9:50	10/09/2023 12:07

Origins Laboratory, Inc.



The results in this report apply to the samples analyzed in accordance with the chain of custody document. This analytical report must be reproduced in its entirety.

Eagle Environmental Consulting, LLC
8000 W 44th Ave
Wheat Ridge CO 80033

Martin C Eckert III
Project Number: [none]
Project: Noble - Trebor #B11-15

Origins Laboratory

F-012207-01-R1
Effective Date: 01/09/12

Sample Receipt Checklist

Origins Work Order: 4310254

Client: Eagle

Client Project ID: Trebor #B11-15

Checklist Completed by: EHS

Shipped Via: HD
(UPS, FedEx, Hand Delivered, Pick-up, etc.)

Date/time completed: 10/9/23

Airbill #: N/A

Matrix(s) Received: (Check all that apply): ☒ Soil/Solid ☐ Water ☐ Other: _____

Cooler Number/Temperature: 115.1 °C 1 °C 1 °C (Describe) _____ °C

Thermometer ID: 7004

Requirement Description	Yes	No	N/A	Comments (if any)
If samples require cooling, was the temperature between 0°C to ≤ 6°C ⁽¹⁾ ?	<input checked="" type="checkbox"/>	<input type="checkbox"/>	<input type="checkbox"/>	
Is there ice present (document if blue ice is used)	<input checked="" type="checkbox"/>	<input type="checkbox"/>	<input type="checkbox"/>	
Are custody seals present on cooler? (if so, document in comments if they are signed and dated, broken or intact)	<input type="checkbox"/>	<input checked="" type="checkbox"/>	<input type="checkbox"/>	
Are custody seals present on each sample container? (if so, document in comments if they are signed and dated, broken or intact)	<input type="checkbox"/>	<input checked="" type="checkbox"/>	<input type="checkbox"/>	
Were all samples received intact ⁽¹⁾ ?	<input checked="" type="checkbox"/>	<input type="checkbox"/>	<input type="checkbox"/>	
Was adequate sample volume provided ⁽¹⁾ ?	<input checked="" type="checkbox"/>	<input type="checkbox"/>	<input type="checkbox"/>	
Are short holding time analytes or samples with HTs due within 48 hours present ⁽¹⁾ ?	<input type="checkbox"/>	<input checked="" type="checkbox"/>	<input type="checkbox"/>	
Is a chain-of-custody (COC) present and filled out completely ⁽¹⁾ ?	<input checked="" type="checkbox"/>	<input type="checkbox"/>	<input type="checkbox"/>	
Does the COC agree with the number and type of sample bottles received ⁽¹⁾ ?	<input checked="" type="checkbox"/>	<input type="checkbox"/>	<input type="checkbox"/>	
Do the sample IDs on the bottle labels match the COC ⁽¹⁾ ?	<input checked="" type="checkbox"/>	<input type="checkbox"/>	<input type="checkbox"/>	
Is the COC properly relinquished by the client with date and time recorded ⁽¹⁾ ?	<input checked="" type="checkbox"/>	<input type="checkbox"/>	<input type="checkbox"/>	
For volatiles in water – is there headspace (> 1/4 inch bubble) present? If yes, contact client and note in narrative.	<input type="checkbox"/>	<input type="checkbox"/>	<input checked="" type="checkbox"/>	
Are samples preserved that require preservation and was it checked ⁽¹⁾ ? (note ID of confirmation instrument used in comments) / (preservation is not confirmed for subcontracted analyses in order to insure sample integrity)/(pH <2 for samples preserved with HNO ₃ , HCL, H ₂ SO ₄) / (pH >10 for samples preserved with NaAsO ₂ +NaOH, ZnAc+NaOH)	<input type="checkbox"/>	<input checked="" type="checkbox"/>	<input type="checkbox"/>	
Additional Comments (if any):				

⁽¹⁾ If NO, then contact the client before proceeding with analysis and note date/time and person contacted as well as the corrective action to in the additional comments (above) and the case narrative.

Reviewed by (Project Manager) [Signature] Date/Time Reviewed 10/10/23

Origins Laboratory, Inc.

[Signature]

The results in this report apply to the samples analyzed in accordance with the chain of custody document. This analytical report must be reproduced in its entirety.

Eagle Environmental Consulting, LLC
8000 W 44th Ave
Wheat Ridge CO 80033

Martin C Eckert III
Project Number: [none]
Project: Noble - Trebor #B11-15

WH-FS-01@6'
10/9/2023 9:50:00AM

Analyte	Result	Min Detection Limit	Reporting Limit	Units	Dilution	Batch	Prepared	Analyzed	Notes
---------	--------	---------------------	-----------------	-------	----------	-------	----------	----------	-------

Origins Laboratory, Inc.
Y310254-01 (Soil)

Boron (DTPA Sorbitol)

Boron	0.103	0.0994	mg/L	1	B3J1115	10/11/2023	10/12/2023	
-------	-------	--------	------	---	---------	------------	------------	--

DRO/ORO by EPA 8015D

Diesel (C10-C28)	ND	25.0	mg/kg	1	B3J1101	10/11/2023	10/11/2023	U
Residual Range Organics (C28-C40)	ND	100	"	"	"	"	"	U

Surrogate: o-Terphenyl	86.8 %	50-150			"	"	"	
------------------------	--------	--------	--	--	---	---	---	--

GBTEX+TMBs by 8260D

1,2,4-Trimethylbenzene	ND	0.00200	mg/kg	1	B3J0937	10/10/2023	10/10/2023	U
1,3,5-Trimethylbenzene	ND	0.00200	"	"	"	"	"	U
Benzene	ND	0.00200	"	"	"	"	"	U
Ethylbenzene	ND	0.00200	"	"	"	"	"	U
Naphthalene	ND	0.00380	"	"	"	"	"	U
Toluene	ND	0.00200	"	"	"	"	"	U
Xylenes, total	ND	0.00200	"	"	"	"	"	U
Gasoline Range Hydrocarbons	ND	0.200	"	"	"	"	"	U

Origins Laboratory, Inc.



The results in this report apply to the samples analyzed in accordance with the chain of custody document. This analytical report must be reproduced in its entirety.

Eagle Environmental Consulting, LLC
8000 W 44th Ave
Wheat Ridge CO 80033

Martin C Eckert III
Project Number: [none]
Project: Noble - Trebor #B11-15

WH-FS-01@6'
10/9/2023 9:50:00AM

Analyte	Result	Min Detection Limit	Reporting Limit	Units	Dilution	Batch	Prepared	Analyzed	Notes
---------	--------	---------------------	-----------------	-------	----------	-------	----------	----------	-------

Origins Laboratory, Inc.
Y310254-01 (Soil)

GBTEX+TMBs by 8260D

Surrogate: 1,2-Dichloroethane-d4	101 %	70-130	B3J0937	10/10/2023	10/10/2023
Surrogate: Toluene-d8	101 %	70-130	"	"	"
Surrogate: 4-Bromofluorobenzene	98.8 %	70-130	"	"	"

Metals by Saturated Paste by EPA 6010

Calcium	0.947	0.499	meq/L	10	[CALC]	10/10/2023	10/11/2023
Magnesium	ND	0.823	"	"	"	"	"
Sodium	1.36	0.435	"	"	"	"	"

PAH by EPA 8270E

1-Methylnaphthalene	ND	0.002	mg/kg	1	B3J0932	10/09/2023	10/12/2023	U
2-Methylnaphthalene	ND	0.002	"	"	"	"	"	U
Acenaphthene	ND	0.020	"	"	"	"	"	U
Anthracene	ND	0.020	"	"	"	"	"	U
Benzo (a) anthracene	ND	0.005	"	"	"	"	"	U
Benzo (a) pyrene	ND	0.020	"	"	"	"	"	U
Benzo (b) fluoranthene	ND	0.020	"	"	"	"	"	U
Benzo (k) fluoranthene	ND	0.020	"	"	"	"	"	U
Chrysene	ND	0.020	"	"	"	"	"	U
Dibenz (a,h) anthracene	ND	0.020	"	"	"	"	"	U

Origins Laboratory, Inc.



The results in this report apply to the samples analyzed in accordance with the chain of custody document. This analytical report must be reproduced in its entirety.

Eagle Environmental Consulting, LLC
8000 W 44th Ave
Wheat Ridge CO 80033

Martin C Eckert III
Project Number: [none]
Project: Noble - Trebor #B11-15

WH-FS-01@6'

10/9/2023 9:50:00AM

Analyte	Result	Min Detection Limit	Reporting Limit	Units	Dilution	Batch	Prepared	Analyzed	Notes
---------	--------	---------------------	-----------------	-------	----------	-------	----------	----------	-------

Origins Laboratory, Inc.
Y310254-01 (Soil)

PAH by EPA 8270E

Fluoranthene	ND	0.020	mg/kg	1	B3J0932	10/09/2023	10/12/2023	U
Fluorene	ND	0.020	"	"	"	"	"	U
Indeno (1,2,3-cd) pyrene	ND	0.020	"	"	"	"	"	U
Pyrene	ND	0.020	"	"	"	"	"	U

Surrogate: Fluorene-d10	94.6 %	60-130	"	"	"
Surrogate: Anthracene-d10	126 %	60-130	"	"	"
Surrogate: Pyrene-d10	131 %	60-130	"	"	" S-07
Surrogate: Benzo (a) pyrene-d12	90.7 %	60-130	"	"	"

pH in Soil by 9045D

pH	8.28	pH Units	1	B3J1017	10/10/2023	10/11/2023
----	------	----------	---	---------	------------	------------

SAR by 20B Saturated Paste

SAR	1.53	0.0100	SAR	1	B3J1013	10/10/2023	10/11/2023
-----	------	--------	-----	---	---------	------------	------------

Specific Conductance Mod. 9050A

Specific Conductance (EC)	0.364	0.00500	mmhos/cm	1	B3J1017	10/10/2023	10/11/2023
---------------------------	-------	---------	----------	---	---------	------------	------------

Table 915 metals by EPA 6020B

Origins Laboratory, Inc.



The results in this report apply to the samples analyzed in accordance with the chain of custody document. This analytical report must be reproduced in its entirety.

Eagle Environmental Consulting, LLC
8000 W 44th Ave
Wheat Ridge CO 80033

Martin C Eckert III
Project Number: [none]
Project: Noble - Trebor #B11-15

WH-FS-01@6'

10/9/2023 9:50:00AM

Analyte	Result	Min Detection Limit	Reporting Limit	Units	Dilution	Batch	Prepared	Analyzed	Notes
---------	--------	---------------------	-----------------	-------	----------	-------	----------	----------	-------

Origins Laboratory, Inc.
Y310254-01 (Soil)

Table 915 metals by EPA 6020B

Arsenic	1.20	0.0932	mg/kg	10	B3J1018	10/10/2023	10/13/2023
Barium	57.3	9.32	"	"	"	"	"
Cadmium	ND	0.0932	"	"	"	"	"
Copper	ND	9.32	"	"	"	"	"
Lead	11.0	9.32	"	"	"	"	"
Nickel	ND	9.32	"	"	"	"	"
Selenium	ND	0.0932	"	"	"	"	"
Silver	ND	0.0932	"	"	"	"	"
Zinc	ND	93.2	"	"	"	"	"

Total Metals by 7196A

Chromium, Hexavalent	ND	0.251	0.515	mg/Kg	1	L712444	10/09/2023	10/23/2023
----------------------	----	-------	-------	-------	---	---------	------------	------------

Origins Laboratory, Inc.



The results in this report apply to the samples analyzed in accordance with the chain of custody document. This analytical report must be reproduced in its entirety.

Eagle Environmental Consulting, LLC
8000 W 44th Ave
Wheat Ridge CO 80033

Martin C Eckert III
Project Number: [none]
Project: Noble - Trebor #B11-15

Volatile Organic Compounds by GC/MS SW846 8260D - Quality Control
Origins Laboratory, Inc.

Analyte	Result	Reporting Limit	Units	Spike Level	Source Result	%REC	%REC Limits	RPD	RPD Limit	Notes
Batch B3J0937 - EPA 5030 (soil)										
Blank (B3J0937-BLK1)					Prepared: 10/10/2023 Analyzed: 10/10/2023					
1,2,4-Trimethylbenzene	ND	0.00200	mg/kg							U
1,3,5-Trimethylbenzene	ND	0.00200	"							U
Benzene	ND	0.00200	"							U
Ethylbenzene	ND	0.00200	"							U
Naphthalene	ND	0.00380	"							U
Toluene	ND	0.00200	"							U
Xylenes, total	ND	0.00200	"							U
Gasoline Range Hydrocarbons	ND	0.200	"							U
Surrogate: 1,2-Dichloroethane-d4	0.12		"	0.125		96.0	70-130			
Surrogate: Toluene-d8	0.12		"	0.125		95.9	70-130			
Surrogate: 4-Bromofluorobenzene	0.12		"	0.125		99.6	70-130			

Origins Laboratory, Inc.



The results in this report apply to the samples analyzed in accordance with the chain of custody document. This analytical report must be reproduced in its entirety.

Eagle Environmental Consulting, LLC
8000 W 44th Ave
Wheat Ridge CO 80033

Martin C Eckert III
Project Number: [none]
Project: Noble - Trebor #B11-15

Volatile Organic Compounds by GC/MS SW846 8260D - Quality Control
Origins Laboratory, Inc.

Analyte	Result	Reporting Limit	Units	Spike Level	Source Result	%REC	%REC Limits	RPD	RPD Limit	Notes
Batch B3J0937 - EPA 5030 (soil)										
LCS (B3J0937-BS1)					Prepared: 10/10/2023 Analyzed: 10/10/2023					
1,2,4-Trimethylbenzene	0.105	0.00200	mg/kg	0.100		105	70-130			
1,3,5-Trimethylbenzene	0.104	0.00200	"	0.100		104	70-130			
Benzene	0.0903	0.00200	"	0.100		90.3	70-130			
Ethylbenzene	0.103	0.00200	"	0.100		103	70-130			
Naphthalene	0.106	0.00380	"	0.100		106	70-130			
Toluene	0.0945	0.00200	"	0.100		94.5	70-130			
o-Xylene	0.118	0.00200	"	0.100		118	70-130			
m,p-Xylene	0.220	0.00400	"	0.200		110	70-130			
Surrogate: 1,2-Dichloroethane-d4	0.11		"	0.125		91.8	70-130			
Surrogate: Toluene-d8	0.13		"	0.125		101	70-130			
Surrogate: 4-Bromofluorobenzene	0.13		"	0.125		104	70-130			

Origins Laboratory, Inc.



The results in this report apply to the samples analyzed in accordance with the chain of custody document. This analytical report must be reproduced in its entirety.

Eagle Environmental Consulting, LLC
8000 W 44th Ave
Wheat Ridge CO 80033

Martin C Eckert III
Project Number: [none]
Project: Noble - Trebor #B11-15

Volatile Organic Compounds by GC/MS SW846 8260D - Quality Control
Origins Laboratory, Inc.

Analyte	Result	Reporting Limit	Units	Spike Level	Source Result	%REC	%REC Limits	RPD	RPD Limit	Notes
Batch B3J0937 - EPA 5030 (soil)										
Matrix Spike (B3J0937-MS1)		Source: Y310231-01			Prepared: 10/10/2023 Analyzed: 10/10/2023					
1,2,4-Trimethylbenzene	0.102	0.00200	mg/kg	0.100	ND	102	70-130			
1,3,5-Trimethylbenzene	0.106	0.00200	"	0.100	ND	106	70-130			
Benzene	0.0876	0.00200	"	0.100	ND	87.6	70-130			
Ethylbenzene	0.103	0.00200	"	0.100	ND	103	70-130			
Naphthalene	0.0733	0.00380	"	0.100	ND	73.3	70-130			
Toluene	0.0925	0.00200	"	0.100	ND	92.5	70-130			
o-Xylene	0.116	0.00200	"	0.100	ND	116	70-130			
m,p-Xylene	0.218	0.00400	"	0.200	ND	109	70-130			
Surrogate: 1,2-Dichloroethane-d4	0.11		"	0.125		90.8	70-130			
Surrogate: Toluene-d8	0.13		"	0.125		101	70-130			
Surrogate: 4-Bromofluorobenzene	0.13		"	0.125		102	70-130			

Origins Laboratory, Inc.



The results in this report apply to the samples analyzed in accordance with the chain of custody document. This analytical report must be reproduced in its entirety.

Eagle Environmental Consulting, LLC
8000 W 44th Ave
Wheat Ridge CO 80033

Martin C Eckert III
Project Number: [none]
Project: Noble - Trebor #B11-15

Volatile Organic Compounds by GC/MS SW846 8260D - Quality Control
Origins Laboratory, Inc.

Analyte	Result	Reporting Limit	Units	Spike Level	Source Result	%REC	%REC Limits	RPD	RPD Limit	Notes
Batch B3J0937 - EPA 5030 (soil)										
Matrix Spike Dup (B3J0937-MSD1)	Source: Y310231-01				Prepared: 10/10/2023 Analyzed: 10/10/2023					
1,2,4-Trimethylbenzene	0.0987	0.00200	mg/kg	0.100	ND	98.7	70-130	3.74	20	
1,3,5-Trimethylbenzene	0.102	0.00200	"	0.100	ND	102	70-130	3.89	20	
Benzene	0.0869	0.00200	"	0.100	ND	86.9	70-130	0.803	20	
Ethylbenzene	0.0982	0.00200	"	0.100	ND	98.2	70-130	4.40	20	
Naphthalene	0.0895	0.00380	"	0.100	ND	89.5	70-130	19.9	20	
Toluene	0.0885	0.00200	"	0.100	ND	88.5	70-130	4.37	20	
o-Xylene	0.112	0.00200	"	0.100	ND	112	70-130	3.46	20	
m,p-Xylene	0.210	0.00400	"	0.200	ND	105	70-130	3.97	20	
Surrogate: 1,2-Dichloroethane-d4	0.12		"	0.125		97.3	70-130			
Surrogate: Toluene-d8	0.12		"	0.125		98.6	70-130			
Surrogate: 4-Bromofluorobenzene	0.13		"	0.125		102	70-130			

Origins Laboratory, Inc.



The results in this report apply to the samples analyzed in accordance with the chain of custody document. This analytical report must be reproduced in its entirety.

Eagle Environmental Consulting, LLC
8000 W 44th Ave
Wheat Ridge CO 80033

Martin C Eckert III
Project Number: [none]
Project: Noble - Trebor #B11-15

Volatile Organic Compounds by GC/MS SW846 8260D - Quality Control
Origins Laboratory, Inc.

Analyte	Result	Reporting Limit	Units	Spike Level	Source Result	%REC	%REC Limits	RPD	RPD Limit	Notes
Batch B3J1101 - EPA 3550B										
Blank (B3J1101-BLK1)					Prepared: 10/11/2023 Analyzed: 10/11/2023					
Diesel (C10-C28)	ND	25.0	mg/kg							U
Residual Range Organics (C28-C40)	ND	100	"							U
Surrogate: o-Terphenyl	21		"	24.9		82.9	50-150			

Origins Laboratory, Inc.



The results in this report apply to the samples analyzed in accordance with the chain of custody document. This analytical report must be reproduced in its entirety.

Eagle Environmental Consulting, LLC
8000 W 44th Ave
Wheat Ridge CO 80033

Martin C Eckert III
Project Number: [none]
Project: Noble - Trebor #B11-15

Extractable Petroleum Hydrocarbons by 8015D - Quality Control
Origins Laboratory, Inc.

Analyte	Result	Reporting Limit	Units	Spike Level	Source Result	%REC	%REC Limits	RPD	RPD Limit	Notes
Batch B3J1101 - EPA 3550B										
LCS (B3J1101-BS1)					Prepared: 10/11/2023 Analyzed: 10/11/2023					
Diesel (C10-C28)	1030	50.0	mg/kg	1000		103	70-130			
Residual Range Organics (C28-C40)	1210	200	"	1000		121	70-130			
Surrogate: o-Terphenyl	41		"	49.8		82.2	50-150			

Origins Laboratory, Inc.



The results in this report apply to the samples analyzed in accordance with the chain of custody document. This analytical report must be reproduced in its entirety.

Eagle Environmental Consulting, LLC
8000 W 44th Ave
Wheat Ridge CO 80033

Martin C Eckert III
Project Number: [none]
Project: Noble - Trebor #B11-15

Extractable Petroleum Hydrocarbons by 8015D - Quality Control
Origins Laboratory, Inc.

Analyte	Result	Reporting Limit	Units	Spike Level	Source Result	%REC	%REC Limits	RPD	RPD Limit	Notes
---------	--------	-----------------	-------	-------------	---------------	------	-------------	-----	-----------	-------

Batch B3J1101 - EPA 3550B

Matrix Spike (B3J1101-MS1)		Source: Y310237-01			Prepared: 10/11/2023 Analyzed: 10/11/2023					
Diesel (C10-C28)	1070	50.0	mg/kg	1000	ND	107	70-130			
Residual Range Organics (C28-C40)	1240	200	"	1000	ND	124	70-130			
Surrogate: o-Terphenyl	41		"	49.8		82.2	50-150			

Origins Laboratory, Inc.



The results in this report apply to the samples analyzed in accordance with the chain of custody document. This analytical report must be reproduced in its entirety.

Eagle Environmental Consulting, LLC
8000 W 44th Ave
Wheat Ridge CO 80033

Martin C Eckert III
Project Number: [none]
Project: Noble - Trebor #B11-15

Extractable Petroleum Hydrocarbons by 8015D - Quality Control Origins Laboratory, Inc.

Analyte	Result	Reporting Limit	Units	Spike Level	Source Result	%REC	%REC Limits	RPD	RPD Limit	Notes
Batch B3J1101 - EPA 3550B										
Matrix Spike Dup (B3J1101-MSD1)		Source: Y310237-01			Prepared: 10/11/2023 Analyzed: 10/11/2023					
Diesel (C10-C28)	1120	50.0	mg/kg	1000	ND	112	70-130	4.38	35	
Residual Range Organics (C28-C40)	1300	200	"	1000	ND	130	70-130	4.93	35	
Surrogate: o-Terphenyl	41		"	49.8		81.5	50-150			

Origins Laboratory, Inc.



The results in this report apply to the samples analyzed in accordance with the chain of custody document. This analytical report must be reproduced in its entirety.

Jordan A. Bynon, Project Manager

Eagle Environmental Consulting, LLC
8000 W 44th Ave
Wheat Ridge CO 80033

Martin C Eckert III
Project Number: [none]
Project: Noble - Trebor #B11-15

Extractable Petroleum Hydrocarbons by 8015D - Quality Control

Origins Laboratory, Inc.

Analyte	Result	Reporting Limit	Units	Spike Level	Source Result	%REC	%REC Limits	RPD	RPD Limit	Notes
---------	--------	-----------------	-------	-------------	---------------	------	-------------	-----	-----------	-------

Metals by EPA 6000/7000 Series Methods - Quality Control

Origins Laboratory, Inc.

Analyte	Result	Reporting Limit	Units	Spike Level	Source Result	%REC	%REC Limits	RPD	RPD Limit	Notes
---------	--------	-----------------	-------	-------------	---------------	------	-------------	-----	-----------	-------

Batch B3J1018 - EPA 3050B

Blank (B3J1018-BLK1)

Prepared: 10/10/2023 Analyzed: 10/13/2023

Arsenic	ND	0.000100	mg/kg
Barium	ND	0.0100	"
Cadmium	ND	0.000100	"
Copper	ND	0.0100	"
Lead	ND	0.0100	"
Nickel	ND	0.0100	"
Selenium	ND	0.000100	"
Silver	ND	0.000100	"
Zinc	ND	0.100	"

LCS (B3J1018-BS1)

Prepared: 10/10/2023 Analyzed: 10/13/2023

Arsenic	0.0452	0.000100	mg/kg	0.0500	90.4	80-120
Barium	5.02	0.0100	"	5.00	100	80-120
Cadmium	0.0508	0.000100	"	0.0500	102	80-120
Copper	0.538	0.0100	"	0.500	108	80-120
Lead	0.0494	0.0100	"	0.0500	98.8	80-120
Nickel	0.0498	0.0100	"	0.0500	99.6	80-120
Selenium	0.0498	0.000100	"	0.0500	99.6	80-120
Silver	0.0516	0.000100	"	0.0500	103	80-120
Zinc	0.508	0.100	"	0.500	102	80-120

Matrix Spike (B3J1018-MS1)

Source: Y310254-01

Prepared: 10/10/2023 Analyzed: 10/13/2023

Origins Laboratory, Inc.



The results in this report apply to the samples analyzed in accordance with the chain of custody document. This analytical report must be reproduced in its entirety.

Eagle Environmental Consulting, LLC
8000 W 44th Ave
Wheat Ridge CO 80033

Martin C Eckert III
Project Number: [none]
Project: Noble - Trebor #B11-15

Metals by EPA 6000/7000 Series Methods - Quality Control
Origins Laboratory, Inc.

Analyte	Result	Reporting Limit	Units	Spike Level	Source Result	%REC	%REC Limits	RPD	RPD Limit	Notes
Batch B3J1018 - EPA 3050B										
Matrix Spike (B3J1018-MS1)		Source: Y310254-01			Prepared: 10/10/2023 Analyzed: 10/13/2023					
Arsenic	5.64	0.0927	mg/kg	4.64	1.20	95.7	75-125			
Barium	495	9.27	"	464	57.3	94.5	75-125			
Cadmium	4.69	0.0927	"	4.64	0.0466	100	75-125			
Copper	52.7	9.27	"	46.4	3.08	107	75-125			
Lead	7.24	9.27	"	4.64	11.0	NR	75-125			QM-07
Nickel	6.57	9.27	"	4.64	2.56	86.4	75-125			
Selenium	4.61	0.0927	"	4.64	ND	99.4	75-125			
Silver	4.67	0.0927	"	4.64	0.00373	101	75-125			
Zinc	59.0	92.7	"	46.4	13.5	98.2	75-125			
Matrix Spike Dup (B3J1018-MSD1)		Source: Y310254-01			Prepared: 10/10/2023 Analyzed: 10/13/2023					
Arsenic	5.44	0.0935	mg/kg	4.67	1.20	90.7	75-125	3.61	20	
Barium	471	9.35	"	467	57.3	88.5	75-125	5.04	20	
Cadmium	4.42	0.0935	"	4.67	0.0466	93.5	75-125	6.05	20	
Copper	50.0	9.35	"	46.7	3.08	100	75-125	5.12	20	
Lead	12.0	9.35	"	4.67	11.0	20.0	75-125	49.2	20	QM-07
Nickel	6.55	9.35	"	4.67	2.56	85.3	75-125	0.297	20	
Selenium	4.35	0.0935	"	4.67	ND	93.1	75-125	5.79	20	
Silver	4.43	0.0935	"	4.67	0.00373	94.6	75-125	5.36	20	
Zinc	57.9	93.5	"	46.7	13.5	95.2	75-125	1.85	20	

Origins Laboratory, Inc.



The results in this report apply to the samples analyzed in accordance with the chain of custody document. This analytical report must be reproduced in its entirety.

Eagle Environmental Consulting, LLC
8000 W 44th Ave
Wheat Ridge CO 80033

Martin C Eckert III
Project Number: [none]
Project: Noble - Trebor #B11-15

EPA 8270E (SW846) - Semivolatile Organic Compounds - Quality Control
Origins Laboratory, Inc.

Analyte	Result	Reporting Limit	Units	Spike Level	Source Result	%REC	%REC Limits	RPD	RPD Limit	Notes
---------	--------	-----------------	-------	-------------	---------------	------	-------------	-----	-----------	-------

Batch B3J0932 - EPA 3580

Blank (B3J0932-BLK1)

Prepared: 10/09/2023 Analyzed: 10/12/2023

1-Methylnaphthalene	ND	0.002	mg/kg							U
2-Methylnaphthalene	ND	0.002	"							U
Acenaphthene	ND	0.020	"							U
Anthracene	ND	0.020	"							U
Benzo (a) anthracene	ND	0.005	"							U
Benzo (a) pyrene	ND	0.020	"							U
Benzo (b) fluoranthene	ND	0.020	"							U
Benzo (g,h,i) perylene	ND	0.020	"							U
Benzo (k) fluoranthene	ND	0.020	"							U
Chrysene	ND	0.020	"							U
Dibenz (a,h) anthracene	ND	0.020	"							U
Fluoranthene	ND	0.020	"							U
Fluorene	ND	0.020	"							U
Indeno (1,2,3-cd) pyrene	ND	0.020	"							U
Naphthalene	ND	0.002	"							U
Phenanthrene	ND	0.020	"							U
Pyrene	ND	0.020	"							U
Surrogate: Fluorene-d10	190		ug/kg	200		95.5	60-130			
Surrogate: Anthracene-d10	200		"	200		101	60-130			
Surrogate: Pyrene-d10	210		"	200		106	60-130			
Surrogate: Benzo (a) pyrene-d12	180		"	200		90.6	60-130			

LCS (B3J0932-BS1)

Prepared: 10/09/2023 Analyzed: 10/12/2023

1-Methylnaphthalene	0.188	0.002	mg/kg	0.200		94.1	70-130			
2-Methylnaphthalene	0.191	0.002	"	0.200		95.6	70-130			
Acenaphthene	0.183	0.020	"	0.200		91.5	70-130			
Anthracene	0.188	0.020	"	0.200		93.9	70-130			

Origins Laboratory, Inc.



The results in this report apply to the samples analyzed in accordance with the chain of custody document. This analytical report must be reproduced in its entirety.

Eagle Environmental Consulting, LLC
8000 W 44th Ave
Wheat Ridge CO 80033

Martin C Eckert III
Project Number: [none]
Project: Noble - Trebor #B11-15

EPA 8270E (SW846) - Semivolatile Organic Compounds - Quality Control
Origins Laboratory, Inc.

Analyte	Result	Reporting Limit	Units	Spike Level	Source Result	%REC	%REC Limits	RPD	RPD Limit	Notes
---------	--------	-----------------	-------	-------------	---------------	------	-------------	-----	-----------	-------

Batch B3J0932 - EPA 3580

LCS (B3J0932-BS1)

Prepared: 10/09/2023 Analyzed: 10/12/2023

Benzo (a) anthracene	0.174	0.005	mg/kg	0.200		86.8	70-130
Benzo (a) pyrene	0.187	0.020	"	0.200		93.3	70-130
Benzo (b) fluoranthene	0.178	0.020	"	0.200		89.2	70-130
Benzo (g,h,i) perylene	0.194	0.020	"	0.200		96.8	70-130
Benzo (k) fluoranthene	0.191	0.020	"	0.200		95.5	70-130
Chrysene	0.201	0.020	"	0.200		100	70-130
Dibenz (a,h) anthracene	0.188	0.020	"	0.200		93.8	70-130
Fluoranthene	0.190	0.020	"	0.200		94.9	70-130
Fluorene	0.181	0.020	"	0.200		90.4	70-130
Indeno (1,2,3-cd) pyrene	0.215	0.020	"	0.200		107	70-130
Naphthalene	0.188	0.002	"	0.200		94.2	70-130
Phenanthrene	0.187	0.020	"	0.200		93.3	70-130
Pyrene	0.193	0.020	"	0.200		96.4	70-130
Surrogate: Fluorene-d10	190		ug/kg	200		97.4	60-130
Surrogate: Anthracene-d10	190		"	200		95.0	60-130
Surrogate: Pyrene-d10	210		"	200		104	60-130
Surrogate: Benzo (a) pyrene-d12	190		"	200		95.9	60-130

Matrix Spike (B3J0932-MS1)

Source: Y310157-01

Prepared: 10/09/2023 Analyzed: 10/12/2023

1-Methylnaphthalene	0.199	0.002	mg/kg	0.200	ND	99.6	70-130
2-Methylnaphthalene	0.189	0.002	"	0.200	ND	94.6	70-130
Acenaphthene	0.186	0.020	"	0.200	ND	93.2	70-130
Anthracene	0.182	0.020	"	0.200	0.0004	90.8	70-130
Benzo (a) anthracene	0.148	0.005	"	0.200	0.0007	73.8	70-130
Benzo (a) pyrene	0.180	0.020	"	0.200	ND	89.8	70-130
Benzo (b) fluoranthene	0.186	0.020	"	0.200	0.0005	92.8	70-130
Benzo (g,h,i) perylene	0.193	0.020	"	0.200	ND	96.5	70-130

Origins Laboratory, Inc.



The results in this report apply to the samples analyzed in accordance with the chain of custody document. This analytical report must be reproduced in its entirety.

Eagle Environmental Consulting, LLC
8000 W 44th Ave
Wheat Ridge CO 80033

Martin C Eckert III
Project Number: [none]
Project: Noble - Trebor #B11-15

EPA 8270E (SW846) - Semivolatile Organic Compounds - Quality Control
Origins Laboratory, Inc.

Analyte	Result	Reporting Limit	Units	Spike Level	Source Result	%REC	%REC Limits	RPD	RPD Limit	Notes
---------	--------	-----------------	-------	-------------	---------------	------	-------------	-----	-----------	-------

Batch B3J0932 - EPA 3580

Matrix Spike (B3J0932-MS1)		Source: Y310157-01			Prepared: 10/09/2023 Analyzed: 10/12/2023					
Benzo (k) fluoranthene	0.204	0.020	mg/kg	0.200	ND	102	70-130			
Chrysene	0.189	0.020	"	0.200	0.0007	94.1	70-130			
Dibenz (a,h) anthracene	0.185	0.020	"	0.200	ND	92.3	70-130			
Fluoranthene	0.192	0.020	"	0.200	0.0004	95.8	70-130			
Fluorene	0.182	0.020	"	0.200	ND	90.9	70-130			
Indeno (1,2,3-cd) pyrene	0.196	0.020	"	0.200	ND	98.1	70-130			
Naphthalene	0.191	0.002	"	0.200	ND	95.4	70-130			
Phenanthrene	0.190	0.020	"	0.200	ND	95.1	70-130			
Pyrene	0.212	0.020	"	0.200	0.0005	106	70-130			
Surrogate: Fluorene-d10	190		ug/kg	200		97.4	60-130			
Surrogate: Anthracene-d10	190		"	200		97.0	60-130			
Surrogate: Pyrene-d10	220		"	200		111	60-130			
Surrogate: Benzo (a) pyrene-d12	200		"	200		102	60-130			

Matrix Spike Dup (B3J0932-MSD1)		Source: Y310157-01			Prepared: 10/09/2023 Analyzed: 10/12/2023					
1-Methylnaphthalene	0.201	0.002	mg/kg	0.200	ND	100	70-130	0.716	20	
2-Methylnaphthalene	0.190	0.002	"	0.200	ND	95.0	70-130	0.495	20	
Acenaphthene	0.189	0.020	"	0.200	ND	94.6	70-130	1.42	20	
Anthracene	0.188	0.020	"	0.200	0.0004	93.8	70-130	3.23	20	
Benzo (a) anthracene	0.199	0.005	"	0.200	0.0007	99.2	70-130	29.3	20	QM-07
Benzo (a) pyrene	0.190	0.020	"	0.200	ND	95.0	70-130	5.65	20	
Benzo (b) fluoranthene	0.181	0.020	"	0.200	0.0005	90.2	70-130	2.85	20	
Benzo (g,h,i) perylene	0.190	0.020	"	0.200	ND	95.0	70-130	1.53	20	
Benzo (k) fluoranthene	0.202	0.020	"	0.200	ND	101	70-130	1.18	20	
Chrysene	0.187	0.020	"	0.200	0.0007	93.2	70-130	0.881	20	
Dibenz (a,h) anthracene	0.186	0.020	"	0.200	ND	92.8	70-130	0.586	20	
Fluoranthene	0.198	0.020	"	0.200	0.0004	98.9	70-130	3.12	20	

Origins Laboratory, Inc.



The results in this report apply to the samples analyzed in accordance with the chain of custody document. This analytical report must be reproduced in its entirety.

Eagle Environmental Consulting, LLC
8000 W 44th Ave
Wheat Ridge CO 80033

Martin C Eckert III
Project Number: [none]
Project: Noble - Trebor #B11-15

EPA 8270E (SW846) - Semivolatile Organic Compounds - Quality Control
Origins Laboratory, Inc.

Analyte	Result	Reporting Limit	Units	Spike Level	Source Result	%REC	%REC Limits	RPD	RPD Limit	Notes
---------	--------	-----------------	-------	-------------	---------------	------	-------------	-----	-----------	-------

Batch B3J0932 - EPA 3580

Matrix Spike Dup (B3J0932-MSD1)		Source: Y310157-01			Prepared: 10/09/2023 Analyzed: 10/12/2023					
Fluorene	0.183	0.020	mg/kg	0.200	ND	91.5	70-130	0.673	20	
Indeno (1,2,3-cd) pyrene	0.172	0.020	"	0.200	ND	86.0	70-130	13.2	20	
Naphthalene	0.195	0.002	"	0.200	ND	97.5	70-130	2.23	20	
Phenanthrene	0.196	0.020	"	0.200	ND	97.8	70-130	2.75	20	
Pyrene	0.192	0.020	"	0.200	0.0005	95.6	70-130	10.0	20	
Surrogate: Fluorene-d10	190		ug/kg	200		96.6	60-130			
Surrogate: Anthracene-d10	210		"	200		107	60-130			
Surrogate: Pyrene-d10	200		"	200		100	60-130			
Surrogate: Benzo (a) pyrene-d12	190		"	200		96.9	60-130			

Origins Laboratory, Inc.



The results in this report apply to the samples analyzed in accordance with the chain of custody document. This analytical report must be reproduced in its entirety.

Eagle Environmental Consulting, LLC
8000 W 44th Ave
Wheat Ridge CO 80033

Martin C Eckert III
Project Number: [none]
Project: Noble - Trebor #B11-15

Classical Chemistry Parameters - Quality Control

Origins Laboratory, Inc.

Analyte	Result	Reporting Limit	Units	Spike Level	Source Result	%REC	%REC Limits	RPD	RPD Limit	Notes
---------	--------	-----------------	-------	-------------	---------------	------	-------------	-----	-----------	-------

Batch B3J1013 - Saturated Paste Metals

Blank (B3J1013-BLK1)

Prepared: 10/10/2023 Analyzed: 10/11/2023

SAR	ND	0.0100	SAR
Calcium PPM	ND	10.0	mg/L
Magnesium PPM	ND	10.0	"
Sodium PPM	ND	10.0	"

Duplicate (B3J1013-DUP1)

Source: Y310202-01

Prepared: 10/10/2023 Analyzed: 10/11/2023

Calcium PPM	18.2	10.0	mg/L	21.0	14.4	50
SAR	ND	0.0100	SAR	4.22	200	
Magnesium PPM	5.95	10.0	mg/L	6.53	9.29	50
Sodium PPM	81.8	10.0	"	86.5	5.61	50

Batch B3J1115 - DTPA Sorbitol Preparation

Blank (B3J1115-BLK1)

Prepared: 10/11/2023 Analyzed: 10/12/2023

Boron	ND	0.100	mg/L
-------	----	-------	------

Duplicate (B3J1115-DUP1)

Source: Y310195-02

Prepared: 10/11/2023 Analyzed: 10/12/2023

Boron	1.85	0.101	mg/L	1.68	9.90	50
-------	------	-------	------	------	------	----

Origins Laboratory, Inc.



The results in this report apply to the samples analyzed in accordance with the chain of custody document. This analytical report must be reproduced in its entirety.

Eagle Environmental Consulting, LLC
8000 W 44th Ave
Wheat Ridge CO 80033

Martin C Eckert III
Project Number: [none]
Project: Noble - Trebor #B11-15

Saturated Paste - Quality Control Origins Laboratory, Inc.

Analyte	Result	Reporting Limit	Units	Spike Level	Source Result	%REC	%REC Limits	RPD	RPD Limit	Notes
Batch B3J1017 - Saturated Paste pH/EC										
Blank (B3J1017-BLK1)					Prepared: 10/10/2023 Analyzed: 10/11/2023					
Specific Conductance (EC)	ND	0.00500	mmhos/cm							
Duplicate (B3J1017-DUP1)					Source: Y310202-01 Prepared: 10/10/2023 Analyzed: 10/11/2023					
pH	8.33		pH Units		8.34			0.120	25	
Specific Conductance (EC)	0.593	0.00500	mmhos/cm		0.604			1.87	25	

Origins Laboratory, Inc.



The results in this report apply to the samples analyzed in accordance with the chain of custody document. This analytical report must be reproduced in its entirety.

Eagle Environmental Consulting, LLC
8000 W 44th Ave
Wheat Ridge CO 80033

Martin C Eckert III
Project Number: [none]
Project: Noble - Trebor #B11-15

Total Metals by 7196A - Quality Control Waypoint Analytical, LLC.

Analyte	Result	Reporting Limit	Units	Spike Level	Source Result	%REC	%REC Limits	RPD	RPD Limit	Notes
Batch L712444 -										
DUP (L 81680-DUP)		Source: Y310254-01			Prepared: Analyzed: 10/23/2023					
Chromium, Hexavalent	ND	0.519	mg/Kg		<0.519		-	0	20	
MS (L 81680-MS)		Source: Y310254-01			Prepared: Analyzed: 10/23/2023					
Chromium, Hexavalent	36.7	2.58	mg/Kg	41.3	<1.26	89	75-125			
LCS (LCS)					Prepared: Analyzed: 10/23/2023					
Chromium, Hexavalent	7.11	0.5	mg/Kg	8		89	75-125			
LRB (LRB)					Prepared: Analyzed: 10/23/2023					
Chromium, Hexavalent	ND	0.5	mg/Kg				-			

Origins Laboratory, Inc.



The results in this report apply to the samples analyzed in accordance with the chain of custody document. This analytical report must be reproduced in its entirety.

Jordan A. Bynon, Project Manager

Eagle Environmental Consulting, LLC
8000 W 44th Ave
Wheat Ridge CO 80033

Martin C Eckert III
Project Number: [none]
Project: Noble - Trebor #B11-15

Notes and Definitions

U Sample is Non-Detect.

S-07 High surrogate in sample, however sample is non-detect. High surrogate indicates result values are biased high.

QM-07 The spike recovery was outside acceptance limits for the MS and/or MSD. The batch was accepted based on acceptable LCS recovery.

ND Analyte NOT DETECTED at or above the reporting limit

RPD Relative Percent Difference

All soil results are reported on a wet weight basis.

Calculated results may use J-flag data (instead of reported "ND") as part of calculation to provide a more accurate result.

Origins Laboratory, Inc.



The results in this report apply to the samples analyzed in accordance with the chain of custody document. This analytical report must be reproduced in its entirety.

Jordan A. Bynon, Project Manager



November 07, 2023

Eagle Environmental Consulting, LLC

Andrew Newberry

8000 W 44th Ave

Wheat Ridge CO 80033

Project Name - Noble - Trebor #B11-15

Project Number - [none]

Attached are your analytical results for Noble - Trebor #B11-15 received by Origins Laboratory, Inc. October 26, 2023. This project is associated with Origins project number Y310701-01.

The analytical results in the following report were analyzed under the guidelines of EPA Methods. These methods are identified as follows; "SW" are defined in SW-846, "EPA" are defined in 40CFR part 136 and "SM" are defined in the most current revision of Standard Methods For the Examination of Water and Wastewater.

The analytical results apply specifically to the samples and analyses specified per the attached Chain of Custody. As such, this report shall not be reproduced except in full, without the written approval of Origin's laboratory.

Unless otherwise noted, the analytical results for all soil samples are reported on a wet weight basis. All analytical analyses were performed under NELAP guidelines unless noted by a data qualifier.

Any holding time exceedances, deviations from the method specifications or deviations from Origins Laboratory's Standard Operating Procedures are outlined in the case narrative.

Thank you for selecting Origins for your analytical needs. Please contact us with any questions concerning this report, or if we can help with anything at all.

Origins Laboratory, Inc.
303.433.1322
o-squad@oelabinc.com



1725 Elk Place, Denver, CO 80211 | Phone: 303.433.1322 | Fax: 303.265.9645

Eagle Environmental Consulting, LLC

8000 W 44th Ave

Wheat Ridge CO 80033

Andrew Newberry

Project Number: [none]

Project: Noble - Trebor #B11-15

CROSS REFERENCE REPORT

Sample ID	Laboratory ID	Matrix	Date Sampled	Date Received
Background-01@2'	Y310701-01	Soil	October 9, 2023 9:30	10/26/2023 10:10

Origins Laboratory, Inc.



The results in this report apply to the samples analyzed in accordance with the chain of custody document. This analytical report must be reproduced in its entirety.

Andrew Newberry
Project Number: [none]
Project: Noble - Trebor #B11-15

ORIGINS
LABORATORY, INC

Client: Eagle Environmental Consulting

Address: 8000 W 44th Ave
Wheat Ridge, CO 80033

Telephone Number: 303-433-0474

Email Address: anlab@eagle-environ.com

www.originslaboratory.com

4310701

page | of |

Project Manager: Andrew Newberry

Project Name: Tribor # B11-15

Project Number: -

Samples Collected By: BV

Sample ID Description	Date Sampled	Time Sampled	# of Containers	Preservative						Matrix					Analysis				Sample Instructions		
				Unpreserved	HCl	HNO ₃	Other	Groundwater	Soil	Air Summa Canister #	Other	- cool P.									
Bulkground-0102'	10/9/23	0930	1	X						X										INDUs Method	1
																				2	
																				3	
																				4	
																				5	
																				6	
																				7	
																				8	
																				9	
Relinquished By: Hartley	Date: 10/26/23																			Turnaround Time:	10
Relinquished By:	Date:		Time: 1010	Received By: EHS	Date: 10/26/23	Time: 1010	Same Day <input type="checkbox"/>	24 Hr <input type="checkbox"/>	48 Hr <input type="checkbox"/>	72 Hr <input type="checkbox"/>	Standard <input checked="" type="checkbox"/>										

* Bill to Jeff

Origins Laboratory, Inc.

Byron

The results in this report apply to the samples analyzed in accordance with the chain of custody document. This analytical report must be reproduced in its entirety.

Eagle Environmental Consulting, LLC
8000 W 44th Ave
Wheat Ridge CO 80033

Andrew Newberry
Project Number: [none]
Project: Noble - Trebor #B11-15

Origins Laboratory

F-012207-01-R1
Effective Date: 01/09/12

Sample Receipt Checklist

Origins Work Order: 4310701

Client: Eagle

Client Project ID: Trebor #B11-15

Checklist Completed by: EHS

Shipped Via: HO

(UPS, FedEx, Hand Delivered, Pick-up, etc.)

Date/time completed: 10/26/23

Airbill #: N/A

Matrix(s) Received: (Check all that apply): ☒ Soil/Solid ☐ Water ☐ Other: _____

Cooler Number/Temperature: 1 / 1.0 °C 1 / _____ °C 1 / _____ °C (Describe)

Thermometer ID: T004

Requirement Description	Yes	No	N/A	Comments (if any)
If samples require cooling, was the temperature between 0°C to ≤ 6°C ⁽¹⁾ ?	<input checked="" type="checkbox"/>	<input type="checkbox"/>	<input type="checkbox"/>	
Is there ice present (document if blue ice is used)	<input checked="" type="checkbox"/>	<input type="checkbox"/>	<input type="checkbox"/>	
Are custody seals present on cooler? (if so, document in comments if they are signed and dated, broken or intact)	<input type="checkbox"/>	<input checked="" type="checkbox"/>	<input type="checkbox"/>	
Are custody seals present on each sample container? (if so, document in comments if they are signed and dated, broken or intact)	<input type="checkbox"/>	<input checked="" type="checkbox"/>	<input type="checkbox"/>	
Were all samples received intact ⁽¹⁾ ?	<input checked="" type="checkbox"/>	<input type="checkbox"/>	<input type="checkbox"/>	
Was adequate sample volume provided ⁽¹⁾ ?	<input checked="" type="checkbox"/>	<input type="checkbox"/>	<input type="checkbox"/>	
Are short holding time analytes or samples with HTs due within 48 hours present ⁽¹⁾ ?	<input type="checkbox"/>	<input checked="" type="checkbox"/>	<input type="checkbox"/>	
Is a chain-of-custody (COC) present and filled out completely ⁽¹⁾ ?	<input checked="" type="checkbox"/>	<input type="checkbox"/>	<input type="checkbox"/>	
Does the COC agree with the number and type of sample bottles received ⁽¹⁾ ?	<input checked="" type="checkbox"/>	<input type="checkbox"/>	<input type="checkbox"/>	
Do the sample IDs on the bottle labels match the COC ⁽¹⁾ ?	<input checked="" type="checkbox"/>	<input type="checkbox"/>	<input type="checkbox"/>	
Is the COC properly relinquished by the client with date and time recorded ⁽¹⁾ ?	<input checked="" type="checkbox"/>	<input type="checkbox"/>	<input type="checkbox"/>	
For volatiles in water – is there headspace (> ¼ inch bubble) present? If yes, contact client and note in narrative.	<input type="checkbox"/>	<input type="checkbox"/>	<input checked="" type="checkbox"/>	
Are samples preserved that require preservation and was it checked ⁽¹⁾ ? (note ID of confirmation instrument used in comments) / (preservation is not confirmed for subcontracted analyses in order to insure sample integrity)/(pH <2 for samples preserved with HNO ₃ , HCL, H ₂ SO ₄) / (pH >10 for samples preserved with NaAsO ₂ +NaOH, ZnAc+NaOH)	<input type="checkbox"/>	<input type="checkbox"/>	<input checked="" type="checkbox"/>	
Additional Comments (if any):				

⁽¹⁾ If NO, then contact the client before proceeding with analysis and note date/time and person contacted as well as the corrective action to in the additional comments (above) and the case narrative.

Reviewed by (Project Manager) [Signature]

Date/Time Reviewed 10/27/23

Origins Laboratory, Inc.

[Signature]

The results in this report apply to the samples analyzed in accordance with the chain of custody document. This analytical report must be reproduced in its entirety.

Eagle Environmental Consulting, LLC
8000 W 44th Ave
Wheat Ridge CO 80033

Andrew Newberry
Project Number: [none]
Project: Noble - Trebor #B11-15

Background-01@2'

10/9/2023 9:30:00AM

Analyte	Result	Reporting	Units	Dilution	Batch	Analyst	Prepared	Analyzed	Notes
		Limit							

Origins Laboratory, Inc.
Y310701-01 (Soil)

Table 915 metals by EPA 6020B

Arsenic	3.26	0.0860	mg/kg	10	B3J2628	CIH	10/26/2023	10/27/2023
---------	------	--------	-------	----	---------	-----	------------	------------

Origins Laboratory, Inc.



The results in this report apply to the samples analyzed in accordance with the chain of custody document. This analytical report must be reproduced in its entirety.

Eagle Environmental Consulting, LLC
8000 W 44th Ave
Wheat Ridge CO 80033

Andrew Newberry
Project Number: [none]
Project: Noble - Trebor #B11-15

Metals by EPA 6000/7000 Series Methods - Quality Control Origins Laboratory, Inc.

Analyte	Result	Reporting Limit	Units	Spike Level	Source Result	%REC	%REC Limits	RPD	RPD Limit	Notes
Batch B3J2628 - EPA 3050B										
Blank (B3J2628-BLK1)					Prepared: 10/26/2023 Analyzed: 10/30/2023					
Arsenic	ND	0.000100	mg/kg							
LCS (B3J2628-BS1)					Prepared: 10/26/2023 Analyzed: 10/27/2023					
Arsenic	0.0545	0.000100	mg/kg	0.0500		109	80-120			
Matrix Spike (B3J2628-MS1)					Source: Y310698-01 Prepared: 10/26/2023 Analyzed: 10/27/2023					
Arsenic	10.4	0.0887	mg/kg	4.44	5.97	101	75-125			
Matrix Spike Dup (B3J2628-MSD1)					Source: Y310698-01 Prepared: 10/26/2023 Analyzed: 10/27/2023					
Arsenic	10.6	0.0908	mg/kg	4.54	5.97	101	75-125	1.23	20	

Origins Laboratory, Inc.



The results in this report apply to the samples analyzed in accordance with the chain of custody document. This analytical report must be reproduced in its entirety.

Eagle Environmental Consulting, LLC
8000 W 44th Ave
Wheat Ridge CO 80033

Andrew Newberry
Project Number: [none]
Project: Noble - Trebor #B11-15

Notes and Definitions

ND Analyte NOT DETECTED at or above the reporting limit

RPD Relative Percent Difference

All soil results are reported at a wet weight basis.

Origins Laboratory, Inc.



The results in this report apply to the samples analyzed in accordance with the chain of custody document. This analytical report must be reproduced in its entirety.