



RECEIVED

FEB 26 1980

COLO. OIL & GAS CONS. COMM.



00055474

R. 68W

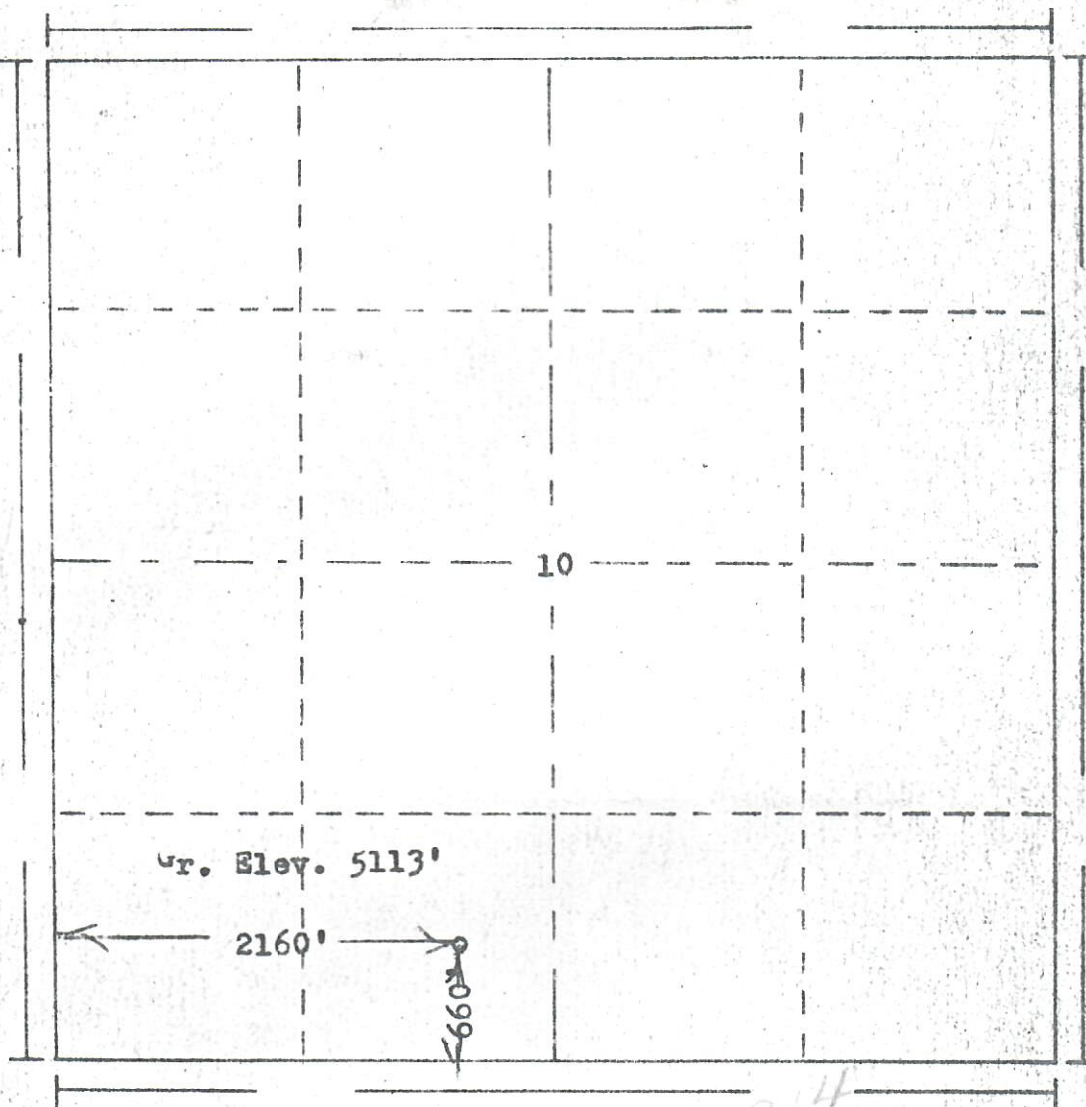

Scale 1" = 1000'

Powers Elevation of Denver, Colorado

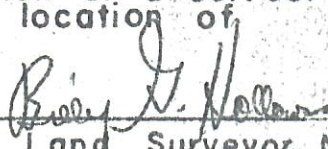
has in accordance with a request from Mr. Perrin
for Amoco Production Co.determined the location of No. 43 UPRR-Pan Am I-28
to be 660'FS & 2160'FW Section 10 Township 1N
Range 68W of the 6th Principal Meridian
Weld County, ColoradoI hereby certify that this plat is an
accurate representation of a correct
survey showing the location ofDate: 2-14-80
Licensed Land Surveyor No. 2853
State of Colorado