



Form PS-102

R. 68 W

RECEIVED

OCT 28 1985

COLO. OIL & GAS CONS. COMM.

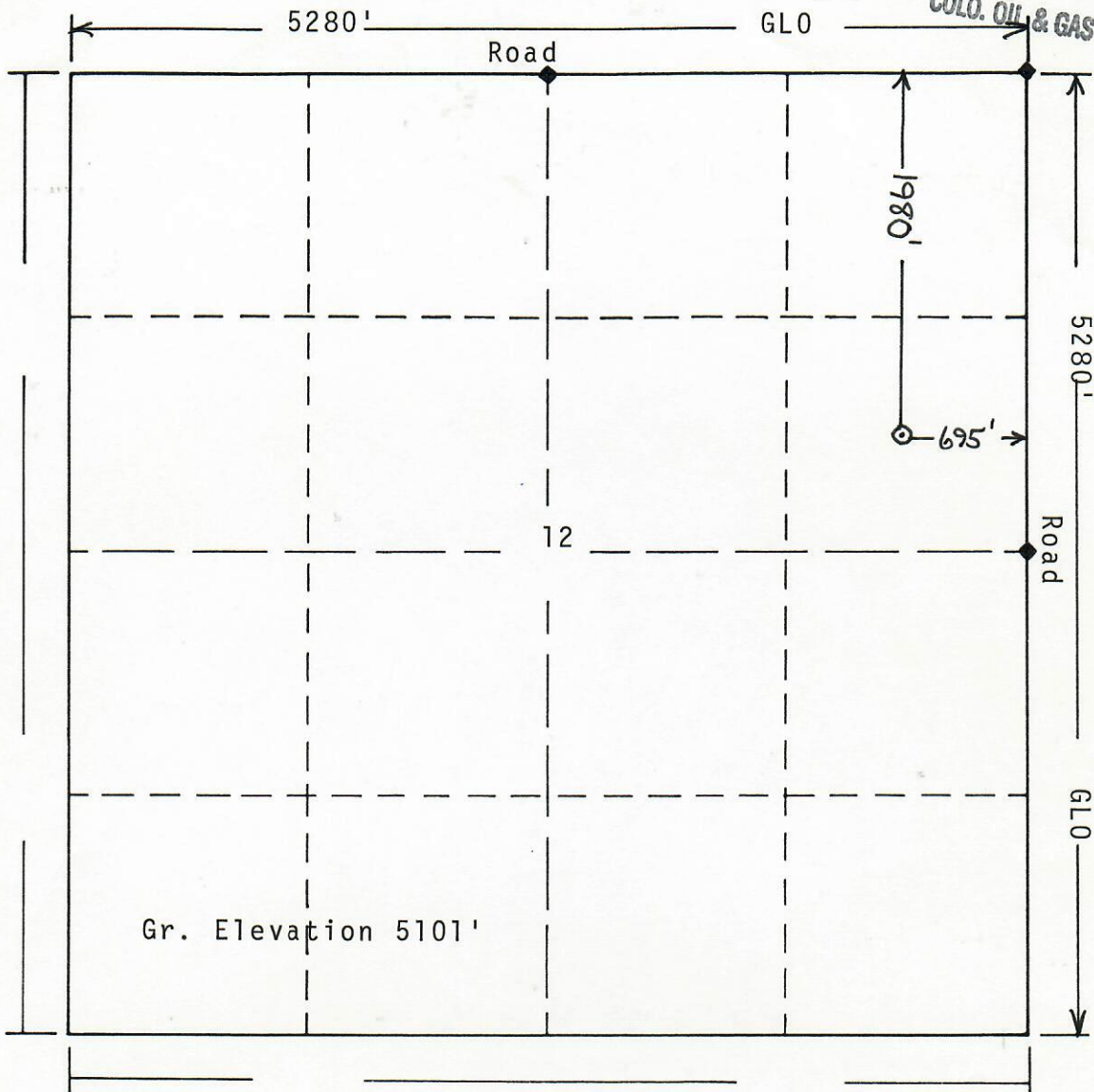

N

T. 1 N

Scale: 1"=1000'

Powers Elevation of Denver, Colorado has in accordance with a request from Mr. Wilt for Amoco Production Co. determined the location of Graham #2 to be 1980fn1, 695fe1 Section 12, Township Range 68 W of the 6th Principal Meridian, Weld County, Colorado



00036722

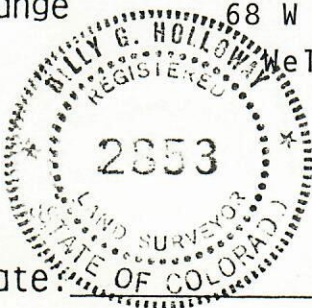

Date: 10-23-85

I hereby certify that this plat is an accurate representation of a correct survey showing the location of Graham #2

Billy G. Holloway

Licensed Land Surveyor/No. 2853
State of Colorado

DR