

DEPARTMENT OF NATURAL RESOURCES

OIL AND GAS CONSERVATION COMMISSION
OF THE STATE OF COLORADO

RECEIVED

MAR 23 1973



00052076

5. ELEVATION OF PRODUCTION SERIAL NO.

APPLICATION

FOR PERMIT TO DRILL, DEEPEN, OR REENTER AND OPERATE

1a. TYPE OF WORK

DRILL ☒DEEPEN ☐REENTER ☐

b. TYPE OF WELL

OIL
WELL ☒GAS
WELL ☐OTHER ☐SINGLE
ZONE ☐MULTIPLE
ZONE ☐

2. NAME OF OPERATOR

PHONE NO.

X O Expl., Claud B. Hamill, & Exeter Drilg. & Expl. Co.

3. ADDRESS OF OPERATOR

623-5141

1010 Patterson Bldg., Denver, 80202

4. LOCATION OF WELL (Report location clearly and in accordance with any State requirements.)

At surface

1860' FWL & 1980' FSL (location moved 120' W. of that shown on
At proposed prod. zone plat to be out of irrigated hayfield)

14. DISTANCE IN MILES AND DIRECTION FROM NEAREST TOWN OR POST OFFICE

15. DISTANCE FROM PROPOSED LOCATION TO NEAREST PROPERTY
OR LEASE LINE, FT.
(Also to nearest drilg. line, if any)

540'

16. NO. OF ACRES IN LEASE*

80

17. NO. OF ACRES AND/OR DRILLING UNIT ASSIGNED
TO THIS WELL

40

18. DISTANCE FROM PROPOSED LOCATION
TO NEAREST WELL, DRILLING, COMPLETED,
OR APPLIED FOR, ON THIS LEASE, FT.

19. PROPOSED DEPTH

5800'

20. ROTARY OR CABLE TOOLS

Rotary

21. ELEVATIONS (Show whether DF, RT, GR, etc.)

5094' GR
23.

22. APPROX. DATE WORK WILL START

April 1, 1973

PROPOSED CASING AND CEMENTING PROGRAM

SIZE OF HOLE	SIZE OF CASING	WEIGHT PER FOOT	SETTING DEPTH	QUANTITY OF CEMENT
12-1/4"	8-5/8"	24#	300'	300 sx.

* DESCRIBE LEASE E/2 SW/4 Sec. 22. Operator also owns W/2 SW/4 Sec. 22.

We propose to test all shows of oil and/or gas.

DVR	
FJP	<input checked="" type="checkbox"/>
HHM	
JAM	<input checked="" type="checkbox"/>
JJD	8/10/73 3-23-73

IN ABOVE SPACE DESCRIBE PROPOSED PROGRAM: If proposal is to deepen or reenter and operate, give data on present productive zone and proposed new productive zone. If proposal is to drill or deepen directionally, give pertinent data on subsurface locations and measured and true vertical depths. Give blowout preventer program, if any.

In accepting this permit the applicant agrees to fully abide by the requirements and rules of this Commission governing this permitted operation including his responsibility to prevent pollution of state waters during drilling, treating, testing, and producing operations and by the casing, cementing and plugging requirements particularly designed for the protection of state waters and the prevention of intermingling of the contents of all the various zones encountered in this permitted operation.

24.

SIGNED

TITLE

AGENT

DATE 3/22/73

(This space for Federal or State Office use)

73 185

PERMIT NO.

APPROVAL DATE

APPROVED BY

TITLE

DIRECTOR
O & G CON. COMM.

DATE MAR 23 1973

CONDITIONS OF APPROVAL, IF ANY:

See Instructions On Reverse Side

A.P.I. NUMBER

25 013 6005

X



FORM F-106

RECEIVED

MAR 23 1973

COLO. OIL & GAS CONS. COMM.

R. 69W

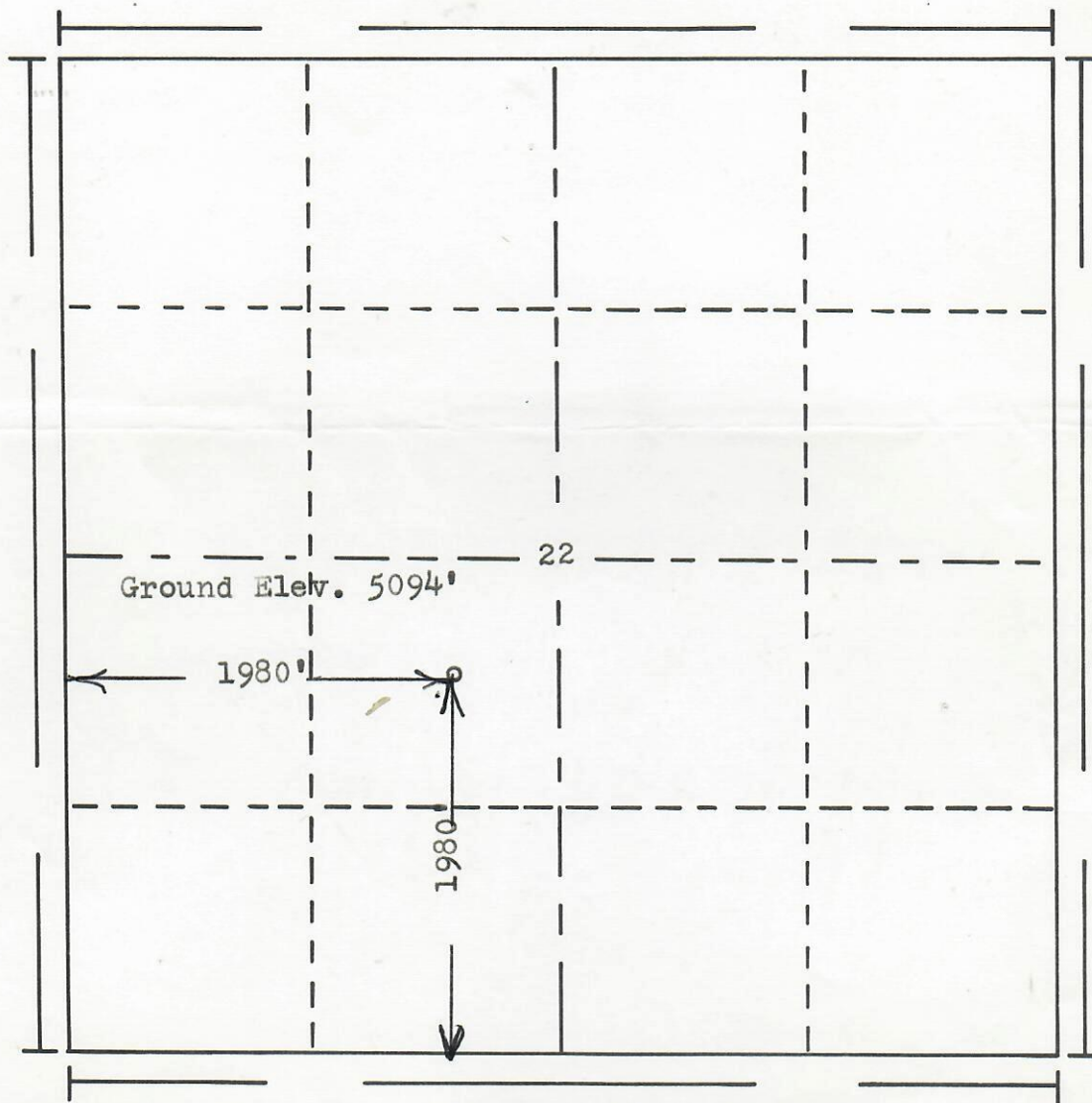
T.
1
N

Scale... 1" = 1000'

Powers Elevation Company, Inc. of Denver, Colorado
has in accordance with a request from Michelle
for Exeter Drlg. & Exploration Co. & X-0 Expl. Co.
determined the location of No. 11-22 Deepe
to be CNE SW Section 22 Township 1N
Range 69W of the 6th Principal Meridian
Boulder County, Colorado

I hereby certify that this plat is an
accurate representation of a correct
survey showing the location of

Date: 3-15-73

Billy G. Holloway
Licensed Land Surveyor No. 2853
State of Colorado