

# Sprague Multi-Well Pad - SESW (302199): Abandon in Place Layout

40.146907, -104.897644  
SESW Sec. 9 T2N, R67W, 6th PM  
Weld County, Colorado  
Crestone Peak Resources (10633)

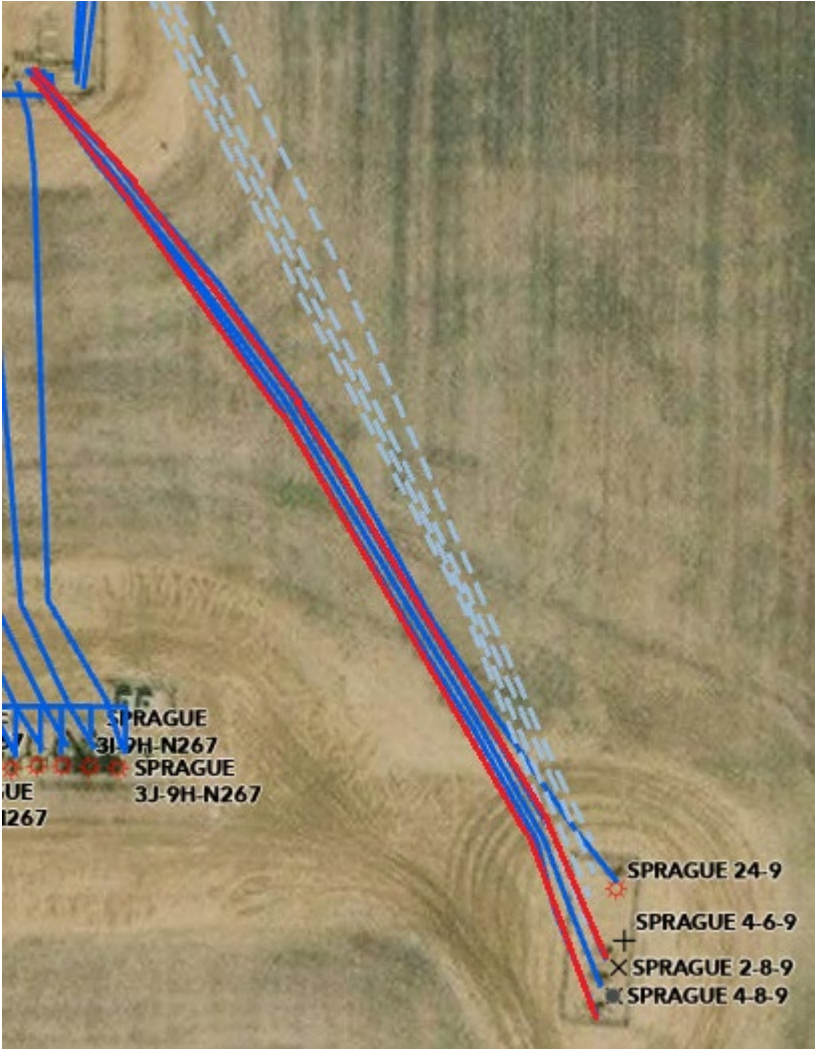

Flowline Unique OperFeatID	Line Type	Start Location Latitude	Start Location Longitude	End Location Latitude (Cut Point)	End Location Longitude (Cut Point)	Length (ft)	Segment	Abandonment Type
12331686_FL (Sprague 4-6-9)	Multiphase	40.146816	-104.897671	40.1477366	-104.8984294	395	Red	Abandon in Place
12330824_FL (Sprague 4-8-9)	Multiphase	40.146790	-104.897659	40.1477375	-104.8984438	415	Red	Abandon in Place