

Legend

- Plugged/Abandoned
- Background Soil Sample
- Soil Sample
- Soil Screening
- Soil Vapor Point (SVP)
- Approximate Location of Flowline (Removed)
- Excavation Extent

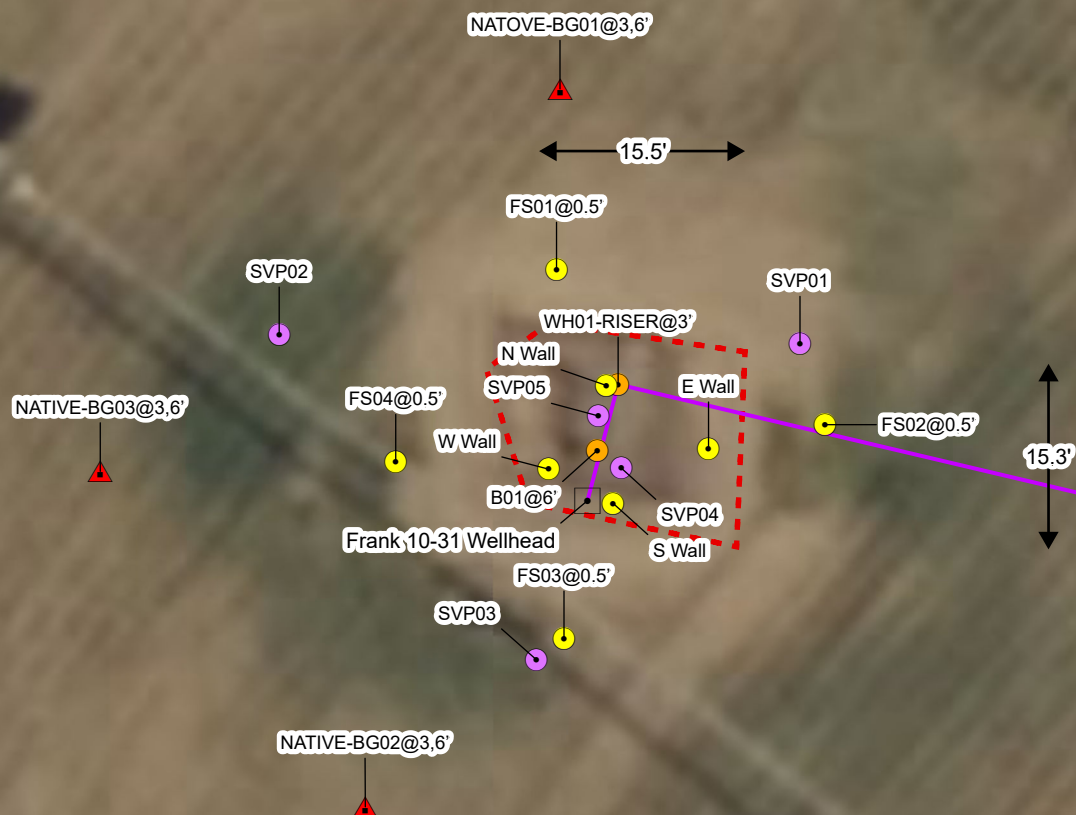

0 10 20
Feet

Sources: Environmental Systems Research Institute (ESRI)



Wellhead Excavation Site Map

Frank 10-31 Wellhead
Kerr-McGee Oil & Gas Onshore, LP
NWSE SEC 31-T4N-R67W
Weld County, CO

Project Number: 09A1417573

FIGURE
1