

Wellhead Closure Checklist

COGCC Rule 911.a.(4) Environmental Site Closure Assessment Field Form

Additional attachments (optional):	Pit Closure	Tank Battery Closure	Flowline Closure 3-31-22	Partially Buried Vault Closure
Site Name & COGCC Facility Number: QC USX #A32-19		Date: 3-31-22		Remediation Project #: 22326
Associated Wells: 05-123-32723		Age of Site: YEARS		Number of Photos Attached: 1
Location: (GPS coordinates of wellhead or southeastern most wellhead for multiple) 40.446490, -104.577610				Estimated Facility Size (acres):
General Condition of Site: (General observations regarding housekeeping, corrosion, waste management, etc.) GOOD				

USCS Soil Type: SW	Estimated Depth to Groundwater: ~18-20'
Hydrocarbon Impacted Soils / Spills: (Note estimated size and if impact appears to be surficial or extends to an unknown depth) NONE OBSERVED	
Salt Crusted Soils or Impacted Vegetation: (Note estimated size and if impact appears to be surficial or extends to an unknown depth) NONE OBSERVED	

Wellhead(s)

Well API	Age	Condition of surface around wellhead	PID Readings	Condition of subsurface (excluding present PID Readings)	Sample taken? Location/Sample ID	Photo Number(s)
05-123-32723	YEARS	GOOD - PER CREW		GOOD		
			NA - EXCAVATED UPON ARRIVAL			
			1.8			
			2.7			
			3.0			
			1.7			
			3.5			
					WH-SS-01	
					WH-SS-02	
					WH-SS-03	
					WH-SS-04	
					WH-FS-01	
						SEE PHOTOLOG

Other observations regarding wellheads:
WELL CASING CUT/CAPPED FOLLOWING ASSESSMENT

Summary

Was impacted soil identified?		<input checked="" type="radio"/> No	Yes - less than 10 cubic yards	Yes - more than 10 cubic yards
Total number of samples field screened:	5	Total number of samples collected:	5	
Highest PID Reading:	3.5	Total number of samples submitted to lab for analysis:	1	
If more than 10 cubic yards of impacted soil were observed:				
Vertical extent:	N/A		Estimated spill volume:	
Lateral extent:	N/A		Volume of soil removed:	
Is additional investigation required?				
Was groundwater encountered during the investigation?				
<input checked="" type="radio"/> No		Yes - not impacted or in contact with impacted soils		Yes - groundwater impacted and/or in contact with impacted soils
Measured depth to groundwater:			Was remedial groundwater removal conducted? Yes No	
Date Groundwater was encountered:			Commencement date of removal:	
Sheen on groundwater?	Yes	No	Volume of groundwater removed prior to sampling:	
Free product observed?	Yes	No	Volume of groundwater removed post sampling:	
Total number of samples collected:			Total Volume of groundwater removed:	
Total number of samples submitted to lab for analysis:				

Flowline Closure Checklist

COGCC Rule 911.a.(4) Environmental Site Closure Assessment Field Form

Additional Attachments:	Tank Battery Closure	Wellhead Closure 3-31-22	Pit Closure	Partially Buried Vault Closure
Site Name & COGCC Facility Number: QC USX #A32-19		Date: 3-31-22		Remediation Project #: 22326
Associated Wells: 05-123-32723		Age of Site: YEARS		Number of Photos Attached: 1
Starting point: (GPS coordinates and descriptions) 40.446492, -104.577625 AT WELL				
End point: (GPS coordinates and descriptions) 40.449482, -104.580947 AT SEPARATOR				
USCS Soil Type: SW			Estimated Depth to Groundwater: ~18-20'	
Hydrocarbon Impacted Soils / Spills: (Note estimated size and if impact appears to be surficial or extends to an unknown depth) NONE OBSERVED				
Salt Crusted Soils or Impacted Vegetation: (Note estimated size and if impact appears to be surficial or extends to an unknown depth) NONE OBSERVED				
Flowlines				
Flowline type	0.6 W			
Depth	~3'			
Age	YEARS			
Length	~1675'			
Construction Material	STEEL			
Were flowlines pulled?	NO - ABANDONED IN PLACE			
Visual Integrity of lines	GOOD - PER INTEGRITY TEST			
Visual impacts if trenched	N/A			
PID Readings if trenched	2.8			
Sample taken? Location/Sample ID#	FL-SS-01			
Photo Number(s)	SEE PHOTOLOG			
Other observations regarding on location flowlines: FLOWLINE ABANDONED IN PLACE. PT. B (OSEP) ASSESSED.				
Summary				
Was impacted soil identified? <input checked="" type="radio"/> No Yes - less than 10 cubic yards Yes - more than 10 cubic yards				
Total number of samples field screened: 1		Total number of samples collected: 1		
Highest PID Reading: 2.8		Total number of samples submitted to lab for analysis: 1		
If more than 10 cubic yards of impacted soil were observed:				
Vertical extent:		Estimated spill volume:		
Lateral extent: N/A		Volume of soil removed:		
Is additional investigation required?				
Was groundwater encountered during the investigation? <input checked="" type="radio"/> No Yes - not impacted or in contact with impacted soils Yes - groundwater impacted and/or in contact with impacted soils				
Measured depth to groundwater:		Was remedial groundwater removal conducted? Yes No		
Date Groundwater was encountered:		Commencement date of removal:		
Sheen on groundwater? Yes No		Volume of groundwater removed prior to sampling:		
Free product observed? Yes No		Volume of groundwater removed post sampling:		
Total number of samples collected:		Total Volume of groundwater removed:		
Total number of samples submitted to lab for analysis:				



FIGURES

Figure 1: Topographic Site Location Map

Figure 2: Aerial Site Location Map

Figure 3: Soil Analytical Map

Figure 4: Polycyclic Aromatic Hydrocarbons Map

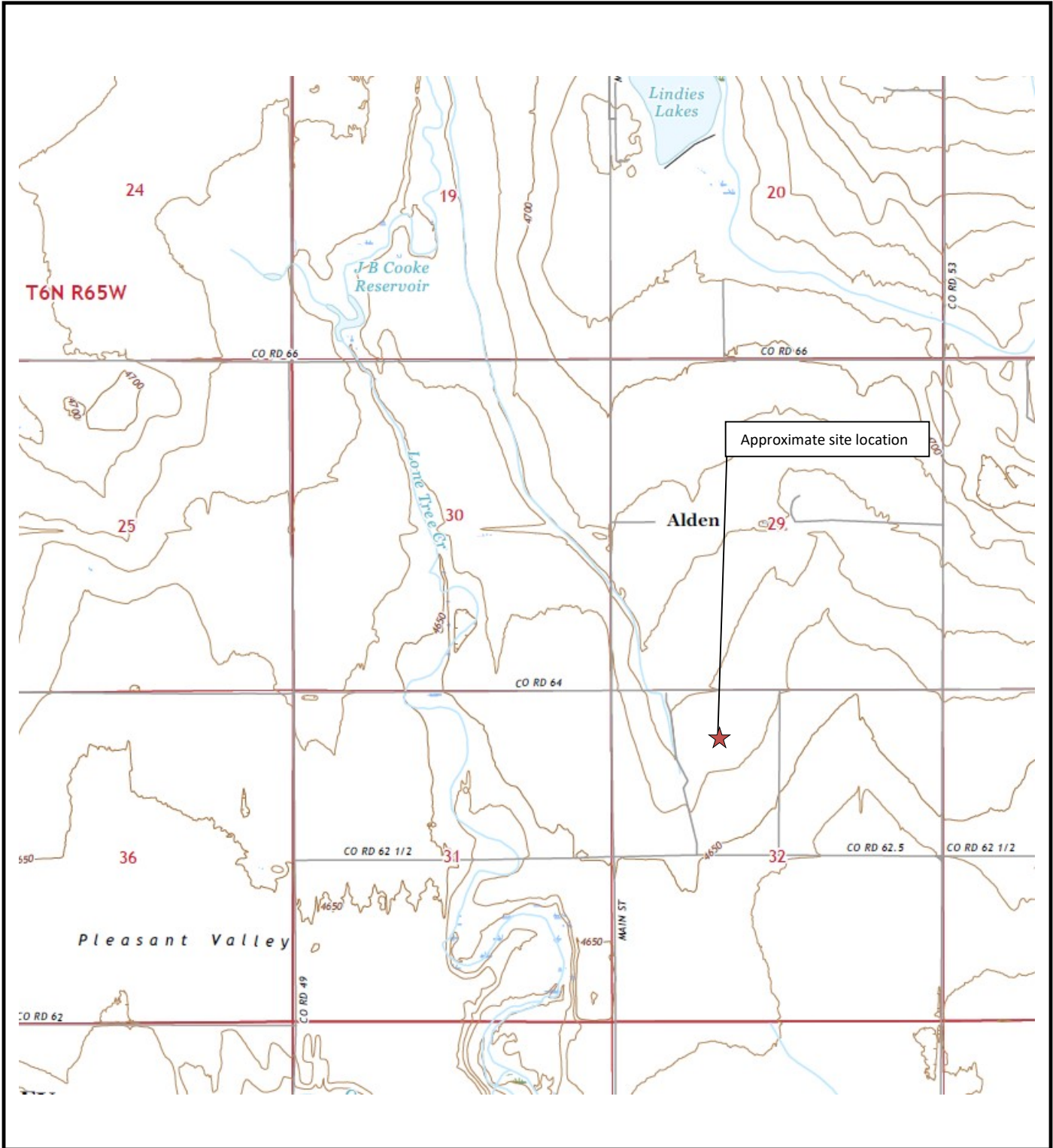

	<p>Topographic Site Location Map QC USX #A32-19 Closure Assessment 40.446490 / -104.577610 NE¼ NW¼ SEC.32 T6N R64W 6PM Weld County, Colorado API # 05-123-32723 Remediation # 22326</p>
	<p>Source: USGS 7.5 Minute Topographic Map, Kersey, CO Quadrangle 2022</p>

	<p>EAGLE ENVIRONMENTAL CONSULTING, INC.</p>
<p>Figure 1</p>	

64



LEGEND

- FORMER QC USX #A32-19 WELLHEAD (PLUGGED AND ABANDONED)
- ASSOCIATED SEPARATOR
- APPROXIMATE FLOWLINE LOCATION

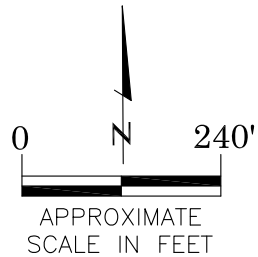

AERIAL SITE LOCATION MAP

QC USX #A32-19
 CLOSURE ASSESSMENT
 40.446490 / -104.577610
 NE¼ NW¼ SEC.32 T6N R64W 6PM
 WELD COUNTY, COLORADO
 API # 05-123-32723
 REMEDIATION # 22326

FIG. NO.
2

DRAWN BY:
CT



EAGLE
 ENVIRONMENTAL
 CONSULTING, INC.

8000 W 44th Ave, Wheat Ridge, CO 80033
 Ph: 303-433-0479 • F: 303-325-5449



FL-SS-01@3'
 03/31/22
 3'
 B = <0.00200
 T = <0.00200
 E = <0.00200
 X = <0.00200
 G = <0.200
 D = <25.0
 R = <100
 1,2,4-TMB = <0.00200
 1,3,5-TMB = <0.00200
 Brn= 0.120
 EC = 0.229
 SAR= 0.482
 pH = 8.23

WH-FS-01@6'
 03/31/22
 6'
 B = <0.00200
 T = <0.00200
 E = <0.00200
 X = <0.00200
 G = <0.200
 D = <25.0
 R = <100
 1,2,4-TMB = <0.00200
 1,3,5-TMB = <0.00200
 Brn= 0.393
 EC = 0.934
 SAR= 1.33
 pH = 7.81

LEGEND

- WELLHEAD ASSESSMENT BOUNDARIES
- APPROXIMATE FLOWLINE LOCATION
- APPROXIMATE LOCATION OF SOIL SAMPLES FIELD SCREENED, ONLY, WITH PHOTOIONIZATION DETECTOR
- APPROXIMATE LOCATION OF SOIL SAMPLES SUBMITTED FOR LABORATORY ANALYSIS

PARAMETERS

SAMPLE LOCATION
 DATE
 DEPTH (FEET)
 B = BENZENE (mg/kg)
 T = TOLUENE (mg/kg)
 E = ETHYLBENZENE (mg/kg)
 X = TOTAL XYLENES (mg/kg)
 G = TPH-GRO (mg/kg)
 D = TPH-DRO (mg/kg)
 R = TPH-RRO (mg/kg)
 1,2,4-TMB = 1,2,4 TRIMETHYLBENZENE (mg/kg)
 1,3,5-TMB = 1,3,5 TRIMETHYLBENZENE (mg/kg)
 Brn= BORON (mg/L)
 EC = SPECIFIC CONDUCTANCE (mmhos/cm)
 SAR= SODIUM ADSORPTION RATIO
 pH = pH (pH UNITS)

mg/kg = MILLIGRAMS PER KILOGRAM
 mg/L = MILLIGRAMS PER LITER
 mmhos/cm = MILLIMHOS PER CENTIMETER

TPH-GRO = TOTAL PETROLEUM HYDROCARBONS - GASOLINE RANGE ORGANICS
 TPH-DRO = TOTAL PETROLEUM HYDROCARBONS - DIESEL RANGE ORGANICS
 TPH-RRO = TOTAL PETROLEUM HYDROCARBONS - RESIDUAL RANGE ORGANICS

NOTES:
 VALUES PRESENTED WITH A LESS THAN SYMBOL (<) DID NOT CONTAIN CONCENTRATIONS AT OR ABOVE LABORATORY DETECTION LIMITS.

VALUES PRESENTED IN **BOLD** EXCEED COGCC TABLE 915-1 REGULATORY LIMITS.

COGCC = COLORADO OIL AND GAS CONSERVATION COMMISSION

SOIL ANALYTICAL MAP
 QC USX #A32-19
 CLOSURE ASSESSMENT
 40.446490 / -104.577610
 NE¼ NW¼ SEC.32 T6N R64W 6PM
 WELD COUNTY, COLORADO
 API # 05-123-32723
 REMEDIATION # 22326

WH-SS-01
 WH-SS-04
 WH-FS-01
 WH-SS-03
 WH-SS-02

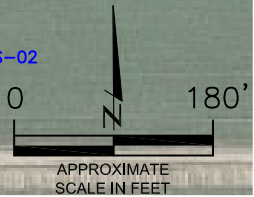

DRAWN BY:

CT

FIG. NO.

3

EAGLE
 ENVIRONMENTAL
 CONSULTING, INC.
 8000 W 44th Ave, Wheat Ridge, CO 80033
 Ph: 303-433-0479 • F: 303-325-5449



FL-SS-01@3'
 03/31/22
 3'
 ND = <0.00067
 1-Methylnaphthalene = ND
 2-Methylnaphthalene = ND
 Acenaphthene = ND
 Anthracene = ND
 Benzo(a)anthracene = ND
 Benzo(a)pyrene = ND
 Benzo(b)fluoranthene = ND
 Benzo(k)fluoranthene = ND
 Chrysene = ND
 Dibenzo(a,h)anthracene = ND
 Fluoranthene = ND
 Fluorene = ND
 Indeno(1,2,3-CD)pyrene = ND
 Naphthalene = ND
 Pyrene = ND

WH-FS-01@6'
 03/31/22
 6'
 ND = <0.00067
 1-Methylnaphthalene = ND
 2-Methylnaphthalene = ND
 Acenaphthene = ND
 Anthracene = ND
 Benzo(a)anthracene = ND
 Benzo(a)pyrene = ND
 Benzo(b)fluoranthene = ND
 Benzo(k)fluoranthene = ND
 Chrysene = ND
 Dibenzo(a,h)anthracene = ND
 Fluoranthene = ND
 Fluorene = ND
 Indeno(1,2,3-CD)pyrene = ND
 Naphthalene = ND
 Pyrene = ND

WH-SS-01
 WH-SS-04
 WH-FS-01
 WH-SS-03
 WH-SS-02

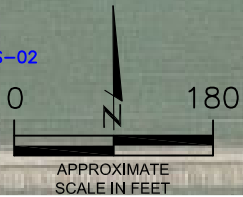

LEGEND

- - - - - WELLHEAD ASSESSMENT BOUNDARIES
- APPROXIMATE FLOWLINE LOCATION
- APPROXIMATE LOCATION OF SOIL SAMPLES FIELD SCREENED, ONLY, WITH PHOTOIONIZATION DETECTOR
- APPROXIMATE LOCATION OF SOIL SAMPLES SUBMITTED FOR LABORATORY ANALYSIS

PARAMETERS

SAMPLE LOCATION
 DATE SAMPLE COLLECTED
 APPROXIMATE DEPTH
 POLYCYCLIC AROMATIC HYDROCARBONS (PAHs) (mg/kg)

mg/kg = MILLIGRAMS PER KILOGRAM
 ND = NON-DETECT

NOTES:
 VALUES PRESENTED WITH A LESS THAN SYMBOL (<) DID NOT CONTAIN CONCENTRATIONS AT OR ABOVE LABORATORY DETECTION LIMITS.

VALUES PRESENTED IN **BOLD** EXCEED COGCC TABLE 915-1 REGULATORY LIMITS.
 COGCC = COLORADO OIL AND GAS CONSERVATION COMMISSION

POLYCYCLIC AROMATIC HYDROCARBONS MAP
 QC USX #A32-19
 CLOSURE ASSESSMENT
 40.446490 / -104.577610
 NE¼ NW¼ SEC.32 T6N R64W 6PM
 WELD COUNTY, COLORADO
 API # 05-123-32723
 REMEDIATION # 22326

DRAWN BY:
 CT

FIG. NO.
 4

EAGLE
 ENVIRONMENTAL
 CONSULTING, INC.
 8000 W 44th Ave, Wheat Ridge, CO 80033
 Ph: 303-433-0479 • F: 303-325-5449



TABLES

Table 1: Photoionization Detector Reading Summary

Table 2: Soil Analytical Results Summary

TABLE 1
PHOTOIONIZATION DETECTOR READING SUMMARY
QC USX #A32-19
CLOSURE ASSESSMENT
40.446490 / -104.577610
NE 1/4 NW 1/4 SEC.32 T6N R64W 6PM
WELD COUNTY, COLORADO
API # 05-123-32723
REMEDATION # 22326

Sample Location (Latitude/Longitude)	Date	Approximate Depth (feet)	PID Reading (ppm-v)	Lab Submission (Y/N)
WH-SS-01 @ 5' (40.446492 / -104.577618)	03/31/22	5	1.8	N
WH-SS-02 @ 5' (40.446480 / -104.577600)	03/31/22	5	2.7	N
WH-SS-03 @ 5' (40.446471 / -104.577615)	03/31/22	5	3.0	N
WH-SS-04 @ 5' (40.446483 / -104.577632)	03/31/22	5	1.7	N
WH-FS-01 @ 6' (40.446486 / -104.577616)	03/31/22	6	3.5	Y
FL-SS-01 @ 3' (40.449464 / -104.580932)	03/31/22	3	2.8	Y
(Y/N) = Yes or No ppm-v = parts per million by volume PID = Photoionization Detector				

TABLE 2
SOIL ANALYTICAL RESULTS SUMMARY
QC USX #A32-19
CLOSURE ASSESSMENT
40.446490 / -104.577610
NE 1/4 NW 1/4 SEC.32 T6N R64W 6PM
WELD COUNTY, COLORADO
API # 05-123-32723
REMEDATION # 22326

Sample Location		WH-FS-01 @ 6'		FL-SS-01 @ 3'	
(Latitude / Longitude)		(40.446486 / -104.577616)		(40.449464 / -104.580932)	
Sample Date		3/31/2022		3/31/2022	
Sample Depth		6'		3'	
PID Reading (ppm-v)		3.5		2.8	
Regulatory Limits					
Chemical of Concern	Units	COGCC Table 915-1 RSSLs	COGCC Table 915-1 GSSLs		
VOCs					
Benzene	mg/kg	1.2	0.0026	<0.00200	<0.00200
Toluene	mg/kg	490	0.69	<0.00200	<0.00200
Ethylbenzene	mg/kg	5.8	0.78	<0.00200	<0.00200
Total Xylenes	mg/kg	58	9.9	<0.00200	<0.00200
1,2,4-Trimethylbenzene	mg/kg	30	0.0081	<0.00200	<0.00200
1,3,5-Trimethylbenzene	mg/kg	27	0.0087	<0.00200	<0.00200
Total Petroleum Hydrocarbons					
TPH-GRO	mg/kg	500	--	<0.200	<0.200
TPH-DRO	mg/kg	500	--	<25.0	<25.0
TPH-RRO	mg/kg	500	--	<100	<100
Polycyclic Aromatics Hydrocarbons					
1-Methyl-naphthalene	mg/kg	18	0.006	<0.00067	<0.00067
2-Methyl-naphthalene	mg/kg	24	0.019	<0.00067	<0.00067
Acenaphthene	mg/kg	360	0.55	<0.00067	<0.00067
Anthracene	mg/kg	1800	5.8	<0.00067	<0.00067
Benzo(a)-anthracene	mg/kg	1.1	0.011	<0.00067	<0.00067
Benzo(a)-pyrene	mg/kg	0.11	0.24	<0.00067	<0.00067
Benzo(b)-fluoranthene	mg/kg	1.1	0.3	<0.00067	<0.00067
Benzo(k)-fluoranthene	mg/kg	11	2.9	<0.00067	<0.00067
Chrysene	mg/kg	110	9	<0.00067	<0.00067
Dibenzo(a,h)-anthracene	mg/kg	0.11	0.096	<0.00067	<0.00067
Fluoranthene	mg/kg	240	8.9	<0.00067	<0.00067
Fluorene	mg/kg	240	0.54	<0.00067	<0.00067
Indeno(1,2,3-cd)-pyrene	mg/kg	1.1	0.98	<0.00067	<0.00067
Naphthalene	mg/kg	2	0.0038	<0.00067	<0.00067
Pyrene	mg/kg	180	1.3	<0.00067	<0.00067
Soil Suitability (Inorganics)					
Boron	mg/L	2	--	0.393	0.120
pH	standard unit	6-8.3	--	7.81	8.23
Sodium Adsorption Ratio (SAR)	--	<6	--	1.33	0.482
Specific Conductance (EC)	mmhos/cm	<4	--	0.934	0.229
COGCC = Colorado Oil and Gas Conservation Commission mg/kg = milligrams per kilogram mmhos/cm = millimhos per centimeter PID = Photoionization Detector ppm-v = parts per million by volume mg/L = milligrams per liter SAR = Sodium Adsorption Ratio Notes: Values presented with a less than symbol (<) did not contain concentrations at or above the laboratory reporting limit and/or minimum detection limit Values presented in BOLD exceed COGCC Table 915-1 Regulatory Limits.					
			VOCs - Volatile Organic Compounds RSSLs = Residential Soil Screening Levels GSSLs = Protection of Groundwater Soil Screening Levels TPH-GRO = Total Petroleum Hydrocarbons - Gasoline Range Organics TPH-DRO = Total Petroleum Hydrocarbons - Diesel Range Organics TPH-RRO = Total Petroleum Hydrocarbons - Residual Range Organics		



ATTACHMENT A

Photo Log

QC USX #A32-19
API # 05-123-32723
Remediation # 22326

Closure Assessment

March 2022



EAGLE
ENVIRONMENTAL
CONSULTING, INC.
8000 W 44th Ave, Wheat Ridge, CO 80033
Ph: 303-433-0479 • F: 303-325-5449



Wellhead Excavation – 03/31/22

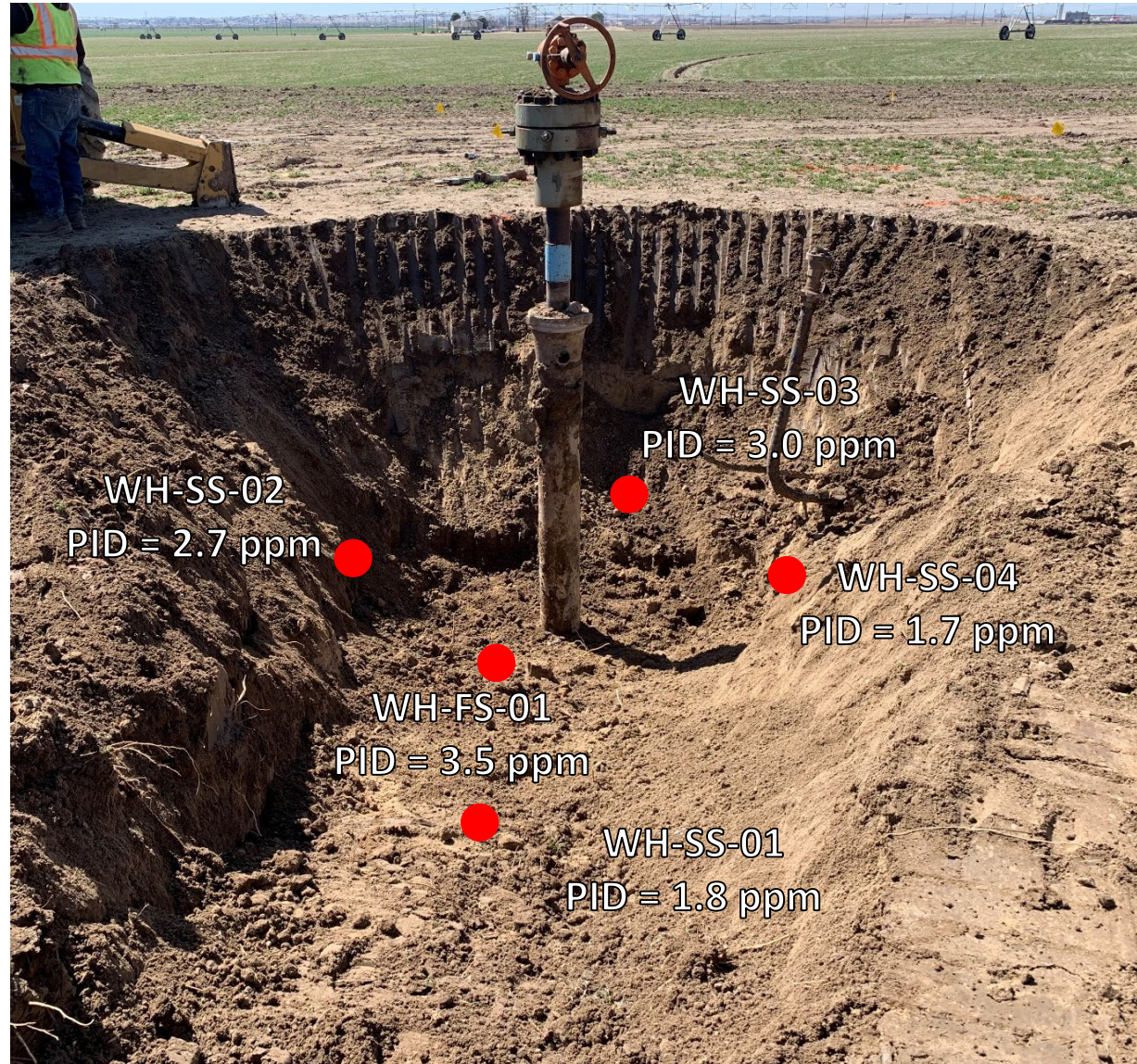

Looking south-southeast
No petroleum hydrocarbon staining or odor observed

Flowline Assessment – 03/31/22



Flowline abandoned in place. Pt. B (at separator) assessed
No petroleum hydrocarbon staining observed or odor observed



ATTACHMENT B

Laboratory Analytical Report



April 14, 2022

Eagle Environmental Consulting, Inc.

Martin C Eckert III

8000 W 44th Ave

Wheat Ridge CO 80033

Project Name - Noble - QC USX #A32-19

Project Number - [none]

Attached are your analytical results for Noble - QC USX #A32-19 received by Origins Laboratory, Inc. March 31, 2022. This project is associated with Origins project number Y203824-01.

The analytical results in the following report were analyzed under the guidelines of EPA Methods. These methods are identified as follows; "SW" are defined in SW-846, "EPA" are defined in 40CFR part 136 and "SM" are defined in the most current revision of Standard Methods For the Examination of Water and Wastewater.

The analytical results apply specifically to the samples and analyses specified per the attached Chain of Custody. As such, this report shall not be reproduced except in full, without the written approval of Origin's laboratory.

Unless otherwise noted, the analytical results for all soil samples are reported on a wet weight basis. All analytical analyses were performed under NELAP guidelines unless noted by a data qualifier.

Any holding time exceedances, deviations from the method specifications or deviations from Origins Laboratory's Standard Operating Procedures are outlined in the case narrative.

Thank you for selecting Origins for your analytical needs. Please contact us with any questions concerning this report, or if we can help with anything at all.

Origins Laboratory, Inc.
303.433.1322
o-squad@oelabinc.com



1725 Elk Place, Denver, CO 80211 | Phone: 303.433.1322 | Fax: 303.265.9645

Eagle Environmental Consulting, Inc.
8000 W 44th Ave
Wheat Ridge CO 80033

Martin C Eckert III
Project Number: [none]
Project: Noble - QC USX #A32-19

CROSS REFERENCE REPORT

Sample ID	Laboratory ID	Matrix	Date Sampled	Date Received
WH-FS-01@6'	Y203824-01	Soil	March 31, 2022 11:38	03/31/2022 15:21
FL-SS-01@3'	Y203824-02	Soil	March 31, 2022 11:51	03/31/2022 15:21

Origins Laboratory, Inc.



The results in this report apply to the samples analyzed in accordance with the chain of custody document. This analytical report must be reproduced in its entirety.

Eagle Environmental Consulting, Inc.
 8000 W 44th Ave
 Wheat Ridge CO 80033

Martin C Eckert III
 Project Number: [none]
 Project: Noble - QC USX #A32-19

Origins Laboratory

F-012207-01-R1
 Effective Date: 01/09/12

Sample Receipt Checklist

Origins Work Order: Y203824 Client: Eagle
 Client Project ID: QC USX A32-19
 Checklist Completed by: SG Shipped Via: HD
 Date/time completed: 3/31/22 (UPS, FedEx, Hand Delivered, Pick-up, etc.)
 Airbill #: N/A
 Matrix(s) Received: (Check all that apply): Soil/Solid Water Other: _____
 Cooler Number/Temperature: 1, 3.1 °C _____ °C _____ °C _____ °C (Describe)
 Thermometer ID: T004

Requirement Description	Yes	No	N/A	Comments (if any)
If samples require cooling, was the temperature between 0°C to ≤ 6°C ⁽¹⁾ ?	<input checked="" type="checkbox"/>			
Is there ice present (document if blue ice is used)	<input checked="" type="checkbox"/>			
Are custody seals present on cooler? (if so, document in comments if they are signed and dated, broken or intact)		<input checked="" type="checkbox"/>		
Are custody seals present on each sample container? (if so, document in comments if they are signed and dated, broken or intact)		<input checked="" type="checkbox"/>		
Were all samples received intact ⁽¹⁾ ?	<input checked="" type="checkbox"/>			
Was adequate sample volume provided ⁽¹⁾ ?	<input checked="" type="checkbox"/>			
Are short holding time analytes or samples with HTs due within 48 hours present ⁽¹⁾ ?		<input checked="" type="checkbox"/>		
Is a chain-of-custody (COC) present and filled out completely ⁽¹⁾ ?	<input checked="" type="checkbox"/>			
Does the COC agree with the number and type of sample bottles received ⁽¹⁾ ?	<input checked="" type="checkbox"/>			
Do the sample IDs on the bottle labels match the COC ⁽¹⁾ ?	<input checked="" type="checkbox"/>			
Is the COC properly relinquished by the client with date and time recorded ⁽¹⁾ ?	<input checked="" type="checkbox"/>			
For volatiles in water – is there headspace (> ¼ inch bubble) present? if yes, contact client and note in narrative.			<input checked="" type="checkbox"/>	
Are samples preserved that require preservation and was it checked ⁽¹⁾ ? (note ID of confirmation instrument used in comments) / (preservation is not confirmed for subcontracted analyses in order to insure sample integrity)/(pH <2 for samples preserved with HNO ₃ , HCL, H ₂ SO ₄) / (pH > 10 for samples preserved with NaAsO ₂ +NaOH, ZnAs+NaOH)			<input checked="" type="checkbox"/>	
Additional Comments (if any):				

⁽¹⁾If NO, then contact the client before proceeding with analysis and note date/time and person contacted as well as the corrective action to in the additional comments (above) and the case narrative.

JP
 Reviewed by (Project Manager)

4/1/22
 Date/Time Reviewed

Origins Laboratory, Inc.



The results in this report apply to the samples analyzed in accordance with the chain of custody document. This analytical report must be reproduced in its entirety.

Eagle Environmental Consulting, Inc.
 8000 W 44th Ave
 Wheat Ridge CO 80033

Martin C Eckert III
 Project Number: [none]
 Project: Noble - QC USX #A32-19

WH-FS-01@6'

3/31/2022 11:38:00AM

Analyte	Result	Min Detection Limit	Reporting Limit	Units	Dilution	Batch	Prepared	Analyzed	Notes
---------	--------	---------------------	-----------------	-------	----------	-------	----------	----------	-------

Origins Laboratory, Inc.
Y203824-01 (Soil)

Boron (DTPA Sorbitol)

Boron	0.393		0.0981	mg/L	1	B2D0110	04/01/2022	04/04/2022	
-------	-------	--	--------	------	---	---------	------------	------------	--

DRO/ORO by EPA 8015D

Diesel (C10-C28)	ND		25.0	mg/kg	1	B2D0103	04/01/2022	04/07/2022	U
Residual Range Organics (C28-C40)	ND		100	"	"	"	"	"	U

Surrogate: o-Terphenyl	84.0 %		50-150			"	"	"	
------------------------	--------	--	--------	--	--	---	---	---	--

GBTEX+TMBs by 8260D

1,2,4-Trimethylbenzene	ND		0.00200	mg/kg	1	B2D0509	04/05/2022	04/08/2022	U
1,3,5-Trimethylbenzene	ND		0.00200	"	"	"	"	"	U
Benzene	ND		0.00200	"	"	"	"	"	U
Ethylbenzene	ND		0.00200	"	"	"	"	"	U
Toluene	ND		0.00200	"	"	"	"	"	U
Xylenes, total	ND		0.00200	"	"	"	"	"	U
Gasoline Range Hydrocarbons	ND		0.200	"	"	"	"	"	U

Surrogate: 1,2-Dichloroethane-d4	110 %		70-130			"	"	"	
----------------------------------	-------	--	--------	--	--	---	---	---	--

Origins Laboratory, Inc.



The results in this report apply to the samples analyzed in accordance with the chain of custody document. This analytical report must be reproduced in its entirety.

Eagle Environmental Consulting, Inc.
 8000 W 44th Ave
 Wheat Ridge CO 80033

Martin C Eckert III
 Project Number: [none]
 Project: Noble - QC USX #A32-19

WH-FS-01@6'

3/31/2022 11:38:00AM

Analyte	Result	Min Detection Limit	Reporting Limit	Units	Dilution	Batch	Prepared	Analyzed	Notes
---------	--------	---------------------	-----------------	-------	----------	-------	----------	----------	-------

Origins Laboratory, Inc.
Y203824-01 (Soil)

GBTEX+TMBs by 8260D

Surrogate: Toluene-d8	95.0 %		70-130			B2D05 09	04/05/2022	04/08/2022	
Surrogate: 4-Bromofluorobenzene	99.2 %		70-130			"	"	"	

Metals by Saturated Paste by EPA 6010

Calcium	4.55		0.499	meq/L	10	[CALC]	04/01/2022	04/05/2022	
Magnesium	2.58		0.823	"	"	"	"	"	
Sodium	2.51		0.435	"	"	"	"	"	

PAH by 8270D SIM

1-Methylnaphthalene	ND	0.000364	0.00067	mg/Kg	1	L610087	04/11/2022	04/12/2022	
2-Methylnaphthalene	ND	0.000645	0.00067	"	"	"	"	"	
Acenaphthene	ND	0.000304	0.00067	"	"	"	"	"	
Anthracene	ND	0.000334	0.00067	"	"	"	"	"	
Benzo(a)anthracene	ND	0.000493	0.00067	"	"	"	"	"	
Benzo(a)pyrene	ND	0.000468	0.00067	"	"	"	"	"	
Benzo(b)fluoranthene	ND	0.000585	0.00067	"	"	"	"	"	
Benzo(k)fluoranthene	ND	0.000437	0.00067	"	"	"	"	"	
Chrysene	ND	0.000624	0.00067	"	"	"	"	"	
Dibenz(a,h)anthracene	ND	0.000614	0.00067	"	"	"	"	"	
Fluoranthene	ND	0.000394	0.00067	"	"	"	"	"	

Origins Laboratory, Inc.



The results in this report apply to the samples analyzed in accordance with the chain of custody document. This analytical report must be reproduced in its entirety.

Eagle Environmental Consulting, Inc.
 8000 W 44th Ave
 Wheat Ridge CO 80033

Martin C Eckert III
 Project Number: [none]
 Project: Noble - QC USX #A32-19

WH-FS-01@6'

3/31/2022 11:38:00AM

Analyte	Result	Min Detection Limit	Reporting Limit	Units	Dilution	Batch	Prepared	Analyzed	Notes
---------	--------	---------------------	-----------------	-------	----------	-------	----------	----------	-------

Waypoint Analytical, Inc.
Y203824-01 (Soil)

PAH by 8270D SIM

Fluorene	ND	0.000286	0.00067	mg/Kg	1	L610087	04/11/2022	04/12/2022	
Indeno(1,2,3-cd)pyrene	ND	0.000627	0.00067	"	"	"	"	"	
Naphthalene	ND	0.000484	0.00067	"	"	"	"	"	
Pyrene	ND	0.000643	0.00067	"	"	"	"	"	

Surrogate: 2-Fluorobiphenyl	45.7 %		33-115			"	"	"	
Surrogate: 4-Terphenyl-d14	58.5 %		33-122			"	"	"	
Surrogate: Nitrobenzene-d5	51.2 %		29-110			"	"	"	

pH in Soil by 9045D

pH	7.81			pH Units	1	B2D0408	04/04/2022	04/05/2022	
----	------	--	--	----------	---	---------	------------	------------	--

SAR by 20B Saturated Paste

SAR	1.33			SAR	1	B2D0109	04/01/2022	04/05/2022	
-----	------	--	--	-----	---	---------	------------	------------	--

Specific Conductance Mod. 9050A

Specific Conductance (EC)	0.934		0.00500	mmhos/cm	1	B2D0409	04/04/2022	04/05/2022	
---------------------------	-------	--	---------	----------	---	---------	------------	------------	--

Origins Laboratory, Inc.



The results in this report apply to the samples analyzed in accordance with the chain of custody document. This analytical report must be reproduced in its entirety.

Eagle Environmental Consulting, Inc.
 8000 W 44th Ave
 Wheat Ridge CO 80033

Martin C Eckert III
 Project Number: [none]
 Project: Noble - QC USX #A32-19

FL-SS-01@3'

3/31/2022 11:51:00AM

Analyte	Result	Min Detection Limit	Reporting Limit	Units	Dilution	Batch	Prepared	Analyzed	Notes
---------	--------	---------------------	-----------------	-------	----------	-------	----------	----------	-------

Origins Laboratory, Inc.
 Y203824-02 (Soil)

Boron (DTPA Sorbitol)

Boron	0.120		0.100	mg/L	1	B2D0110	04/01/2022	04/04/2022	
-------	-------	--	-------	------	---	---------	------------	------------	--

DRO/ORO by EPA 8015D

Diesel (C10-C28)	ND		25.0	mg/kg	1	B2D0103	04/01/2022	04/07/2022	U
Residual Range Organics (C28-C40)	ND		100	"	"	"	"	"	U

Surrogate: o-Terphenyl	90.3 %		50-150			"	"	"	
------------------------	--------	--	--------	--	--	---	---	---	--

GBTEX+TMBs by 8260D

1,2,4-Trimethylbenzene	ND		0.00200	mg/kg	1	B2D0509	04/05/2022	04/08/2022	U
1,3,5-Trimethylbenzene	ND		0.00200	"	"	"	"	"	U
Benzene	ND		0.00200	"	"	"	"	"	U
Ethylbenzene	ND		0.00200	"	"	"	"	"	U
Toluene	ND		0.00200	"	"	"	"	"	U
Xylenes, total	ND		0.00200	"	"	"	"	"	U
Gasoline Range Hydrocarbons	ND		0.200	"	"	"	"	"	U

Surrogate: 1,2-Dichloroethane-d4	110 %		70-130			"	"	"	
----------------------------------	-------	--	--------	--	--	---	---	---	--

Origins Laboratory, Inc.



The results in this report apply to the samples analyzed in accordance with the chain of custody document. This analytical report must be reproduced in its entirety.

Eagle Environmental Consulting, Inc.
 8000 W 44th Ave
 Wheat Ridge CO 80033

Martin C Eckert III
 Project Number: [none]
 Project: Noble - QC USX #A32-19

FL-SS-01@3'

3/31/2022 11:51:00AM

Analyte	Result	Min Detection Limit	Reporting Limit	Units	Dilution	Batch	Prepared	Analyzed	Notes
---------	--------	---------------------	-----------------	-------	----------	-------	----------	----------	-------

Origins Laboratory, Inc.
 Y203824-02 (Soil)

GBTEX+TMBs by 8260D

Surrogate: Toluene-d8	94.9 %		70-130			B2D05 09	04/05/2022	04/08/2022	
Surrogate: 4-Bromofluorobenzene	98.8 %		70-130			"	"	"	

Metals by Saturated Paste by EPA 6010

Calcium	1.34		0.499	meq/L	10	[CALC]	04/01/2022	04/05/2022	
Magnesium	ND		0.823	"	"	"	"	"	
Sodium	0.457		0.435	"	"	"	"	"	

PAH by 8270D SIM

1-Methylnaphthalene	ND	0.000364	0.00067	mg/Kg	1	L610087	04/11/2022	04/12/2022	
2-Methylnaphthalene	ND	0.000645	0.00067	"	"	"	"	"	
Acenaphthene	ND	0.000304	0.00067	"	"	"	"	"	
Anthracene	ND	0.000334	0.00067	"	"	"	"	"	
Benzo(a)anthracene	ND	0.000493	0.00067	"	"	"	"	"	
Benzo(a)pyrene	ND	0.000468	0.00067	"	"	"	"	"	
Benzo(b)fluoranthene	ND	0.000585	0.00067	"	"	"	"	"	
Benzo(k)fluoranthene	ND	0.000437	0.00067	"	"	"	"	"	
Chrysene	ND	0.000624	0.00067	"	"	"	"	"	
Dibenz(a,h)anthracene	ND	0.000614	0.00067	"	"	"	"	"	
Fluoranthene	ND	0.000394	0.00067	"	"	"	"	"	

Origins Laboratory, Inc.



The results in this report apply to the samples analyzed in accordance with the chain of custody document. This analytical report must be reproduced in its entirety.

Eagle Environmental Consulting, Inc.
 8000 W 44th Ave
 Wheat Ridge CO 80033

Martin C Eckert III
 Project Number: [none]
 Project: Noble - QC USX #A32-19

FL-SS-01@3'

3/31/2022 11:51:00AM

Analyte	Result	Min Detection Limit	Reporting Limit	Units	Dilution	Batch	Prepared	Analyzed	Notes
---------	--------	---------------------	-----------------	-------	----------	-------	----------	----------	-------

Waypoint Analytical, Inc.
Y203824-02 (Soil)

PAH by 8270D SIM

Fluorene	ND	0.000286	0.00067	mg/Kg	1	L610087	04/11/2022	04/12/2022	
Indeno(1,2,3-cd)pyrene	ND	0.000627	0.00067	"	"	"	"	"	
Naphthalene	ND	0.000484	0.00067	"	"	"	"	"	
Pyrene	ND	0.000643	0.00067	"	"	"	"	"	

Surrogate: 2-Fluorobiphenyl	44 %		33-115			"	"	"	
Surrogate: 4-Terphenyl-d14	61.5 %		33-122			"	"	"	
Surrogate: Nitrobenzene-d5	50.2 %		29-110			"	"	"	

pH in Soil by 9045D

pH	8.23			pH Units	1	B2D0408	04/04/2022	04/05/2022	
----	------	--	--	----------	---	---------	------------	------------	--

SAR by 20B Saturated Paste

SAR	0.482			SAR	1	B2D0109	04/01/2022	04/05/2022	
-----	-------	--	--	-----	---	---------	------------	------------	--

Specific Conductance Mod. 9050A

Specific Conductance (EC)	0.229		0.00500	mmhos/cm	1	B2D0409	04/04/2022	04/05/2022	
---------------------------	-------	--	---------	----------	---	---------	------------	------------	--

Origins Laboratory, Inc.



The results in this report apply to the samples analyzed in accordance with the chain of custody document. This analytical report must be reproduced in its entirety.

Eagle Environmental Consulting, Inc.
 8000 W 44th Ave
 Wheat Ridge CO 80033

Martin C Eckert III
 Project Number: [none]
 Project: Noble - QC USX #A32-19

Extractable Petroleum Hydrocarbons by 8015D - Quality Control
Origins Laboratory, Inc.

Analyte	Result	Reporting Limit	Units	Spike Level	Source Result	%REC	%REC Limits	RPD	RPD Limit	Notes
Batch B2D0103 - EPA 3550B										
Blank (B2D0103-BLK1)										
					Prepared: 04/01/2022 Analyzed: 04/07/2022					
Diesel (C10-C28)	ND	25.0	mg/kg							U
Residual Range Organics (C28-C40)	ND	100	"							U
Surrogate: o-Terphenyl	23		"	24.9		91.6	50-150			

Origins Laboratory, Inc.



The results in this report apply to the samples analyzed in accordance with the chain of custody document. This analytical report must be reproduced in its entirety.

Eagle Environmental Consulting, Inc.
 8000 W 44th Ave
 Wheat Ridge CO 80033

Martin C Eckert III
 Project Number: [none]
 Project: Noble - QC USX #A32-19

Extractable Petroleum Hydrocarbons by 8015D - Quality Control
Origins Laboratory, Inc.

Analyte	Result	Reporting Limit	Units	Spike Level	Source Result	%REC	%REC Limits	RPD	RPD Limit	Notes
---------	--------	-----------------	-------	-------------	---------------	------	-------------	-----	-----------	-------

Batch B2D0103 - EPA 3550B

LCS (B2D0103-BS1)

Prepared: 04/01/2022 Analyzed: 04/07/2022

Diesel (C10-C28)	878	50.0	mg/kg	1000		87.8	70-130			
Residual Range Organics (C28-C40)	1010	200	"	1000		101	70-130			
Surrogate: o-Terphenyl	53		"	49.8		107	50-150			

Origins Laboratory, Inc.



The results in this report apply to the samples analyzed in accordance with the chain of custody document. This analytical report must be reproduced in its entirety.

Eagle Environmental Consulting, Inc.
 8000 W 44th Ave
 Wheat Ridge CO 80033

Martin C Eckert III
 Project Number: [none]
 Project: Noble - QC USX #A32-19

Extractable Petroleum Hydrocarbons by 8015D - Quality Control
Origins Laboratory, Inc.

Analyte	Result	Reporting Limit	Units	Spike Level	Source Result	%REC	%REC Limits	RPD	RPD Limit	Notes
---------	--------	-----------------	-------	-------------	---------------	------	-------------	-----	-----------	-------

Batch B2D0103 - EPA 3550B

Matrix Spike (B2D0103-MS1)	Source: Y203818-01			Prepared: 04/01/2022 Analyzed: 04/07/2022						
Diesel (C10-C28)	884	50.0	mg/kg	1000	148	73.6	70-130			
Residual Range Organics (C28-C40)	869	200	"	1000	79.5	78.9	70-130			
Surrogate: o-Terphenyl	42		"	49.8		84.0	50-150			

Origins Laboratory, Inc.



The results in this report apply to the samples analyzed in accordance with the chain of custody document. This analytical report must be reproduced in its entirety.

Eagle Environmental Consulting, Inc.
 8000 W 44th Ave
 Wheat Ridge CO 80033

Martin C Eckert III
 Project Number: [none]
 Project: Noble - QC USX #A32-19

Extractable Petroleum Hydrocarbons by 8015D - Quality Control
Origins Laboratory, Inc.

Analyte	Result	Reporting Limit	Units	Spike Level	Source Result	%REC	%REC Limits	RPD	RPD Limit	Notes
---------	--------	-----------------	-------	-------------	---------------	------	-------------	-----	-----------	-------

Batch B2D0103 - EPA 3550B

Matrix Spike Dup (B2D0103-MSD1)	Source: Y203818-01			Prepared: 04/01/2022 Analyzed: 04/07/2022						
Diesel (C10-C28)	828	50.0	mg/kg	1000	148	68.0	70-130	6.51	35	QM-07
Residual Range Organics (C28-C40)	905	200	"	1000	79.5	82.6	70-130	4.11	35	
Surrogate: o-Terphenyl	49		"	49.8		98.1	50-150			

Origins Laboratory, Inc.



The results in this report apply to the samples analyzed in accordance with the chain of custody document. This analytical report must be reproduced in its entirety.

Eagle Environmental Consulting, Inc.
 8000 W 44th Ave
 Wheat Ridge CO 80033

Martin C Eckert III
 Project Number: [none]
 Project: Noble - QC USX #A32-19

Extractable Petroleum Hydrocarbons by 8015D - Quality Control
Origins Laboratory, Inc.

Analyte	Result	Reporting Limit	Units	Spike Level	Source Result	%REC	%REC Limits	RPD	RPD Limit	Notes
---------	--------	-----------------	-------	-------------	---------------	------	-------------	-----	-----------	-------

Batch B2D0509 - EPA 5030 (soil)

Blank (B2D0509-BLK1)

Prepared: 04/05/2022 Analyzed: 04/08/2022

1,2,4-Trimethylbenzene	ND	0.00200	mg/kg							U
1,3,5-Trimethylbenzene	ND	0.00200	"							U
Benzene	ND	0.00200	"							U
Ethylbenzene	ND	0.00200	"							U
Naphthalene	ND	0.0100	"							U
Toluene	ND	0.00200	"							U
Xylenes, total	ND	0.00200	"							U
Gasoline Range Hydrocarbons	ND	0.200	"							U
Surrogate: 1,2-Dichloroethane-d4	0.14		"	0.125	110		70-130			
Surrogate: Toluene-d8	0.12		"	0.125	95.6		70-130			
Surrogate: 4-Bromofluorobenzene	0.12		"	0.125	98.1		70-130			

Origins Laboratory, Inc.



The results in this report apply to the samples analyzed in accordance with the chain of custody document. This analytical report must be reproduced in its entirety.

Eagle Environmental Consulting, Inc.
 8000 W 44th Ave
 Wheat Ridge CO 80033

Martin C Eckert III
 Project Number: [none]
 Project: Noble - QC USX #A32-19

Volatile Organic Compounds by GC/MS SW846 8260D - Quality Control
Origins Laboratory, Inc.

Analyte	Result	Reporting Limit	Units	Spike Level	Source Result	%REC	%REC Limits	RPD	RPD Limit	Notes
---------	--------	-----------------	-------	-------------	---------------	------	-------------	-----	-----------	-------

Batch B2D0509 - EPA 5030 (soil)

LCS (B2D0509-BS1)

Prepared: 04/05/2022 Analyzed: 04/08/2022

1,2,4-Trimethylbenzene	0.105	0.00200	mg/kg	0.100		105	70-130			
1,3,5-Trimethylbenzene	0.104	0.00200	"	0.100		104	70-130			
Benzene	0.106	0.00200	"	0.100		106	70-130			
Ethylbenzene	0.0971	0.00200	"	0.100		97.1	70-130			
Naphthalene	0.114	0.0100	"	0.100		114	70-130			
Toluene	0.101	0.00200	"	0.100		101	70-130			
o-Xylene	0.103	0.00200	"	0.100		103	70-130			
m,p-Xylene	0.200	0.00400	"	0.200		100	70-130			
Surrogate: 1,2-Dichloroethane-d4	0.14		"	0.125		109	70-130			
Surrogate: Toluene-d8	0.12		"	0.125		98.0	70-130			
Surrogate: 4-Bromofluorobenzene	0.12		"	0.125		99.6	70-130			

Origins Laboratory, Inc.



The results in this report apply to the samples analyzed in accordance with the chain of custody document. This analytical report must be reproduced in its entirety.

Eagle Environmental Consulting, Inc.
 8000 W 44th Ave
 Wheat Ridge CO 80033

Martin C Eckert III
 Project Number: [none]
 Project: Noble - QC USX #A32-19

Volatile Organic Compounds by GC/MS SW846 8260D - Quality Control
Origins Laboratory, Inc.

Analyte	Result	Reporting Limit	Units	Spike Level	Source Result	%REC	%REC Limits	RPD	RPD Limit	Notes
---------	--------	-----------------	-------	-------------	---------------	------	-------------	-----	-----------	-------

Batch B2D0509 - EPA 5030 (soil)

Matrix Spike (B2D0509-MS1)	Source: Y203824-01			Prepared: 04/05/2022 Analyzed: 04/08/2022						
1,2,4-Trimethylbenzene	0.117	0.00200	mg/kg	0.100	ND	117	70-130			
1,3,5-Trimethylbenzene	0.117	0.00200	"	0.100	ND	117	70-130			
Benzene	0.115	0.00200	"	0.100	ND	115	70-130			
Ethylbenzene	0.108	0.00200	"	0.100	ND	108	70-130			
Naphthalene	0.100	0.0100	"	0.100	ND	100	70-130			
Toluene	0.109	0.00200	"	0.100	ND	109	70-130			
o-Xylene	0.113	0.00200	"	0.100	ND	113	70-130			
m,p-Xylene	0.227	0.00400	"	0.200	ND	113	70-130			
Surrogate: 1,2-Dichloroethane-d4	0.13		"	0.125		105	70-130			
Surrogate: Toluene-d8	0.12		"	0.125		97.6	70-130			
Surrogate: 4-Bromofluorobenzene	0.12		"	0.125		98.8	70-130			

Origins Laboratory, Inc.



The results in this report apply to the samples analyzed in accordance with the chain of custody document. This analytical report must be reproduced in its entirety.

Eagle Environmental Consulting, Inc.
 8000 W 44th Ave
 Wheat Ridge CO 80033

Martin C Eckert III
 Project Number: [none]
 Project: Noble - QC USX #A32-19

Volatile Organic Compounds by GC/MS SW846 8260D - Quality Control
Origins Laboratory, Inc.

Analyte	Result	Reporting Limit	Units	Spike Level	Source Result	%REC	%REC Limits	RPD	RPD Limit	Notes
---------	--------	-----------------	-------	-------------	---------------	------	-------------	-----	-----------	-------

Batch B2D0509 - EPA 5030 (soil)

Matrix Spike Dup (B2D0509-MSD1)	Source: Y203824-01			Prepared: 04/05/2022 Analyzed: 04/08/2022						
1,2,4-Trimethylbenzene	0.109	0.00200	mg/kg	0.100	ND	109	70-130	7.06	20	
1,3,5-Trimethylbenzene	0.108	0.00200	"	0.100	ND	108	70-130	8.24	20	
Benzene	0.107	0.00200	"	0.100	ND	107	70-130	6.81	20	
Ethylbenzene	0.101	0.00200	"	0.100	ND	101	70-130	7.04	20	
Naphthalene	0.108	0.0100	"	0.100	ND	108	70-130	7.93	20	
Toluene	0.102	0.00200	"	0.100	ND	102	70-130	6.26	20	
o-Xylene	0.106	0.00200	"	0.100	ND	106	70-130	6.11	20	
m,p-Xylene	0.208	0.00400	"	0.200	ND	104	70-130	8.54	20	
Surrogate: 1,2-Dichloroethane-d4	0.13		"	0.125		104	70-130			
Surrogate: Toluene-d8	0.12		"	0.125		98.0	70-130			
Surrogate: 4-Bromofluorobenzene	0.13		"	0.125		100	70-130			

Origins Laboratory, Inc.



The results in this report apply to the samples analyzed in accordance with the chain of custody document. This analytical report must be reproduced in its entirety.

Eagle Environmental Consulting, Inc.
 8000 W 44th Ave
 Wheat Ridge CO 80033

Martin C Eckert III
 Project Number: [none]
 Project: Noble - QC USX #A32-19

Volatile Organic Compounds by GC/MS SW846 8260D - Quality Control
Origins Laboratory, Inc.

Analyte	Result	Reporting Limit	Units	Spike Level	Source Result	%REC	%REC Limits	RPD	RPD Limit	Notes
---------	--------	-----------------	-------	-------------	---------------	------	-------------	-----	-----------	-------

Saturated Paste - Quality Control
Origins Laboratory, Inc.

Analyte	Result	Reporting Limit	Units	Spike Level	Source Result	%REC	%REC Limits	RPD	RPD Limit	Notes
---------	--------	-----------------	-------	-------------	---------------	------	-------------	-----	-----------	-------

Batch B2D0408 - NO PREP

Duplicate (B2D0408-DUP1)

Source: Y203806-04

Prepared: 04/04/2022 Analyzed: 04/05/2022

pH	7.90		pH Units		7.93			0.379	25	
----	------	--	----------	--	------	--	--	-------	----	--

Batch B2D0409 - NO PREP

Blank (B2D0409-BLK1)

Prepared: 04/04/2022 Analyzed: 04/05/2022

Specific Conductance (EC)	0.000800	0.00500	mmhos/cm							
---------------------------	----------	---------	----------	--	--	--	--	--	--	--

Duplicate (B2D0409-DUP1)

Source: Y203806-04

Prepared: 04/04/2022 Analyzed: 04/05/2022

Specific Conductance (EC)	0.622	0.00500	mmhos/cm		0.634			1.85	25	
---------------------------	-------	---------	----------	--	-------	--	--	------	----	--

Origins Laboratory, Inc.



The results in this report apply to the samples analyzed in accordance with the chain of custody document. This analytical report must be reproduced in its entirety.

Eagle Environmental Consulting, Inc.
 8000 W 44th Ave
 Wheat Ridge CO 80033

Martin C Eckert III
 Project Number: [none]
 Project: Noble - QC USX #A32-19

PAH by 8270D SIM - Quality Control
Waypoint Analytical, Inc.

Analyte	Result	Reporting Limit	Units	Spike Level	Source Result	%REC	%REC Limits	RPD	RPD Limit	Notes
---------	--------	-----------------	-------	-------------	---------------	------	-------------	-----	-----------	-------

Batch L610087 - 3550B

MSD (L 89927-MSD-L610087)		Source: 89927			Prepared: 04/11/2022 Analyzed: 04/12/2022					
Benzo(a)pyrene	0.00368	0.000468	mg/Kg	0.164	<0.000468	2.2	30-130	187	30	*
1-Methylnaphthalene	0.00233	0.000364	"	0.164	<0.000364	1.4	30-130	190	30	*
2-Methylnaphthalene	0.00241	0.000645	"	0.164	<0.000645	1.4	30-130	189	30	*
Acenaphthene	0.00216	0.000304	"	0.164	<0.000304	1.3	30-130	191	30	*
Naphthalene	0.00203	0.000484	"	0.164	<0.000484	1.2	30-130	191	30	*
Benzo(a)anthracene	0.00302	0.000493	"	0.164	<0.000493	1.8	30-130	189	30	*
Indeno(1,2,3-cd)pyrene	0.00285	0.000627	"	0.164	<0.000627	1.7	30-130	189	30	*
Fluorene	0.00254	0.000286	"	0.164	<0.000286	1.5	30-130	190	30	*
Fluoranthene	0.00264	0.000394	"	0.164	<0.000394	1.6	30-130	190	30	*
Dibenz(a,h)anthracene	0.00322	0.000614	"	0.164	<0.000614	1.9	30-130	188	30	*
Chrysene	0.00372	0.000624	"	0.164	<0.000624	2.2	30-130	186	30	*
Benzo(k)fluoranthene	0.00294	0.000437	"	0.164	<0.000437	1.7	30-130	188	30	*
Benzo(b)fluoranthene	0.00252	0.000585	"	0.164	<0.000585	1.5	30-130	190	30	*
Anthracene	0.00228	0.000334	"	0.164	<0.000334	1.3	30-130	191	30	*
Pyrene	0.00293	0.000643	"	0.164	<0.000643	1.7	30-130	189	30	*
Surrogate: 2-Fluorobiphenyl	43.5		"	0.328	154	43.5	33-115			
Surrogate: 4-Terphenyl-d14	57.9		"	0.328	208	57.9	33-122			
Surrogate: Nitrobenzene-d5	48.1		"	0.328	174	48.1	29-110			

MS (L 89927-MS-L610087)		Source: 89927			Prepared: 04/11/2022 Analyzed: 04/12/2022					
Benzo(a)anthracene	0.11	0.000493	mg/Kg	0.164	<0.000493	67	30-130			
Chrysene	0.106	0.000624	"	0.164	<0.000624	64.6	30-130			
Pyrene	0.105	0.000643	"	0.164	<0.000643	64	30-130			
Naphthalene	0.0886	0.000484	"	0.164	<0.000484	54	30-130			
Indeno(1,2,3-cd)pyrene	0.103	0.000627	"	0.164	<0.000627	62.8	30-130			
Fluorene	0.0998	0.000286	"	0.164	<0.000286	60.8	30-130			
Fluoranthene	0.106	0.000394	"	0.164	<0.000394	64.6	30-130			

Origins Laboratory, Inc.



The results in this report apply to the samples analyzed in accordance with the chain of custody document. This analytical report must be reproduced in its entirety.

Eagle Environmental Consulting, Inc.
 8000 W 44th Ave
 Wheat Ridge CO 80033

Martin C Eckert III
 Project Number: [none]
 Project: Noble - QC USX #A32-19

PAH by 8270D SIM - Quality Control
Waypoint Analytical, Inc.

Analyte	Result	Reporting Limit	Units	Spike Level	Source Result	%REC	%REC Limits	RPD	RPD Limit	Notes
---------	--------	-----------------	-------	-------------	---------------	------	-------------	-----	-----------	-------

Batch L610087 - 3550B

MS (L 89927-MS-L610087)	Source: 89927		Prepared: 04/11/2022 Analyzed: 04/12/2022							
Dibenz(a,h)anthracene	0.107	0.000614	mg/Kg	0.164	<0.000614	65.2	30-130			
Benzo(a)pyrene	0.109	0.000468	"	0.164	<0.000468	66.4	30-130			
Anthracene	0.0994	0.000334	"	0.164	<0.000334	60.6	30-130			
Acenaphthene	0.0916	0.000304	"	0.164	<0.000304	55.8	30-130			
2-Methylnaphthalene	0.0873	0.000645	"	0.164	<0.000645	53.2	30-130			
Benzo(k)fluoranthene	0.099	0.000437	"	0.164	<0.000437	60.3	30-130			
Benzo(b)fluoranthene	0.0945	0.000585	"	0.164	<0.000585	57.6	30-130			
1-Methylnaphthalene	0.0869	0.000364	"	0.164	<0.000364	52.9	30-130			
Surrogate: Nitrobenzene-d5	53.9		"	0.328	174	53.9	29-110			
Surrogate: 2-Fluorobiphenyl	47.2		"	0.328	154	47.2	33-115			
Surrogate: 4-Terphenyl-d14	63.1		"	0.328	208	63.1	33-122			

LCS (LCS-L610087)	Prepared: 04/11/2022 Analyzed: 04/12/2022									
Dibenz(a,h)anthracene	0.0975	0.000614	mg/Kg	0.167		58.3	30-130			
Fluoranthene	0.0966	0.000394	"	0.167		57.8	30-130			
Fluorene	0.0897	0.000286	"	0.167		53.7	30-130			
Pyrene	0.096	0.000643	"	0.167		57.4	30-130			
Indeno(1,2,3-cd)pyrene	0.0895	0.000627	"	0.167		53.5	30-130			
2-Methylnaphthalene	0.0812	0.000645	"	0.167		48.6	30-130			
Chrysene	0.0941	0.000624	"	0.167		56.3	30-130			
Naphthalene	0.0822	0.000484	"	0.167		49.2	30-130			
Benzo(b)fluoranthene	0.0858	0.000585	"	0.167		51.3	30-130			
Benzo(a)pyrene	0.0955	0.000468	"	0.167		57.1	30-130			
Benzo(a)anthracene	0.0982	0.000493	"	0.167		58.8	30-130			
Anthracene	0.0934	0.000334	"	0.167		55.9	30-130			
1-Methylnaphthalene	0.0822	0.000364	"	0.167		49.2	30-130			
Acenaphthene	0.085	0.000304	"	0.167		50.8	30-130			

Origins Laboratory, Inc.



The results in this report apply to the samples analyzed in accordance with the chain of custody document. This analytical report must be reproduced in its entirety.

Eagle Environmental Consulting, Inc.
 8000 W 44th Ave
 Wheat Ridge CO 80033

Martin C Eckert III
 Project Number: [none]
 Project: Noble - QC USX #A32-19

PAH by 8270D SIM - Quality Control
Waypoint Analytical, Inc.

Analyte	Result	Reporting Limit	Units	Spike Level	Source Result	%REC	%REC Limits	RPD	RPD Limit	Notes
---------	--------	-----------------	-------	-------------	---------------	------	-------------	-----	-----------	-------

Batch L610087 - 3550B

LCS (LCS-L610087)

Prepared: 04/11/2022 Analyzed: 04/12/2022

Benzo(k)fluoranthene	0.0971	0.000437	mg/Kg	0.167		58.1	30-130			
Surrogate: Nitrobenzene-d5	58.2		"	0.333		58.2	29-110			
Surrogate: 4-Terphenyl-d14	68.4		"	0.333		68.4	33-122			
Surrogate: 2-Fluorobiphenyl	52.5		"	0.333		52.5	33-115			

LRB (LRB-L610087)

Prepared: 04/11/2022 Analyzed: 04/12/2022

Chrysene	ND	0.00067	mg/Kg				-			
Dibenz(a,h)anthracene	ND	0.00067	"				-			
Fluoranthene	ND	0.00067	"				-			
Fluorene	ND	0.00067	"				-			
Benzo(k)fluoranthene	ND	0.00067	"				-			
Naphthalene	ND	0.00067	"				-			
Indeno(1,2,3-cd)pyrene	ND	0.00067	"				-			
Benzo(b)fluoranthene	ND	0.00067	"				-			
Benzo(a)pyrene	ND	0.00067	"				-			
Benzo(a)anthracene	ND	0.00067	"				-			
Acenaphthene	ND	0.00067	"				-			
2-Methylnaphthalene	ND	0.00067	"				-			
1-Methylnaphthalene	ND	0.00067	"				-			
Pyrene	ND	0.00067	"				-			
Anthracene	ND	0.00067	"				-			
Surrogate: Nitrobenzene-d5	48.6		"	0.333		48.6	29-110			
Surrogate: 4-Terphenyl-d14	55.5		"	0.333		55.5	33-122			
Surrogate: 2-Fluorobiphenyl	45		"	0.333		45	33-115			

Origins Laboratory, Inc.



The results in this report apply to the samples analyzed in accordance with the chain of custody document. This analytical report must be reproduced in its entirety.

Eagle Environmental Consulting, Inc.
8000 W 44th Ave
Wheat Ridge CO 80033

Martin C Eckert III
Project Number: [none]
Project: Noble - QC USX #A32-19

Notes and Definitions

U Sample is Non-Detect.

QM-07 The spike recovery was outside acceptance limits for the MS and/or MSD. The batch was accepted based on acceptable LCS recovery.

* QC Failure

ND Analyte NOT DETECTED at or above the reporting limit

RPD Relative Percent Difference

All soil results are reported on a wet weight basis.

Origins Laboratory, Inc.



The results in this report apply to the samples analyzed in accordance with the chain of custody document. This analytical report must be reproduced in its entirety.