

Wellhead Closure Checklist

Additional Attachments (Optional)	Flowline Closure
Well Name	Berry 1
Remediation Project #	
Date	10/17/2022
Wellhead Information	
Client	Occidental Petroleum
Weather	52, Sunny
Field Personnel	MDB
Location	
Latitude	40.24369
Longitude	-104.9086
General Condition of Site	Good
USCS Soil Type	Clay Loam / Clay Loam
Estimated Depth to Groundwater	<20'
Hydrocarbon Impacted Soils / Spills	HC impacted soils observed at wellhead
Salt Crusted Soils or Impacted Vegetation	None observed

Soil Samples							
#	Sample Date	Sample Time	Soil Sample ID	PID Readings	Visual	Olfactory	Equipment Name
R1	10/17/2022	10:13 AM	WHS-N01@3"	0.7	N.S	N.O	wellhead
R2	10/17/2022	10:15 AM	WHS-S01@3"	22.4	N.S	Slight HC Odor	wellhead
R3	10/17/2022	10:17 AM	WHS-E01@3"	1.6	N.S	N.O	wellhead
R4	10/17/2022	10:18 AM	WHS-W01@3"	0.9	N.S	N.O	wellhead
R5	10/17/2022	10:19 AM	WH-BG01@3'	1.4	N.S	N.O	wellhead
R6	10/17/2022	10:21 AM	WH-BG01@6'	1.1	N.S	N.O	wellhead
R7	10/17/2022	11:46 AM	WH-B01@6'	1087	HC staining	Strong HC odor	wellhead
R8	10/17/2022	11:49 AM	FL-B01@4'	26.7	N.S	N.O	wellhead
R9	10/17/2022	11:50 AM	WH-N01@5'	148.1	Slight HC staining	slight HC odor	wellhead
R10	10/17/	11:52 AM	WH-S01@5'	410.8	slight HC	Strong HC	wellhead

#	Sample Date	Sample Time	Soil Sample ID	PID Readings	Visual	Olfactory	Equipment Name
	2022				staining	odor	
R11	10/17/2022	11:53 AM	WH-E01@5'	34.5	N.S	N.O	wellhead
R12	10/17/2022	11:54 AM	WH-W01@5'	50.3	N.S	Slight HC odor	wellhead
R13	10/17/2022	11:55 AM	WH-BG02@3'	7.5	N.S	N.O	wellhead
R14	10/17/2022	11:56 AM	WH-BG02@6'	6.1	N.S	N.O	wellhead
R15	10/17/2022	11:57 AM	WH-BG03@3'	5.2	N.S	N.O	wellhead
R16	10/17/2022	11:57 AM	WH-BG03@6'	4.5	N.S	N.O	wellhead
R17	11/07/2022	01:43 PM	FL-B02@3'	0.8	N.S	N.O	Flowline at Separator
R18	01/09/2024	09:15 AM	FL-B03 @ 4'	0.4	NS	NO	Flowline
R19	01/09/2024	09:45 AM	FL-B04 @ 4'	0.4	NS	NO	Flowline
R20	01/09/2024	10:10 AM	FL-B05 @ 4'	0.3	NS	NO	Flowline
R21	01/09/2024	10:40 AM	FL-B06 @ 4'	2.3	NS	NO	Flowline
R22	01/09/2024	11:15 AM	FL-B07 @ 4'	0.8	NS	NO	Flowline
R23	01/09/2024	12:30 PM	FL-B08 @ 4'	0.2	NS	NO	Flowline directional change
R24	01/09/2024	01:00 PM	FL-B09 @ 4'	1.1	NS	NO	Flowline
R25	01/09/2024	01:30 PM	FL-B10 @ 4'	1.2	NS	NO	Flowline directional change
R26	01/09/2024	01:50 PM	FL-B11 @ 4'	0.3	NS	NO	Flowline
R27	01/09/2024	02:10 PM	FL-B12 @ 4'	1.0	NS	NO	Flowline directional change
R28	01/09/2024	02:25 PM	FL-B13 @ 4'	0.8	NS	NO	Flowline
R29	01/10/2024	01:20 PM	FL-B14@4'	0.7	N/S	N/O	Flowline
R30	01/10/2024	01:35 PM	FL-B15@4'	1.2	N/S	N/O	Flowline
R31	01/10/2024	01:50 PM	FL-B16@4'	1.0	N/S	N/O	Flowline
R32	01/10/2024	02:15 PM	FL-B17@4'	0.8	N/S	N/O	Flowline
R33	01/10/	02:30 PM	FL-B18@4'	1.2	N/S	N/O	Flowline

#	Sample Date	Sample Time	Soil Sample ID	PID Readings	Visual	Olfactory	Equipment Name
	2024						
R34	01/10/2024	02:50 PM	FL-B19@4'	0.9	N/S	N/O	Flowline
R35	01/19/2024	09:40 AM	WH-B01-01@6'	51.5	HC Staining	HC Odor	Wellhead
R36	01/19/2024	10:00 AM	WH-S01-01@5'	0.5	N/S	N/O	Wellhead
R37	01/19/2024	10:20 AM	WH-W01-01@5'	0.4	N/S	N/O	Wellhead
R38	01/19/2024	11:00 AM	FL-B20@4'	1.1	N/S	N/O	Flowline
R39	01/19/2024	11:30 AM	FL-B21@4'	0.6	N/S	N/O	Flowline
R40	01/19/2024	12:00 PM	FL-B22@4'	0.8	N/S	N/O	Flowline
R41	01/19/2024	01:00 PM	FL-B08-01@4'	0.4	N/S	N/O	Flowline
R42	01/19/2024	01:20 PM	FL-B10-01@4'	0.3	N/S	N/O	Flowline
R43	01/19/2024	01:30 PM	FL-B12-01@4'	0.5	N/S	N/O	Flowline
R44	01/19/2024	02:00 PM	FL-BG01@4'	0.2	N/S	N/O	Background
R45	01/19/2024	02:20 PM	FL-BG02@4'	0.1	N/S	N/O	Background
R46	01/19/2024	02:40 PM	FL-BG03@4'	0.2	N/S	N/O	Background
R47	01/19/2024	02:50 PM	FL-BG04@4'	0.4	N/S	N/O	Background
R48	01/19/2024	03:00 PM	FL-BG05@4'	0.3	N/S	N/O	Background
R49	02/08/2024	09:40 AM	FL-B21-01@4'	0.6	N/S	N/O	Flowline

Photo(s)

R1 - P1



Looking northwest

R2 - P1



Looking southeast

R3 - P1



Looking west

R5 - P1



Looking northeast

R13 - P1



Looking north

R17 - P1



Looking South

R18 - P1



Looking south

R19 - P1



Looking south

R20 - P1



Looking south

R21 - P1

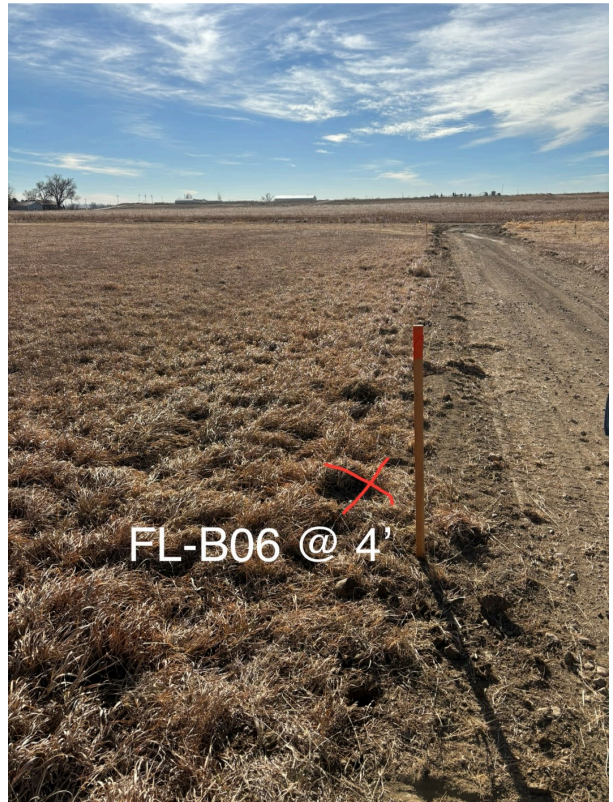

Looking south

R22 - P1



Looking south

R23 - P1



Looking SE

R24 - P1

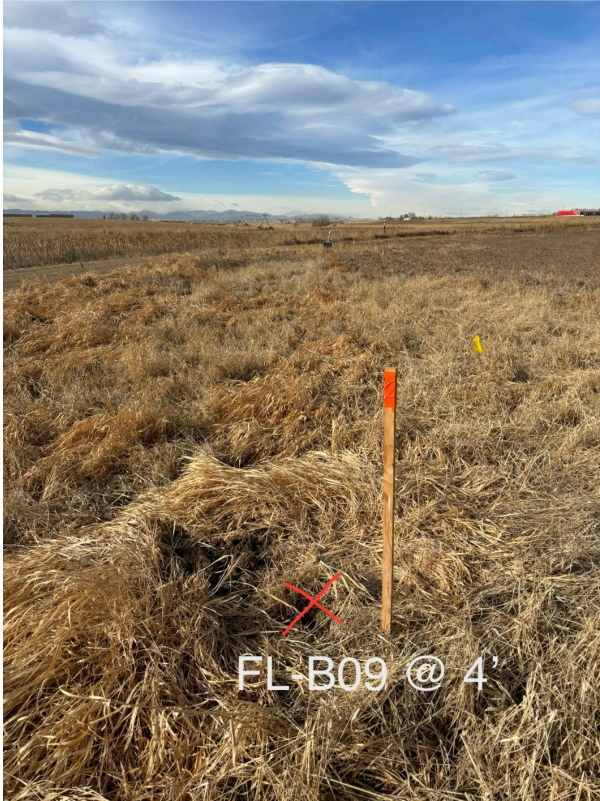

Looking NW

R25 - P1



Looking north

R26 - P1



Looking north

R27 - P1



Looking north

R28 - P1



Looking north

R29 - P1

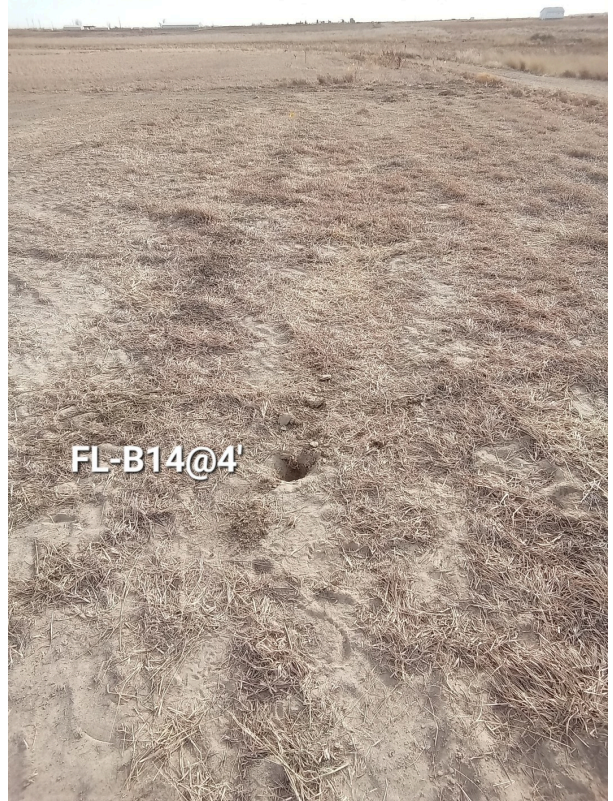

Looking south

R30 - P1



Looking south

R31 - P1



Looking south

R32 - P1



Looking south

R33 - P1



Looking south

R34 - P1

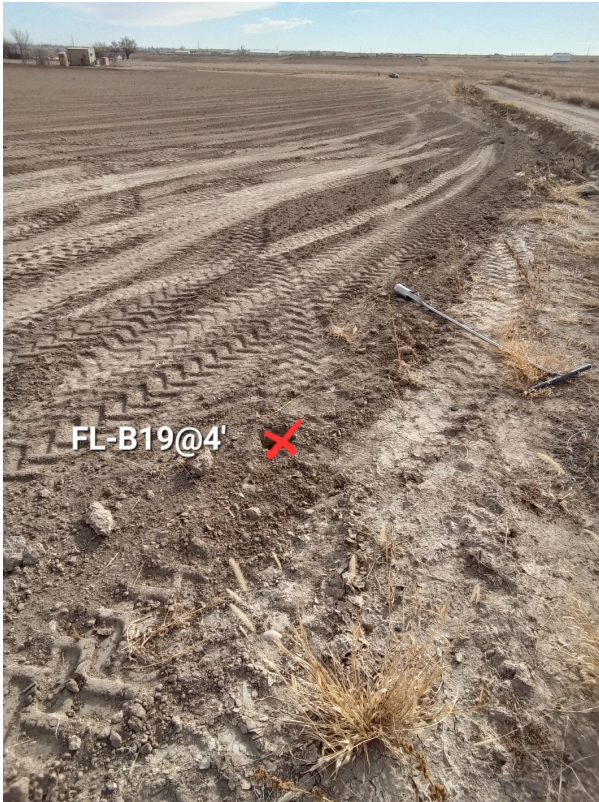

Looking south

R35 - P1



Looking east

R36 - P1



Looking north

R37 - P1



Looking east

R38 - P1



Looking south

R39 - P1



Looking north

R40 - P1



Looking east

R41 - P1



Looking south

R42 - P1



Looking north

R43 - P1



Looking north

R44 - P1



Looking south

R45 - P1



Looking east

R46 - P1



Looking east

R47 - P1



Looking east

R48 - P1



Looking north

R49 - P1



Facing East

Other observations regarding wellheads

Summary

Was impacted soil identified?	Yes - less than 10 cubic yards
-------------------------------	--------------------------------

Total number of soil samples field screened	49
---	----

Total number of soil samples collected	49
--	----

Highest PID Reading	1087
---------------------	------

Total number of soil samples submitted to lab for analysis	37
--	----

Was groundwater encountered during the investigation?	No
---	----

Measured depth to groundwater	
-------------------------------	--

Was remedial groundwater removal conducted?	
---	--

Date Groundwater was encountered	
----------------------------------	--

Commencement date of removal	
------------------------------	--

Seen on groundwater?	
----------------------	--

Free product observed?	
------------------------	--

Volume of groundwater removed prior to sampling	
---	--

Volume of groundwater removed post sampling	
---	--

Total volume of groundwater removed	
-------------------------------------	--

Total number of groundwater samples collected	
---	--

Total number of groundwater samples submitted to lab for analysis	
---	--