

Inspection Photos

08/21/2024

Operator: QUICKSILVER RESOURCES INC
10255

Location ID: 313181

Inspection Doc: 696206202

Moffat County, CO

Aaron Trujillo
Reclamation Work Lead
ECMC



COLORADO

**Energy & Carbon Management
Commission**

Department of Natural Resources

Inspection Photos

Operator Name: QUICKSILVER RESOURCES INC 10255

Location ID: 313181



Photo 1: Photos 1-2 taken from the east end of the Location. Photos provide an overview of the Location from south, southwest, northwest to north.



COLORADO

**Energy & Carbon Management
Commission**

Department of Natural Resources

Inspection Photos

Operator Name: QUICKSILVER RESOURCES INC 10255

Location ID: 313181



Photo 2: See comments under photo 1.



COLORADO

**Energy & Carbon Management
Commission**

Department of Natural Resources

Inspection Photos

Operator Name: QUICKSILVER RESOURCES INC 10255

Location ID: 313181



Photo 3: Photo shows utility equipment on, and leading to, the Location has not been removed.



COLORADO

**Energy & Carbon Management
Commission**

Department of Natural Resources

Inspection Photos

Operator Name: QUICKSILVER RESOURCES INC 10255

Location ID: 313181



Photo 4: Photo example showing noxious weeds (Scotch thistle) established on the Location.



COLORADO

**Energy & Carbon Management
Commission**

Department of Natural Resources

Inspection Photos

Operator Name: QUICKSILVER RESOURCES INC 10255

Location ID: 313181



Photo 5: Photos 5-7 show access road has not been reclaimed in accordance with 1004 Rules- culverts remaining. Gravel has not been removed; road has not been decompacted, recontoured/regraded and reclaimed.



COLORADO

**Energy & Carbon Management
Commission**

Department of Natural Resources

Inspection Photos

Operator Name: QUICKSILVER RESOURCES INC 10255

Location ID: 313181



Photo 6: See comments under photo 5.



COLORADO

**Energy & Carbon Management
Commission**

Department of Natural Resources

Inspection Photos

Operator Name: QUICKSILVER RESOURCES INC 10255

Location ID: 313181



Photo 7: See comments under photo 5.



COLORADO

**Energy & Carbon Management
Commission**

Department of Natural Resources

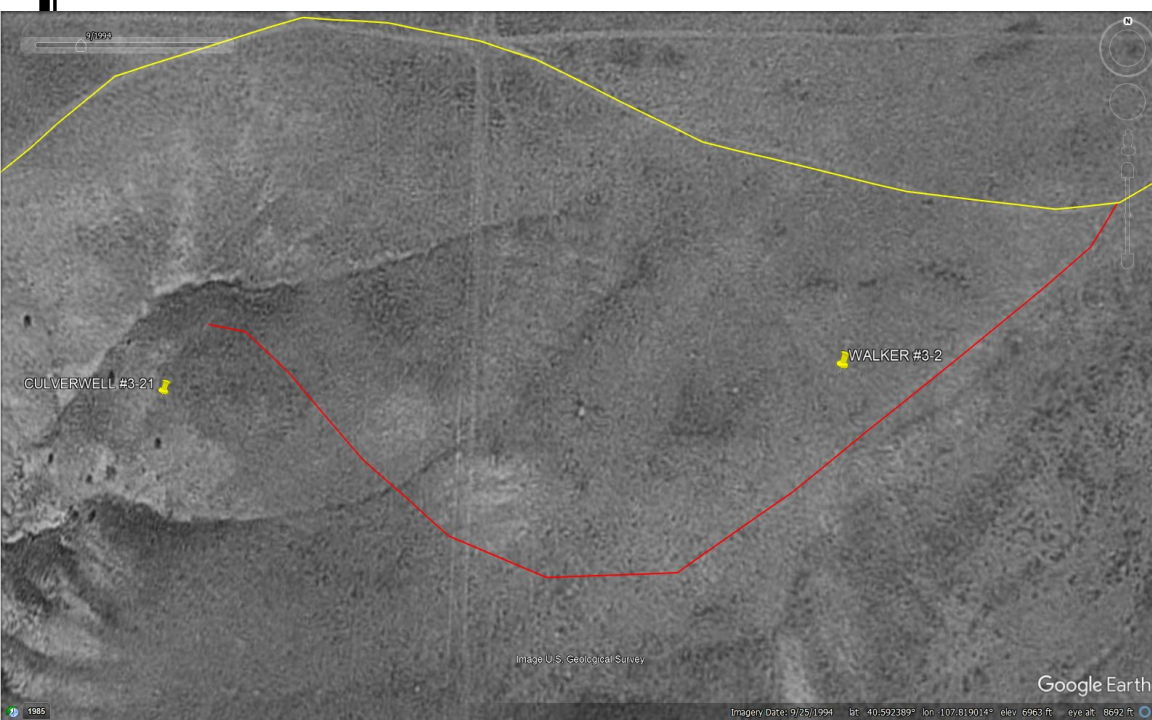

Photo 8: Google earth aerial imagery. Top photo dated 2023; bottom 1994. Yellow lines represent access roads that existed prior to Oil and Gas disturbances. Red lines represent access roads constructed to Oil and Gas Locations subject to 1004 final reclamation requirements. Access road to the CULVERWELL #3-21 did not pre-exist the Location.