

HYDROLOGY MAP TULIP WELL PAD HORIZONTAL MULTI-WELL PAD

NW1/4 NE1/4 SECTION 30, TOWNSHIP 4 NORTH, RANGE 67 WEST, 6TH P.M., WELD COUNTY, COLORADO

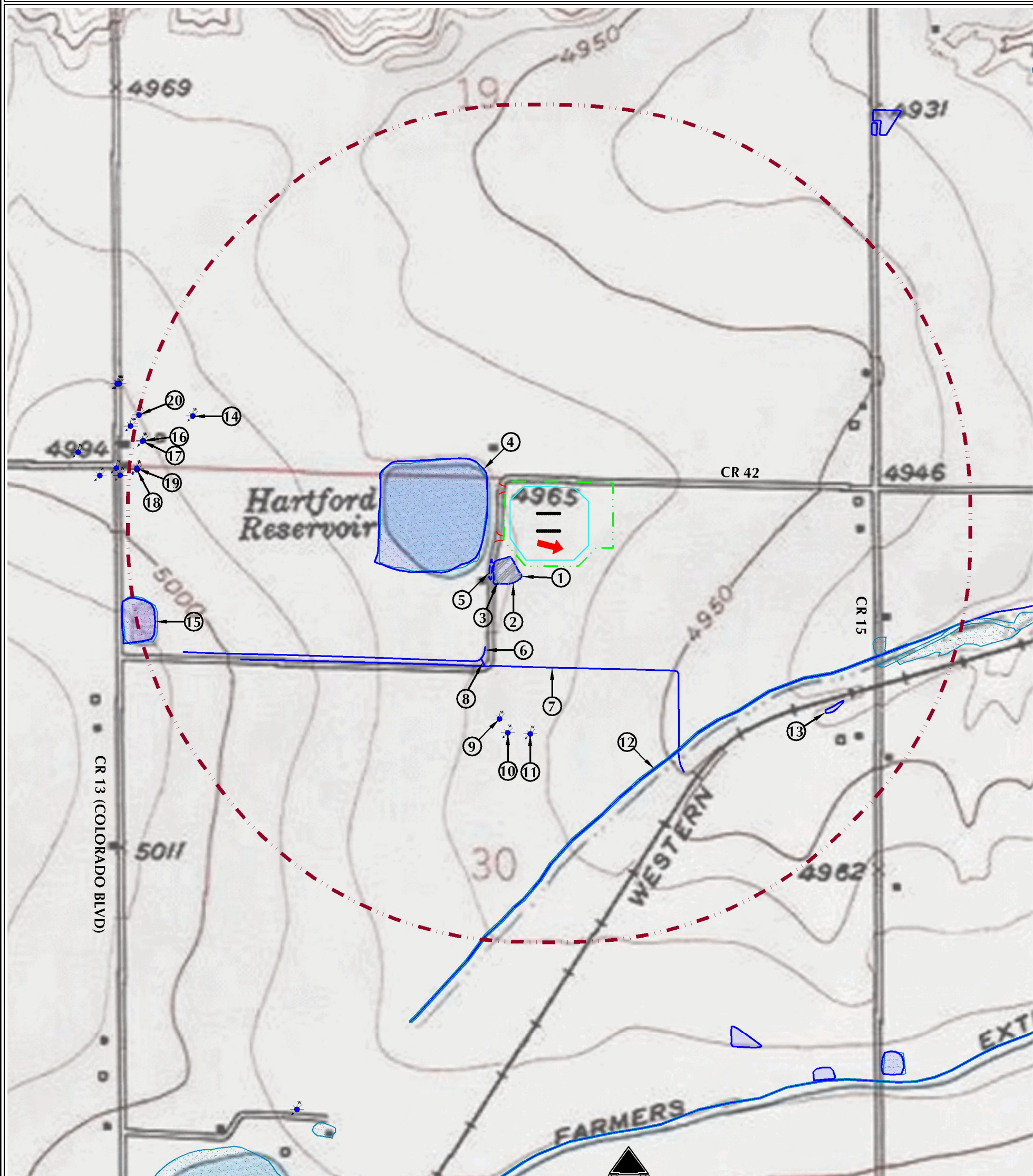

NOTES:

1. WORKING PAD SURFACE IS NOT WITHIN 2640' OF A GUDI OR TYPE III AQUIFER PUBLIC WATER SYSTEM WELL.
2. WORKING PAD SURFACE DOES NOT HAVE ANY SURFACE WATERS WITHIN 2640' THAT ARE 15 MILES UPSTREAM OF A PUBLIC WATER SYSTEM INTAKE.

- | | |
|--|--|
| <ol style="list-style-type: none"> 1. POND IS ±74' SW. 2. DELINEATED WETLAND (PER 2DOT) IS ±74' SW. 3. NWI RIVERINE/POND/WETLAND AREAS ARE ±77' SW, ±160' W, ±1459' SE, ±2078' E, ±2160' E, ±2277' E AND ±2490' W. 4. POND IS ±156' W. 5. DELINEATED WETLAND (PER 2DOT) IS ±189' SW. 6. DITCH IS ±663' SW. 7. DITCH IS ±737' S. 8. DITCH IS ±746' SW. 9. EXISTING WATER WELL (PERMIT#285104, WELL CONSTRUCTED) IS ±1112' S. 10. EXISTING WATER WELL (PERMIT#285103, WELL CONSTRUCTED) IS ±1199' S. 11. EXISTING WATER WELL (PERMIT#285102, WELL CONSTRUCTED) IS ±1200' S. | <ol style="list-style-type: none"> 12. DITCH (NOT PRESENT) IS ±1468' SE. 13. POND IS ±1993' SE. 14. EXISTING WATER WELL (PERMIT#63966-MH, WELL CONSTRUCTED) IS ±2269' W. 15. POND IS ±2507' W. 16. EXISTING WATER WELL (PERMIT#4000584-MH, WELL CONSTRUCTED) IS ±2569' W. 17. EXISTING WATER WELL (PERMIT#4000607-MH, WELL CONSTRUCTED) IS ±2573' W. 18. EXISTING WATER WELL (PERMIT#4000585-MH, WELL CONSTRUCTED) IS ±2586' W. 19. EXISTING WATER WELL (PERMIT#4000606-MH, WELL CONSTRUCTED) IS ±2587' W. 20. EXISTING WATER WELL (PERMIT#61721-MH, WELL CONSTRUCTED) IS ±2631' W. |
|--|--|

LEGEND	
<ul style="list-style-type: none"> PROPOSED WELL WATER WELL PROPOSED ACCESS ROAD DITCH/CANAL/DRAINAGE DOWNGRADIENT 2640' WORKING PAD SURFACE BUFFER 	<ul style="list-style-type: none"> PROPOSED OIL & GAS LOCATION WORKING PAD SURFACE NWI RIVERINE/POND/WETLAND NWI RIPARIAN AREA DELINEATED WETLAND

ALL MEASUREMENTS ARE MADE FROM NEAREST EDGE OF THE WORKING PAD SURFACE

609 CONSULTING, LLC

LOVELAND OFFICE
6706 North Franklin Avenue
Loveland, Colorado 80538
Phone: 970-776-1331

SHERIDAN OFFICE
1095 Saberton Avenue
Sheridan, Wyoming 82801
Phone: 307-674-6069

DATE SURVEYED: 3/21/24
 DATE: 4/30/24
 DRAFTER: GLK
 REVISED:

DATA SOURCES & NOTES:

- TOPOGRAPHIC MAP IS COURTESY OF USGS.
- WATER WELLS COURTESY OF COLORADO DIVISION OF WATER RESOURCES.
- MANY FEATURES ON THIS MAP COME FROM PUBLICLY AVAILABLE DATA AND SURFACE WATER LYING OUTSIDE THE SURFACE PROPERTY MAY HAVE BEEN OBTAINED FROM AERIAL IMAGERY. THE ACCURACY AND COMPLETENESS OF SAID DATA HAS NOT BEEN VERIFIED BY 609 CONSULTING, LLC. EXISTING CONDITIONS MAY DIFFER FROM WHAT IS SHOWN.

PREPARED FOR:
Kerr-McGee Oil & Gas Onshore LP

K:\HW\2024\03\21\2018_219_TULIP_JVGREN_03_03_2024_1411_R67W_SEC_30\DWG\TULIP_1411_157W_30.dwg - 4/30/2024 12:22:04 PM, swardberg