

- NOTES:**
- PIPELINE AND UTILITY CORRIDORS ARE PLANNED AND DETERMINED BY THIRD PARTY COMPANIES. SPECIFIC PIPELINE AND UTILITY CORRIDOR LOCATIONS WILL BE DECIDED BY THOSE THIRD PARTY COMPANIES CLOSER TO THE START DATE OF OPERATIONS BASED ON CONTRACT AND RIGHT-OF-WAY NEGOTIATIONS.
 - EXISTING UTILITIES DISPLAYED ON THE GRADING PLAN ARE FOR REFERENCE PURPOSES ONLY. PRIOR TO CONSTRUCTION OR EARTHWORK, CONTRACTOR WILL BE RESPONSIBLE TO CALL FOR LOCATES: (800) 922-1987
 - DIVERSION DITCH AND/OR BERM TO BE CONSTRUCTED AROUND THE ENTIRE PAD LOCATION. BERM SECTIONS TO BE COMPACTED IN ACCORDANCE WITH STANDARD CONSTRUCTION PRACTICES.
 - CENTER OF WELL PAD REFERENCED BELOW CORRESPONDS TO THE SURFACE LOCATION OF THE TULIP WEST 30-6HZ WELL.
 - FLAT GRADED AREA TO BE RECLAIMED DURING INTERIM RECLAMATION.

WELL NAME:	C/F	WELL NAME:	C/F
TULIP WEST 30-1HZ	F1.4	TULIP EAST 30-12HZ	F0.9
TULIP WEST 30-2HZ	F1.5	TULIP EAST 30-13HZ	F0.9
TULIP WEST 30-3HZ	F1.6	TULIP EAST 30-14HZ	F1.0
TULIP WEST 30-4HZ	F1.7	TULIP EAST 30-15HZ	F1.2
TULIP WEST 30-5HZ	F1.8	TULIP EAST 30-16HZ	F1.2
TULIP WEST 30-6HZ	F2.0	TULIP EAST 30-17HZ	F1.4
TULIP WEST 30-7HZ	F2.1	TULIP EAST 30-18HZ	F1.5
TULIP WEST 30-8HZ	F2.2	TULIP EAST 30-19HZ	F1.6
TULIP WEST 30-9HZ	F2.3	TULIP EAST 30-20HZ	F1.8
TULIP WEST 30-10HZ	F2.8	TULIP EAST 30-21HZ	F1.9
TULIP WEST 30-11HZ	F2.6	TULIP EAST 30-22HZ	F2.0

TULIP WELL PAD CONSTRUCTION LAYOUT DRAWING - PLAN VIEW

WELL PAD QUANTITIES AND DESIGN PARAMETERS
 EXISTING GRADE @ CENTER OF WELL PAD = 4966.3'
 FINISHED GRADE ELEVATION = 4968.3'
 CUT SLOPES = 3:1
 FILL SLOPES = 3:1
 SHRINKAGE FACTOR = 1.10
 SWELL FACTOR = 1.00
 GRADED WELL PAD SURFACE AREA = 5.75 ACRES
 TOTAL WELL PAD AREA = 6.34 ACRES
 PROPOSED OIL & GAS LOCATION = 9.25 ACRES

WELL PAD QUANTITIES
 TOTAL CUT FOR WELL PAD = 0 C.Y.
 TOTAL FILL FOR WELL PAD = 26,240 C.Y.
 TOPSOIL @ 10" DEPTH = 8,519 C.Y.
 IMPORT MATERIAL = 26,240 C.Y.
TOTAL DISTURBANCE AREA
 OIL & GAS LOCATION = 9.25 ACRES
 WORKING PAD SURFACE = 5.75 ACRES
 ACCESS ROAD = 0.28 ACRES
 PIPELINE/UTILITY CORRIDOR = SEE NOTE 1

WELL PAD LEGEND

- EXISTING WELL LOCATION
- PROPOSED WELL LOCATION
- - - EXISTING CONTOURS (2' INTERVAL)
- - - PROPOSED CONTOURS (2' INTERVAL)
- EPL - EXISTING PIPELINE
- PFL - PROPOSED FLOWLINE
- X - X - EXISTING FENCE
- PUE - PROPOSED UNDERGROUND ELECTRIC LINE
- - - PROPOSED SOUND MITIGATION
- - - WORKING PAD SURFACE (WPS)
- - - DIVERSION DITCH
- - - BERM

SCALE: 1"=100'
DATE: 4/30/24
SHEET NO: 1 OF 1

TULIP WELL PAD
 CONSTRUCTION LAYOUT DRAWING - PLAN VIEW
 TULIP WEST 30-1HZ, TULIP WEST 30-2HZ,
 TULIP WEST 30-3HZ, TULIP WEST 30-4HZ, TULIP WEST 30-5HZ,
 TULIP WEST 30-6HZ, TULIP WEST 30-7HZ, TULIP WEST 30-8HZ,
 TULIP WEST 30-9HZ, TULIP WEST 30-10HZ, TULIP WEST 30-11HZ,
 TULIP WEST 30-12HZ, TULIP WEST 30-13HZ, TULIP WEST 30-14HZ,
 TULIP WEST 30-15HZ, TULIP WEST 30-16HZ, TULIP WEST 30-17HZ,
 TULIP WEST 30-18HZ, TULIP WEST 30-19HZ, TULIP WEST 30-20HZ,
 TULIP WEST 30-21HZ & TULIP WEST 30-22HZ
 LOCATED IN SECTION 30, T4N, R67W, 6TH P.M.
 WELD COUNTY, COLORADO

Kerr-McGee Oil & Gas Onshore LP
 1099 18th Street
 Denver, Colorado 80202

609 CONSULTING, LLC

LOVELAND OFFICE
 6706 North Franklin Avenue
 Loveland, Colorado 80538
 Phone 970-776-4331

SHERIDAN OFFICE
 1095 Saberton Avenue
 Sheridan, Wyoming 82801
 Phone 307-674-0609

K:\AMARCO\2018\219_TULIP_INVENEN.B. OLSON_T4N_R67W_SEC_30\DWG\TULIP_T4N_R67W_SEC_30.DWG, 4/30/2024 6:03:11 PM, ssundberg

PRELIMINARY RIG LAYOUT DRAWING - 1ST OCCUPATION
TULIP WELL PAD - SOUTH STRING
 NW1/4 NE1/4 SECTION 30, TOWNSHIP 4 NORTH, RANGE 67 WEST, 6TH P.M., WELD COUNTY, COLORADO

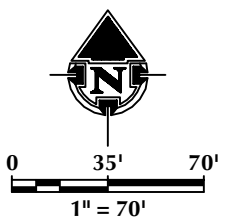
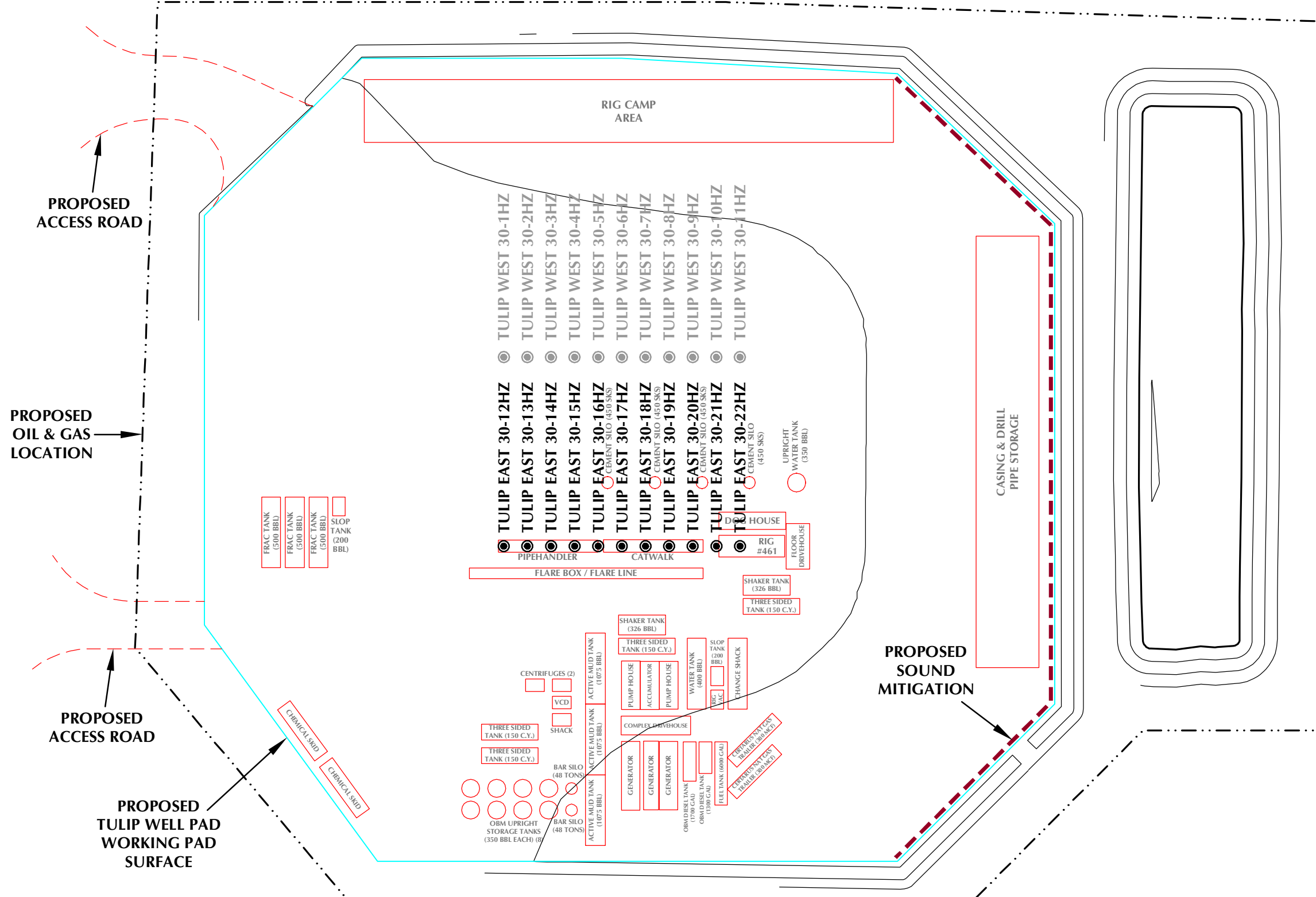

LEGEND

- PROPOSED WELL
- EXISTING WELL
- PROPOSED OIL & GAS LOCATION
- PROPOSED WORKING PAD SURFACE
- PROPOSED 2' CONTOUR

609 CONSULTING, LLC
 LOVELAND OFFICE
 6706 North Franklin Avenue
 Loveland, Colorado 80538
 Phone 970-776-4331
 SHERIDAN OFFICE
 1095 Saberton Avenue
 Sheridan, Wyoming 82801
 Phone 307-674-0609

Kerr-McGee Oil & Gas Onshore LP
 1099 18th Street
 Denver, Colorado 80202

SCALE:	1" = 70'
DATE SURVEYED:	3/21/24
DATE:	4/30/24
DRAFTER:	GLK
REVISED:	

NOTE:
 1. RIG PROFILE IS APPROXIMATE AND SUBJECT TO MODIFICATION DUE TO SPECIFIC CIRCUMSTANCES.

K:\ANADARKO\2018-219_TULIP_INVIGREN & OLSON_T4N_R67W_SEC_30\DWG\TULIP_T4N_R67W_4/29/2024 5:17:34 PM.sundberg

PRELIMINARY RIG LAYOUT DRAWING - 2ND OCCUPATION
TULIP WELL PAD - NORTH STRING
 NW1/4 NE1/4 SECTION 30, TOWNSHIP 4 NORTH, RANGE 67 WEST, 6TH P.M., WELD COUNTY, COLORADO

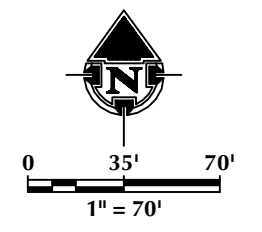
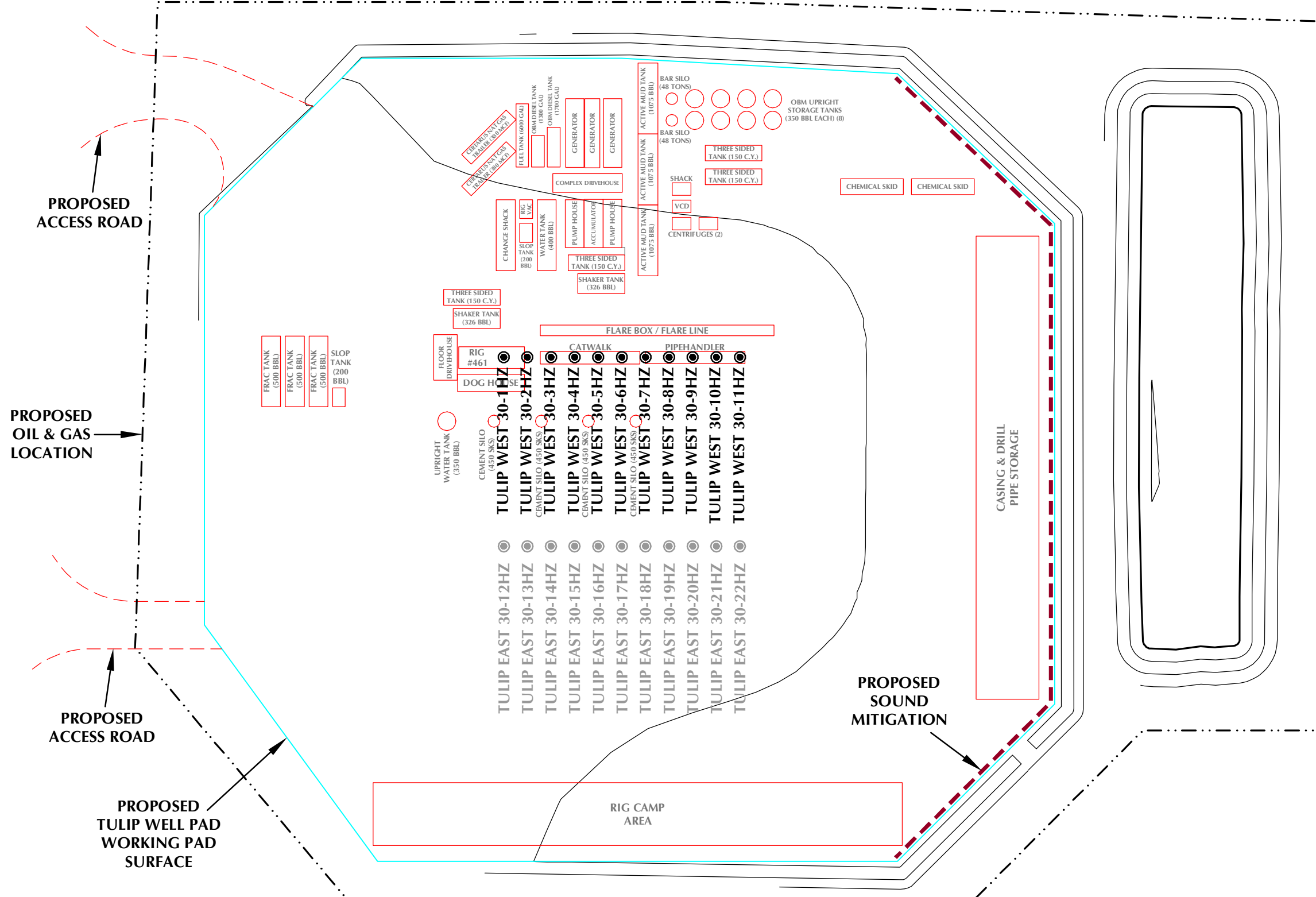

LEGEND

- PROPOSED WELL
- EXISTING WELL
- PROPOSED OIL & GAS LOCATION
- ▭ PROPOSED WORKING PAD SURFACE
- PROPOSED 2' CONTOUR

609 CONSULTING, LLC
 LOVELAND OFFICE
 6706 North Franklin Avenue
 Loveland, Colorado 80538
 Phone 970-776-4331
 SHERIDAN OFFICE
 1095 Saberton Avenue
 Sheridan, Wyoming 82801
 Phone 307-674-0609

Kerr-McGee Oil & Gas Onshore LP
 1099 18th Street
 Denver, Colorado 80202

SCALE:	1" = 70'
DATE SURVEYED:	3/21/24
DATE:	4/30/24
DRAFTER:	GLK
REVISED:	

NOTE:
 1. RIG PROFILE IS APPROXIMATE AND SUBJECT TO MODIFICATION DUE TO SPECIFIC CIRCUMSTANCES.

K:\AWARD\2018\219_TULIP_INVIGREN & OLSON_T4N_R67W_SEC_30\DWG\TULIP_T4N_R67W_30.dwg - 4/29/2024 5:15:10 PM - s.aundberg

PRELIMINARY WELL COMPLETION, STIMULATION AND RECYCLING LAYOUT DRAWING - 1ST OCCUPATION

TULIP WELL PAD

NW1/4 NE1/4 SECTION 30, TOWNSHIP 4 NORTH, RANGE 67 WEST, 6TH P.M., WELD COUNTY, COLORADO

EQUIPMENT	CAPACITY
ACID TRANSPORT	4,000 GAL CAPACITY
HCR SYNTHETIC ACID TRANSPORT	4,000 GAL CAPACITY
FRICTION REDUCER ISO	4,500 GAL CAPACITY
BIOCIDE ISO	6,000 GAL CAPACITY
DEF TANK	2,200 GAL DEF TANK
DIESEL TANK	16,000 GAL DIESEL TANK
ROUND WATER TANK	3,600 BBL CAPACITY
STORAGE TANK (OPEN TOP, CLOSED TOP, WATER)	500 BBL CAPACITY
WATER RECYCLE TANK	500 BBL CAPACITY

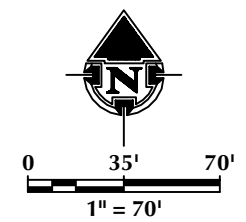
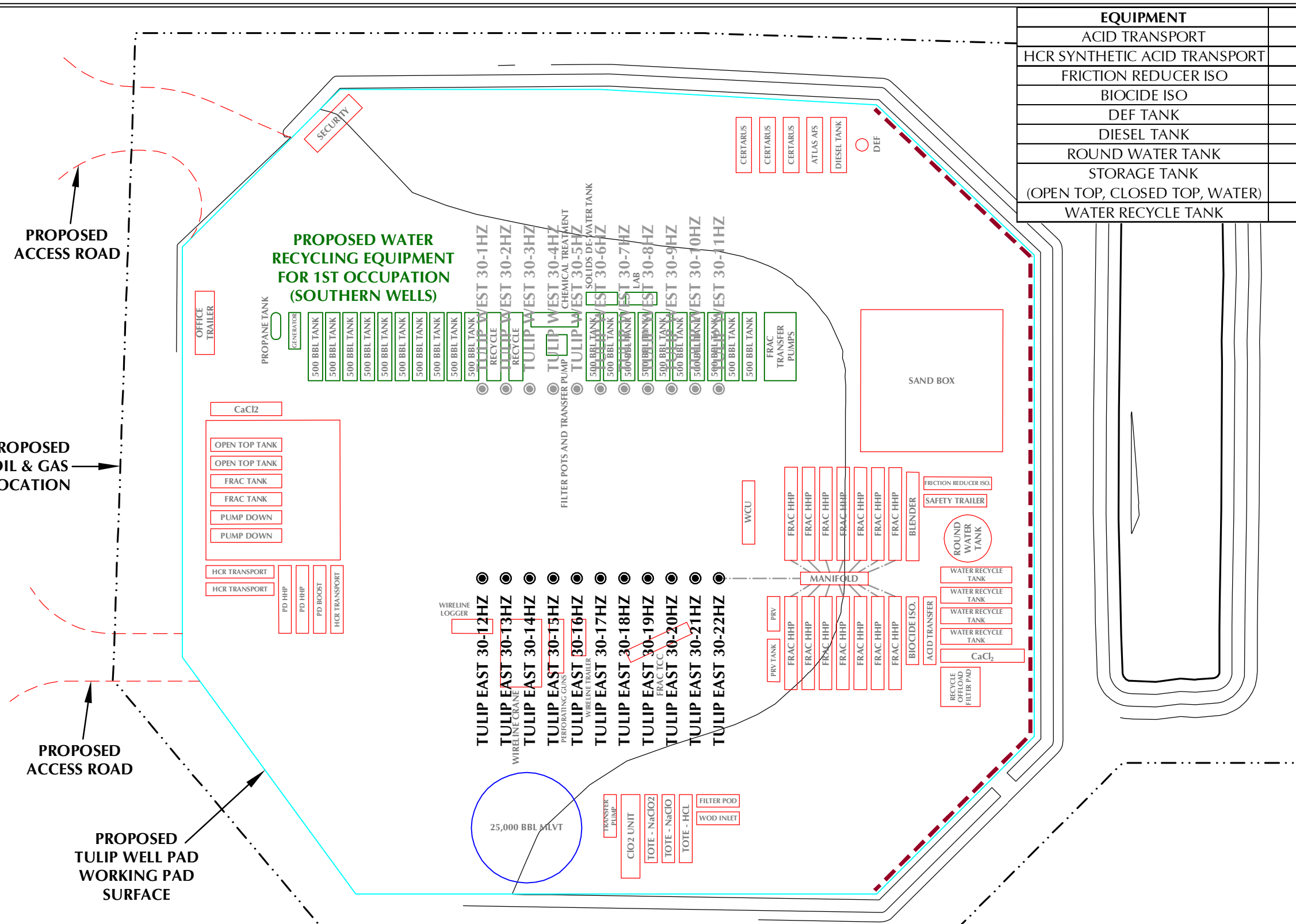

LEGEND

- PROPOSED WELL
- EXISTING WELL
- PROPOSED OIL & GAS LOCATION
- PROPOSED WORKING PAD SURFACE
- PROPOSED 2' CONTOUR

609 CONSULTING, LLC

LOVELAND OFFICE
6706 North Franklin Avenue
Loveland, Colorado 80538
Phone 970-776-4331

SHERIDAN OFFICE
1095 Saberton Avenue
Sheridan, Wyoming 82801
Phone 307-674-0609

Kerr-McGee Oil & Gas Onshore LP

1099 18th Street
Denver, Colorado 80202

SCALE: 1" = 70'
DATE SURVEYED: 3/21/24
DATE: 4/30/24
DRAFTER: GLK
REVISED:

NOTE:
1. COMPLETION AND STIMULATION LAYOUT IS APPROXIMATE AND SUBJECT TO MODIFICATION DUE TO SPECIFIC CIRCUMSTANCES.

K:\ANADARKO\2018-219_TULIP_INVENEN & OLSON_T4N_R67W_SEC_30\DWG\TULIP_T4N_R67W_30.dwg - 4/29/2024 5:22:48 PM s.aundberg

PRELIMINARY FLOWBACK EQUIPMENT LAYOUT DRAWING

TULIP WELL PAD

NW1/4 NE1/4 SECTION 30, TOWNSHIP 4 NORTH, RANGE 67 WEST, 6TH P.M., WELD COUNTY, COLORADO

EQUIPMENT	CAPACITY
STORAGE TANK (OPEN TOP, CLOSED TOP, WATER)	500 BBL CAPACITY

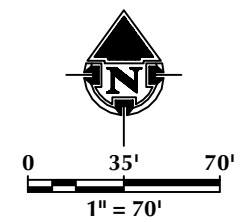
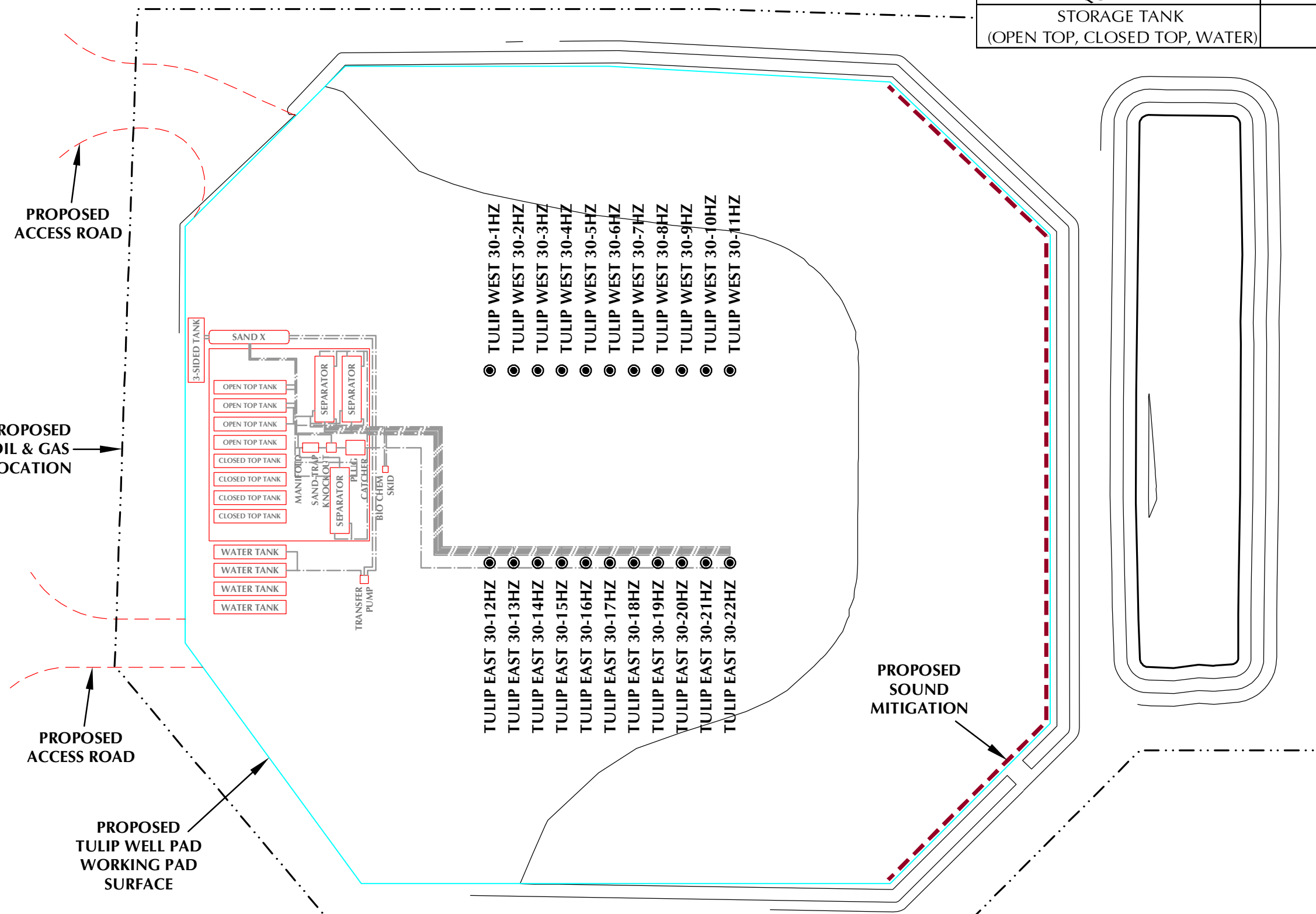

LEGEND

- PROPOSED WELL
- EXISTING WELL
- PROPOSED OIL & GAS LOCATION
- PROPOSED WORKING PAD SURFACE
- PROPOSED 2' CONTOUR
- - - - PROPOSED PIPELINE

609
CONSULTING, LLC

LOVELAND OFFICE
6706 North Franklin Avenue
Loveland, Colorado 80538
Phone 970-776-4331

SHERIDAN OFFICE
1095 Saberton Avenue
Sheridan, Wyoming 82801
Phone 307-674-0609

Kerr-McGee Oil & Gas Onshore LP
1099 18th Street
Denver, Colorado 80202

SCALE: 1" = 70'
DATE SURVEYED: 3/21/24
DATE: 4/30/24
DRAFTER: GLK
REVISED:

NOTE:
1. WELLHEADS WILL REMAIN PERMANENTLY AFTER FLOWBACK IS COMPLETE. ALL OTHER EQUIPMENT DISPLAYED IS TEMPORARY AND WILL BE REMOVED FOLLOWING FLOWBACK OPERATIONS.

K:\ANADARKO\2018-219_TULIP_INVENEN & OLSON_T4N_R67W_SEC_30\DWG\TULIP_T4N_R67W_30.dwg - 4/29/2024 5:21:08 PM s.aundberg

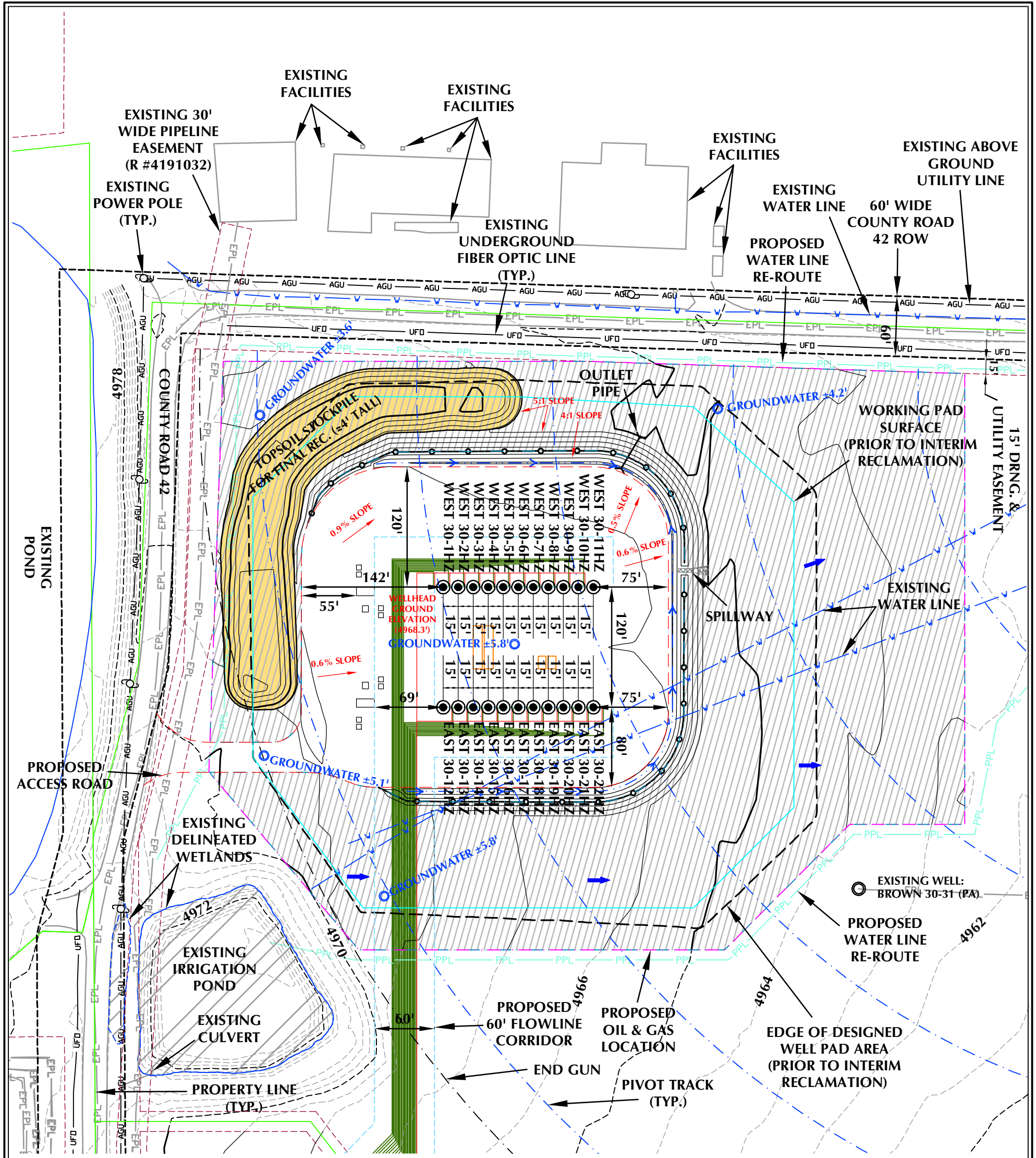

NOTES:

1. PIPELINE AND UTILITY CORRIDORS ARE PLANNED AND DETERMINED BY THIRD PARTY COMPANIES. SPECIFIC PIPELINE AND UTILITY CORRIDOR LOCATIONS WILL BE DECIDED BY THOSE THIRD PARTY COMPANIES CLOSER TO THE START DATE OF OPERATIONS BASED ON CONTRACT AND RIGHT-OF-WAY NEGOTIATIONS.
2. EXISTING UTILITIES DISPLAYED ON THE GRADING PLAN ARE FOR REFERENCE PURPOSES ONLY. PRIOR TO CONSTRUCTION OR EARTHWORK, CONTRACTOR WILL BE RESPONSIBLE TO CALL FOR LOCATES: (800) 922-1987
3. RECLAIMED AREA WILL BE RE-SEEDD AND RE-VEGETATED DURING INTERIM RECLAMATION.

TULIP WELL PAD FACILITY LAYOUT DRAWING

QUANTITIES AND DESIGN PARAMETERS
 SHRINKAGE FACTOR = 1.00
 SWELL FACTOR = 1.00
 PROPOSED OIL & GAS LOCATION = 9.25 ACRES
 AREA RECLAIMED DURING INTERIM RECLAMATION = 6.29 ACRES
 TOTAL WELL PAD AREA AFTER INTERIM RECLAMATION = 2.96 ACRES

WELL PAD QUANTITIES
 TOTAL CUT = 15,711 C.Y.
 TOTAL FILL = 3,334 C.Y.
 TOPSOIL @ 10" DEPTH FROM CONSTRUCTION PHASE = 8,519 C.Y.
 TOPSOIL USED FOR INTERIM REC = 4,953 C.Y.
 TOPSOIL STORED FOR FINAL REC = 3,566 C.Y.
 TOTAL EXPORT = 12,377 C.Y.

LAND USE: IRRIGATED CROPLAND

LEGEND

- EXISTING WELL LOCATION
- PROPOSED WELL LOCATION
- - - EXISTING CONTOURS (1' INTERVAL)
- - - PROPOSED CONTOURS (1' INTERVAL)
- EPL - EXISTING PIPELINE
- PPL - PROPOSED PIPELINE
- - - EXISTING FENCE
- - - RECLAMATION AREA
- PLANNED FLOW DIRECTION
- WORKING PAD SURFACE (WPS)
- DIVERSION DITCH
- BERM

SCALE: 1"=100'
DATE: 4/30/24
SHEET NO: 1 OF 2

TULIP WELL PAD
 FACILITY LAYOUT DRAWING
 TULIP WEST 30-1HZ, TULIP WEST 30-2HZ,
 TULIP WEST 30-3HZ, TULIP WEST 30-4HZ, TULIP WEST 30-5HZ,
 TULIP WEST 30-6HZ, TULIP WEST 30-7HZ, TULIP WEST 30-8HZ,
 TULIP WEST 30-9HZ, TULIP WEST 30-10HZ, TULIP WEST 30-11HZ,
 TULIP WEST 30-12HZ, TULIP WEST 30-13HZ, TULIP WEST 30-14HZ,
 TULIP WEST 30-15HZ, TULIP WEST 30-16HZ, TULIP WEST 30-17HZ,
 TULIP WEST 30-18HZ, TULIP WEST 30-19HZ, TULIP WEST 30-20HZ,
 TULIP WEST 30-21HZ & TULIP WEST 30-22HZ
 LOCATED IN SECTION 30, T4N, R67W, 6TH P.M.
 WELD COUNTY, COLORADO

Kerr-McGee Oil & Gas Onshore LP
 1099 18th Street
 Denver, Colorado 80202



LOVELAND OFFICE
 6706 North Franklin Avenue
 Loveland, Colorado 80538
 Phone 970-776-4331

SHERIDAN OFFICE
 1095 Saberton Avenue
 Sheridan, Wyoming 82801
 Phone 307-674-0609

K:\AMARCO\2018\219_TULIP_INVENEN.B. OLSON_TML_R67W_SEC_30\DWG\TULIP_TML_R67W_SEC_30.DWG, 4/29/2024 1:53:10 PM, psumberg

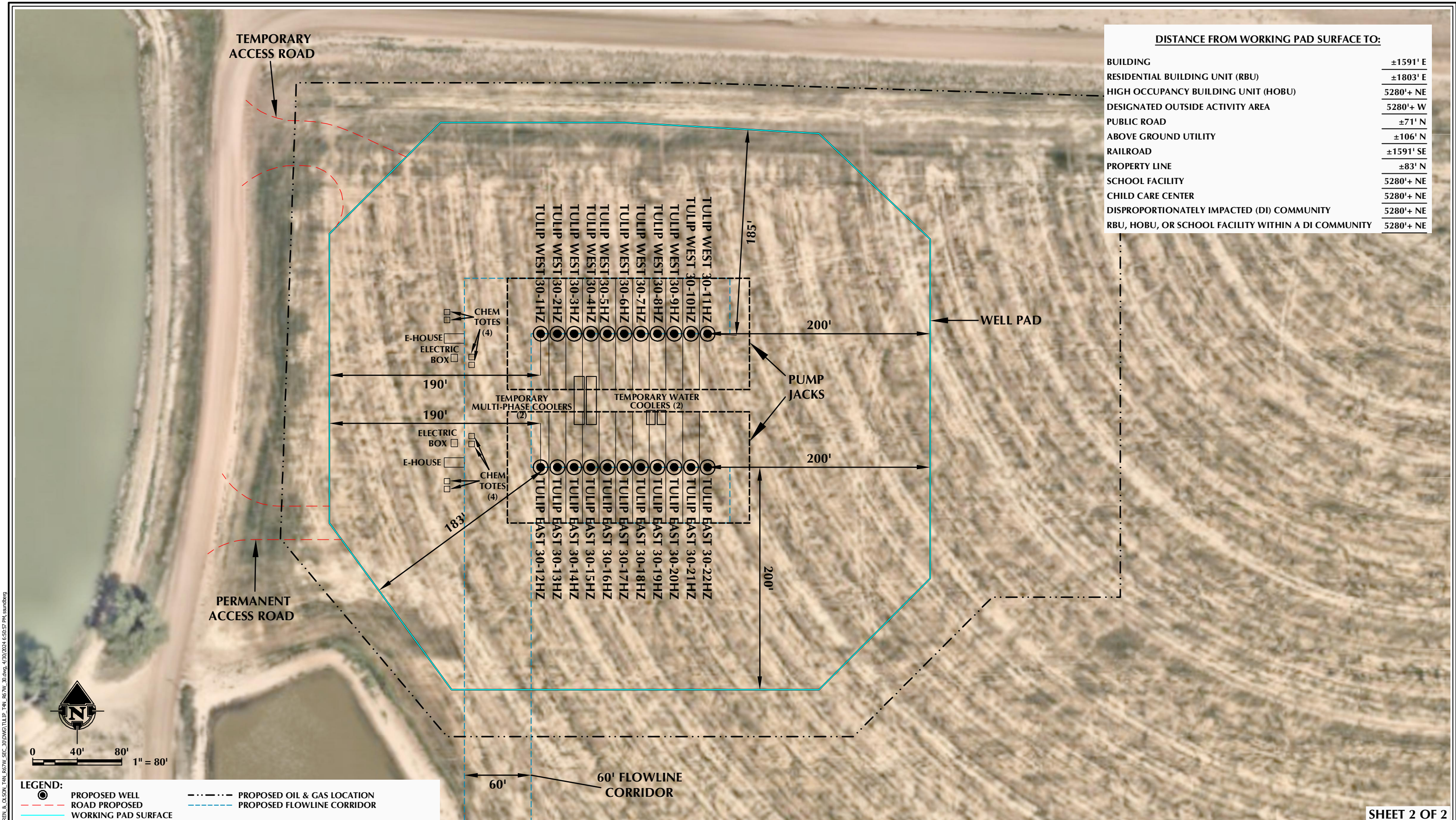

DISTANCE FROM WORKING PAD SURFACE TO:	
BUILDING	±1591' E
RESIDENTIAL BUILDING UNIT (RBU)	±1803' E
HIGH OCCUPANCY BUILDING UNIT (HOBU)	5280'+ NE
DESIGNATED OUTSIDE ACTIVITY AREA	5280'+ W
PUBLIC ROAD	±71' N
ABOVE GROUND UTILITY	±106' N
RAILROAD	±1591' SE
PROPERTY LINE	±83' N
SCHOOL FACILITY	5280'+ NE
CHILD CARE CENTER	5280'+ NE
DISPROPORTIONATELY IMPACTED (DI) COMMUNITY	5280'+ NE
RBU, HOBU, OR SCHOOL FACILITY WITHIN A DI COMMUNITY	5280'+ NE

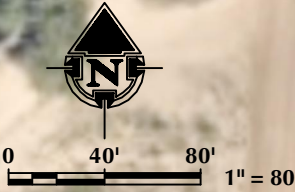

LEGEND:	
	PROPOSED WELL
	ROAD PROPOSED
	WORKING PAD SURFACE
	PROPOSED OIL & GAS LOCATION
	PROPOSED FLOWLINE CORRIDOR

NOTES:

- EQUIPMENT PLACEMENT IS APPROXIMATE AND SUBJECT TO MINOR MODIFICATION DUE TO SPECIFIC CIRCUMSTANCES.
- FLOWLINE CORRIDOR IS APPROXIMATE AND SUBJECT TO MINOR MODIFICATION DUE TO SPECIFIC CIRCUMSTANCES.

DATA SOURCES:
- AERIAL COURTESY OF NEARMAP

609 CONSULTING, LLC

LOVELAND OFFICE
6706 North Franklin Avenue
Loveland, Colorado 80538
Phone 970-776-4331

SHERIDAN OFFICE
1095 Saberton Avenue
Sheridan, Wyoming 82801
Phone 307-674-0609

Kerr-McGee Oil & Gas Onshore LP
1099 18th Street
Denver, Colorado 80202

SCALE: 1" = 80'
DATE SURVEYED: 3/21/24
DATE: 4/30/24
DRAFTER: GLK
REVISED:

FACILITY LAYOUT DRAWING
TULIP WELL PAD
LOCATED IN SECTION 30, T4N, R67W, 6TH P.M.
WELD COUNTY, COLORADO

K:\AWARD\2018\219_TULIP_INVENR & OLSON_T4N_R67W_SEC_30\DWG\TULIP_T4N_R67W_30.dwg, 4/30/24 6:50:57 PM, ssundberg