

Borehole: Speed Goat Fed 3432-08H	Well: Speed Goat Fed 3432-08H	Field: CO, Weld County (NAD 83 NZ) - 2019	Structure: Verdad Resources 34-09N-58W (Speed Goat 3432-3435 Pad)
---	---	---	---

Gravity & Magnetic Parameters			Surface Location			Miscellaneous		
Model: HDGM 2024	Dip: 66.849°	Date: 14-Jun-2024	Lat: N 40 42 50.54	Northing: 1507255.54ftUS	Grid Conv: 1.0701°	Slot: Speed Goat Fed 3432-08H	TVD Ref: RKB(4743ft above Mean Sea Level)	
MagDec: 7.116°	FS: 51814.784mT	Gravity FS: 999.096mg (9.80665 Based)	Lon: W 103 50 37.64	Easting: 3459108.11ftUS	Scale Fact: 0.99998949	Plan: Speed Goat Fed 3432-08H IFR1+MS+SAG 0' to 20782' Definitive		

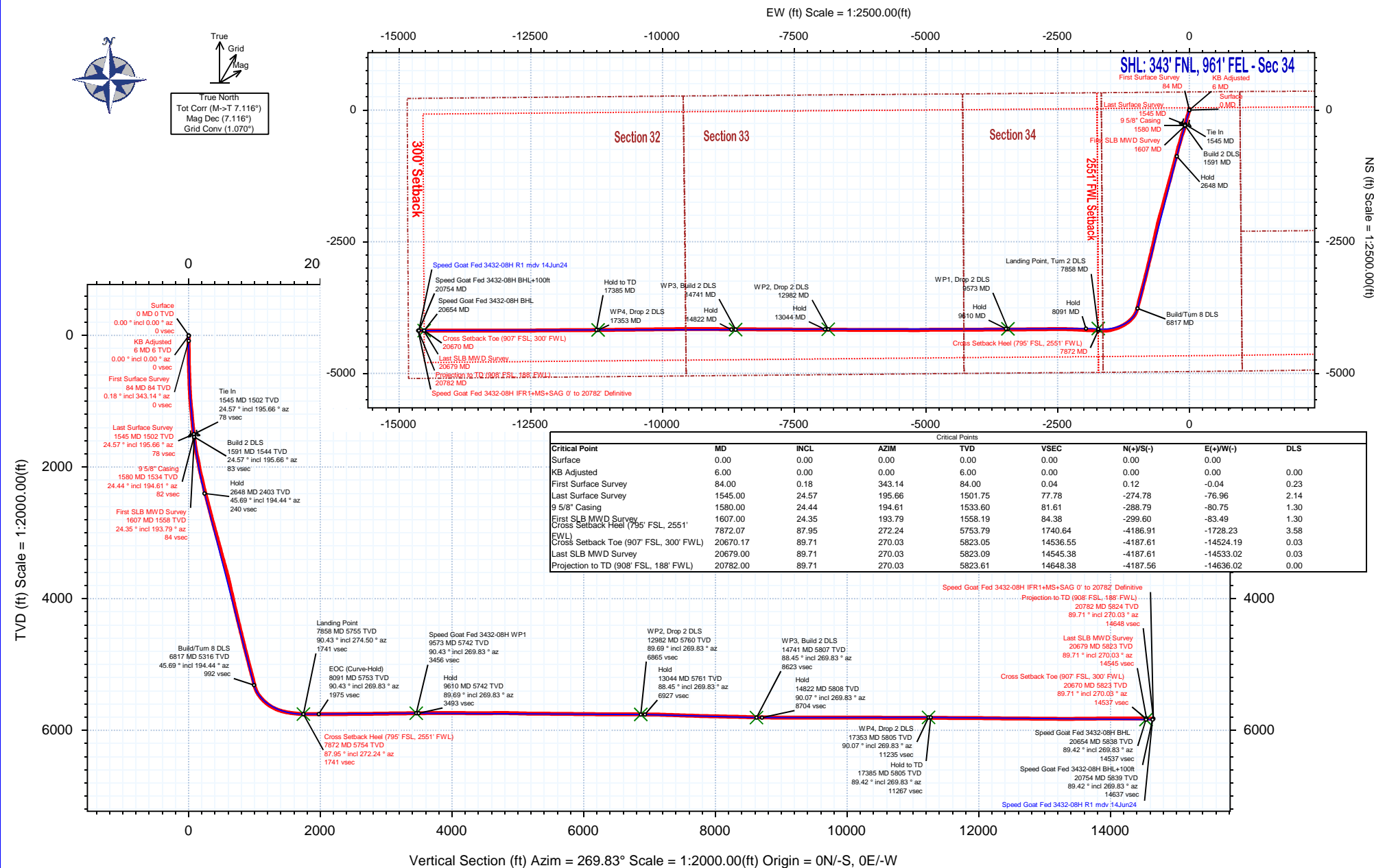



Speed Goat Fed 3432-08H IFR1+MS+SAG 0' to 20782' Definitive Survey

Geodetic Report

(Def Survey)



Report Date: July 08, 2024 - 09:14 AM
Client: Verdad Resources
Field: CO, Weld County (NAD 83 NZ) - 2019
Structure / Slot: Verdad Resources 34-09N-58W (Speed Goat 3432-3435 Pad) / Speed Goat Fed 3432-08H
Well: Speed Goat Fed 3432-08H
Borehole: Speed Goat Fed 3432-08H
UWI / API#: Unknown / Unknown
Survey Name: Speed Goat Fed 3432-08H IFR1+MS+SAG 0' to 20782' Definitive
Survey Date: May 08, 2024
Tort / AHD / DDI / ERD Ratio: 247.337 ° / 17727.421 ft / 7.194 / 3.042
Coordinate Reference System: NAD83 Colorado State Plane, Northern Zone, US Feet
Location Lat / Long: N 40° 42' 50.53675", W 103° 50' 37.64405"
Location Grid N/E Y/X: N 1507255.540 ftUS, E 3459108.110 ftUS
CRS Grid Convergence Angle: 1.0701 °
Grid Scale Factor: 0.99998949
Version / Patch: 2.10.836.0

Survey / DLS Computation: Minimum Curvature / Lubinski
Vertical Section Azimuth: 269.830 ° (True North)
Vertical Section Origin: 0.000 ft, 0.000 ft
TVD Reference Datum: RKB
TVD Reference Elevation: 4743.000 ft above Mean Sea Level
Seabed / Ground Elevation: 4722.000 ft above Mean Sea Level
Magnetic Declination: 7.116 °
Total Gravity Field Strength: 999.0960mgn (9.80665 Based)
Gravity Model: GARM
Total Magnetic Field Strength: 51814.60mT
Magnetic Dip Angle: 66.849 °
Declination Date: June 14, 2024
Magnetic Declination Model: HDGM 2024
North Reference: True North
Grid Convergence Used: 0.0000 °
Total Corr Mag North->True North: 7.1156 °
Local Coord Referenced To: Well Head

Comments	MD (ft)	Incl (°)	Azim True (°)	TVD (ft)	VSEC (ft)	NS (ft)	EW (ft)	DLS (°/100ft)	Northing (ftUS)	Easting (ftUS)	Latitude (°)	Longitude (°)
Surface	0.00	0.00	0.00	0.00	0.00	0.00	0.00	N/A	1507255.54	3459108.11	40.714038	-103.843790
KB Adjusted	6.00	0.00	0.00	6.00	0.00	0.00	0.00	0.00	1507255.54	3459108.11	40.714038	-103.843790
First Surface	84.00	0.18	343.14	84.00	0.04	0.12	-0.04	0.23	1507255.66	3459108.07	40.714038	-103.843790
Survey	176.00	0.22	308.33	176.00	0.21	0.37	-0.22	0.14	1507255.90	3459107.89	40.714039	-103.843791
	267.00	0.18	235.47	267.00	0.47	0.39	-0.47	0.26	1507255.92	3459107.63	40.714039	-103.843792
	358.00	1.54	208.22	357.99	1.17	-0.77	-1.17	1.52	1507254.75	3459106.96	40.714036	-103.843794
	448.00	3.91	205.32	447.88	3.06	-4.61	-3.05	2.64	1507250.88	3459105.15	40.714025	-103.843801
	537.00	6.06	199.52	536.54	5.95	-11.78	-5.92	2.48	1507243.65	3459102.41	40.714006	-103.843811
	627.00	7.38	195.04	625.92	9.07	-21.84	-9.01	1.58	1507233.54	3459099.51	40.713978	-103.843823
	716.00	9.27	190.29	713.98	11.87	-34.41	-11.77	2.26	1507220.91	3459096.98	40.713944	-103.843832
	806.00	10.94	192.14	802.58	15.01	-49.90	-14.86	1.89	1507205.38	3459094.18	40.713901	-103.843844
	895.00	12.88	193.37	889.66	19.13	-67.80	-18.93	2.20	1507187.40	3459090.45	40.713852	-103.843858
	984.00	14.90	199.17	976.06	25.25	-88.27	-24.98	2.75	1507166.82	3459084.78	40.713796	-103.843880
	1074.00	17.23	198.20	1062.53	33.28	-111.86	-32.95	2.61	1507143.08	3459077.26	40.713731	-103.843909
	1163.00	18.28	197.77	1147.29	41.73	-137.68	-41.33	1.19	1507117.12	3459069.36	40.713660	-103.843939
	1253.00	19.60	193.90	1232.42	49.75	-165.77	-49.26	2.02	1507088.88	3459061.96	40.713583	-103.843968
	1342.00	21.62	192.58	1315.72	57.00	-196.27	-56.42	2.33	1507058.25	3459055.37	40.713499	-103.843994
	1431.00	23.47	194.51	1397.92	65.11	-229.43	-64.43	2.24	1507024.95	3459047.98	40.713408	-103.844022
	1521.00	25.05	196.10	1479.97	74.99	-265.09	-74.20	1.90	1506989.11	3459038.87	40.713310	-103.844058
Last Surface	1545.00	24.57	195.66	1501.75	77.78	-274.78	-76.96	2.14	1506979.38	3459036.30	40.713284	-103.844068
Survey	1580.00	24.44	194.61	1533.60	81.61	-288.79	-80.75	1.30	1506965.29	3459032.77	40.713245	-103.844081
9 5/8" Casing	1607.00	24.35	193.79	1558.19	84.38	-299.60	-83.49	1.30	1506954.43	3459030.23	40.713216	-103.844091
First SLB MWD	1697.00	26.39	195.06	1639.51	94.11	-336.94	-93.11	2.35	1506916.92	3459021.31	40.713113	-103.844126
Survey	1786.00	28.09	196.92	1718.64	105.46	-376.09	-104.35	2.14	1506877.57	3459010.81	40.713006	-103.844166
	1876.00	30.10	199.70	1797.28	119.36	-417.61	-118.12	2.69	1506835.80	3458997.81	40.712892	-103.844216
	1965.00	32.11	202.44	1873.48	136.04	-460.49	-134.68	2.76	1506792.62	3458982.06	40.712774	-103.844276
	2055.00	33.95	193.41	1948.98	151.15	-507.08	-149.65	5.83	1506745.76	3458967.96	40.712646	-103.844330
	2145.00	37.06	194.86	2022.24	164.09	-557.75	-162.43	3.58	1506694.86	3458956.12	40.712507	-103.844376
	2234.00	37.77	196.54	2092.93	178.88	-609.80	-177.07	1.40	1506642.54	3458942.46	40.712364	-103.844429
	2324.00	40.05	198.21	2162.96	195.94	-663.74	-193.97	2.79	1506588.30	3458926.57	40.712216	-103.844490
	2413.00	41.91	194.47	2230.15	212.48	-719.73	-210.35	3.46	1506532.01	3458911.24	40.712062	-103.844549
	2502.00	44.04	192.62	2295.27	226.85	-778.71	-224.54	2.78	1506472.78	3458898.16	40.711901	-103.844600
	2592.00	44.22	195.33	2359.87	242.16	-839.51	-239.67	2.11	1506411.71	3458884.16	40.711734	-103.844655
	2682.00	44.33	194.98	2424.31	258.76	-900.16	-256.09	0.30	1506350.77	3458868.87	40.711567	-103.844714
	2771.00	44.53	195.38	2487.87	275.26	-960.28	-272.41	0.39	1506290.35	3458853.69	40.711402	-103.844773
	2861.00	44.42	195.38	2552.09	292.16	-1021.08	-289.13	0.12	1506229.25	3458838.10	40.711235	-103.844833
	2950.00	44.95	194.50	2615.37	308.47	-1081.55	-305.26	0.92	1506168.49	3458823.10	40.711069	-103.844891
	3040.00	44.61	195.58	2679.25	325.10	-1142.77	-321.71	0.93	1506106.97	3458807.80	40.710901	-103.844950
	3130.00	44.82	194.23	2743.21	341.57	-1203.96	-338.00	1.08	1506045.49	3458792.66	40.710733	-103.845009
	3219.00	45.49	195.20	2805.97	357.78	-1264.99	-354.03	1.08	1505984.17	3458777.77	40.710566	-103.845067
	3309.00	45.57	195.41	2869.02	374.92	-1326.94	-370.98	0.19	1505921.92	3458761.98	40.710396	-103.845128
	3398.00	45.46	195.62	2931.38	392.08	-1388.12	-387.97	0.21	1505860.43	3458746.14	40.710228	-103.845189
	3488.00	46.12	195.15	2994.14	409.38	-1450.32	-405.08	0.82	1505797.93	3458730.19	40.710057	-103.845251
	3578.00	46.38	196.01	3056.38	427.03	-1512.94	-422.54	0.75	1505734.99	3458713.90	40.709885	-103.845314
	3667.00	46.35	194.04	3117.80	443.91	-1575.15	-439.24	1.60	1505672.48	3458698.37	40.709715	-103.845374
	3757.00	46.20	195.66	3180.01	460.76	-1638.01	-455.91	1.31	1505609.32	3458682.88	40.709542	-103.845434
	3846.00	46.23	195.69	3241.59	478.31	-1699.87	-473.27	0.04	1505547.14	3458666.68	40.709372	-103.845497
	3936.00	46.08	192.52	3303.94	494.31	-1762.81	-489.08	2.55	1505483.92	3458652.04	40.709199	-103.845554
	4026.00	46.73	195.89	3366.01	510.50	-1825.98	-505.08	2.81	1505420.47	3458637.22	40.709026	-103.845612
	4115.00	46.15	195.35	3427.34	528.05	-1888.09	-522.45	0.79	1505358.05	3458621.92	40.708856	-103.845674
	4204.00	46.21	195.84	3488.97	545.50	-1949.94	-539.71	0.40	1505295.88	3458604.91	40.708686	-103.845737
	4294.00	45.83	196.30	3551.46	563.61	-2012.17	-557.64	0.56	1505233.33	3458588.15	40.708515	-103.845801
	4384.00	45.61	195.11	3614.30	581.23	-2074.20	-575.08	0.98	1505170.99	3458571.87	40.708345	-103.845864
	4473.00	45.72	193.39	3676.50	597.08	-2135.89	-590.75	1.39	1505109.01	3458555.37	40.708175	-103.845921
	4561.00	45.84	192.78	3737.87	611.54	-2197.32	-605.03	0.52	1505047.33	3458544.23	40.708007	-103.845972
	4651.00	45.36	192.68	3800.84	625.90	-2260.04	-619.20	0.54	1504984.35	3458531.24	40.707835	-103.846023
	4740.00	45.80	193.12	3863.13	640.27	-2322.00	-633.39	0.61	1504922.14	3458518.21	40.707665	-103.846075
	4830.00	45.74	192.73	3925.91	654.89	-2384.86	-647.81	0.32	1504859.03	3458504.96	40.707492	-103.846127
	4920.00	45.71	192.51	3988.74	669.15	-2447.74	-661.89	0.18	1504795.89	3458492.06	40.707320	-103.846177
	5009.00	45.78	192.54	4050.85	683.16	-2509.97	-675.72	0.08	1504733.42	3458479.40	40.707149	-103.846227
	5098.00	45.39	192.52	4113.14	697.14	-2572.03	-689.51	0.44	1504671.11	3458466.77	40.706978	-103.846277
	5188.00	45.64	193.27	4176.20	711.65	-2634.62	-703.84	0.66	1504608.27	3458453.61	40.706807	-103.846329
	5277.00	45.80	193.41	4238.34	726.54	-2696.62	-718.54	0.21	1504546.01	3458440.07	40.706636	-103.846382
	5367.00	45.46	193.54	4301.27	741.71	-2759.18	-733.53	0.39	1504483.18	3458426.25	40.706465	-103.846436
	5456.00	45.62	193.89	4363.61	756.96	-2820.89	-748.59	0.33	1504421.19	3458412.34	40.706295	-103.846490
	5546.00	45.71	193.71	4426.51	772.50	-2883.41	-763.95	0.17	1504358.40	3458398.16	40.706124	-103.846545
	5635.00	45.66	193.41	4488.68	787.61	-2945.31	-778.88	0.25	1504296.23	3458384.38	40.705954	-103.846599
	5725.00	45.58	193.89	4551.63	802.98	-3007.82	-794.06	0.39	1504233.45	3458370.37	40.705782	-103.846654
	5815.00	45.91	193.88	4614.44	818.63	-3070.40	-809.53	0.37	1504170.60	3458356.08	40.705610	-103.846710
	5904.00	45.64	193.53	4676.51	833.93	-3132.36	-824.64	0.41	1504108.36	3458342.13	40.705440	-103.846764
	5994.00	45.81	193.62	4739.34	849.24	-3195.00	-839.76	0.20	1504045.45	3458328.17	40.705268	-103.846819
	6083.00	45.67	194.56	4801.46	864.94	-3256.82	-855.28	0.77	1503983.36	3458313.82	40.705099	-103.846875
	6173.00	45.										

Comments	MD (ft)	Incl (°)	Azim True (°)	TVD (ft)	VSEC (ft)	NS (ft)	EW (ft)	DLS (°/100ft)	Northing (ftUS)	Easting (ftUS)	Latitude (°)	Longitude (°)
	6441.00	45.65	194.74	5051.83	930.56	-3504.35	-920.17	0.16	1503734.66	3458253.56	40.704419	-103.847109
	6531.00	45.67	194.83	5114.73	947.17	-3566.58	-936.60	0.07	1503672.13	3458238.30	40.704249	-103.847168
	6621.00	45.88	194.91	5177.50	963.91	-3628.92	-953.15	0.24	1503609.50	3458222.91	40.704077	-103.847228
	6710.00	45.74	193.90	5239.54	979.97	-3690.73	-969.02	0.83	1503547.41	3458208.20	40.703908	-103.847285
	6800.00	45.53	193.54	5302.47	995.42	-3753.23	-984.28	0.37	1503484.63	3458194.11	40.703736	-103.847340
	6889.00	46.61	197.41	5364.23	1012.71	-3814.97	-1001.40	3.36	1503422.58	3458178.15	40.703567	-103.847402
	6979.00	48.83	208.64	5424.88	1038.96	-3876.02	-1027.47	9.55	1503361.05	3458153.22	40.703399	-103.847496
	7069.00	50.63	219.41	5483.15	1077.52	-3932.73	-1065.86	9.34	1503303.64	3458115.90	40.703244	-103.847634
	7158.00	52.77	226.06	5538.34	1125.07	-3983.94	-1113.25	6.34	1503251.56	3458069.47	40.703103	-103.847805
	7248.00	56.70	233.19	5590.34	1181.19	-4031.39	-1169.23	7.80	1503203.06	3458014.39	40.702973	-103.848007
	7338.00	62.01	239.11	5636.23	1245.62	-4074.39	-1233.53	8.17	1503158.87	3457950.90	40.702855	-103.848239
	7427.00	67.39	244.44	5674.27	1316.60	-4122.34	-1304.41	8.11	1503119.61	3457890.75	40.702751	-103.848494
	7517.00	73.88	250.68	5704.13	1395.12	-4144.63	-1382.83	9.73	1503085.86	3457802.94	40.702662	-103.848777
	7606.00	79.49	255.82	5724.63	1478.08	-4169.52	-1465.71	8.44	1503059.42	3457720.54	40.702594	-103.849076
	7696.00	82.53	263.40	5738.71	1565.49	-4185.52	-1553.08	8.98	1503041.80	3457633.49	40.702550	-103.849391
	7786.00	85.00	271.35	5748.50	1654.80	-4189.60	-1642.37	9.20	1503036.05	3457544.29	40.702538	-103.849713
Cross Setback Heel (795' FSL, 2551' FWL)	7872.07	87.95	272.24	5753.79	1740.64	-4186.91	-1728.23	3.58	1503037.14	3457458.40	40.702546	-103.850023
	7875.00	88.05	272.27	5753.89	1743.57	-4186.79	-1731.15	3.58	1503037.20	3457455.47	40.702546	-103.850034
	7964.00	90.21	272.61	5755.24	1832.46	-4183.00	-1820.06	2.46	1503039.33	3457366.51	40.702556	-103.850354
	8054.00	90.32	272.50	5754.83	1922.36	-4178.99	-1909.97	0.17	1503041.66	3457276.55	40.702567	-103.850678
	8144.00	90.25	272.83	5754.38	2012.25	-4174.80	-1999.87	0.37	1503044.17	3457186.58	40.702579	-103.851003
	8233.00	90.14	272.81	5754.08	2101.12	-4170.43	-2088.76	0.13	1503046.88	3457097.63	40.702591	-103.851323
	8323.00	90.32	272.57	5753.72	2191.01	-4166.20	-2178.66	0.33	1503049.43	3457007.67	40.702603	-103.851648
	8412.00	90.11	272.36	5753.38	2279.92	-4162.37	-2267.58	0.33	1503051.59	3456918.69	40.702613	-103.851968
	8502.00	90.17	270.68	5753.16	2369.87	-4159.99	-2357.54	1.87	1503052.30	3456828.70	40.702620	-103.852293
	8591.00	90.34	270.28	5752.77	2458.87	-4159.24	-2446.54	0.49	1503051.38	3456739.71	40.702622	-103.852614
	8680.00	90.04	269.51	5752.47	2547.87	-4159.40	-2535.54	0.93	1503049.56	3456650.73	40.702621	-103.852935
	8770.00	90.52	269.51	5752.03	2637.86	-4160.17	-2625.53	0.53	1503047.11	3456560.76	40.702619	-103.853259
	8859.00	90.80	269.51	5751.01	2726.86	-4160.94	-2714.52	0.31	1503044.69	3456471.81	40.702617	-103.853580
	8949.00	91.25	269.42	5749.40	2816.84	-4161.78	-2804.50	0.51	1503042.17	3456381.86	40.702614	-103.853905
	9038.00	90.64	269.45	5747.93	2905.82	-4162.65	-2893.49	0.69	1503039.63	3456292.91	40.702612	-103.854226
	9128.00	90.66	269.06	5746.91	2995.81	-4163.82	-2983.47	0.43	1503036.78	3456202.96	40.702609	-103.854550
	9217.00	90.62	269.71	5745.91	3084.81	-4164.78	-3072.46	0.73	1503034.16	3456114.00	40.702606	-103.854871
	9307.00	90.84	269.68	5744.77	3174.80	-4165.26	-3162.25	0.25	1503032.00	3456024.04	40.702605	-103.855196
	9396.00	90.75	269.39	5743.53	3263.79	-4165.98	-3251.44	0.34	1503029.61	3455935.08	40.702603	-103.855517
	9486.00	90.79	269.99	5742.32	3353.78	-4166.47	-3341.43	0.67	1503027.45	3455845.12	40.702601	-103.855841
	9575.00	90.68	269.91	5741.18	3442.77	-4166.54	-3430.42	0.15	1503025.71	3455756.14	40.702601	-103.856162
	9665.00	90.58	269.93	5740.19	3532.77	-4166.67	-3520.42	0.11	1503023.90	3455666.17	40.702601	-103.856487
	9754.00	90.71	269.72	5739.19	3621.76	-4166.94	-3609.41	0.28	1503021.97	3455577.17	40.702600	-103.856808
	9844.00	90.50	269.50	5738.24	3711.75	-4167.55	-3699.41	0.34	1503019.67	3455487.23	40.702598	-103.857132
	9933.00	89.85	269.68	5737.97	3800.75	-4168.19	-3788.40	0.76	1503017.38	3455398.26	40.702597	-103.857453
	10023.00	89.65	269.40	5738.36	3890.75	-4168.91	-3878.40	0.38	1503014.97	3455308.30	40.702595	-103.857778
	10112.00	89.86	269.53	5738.74	3979.75	-4169.74	-3967.39	0.28	1503012.48	3455219.33	40.702592	-103.858099
	10202.00	89.77	269.97	5739.03	4069.75	-4170.14	-4057.39	0.50	1503010.41	3455129.36	40.702591	-103.858423
	10291.00	89.80	270.18	5739.36	4158.75	-4170.02	-4146.39	0.24	1503008.86	3455040.37	40.702591	-103.858744
	10381.00	89.63	269.85	5739.81	4248.74	-4170.00	-4236.39	0.41	1503007.20	3454950.39	40.702591	-103.859069
	10470.00	89.92	269.92	5740.16	4337.74	-4170.18	-4325.39	0.34	1503005.36	3454861.41	40.702591	-103.859390
	10560.00	89.48	270.11	5740.63	4427.74	-4170.15	-4415.39	0.53	1503003.70	3454771.43	40.702591	-103.859714
	10649.00	89.81	269.82	5741.18	4516.74	-4170.21	-4504.39	0.49	1503001.99	3454682.45	40.702591	-103.860035
	10739.00	91.92	270.32	5739.83	4606.72	-4170.10	-4594.37	2.41	1503000.42	3454592.48	40.702591	-103.860360
	10828.00	89.66	269.78	5738.60	4695.71	-4170.02	-4683.36	2.61	1502998.83	3454503.51	40.702591	-103.860681
	10918.00	90.13	269.43	5738.76	4785.71	-4170.64	-4773.35	0.65	1502996.53	3454413.54	40.702589	-103.861006
	11007.00	88.70	268.84	5739.67	4874.69	-4171.98	-4862.34	1.74	1502993.53	3454324.60	40.702586	-103.861326
	11097.00	88.47	269.13	5741.89	4964.65	-4173.58	-4952.29	0.41	1502990.25	3454234.69	40.702581	-103.861651
	11186.00	88.48	268.13	5744.26	5053.60	-4175.70	-5042.14	1.12	1502986.47	3454145.80	40.702575	-103.861972
	11276.00	88.50	268.92	5746.64	5143.55	-4178.02	-5131.17	0.88	1502982.47	3454055.92	40.702569	-103.862296
	11365.00	89.06	270.43	5748.53	5232.52	-4178.52	-5220.15	1.81	1502980.30	3453966.97	40.702567	-103.862617
	11455.00	90.01	270.73	5749.26	5322.51	-4177.61	-5310.14	1.11	1502979.53	3453876.98	40.702570	-103.862941
	11544.00	90.17	270.81	5749.12	5411.50	-4176.42	-5399.13	0.20	1502979.07	3453787.99	40.702573	-103.863262
	11634.00	88.93	269.78	5749.83	5501.49	-4175.95	-5489.13	1.79	1502977.85	3453698.00	40.702574	-103.863587
	11723.00	89.93	270.53	5750.71	5590.48	-4175.71	-5578.12	1.40	1502976.43	3453609.02	40.702575	-103.863908
	11812.00	89.30	269.97	5751.31	5679.48	-4175.33	-5667.12	0.95	1502975.16	3453520.03	40.702576	-103.864229
	11902.00	89.52	270.31	5752.24	5769.47	-4175.11	-5757.11	0.45	1502973.70	3453430.05	40.702576	-103.864554
	11991.00	89.15	269.80	5753.27	5858.47	-4175.02	-5846.10	0.71	1502972.12	3453341.07	40.702577	-103.864874
	12081.00	89.85	270.27	5754.06	5948.46	-4174.96	-5936.10	0.94	1502970.49	3453251.09	40.702577	-103.865199
	12171.00	89.65	269.97	5754.45	6038.46	-4174.78	-6026.10	0.40	1502969.00	3453161.11	40.702577	-103.865524
	12260.00	89.02	269.91	5755.48	6127.45	-4174.87	-6115.09	0.71	1502967.25	3453072.13	40.702577	-103.865848
	12350.00	89.42	269.90	5756.71	6217.44	-4175.02	-6205.08	0.44	1502965.42	3452982.16	40.702576	-103.866169
	12439.00	89.98	270.67	5757.17	6306.44	-4174.58	-6294.08	1.07	1502964.20	3452893.17	40.702578	-103.866490
	12529.00	89.73	270.23	5757.40	6396.43	-4173.87	-6384.08	0.56	1502963.22	3452803.18	40.702579	-103.866815
	12618.00	89.92	270.39	5757.67	6486.43	-4173.39	-6473.07	0.28	1502962.04	3452714.19	40.702581	-103.867136
	12708.00	89.99	270.26	5757.74	6576.43	-4172.88	-6563.07	0.16	1502960.87	3452624.20	40.702582	-103.867457
	12798.00	89.82	270.51	5757.89	6666.42	-4172.27	-6653.07	0.34	1502959.79	3452534.20	40.702584	-103.867778
	12887.00	89.58	270.48	5758.36	6754.41	-4171.50	-6742.07	0.27	1502958.90	3452444.21	40.702586	-103.868100
	12977.00	89.48	270.12	5759.10	6844.41	-4171.03	-6832.06	0.42	1502957.69	3452354.22	40.702587	-103.868420
	13066.00	89.58	270.17	5759.83	6934.40	-4170.81	-6921.06	0.13	1502956.25	3452264.24	40.702587	-103.868741
	13156.00	90.13	270.77	5760.05	7023.40	-4170.07	-7011.05	0.90	1502955.31	3452174.25		

Comments	MD (ft)	Incl (°)	Azim True (°)	TVD (ft)	VSEC (ft)	NS (ft)	EW (ft)	DLS (°/100ft)	Northing (ftUS)	Easting (ftUS)	Latitude (°)	Longitude (°)
	15933.00	89.92	269.00	5806.78	9799.62	-4161.05	-9787.32	0.10	1502912.48	3449400.33	40.702612	-103.879089
	16023.00	89.74	269.58	5807.05	9889.62	-4162.16	-9877.31	0.67	1502909.69	3449310.38	40.702608	-103.879413
	16112.00	89.58	269.40	5807.58	9978.62	-4162.95	-9966.31	0.27	1502907.23	3449221.41	40.702606	-103.879734
	16202.00	90.18	269.96	5807.76	10068.61	-4163.46	-10056.31	0.91	1502905.05	3449131.44	40.702605	-103.880059
	16291.00	89.88	268.68	5807.72	10157.61	-4164.51	-10145.30	1.48	1502902.33	3449042.49	40.702602	-103.880380
	16381.00	89.92	269.77	5807.87	10247.60	-4165.73	-10235.29	1.21	1502899.43	3448952.54	40.702598	-103.880704
	16471.00	89.27	268.95	5808.51	10337.60	-4166.74	-10325.28	1.16	1502896.75	3448862.58	40.702595	-103.881029
	16560.00	89.89	269.42	5809.16	10426.59	-4168.00	-10414.27	0.87	1502893.82	3448773.63	40.702592	-103.881350
	16649.00	89.76	269.38	5809.44	10515.58	-4168.93	-10503.26	0.15	1502891.23	3448684.67	40.702589	-103.881671
	16739.00	89.25	269.26	5810.21	10605.58	-4170.00	-10593.25	0.58	1502888.48	3448594.72	40.702586	-103.881995
	16828.00	89.87	269.52	5810.90	10694.57	-4170.95	-10682.24	0.76	1502885.87	3448505.76	40.702583	-103.882316
	16918.00	89.89	269.73	5811.08	10784.57	-4171.54	-10772.24	0.23	1502883.60	3448415.79	40.702582	-103.882641
	17008.00	90.15	268.75	5811.05	10874.56	-4172.73	-10862.23	1.13	1502880.72	3448325.84	40.702578	-103.882966
	17097.00	90.31	269.68	5810.70	10963.56	-4173.95	-10952.22	1.06	1502877.84	3448236.89	40.702575	-103.883287
	17187.00	89.68	269.34	5810.70	11053.56	-4174.72	-11042.22	0.80	1502875.39	3448146.92	40.702573	-103.883611
	17277.00	90.08	269.51	5810.89	11143.55	-4175.62	-11131.21	0.48	1502872.81	3448056.96	40.702570	-103.883936
	17366.00	90.14	269.26	5810.72	11232.55	-4176.58	-11220.21	0.29	1502870.19	3447968.00	40.702567	-103.884257
	17455.00	89.42	269.59	5811.06	11321.55	-4177.47	-11309.20	0.89	1502867.64	3447879.04	40.702565	-103.884578
	17545.00	89.43	269.52	5811.97	11411.54	-4178.17	-11399.19	0.08	1502865.26	3447789.08	40.702563	-103.884902
	17635.00	89.56	269.45	5812.76	11501.54	-4178.98	-11489.19	0.16	1502862.77	3447699.12	40.702560	-103.885227
	17724.00	89.66	269.53	5813.37	11590.53	-4179.77	-11578.18	0.14	1502860.31	3447610.15	40.702558	-103.885548
	17814.00	89.78	269.87	5813.81	11680.53	-4180.24	-11668.18	0.40	1502858.16	3447520.18	40.702557	-103.885872
	17903.00	89.94	269.88	5814.02	11769.53	-4180.44	-11757.18	0.18	1502856.31	3447431.20	40.702556	-103.886193
	17993.00	89.79	269.45	5814.23	11859.53	-4180.96	-11847.18	0.51	1502854.10	3447341.23	40.702554	-103.886518
	18082.00	89.48	269.70	5814.80	11948.53	-4181.62	-11936.17	0.45	1502851.78	3447252.27	40.702553	-103.886839
	18172.00	89.27	269.31	5815.78	12038.52	-4182.40	-12026.16	0.49	1502849.32	3447162.31	40.702550	-103.887163
	18262.00	89.11	269.33	5817.06	12128.51	-4183.47	-12116.15	0.18	1502846.57	3447072.36	40.702547	-103.887488
	18351.00	89.32	269.52	5818.28	12217.50	-4184.36	-12205.13	0.32	1502844.02	3446983.40	40.702545	-103.887809
	18441.00	89.49	269.51	5819.21	12307.49	-4185.13	-12295.13	0.19	1502841.57	3446893.44	40.702542	-103.888133
	18530.00	89.30	269.63	5820.15	12396.48	-4185.79	-12384.11	0.25	1502839.24	3446804.48	40.702540	-103.888454
	18620.00	89.45	269.82	5821.13	12486.48	-4186.22	-12474.11	0.27	1502837.13	3446714.51	40.702539	-103.888779
	18709.00	89.78	269.78	5821.73	12575.48	-4186.54	-12563.11	0.37	1502835.16	3446625.54	40.702538	-103.889100
	18799.00	89.64	269.77	5822.18	12665.47	-4186.89	-12653.11	0.16	1502833.12	3446535.56	40.702537	-103.889424
	18888.00	89.48	269.88	5822.87	12754.47	-4187.16	-12742.10	0.22	1502831.19	3446446.59	40.702536	-103.889745
	18978.00	89.34	269.75	5823.80	12844.47	-4187.45	-12832.10	0.21	1502829.22	3446356.61	40.702535	-103.890070
	19068.00	89.76	270.17	5824.50	12934.46	-4187.51	-12922.10	0.66	1502827.48	3446266.64	40.702535	-103.890395
	19157.00	89.86	270.11	5824.80	13023.46	-4187.30	-13011.10	0.13	1502826.03	3446177.65	40.702535	-103.890716
	19247.00	89.39	269.27	5825.39	13113.46	-4187.78	-13101.09	1.07	1502823.86	3446087.68	40.702534	-103.891040
	19336.00	89.02	269.50	5826.62	13202.45	-4188.74	-13190.08	0.49	1502821.25	3445998.73	40.702531	-103.891361
	19426.00	89.92	270.16	5827.45	13292.44	-4189.01	-13280.07	1.24	1502819.30	3445908.75	40.702530	-103.891686
	19515.00	90.59	270.20	5827.06	13381.44	-4188.73	-13369.07	0.75	1502817.92	3445819.77	40.702531	-103.892007
	19605.00	90.81	270.32	5825.96	13471.43	-4188.32	-13459.06	0.28	1502816.64	3445729.78	40.702532	-103.892331
	19694.00	90.38	269.98	5825.03	13560.42	-4188.08	-13548.06	0.62	1502815.21	3445640.80	40.702532	-103.892652
	19784.00	90.85	270.34	5824.07	13650.42	-4187.83	-13638.05	0.66	1502813.78	3445550.82	40.702533	-103.892977
	19873.00	90.37	269.97	5823.12	13739.41	-4187.59	-13727.04	0.68	1502812.36	3445461.84	40.702534	-103.893298
	19962.00	90.05	269.82	5822.79	13828.41	-4187.76	-13816.04	0.40	1502810.54	3445372.86	40.702533	-103.893619
	20052.00	90.08	269.75	5822.69	13918.41	-4188.09	-13906.04	0.08	1502808.52	3445282.88	40.702532	-103.893943
	20142.00	91.04	270.45	5821.81	14008.40	-4187.94	-13996.04	1.32	1502807.00	3445192.90	40.702532	-103.894268
	20231.00	90.08	269.95	5820.94	14097.39	-4187.63	-14085.03	1.22	1502805.64	3445103.92	40.702533	-103.894589
	20321.00	89.35	269.37	5821.39	14187.39	-4188.16	-14175.03	1.04	1502803.43	3445013.95	40.702531	-103.894913
	20410.00	89.82	270.34	5822.03	14276.39	-4188.39	-14264.02	1.21	1502801.54	3444924.98	40.702531	-103.895234
	20500.00	89.85	270.31	5822.29	14366.38	-4187.87	-14354.02	0.05	1502800.37	3444834.98	40.702532	-103.895559
	20589.00	89.71	270.00	5822.64	14455.38	-4187.63	-14443.02	0.38	1502798.95	3444746.00	40.702532	-103.895880
Cross Setback Toe (90' FSL, 300' FWL)	20670.17	89.71	270.03	5823.05	14536.55	-4187.61	-14524.19	0.03	1502797.45	3444656.84	40.702532	-103.896173
Last SLB MWD Survey	20679.00	89.71	270.03	5823.09	14545.38	-4187.61	-14533.02	0.03	1502797.29	3444656.02	40.702532	-103.896205
Projection to TD (90' FSL, 188' FWL)	20782.00	89.71	270.03	5823.61	14648.38	-4187.56	-14636.02	0.00	1502795.42	3444553.03	40.702532	-103.896576

Survey Type: Def Survey

Survey Error Model: ISCWSA Rev 3 *** 3-D 95.000% Confidence 2.7955 sigma
 Survey Program:

Description	Part	MD From (ft)	MD To (ft)	EOU Freq (ft)	Hole Size (in)	Casing Diameter (in)	Survey Tool Type	Borehole / Survey
	1	0.000	6.000	1/98.425	13.500	9.625	A001Mb_MWD-Depth Only	Speed Goat Fed 3432-08H / Speed Goat Fed 3432-08H
	1	6.000	21.000	Act Stns	13.500	9.625	A001Mb_MWD-Depth Only	Speed Goat Fed 3432-08H / Speed Goat Fed 3432-08H
	1	21.000	1545.000	Act Stns	13.500	9.625	A001Mb_MWD	Speed Goat Fed 3432-08H / Speed Goat Fed 3432-08H
	1	1545.000	20782.000	Act Stns	8.500	5.500	A010Mb_MWD+IFR1+SAG+MS	Speed Goat Fed 3432-08H / Speed Goat Fed 3432-08H / IFR1+MS+SAG 0' to 20782'

...Speed Goat Fed 3432-08H/Speed Goat Fed 3432-08H IFR1+MS+SAG 0' to 20782' Definitive