

# NOBLE ENERGY, INC

Location: COLORADO Slot: SLOT#03 BEEBE DRAW FEDERAL H15-764 (226'FSL & 1764'FWL,SEC.03)  
 Field: WELD COUNTY (NOBLE NAD 83 GRID) Well: BEEBE DRAW FEDERAL H15-764  
 Facility: SEC.03-T03N-R65W Wellbore: BEEBE DRAW FEDERAL H15-764 PWB

Plot reference wellpath is BEEBE DRAW FEDERAL H15-764 (REV-C.0) PWP  
 True vertical depths are referenced to (4804'GL+25'KB @4829'RKB) (RKB)  
 Reference wellpath measured depths are referenced to (4804'GL+25'KB @4829'RKB) (RKB)  
 (4804'GL+25'KB @4829'RKB) (RKB) to Mean Sea Level: 4829 feet  
 Mean Sea Level to Ground level (At Slot: SLOT#03 BEEBE DRAW FEDERAL H15-764 (226'FSL & 1764'FWL,SEC.03)): 0 feet  
 Offset wellpath MDs are referenced to each path's default MD datum

| Location Information  |              |              |                   |                    |                 |                 |
|---|--------------|--------------|-------------------|--------------------|-----------------|-----------------|
| Facility Name   |              |              | Grid East (US ft) | Grid North (US ft) | Latitude        | Longitude       |
| SEC.03-T03N-R65W  |              |              | 3000000.000       | 4454106.150        | 48°46'34.3150"N | 105°30'0.0000"W |
| Slot  | Local N (ft) | Local E (ft) | Grid East (US ft) | Grid North (US ft) | Latitude        | Longitude       |
| SLOT#03 BEEBE DRAW FEDERAL H15-764 (226'FSL & 1764'FWL,SEC.03)  | -3084064.54  | 233839.47    | 3236555.744       | 1334216.151        | 40°14'51.7884"N | 104°39'9.1080"W |
| (4804'GL+25'KB @4829'RKB) (RKB) to Ground level (At Slot: SLOT#03 BEEBE DRAW FEDERAL H15-764 (226'FSL & 1764'FWL,SEC.03)) |              |              |                   |                    | 4829ft          |                 |
| Mean Sea Level to Ground level (At Slot: SLOT#03 BEEBE DRAW FEDERAL H15-764 (226'FSL & 1764'FWL,SEC.03))                  |              |              |                   |                    | 0ft             |                 |
| (4804'GL+25'KB @4829'RKB) (RKB) to Mean Sea Level   |              |              |                   |                    | 4829ft          |                 |

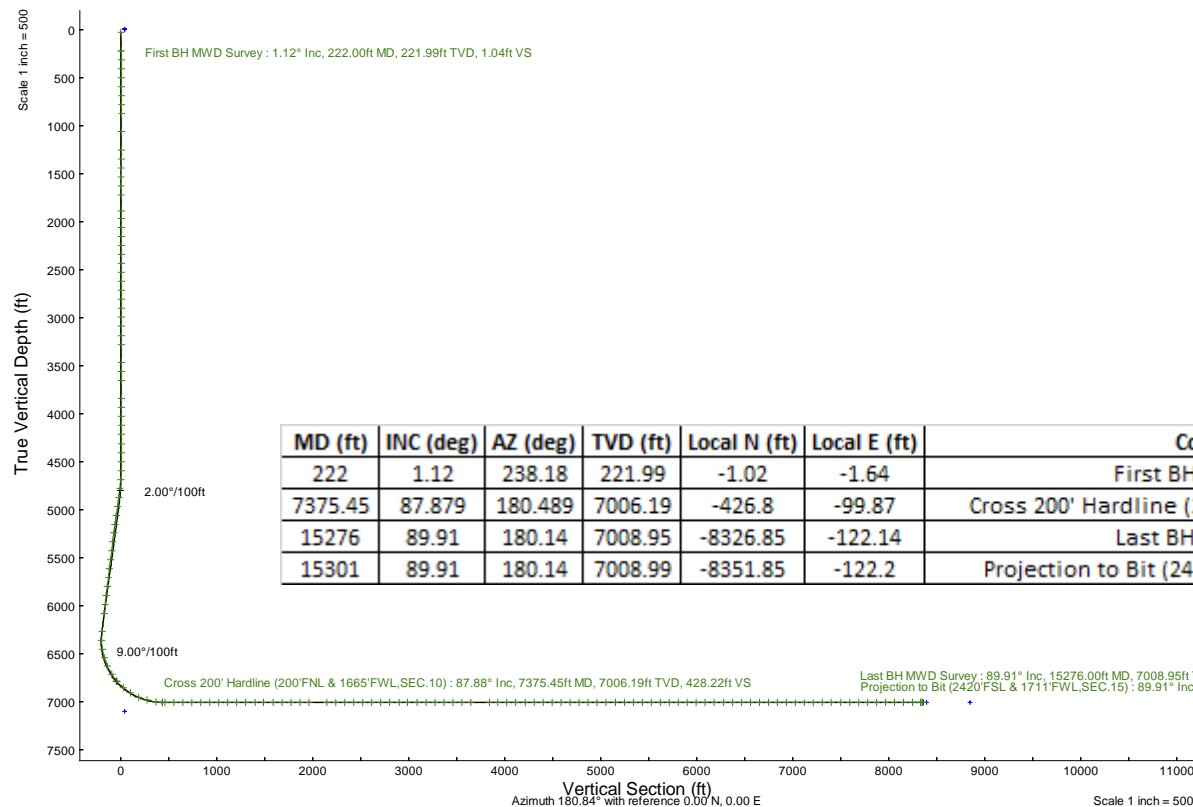
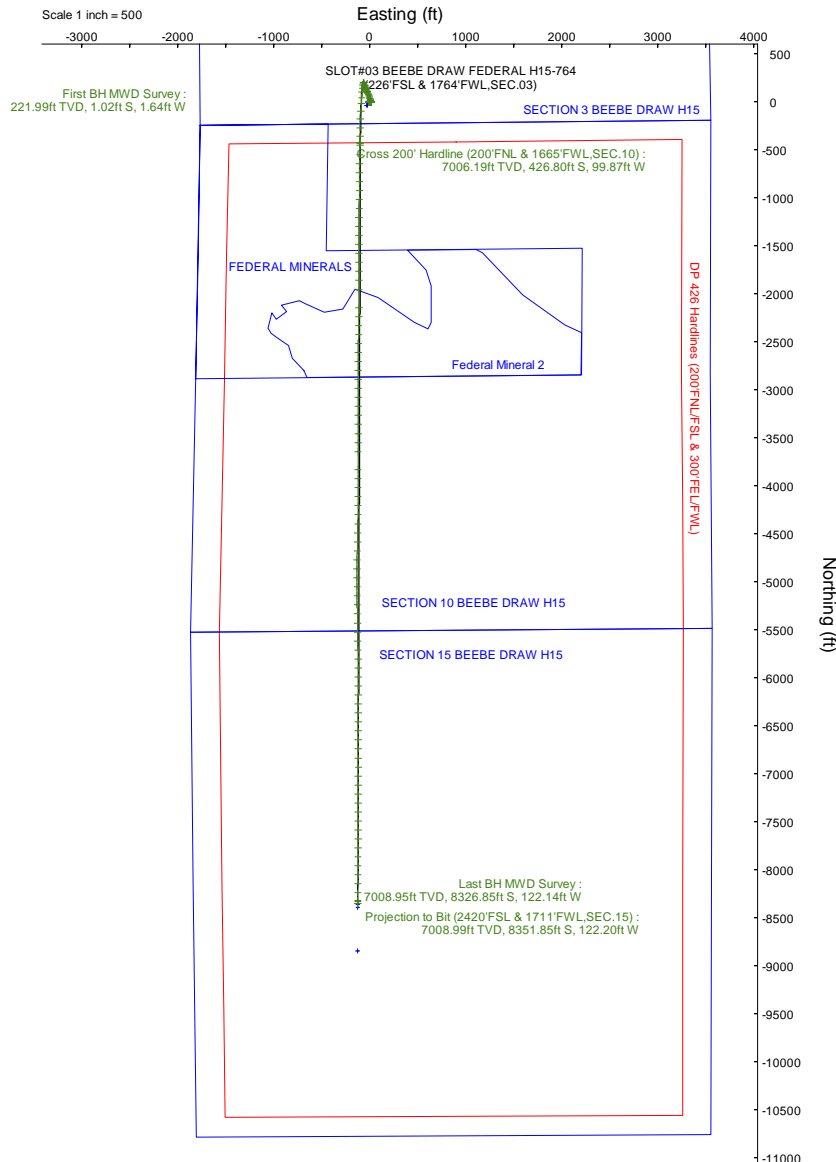

| MD (ft) | INC (deg) | AZ (deg) | TVD (ft) | Local N (ft) | Local E (ft) | Comment   |
|---------|-----------|----------|----------|--------------|--------------|---|
| 222     | 1.12      | 238.18   | 221.99   | -1.02        | -1.64        | First BH MWD Survey                             |
| 7375.45 | 87.879    | 180.489  | 7006.19  | -426.8       | -99.87       | Cross 200' Hardline (200'FNL & 1665'FWL,SEC.10) |
| 15276   | 89.91     | 180.14   | 7008.95  | -8326.85     | -122.14      | Last BH MWD Survey                              |
| 15301   | 89.91     | 180.14   | 7008.99  | -8351.85     | -122.2       | Projection to Bit (2420'FSL & 1711'FWL,SEC.15)  |

| REFERENCE WELLPATH IDENTIFICATION |  |           |                                |
|-----------------------------------|--|-----------|--------------------------------|
| Operator                          | NOBLE ENERGY, INC  | Well      | BEEBE DRAW FEDERAL H15-764     |
| Field                             | WELD COUNTY (NOBLE NAD 83 GRID)                                | API/Legal | 05-123-48847                   |
| Facility                          | SEC.03-T03N-R65W   | Wellbore  | BEEBE DRAW FEDERAL H15-764 AWB |
| Slot                              | SLOT#03 BEEBE DRAW FEDERAL H15-764 (226'FSL & 1764'FWL,SEC.03) |           |                                |

| REPORT SETUP INFORMATION |   |                  |                          |
|--------------------------|---|------------------|--------------------------|
| Projection System        | NAD83 / Lambert Colorado SP, Northern Zone (501), US feet | Software System  | WellArchitect® 6.0       |
| North Reference          | Grid  | User             | Martsam01                |
| Scale                    | 0.999957  | Report Generated | 7/23/2024 at 10:56:16 AM |
| Convergence at slot      | 0.55° East  | Database         | WA_Denver                |

| WELLPATH LOCATION     |                   |           |                  |                 |                        |               |
|-----------------------|-------------------|-----------|------------------|-----------------|------------------------|---------------|
|                       | Local coordinates |           | Grid coordinates |                 | Geographic coordinates |               |
|                       | North[ft]         | East[ft]  | Easting[US ft]   | Northing[US ft] | Latitude               | Longitude     |
| Slot Location         | -3084064.54       | 233839.47 | 3236555.74       | 1334216.15      | 40.2477190°            | -104.6525300° |
| Facility Reference Pt |                   |           | 3000000.00       | 4454105.15      | 48.7761986°            | -105.5000000° |
| Field Reference Pt    |                   |           | 3000000.00       | 4454105.15      | 48.7761986°            | -105.5000000° |

| WELLPATH DATUM           |                                |   |                   |
|--------------------------|--------------------------------|---|-------------------|
| Calculation method       | Minimum curvature              | (4804'GL+25'KB@4829'RKB) (RKB) to Facility Vertical Datum   | 4829.00ft         |
| Horizontal Reference Pt  | Slot                           | (4804'GL+25'KB@4829'RKB) (RKB) to Mean Sea Level  | 4829.00ft         |
| Vertical Reference Pt    | (4804'GL+25'KB@4829'RKB) (RKB) | (4804'GL+25'KB@4829'RKB) (RKB) to Ground Level at Slot (SLOT#03 BEEBE DRAW FEDERAL H15-764 (226'FSL & 1764'FWL,SEC.03)) | 4829.00ft         |
| MD Reference Pt          | (4804'GL+25'KB@4829'RKB) (RKB) | Section Origin  | N 0.00, E 0.00 ft |
| Field Vertical Reference | Mean Sea Level                 | Section Azimuth   | 180.84°           |

| REFERENCE WELLPATH IDENTIFICATION |  |           |                                |
|-----------------------------------|--|-----------|--------------------------------|
| Operator                          | NOBLE ENERGY, INC  | Well      | BEEBE DRAW FEDERAL H15-764     |
| Field                             | WELD COUNTY (NOBLE NAD 83 GRID)                                | API/Legal | 05-123-48847                   |
| Facility                          | SEC.03-T03N-R65W   | Wellbore  | BEEBE DRAW FEDERAL H15-764 AWB |
| Slot                              | SLOT#03 BEEBE DRAW FEDERAL H15-764 (226'FSL & 1764'FWL,SEC.03) |           |                                |

**WELLPATH DATA (159 stations)** † = interpolated, ‡ = extrapolated station

| MD [ft] | Inclination [°] | Azimuth [°] | TVD [ft] | Vert Sect [ft] | North [ft] | East [ft] | Latitude   | Longitude    | DLS [°/100ft] | Comments            |
|---------|-----------------|-------------|----------|----------------|------------|-----------|------------|--------------|---------------|---------------------|
| 0.00†   | 0.000           | 238.180     | 0.00     | 0.00           | 0.00       | 0.00      | 40.2477190 | -104.6525300 | 0.00          |                     |
| 25.00   | 0.000           | 238.180     | 25.00    | 0.00           | 0.00       | 0.00      | 40.2477190 | -104.6525300 | 0.00          |                     |
| 222.00  | 1.120           | 238.180     | 221.99   | 1.04           | -1.02      | -1.64     | 40.2477163 | -104.6525359 | 0.57          | First BH MWD Survey |
| 314.00  | 0.790           | 236.750     | 313.97   | 1.88           | -1.84      | -2.93     | 40.2477140 | -104.6525406 | 0.36          |                     |
| 408.00  | 0.950           | 231.270     | 407.96   | 2.74           | -2.68      | -4.08     | 40.2477118 | -104.6525447 | 0.19          |                     |
| 502.00  | 1.160           | 234.410     | 501.95   | 3.80           | -3.72      | -5.46     | 40.2477089 | -104.6525497 | 0.23          |                     |
| 595.00  | 1.090           | 227.710     | 594.93   | 4.96           | -4.86      | -6.88     | 40.2477058 | -104.6525548 | 0.16          |                     |
| 689.00  | 1.110           | 245.270     | 688.91   | 5.97           | -5.85      | -8.37     | 40.2477032 | -104.6525602 | 0.36          |                     |
| 782.00  | 0.310           | 103.510     | 781.91   | 6.41           | -6.28      | -8.94     | 40.2477020 | -104.6525623 | 1.47          |                     |
| 876.00  | 0.500           | 90.690      | 875.91   | 6.47           | -6.35      | -8.29     | 40.2477018 | -104.6525599 | 0.22          |                     |
| 1063.00 | 1.330           | 56.010      | 1062.88  | 5.23           | -5.14      | -5.67     | 40.2477050 | -104.6525505 | 0.51          |                     |
| 1251.00 | 1.510           | 68.710      | 1250.82  | 3.05           | -3.02      | -1.55     | 40.2477107 | -104.6525357 | 0.19          |                     |
| 1345.00 | 1.680           | 56.010      | 1344.79  | 1.79           | -1.80      | 0.74      | 40.2477140 | -104.6525274 | 0.42          |                     |
| 1439.00 | 2.130           | 59.600      | 1438.74  | 0.10           | -0.15      | 3.39      | 40.2477185 | -104.6525179 | 0.50          |                     |
| 1534.00 | 0.950           | 107.830     | 1533.70  | -0.59          | 0.50       | 5.66      | 40.2477202 | -104.6525097 | 1.74          |                     |
| 1628.00 | 1.010           | 108.330     | 1627.69  | -0.11          | 0.00       | 7.19      | 40.2477188 | -104.6525042 | 0.06          |                     |
| 1721.00 | 1.410           | 105.760     | 1720.67  | 0.43           | -0.57      | 9.07      | 40.2477172 | -104.6524975 | 0.43          |                     |
| 1888.00 | 1.410           | 130.780     | 1887.62  | 2.28           | -2.47      | 12.61     | 40.2477119 | -104.6524849 | 0.37          |                     |
| 1964.00 | 1.280           | 126.150     | 1963.60  | 3.37           | -3.58      | 14.00     | 40.2477088 | -104.6524800 | 0.22          |                     |
| 2058.00 | 0.180           | 275.540     | 2057.59  | 3.97           | -4.18      | 14.70     | 40.2477071 | -104.6524775 | 1.53          |                     |
| 2152.00 | 0.250           | 147.130     | 2151.59  | 4.12           | -4.34      | 14.66     | 40.2477067 | -104.6524776 | 0.41          |                     |
| 2246.00 | 0.250           | 119.920     | 2245.59  | 4.40           | -4.61      | 14.95     | 40.2477059 | -104.6524766 | 0.13          |                     |
| 2340.00 | 0.260           | 94.560      | 2339.59  | 4.51           | -4.73      | 15.34     | 40.2477056 | -104.6524752 | 0.12          |                     |
| 2434.00 | 0.110           | 228.950     | 2433.59  | 4.58           | -4.81      | 15.49     | 40.2477054 | -104.6524747 | 0.37          |                     |
| 2529.00 | 0.290           | 88.920      | 2528.59  | 4.64           | -4.87      | 15.66     | 40.2477052 | -104.6524741 | 0.40          |                     |
| 2622.00 | 0.320           | 155.820     | 2621.59  | 4.86           | -5.10      | 16.00     | 40.2477046 | -104.6524729 | 0.36          |                     |
| 2715.00 | 0.130           | 2.910       | 2714.59  | 4.99           | -5.23      | 16.11     | 40.2477042 | -104.6524725 | 0.47          |                     |
| 2809.00 | 0.240           | 131.390     | 2808.59  | 5.01           | -5.25      | 16.27     | 40.2477042 | -104.6524719 | 0.36          |                     |
| 2903.00 | 0.370           | 352.860     | 2902.59  | 4.84           | -5.08      | 16.38     | 40.2477046 | -104.6524715 | 0.61          |                     |
| 2997.00 | 0.160           | 157.730     | 2996.59  | 4.66           | -4.90      | 16.39     | 40.2477051 | -104.6524715 | 0.56          |                     |
| 3090.00 | 0.280           | 202.050     | 3089.58  | 4.99           | -5.23      | 16.35     | 40.2477042 | -104.6524716 | 0.21          |                     |
| 3184.00 | 0.220           | 222.680     | 3183.58  | 5.34           | -5.58      | 16.14     | 40.2477033 | -104.6524724 | 0.11          |                     |
| 3279.00 | 0.110           | 318.210     | 3278.58  | 5.41           | -5.64      | 15.96     | 40.2477031 | -104.6524730 | 0.27          |                     |
| 3465.00 | 0.150           | 7.960       | 3464.58  | 5.04           | -5.27      | 15.87     | 40.2477041 | -104.6524733 | 0.06          |                     |
| 3558.00 | 0.160           | 343.550     | 3557.58  | 4.79           | -5.03      | 15.85     | 40.2477048 | -104.6524734 | 0.07          |                     |
| 3653.00 | 0.110           | 185.100     | 3652.58  | 4.76           | -4.99      | 15.81     | 40.2477049 | -104.6524735 | 0.28          |                     |
| 3840.00 | 0.110           | 243.000     | 3839.58  | 5.02           | -5.25      | 15.63     | 40.2477042 | -104.6524742 | 0.06          |                     |
| 3934.00 | 0.410           | 142.400     | 3933.58  | 5.33           | -5.56      | 15.76     | 40.2477033 | -104.6524737 | 0.47          |                     |
| 4028.00 | 0.150           | 14.220      | 4027.58  | 5.47           | -5.70      | 15.99     | 40.2477029 | -104.6524729 | 0.55          |                     |
| 4122.00 | 0.040           | 33.900      | 4121.58  | 5.32           | -5.56      | 16.04     | 40.2477033 | -104.6524727 | 0.12          |                     |
| 4216.00 | 0.130           | 354.710     | 4215.58  | 5.19           | -5.42      | 16.05     | 40.2477037 | -104.6524727 | 0.11          |                     |
| 4311.00 | 0.100           | 3.900       | 4310.58  | 5.00           | -5.23      | 16.04     | 40.2477042 | -104.6524727 | 0.04          |                     |
| 4405.00 | 0.220           | 330.610     | 4404.58  | 4.76           | -4.99      | 15.96     | 40.2477049 | -104.6524730 | 0.16          |                     |
| 4499.00 | 0.240           | 31.810      | 4498.58  | 4.44           | -4.67      | 15.98     | 40.2477058 | -104.6524729 | 0.25          |                     |
| 4592.00 | 2.930           | 341.410     | 4591.54  | 2.03           | -2.25      | 15.32     | 40.2477124 | -104.6524752 | 2.99          |                     |

| REFERENCE WELLPATH IDENTIFICATION |  |           |                                |
|-----------------------------------|--|-----------|--------------------------------|
| Operator                          | NOBLE ENERGY, INC  | Well      | BEEBE DRAW FEDERAL H15-764     |
| Field                             | WELD COUNTY (NOBLE NAD 83 GRID)                                | API/Legal | 05-123-48847                   |
| Facility                          | SEC.03-T03N-R65W   | Wellbore  | BEEBE DRAW FEDERAL H15-764 AWB |
| Slot                              | SLOT#03 BEEBE DRAW FEDERAL H15-764 (226'FSL & 1764'FWL,SEC.03) |           |                                |

**WELLPATH DATA (159 stations)** † = interpolated, ‡ = extrapolated station

| MD [ft]  | Inclination [°] | Azimuth [°] | TVD [ft] | Vert Sect [ft] | North [ft] | East [ft] | Latitude   | Longitude    | DLS ["/100ft] | Comments  |
|----------|-----------------|-------------|----------|----------------|------------|-----------|------------|--------------|---------------|---|
| 4686.00  | 4.650           | 343.100     | 4685.33  | -3.87          | 3.67       | 13.45     | 40.2477287 | -104.6524817 | 1.83          |   |
| 4780.00  | 6.960           | 343.630     | 4778.84  | -12.94         | 12.78      | 10.74     | 40.2477538 | -104.6524911 | 2.46          |   |
| 4873.00  | 7.210           | 342.400     | 4871.13  | -23.86         | 23.75      | 7.38      | 40.2477840 | -104.6525027 | 0.31          |   |
| 4967.00  | 9.240           | 341.240     | 4964.16  | -36.56         | 36.52      | 3.17      | 40.2478192 | -104.6525174 | 2.17          |   |
| 5062.00  | 8.850           | 339.260     | 5057.98  | -50.55         | 50.58      | -1.87     | 40.2478579 | -104.6525350 | 0.53          |   |
| 5156.00  | 8.640           | 338.230     | 5150.88  | -63.79         | 63.90      | -7.05     | 40.2478946 | -104.6525531 | 0.28          |   |
| 5249.00  | 7.780           | 339.210     | 5242.93  | -76.09         | 76.27      | -11.87    | 40.2479287 | -104.6525699 | 0.94          |   |
| 5343.00  | 7.360           | 338.610     | 5336.11  | -87.58         | 87.82      | -16.33    | 40.2479605 | -104.6525855 | 0.45          |   |
| 5437.00  | 7.300           | 338.330     | 5429.34  | -98.67         | 98.98      | -20.73    | 40.2479912 | -104.6526009 | 0.07          |   |
| 5531.00  | 7.580           | 337.720     | 5522.55  | -109.89        | 110.27     | -25.29    | 40.2480223 | -104.6526168 | 0.31          |   |
| 5624.00  | 7.480           | 337.560     | 5614.75  | -121.09        | 121.54     | -29.92    | 40.2480534 | -104.6526330 | 0.11          |   |
| 5718.00  | 7.390           | 338.370     | 5707.96  | -132.29        | 132.81     | -34.49    | 40.2480845 | -104.6526490 | 0.15          |   |
| 5812.00  | 7.510           | 338.560     | 5801.16  | -143.56        | 144.15     | -38.96    | 40.2481157 | -104.6526646 | 0.13          |   |
| 5906.00  | 7.410           | 338.150     | 5894.37  | -154.84        | 155.49     | -43.46    | 40.2481469 | -104.6526804 | 0.12          |   |
| 5999.00  | 7.310           | 339.220     | 5986.60  | -165.88        | 166.59     | -47.79    | 40.2481775 | -104.6526955 | 0.18          |   |
| 6093.00  | 7.470           | 338.750     | 6079.82  | -177.10        | 177.88     | -52.13    | 40.2482086 | -104.6527106 | 0.18          |   |
| 6280.00  | 6.760           | 338.860     | 6265.38  | -198.57        | 199.47     | -60.50    | 40.2482681 | -104.6527399 | 0.38          |   |
| 6373.00  | 0.340           | 173.260     | 6358.17  | -203.37        | 204.31     | -62.45    | 40.2482814 | -104.6527467 | 7.62          |   |
| 6466.00  | 10.390          | 192.330     | 6450.65  | -194.86        | 195.82     | -64.21    | 40.2482582 | -104.6527533 | 10.83         |   |
| 6560.00  | 16.610          | 194.030     | 6542.01  | -173.45        | 174.49     | -69.28    | 40.2481998 | -104.6527722 | 6.63          |   |
| 6653.00  | 23.320          | 184.590     | 6629.39  | -142.10        | 143.20     | -73.98    | 40.2481140 | -104.6527901 | 7.98          |   |
| 6747.00  | 31.990          | 184.410     | 6712.57  | -98.60         | 99.74      | -77.39    | 40.2479948 | -104.6528038 | 9.22          |   |
| 6840.00  | 40.540          | 184.810     | 6787.49  | -43.76         | 44.96      | -81.83    | 40.2478446 | -104.6528216 | 9.20          |   |
| 6933.00  | 49.760          | 184.670     | 6853.01  | 21.95          | -20.68     | -87.27    | 40.2476645 | -104.6528433 | 9.91          |   |
| 7027.00  | 58.620          | 184.290     | 6907.95  | 97.95          | -96.60     | -93.20    | 40.2474563 | -104.6528672 | 9.43          |   |
| 7122.00  | 66.570          | 181.280     | 6951.65  | 182.16         | -180.76    | -97.22    | 40.2472254 | -104.6528844 | 8.83          |   |
| 7215.00  | 75.050          | 180.300     | 6982.19  | 269.91         | -268.50    | -98.41    | 40.2469846 | -104.6528917 | 9.17          |   |
| 7309.00  | 82.400          | 180.680     | 7000.56  | 362.03         | -360.62    | -99.20    | 40.2467318 | -104.6528977 | 7.83          |   |
| 7375.45† | 87.879          | 180.489     | 7006.19  | 428.22         | -426.80    | -99.87    | 40.2465501 | -104.6529024 | 8.25          | Cross 200' Hardline (200'FNL & 1665'FWL,SEC.10) |
| 7378.00‡ | 88.089          | 180.481     | 7006.28  | 430.77         | -429.35    | -99.89    | 40.2465431 | -104.6529025 | 8.25          | Shallowest MD for Perf                          |
| 7403.00  | 90.150          | 180.410     | 7006.66  | 455.76         | -454.35    | -100.09   | 40.2464745 | -104.6529041 | 8.25          |   |
| 7497.00  | 89.880          | 180.780     | 7006.64  | 549.76         | -548.34    | -101.06   | 40.2462165 | -104.6529108 | 0.49          |   |
| 7591.00  | 90.490          | 182.220     | 7006.33  | 643.75         | -642.31    | -103.53   | 40.2459587 | -104.6529228 | 1.66          |   |
| 7685.00  | 89.850          | 180.160     | 7006.05  | 737.74         | -736.28    | -105.48   | 40.2457008 | -104.6529330 | 2.29          |   |
| 7778.00  | 90.120          | 180.670     | 7006.08  | 830.74         | -829.28    | -106.15   | 40.2454455 | -104.6529386 | 0.62          |   |
| 7872.00  | 90.150          | 180.690     | 7005.86  | 924.74         | -923.27    | -107.27   | 40.2451876 | -104.6529458 | 0.04          |   |
| 7965.00  | 89.970          | 180.420     | 7005.76  | 1017.74        | -1016.27   | -108.17   | 40.2449323 | -104.6529522 | 0.35          |   |
| 8059.00  | 90.090          | 180.370     | 7005.71  | 1111.74        | -1110.26   | -108.82   | 40.2446744 | -104.6529578 | 0.14          |   |
| 8153.00  | 90.220          | 180.430     | 7005.46  | 1205.73        | -1204.26   | -109.47   | 40.2444164 | -104.6529634 | 0.15          |   |
| 8247.00  | 90.000          | 180.230     | 7005.28  | 1299.73        | -1298.26   | -110.01   | 40.2441584 | -104.6529685 | 0.32          |   |
| 8341.00  | 90.030          | 180.200     | 7005.25  | 1393.72        | -1392.26   | -110.37   | 40.2439004 | -104.6529730 | 0.05          |   |
| 8434.00  | 89.940          | 180.260     | 7005.28  | 1486.72        | -1485.26   | -110.74   | 40.2436451 | -104.6529775 | 0.12          |   |
| 8528.00  | 89.880          | 180.230     | 7005.42  | 1580.71        | -1579.26   | -111.14   | 40.2433871 | -104.6529822 | 0.07          |   |
| 8622.00  | 89.910          | 180.370     | 7005.60  | 1674.71        | -1673.25   | -111.63   | 40.2431291 | -104.6529871 | 0.15          |   |
| 8716.00  | 89.820          | 180.130     | 7005.82  | 1768.70        | -1767.25   | -112.04   | 40.2428711 | -104.6529918 | 0.27          |   |

| REFERENCE WELLPATH IDENTIFICATION |  |           |                                |
|-----------------------------------|--|-----------|--------------------------------|
| Operator                          | NOBLE ENERGY, INC  | Well      | BEEBE DRAW FEDERAL H15-764     |
| Field                             | WELD COUNTY (NOBLE NAD 83 GRID)                                | API/Legal | 05-123-48847                   |
| Facility                          | SEC.03-T03N-R65W   | Wellbore  | BEEBE DRAW FEDERAL H15-764 AWB |
| Slot                              | SLOT#03 BEEBE DRAW FEDERAL H15-764 (226'FSL & 1764'FWL,SEC.03) |           |                                |

### WELLPATH DATA (159 stations)

| MD [ft]  | Inclination [°] | Azimuth [°] | TVD [ft] | Vert Sect [ft] | North [ft] | East [ft] | Latitude   | Longitude    | DLS [°/100ft] | Comments |
|----------|-----------------|-------------|----------|----------------|------------|-----------|------------|--------------|---------------|----------|
| 8810.00  | 90.090          | 180.380     | 7005.89  | 1862.70        | -1861.25   | -112.46   | 40.2426131 | -104.6529965 | 0.39          |          |
| 8904.00  | 89.880          | 180.140     | 7005.91  | 1956.69        | -1955.25   | -112.89   | 40.2423551 | -104.6530013 | 0.34          |          |
| 9093.00  | 89.880          | 180.260     | 7006.31  | 2145.68        | -2144.25   | -113.55   | 40.2418363 | -104.6530101 | 0.06          |          |
| 9186.00  | 90.030          | 180.230     | 7006.38  | 2238.68        | -2237.25   | -113.95   | 40.2415811 | -104.6530147 | 0.16          |          |
| 9280.00  | 89.940          | 180.250     | 7006.41  | 2332.67        | -2331.25   | -114.34   | 40.2413231 | -104.6530193 | 0.10          |          |
| 9372.00  | 89.880          | 180.190     | 7006.55  | 2424.67        | -2423.25   | -114.69   | 40.2410706 | -104.6530238 | 0.09          |          |
| 9466.00  | 90.150          | 180.550     | 7006.53  | 2518.66        | -2517.24   | -115.30   | 40.2408126 | -104.6530292 | 0.48          |          |
| 9560.00  | 90.090          | 180.250     | 7006.33  | 2612.66        | -2611.24   | -115.96   | 40.2405546 | -104.6530347 | 0.33          |          |
| 9653.00  | 90.030          | 180.510     | 7006.23  | 2705.66        | -2704.24   | -116.57   | 40.2402993 | -104.6530401 | 0.29          |          |
| 9747.00  | 89.850          | 180.130     | 7006.33  | 2799.65        | -2798.24   | -117.10   | 40.2400413 | -104.6530452 | 0.45          |          |
| 9841.00  | 89.690          | 180.080     | 7006.71  | 2893.64        | -2892.24   | -117.27   | 40.2397833 | -104.6530490 | 0.18          |          |
| 9934.00  | 90.250          | 180.360     | 7006.76  | 2986.64        | -2985.24   | -117.63   | 40.2395281 | -104.6530535 | 0.67          |          |
| 10029.00 | 90.310          | 180.370     | 7006.29  | 3081.63        | -3080.23   | -118.23   | 40.2392673 | -104.6530589 | 0.06          |          |
| 10122.00 | 90.120          | 180.170     | 7005.95  | 3174.63        | -3173.23   | -118.67   | 40.2390121 | -104.6530637 | 0.30          |          |
| 10216.00 | 89.880          | 180.380     | 7005.95  | 3268.62        | -3267.23   | -119.12   | 40.2387541 | -104.6530685 | 0.34          |          |
| 10310.00 | 90.060          | 180.500     | 7005.99  | 3362.62        | -3361.23   | -119.84   | 40.2384961 | -104.6530743 | 0.23          |          |
| 10404.00 | 89.850          | 180.150     | 7006.07  | 3456.62        | -3455.23   | -120.38   | 40.2382381 | -104.6530794 | 0.43          |          |
| 10497.00 | 89.600          | 180.150     | 7006.51  | 3549.61        | -3548.22   | -120.62   | 40.2379828 | -104.6530835 | 0.27          |          |
| 10592.00 | 89.750          | 180.370     | 7007.05  | 3644.60        | -3643.22   | -121.05   | 40.2377221 | -104.6530883 | 0.28          |          |
| 10781.00 | 89.910          | 179.760     | 7007.61  | 3833.58        | -3832.22   | -121.27   | 40.2372033 | -104.6530955 | 0.33          |          |
| 10874.00 | 89.880          | 180.170     | 7007.78  | 3926.57        | -3925.22   | -121.21   | 40.2369480 | -104.6530985 | 0.44          |          |
| 10967.00 | 89.910          | 179.720     | 7007.96  | 4019.56        | -4018.22   | -121.12   | 40.2366928 | -104.6531013 | 0.48          |          |
| 11060.00 | 90.030          | 180.130     | 7008.00  | 4112.55        | -4111.22   | -121.00   | 40.2364375 | -104.6531041 | 0.46          |          |
| 11155.00 | 89.940          | 179.960     | 7008.03  | 4207.54        | -4206.22   | -121.07   | 40.2361767 | -104.6531076 | 0.20          |          |
| 11250.00 | 89.880          | 180.290     | 7008.18  | 4302.53        | -4301.22   | -121.28   | 40.2359160 | -104.6531116 | 0.35          |          |
| 11344.00 | 90.000          | 180.740     | 7008.28  | 4396.53        | -4395.21   | -122.12   | 40.2356580 | -104.6531178 | 0.50          |          |
| 11438.00 | 90.000          | 180.480     | 7008.28  | 4490.53        | -4489.21   | -123.13   | 40.2354000 | -104.6531246 | 0.28          |          |
| 11532.00 | 90.340          | 182.830     | 7008.00  | 4584.51        | -4583.16   | -125.84   | 40.2351422 | -104.6531376 | 2.53          |          |
| 11625.00 | 89.780          | 180.150     | 7007.90  | 4677.50        | -4676.12   | -128.26   | 40.2348871 | -104.6531494 | 2.94          |          |
| 11719.00 | 90.060          | 182.210     | 7008.03  | 4771.49        | -4770.10   | -130.19   | 40.2346292 | -104.6531596 | 2.21          |          |
| 11813.00 | 89.750          | 179.260     | 7008.19  | 4865.48        | -4864.08   | -131.40   | 40.2343713 | -104.6531671 | 3.16          |          |
| 11907.00 | 89.970          | 179.040     | 7008.42  | 4959.44        | -4958.07   | -130.00   | 40.2341133 | -104.6531653 | 0.33          |          |
| 12001.00 | 89.750          | 179.860     | 7008.65  | 5053.41        | -5052.06   | -129.10   | 40.2338552 | -104.6531653 | 0.90          |          |
| 12095.00 | 89.910          | 180.200     | 7008.93  | 5147.40        | -5146.06   | -129.15   | 40.2335972 | -104.6531687 | 0.40          |          |
| 12189.00 | 90.150          | 179.260     | 7008.88  | 5241.38        | -5240.06   | -128.71   | 40.2333392 | -104.6531703 | 1.03          |          |
| 12283.00 | 90.150          | 179.370     | 7008.63  | 5335.35        | -5334.05   | -127.58   | 40.2330812 | -104.6531695 | 0.12          |          |
| 12377.00 | 89.910          | 178.920     | 7008.58  | 5429.31        | -5428.04   | -126.18   | 40.2328231 | -104.6531677 | 0.54          |          |
| 12471.00 | 90.150          | 179.100     | 7008.53  | 5523.26        | -5522.03   | -124.56   | 40.2325651 | -104.6531651 | 0.32          |          |
| 12565.00 | 90.000          | 179.130     | 7008.41  | 5617.22        | -5616.02   | -123.11   | 40.2323071 | -104.6531631 | 0.16          |          |
| 12658.00 | 90.000          | 178.910     | 7008.41  | 5710.17        | -5709.00   | -121.52   | 40.2320518 | -104.6531606 | 0.24          |          |
| 12752.00 | 90.090          | 179.470     | 7008.33  | 5804.13        | -5802.99   | -120.19   | 40.2317938 | -104.6531591 | 0.60          |          |
| 12846.00 | 89.970          | 179.030     | 7008.29  | 5898.09        | -5896.98   | -118.96   | 40.2315358 | -104.6531579 | 0.49          |          |
| 12939.00 | 89.940          | 179.190     | 7008.36  | 5991.05        | -5989.97   | -117.51   | 40.2312805 | -104.6531559 | 0.18          |          |
| 13033.00 | 90.030          | 179.300     | 7008.38  | 6085.01        | -6083.96   | -116.27   | 40.2310225 | -104.6531546 | 0.15          |          |
| 13128.00 | 90.120          | 180.360     | 7008.26  | 6180.00        | -6178.96   | -115.99   | 40.2307617 | -104.6531569 | 1.12          |          |

| REFERENCE WELLPATH IDENTIFICATION |  |           |                                |
|-----------------------------------|--|-----------|--------------------------------|
| Operator                          | NOBLE ENERGY, INC  | Well      | BEEBE DRAW FEDERAL H15-764     |
| Field                             | WELD COUNTY (NOBLE NAD 83 GRID)                                | API/Legal | 05-123-48847                   |
| Facility                          | SEC.03-T03N-R65W   | Wellbore  | BEEBE DRAW FEDERAL H15-764 AWB |
| Slot                              | SLOT#03 BEEBE DRAW FEDERAL H15-764 (226'FSL & 1764'FWL,SEC.03) |           |                                |

**WELLPATH DATA (159 stations)** † = interpolated, ‡ = extrapolated station

| MD [ft]   | Inclination [°] | Azimuth [°] | TVD [ft] | Vert Sect [ft] | North [ft] | East [ft] | Latitude   | Longitude    | DLS ["/100ft] | Comments                                       |
|-----------|-----------------|-------------|----------|----------------|------------|-----------|------------|--------------|---------------|--|
| 13222.00  | 90.090          | 180.120     | 7008.09  | 6273.99        | -6272.96   | -116.38   | 40.2305037 | -104.6531615 | 0.26          |  |
| 13316.00  | 89.970          | 179.970     | 7008.04  | 6367.98        | -6366.96   | -116.46   | 40.2302457 | -104.6531650 | 0.20          |  |
| 13410.00  | 89.940          | 180.060     | 7008.11  | 6461.97        | -6460.96   | -116.48   | 40.2299877 | -104.6531683 | 0.10          |  |
| 13503.00  | 90.120          | 180.080     | 7008.06  | 6554.97        | -6553.96   | -116.60   | 40.2297324 | -104.6531719 | 0.19          |  |
| 13596.00  | 90.000          | 180.160     | 7007.97  | 6647.96        | -6646.96   | -116.79   | 40.2294771 | -104.6531758 | 0.16          |  |
| 13690.00  | 90.250          | 180.120     | 7007.76  | 6741.95        | -6740.96   | -117.02   | 40.2292191 | -104.6531798 | 0.27          |  |
| 13784.00  | 90.030          | 180.060     | 7007.53  | 6835.94        | -6834.96   | -117.17   | 40.2289611 | -104.6531835 | 0.24          |  |
| 13878.00  | 88.860          | 178.100     | 7008.44  | 6929.89        | -6928.94   | -115.66   | 40.2287031 | -104.6531813 | 2.43          |  |
| 13972.00  | 90.180          | 182.940     | 7009.23  | 7023.85        | -7022.90   | -116.51   | 40.2284452 | -104.6531876 | 5.34          |  |
| 14066.00  | 90.000          | 179.980     | 7009.08  | 7117.84        | -7116.86   | -118.91   | 40.2281874 | -104.6531994 | 3.15          |  |
| 14160.00  | 90.030          | 180.090     | 7009.06  | 7211.83        | -7210.86   | -118.97   | 40.2279294 | -104.6532028 | 0.12          |  |
| 14254.00  | 90.120          | 180.180     | 7008.93  | 7305.82        | -7304.86   | -119.19   | 40.2276714 | -104.6532068 | 0.14          |  |
| 14348.00  | 89.940          | 180.160     | 7008.88  | 7399.81        | -7398.86   | -119.47   | 40.2274134 | -104.6532110 | 0.19          |  |
| 14442.00  | 90.000          | 180.040     | 7008.93  | 7493.81        | -7492.86   | -119.63   | 40.2271554 | -104.6532149 | 0.14          |  |
| 14535.00  | 90.120          | 180.260     | 7008.84  | 7586.80        | -7585.86   | -119.87   | 40.2269001 | -104.6532189 | 0.27          |  |
| 14629.00  | 90.090          | 180.240     | 7008.66  | 7680.79        | -7679.86   | -120.28   | 40.2266421 | -104.6532236 | 0.04          |  |
| 14722.00  | 89.970          | 180.170     | 7008.62  | 7773.79        | -7772.86   | -120.62   | 40.2263868 | -104.6532280 | 0.15          |  |
| 14815.00  | 89.910          | 180.080     | 7008.71  | 7866.78        | -7865.86   | -120.82   | 40.2261316 | -104.6532319 | 0.12          |  |
| 14909.00  | 89.910          | 180.230     | 7008.86  | 7960.77        | -7959.86   | -121.07   | 40.2258736 | -104.6532360 | 0.16          |  |
| 15002.00  | 90.060          | 180.150     | 7008.88  | 8053.77        | -8052.85   | -121.38   | 40.2256183 | -104.6532403 | 0.18          |  |
| 15096.00  | 90.060          | 180.140     | 7008.79  | 8147.76        | -8146.85   | -121.62   | 40.2253603 | -104.6532443 | 0.01          |  |
| 15190.00  | 89.910          | 180.190     | 7008.81  | 8241.76        | -8240.85   | -121.89   | 40.2251023 | -104.6532485 | 0.17          |  |
| 15276.00  | 89.910          | 180.140     | 7008.95  | 8327.75        | -8326.85   | -122.14   | 40.2248662 | -104.6532524 | 0.06          | Last BH MWD Survey                             |
| 15301.00‡ | 89.910          | 180.140     | 7008.99  | 8352.75        | -8351.85   | -122.20   | 40.2247976 | -104.6532534 | 0.00          | Projection to Bit (2420'FSL & 1711'FWL,SEC.15) |

| REFERENCE WELLPATH IDENTIFICATION |  |           |                                |
|-----------------------------------|--|-----------|--------------------------------|
| Operator                          | NOBLE ENERGY, INC  | Well      | BEEBE DRAW FEDERAL H15-764     |
| Field                             | WELD COUNTY (NOBLE NAD 83 GRID)                                | API/Legal | 05-123-48847                   |
| Facility                          | SEC.03-T03N-R65W   | Wellbore  | BEEBE DRAW FEDERAL H15-764 AWB |
| Slot                              | SLOT#03 BEEBE DRAW FEDERAL H15-764 (226'FSL & 1764'FWL,SEC.03) |           |                                |

| TARGETS   |                                       |            |           |                   |                    |                   |                     |         |
|---|---------------------------------------|------------|-----------|-------------------|--------------------|-------------------|---------------------|---------|
| Name  | TVD [ft]                              | North [ft] | East [ft] | Grid East [US ft] | Grid North [US ft] | Latitude          | Longitude           | Shape   |
| BEEBE DRAW H15-783 FEDERAL MINERALS                                       | -5.00                                 | -36.33     | -27.57    | 3236528.18        | 1334179.82         | 40.2476200        | -104.6526300        | polygon |
|   | 2D Polygon: dimensions not calculated |            |           |                   |                    |                   |                     |         |
| Federal Mineral 2   | -5.00                                 | -36.33     | -27.57    | 3236528.18        | 1334179.82         | 40.2476200        | -104.6526300        | polygon |
|   | 2D Polygon: dimensions not calculated |            |           |                   |                    |                   |                     |         |
| SECTION 10 BEEBE DRAW H15-783   | -5.00                                 | -36.33     | -27.57    | 3236528.18        | 1334179.82         | 40.2476200        | -104.6526300        | polygon |
|   | 2D Polygon: dimensions not calculated |            |           |                   |                    |                   |                     |         |
| SECTION 15 BEEBE DRAW H15-783   | -5.00                                 | -36.33     | -27.57    | 3236528.18        | 1334179.82         | 40.2476200        | -104.6526300        | polygon |
|   | 2D Polygon: dimensions not calculated |            |           |                   |                    |                   |                     |         |
| SECTION 3 BEEBE DRAW H15-783  | -5.00                                 | -36.33     | -27.57    | 3236528.18        | 1334179.82         | 40.2476200        | -104.6526300        | polygon |
|   | 2D Polygon: dimensions not calculated |            |           |                   |                    |                   |                     |         |
| BEEBE DRAW FEDERAL H15-764 BHL Rev-2 (2417'FSL & 1705'FWL,SEC.15)         | 7006.00                               | -8357.65   | -122.44   | <b>3236433.31</b> | <b>1325858.88</b>  | 40.2247817        | -104.6532545        | point   |
| BEEBE DRAW FEDERAL H15-764 LP /Plan (200'FNL & 1669'FWL,SEC.10)           | 7006.00                               | -426.68    | -95.52    | 3236460.22        | 1333789.49         | 40.2465503        | -104.6528868        | point   |
| BEEBE DRAW FEDERAL H15-764 REV-2 LP on Plat(200'FNL & 1669'FWL,SEC.10)    | 7006.00                               | -426.80    | -95.58    | 3236460.17        | 1333789.37         | <b>40.2465500</b> | <b>-104.6528870</b> | point   |
| BEEBE DRAW FEDERAL H15-764 Rev-3 BHL on Plat (2414'FSL & 1711'FWL,SEC.15) | 7006.00                               | -8357.54   | -122.31   | 3236433.44        | 1325858.99         | <b>40.2247820</b> | <b>-104.6532540</b> | point   |
| BEEBE DRAW H15-764 BHL Plan (1930'FSL & 1703'FWL,SEC.15)                  | 7006.00                               | -8843.46   | -124.08   | 3236431.67        | 1325373.09         | 40.2234483        | -104.6532770        | point   |
| BEEBE DRAW H15-764 BHL Plan (2381'FSL & 1705'FWL,SEC.15)                  | 7006.00                               | -8391.77   | -122.55   | 3236433.20        | 1325824.76         | 40.2246881        | -104.6532561        | point   |
| DP 426 Hardlines (200'FNL/FSL & 300'FEL/FWL)                              | 7100.00                               | -36.33     | -27.57    | 3236528.18        | 1334179.82         | 40.2476200        | -104.6526300        | polygon |
|   | 2D Polygon: dimensions not calculated |            |           |                   |                    |                   |                     |         |

| REFERENCE WELLPATH IDENTIFICATION |  |           |                                |
|-----------------------------------|--|-----------|--------------------------------|
| Operator                          | NOBLE ENERGY, INC  | Well      | BEEBE DRAW FEDERAL H15-764     |
| Field                             | WELD COUNTY (NOBLE NAD 83 GRID)                                | API/Legal | 05-123-48847                   |
| Facility                          | SEC.03-T03N-R65W   | Wellbore  | BEEBE DRAW FEDERAL H15-764 AWB |
| Slot                              | SLOT#03 BEEBE DRAW FEDERAL H15-764 (226'FSL & 1764'FWL,SEC.03) |           |                                |

| WELLPATH COMPOSITION - Ref Wellbore: BEEBE DRAW FEDERAL H15-764 AWB Ref Wellpath: BEEBE DRAW FEDERAL H15-764 AWP |             |                              |   |                                |             |
|--|-------------|------------------------------|---|--------------------------------|-------------|
| Start MD [ft]  | End MD [ft] | Positional Uncertainty Model | Log Name/Comment  | Wellbore                       | Survey Date |
| 25.00  | 1888.00     | OWSG MWD rev2 - Standard     | 13.5" EVO Surface OWSG MWD rev2 (Standard) <222'-1888'> | BEEBE DRAW FEDERAL H15-764 AWB | 6/16/2024   |
| 1888.00  | 15301.00    | OWSG MWD rev2 (MS+IFR1)      | 8.5" ATC Lucida OWSG MWD rev2 (MS+IFR1) <1964'-15276'>  | BEEBE DRAW FEDERAL H15-764 AWB | 6/16/2024   |

| REFERENCE WELLPATH IDENTIFICATION |  |           |                                |
|-----------------------------------|--|-----------|--------------------------------|
| Operator                          | NOBLE ENERGY, INC  | Well      | BEEBE DRAW FEDERAL H15-764     |
| Field                             | WELD COUNTY (NOBLE NAD 83 GRID)                                | API/Legal | 05-123-48847                   |
| Facility                          | SEC.03-T03N-R65W   | Wellbore  | BEEBE DRAW FEDERAL H15-764 AWB |
| Slot                              | SLOT#03 BEEBE DRAW FEDERAL H15-764 (226'FSL & 1764'FWL,SEC.03) |           |                                |

| WELLPATH COMMENTS |                 |             |          |   |
|-------------------|-----------------|-------------|----------|---|
| MD [ft]           | Inclination [°] | Azimuth [°] | TVD [ft] | Comment   |
| 222.00            | 1.120           | 238.180     | 221.99   | First BH MWD Survey                             |
| 7375.45           | 87.879          | 180.489     | 7006.19  | Cross 200' Hardline (200'FNL & 1665'FWL,SEC.10) |
| 7378.00           | 88.089          | 180.481     | 7006.28  | Shallowest MD for Perf                          |
| 15276.00          | 89.910          | 180.140     | 7008.95  | Last BH MWD Survey                              |
| 15301.00          | 89.910          | 180.140     | 7008.99  | Projection to Bit (2420'FSL & 1711'FWL,SEC.15)  |