

Legend

- P&A'd Wellhead
- Soil Sample
- Soil Screening
- Soil Vapor Point (SVP)
- Approximate Location of Flowline (Removed)
- Excavation Extent
- Sample_Location selection

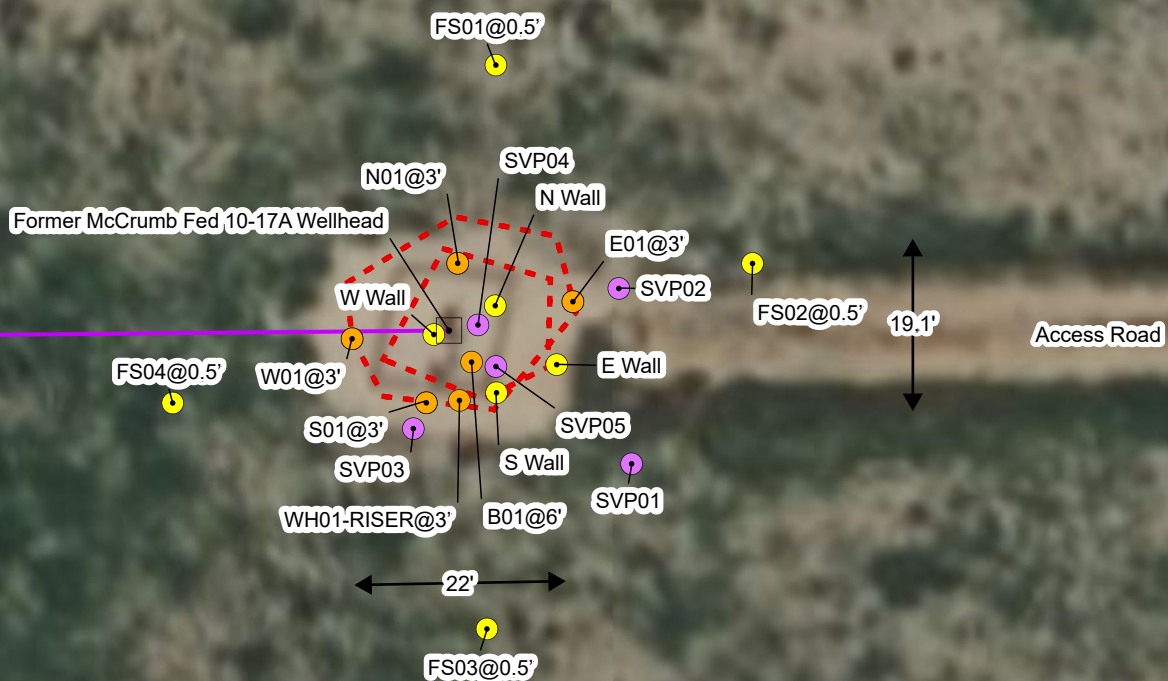

Rangeland



0 20 40 Feet

Sources: Environmental Systems Research Institute (ESRI)



Wellhead Excavation Site Map

McCrumb Fed 10-17A Wellhead
Kerr-McGee Oil & Gas Onshore, LP
NWSE SEC 17-T2N-R66W
Weld County, CO

Project Number: 09A1417654

FIGURE

1