

Chevron DJ Basin

GEORGE 15NA

George Pad

North American Datum 1983 , US State Plane 1983, Colorado Northern Zone

Ground Elevation: 4718.0

+N/-S	+E/-W	Northing	Easting	Latitude	Longitude
0.0	0.0	1353491.07	3263745.39	40.299873	-104.554393

T41 - RKB 25' WELL @ 4743.0ft (T41 - RKB 25')



George Pad
GEORGE 15NA
GEORGE 15NA Final Surveys
10:19, April 26 2024

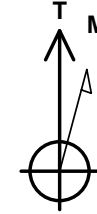

Azimuths to True North
Magnetic North: 7.65°

Magnetic Field
Strength: 51602.3nT
Dip Angle: 66.53°
Date: 04/04/2024
Model: HRGM

ANNOTATIONS

MD	TVD	Annotation
7768.0	6770.9	LPL - 2078' FSL & 727' FEL
17377.0	6836.4	BHL - 2085' FSL & 206' FWL

FINAL SURVEY

Projected Bottom Hole Location

**17377.0' MD / 6836.4' TVD
89.74° INC / 270.77° AZM
2085' FSL / 206' FWL**

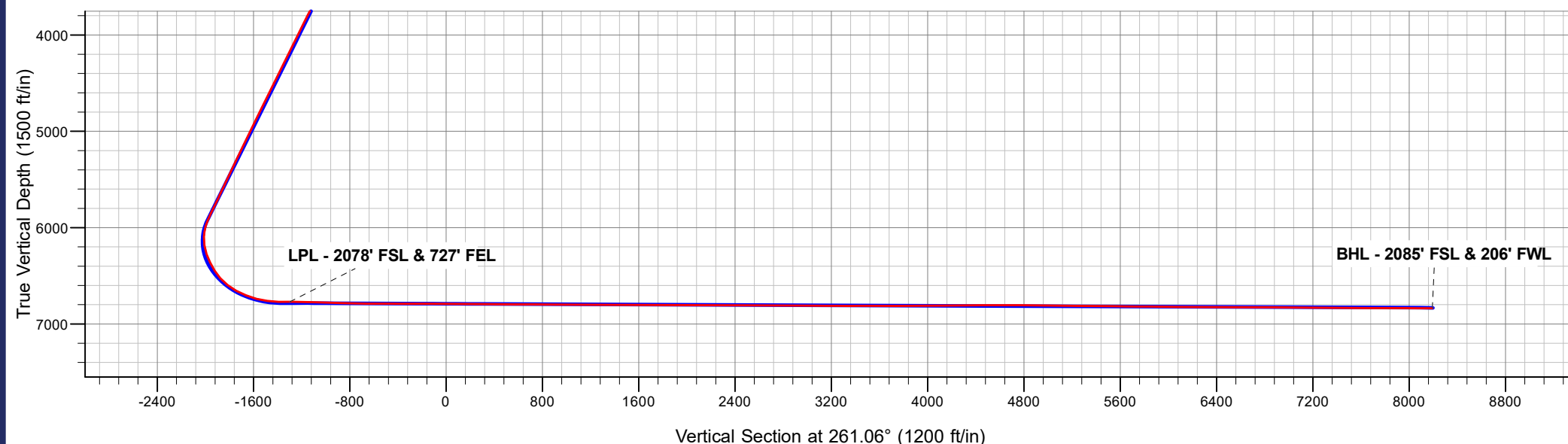
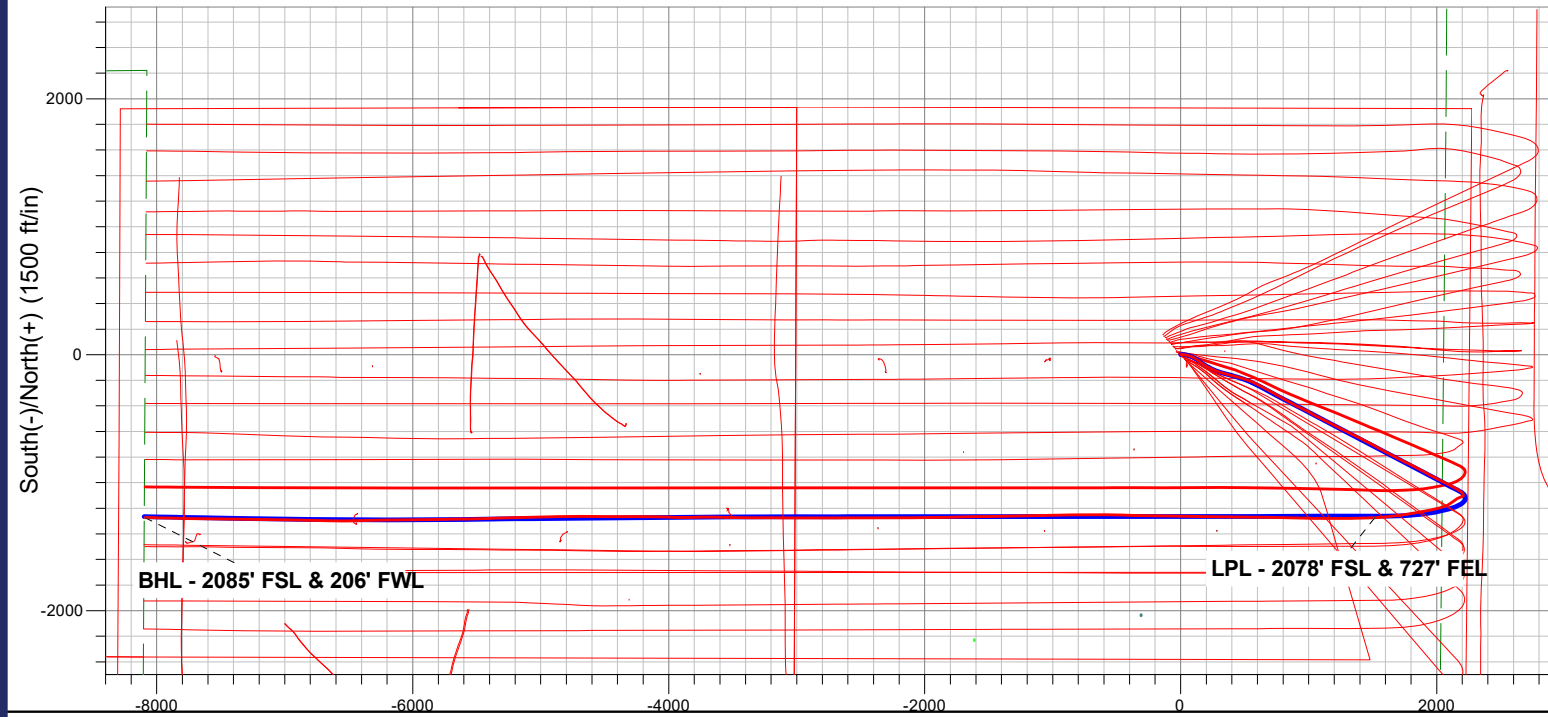

Chevron DJ Basin

SEC.21-T4N-R64W

George Pad

GEORGE 15NA

GEORGE 15NA

Design: GEORGE 15NA Final Surveys

Survey Report - Geographic

26 April, 2024

Ensign

Survey Report - Geographic

Company: Chevron DJ Basin	Local Co-ordinate Reference: Well GEORGE 15NA
Project: SEC.21-T4N-R64W	TVD Reference: WELL @ 4743.0ft (T41 - RKB 25')
Site: George Pad	MD Reference: WELL @ 4743.0ft (T41 - RKB 25')
Well: GEORGE 15NA	North Reference: True
Wellbore: GEORGE 15NA	Survey Calculation Method: Minimum Curvature
Design: GEORGE 15NA Final Surveys	Database: US_EDM

Project SEC.21-T4N-R64W, Weld County, CO			
Map System: US State Plane 1983	System Datum: Mean Sea Level		
Geo Datum: North American Datum 1983			
Map Zone: Colorado Northern Zone		Using geodetic scale factor	

Site George Pad			
Site Position:	Northing: 1,353,524.28 usft	Latitude: 40.299965	
From: Lat/Long	Easting: 3,263,715.11 usft	Longitude: -104.554500	
Position Uncertainty: 0.0 ft	Slot Radius: 13-3/16 "	Grid Convergence: 0.61 °	

Well GEORGE 15NA					
Well Position	+N/-S 0.0 ft	Northing: 1,353,491.07 usft	Latitude: 40.299873		
	+E/-W 0.0 ft	Easting: 3,263,745.40 usft	Longitude: -104.554393		
Position Uncertainty	0.0 ft	Wellhead Elevation: ft	Ground Level: 4,718.0 ft		

Wellbore GEORGE 15NA					
Magnetics	Model Name	Sample Date	Declination (°)	Dip Angle (°)	Field Strength (nT)
	HRGM	04/04/2024	7.65	66.53	51,602.34620161

Design GEORGE 15NA Final Surveys					
Audit Notes:					
Version: 1.0	Phase: ACTUAL	Tie On Depth: 0.0			
Vertical Section:	Depth From (TVD) (ft)	+N/-S (ft)	+E/-W (ft)	Direction (°)	
	0.0	0.0	0.0	261.06	

Survey Program Date 04/26/2024					
From (ft)	To (ft)	Survey (Wellbore)	Tool Name	Description	
208.0	17,377.0	Survey #1 (GEORGE 15NA)	MWD+IFR1+SAG+MS	OWSG MWD + IFR1 + Sag + Multi-Station Corre	

Survey										
Measured Depth (ft)	Inclination (°)	Azimuth (°)	Vertical Depth (ft)	+N/-S (ft)	+E/-W (ft)	Map Northing (usft)	Map Easting (usft)	Latitude	Longitude	
0.0	0.00	0.00	0.0	0.0	0.0	1,353,491.07	3,263,745.40	40.299873	-104.554393	
208.0	0.70	69.71	208.0	0.4	1.2	1,353,491.52	3,263,746.58	40.299874	-104.554389	
300.0	1.14	64.96	300.0	1.0	2.5	1,353,492.12	3,263,747.93	40.299876	-104.554384	
394.0	2.99	90.28	393.9	1.4	5.8	1,353,492.53	3,263,751.23	40.299877	-104.554372	
488.0	3.78	95.02	487.8	1.1	11.4	1,353,492.31	3,263,756.77	40.299876	-104.554352	
582.0	4.31	95.20	581.5	0.5	18.0	1,353,491.79	3,263,763.38	40.299874	-104.554328	
677.0	4.75	98.19	676.2	-0.4	25.4	1,353,490.99	3,263,770.84	40.299872	-104.554302	
771.0	6.95	97.48	769.7	-1.6	34.9	1,353,489.79	3,263,780.34	40.299869	-104.554268	
864.0	10.29	104.69	861.7	-4.5	48.5	1,353,487.10	3,263,793.99	40.299861	-104.554219	
958.0	11.52	106.62	954.0	-9.3	65.7	1,353,482.47	3,263,811.15	40.299847	-104.554158	
1,052.0	13.28	108.73	1,045.8	-15.5	84.9	1,353,476.52	3,263,830.44	40.299831	-104.554089	
1,145.0	15.65	119.98	1,135.8	-25.2	105.9	1,353,467.04	3,263,851.53	40.299804	-104.554013	

Ensign

Survey Report - Geographic

Company:	Chevron DJ Basin	Local Co-ordinate Reference:	Well GEORGE 15NA
Project:	SEC.21-T4N-R64W	TVD Reference:	WELL @ 4743.0ft (T41 - RKB 25')
Site:	GEORGE Pad	MD Reference:	WELL @ 4743.0ft (T41 - RKB 25')
Well:	GEORGE 15NA	North Reference:	True
Wellbore:	GEORGE 15NA	Survey Calculation Method:	Minimum Curvature
Design:	GEORGE 15NA Final Surveys	Database:	US_EDM

Survey									
Measured Depth (ft)	Inclination (°)	Azimuth (°)	Vertical Depth (ft)	+N/-S (ft)	+E/-W (ft)	Map Northing (usft)	Map Easting (usft)	Latitude	Longitude
1,239.0	17.50	125.61	1,225.9	-39.7	128.3	1,353,452.72	3,263,874.16	40.299764	-104.553933
1,333.0	17.41	128.42	1,315.6	-56.7	150.9	1,353,435.99	3,263,896.84	40.299717	-104.553852
1,428.0	19.35	122.62	1,405.8	-74.0	175.3	1,353,418.93	3,263,921.42	40.299670	-104.553765
1,522.0	22.25	119.63	1,493.6	-91.2	203.8	1,353,402.04	3,263,950.20	40.299623	-104.553662
1,616.0	23.30	116.82	1,580.3	-108.4	235.9	1,353,385.20	3,263,982.44	40.299575	-104.553547
1,710.0	25.59	112.78	1,665.9	-124.6	271.2	1,353,369.33	3,264,017.92	40.299531	-104.553421
1,804.0	27.61	106.10	1,749.9	-138.5	310.9	1,353,355.85	3,264,057.72	40.299493	-104.553278
1,893.0	30.07	105.57	1,827.9	-150.3	352.2	1,353,344.58	3,264,099.15	40.299461	-104.553130
2,049.0	28.60	104.52	1,963.9	-170.1	426.0	1,353,325.52	3,264,173.15	40.299406	-104.552866
2,143.0	29.58	104.57	2,046.0	-181.6	470.2	1,353,314.51	3,264,217.50	40.299375	-104.552707
2,237.0	29.12	109.89	2,128.0	-195.2	514.2	1,353,301.36	3,264,261.61	40.299337	-104.552550
2,331.0	29.54	114.06	2,209.9	-212.4	556.9	1,353,284.59	3,264,304.46	40.299290	-104.552397
2,424.0	29.49	116.32	2,290.9	-231.9	598.3	1,353,265.54	3,264,346.12	40.299236	-104.552248
2,518.0	25.81	117.38	2,374.1	-251.6	637.2	1,353,246.28	3,264,385.25	40.299182	-104.552108
2,612.0	26.57	120.05	2,458.5	-271.5	673.6	1,353,226.73	3,264,421.83	40.299128	-104.551978
2,706.0	27.03	119.36	2,542.4	-292.5	710.4	1,353,206.12	3,264,458.86	40.299070	-104.551846
2,801.0	26.36	117.83	2,627.3	-313.0	747.9	1,353,186.09	3,264,496.54	40.299014	-104.551712
2,895.0	26.17	119.73	2,711.5	-333.0	784.3	1,353,166.46	3,264,533.21	40.298959	-104.551581
2,988.0	26.14	118.56	2,795.0	-353.0	820.1	1,353,146.88	3,264,569.22	40.298904	-104.551453
3,082.0	26.14	119.99	2,879.4	-373.2	856.3	1,353,127.02	3,264,605.55	40.298849	-104.551323
3,175.0	26.45	118.64	2,962.8	-393.4	892.2	1,353,107.24	3,264,641.68	40.298793	-104.551194
3,269.0	24.92	115.67	3,047.5	-412.0	928.4	1,353,089.01	3,264,678.11	40.298742	-104.551065
3,363.0	24.29	114.88	3,133.0	-428.7	963.8	1,353,072.68	3,264,713.67	40.298696	-104.550938
3,457.0	26.44	118.59	3,217.9	-446.9	999.7	1,353,054.91	3,264,749.78	40.298646	-104.550809
3,551.0	26.58	118.54	3,302.0	-466.9	1,036.6	1,353,035.24	3,264,786.84	40.298591	-104.550677
3,646.0	26.59	118.29	3,387.0	-487.2	1,074.0	1,353,015.41	3,264,824.45	40.298536	-104.550543
3,740.0	26.52	117.96	3,471.1	-507.0	1,111.0	1,352,996.00	3,264,861.71	40.298481	-104.550410
3,833.0	25.63	116.64	3,554.6	-525.7	1,147.3	1,352,977.63	3,264,898.23	40.298430	-104.550280
3,927.0	26.80	114.58	3,638.9	-543.7	1,184.8	1,352,960.10	3,264,935.86	40.298381	-104.550146
4,022.0	27.30	118.28	3,723.5	-562.9	1,223.5	1,352,941.29	3,264,974.73	40.298328	-104.550007
4,115.0	25.82	117.03	3,806.7	-582.2	1,260.3	1,352,922.37	3,265,011.75	40.298275	-104.549875
4,209.0	26.17	116.20	3,891.2	-600.6	1,297.1	1,352,904.31	3,265,048.78	40.298224	-104.549743
4,303.0	26.25	117.25	3,975.6	-619.3	1,334.2	1,352,886.04	3,265,086.06	40.298173	-104.549610
4,397.0	26.45	116.31	4,059.8	-638.1	1,371.4	1,352,867.64	3,265,123.50	40.298121	-104.549476
4,491.0	26.43	117.40	4,144.0	-657.0	1,408.8	1,352,849.13	3,265,161.04	40.298069	-104.549343
4,586.0	25.72	117.39	4,229.3	-676.2	1,445.8	1,352,830.32	3,265,198.31	40.298017	-104.549210
4,679.0	26.28	117.23	4,312.9	-694.9	1,482.1	1,352,812.00	3,265,234.73	40.297965	-104.549080
4,772.0	26.57	117.70	4,396.2	-714.0	1,518.8	1,352,793.31	3,265,271.65	40.297913	-104.548948
4,865.0	26.36	118.75	4,479.4	-733.6	1,555.3	1,352,774.10	3,265,308.38	40.297859	-104.548817
4,959.0	26.33	117.01	4,563.6	-753.1	1,592.2	1,352,754.99	3,265,345.45	40.297806	-104.548685
5,053.0	26.62	118.96	4,647.8	-772.8	1,629.2	1,352,735.72	3,265,382.65	40.297752	-104.548552
5,147.0	26.35	119.10	4,731.9	-793.1	1,665.8	1,352,715.77	3,265,419.52	40.297696	-104.548421
5,240.0	26.47	118.91	4,815.2	-813.2	1,702.0	1,352,696.10	3,265,455.91	40.297641	-104.548291
5,334.0	26.25	116.46	4,899.4	-832.6	1,739.0	1,352,677.11	3,265,493.06	40.297587	-104.548159
5,427.0	25.25	114.09	4,983.2	-849.8	1,775.5	1,352,660.24	3,265,529.76	40.297540	-104.548028
5,521.0	25.92	118.54	5,068.0	-867.8	1,811.8	1,352,642.63	3,265,566.31	40.297491	-104.547898
5,614.0	25.04	117.51	5,152.0	-886.7	1,847.2	1,352,624.20	3,265,601.82	40.297439	-104.547771
5,708.0	25.65	118.02	5,236.9	-905.4	1,882.8	1,352,605.84	3,265,637.62	40.297388	-104.547643
5,801.0	25.95	118.52	5,320.6	-924.6	1,918.4	1,352,587.05	3,265,673.46	40.297335	-104.547516
5,895.0	25.85	118.75	5,405.2	-944.2	1,954.4	1,352,567.76	3,265,709.71	40.297281	-104.547386
5,988.0	24.41	116.24	5,489.4	-962.5	1,989.5	1,352,549.88	3,265,744.91	40.297231	-104.547261
6,080.0	25.48	117.52	5,572.8	-980.0	2,024.1	1,352,532.70	3,265,779.70	40.297183	-104.547137
6,174.0	24.74	117.20	5,657.9	-998.4	2,059.5	1,352,514.75	3,265,815.32	40.297132	-104.547010
6,268.0	25.59	117.25	5,743.0	-1,016.7	2,095.0	1,352,496.84	3,265,851.05	40.297082	-104.546882
6,362.0	25.78	118.20	5,827.7	-1,035.6	2,131.1	1,352,478.28	3,265,887.31	40.297030	-104.546753

Ensign

Survey Report - Geographic

Company:	Chevron DJ Basin	Local Co-ordinate Reference:	Well GEORGE 15NA
Project:	SEC.21-T4N-R64W	TVD Reference:	WELL @ 4743.0ft (T41 - RKB 25')
Site:	George Pad	MD Reference:	WELL @ 4743.0ft (T41 - RKB 25')
Well:	GEORGE 15NA	North Reference:	True
Wellbore:	GEORGE 15NA	Survey Calculation Method:	Minimum Curvature
Design:	GEORGE 15NA Final Surveys	Database:	US_EDM

Survey									
Measured Depth (ft)	Inclination (°)	Azimuth (°)	Vertical Depth (ft)	+N/-S (ft)	+E/-W (ft)	Map Northing (usft)	Map Easting (usft)	Latitude	Longitude
6,456.0	25.12	119.31	5,912.6	-1,055.0	2,166.5	1,352,459.23	3,265,922.93	40.296977	-104.546626
6,550.0	17.60	134.02	6,000.1	-1,074.7	2,194.2	1,352,439.84	3,265,950.81	40.296923	-104.546527
6,643.0	10.99	155.93	6,090.3	-1,092.6	2,207.9	1,352,422.09	3,265,964.75	40.296874	-104.546478
6,737.0	7.42	227.16	6,183.3	-1,105.0	2,207.1	1,352,409.74	3,265,964.09	40.296840	-104.546481
6,831.0	16.52	255.53	6,275.2	-1,112.5	2,189.7	1,352,402.07	3,265,946.73	40.296819	-104.546543
6,924.0	23.03	242.68	6,362.7	-1,124.1	2,160.7	1,352,390.09	3,265,917.85	40.296787	-104.546647
7,018.0	30.22	227.49	6,446.8	-1,148.6	2,126.8	1,352,365.24	3,265,884.25	40.296720	-104.546768
7,111.0	36.18	246.06	6,524.8	-1,175.7	2,084.3	1,352,337.75	3,265,842.06	40.296646	-104.546921
7,205.0	45.56	255.41	6,595.9	-1,195.4	2,026.3	1,352,317.35	3,265,784.25	40.296591	-104.547129
7,299.0	55.20	258.04	6,655.8	-1,211.9	1,955.9	1,352,300.11	3,265,714.03	40.296546	-104.547381
7,393.0	63.49	259.56	6,703.6	-1,227.6	1,876.7	1,352,283.62	3,265,634.95	40.296503	-104.547665
7,487.0	72.28	260.81	6,739.0	-1,242.4	1,790.9	1,352,267.91	3,265,549.39	40.296463	-104.547973
7,581.0	80.69	262.43	6,760.9	-1,255.7	1,700.6	1,352,253.66	3,265,459.20	40.296426	-104.548297
7,675.0	88.04	263.76	6,770.2	-1,266.9	1,607.8	1,352,241.44	3,265,366.52	40.296395	-104.548629
7,768.0	91.04	267.00	6,770.9	-1,274.4	1,515.1	1,352,232.97	3,265,273.94	40.296375	-104.548961
LPL - 2078' FSL & 727' FEL									
7,863.0	89.08	269.25	6,770.8	-1,277.5	1,420.2	1,352,228.85	3,265,179.05	40.296366	-104.549302
7,958.0	88.06	269.81	6,773.2	-1,278.3	1,325.2	1,352,227.06	3,265,084.10	40.296364	-104.549642
8,051.0	87.48	269.84	6,776.8	-1,278.6	1,232.3	1,352,225.78	3,264,991.18	40.296363	-104.549975
8,144.0	87.74	270.05	6,780.7	-1,278.6	1,139.4	1,352,224.70	3,264,898.27	40.296363	-104.550308
8,238.0	87.88	270.73	6,784.3	-1,278.0	1,045.4	1,352,224.34	3,264,804.35	40.296365	-104.550645
8,332.0	89.05	271.29	6,786.8	-1,276.3	951.5	1,352,224.99	3,264,710.39	40.296369	-104.550982
8,426.0	89.84	271.33	6,787.7	-1,274.2	857.5	1,352,226.14	3,264,616.41	40.296375	-104.551319
8,520.0	89.49	270.89	6,788.3	-1,272.4	763.5	1,352,226.96	3,264,522.42	40.296380	-104.551656
8,615.0	89.55	271.21	6,789.1	-1,270.6	668.5	1,352,227.69	3,264,427.43	40.296385	-104.551996
8,709.0	89.83	270.33	6,789.6	-1,269.4	574.6	1,352,227.95	3,264,333.43	40.296389	-104.552333
8,803.0	90.06	271.05	6,789.6	-1,268.2	480.6	1,352,228.08	3,264,239.44	40.296392	-104.552670
8,896.0	89.61	270.46	6,789.9	-1,267.0	387.6	1,352,228.31	3,264,146.44	40.296395	-104.553004
8,989.0	89.57	270.48	6,790.6	-1,266.3	294.6	1,352,228.08	3,264,053.45	40.296397	-104.553337
9,084.0	89.44	270.90	6,791.4	-1,265.1	199.6	1,352,228.21	3,263,958.46	40.296400	-104.553677
9,177.0	89.79	270.78	6,792.0	-1,263.7	106.6	1,352,228.58	3,263,865.47	40.296404	-104.554011
9,271.0	89.54	270.87	6,792.6	-1,262.4	12.6	1,352,228.94	3,263,771.47	40.296408	-104.554348
9,364.0	89.49	271.36	6,793.4	-1,260.6	-80.4	1,352,229.75	3,263,678.48	40.296413	-104.554681
9,458.0	89.54	270.52	6,794.2	-1,259.0	-174.3	1,352,230.29	3,263,584.49	40.296417	-104.555018
9,551.0	89.38	271.13	6,795.0	-1,257.7	-267.3	1,352,230.64	3,263,491.50	40.296421	-104.555351
9,645.0	89.35	271.03	6,796.1	-1,255.9	-361.3	1,352,231.41	3,263,397.52	40.296426	-104.555688
9,739.0	89.92	272.38	6,796.7	-1,253.1	-455.3	1,352,233.20	3,263,303.54	40.296433	-104.556025
9,833.0	89.97	270.53	6,796.8	-1,250.7	-549.2	1,352,234.59	3,263,209.56	40.296440	-104.556362
9,926.0	89.47	270.36	6,797.2	-1,250.0	-642.2	1,352,234.32	3,263,116.57	40.296442	-104.556695
10,021.0	89.61	269.90	6,798.0	-1,249.8	-737.2	1,352,233.52	3,263,021.58	40.296442	-104.557036
10,114.0	89.43	269.11	6,798.8	-1,250.6	-830.2	1,352,231.73	3,262,928.60	40.296440	-104.557369
10,208.0	89.55	268.83	6,799.6	-1,252.3	-924.2	1,352,229.04	3,262,834.65	40.296435	-104.557706
10,302.0	89.61	268.39	6,800.3	-1,254.6	-1,018.2	1,352,225.75	3,262,740.71	40.296429	-104.558043
10,396.0	89.60	268.76	6,800.9	-1,256.9	-1,112.1	1,352,222.41	3,262,646.78	40.296423	-104.558380
10,490.0	89.74	269.12	6,801.5	-1,258.7	-1,206.1	1,352,219.67	3,262,552.83	40.296418	-104.558717
10,583.0	89.81	269.07	6,801.8	-1,260.1	-1,299.1	1,352,217.21	3,262,459.86	40.296414	-104.559050
10,677.0	90.04	269.28	6,802.0	-1,261.5	-1,393.1	1,352,214.86	3,262,365.90	40.296410	-104.559387
10,771.0	89.59	268.99	6,802.3	-1,262.9	-1,487.1	1,352,212.44	3,262,271.93	40.296406	-104.559724
10,866.0	89.55	268.88	6,803.0	-1,264.7	-1,582.1	1,352,209.66	3,262,176.98	40.296401	-104.560064
10,959.0	89.53	268.96	6,803.7	-1,266.4	-1,675.0	1,352,206.91	3,262,084.03	40.296397	-104.560398
11,053.0	89.58	268.94	6,804.5	-1,268.1	-1,769.0	1,352,204.19	3,261,990.07	40.296392	-104.560735
11,147.0	89.92	268.68	6,804.9	-1,270.1	-1,863.0	1,352,201.24	3,261,896.13	40.296386	-104.561072
11,240.0	89.56	269.39	6,805.3	-1,271.7	-1,956.0	1,352,198.68	3,261,803.17	40.296382	-104.561405
11,335.0	89.87	269.26	6,805.8	-1,272.8	-2,051.0	1,352,196.55	3,261,708.20	40.296379	-104.561746
11,429.0	89.96	269.40	6,805.9	-1,273.9	-2,145.0	1,352,194.45	3,261,614.22	40.296376	-104.562082

Ensign

Survey Report - Geographic

Company:	Chevron DJ Basin	Local Co-ordinate Reference:	Well GEORGE 15NA
Project:	SEC.21-T4N-R64W	TVD Reference:	WELL @ 4743.0ft (T41 - RKB 25')
Site:	George Pad	MD Reference:	WELL @ 4743.0ft (T41 - RKB 25')
Well:	GEORGE 15NA	North Reference:	True
Wellbore:	GEORGE 15NA	Survey Calculation Method:	Minimum Curvature
Design:	GEORGE 15NA Final Surveys	Database:	US_EDM

Survey									
Measured Depth (ft)	Inclination (°)	Azimuth (°)	Vertical Depth (ft)	+N/-S (ft)	+E/-W (ft)	Map Northing (usft)	Map Easting (usft)	Latitude	Longitude
11,524.0	89.97	269.15	6,806.0	-1,275.1	-2,240.0	1,352,192.23	3,261,519.26	40.296373	-104.562423
11,618.0	89.64	270.39	6,806.3	-1,275.5	-2,334.0	1,352,190.85	3,261,425.27	40.296372	-104.562760
11,712.0	89.44	270.51	6,807.0	-1,274.7	-2,428.0	1,352,190.59	3,261,331.28	40.296374	-104.563097
11,806.0	89.67	270.05	6,807.8	-1,274.3	-2,522.0	1,352,190.04	3,261,237.29	40.296375	-104.563434
11,900.0	89.64	269.89	6,808.3	-1,274.3	-2,616.0	1,352,188.99	3,261,143.30	40.296375	-104.563771
11,994.0	89.68	269.40	6,808.9	-1,274.9	-2,709.9	1,352,187.41	3,261,049.32	40.296373	-104.564108
12,088.0	89.50	270.67	6,809.6	-1,274.8	-2,803.9	1,352,186.46	3,260,955.33	40.296373	-104.564445
12,182.0	89.52	269.73	6,810.4	-1,274.5	-2,897.9	1,352,185.79	3,260,861.34	40.296374	-104.564782
12,276.0	89.54	269.94	6,811.1	-1,274.8	-2,991.9	1,352,184.52	3,260,767.36	40.296373	-104.565119
12,369.0	89.54	270.20	6,811.9	-1,274.7	-3,084.9	1,352,183.64	3,260,674.37	40.296374	-104.565452
12,463.0	90.06	270.61	6,812.2	-1,274.0	-3,178.9	1,352,183.30	3,260,580.38	40.296375	-104.565789
12,557.0	90.25	269.93	6,812.0	-1,273.6	-3,272.9	1,352,182.74	3,260,486.38	40.296377	-104.566126
12,651.0	90.10	270.65	6,811.7	-1,273.1	-3,366.9	1,352,182.21	3,260,392.39	40.296378	-104.566463
12,744.0	89.50	270.44	6,812.0	-1,272.2	-3,459.9	1,352,182.11	3,260,299.40	40.296380	-104.566796
12,837.0	90.12	271.13	6,812.3	-1,270.9	-3,552.9	1,352,182.39	3,260,206.40	40.296384	-104.567130
12,931.0	90.68	270.54	6,811.6	-1,269.6	-3,646.9	1,352,182.76	3,260,112.41	40.296387	-104.567467
13,025.0	90.14	269.64	6,811.0	-1,269.4	-3,740.9	1,352,181.90	3,260,018.42	40.296388	-104.567804
13,119.0	90.17	269.06	6,810.7	-1,270.5	-3,834.9	1,352,179.83	3,259,924.45	40.296385	-104.568141
13,213.0	90.88	271.35	6,809.9	-1,270.1	-3,928.9	1,352,179.17	3,259,830.47	40.296386	-104.568478
13,307.0	90.42	271.14	6,808.8	-1,268.1	-4,022.8	1,352,180.21	3,259,736.48	40.296391	-104.568814
13,400.0	90.74	270.88	6,807.9	-1,266.5	-4,115.8	1,352,180.85	3,259,643.50	40.296396	-104.569148
13,494.0	90.94	270.58	6,806.5	-1,265.3	-4,209.8	1,352,181.05	3,259,549.51	40.296399	-104.569485
13,588.0	90.02	269.79	6,805.7	-1,265.0	-4,303.8	1,352,180.35	3,259,455.52	40.296400	-104.569822
13,682.0	90.04	270.49	6,805.6	-1,264.7	-4,397.8	1,352,179.58	3,259,361.53	40.296400	-104.570159
13,776.0	89.86	270.32	6,805.7	-1,264.1	-4,491.8	1,352,179.24	3,259,267.53	40.296402	-104.570496
13,870.0	89.88	270.52	6,805.9	-1,263.4	-4,585.8	1,352,178.93	3,259,173.54	40.296404	-104.570833
13,963.0	89.67	270.42	6,806.3	-1,262.6	-4,678.8	1,352,178.70	3,259,080.54	40.296406	-104.571166
14,057.0	88.94	268.98	6,807.4	-1,263.1	-4,772.8	1,352,177.20	3,258,986.57	40.296405	-104.571503
14,150.0	89.34	269.29	6,808.8	-1,264.5	-4,865.8	1,352,174.81	3,258,893.62	40.296401	-104.571836
14,243.0	89.41	268.98	6,809.8	-1,265.9	-4,958.7	1,352,172.41	3,258,800.66	40.296397	-104.572170
14,338.0	89.12	267.39	6,811.1	-1,268.9	-5,053.7	1,352,168.39	3,258,705.76	40.296389	-104.572510
14,431.0	89.24	268.98	6,812.4	-1,271.9	-5,146.6	1,352,164.46	3,258,612.86	40.296380	-104.572843
14,525.0	89.43	268.44	6,813.5	-1,274.0	-5,240.6	1,352,161.34	3,258,518.92	40.296375	-104.573180
14,618.0	89.15	268.38	6,814.6	-1,276.6	-5,333.6	1,352,157.77	3,258,426.00	40.296367	-104.573513
14,711.0	89.36	268.04	6,815.9	-1,279.5	-5,426.5	1,352,153.87	3,258,333.09	40.296359	-104.573846
14,805.0	89.21	268.10	6,817.0	-1,282.6	-5,520.4	1,352,149.71	3,258,239.20	40.296351	-104.574183
14,899.0	89.34	269.72	6,818.2	-1,284.4	-5,614.4	1,352,146.92	3,258,145.25	40.296346	-104.574520
14,993.0	89.28	268.62	6,819.3	-1,285.8	-5,708.4	1,352,144.55	3,258,051.30	40.296342	-104.574857
15,088.0	89.37	269.84	6,820.5	-1,287.1	-5,803.4	1,352,142.26	3,257,956.34	40.296338	-104.575197
15,182.0	89.27	269.29	6,821.6	-1,287.8	-5,897.4	1,352,140.55	3,257,862.36	40.296336	-104.575534
15,275.0	89.12	269.00	6,822.9	-1,289.2	-5,990.3	1,352,138.17	3,257,769.41	40.296332	-104.575868
15,370.0	89.49	269.53	6,824.0	-1,290.4	-6,085.3	1,352,135.94	3,257,674.45	40.296329	-104.576208
15,464.0	89.75	268.74	6,824.7	-1,291.8	-6,179.3	1,352,133.52	3,257,580.48	40.296325	-104.576545
15,558.0	90.01	268.84	6,824.9	-1,293.8	-6,273.3	1,352,130.53	3,257,486.54	40.296319	-104.576882
15,652.0	90.02	268.60	6,824.8	-1,295.9	-6,367.3	1,352,127.43	3,257,392.59	40.296314	-104.577219
15,747.0	89.70	268.70	6,825.1	-1,298.1	-6,462.2	1,352,124.18	3,257,297.65	40.296307	-104.577559
15,840.0	89.59	270.55	6,825.6	-1,298.7	-6,555.2	1,352,122.58	3,257,204.68	40.296306	-104.577893
15,934.0	89.68	270.76	6,826.2	-1,297.6	-6,649.2	1,352,122.65	3,257,110.68	40.296309	-104.578230
16,028.0	89.54	270.75	6,826.9	-1,296.4	-6,743.2	1,352,122.89	3,257,016.69	40.296312	-104.578567
16,122.0	89.10	272.26	6,828.0	-1,293.9	-6,837.2	1,352,124.35	3,256,922.71	40.296319	-104.578903
16,216.0	89.51	270.72	6,829.1	-1,291.5	-6,931.1	1,352,125.79	3,256,828.74	40.296325	-104.579240
16,310.0	89.42	271.25	6,830.0	-1,289.9	-7,025.1	1,352,126.41	3,256,734.75	40.296330	-104.579577
16,405.0	89.51	271.33	6,830.9	-1,287.7	-7,120.1	1,352,127.53	3,256,639.76	40.296335	-104.579918
16,499.0	89.27	271.01	6,831.9	-1,285.8	-7,214.1	1,352,128.45	3,256,545.78	40.296341	-104.580255
16,593.0	89.44	270.59	6,833.0	-1,284.5	-7,308.0	1,352,128.76	3,256,451.79	40.296344	-104.580592

Ensign

Survey Report - Geographic

Company: Chevron DJ Basin	Local Co-ordinate Reference: Well GEORGE 15NA
Project: SEC.21-T4N-R64W	TVD Reference: WELL @ 4743.0ft (T41 - RKB 25')
Site: George Pad	MD Reference: WELL @ 4743.0ft (T41 - RKB 25')
Well: GEORGE 15NA	North Reference: True
Wellbore: GEORGE 15NA	Survey Calculation Method: Minimum Curvature
Design: GEORGE 15NA Final Surveys	Database: US_EDM

Survey									
Measured Depth (ft)	Inclination (°)	Azimuth (°)	Vertical Depth (ft)	+N/-S (ft)	+E/-W (ft)	Map Northing (usft)	Map Easting (usft)	Latitude	Longitude
16,686.0	89.77	269.78	6,833.6	-1,284.2	-7,401.0	1,352,128.07	3,256,358.80	40.296345	-104.580925
16,779.0	89.52	270.19	6,834.2	-1,284.2	-7,494.0	1,352,127.05	3,256,265.81	40.296345	-104.581258
16,873.0	89.81	270.52	6,834.7	-1,283.7	-7,588.0	1,352,126.63	3,256,171.82	40.296346	-104.581595
16,967.0	90.17	271.92	6,834.7	-1,281.7	-7,682.0	1,352,127.63	3,256,077.83	40.296352	-104.581932
17,061.0	89.57	271.23	6,835.0	-1,279.1	-7,776.0	1,352,129.21	3,255,983.85	40.296359	-104.582269
17,155.0	89.51	271.19	6,835.7	-1,277.1	-7,870.0	1,352,130.20	3,255,889.86	40.296364	-104.582606
17,249.0	90.07	271.52	6,836.1	-1,274.9	-7,963.9	1,352,131.42	3,255,795.87	40.296370	-104.582943
17,343.0	89.74	270.77	6,836.2	-1,273.0	-8,057.9	1,352,132.29	3,255,701.88	40.296375	-104.583280
17,377.0	89.74	270.77	6,836.4	-1,272.5	-8,091.9	1,352,132.39	3,255,667.89	40.296376	-104.583402
BHL - 2085' FSL & 206' FWL									

Casing Points					
Measured Depth (ft)	Vertical Depth (ft)	Name	Casing Diameter (")	Hole Diameter (")	
50.0	50.0	5 1/2"	13-3/8	13-3/8	

Design Annotations					
Measured Depth (ft)	Vertical Depth (ft)	Local Coordinates		Comment	
		+N/-S (ft)	+E/-W (ft)		
7,768.0	6,770.9	-1,274.4	1,515.1	LPL - 2078' FSL & 727' FEL	
17,377.0	6,836.4	-1,272.5	-8,091.9	BHL - 2085' FSL & 206' FWL	

Checked By: _____	Approved By: _____	Date: _____
-------------------	--------------------	-------------

Chevron DJ Basin

SEC.21-T4N-R64W

George Pad

GEORGE 15NA

GEORGE 15NA

GEORGE 15NA Final Surveys

Anticollision Summary Report

26 April, 2024

Ensign

Anticollision Summary Report

Company:	Chevron DJ Basin	Local Co-ordinate Reference:	Well GEORGE 15NA
Project:	SEC.21-T4N-R64W	TVD Reference:	WELL @ 4743.0ft (T41 - RKB 25')
Reference Site:	George Pad	MD Reference:	WELL @ 4743.0ft (T41 - RKB 25')
Site Error:	0.0 ft	North Reference:	True
Reference Well:	GEORGE 15NA	Survey Calculation Method:	Minimum Curvature
Well Error:	0.0 ft	Output errors are at	3.50 sigma
Reference Wellbore	GEORGE 15NA	Database:	US_EDM
Reference Design:	GEORGE 15NA Final Surveys	Offset TVD Reference:	Offset Datum

Reference	GEORGE 15NA Final Surveys		
Filter type:	GLOBAL FILTER APPLIED: All wellpaths within 200'+ 100/1000 of refere		
Interpolation Method:	MD Interval 100.0ft	Error Model:	ISCWSA
Depth Range:	Unlimited	Scan Method:	Closest Approach 3D
Results Limited by:	Maximum ellipse separation of 1,000.0 ft	Error Surface:	Combined Pedal Curve
Warning Levels Evaluated at:	3.50 Sigma	Casing Method:	N/A Unknown

Survey Program	Date	04/26/2024		
From (ft)	To (ft)	Survey (Wellbore)	Tool Name	Description
208.0	17,377.0	Survey #1 (GEORGE 15NA)	MWD+IFR1+SAG+MS	OWSG MWD + IFR1 + Sag + Multi-Station Corre

Site Name Offset Well - Wellbore - Design	Reference Measured Depth (ft)	Offset Measured Depth (ft)	Distance Between Centres (ft)	Distance Between Ellipses (ft)	Separation Factor	Warning
Balboa C20-24D Pad Sec.20-T4N-R64W						
Balboa C20-24D - Wellbore #1 - Wellbore #1	14,858.6	7,019.0	711.4	532.3	4.008	CC, ES
Balboa C20-24D - Wellbore #1 - Wellbore #1	14,900.0	7,018.8	712.8	533.3	4.005	SF
Chenoweth C20-25D - Wellbore #1 - Wellbore #1	16,262.4	7,121.8	816.4	605.8	3.907	CC, ES
Chenoweth C20-25D - Wellbore #1 - Wellbore #1	16,300.0	7,122.3	817.0	606.0	3.901	SF
Borys Pad						
BORYS C22-783 - BORYS C22-783 - BORYS C22-783	6,842.9	6,903.1	705.2	642.4	11.597	CC, ES
BORYS C22-783 - BORYS C22-783 - BORYS C22-783	6,900.0	6,933.9	709.6	645.8	11.455	SF
George Pad						
GEORGE 01N - GEORGE 01N - GEORGE 01N Final Su	210.1	210.1	209.9	201.9	35.782	CC, ES
GEORGE 01N - GEORGE 01N - GEORGE 01N Final Su	1,100.0	1,097.5	285.6	272.6	26.401	SF
GEORGE 02N - GEORGE 02N - GEORGE 02N Final Su	325.4	327.1	194.4	186.1	31.852	CC, ES
GEORGE 02N - GEORGE 02N - GEORGE 02N Final Su	1,100.0	1,105.2	264.6	251.7	24.798	SF
GEORGE 03NA - GEORGE 03NA - GEORGE 03NA Finz	356.6	359.7	177.6	169.2	28.619	CC, ES
GEORGE 03NA - GEORGE 03NA - GEORGE 03NA Finz	1,100.0	1,108.8	223.3	210.4	20.882	SF
GEORGE 04N - GEORGE 04N - GEORGE 04N Final Su	0.0	0.0	165.0			
GEORGE 04N - GEORGE 04N - GEORGE 04N Final Su	200.0	199.7	165.0	156.9	28.082	ES
GEORGE 04N - GEORGE 04N - GEORGE 04N Final Su	1,100.0	1,120.0	205.2	192.4	19.322	SF
GEORGE 05N - GEORGE 05N - GEORGE 05N Final Su	224.1	223.8	149.8	141.7	25.341	CC, ES
GEORGE 05N - GEORGE 05N - GEORGE 05N Final Su	1,100.0	1,115.7	198.0	185.3	18.654	SF
GEORGE 06N - GEORGE 06N - GEORGE 06N Final Su	330.3	331.3	133.8	125.5	21.756	CC, ES
GEORGE 06N - GEORGE 06N - GEORGE 06N Final Su	1,200.0	1,221.3	191.1	177.6	16.769	SF
GEORGE 07NA - GEORGE 07NA - GEORGE 07NA Finz	0.0	0.0	120.0			
GEORGE 07NA - GEORGE 07NA - GEORGE 07NA Finz	17,377.0	18,088.0	1,763.8	1,426.9	5.264	SF
GEORGE 08N - GEORGE 08N - GEORGE 08N Final Su	742.7	751.2	101.5	91.2	12.377	CC
GEORGE 08N - GEORGE 08N - GEORGE 08N Final Su	800.0	808.3	101.7	91.0	11.852	ES
GEORGE 08N - GEORGE 08N - GEORGE 08N Final Su	17,377.0	17,984.0	1,533.5	1,198.2	4.597	SF
GEORGE 09N - GEORGE 09N - GEORGE 09N Final Su	0.0	0.0	90.0			
GEORGE 09N - GEORGE 09N - GEORGE 09N Final Su	17,377.0	17,953.0	1,313.5	979.7	3.955	SF
GEORGE 10N - GEORGE 10N - GEORGE 10N Final Su	654.5	659.1	51.2	41.5	6.628	CC, ES
GEORGE 10N - GEORGE 10N - GEORGE 10N Final Su	17,377.0	17,939.1	1,114.1	780.0	3.351	SF
GEORGE 11N - GEORGE 11N - GEORGE 11N Final Su	306.6	307.1	59.7	51.5	9.682	CC, ES
GEORGE 11N - GEORGE 11N - GEORGE 11N Final Su	17,377.0	17,992.0	892.1	557.5	2.678	SF
GEORGE 12N - GEORGE 12N - GEORGE 12N Final Su	218.8	219.1	44.9	36.8	7.328	CC
GEORGE 12N - GEORGE 12N - GEORGE 12N Final Su	300.0	300.2	45.0	36.8	7.164	ES
GEORGE 12N - GEORGE 12N - GEORGE 12N Final Su	17,377.0	18,044.2	671.6	337.4	2.017	SF

CC - Min centre to center distance or convergent point, SF - min separation factor, ES - min ellipse separation

Ensign

Anticollision Summary Report

Company:	Chevron DJ Basin	Local Co-ordinate Reference:	Well GEORGE 15NA
Project:	SEC.21-T4N-R64W	TVD Reference:	WELL @ 4743.0ft (T41 - RKB 25')
Reference Site:	George Pad	MD Reference:	WELL @ 4743.0ft (T41 - RKB 25')
Site Error:	0.0 ft	North Reference:	True
Reference Well:	GEORGE 15NA	Survey Calculation Method:	Minimum Curvature
Well Error:	0.0 ft	Output errors are at	3.50 sigma
Reference Wellbore	GEORGE 15NA	Database:	US_EDM
Reference Design:	GEORGE 15NA Final Surveys	Offset TVD Reference:	Offset Datum

Summary						
Site Name	Reference Measured Depth (ft)	Offset Measured Depth (ft)	Distance Between Centres (ft)	Distance Between Ellipses (ft)	Separation Factor	Warning
Offset Well - Wellbore - Design						
George Pad						
GEORGE 13N - GEORGE 13N - GEORGE 13N Final Su	222.3	222.5	29.9	21.8	4.739	CC, ES
GEORGE 13N - GEORGE 13N - GEORGE 13N Final Su	17,377.0	17,319.0	453.5	129.6	1.403	Collision Monitoring, SF
GEORGE 14N - GEORGE 14N - GEORGE 14N Final Su	251.3	251.4	14.4	6.3	2.075	CC
GEORGE 14N - GEORGE 14N - GEORGE 14N Final Su	17,376.2	17,313.2	248.4	-65.6	0.790	Shut in, ES, SF
GEORGE 15NA - GEORGE 15NA - GEORGE 15NA Plar	9,223.4	9,250.0	1.5	-39.9	-0.020	Unacceptable Path, SF
GEORGE 15NA - GEORGE 15NA - GEORGE 15NA Plar	15,080.8	15,106.6	0.0	-234.2	-0.010	Unacceptable Path, CC
GEORGE 15NA - GEORGE 15NA - GEORGE 15NA Plar	17,377.0	17,402.5	8.4	-259.3	0.023	Unacceptable Path, ES
GEORGE 16N - GEORGE 16N - GEORGE 16N Final Su	0.0	0.0	15.0			
GEORGE 16N - GEORGE 16N - GEORGE 16N Final Su	17,377.0	17,414.0	226.7	-96.3	0.700	Authorization, ES, SF
GEORGE 16N - GEORGE 16N - GEORGE 16N Plan #3	0.0	0.0	15.0			
GEORGE 16N - GEORGE 16N - GEORGE 16N Plan #3	17,377.0	17,428.6	212.0	-111.6	0.653	Authorization, ES, SF
GEORGE 17N - George 17N - George 17N Final Survey	218.1	217.9	29.3	21.4	4.673	CC, ES
GEORGE 17N - George 17N - George 17N Final Survey	17,377.0	17,391.1	431.7	113.1	1.357	Collision Monitoring, SF
GEORGE 17N - George 17N - GEORGE 17N Plan #3 4-	218.1	217.9	29.3	21.2	4.643	CC, ES
GEORGE 17N - George 17N - GEORGE 17N Plan #3 4-	17,377.0	17,395.3	437.5	117.6	1.370	Collision Monitoring, SF
GEORGE 18N - GEORGE 18N - GEORGE 18N	0.0	0.0	45.0			
GEORGE 18N - GEORGE 18N - GEORGE 18N Plan #3	0.0	0.0	45.0			
GEORGE 18N - GEORGE 18N - GEORGE 18N Plan #3	17,377.0	17,502.4	650.1	327.0	2.019	SF
GEORGE 19NA - GEORGE 19NA - GEORGE 19NA	0.0	0.0	60.0			
GEORGE 19NA - GEORGE 19NA - GEORGE 19NA Plar	0.0	0.0	60.0			
GEORGE 19NA - GEORGE 19NA - GEORGE 19NA Plar	17,377.0	17,496.7	873.9	551.7	2.724	SF
GEORGE 20N - GEORGE 20N - GEORGE 20N Plan #2	106.7	106.5	74.9	67.1	12.623	CC, ES
GEORGE 20N - GEORGE 20N - GEORGE 20N Plan #2	17,377.0	27,195.1	1,088.4	715.3	2.928	SF
GEORGE 21N - GEORGE 21N - George 21N Plan #2 4-	1,088.5	1,086.0	87.6	74.9	8.011	CC, ES
GEORGE 21N - GEORGE 21N - George 21N Plan #2 4-	1,200.0	1,192.5	91.9	78.4	7.811	SF
GEORGE 22N - GEORGE 22N - GEORGE 22N Plan #2	106.7	106.5	104.9	96.8	17.784	CC, ES
GEORGE 22N - GEORGE 22N - GEORGE 22N Plan #2	17,377.0	17,655.6	1,529.0	1,206.5	4.767	SF
GEORGE 23N - GEORGE 23N - GEORGE 23N Plan #2	106.8	106.5	119.7	111.7	20.399	CC, ES
GEORGE 23N - GEORGE 23N - GEORGE 23N Plan #2	17,377.0	17,834.9	1,705.6	1,159.9	3.134	SF
Long C20-18 Pad Sec.20-T4N-R64W						
Long C20-21D - Wellbore #1 - Wellbore #1	14,800.0	7,041.0	672.7	495.0	3.819	CC, ES, SF
Long C20-22D - Wellbore #1 - Wellbore #1	13,617.2	7,096.4	715.0	557.0	4.573	CC, ES
Long C20-22D - Wellbore #1 - Wellbore #1	13,700.0	7,095.1	719.3	559.3	4.541	SF
SEC.15-T4N-R64W (Existing)						
STOCKLEY C22-79HN - STOCKLEY C22-79HN - STOC	7,113.1	9,568.2	342.1	239.6	3.387	CC, ES
STOCKLEY C22-79HN - STOCKLEY C22-79HN - STOC	7,200.0	9,584.9	359.6	245.4	3.189	SF
SEC.19-T4N-R64W (Exist)						
OSTER PM C19-8 (Vert) - OSTER PM C19-8 - OSTER F	17,377.0	6,892.4	1,385.9	861.9	2.651	CC, ES, SF
VCTOR C19-9 - VICTOR C19-9 - VICTOR C19-9	17,377.0	6,893.0	868.9	807.4	14.602	CC, ES, SF
VICTOR C19-16 (Vert) - VICTOR C19-16 - VICTOR C19-	17,377.0	6,914.4	1,655.4	1,131.4	3.168	CC, ES, SF

CC - Min centre to center distance or convergent point, SF - min separation factor, ES - min ellipse separation

Ensign

Anticollision Summary Report

Company:	Chevron DJ Basin	Local Co-ordinate Reference:	Well GEORGE 15NA
Project:	SEC.21-T4N-R64W	TVD Reference:	WELL @ 4743.0ft (T41 - RKB 25')
Reference Site:	George Pad	MD Reference:	WELL @ 4743.0ft (T41 - RKB 25')
Site Error:	0.0 ft	North Reference:	True
Reference Well:	GEORGE 15NA	Survey Calculation Method:	Minimum Curvature
Well Error:	0.0 ft	Output errors are at	3.50 sigma
Reference Wellbore	GEORGE 15NA	Database:	US_EDM
Reference Design:	GEORGE 15NA Final Surveys	Offset TVD Reference:	Offset Datum

Site Name Offset Well - Wellbore - Design	Reference Measured Depth (ft)	Offset Measured Depth (ft)	Distance Between Centres (ft)	Distance Between Ellipses (ft)	Separation Factor	Warning
SEC.20-T4N-R64W (Exist)						
API 20-614 (Vert) - API 20-614 - API 20-614	15,572.6	6,846.9	1,206.7	1,013.5	6.305	CC
API 20-614 (Vert) - API 20-614 - API 20-614	15,600.0	6,846.9	1,206.9	1,013.2	6.286	ES
API 20-614 (Vert) - API 20-614 - API 20-614	15,700.0	6,846.9	1,213.5	1,018.3	6.272	SF
BALBOA 20-1 (Vert) - BALBOA 20-1 - BALBOA 20-1	12,929.0	6,826.7	1,365.2	867.2	2.749	CC, ES, SF
BALBOA 20-3 - BALBOA 20-3 - BALBOA 20-3	14,076.2	6,810.8	121.6	-40.7	0.746	Authorization, CC, ES, SF
BALBOA C-20-2 (Vert) - BALBOA C-20-2 - BALBOA C-20-2	12,801.6	6,804.3	213.2	75.7	1.559	CC, ES, SF
BALBOA C20-23 (Vert) - BALBOA C20-23 - BALBOA C20-23	13,600.0	6,812.7	644.7	491.6	4.255	CC, ES, SF
BALBOA C20-24D - BALBOA C20-24D - BALBOA C20-24D	14,865.6	7,019.1	707.6	528.4	3.983	CC, ES
BALBOA C20-24D - BALBOA C20-24D - BALBOA C20-24D	14,900.0	7,018.9	708.6	528.9	3.979	SF
BALBOA C20-4 (Vert) - BALBOA C20-4 - BALBOA C20-4	14,442.8	6,824.5	1,435.5	1,265.5	8.535	CC, ES
BALBOA C20-4 (Vert) - BALBOA C20-4 - BALBOA C20-4	14,600.0	6,826.4	1,444.5	1,272.7	8.502	SF
BALBOA C20-9X - BALBOA C20-9X - BALBOA C20-9X	12,825.4	6,805.3	58.3	-79.0	0.416	Unacceptable Path, CC, ES
CHENOWETH 2 - CHENOWETH 2 - CHENOWETH 2	16,923.4	6,883.6	1,405.2	1,184.4	6.417	CC, ES
CHENOWETH 2 - CHENOWETH 2 - CHENOWETH 2	17,000.0	6,883.9	1,408.1	1,185.9	6.387	SF
CHENOWETH C20-25D - CHENOWETH C20-25D - CHI	16,267.9	7,121.9	812.8	602.2	3.888	CC
CHENOWETH C20-25D - CHENOWETH C20-25D - CHI	16,300.0	7,122.2	813.2	602.2	3.881	ES, SF
HIGHLAND 11-20 - HIGHLAND 11-20 - HIGHLAND 11-20	15,715.5	6,829.2	55.9	-139.5	0.279	Unacceptable Path, CC, ES
HIGHLAND 12-20 - HIGHLAND 12-20 - HIGHLAND 12-20	16,941.4	6,863.5	120.1	-101.6	0.537	Authorization, CC, ES, SF
KLINGENBERG C20-780 - KLINGENBERG C20-780 (Pi	17,026.9	6,892.7	1,817.3	1,594.1	8.212	CC
KLINGENBERG C20-780 - KLINGENBERG C20-780 (Pi	17,100.0	6,892.9	1,818.4	1,593.7	8.158	ES
KLINGENBERG C20-780 - KLINGENBERG C20-780 (Pi	17,200.0	6,893.1	1,824.6	1,598.2	8.127	SF
KLINGENBERG C20-780 - KLINGENBERG C20-780 (S	17,000.0	8,785.0	370.5	272.0	3.824	SF
KLINGENBERG C20-780 - KLINGENBERG C20-780 (S	17,100.0	8,785.0	364.5	270.6	3.945	CC, ES
KLINGENBERG C20-780 - KLINGENBERG C20-780 (S	17,000.0	8,759.5	386.2	287.3	3.967	SF
KLINGENBERG C20-780 - KLINGENBERG C20-780 (S	17,100.0	8,759.8	379.0	284.0	4.058	CC, ES
LONG C20-21D - LONG C20-21D - LONG C20-21D	14,805.6	7,041.0	676.4	498.6	3.837	CC, ES, SF
LONG C20-22D - LONG C20-22D - LONG C20-22D	13,620.2	7,096.4	715.0	556.9	4.571	CC, ES
LONG C20-22D - LONG C20-22D - LONG C20-22D	13,700.0	7,095.2	718.9	558.9	4.539	SF
PREBISH 2 - PREBISH 2 - PREBISH 2	16,840.8	6,871.6	1,274.7	1,055.4	5.861	CC, ES
PREBISH 2 - PREBISH 2 - PREBISH 2	16,900.0	6,871.1	1,276.0	1,055.9	5.842	SF
TODD 20-8 (Vert) - TODD 20-8 - TODD 20-8	13,031.2	6,799.9	1,121.5	624.7	2.263	CC, ES, SF
SEC.21-T4N-R64W (Exist)						
HAMLIN C21-22 (Vert) - HAMLIN C21-22 - HAMLIN C21	3,983.5	3,651.4	328.2	69.0	1.269	Collision Monitoring, CC
HAMLIN C21-22 (Vert) - HAMLIN C21-22 - HAMLIN C21	8,230.1	6,745.9	430.8	-46.3	0.903	Shut in, ES, SF
HANSCOME C21-20 (Vert) - HANSCOME C21-20 - HAN	10,972.3	6,805.8	508.3	20.9	1.043	Collision Monitoring, CC,
HANSCOME C21-21 (Vert) - HANSCOME C21-21 - HAN	9,661.1	6,792.2	517.8	35.3	1.073	Collision Monitoring, CC,
HANSCOME C21-24 (Vert) - HANSCOME C21-24 - HAN	9,579.1	6,792.3	774.5	292.1	1.608	CC, ES, SF
HANSCOME C21-79HN - HANSCOME C21-79HN - HAN	12,400.0	8,196.6	82.5	18.6	1.300	Collision Monitoring, CC,
JULIE C21-25 (Vert) - JULIE C21-25 - JULIE C21-25	10,913.8	6,830.4	961.5	472.3	1.970	CC, ES, SF
KLEIN 21-12 (Vert) - KLEIN 21-12 - KLEIN 21-12	11,648.3	6,807.5	77.2	-413.2	0.154	Unacceptable Path, CC, ES
LEONARD 2 - LEONARD 2 - LEONARD 2	11,584.2	6,782.2	1,137.0	1,023.6	10.198	CC, ES
LEONARD 2 - LEONARD 2 - LEONARD 2	11,700.0	6,782.9	1,142.4	1,027.0	10.065	SF
LEONARD 21-10 (Vert) - LEONARD 21-10 - LEONARD ;	9,000.0	6,770.7	108.4	-371.6	0.222	Unacceptable Path, ES, SF
LEONARD 21-10 (Vert) - LEONARD 21-10 - LEONARD ;	9,000.1	6,770.7	108.4	-371.6	0.222	Unacceptable Path, CC
LEONARD 21-614 - LEONARD 21-614 - LEONARD 21-61	0.0	0.0	1,021.3			
LEONARD 21-614 - LEONARD 21-614 - LEONARD 21-61	10,500.0	6,798.5	1,215.1	1,120.8	13.150	SF
LEONARD 3 (Vert) - LEONARD 3 - LEONARD 3	10,348.8	6,820.6	118.7	-367.8	0.241	Unacceptable Path, CC, ES
LEONARD 4 (Vert) - LEONARD 4 - LEONARD 4	1,743.0	1,667.6	172.1	52.8	1.450	Collision Monitoring, CC
LEONARD 4 (Vert) - LEONARD 4 - LEONARD 4	1,800.0	1,718.4	173.3	50.4	1.418	Collision Monitoring, ES, SF
THOUTT 2 - THOUTT 2 - THOUTT 2	7,700.0	6,889.7	304.7	244.1	5.174	ES, SF
THOUTT 2 - THOUTT 2 - THOUTT 2	7,706.6	6,889.8	304.6	244.2	5.192	CC

CC - Min centre to center distance or convergent point, SF - min separation factor, ES - min ellipse separation

Ensign

Anticollision Summary Report

Company:	Chevron DJ Basin	Local Co-ordinate Reference:	Well GEORGE 15NA
Project:	SEC.21-T4N-R64W	TVD Reference:	WELL @ 4743.0ft (T41 - RKB 25')
Reference Site:	George Pad	MD Reference:	WELL @ 4743.0ft (T41 - RKB 25')
Site Error:	0.0 ft	North Reference:	True
Reference Well:	GEORGE 15NA	Survey Calculation Method:	Minimum Curvature
Well Error:	0.0 ft	Output errors are at	3.50 sigma
Reference Wellbore	GEORGE 15NA	Database:	US_EDM
Reference Design:	GEORGE 15NA Final Surveys	Offset TVD Reference:	Offset Datum

Reference Depths are relative to WELL @ 4743.0ft (T41 - RKB 25') Coordinates are relative to: GEORGE 15NA
 Offset Depths are relative to Offset Datum Coordinate System is US State Plane 1983, Colorado Northern Zone
 Central Meridian is -105.500000 Grid Convergence at Surface is: 0.61°

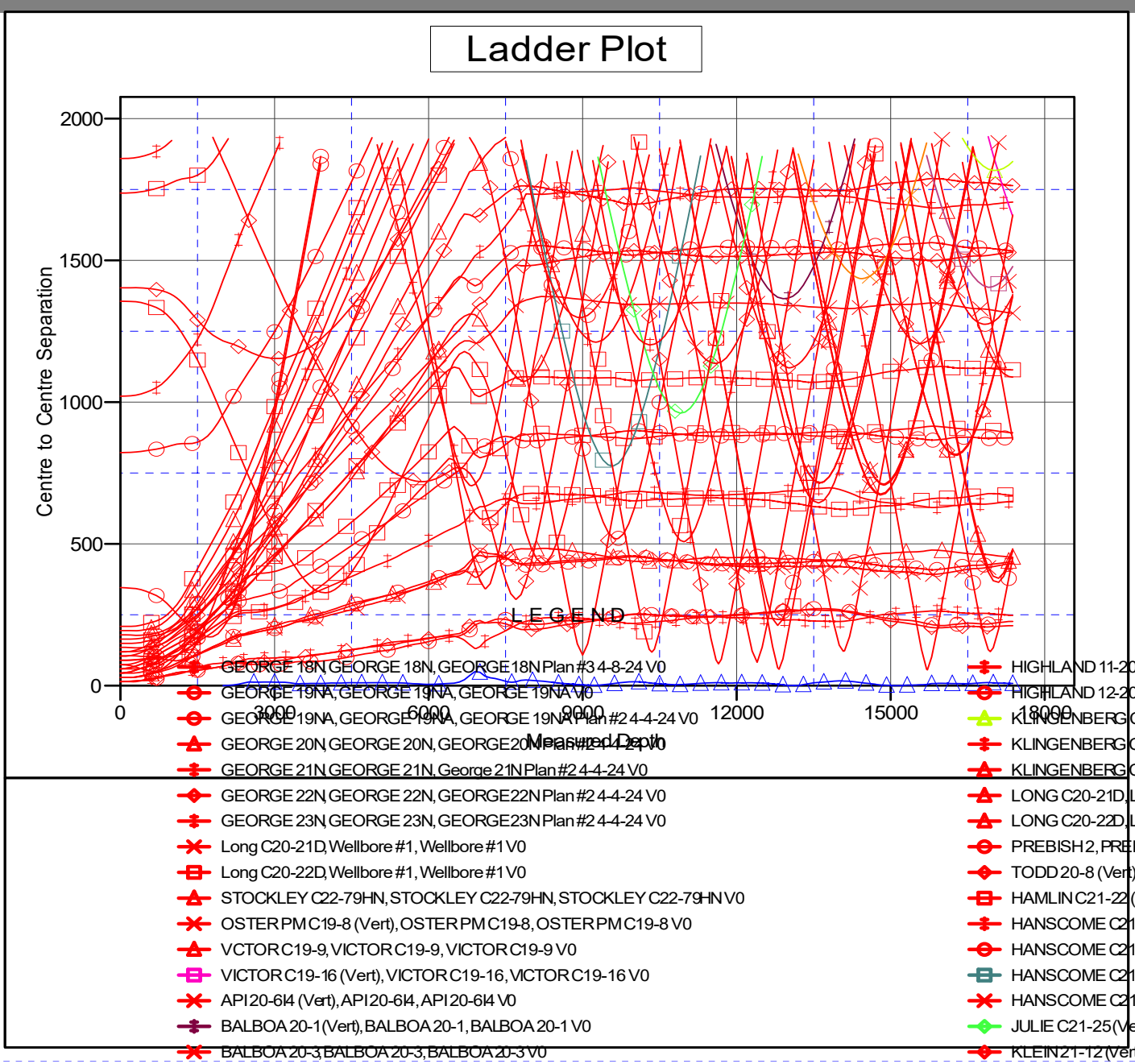

Ensign

Anticollision Summary Report

Company:	Chevron DJ Basin	Local Co-ordinate Reference:	Well GEORGE 15NA
Project:	SEC.21-T4N-R64W	TVD Reference:	WELL @ 4743.0ft (T41 - RKB 25')
Reference Site:	George Pad	MD Reference:	WELL @ 4743.0ft (T41 - RKB 25')
Site Error:	0.0 ft	North Reference:	True
Reference Well:	GEORGE 15NA	Survey Calculation Method:	Minimum Curvature
Well Error:	0.0 ft	Output errors are at	3.50 sigma
Reference Wellbore	GEORGE 15NA	Database:	US_EDM
Reference Design:	GEORGE 15NA Final Surveys	Offset TVD Reference:	Offset Datum

Reference Depths are relative to WELL @ 4743.0ft (T41 - RKB 25') Coordinates are relative to: GEORGE 15NA
 Offset Depths are relative to Offset Datum Coordinate System is US State Plane 1983, Colorado Northern Zone
 Central Meridian is -105.500000 Grid Convergence at Surface is: 0.61°

Separation Factor Plot

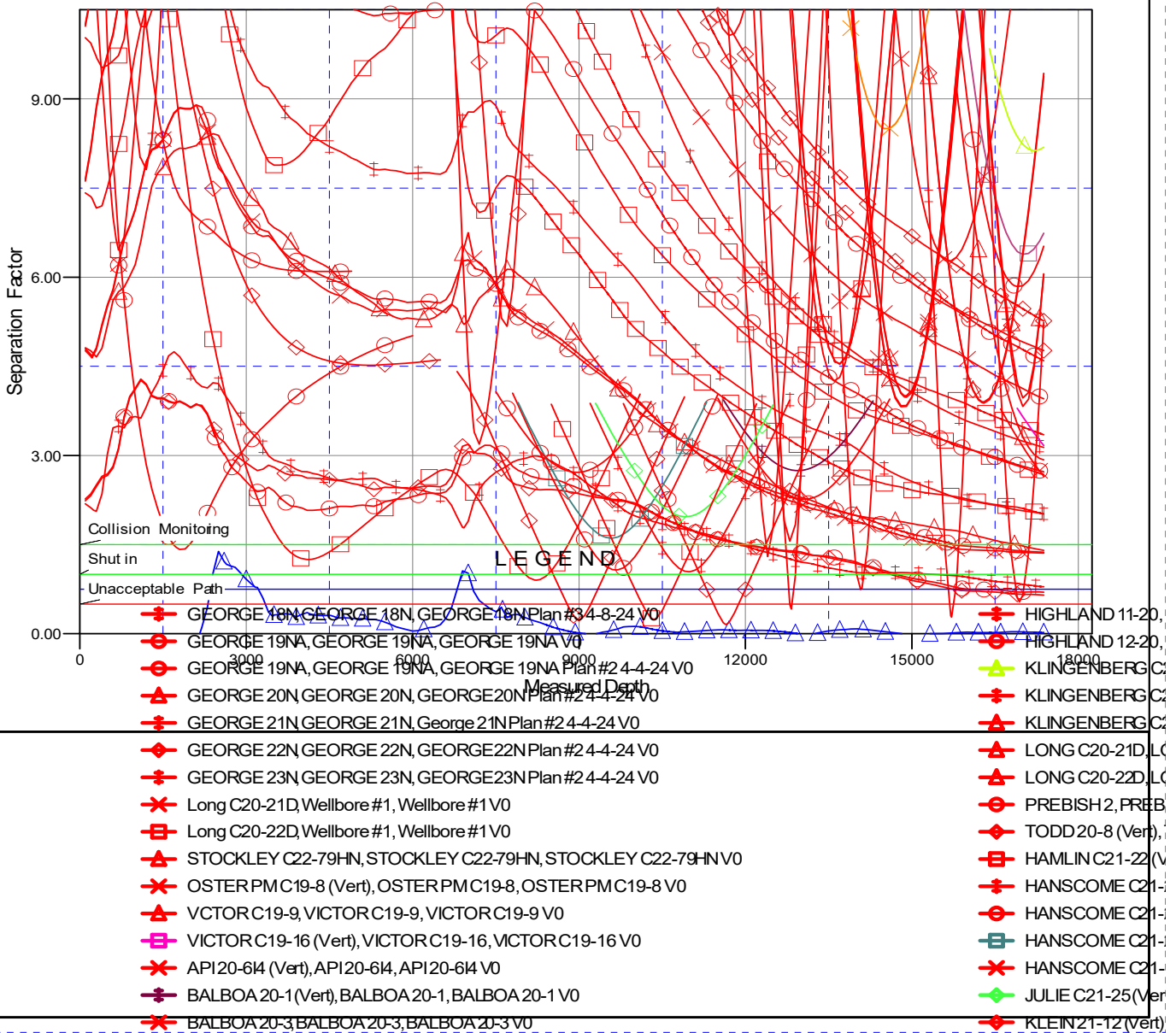

CC - Min centre to center distance or convergent point, SF - min separation factor, ES - min ellipse separation