



FORM F-106



00055496

R. 68W

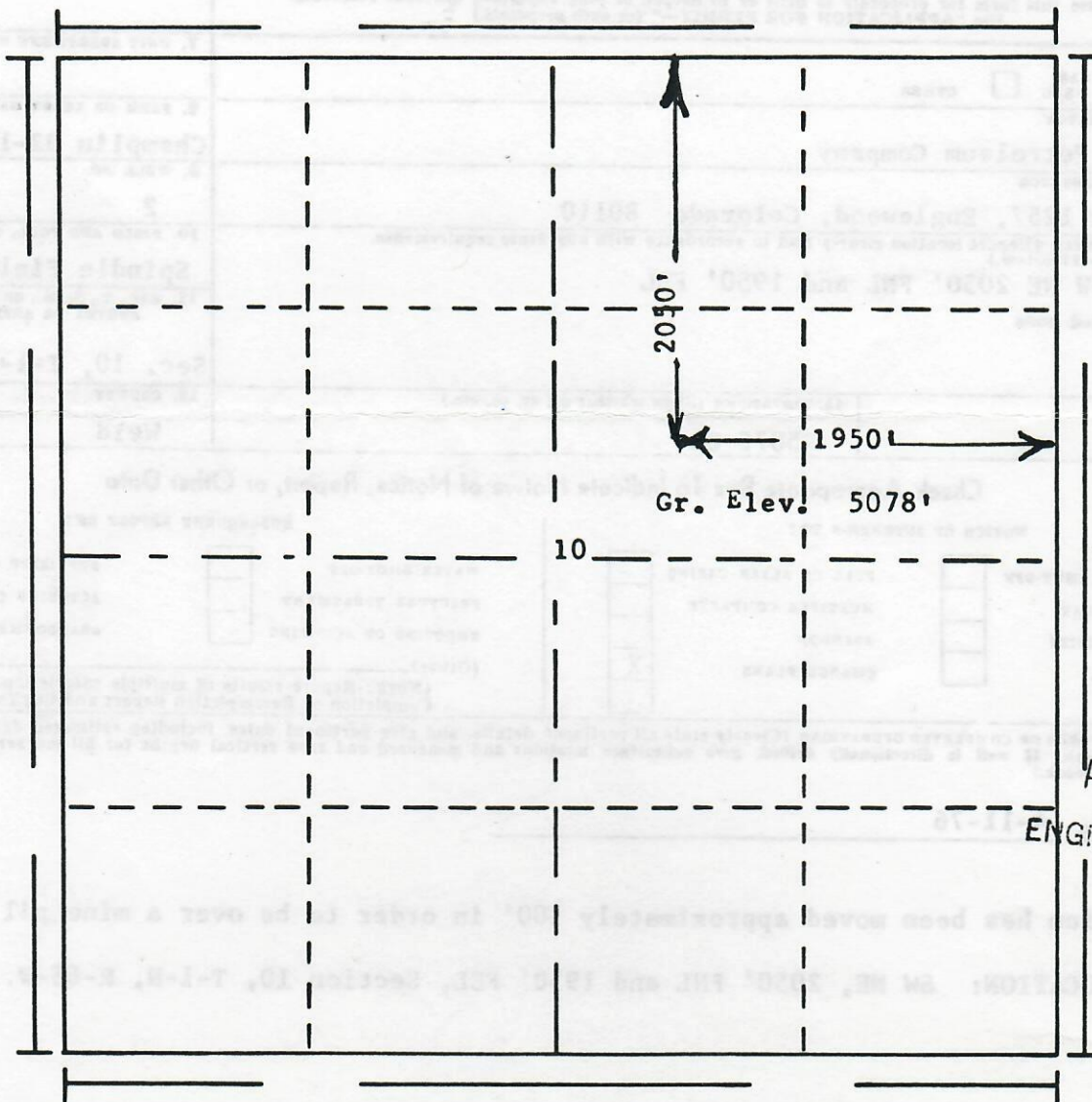
T.
1
N

APR 20 1976

ENGINEERING DEPT.

Scale... 1" = 1000'

Powers Elevation Company, Inc. of Denver, Colorado
has in accordance with a request from Mr. Cooper
for Champlin Petroleum Co.

determined the location of No. 2 Champlin 32-10
to be 2050'FN & 1950'FE Section 10 Township 1N
Range 68W of the 6th Principal Meridian
Weld County, Colorado

I hereby certify that this plat is an
accurate representation of a correct
survey showing the location of

Date: 4-11-76

Bill H. Harty
Licensed Land Surveyor No. 2853
State of Colorado

OIL AND GAS CONSERVATION COMMISSION DEPARTMENT OF NATURAL RESOURCES OF THE STATE OF COLORADO

File in duplicate for Patented and Federal lands.
File in triplicate for State lands.

FEB 10 1987

RECEIVED
APR 14 1976

LEASE DESIGNATION AND SERIAL NO.

UPRR

IF INDIAN, ALLOTTEE OR TRIBE NAME

SUNDRY NOTICES AND REPORTS ON WELLS

(Do not use this form for proposals to drill or to deepen or plug back to a different reservoir.
Use "APPLICATION FOR PERMIT—" for such proposals.)

1. OIL WELL <input checked="" type="checkbox"/> GAS WELL <input type="checkbox"/> OTHER <input type="checkbox"/>		7. UNIT AGREEMENT NAME	
2. NAME OF OPERATOR Champlin Petroleum Company		8. FARM OR LEASE NAME Champlin 32-10 (1-68)	
3. ADDRESS OF OPERATOR P. O. Box 1257, Englewood, Colorado 80110		9. WELL NO. 2	
4. LOCATION OF WELL (Report location clearly and in accordance with any State requirements. See also space 17 below.) At surface SW NE 2050' FNL and 1950' FEL At proposed prod. zone		10. FIELD AND POOL, OR WILDCAT Spindle Field	
14. PERMIT NO. 76218		11. SEC., T., R., M., OR BLK. AND SURVEY OR AREA Sec. 10, T-1-N, R-68-W	
15. ELEVATIONS (Show whether DF, RT, OR, etc.) 5078 GR		12. COUNTY Weld	
		13. STATE Colorado	

16. Check Appropriate Box To Indicate Nature of Notice, Report, or Other Data

NOTICE OF INTENTION TO:

TEST WATER SHUT-OFF

☐
☐
☐
☐

PULL OR ALTER CASING

☐
☐
☐
☒

FRACTURE TREAT

MULTIPLE COMPLETION

SHOOT OR ACIDIZE

ABANDON

REPAIR WELL

CHANGE PLANS

(Other)

SUBSEQUENT REPORT OF:

WATER SHUT-OFF

☐
☐
☐

FRACTURE TREATMENT

REPAIRING WELL

☐
☐
☐

SHOOTING OR ACIDIZING

ALTERING CASING

(Other)

ABANDONMENT

(NOTE: Report results of multiple completion on Well Completion or Recompletion Report and Log form.)

17. DESCRIBE PROPOSED OR COMPLETED OPERATIONS (Clearly state all pertinent details, and give pertinent dates, including estimated date of starting any proposed work. If well is directionally drilled, give subsurface locations and measured and true vertical depths for all markers and zones pertinent to this work.)

Date of work 4-11-76

1. Location has been moved approximately 100' in order to be over a mine pillar.
2. NEW LOCATION: SW NE, 2050' FNL and 1950' FEL, Section 10, T-1-N, R-68-W.

FOR OFFICE USE ONLY
CT
RT
UC
SE

18. I hereby certify that the foregoing is true and correct

SIGNED

D. W. Pitchford

TITLE Drilling EngineerDATE 4-12-76

(This space for Federal or State office use)

APPROVED BY

D. W. Pitchford

TITLE

DATE

CONDITIONS OF APPROVAL, IF ANY: