



FORM F-106



RECEIVED

JUN 22 1984

COLO. OIL & GAS CONS. COMM.

R. 67W

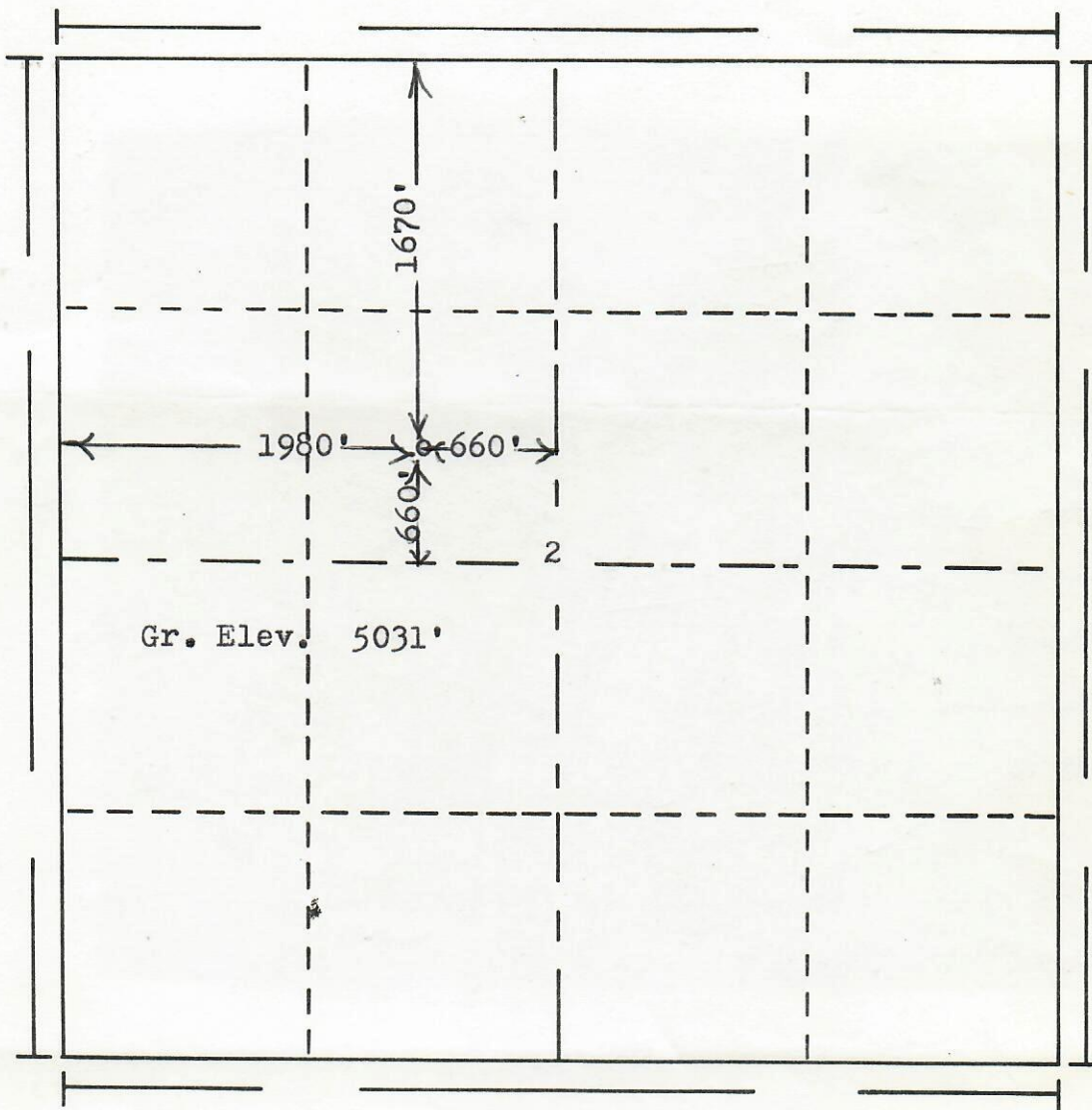
T.
1
S

Scale... 1" = 1000'

Powers Elevation of Denver, Colorado
has in accordance with a request from Mr. Reeve
for Clark Energy Corp.
determined the location of Clark-Guthrie No.2-8
to be CSE NW Section 2 Township 1S
Range 67W of the 6th Principal Meridian
Adams County, Colorado

I hereby certify that this plat is an
accurate representation of a correct
survey showing the location of

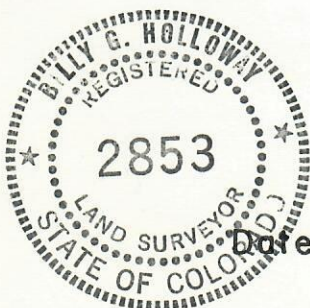

Date: 6-15-84

Billy G. Holloway
Licensed Land Surveyor No. 2853
State of Colorado

RECEIVED

JUL 23 1984

COLO. OIL & GAS COM. COMM.

R. 67W



NGPA FILING

~~SE~~ SENW

Date Check Recd.

API No. 05-001-8475 County Adams

Filing No. 84-2474

Well Name Guthrie 2-8

Date of Check 10/15/85 Check No. 1980 Amount 100

Name of CO. Clark Energy Group

Address _____

Maker of Check Adams

Bank Check Issued On 1st Bank
Castle Rock

Purchaser _____

Address _____

Power Elevation of Denver, Colorado
has in accordance with a request from Mr. Neave
for Clark Energy Corp.
determined the location of Clark-Guthrie No. 2-8
Section 2 Township 18
to be GSE NW
of the 6th Principal
Mendon
Adams County, Colorado

I hereby certify that this plot is an
accurate representation of a correct
survey showing the location of

6-12-84
Licensed Land Surveyor No. 2853
State of Colorado
B. J. [Signature]

