

Wellhead Closure Checklist

COGCC Rule 911.a.(4) Environmental Site Closure Assessment Field Form

Additional attachments (optional): <u> </u>		Pit Closure <u> </u>		Tank Battery Closure <u> </u>		Flowline Closure <u> </u>		Partially Buried Vault Closure <u> </u>
Site Name & COGCC Facility Number: NCLP PC #AA04-05		Date: 10/16/23					Remediation Project #: 30352	
Associated Wells: 05-123-29482		Age of Site: years					Number of Photos Attached: 2	
Location: (GPS coordinates of wellhead or southeastern most wellhead for multiple)							40.517612 / -104.448838	
General Condition of Site: (General observations regarding housekeeping, corrosion, waste management, etc.)								
Good condition								
USCS Soil Type: Clayey SAND					Estimated Depth to Groundwater: ~15-25'			
Hydrocarbon Impacted Soils / Spills: (Note estimated size and if impact appears to be surficial or extends to an unknown depth)								
None observed								
Salt Crusted Soils or Impacted Vegetation: (Note estimated size and if impact appears to be surficial or extends to an unknown depth)								
None observed								
Wellhead(s)								
Well API	05-123-29482							
Age	years							
Condition of surface around wellhead	Good - No odor/no staining							
PID Readings	WH-N: 0.8	WH-E: 1.0	WH-S: 0.9	WH-W: 0.8				
Condition of subsurface (staining present)	Good - No odor/no staining							
PID Readings	4.6	2.9	1.6	8.5	9.6			
Sample taken? Location/Sample ID#	WH-SS-01	WH-SS-02	WH-SS-03	WH-SS-04	WH-FS-01			
Photo Number(s)	See photo log							
Other observations regarding wellheads:								
Well casing cut/capped following assessment								
Summary								
Was impacted soil identified?								
<input checked="" type="radio"/> No Yes - less than 10 cubic yards Yes - more than 10 cubic yards								
Total number of samples field screened: 9					Total number of samples collected: 9			
Highest PID Reading: 9.6					Total number of samples submitted to lab for analysis: 1			
If more than 10 cubic yards of impacted soil were observed:								
Vertical extent:					Estimated spill volume:			
Lateral extent:					Volume of soil removed:			
Is additional investigation required?								
Was groundwater encountered during the investigation?								
<input checked="" type="radio"/> No Yes - not impacted or in contact with impacted soils Yes - groundwater impacted and/or in contact with impacted soils								
Measured depth to groundwater:					Was remedial groundwater removal conducted? Yes No			
Date Groundwater was encountered:					Commencement date of removal:			
Sheen on groundwater? Yes No					Volume of groundwater removed prior to sampling:			
Free product observed? Yes No					Volume of groundwater removed post sampling:			
Total number of samples collected:					Total Volume of groundwater removed:			
Total number of samples submitted to lab for analysis:								



FIGURES

Figure 1: Topographic Site Location Map

Figure 2: Aerial Site Location Map

Figure 3: Sample Location Map

Figure 4: Soil Analytical Map

Figure 5: Metals in Soil Map

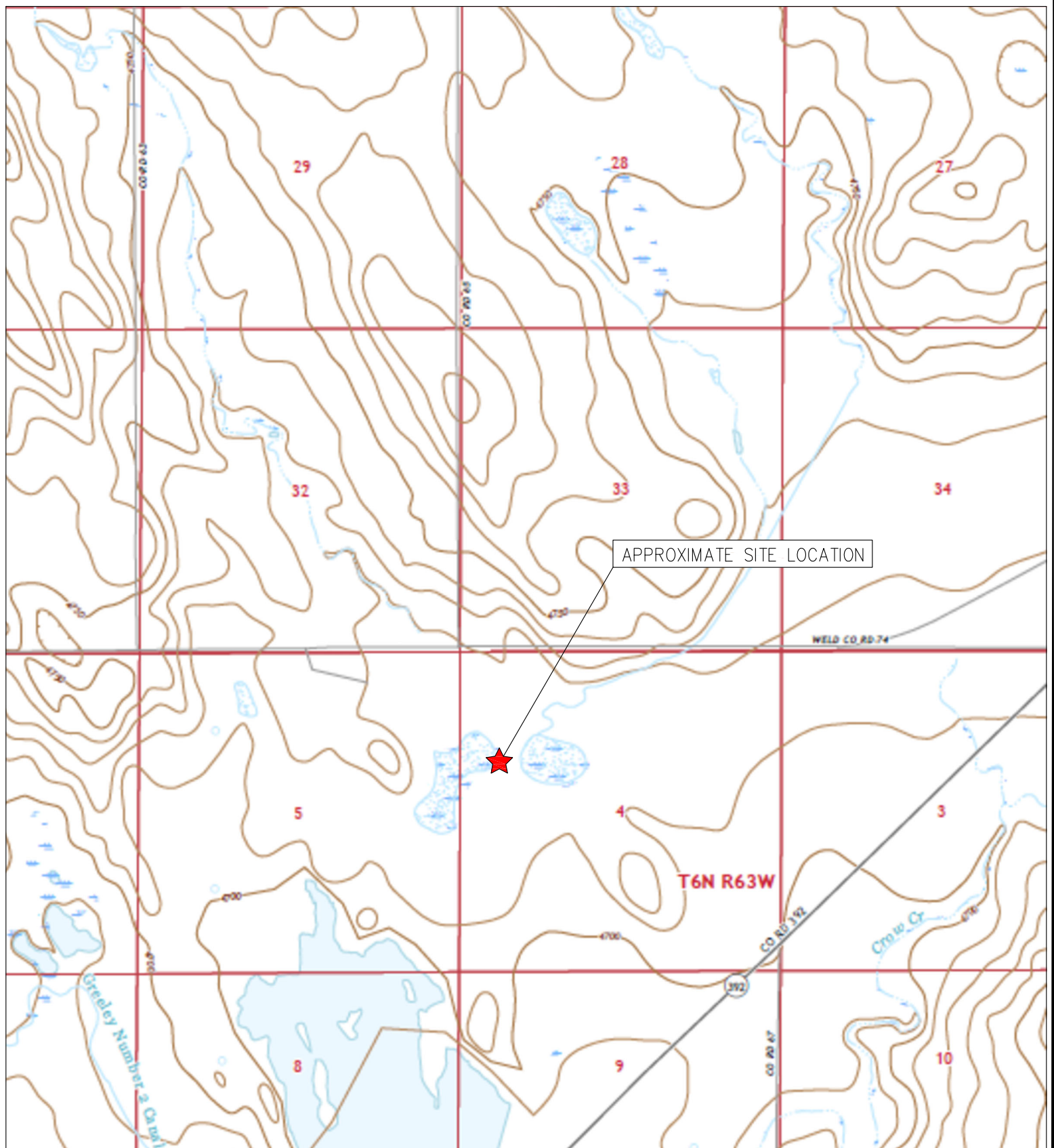

TOPOGRAPHIC SITE LOCATION MAP
 NCLP PC #AA04-05
 CLOSURE ASSESSMENT
 40.517612 / -104.448838
 SW¼ NW¼ SEC.4 T6N R63W 6PM
 WELD COUNTY, COLORADO
 API # 05-123-29482
 REMEDIATION # 30352



EAGLE
 ENVIRONMENTAL
 CONSULTING, LLC

8000 W 44th Ave, Wheat Ridge, CO 80033
 Ph: 303-433-0479 • F: 303-325-5449

SOURCE: USGS 7.5 MINUTE TOPOGRAPHIC MAP,
 CORNISH, CO QUADRANGLE 2022

FIGURE NO. 1



LEGEND

FORMER NCLP PC #AA04-05 WELLHEAD (PLUGGED AND ABANDONED)

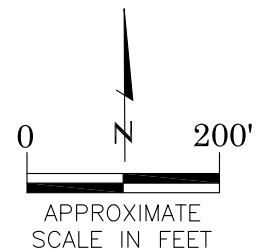

AERIAL SITE LOCATION MAP
NCLP PC #AA04-05
CLOSURE ASSESSMENT
40.517612 / -104.448838
SW $\frac{1}{4}$ NW $\frac{1}{4}$ SEC.4 T6N R63W 6PM
WELD COUNTY, COLORADO
API # 05-123-29482
REMEDATION # 30352

FIGURE NO.
2

DRAWN BY:
BB



EAGLE
ENVIRONMENTAL
CONSULTING, LLC
8000 W 44th Ave, Wheat Ridge, CO 80033
Ph: 303-433-0479 • F: 303-325-5449

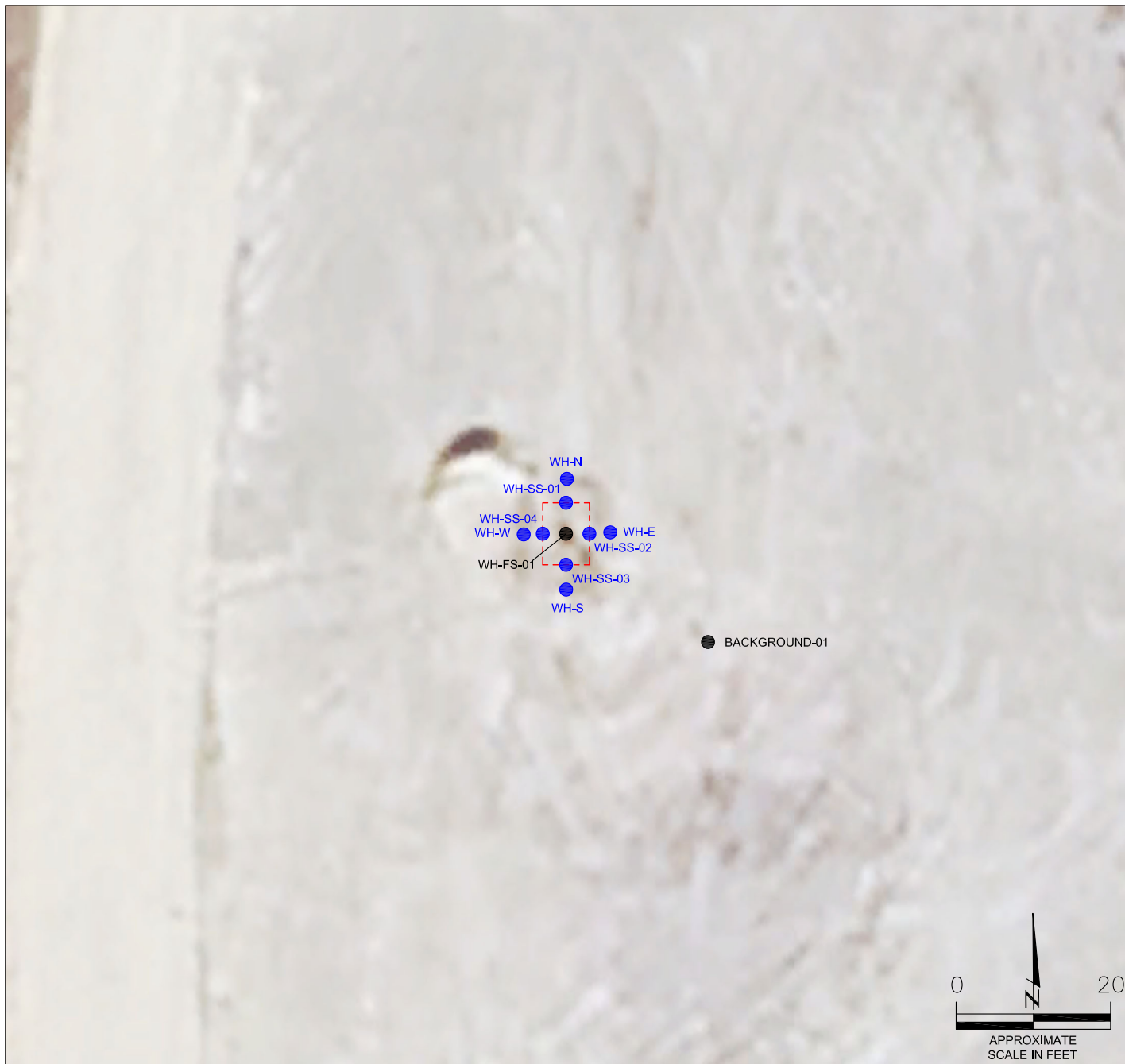

LEGEND

- WELLHEAD ASSESSMENT BOUNDARIES
- SS-02 APPROXIMATE LOCATION OF SOIL SAMPLES FIELD SCREENED, ONLY, WITH PHOTOIONIZATION DETECTOR
- SS-02 APPROXIMATE LOCATION OF SOIL SAMPLES SUBMITTED FOR LABORATORY ANALYSIS

SAMPLE LOCATION MAP
NCLP PC #AA04-05
CLOSURE ASSESSMENT
40.517612 / -104.448838
SW¼ NW¼ SEC.4 T6N R63W 6PM
WELD COUNTY, COLORADO
API # 05-123-29482
REMEDIALTION # 30352

FIGURE NO.
3

DRAWN BY:
BB



EAGLE
ENVIRONMENTAL
CONSULTING, LLC
8000 W 44th Ave, Wheat Ridge, CO 80033
Ph: 303-433-0479 • F: 303-325-5449

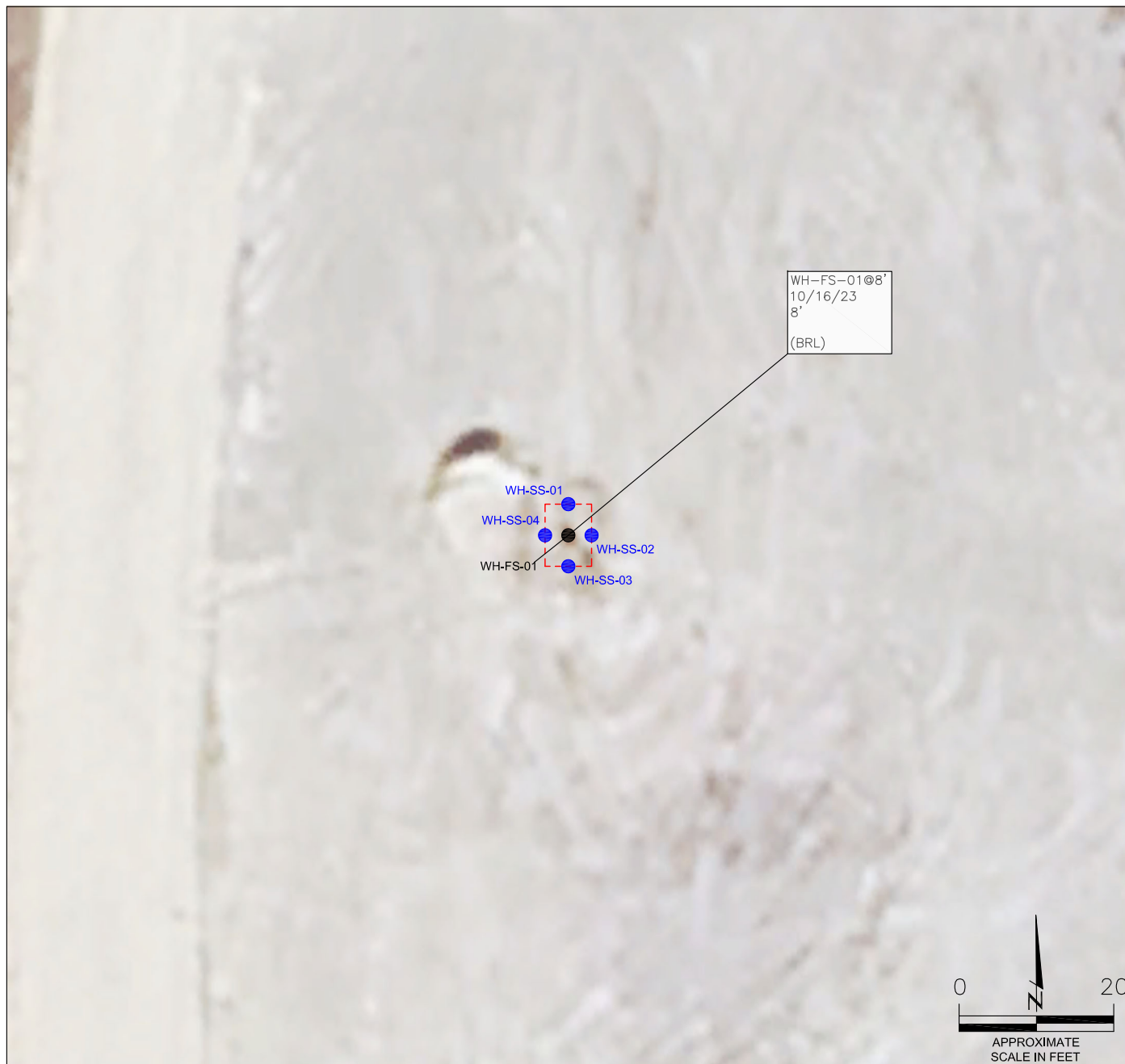

LEGEND

- WELLHEAD ASSESSMENT BOUNDARIES
- APPROXIMATE LOCATION OF SOIL SAMPLES FIELD SCREENED, ONLY, WITH PHOTOIONIZATION DETECTOR
- APPROXIMATE LOCATION OF SOIL SAMPLES SUBMITTED FOR LABORATORY ANALYSIS

PARAMETERS

SAMPLE LOCATION
DATE
DEPTH (FEET)
B = BENZENE (mg/kg)
T = TOLUENE (mg/kg)
E = ETHYLBENZENE (mg/kg)
X = TOTAL XYLENES (mg/kg)
N = NAPHTHALENE (mg/kg)
G = TPH-GRO (mg/kg)
D = TPH-DRO (mg/kg)
R = TPH-RRO (mg/kg)
1,2,4-TMB = 1,2,4 TRIMETHYLBENZENE (mg/kg)
1,3,5-TMB = 1,3,5 TRIMETHYLBENZENE (mg/kg)
Brn= BORON (mg/L)
EC = SPECIFIC CONDUCTANCE (mmhos/cm)
SAR= SODIUM ADSORPTION RATIO
pH = pH (pH UNITS)
POLYCYCLIC AROMATIC HYDROCARBONS (PAHs) (mg/kg)

mg/kg = MILLIGRAMS PER KILOGRAM
mg/L = MILLIGRAMS PER LITER
mmhos/cm = MILLIMHOS PER CENTIMETER

(BRL) = ALL VALUES BELOW REGULATORY LIMITS

TPH-GRO = TOTAL PETROLEUM HYDROCARBONS - GASOLINE RANGE ORGANICS
TPH-DRO = TOTAL PETROLEUM HYDROCARBONS - DIESEL RANGE ORGANICS
TPH-RRO = TOTAL PETROLEUM HYDROCARBONS - RESIDUAL RANGE ORGANICS

NOTES:
VALUES PRESENTED IN **BOLD** EXCEED ECMC TABLE 915-1 REGULATORY LIMITS.

ECMC = ENERGY & CARBON MANAGEMENT COMMISSION

SOIL ANALYTICAL MAP
NCLP PC #AA04-05
CLOSURE ASSESSMENT
40.517612 / -104.448838
SW¼ NW¼ SEC.4 T6N R63W 6PM
WELD COUNTY, COLORADO
API # 05-123-29482
REMEDATION # 30352

FIGURE NO.
4

DRAWN BY:
BB



EAGLE
ENVIRONMENTAL
CONSULTING, LLC
8000 W 44th Ave, Wheat Ridge, CO 80033
Ph: 303-433-0479 • F: 303-325-5449

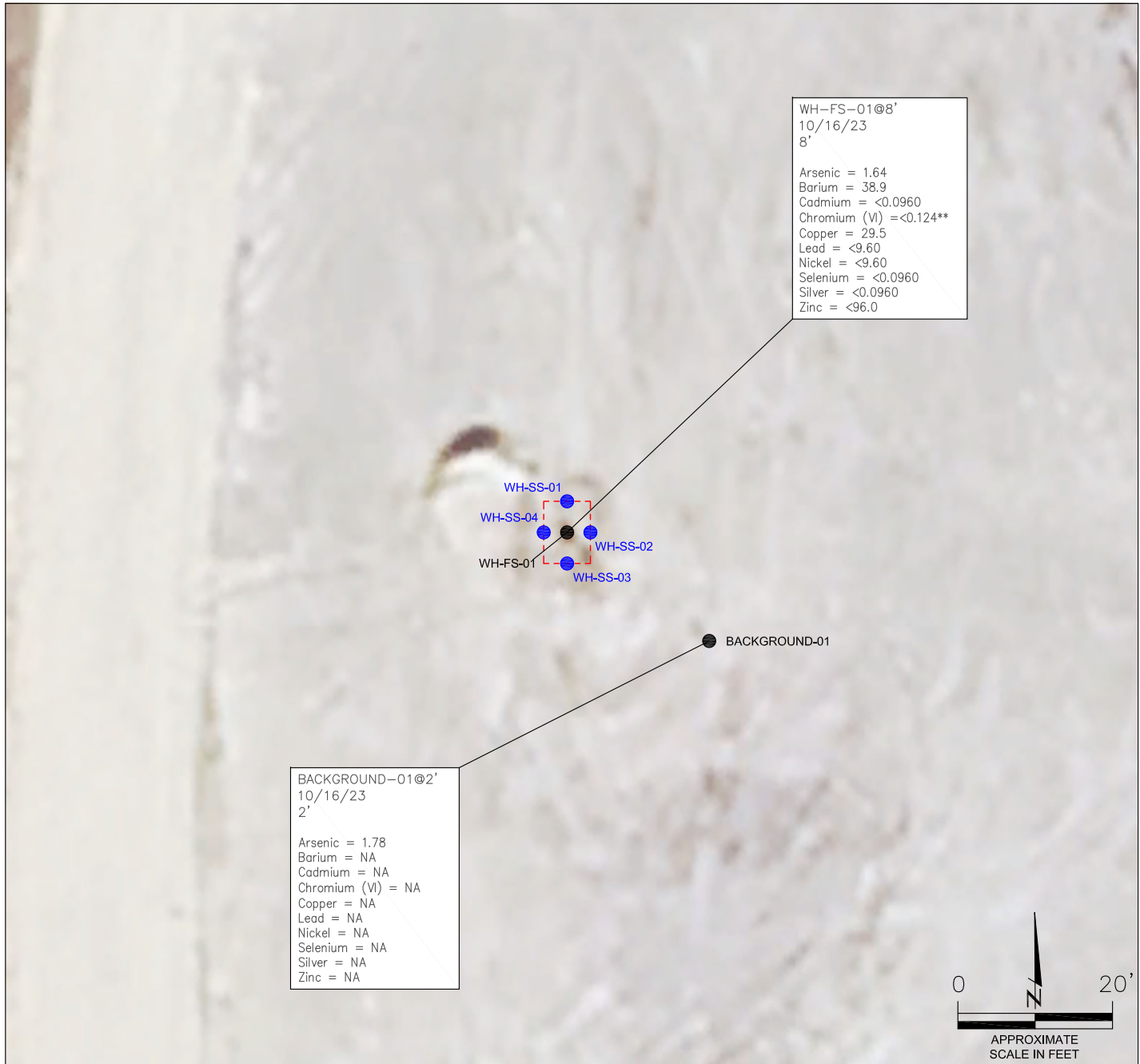

WH-FS-01@8'
10/16/23
8'

Arsenic = 1.64
Barium = 38.9
Cadmium = <0.0960
Chromium (VI) = <0.124**
Copper = 29.5
Lead = <9.60
Nickel = <9.60
Selenium = <0.0960
Silver = <0.0960
Zinc = <96.0

BACKGROUND-01@2'
10/16/23
2'

Arsenic = 1.78
Barium = NA
Cadmium = NA
Chromium (VI) = NA
Copper = NA
Lead = NA
Nickel = NA
Selenium = NA
Silver = NA
Zinc = NA

LEGEND

- WELLHEAD ASSESSMENT BOUNDARIES
- SS-02 APPROXIMATE LOCATION OF SOIL SAMPLES FIELD SCREENED, ONLY, WITH PHOTOIONIZATION DETECTOR
- SS-02 APPROXIMATE LOCATION OF SOIL SAMPLES SUBMITTED FOR LABORATORY ANALYSIS

PARAMETERS

SAMPLE LOCATION
DATE SAMPLE COLLECTED
APPROXIMATE DEPTH
Arsenic = (mg/kg)
Barium = (mg/kg)
Cadmium = (mg/kg)
Chromium (VI) = (mg/kg)
Copper = (mg/kg)
Lead = (mg/kg)
Nickel = (mg/kg)
Selenium = (mg/kg)
Silver = (mg/kg)
Zinc = (mg/kg)

mg/kg = MILLIGRAMS PER KILOGRAM

NA = NOT ANALYZED

NOTES:
VALUES PRESENTED WITH A LESS THAN SYMBOL (<) DID NOT CONTAIN CONCENTRATIONS AT/OR ABOVE LABORATORY REPORTING LIMITS AND/OR MINIMUM DETECTION LIMITS.

ELEVATED METALS ARE NATURALLY OCCURRING IN COLORADO. LOCAL CLEAN-UP LEVELS ARE 1.25*BACKGROUND CONCENTRATIONS WHERE APPLICABLE.

VALUES PRESENTED IN **BOLD** EXCEED ECMC TABLE 915-1 REGULATORY LIMITS AND APPLICABLE LOCAL CLEAN-UP LEVELS.

****ACHIEVABLE PRACTICAL QUANTITATIVE LIMITS FOR HEXAVALENT CHROMIUM (Cr VI) IN SOILS IS IN THE RANGE OF 0.1 TO 1 mg/kg.**

ECMC = ENERGY & CARBON MANAGEMENT COMMISSION

METALS IN SOIL MAP
NCLP PC #AA04-05
CLOSURE ASSESSMENT
40.517612 / -104.448838
SW¼ NW¼ SEC.4 T6N R63W 6PM
WELD COUNTY, COLORADO
API # 05-123-29482
REMEDATION # 30352

FIGURE NO.
5

DRAWN BY:
BB



EAGLE
ENVIRONMENTAL
CONSULTING, LLC
8000 W 44th Ave, Wheat Ridge, CO 80033
Ph: 303-433-0479 • F: 303-325-5449



TABLES

Table 1: Photoionization Detector Reading Summary

Table 2: Soil Analytical Results Summary

TABLE 1
PHOTOIONIZATION DETECTOR READING SUMMARY
NCLP PC #AA04-05
CLOSURE ASSESSMENT
40.517612 / -104.448838
SW¼ NW¼ SEC.4 T6N R63W 6PM
WELD COUNTY, COLORADO
API # 05-123-29482
REMEDIALTION # 30352

Sample Location (Latitude/Longitude)	Date	Approximate Depth (feet)	PID Reading (ppm-v)	Lab Submission (Y/N)
WH-FS-01 @ 8' (40.517610 / -104.448843)	10/16/23	8	9.6	Y
WH-SS-01 @ 7' (40.517622 / -104.448843)	10/16/23	7	4.6	N
WH-SS-02 @ 7' (40.517610 / -104.448832)	10/16/23	7	2.9	N
WH-SS-03 @ 7' (40.517600 / -104.448843)	10/16/23	7	1.6	N
WH-SS-04 @ 7' (40.517610 / -104.448856)	10/16/23	7	8.5	N
WH-N @ 0.5' (40.517629 / -104.448843)	10/16/23	0.5	0.8	N
WH-E @ 0.5' (40.517610 / -104.448823)	10/16/23	0.5	1.0	N
WH-S @ 0.5' (40.517590 / -104.448843)	10/16/23	0.5	0.9	N
WH-W @ 0.5' (40.517610 / -104.448864)	10/16/23	0.5	0.8	N
Background-01 @ 2' (40.517573 / -104.448780)	10/16/23	2	1.2	Y
(Y/N) = Yes or No ppm-v = parts per million by volume PID = Photoionization Detector				



TABLE 2
SOIL ANALYTICAL RESULTS SUMMARY
NCLP PC #AA04-05
CLOSURE ASSESSMENT
40.517612 / -104.448838
SW¼ NW¼ SEC.4 T6N R63W 6PM
WELD COUNTY, COLORADO
API # 05-123-29482
REMEDIALTION # 30352

Sample Location				WH-FS-01 @ 8'		Background-01 @ 2'	
(Latitude / Longitude)				(40.517610 / -104.448843)		(40.517573 / -104.448780)	
Sample Date				10/16/2023		10/16/2023	
Sample Depth				8'		2'	
PID Reading (ppm-v)				9.6		1.2	
Regulatory Limits							
Chemical of Concern	Units	ECMC Table 915-1 RSSLs	ECMC Table 915-1 GSSLs	Local Clean-Up Level			
VOCs							
Benzene	mg/kg	1.2	0.0026	--	<0.00200	NA	
Toluene	mg/kg	490	0.69	--	<0.00200	NA	
Ethylbenzene	mg/kg	5.8	0.78	--	<0.00200	NA	
Total Xylenes	mg/kg	58	9.9	--	<0.00200	NA	
Naphthalene	mg/kg	2	0.0038	--	<0.00380	NA	
1,2,4-Trimethylbenzene	mg/kg	30	0.0081	--	<0.00200	NA	
1,3,5-Trimethylbenzene	mg/kg	27	0.0087	--	<0.00200	NA	
TOTAL PETROLEUM HYDROCARBONS							
TPH-GRO	mg/kg	500	--	--	<0.200	NA	
TPH-DRO	mg/kg	500	--	--	<25.0	NA	
TPH-RRO	mg/kg	500	--	--	<100	NA	
POLYCYCLIC AROMATIC HYDROCARBONS							
1-Methyl-naphthalene	mg/kg	18	0.006	--	<0.002	NA	
2-Methyl-naphthalene	mg/kg	24	0.019	--	<0.002	NA	
Acenaphthene	mg/kg	360	0.55	--	<0.020	NA	
Anthracene	mg/kg	1800	5.8	--	<0.020	NA	
Benzo(a)-anthracene	mg/kg	1.1	0.011	--	<0.005	NA	
Benzo(a)-pyrene	mg/kg	0.11	0.24	--	<0.020	NA	
Benzo(b)-fluoranthene	mg/kg	1.1	0.3	--	<0.020	NA	
Benzo(k)-fluoranthene	mg/kg	11	2.9	--	<0.020	NA	
Chrysene	mg/kg	110	9	--	<0.020	NA	
Dibenzo(a,h)-anthracene	mg/kg	0.11	0.096	--	<0.020	NA	
Fluoranthene	mg/kg	240	8.9	--	<0.020	NA	
Fluorene	mg/kg	240	0.54	--	<0.020	NA	
Indeno(1,2,3-cd)-pyrene	mg/kg	1.1	0.98	--	<0.020	NA	
Pyrene	mg/kg	180	1.3	--	<0.020	NA	
SOIL SUITABILITY (Inorganics)							
Boron	mg/L	2	--	--	0.110	NA	
pH	standard unit	6-8.3	--	--	8.09	NA	
Sodium Adsorption Ratio (SAR)	--	<6	--	--	2.23	NA	
Specific Conductance (EC)	mmhos/cm	<4	--	--	0.660	NA	
METALS							
Arsenic	mg/kg	0.68	0.29	2.23	1.64	1.78	
Barium	mg/kg	15000	82	--	38.9	NA	
Cadmium	mg/kg	71	0.38	--	<0.0960	NA	
Copper	mg/kg	3100	46	--	29.5	NA	
Lead	mg/kg	400	14	--	<9.60	NA	
Nickel	mg/kg	1500	26	--	<9.60	NA	
Selenium	mg/kg	390	0.26	--	<0.0960	NA	
Silver	mg/kg	390	0.8	--	<0.0960	NA	
Zinc	mg/kg	23000	370	--	<96.0	NA	
Hexavalent Chromium	mg/kg	0.3**	0.00067**	0.1 to 1.0**	<0.124**	NA	
ECMC = Energy & Carbon Management Commission mg/kg = milligrams per kilogram mmhos/cm = millimhos per centimeter PID = Photoionization Detector ppm-v = parts per million by volume mg/L = milligrams per liter SAR = Sodium Adsorption Ratio Notes: Values presented with a less than symbol (<) did not contain concentrations at or above the laboratory reporting limit and/or minimum detection limit. Elevated metals are naturally occurring in Colorado. Local Clean-up Levels are 1.25*Background concentrations where applicable. Values presented in BOLD exceed ECMC Table 915-1 Regulatory Limits and applicable Local Clean-up Levels. **Achievable practical quantitative limits for Hexavalent Chromium in soils is in the range of 0.1 to 1 mg/kg.							



ATTACHMENT A

Photo Log

NCLP PC #AA04-05
API # 05-123-29482
Remediation # 30352

Closure Assessment

October 2023



Wellhead Excavation – 10/16/23

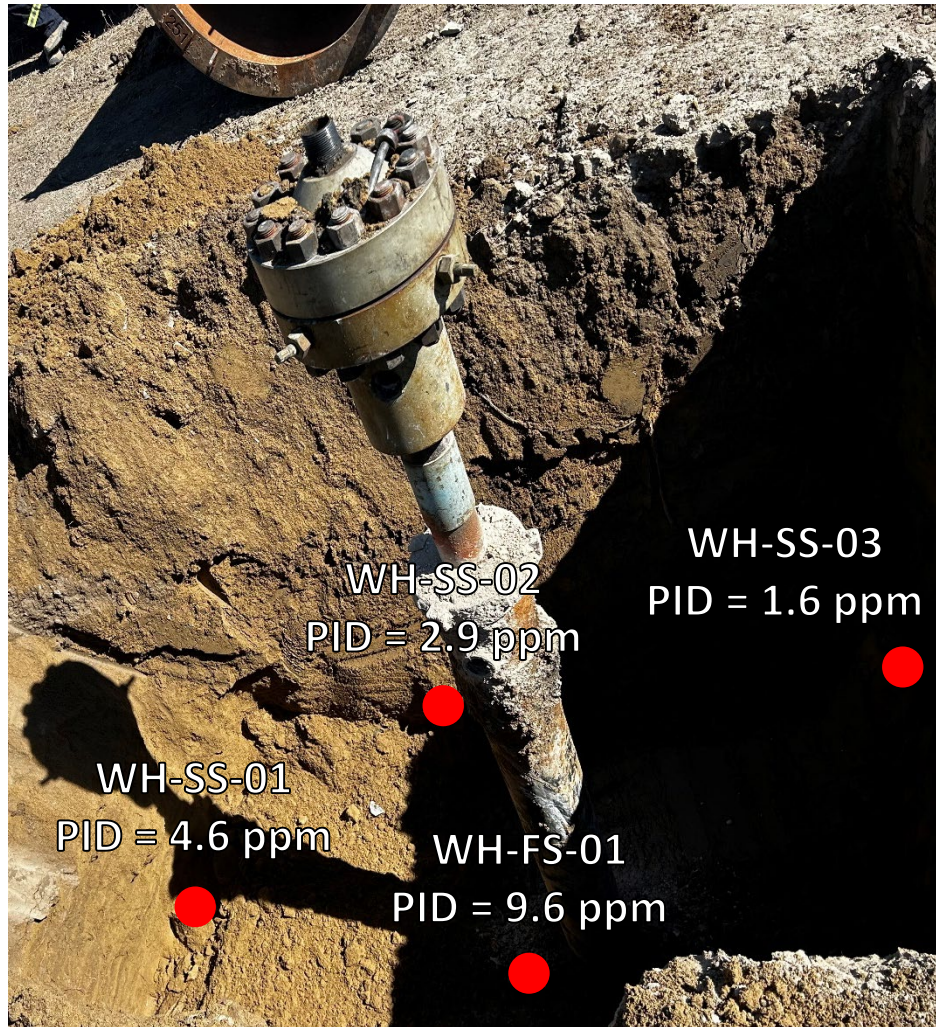

Looking east

No petroleum hydrocarbon staining or odor observed

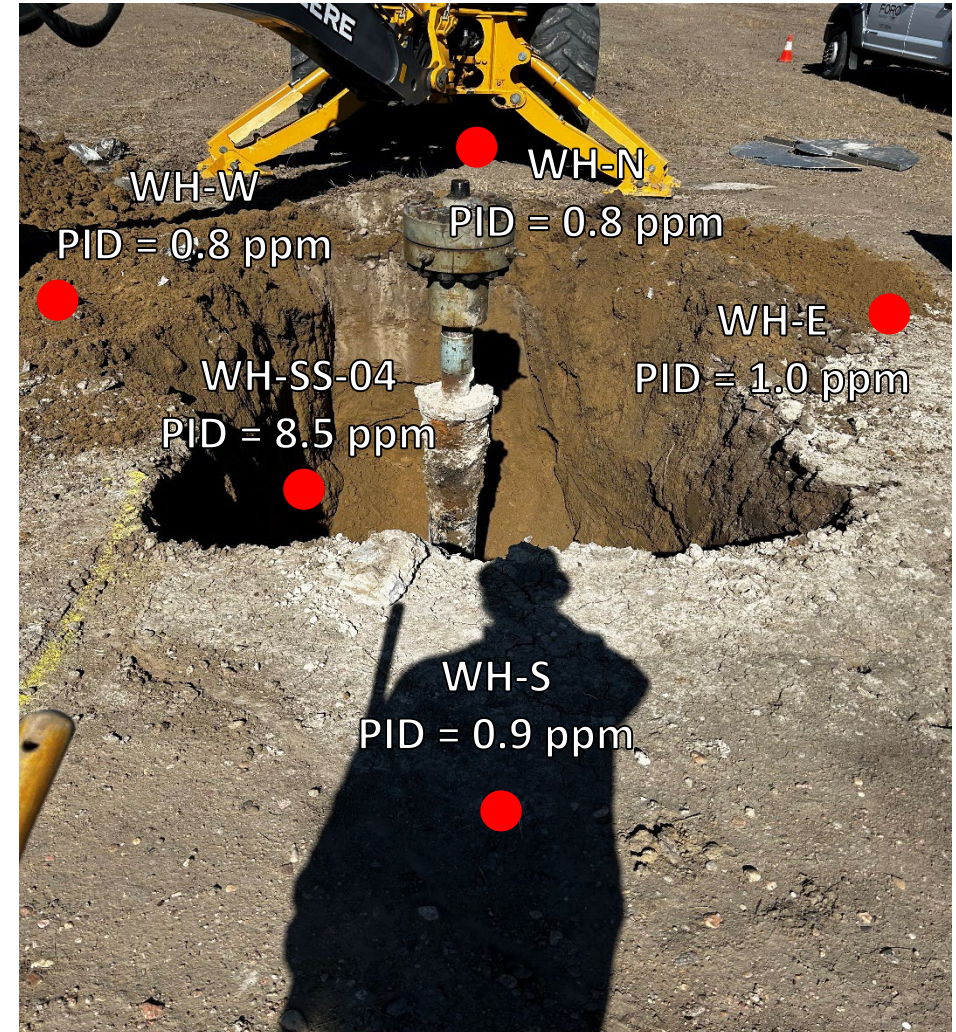

Looking north

No petroleum hydrocarbon staining or odor observed



ATTACHMENT B

Laboratory Analytical Reports



October 31, 2023

Eagle Environmental Consulting, LLC

Andrew Newberry

8000 W 44th Ave

Wheat Ridge CO 80033

Project Name - Noble - NCLP PC #AA04-05

Project Number - [none]

Attached are your analytical results for Noble - NCLP PC #AA04-05 received by Origins Laboratory, Inc. October 16, 2023. This project is associated with Origins project number Y310441-01.

The analytical results in the following report were analyzed under the guidelines of EPA Methods. These methods are identified as follows; "SW" are defined in SW-846, "EPA" are defined in 40CFR part 136 and "SM" are defined in the most current revision of Standard Methods For the Examination of Water and Wastewater.

The analytical results apply specifically to the samples and analyses specified per the attached Chain of Custody. As such, this report shall not be reproduced except in full, without the written approval of Origin's laboratory.

Unless otherwise noted, the analytical results for all soil samples are reported on a wet weight basis. All analytical analyses were performed under NELAP guidelines unless noted by a data qualifier.

Any holding time exceedances, deviations from the method specifications or deviations from Origins Laboratory's Standard Operating Procedures are outlined in the case narrative.

Thank you for selecting Origins for your analytical needs. Please contact us with any questions concerning this report, or if we can help with anything at all.

Origins Laboratory, Inc.
303.433.1322
o-squad@oelabinc.com



1725 Elk Place, Denver, CO 80211 | Phone: 303.433.1322 | Fax: 303.265.9645

Eagle Environmental Consulting, LLC
8000 W 44th Ave
Wheat Ridge CO 80033

Andrew Newberry
Project Number: [none]
Project: Noble - NCLP PC #AA04-05

CROSS REFERENCE REPORT

Sample ID	Laboratory ID	Matrix	Date Sampled	Date Received
WH-FS-01@8'	Y310441-01	Soil	October 16, 2023 13:35	10/16/2023 15:45

Origins Laboratory, Inc.



The results in this report apply to the samples analyzed in accordance with the chain of custody document. This analytical report must be reproduced in its entirety.

Jordan A. Bynon, Project Manager

Eagle Environmental Consulting, LLC
8000 W 44th Ave
Wheat Ridge CO 80033

Andrew Newberry
Project Number: [none]
Project: Noble - NCLP PC #AA04-05

Origins Laboratory

F-012207-01-R1
Effective Date: 01/09/12

Sample Receipt Checklist

Origins Work Order: YB10441

Client: Eagle

Client Project ID: NCLP PC #AA04-05

Checklist Completed by: TJH/EHS

Shipped Via: TD

(UPS, FedEx, Hand Delivered, Pick-up, etc.)

Date/time completed: 10/17/23

Airbill #: N/A

Matrix(s) Received: (Check all that apply): X Soil/Solid Water Other: (Describe)

Cooler Number/Temperature: 1 / 4.3 °C / °C / °C

Thermometer ID: T004

Requirement Description	Yes	No	N/A	Comments (if any)
If samples require cooling, was the temperature between 0°C to ≤ 6°C ⁽¹⁾ ?	<input checked="" type="checkbox"/>	<input type="checkbox"/>	<input type="checkbox"/>	
Is there ice present (document if blue ice is used)	<input checked="" type="checkbox"/>	<input type="checkbox"/>	<input type="checkbox"/>	
Are custody seals present on cooler? (if so, document in comments if they are signed and dated, broken or intact)	<input type="checkbox"/>	<input checked="" type="checkbox"/>	<input type="checkbox"/>	
Are custody seals present on each sample container? (if so, document in comments if they are signed and dated, broken or intact)	<input type="checkbox"/>	<input checked="" type="checkbox"/>	<input type="checkbox"/>	
Were all samples received intact ⁽¹⁾ ?	<input checked="" type="checkbox"/>	<input type="checkbox"/>	<input type="checkbox"/>	
Was adequate sample volume provided ⁽¹⁾ ?	<input checked="" type="checkbox"/>	<input type="checkbox"/>	<input type="checkbox"/>	
Are short holding time analytes or samples with HTs due within 48 hours present ⁽¹⁾ ?	<input type="checkbox"/>	<input checked="" type="checkbox"/>	<input type="checkbox"/>	
Is a chain-of-custody (COC) present and filled out completely ⁽¹⁾ ?	<input checked="" type="checkbox"/>	<input type="checkbox"/>	<input type="checkbox"/>	
Does the COC agree with the number and type of sample bottles received ⁽¹⁾ ?	<input checked="" type="checkbox"/>	<input type="checkbox"/>	<input type="checkbox"/>	
Do the sample IDs on the bottle labels match the COC ⁽¹⁾ ?	<input checked="" type="checkbox"/>	<input type="checkbox"/>	<input type="checkbox"/>	
Is the COC properly relinquished by the client with date and time recorded ⁽¹⁾ ?	<input checked="" type="checkbox"/>	<input type="checkbox"/>	<input type="checkbox"/>	
For volatiles in water – is there headspace (> ¼ inch bubble) present? If yes, contact client and note in narrative.	<input type="checkbox"/>	<input type="checkbox"/>	<input checked="" type="checkbox"/>	
Are samples preserved that require preservation and was it checked ⁽¹⁾ ? (note ID of confirmation instrument used in comments) / (preservation is not confirmed for subcontracted analyses in order to insure sample integrity)/(pH <2 for samples preserved with HNO ₃ , HCL, H ₂ SO ₄) / (pH >10 for samples preserved with NaAsO ₂ +NaOH, ZnAc+NaOH)	<input type="checkbox"/>	<input type="checkbox"/>	<input checked="" type="checkbox"/>	
Additional Comments (if any):				

⁽¹⁾If NO, then contact the client before proceeding with analysis and note date, time and person contacted as well as the corrective action to in the additional comments (above) and the case narrative.

Reviewed by (Project Manager) [Signature]

Date/Time Reviewed 10/18/23

Origins Laboratory, Inc.

[Signature]

The results in this report apply to the samples analyzed in accordance with the chain of custody document. This analytical report must be reproduced in its entirety.

Eagle Environmental Consulting, LLC
8000 W 44th Ave
Wheat Ridge CO 80033

Andrew Newberry
Project Number: [none]
Project: Noble - NCLP PC #AA04-05

WH-FS-01@8'

10/16/2023 1:35:00PM

Analyte	Result	Min Detection Limit	Reporting Limit	Units	Dilution	Batch	Prepared	Analyzed	Notes
---------	--------	---------------------	-----------------	-------	----------	-------	----------	----------	-------

Origins Laboratory, Inc.
Y310441-01 (Soil)

Boron (DTPA Sorbitol)

Boron	0.110	0.100	mg/L	1	B3J1810	10/18/2023	10/19/2023	
-------	-------	-------	------	---	---------	------------	------------	--

DRO/ORO by EPA 8015D

Diesel (C10-C28)	ND	25.0	mg/kg	1	B3J1702	10/17/2023	10/19/2023	Ua
Residual Range Organics (C28-C40)	ND	100	"	"	"	"	"	Ua

Surrogate: o-Terphenyl	73.9 %	50-150	"	"	"	"	"	
------------------------	--------	--------	---	---	---	---	---	--

GBTEX+TMBs by 8260D

1,2,4-Trimethylbenzene	ND	0.00200	mg/kg	1	B3J1707	10/17/2023	10/18/2023	Ua
1,3,5-Trimethylbenzene	ND	0.00200	"	"	"	"	"	Ua
Benzene	ND	0.00200	"	"	"	"	"	Ua
Ethylbenzene	ND	0.00200	"	"	"	"	"	Ua
Naphthalene	ND	0.00380	"	"	"	"	"	Ua
Toluene	ND	0.00200	"	"	"	"	"	Ua
Xylenes, total	ND	0.00200	"	"	"	"	"	Ua
Gasoline Range Hydrocarbons	ND	0.200	"	"	"	"	"	Ua

Origins Laboratory, Inc.



The results in this report apply to the samples analyzed in accordance with the chain of custody document. This analytical report must be reproduced in its entirety.

Eagle Environmental Consulting, LLC
8000 W 44th Ave
Wheat Ridge CO 80033

Andrew Newberry
Project Number: [none]
Project: Noble - NCLP PC #AA04-05

WH-FS-01@8'

10/16/2023 1:35:00PM

Analyte	Result	Min Detection Limit	Reporting Limit	Units	Dilution	Batch	Prepared	Analyzed	Notes
---------	--------	---------------------	-----------------	-------	----------	-------	----------	----------	-------

Origins Laboratory, Inc.
Y310441-01 (Soil)

GBTEX+TMBs by 8260D

Surrogate: 1,2-Dichloroethane-d4	114 %	70-130	B3J1707	10/17/2023	10/18/2023
Surrogate: Toluene-d8	87.5 %	70-130	"	"	"
Surrogate: 4-Bromofluorobenzene	98.8 %	70-130	"	"	"

Metals by Saturated Paste by EPA 6010

Calcium	2.43	0.499	meq/L	10	[CALC]	10/18/2023	10/19/2023
Magnesium	1.14	0.823	"	"	"	"	"
Sodium	2.97	0.435	"	"	"	"	"

PAH by EPA 8270E

1-Methylnaphthalene	ND	0.002	mg/kg	1	B3J1821	10/18/2023	10/26/2023	Ua
2-Methylnaphthalene	ND	0.002	"	"	"	"	"	Ua
Acenaphthene	ND	0.020	"	"	"	"	"	Ua
Anthracene	ND	0.020	"	"	"	"	"	Ua
Benzo (a) anthracene	ND	0.005	"	"	"	"	"	Ua
Benzo (a) pyrene	ND	0.020	"	"	"	"	"	Ua
Benzo (b) fluoranthene	ND	0.020	"	"	"	"	"	Ua
Benzo (k) fluoranthene	ND	0.020	"	"	"	"	"	Ua
Chrysene	ND	0.020	"	"	"	"	"	Ua
Dibenz (a,h) anthracene	ND	0.020	"	"	"	"	"	Ua

Origins Laboratory, Inc.



The results in this report apply to the samples analyzed in accordance with the chain of custody document. This analytical report must be reproduced in its entirety.

Eagle Environmental Consulting, LLC
8000 W 44th Ave
Wheat Ridge CO 80033

Andrew Newberry
Project Number: [none]
Project: Noble - NCLP PC #AA04-05

WH-FS-01@8'

10/16/2023 1:35:00PM

Analyte	Result	Min Detection Limit	Reporting Limit	Units	Dilution	Batch	Prepared	Analyzed	Notes
---------	--------	---------------------	-----------------	-------	----------	-------	----------	----------	-------

Origins Laboratory, Inc.
Y310441-01 (Soil)

PAH by EPA 8270E

Fluoranthene	ND	0.020	mg/kg	1	B3J1821	10/18/2023	10/26/2023	Ua
Fluorene	ND	0.020	"	"	"	"	"	Ua
Indeno (1,2,3-cd) pyrene	ND	0.020	"	"	"	"	"	Ua
Pyrene	ND	0.020	"	"	"	"	"	Ua

Surrogate: Fluorene-d10	95.0 %	60-130	"	"	"	"
Surrogate: Anthracene-d10	95.8 %	60-130	"	"	"	"
Surrogate: Pyrene-d10	132 %	60-130	"	"	"	S-04
Surrogate: Benzo (a) pyrene-d12	99.6 %	60-130	"	"	"	"

pH in Soil by 9045D

pH	8.09	pH Units	1	B3J1813	10/18/2023	10/19/2023
----	------	----------	---	---------	------------	------------

SAR by 20B Saturated Paste

SAR	2.23	0.0100	SAR	1	B3J1806	10/18/2023	10/19/2023
-----	------	--------	-----	---	---------	------------	------------

Specific Conductance Mod. 9050A

Specific Conductance (EC)	0.660	0.00500	mmhos/cm	1	B3J1813	10/18/2023	10/19/2023
---------------------------	-------	---------	----------	---	---------	------------	------------

Table 915 metals by EPA 6020B

Origins Laboratory, Inc.



The results in this report apply to the samples analyzed in accordance with the chain of custody document. This analytical report must be reproduced in its entirety.

Eagle Environmental Consulting, LLC
8000 W 44th Ave
Wheat Ridge CO 80033

Andrew Newberry
Project Number: [none]
Project: Noble - NCLP PC #AA04-05

WH-FS-01@8'

10/16/2023 1:35:00PM

Analyte	Result	Min Detection Limit	Reporting Limit	Units	Dilution	Batch	Prepared	Analyzed	Notes
---------	--------	---------------------	-----------------	-------	----------	-------	----------	----------	-------

Origins Laboratory, Inc.
Y310441-01 (Soil)

Table 915 metals by EPA 6020B

Arsenic	1.64	0.0960	mg/kg	10	B3J1720	10/17/2023	10/20/2023
Barium	38.9	9.60	"	"	"	"	"
Cadmium	ND	0.0960	"	"	"	"	"
Copper	29.5	9.60	"	"	"	"	"
Lead	ND	9.60	"	"	"	"	"
Nickel	ND	9.60	"	"	"	"	"
Selenium	ND	0.0960	"	"	"	"	"
Silver	ND	0.0960	"	"	"	"	"
Zinc	ND	96.0	"	"	"	"	"

Total Metals by 7196A

Hexavalent Chromium	ND	0.124	0.310	mg/kg dry	1	2510704	10/19/2023	10/19/2023	U
---------------------	----	-------	-------	-----------	---	---------	------------	------------	---

Origins Laboratory, Inc.



The results in this report apply to the samples analyzed in accordance with the chain of custody document. This analytical report must be reproduced in its entirety.

Eagle Environmental Consulting, LLC
8000 W 44th Ave
Wheat Ridge CO 80033

Andrew Newberry
Project Number: [none]
Project: Noble - NCLP PC #AA04-05

Extractable Petroleum Hydrocarbons by 8015D - Quality Control
Origins Laboratory, Inc.

Analyte	Result	Reporting Limit	Units	Spike Level	Source Result	%REC	%REC Limits	RPD	RPD Limit	Notes
Batch B3J1702 - EPA 3550B										
Blank (B3J1702-BLK1)					Prepared: 10/17/2023 Analyzed: 10/18/2023					
Diesel (C10-C28)	ND	25.0	mg/kg							Ua
Residual Range Organics (C28-C40)	ND	100	"							Ua
Surrogate: o-Terphenyl	28		"	24.9		112	50-150			

Origins Laboratory, Inc.



The results in this report apply to the samples analyzed in accordance with the chain of custody document. This analytical report must be reproduced in its entirety.

Eagle Environmental Consulting, LLC
8000 W 44th Ave
Wheat Ridge CO 80033

Andrew Newberry
Project Number: [none]
Project: Noble - NCLP PC #AA04-05

Extractable Petroleum Hydrocarbons by 8015D - Quality Control
Origins Laboratory, Inc.

Analyte	Result	Reporting Limit	Units	Spike Level	Source Result	%REC	%REC Limits	RPD	RPD Limit	Notes
Batch B3J1702 - EPA 3550B										
LCS (B3J1702-BS1)					Prepared: 10/17/2023 Analyzed: 10/18/2023					
Diesel (C10-C28)	881	50.0	mg/kg	1000		88.1	70-130			
Residual Range Organics (C28-C40)	952	200	"	1000		95.2	70-130			
Surrogate: o-Terphenyl	40		"	49.8		80.0	50-150			

Origins Laboratory, Inc.



The results in this report apply to the samples analyzed in accordance with the chain of custody document. This analytical report must be reproduced in its entirety.

Eagle Environmental Consulting, LLC
8000 W 44th Ave
Wheat Ridge CO 80033

Andrew Newberry
Project Number: [none]
Project: Noble - NCLP PC #AA04-05

Extractable Petroleum Hydrocarbons by 8015D - Quality Control Origins Laboratory, Inc.

Analyte	Result	Reporting Limit	Units	Spike Level	Source Result	%REC	%REC Limits	RPD	RPD Limit	Notes
Batch B3J1702 - EPA 3550B										
Matrix Spike (B3J1702-MS1)		Source: Y310434-01			Prepared: 10/17/2023 Analyzed: 10/18/2023					
Diesel (C10-C28)	30800	50.0	mg/kg	1000	37900	NR	70-130			QM-07
Residual Range Organics (C28-C40)	42500	200	"	1000	38100	437	70-130			QM-07
Surrogate: o-Terphenyl	160		"	49.8		331	50-150			S-04

Origins Laboratory, Inc.



The results in this report apply to the samples analyzed in accordance with the chain of custody document. This analytical report must be reproduced in its entirety.

Eagle Environmental Consulting, LLC
8000 W 44th Ave
Wheat Ridge CO 80033

Andrew Newberry
Project Number: [none]
Project: Noble - NCLP PC #AA04-05

Extractable Petroleum Hydrocarbons by 8015D - Quality Control

Origins Laboratory, Inc.

Analyte	Result	Reporting Limit	Units	Spike Level	Source Result	%REC	%REC Limits	RPD	RPD Limit	Notes
---------	--------	-----------------	-------	-------------	---------------	------	-------------	-----	-----------	-------

Batch B3J1702 - EPA 3550B

Matrix Spike Dup (B3J1702-MSD1)		Source: Y310434-01			Prepared: 10/17/2023 Analyzed: 10/18/2023					
Diesel (C10-C28)	28600	50.0	mg/kg	1000	37900	NR	70-130	7.49	35	QM-07
Residual Range Organics (C28-C40)	37500	200	"	1000	38100	NR	70-130	12.5	35	QM-07
Surrogate: o-Terphenyl	410		"	49.8		824	50-150			S-04

Origins Laboratory, Inc.



The results in this report apply to the samples analyzed in accordance with the chain of custody document. This analytical report must be reproduced in its entirety.

Eagle Environmental Consulting, LLC
8000 W 44th Ave
Wheat Ridge CO 80033

Andrew Newberry
Project Number: [none]
Project: Noble - NCLP PC #AA04-05

Extractable Petroleum Hydrocarbons by 8015D - Quality Control

Origins Laboratory, Inc.

Analyte	Result	Reporting Limit	Units	Spike Level	Source Result	%REC	%REC Limits	RPD	RPD Limit	Notes
Batch B3J1707 - EPA 5030 (soil)										
Blank (B3J1707-BLK1)					Prepared: 10/17/2023 Analyzed: 10/17/2023					
1,2,4-Trimethylbenzene	ND	0.00200	mg/kg							Ua
1,3,5-Trimethylbenzene	ND	0.00200	"							Ua
Benzene	ND	0.00200	"							Ua
Ethylbenzene	ND	0.00200	"							Ua
Naphthalene	ND	0.00380	"							Ua
Toluene	ND	0.00200	"							Ua
Xylenes, total	ND	0.00200	"							Ua
Gasoline Range Hydrocarbons	ND	0.200	"							Ua
Surrogate: 1,2-Dichloroethane-d4	0.14		"	0.125	115		70-130			
Surrogate: Toluene-d8	0.12		"	0.125	97.3		70-130			
Surrogate: 4-Bromofluorobenzene	0.12		"	0.125	94.0		70-130			

Origins Laboratory, Inc.



The results in this report apply to the samples analyzed in accordance with the chain of custody document. This analytical report must be reproduced in its entirety.

Eagle Environmental Consulting, LLC
8000 W 44th Ave
Wheat Ridge CO 80033

Andrew Newberry
Project Number: [none]
Project: Noble - NCLP PC #AA04-05

Volatile Organic Compounds by GC/MS SW846 8260D - Quality Control
Origins Laboratory, Inc.

Analyte	Result	Reporting Limit	Units	Spike Level	Source Result	%REC	%REC Limits	RPD	RPD Limit	Notes
Batch B3J1707 - EPA 5030 (soil)										
LCS (B3J1707-BS1)					Prepared: 10/17/2023 Analyzed: 10/17/2023					
1,2,4-Trimethylbenzene	0.0892	0.00200	mg/kg	0.100		89.2	70-130			
1,3,5-Trimethylbenzene	0.0891	0.00200	"	0.100		89.1	70-130			
Benzene	0.0833	0.00200	"	0.100		83.3	70-130			
Ethylbenzene	0.0848	0.00200	"	0.100		84.8	70-130			
Naphthalene	0.0845	0.00380	"	0.100		84.5	70-130			
Toluene	0.0864	0.00200	"	0.100		86.4	70-130			
o-Xylene	0.0909	0.00200	"	0.100		90.9	70-130			
m,p-Xylene	0.178	0.00400	"	0.200		88.8	70-130			
Surrogate: 1,2-Dichloroethane-d4	0.14		"	0.125		115	70-130			
Surrogate: Toluene-d8	0.12		"	0.125		99.0	70-130			
Surrogate: 4-Bromofluorobenzene	0.12		"	0.125		94.4	70-130			

Origins Laboratory, Inc.



The results in this report apply to the samples analyzed in accordance with the chain of custody document. This analytical report must be reproduced in its entirety.

Eagle Environmental Consulting, LLC
8000 W 44th Ave
Wheat Ridge CO 80033

Andrew Newberry
Project Number: [none]
Project: Noble - NCLP PC #AA04-05

Volatile Organic Compounds by GC/MS SW846 8260D - Quality Control
Origins Laboratory, Inc.

Analyte	Result	Reporting Limit	Units	Spike Level	Source Result	%REC	%REC Limits	RPD	RPD Limit	Notes
Batch B3J1707 - EPA 5030 (soil)										
Matrix Spike (B3J1707-MS1)		Source: Y310415-21			Prepared: 10/17/2023 Analyzed: 10/18/2023					
1,2,4-Trimethylbenzene	0.0790	0.00200	mg/kg	0.100	ND	79.0	70-130			
1,3,5-Trimethylbenzene	0.0767	0.00200	"	0.100	ND	76.7	70-130			
Benzene	0.0985	0.00200	"	0.100	ND	98.5	70-130			
Ethylbenzene	0.0877	0.00200	"	0.100	ND	87.7	70-130			
Naphthalene	0.0906	0.00380	"	0.100	ND	90.6	70-130			
Toluene	0.0910	0.00200	"	0.100	ND	91.0	70-130			
o-Xylene	0.0873	0.00200	"	0.100	ND	87.3	70-130			
m,p-Xylene	0.180	0.00400	"	0.200	ND	89.9	70-130			
Surrogate: 1,2-Dichloroethane-d4	0.13		"	0.125		105	70-130			
Surrogate: Toluene-d8	0.12		"	0.125		94.6	70-130			
Surrogate: 4-Bromofluorobenzene	0.13		"	0.125		103	70-130			

Origins Laboratory, Inc.



The results in this report apply to the samples analyzed in accordance with the chain of custody document. This analytical report must be reproduced in its entirety.

Eagle Environmental Consulting, LLC
8000 W 44th Ave
Wheat Ridge CO 80033

Andrew Newberry
Project Number: [none]
Project: Noble - NCLP PC #AA04-05

Volatile Organic Compounds by GC/MS SW846 8260D - Quality Control

Origins Laboratory, Inc.

Analyte	Result	Reporting Limit	Units	Spike Level	Source Result	%REC	%REC Limits	RPD	RPD Limit	Notes
Batch B3J1707 - EPA 5030 (soil)										
Matrix Spike Dup (B3J1707-MSD1)		Source: Y310415-21			Prepared: 10/17/2023 Analyzed: 10/18/2023					
1,2,4-Trimethylbenzene	0.0851	0.00200	mg/kg	0.100	ND	85.1	70-130	7.46	20	
1,3,5-Trimethylbenzene	0.0823	0.00200	"	0.100	ND	82.3	70-130	7.09	20	
Benzene	0.109	0.00200	"	0.100	ND	109	70-130	10.0	20	
Ethylbenzene	0.0963	0.00200	"	0.100	ND	96.3	70-130	9.32	20	
Naphthalene	0.102	0.00380	"	0.100	ND	102	70-130	11.4	20	
Toluene	0.0983	0.00200	"	0.100	ND	98.3	70-130	7.80	20	
o-Xylene	0.0962	0.00200	"	0.100	ND	96.2	70-130	9.61	20	
m,p-Xylene	0.197	0.00400	"	0.200	ND	98.7	70-130	9.25	20	
Surrogate: 1,2-Dichloroethane-d4	0.13		"	0.125		106	70-130			
Surrogate: Toluene-d8	0.12		"	0.125		93.3	70-130			
Surrogate: 4-Bromofluorobenzene	0.13		"	0.125		105	70-130			

Origins Laboratory, Inc.



The results in this report apply to the samples analyzed in accordance with the chain of custody document. This analytical report must be reproduced in its entirety.

Eagle Environmental Consulting, LLC
8000 W 44th Ave
Wheat Ridge CO 80033

Andrew Newberry
Project Number: [none]
Project: Noble - NCLP PC #AA04-05

Volatile Organic Compounds by GC/MS SW846 8260D - Quality Control

Origins Laboratory, Inc.

Analyte	Result	Reporting Limit	Units	Spike Level	Source Result	%REC	%REC Limits	RPD	RPD Limit	Notes
---------	--------	-----------------	-------	-------------	---------------	------	-------------	-----	-----------	-------

Metals by EPA 6000/7000 Series Methods - Quality Control

Origins Laboratory, Inc.

Analyte	Result	Reporting Limit	Units	Spike Level	Source Result	%REC	%REC Limits	RPD	RPD Limit	Notes
---------	--------	-----------------	-------	-------------	---------------	------	-------------	-----	-----------	-------

Batch B3J1720 - EPA 3050B

Blank (B3J1720-BLK1)

Prepared: 10/17/2023 Analyzed: 10/20/2023

Arsenic	ND	0.000100	mg/kg
Barium	ND	0.0100	"
Cadmium	ND	0.000100	"
Copper	ND	0.0100	"
Lead	ND	0.0100	"
Nickel	ND	0.0100	"
Selenium	ND	0.000100	"
Silver	ND	0.000100	"
Zinc	ND	0.100	"

LCS (B3J1720-BS1)

Prepared: 10/17/2023 Analyzed: 10/20/2023

Arsenic	0.0497	0.000100	mg/kg	0.0500	99.4	80-120
Barium	4.98	0.0100	"	5.00	99.5	80-120
Cadmium	0.0509	0.000100	"	0.0500	102	80-120
Copper	0.542	0.0100	"	0.500	108	80-120
Lead	0.0504	0.0100	"	0.0500	101	80-120
Nickel	0.0491	0.0100	"	0.0500	98.2	80-120
Selenium	0.0478	0.000100	"	0.0500	95.7	80-120
Silver	0.0479	0.000100	"	0.0500	95.8	80-120
Zinc	0.506	0.100	"	0.500	101	80-120

Matrix Spike (B3J1720-MS1)

Source: Y310404-03

Prepared: 10/17/2023 Analyzed: 10/20/2023

Origins Laboratory, Inc.



The results in this report apply to the samples analyzed in accordance with the chain of custody document. This analytical report must be reproduced in its entirety.

Eagle Environmental Consulting, LLC
8000 W 44th Ave
Wheat Ridge CO 80033

Andrew Newberry
Project Number: [none]
Project: Noble - NCLP PC #AA04-05

Metals by EPA 6000/7000 Series Methods - Quality Control

Origins Laboratory, Inc.

Analyte	Result	Reporting Limit	Units	Spike Level	Source Result	%REC	%REC Limits	RPD	RPD Limit	Notes
---------	--------	-----------------	-------	-------------	---------------	------	-------------	-----	-----------	-------

Batch B3J1720 - EPA 3050B

Matrix Spike (B3J1720-MS1)		Source: Y310404-03			Prepared: 10/17/2023 Analyzed: 10/20/2023					
Arsenic	6.53	0.0946	mg/kg	4.73	1.71	102	75-125			
Barium	546	9.46	"	473	58.5	103	75-125			
Cadmium	5.05	0.0946	"	4.73	0.0499	106	75-125			
Copper	55.5	9.46	"	47.3	3.95	109	75-125			
Lead	9.83	9.46	"	4.73	5.29	96.1	75-125			
Nickel	9.76	9.46	"	4.73	5.09	98.8	75-125			
Selenium	4.49	0.0946	"	4.73	0.0634	93.5	75-125			
Silver	4.64	0.0946	"	4.73	0.0317	97.4	75-125			
Zinc	71.3	94.6	"	47.3	21.0	106	75-125			
Matrix Spike Dup (B3J1720-MSD1)		Source: Y310404-03			Prepared: 10/17/2023 Analyzed: 10/20/2023					
Arsenic	6.41	0.0930	mg/kg	4.65	1.71	101	75-125	1.86	20	
Barium	524	9.30	"	465	58.5	100	75-125	4.09	20	
Cadmium	4.81	0.0930	"	4.65	0.0499	102	75-125	4.75	20	
Copper	53.2	9.30	"	46.5	3.95	106	75-125	4.32	20	
Lead	10.0	9.30	"	4.65	5.29	102	75-125	1.96	20	
Nickel	10.1	9.30	"	4.65	5.09	107	75-125	3.19	20	
Selenium	4.40	0.0930	"	4.65	0.0634	93.4	75-125	1.87	20	
Silver	4.43	0.0930	"	4.65	0.0317	94.7	75-125	4.52	20	
Zinc	69.6	93.0	"	46.5	21.0	105	75-125	2.35	20	

Origins Laboratory, Inc.



The results in this report apply to the samples analyzed in accordance with the chain of custody document. This analytical report must be reproduced in its entirety.

Eagle Environmental Consulting, LLC
8000 W 44th Ave
Wheat Ridge CO 80033

Andrew Newberry
Project Number: [none]
Project: Noble - NCLP PC #AA04-05

EPA 8270E (SW846) - Semivolatile Organic Compounds - Quality Control
Origins Laboratory, Inc.

Analyte	Result	Reporting Limit	Units	Spike Level	Source Result	%REC	%REC Limits	RPD	RPD Limit	Notes
---------	--------	-----------------	-------	-------------	---------------	------	-------------	-----	-----------	-------

Batch B3J1821 - EPA 3580

Blank (B3J1821-BLK1)

Prepared: 10/18/2023 Analyzed: 10/26/2023

1-Methylnaphthalene	ND	0.002	mg/kg							Ua
2-Methylnaphthalene	ND	0.002	"							Ua
Acenaphthene	ND	0.020	"							Ua
Anthracene	ND	0.020	"							Ua
Benzo (a) anthracene	ND	0.005	"							Ua
Benzo (a) pyrene	ND	0.020	"							Ua
Benzo (b) fluoranthene	ND	0.020	"							Ua
Benzo (g,h,i) perylene	ND	0.020	"							Ua
Benzo (k) fluoranthene	ND	0.020	"							Ua
Chrysene	ND	0.020	"							Ua
Dibenz (a,h) anthracene	ND	0.020	"							Ua
Fluoranthene	ND	0.020	"							Ua
Fluorene	ND	0.020	"							Ua
Indeno (1,2,3-cd) pyrene	ND	0.020	"							Ua
Naphthalene	ND	0.002	"							Ua
Phenanthrene	ND	0.020	"							Ua
Pyrene	ND	0.020	"							Ua

Surrogate: Fluorene-d10	190		ug/kg	200		97.0	60-130
Surrogate: Anthracene-d10	200		"	200		99.8	60-130
Surrogate: Pyrene-d10	260		"	200		129	60-130
Surrogate: Benzo (a) pyrene-d12	190		"	200		96.1	60-130

LCS (B3J1821-BS1)

Prepared: 10/18/2023 Analyzed: 10/26/2023

1-Methylnaphthalene	0.193	0.002	mg/kg	0.200		96.6	70-130
2-Methylnaphthalene	0.191	0.002	"	0.200		95.5	70-130
Acenaphthene	0.195	0.020	"	0.200		97.6	70-130
Anthracene	0.172	0.020	"	0.200		86.1	70-130

Origins Laboratory, Inc.



The results in this report apply to the samples analyzed in accordance with the chain of custody document. This analytical report must be reproduced in its entirety.

Eagle Environmental Consulting, LLC
8000 W 44th Ave
Wheat Ridge CO 80033

Andrew Newberry
Project Number: [none]
Project: Noble - NCLP PC #AA04-05

EPA 8270E (SW846) - Semivolatile Organic Compounds - Quality Control
Origins Laboratory, Inc.

Analyte	Result	Reporting Limit	Units	Spike Level	Source Result	%REC	%REC Limits	RPD	RPD Limit	Notes
---------	--------	-----------------	-------	-------------	---------------	------	-------------	-----	-----------	-------

Batch B3J1821 - EPA 3580

LCS (B3J1821-BS1)

Prepared: 10/18/2023 Analyzed: 10/26/2023

Benzo (a) anthracene	0.168	0.005	mg/kg	0.200		83.8	70-130
Benzo (a) pyrene	0.204	0.020	"	0.200		102	70-130
Benzo (b) fluoranthene	0.203	0.020	"	0.200		102	70-130
Benzo (g,h,i) perylene	0.197	0.020	"	0.200		98.3	70-130
Benzo (k) fluoranthene	0.168	0.020	"	0.200		84.1	70-130
Chrysene	0.183	0.020	"	0.200		91.4	70-130
Dibenz (a,h) anthracene	0.190	0.020	"	0.200		95.0	70-130
Fluoranthene	0.178	0.020	"	0.200		88.9	70-130
Fluorene	0.195	0.020	"	0.200		97.3	70-130
Indeno (1,2,3-cd) pyrene	0.203	0.020	"	0.200		102	70-130
Naphthalene	0.198	0.002	"	0.200		98.9	70-130
Phenanthrene	0.194	0.020	"	0.200		96.8	70-130
Pyrene	0.228	0.020	"	0.200		114	70-130
Surrogate: Fluorene-d10	200		ug/kg	200		99.3	60-130
Surrogate: Anthracene-d10	200		"	200		99.0	60-130
Surrogate: Pyrene-d10	250		"	200		123	60-130
Surrogate: Benzo (a) pyrene-d12	200		"	200		100	60-130

Matrix Spike (B3J1821-MS1)

Source: Y310437-01

Prepared: 10/18/2023 Analyzed: 10/26/2023

1-Methylnaphthalene	0.186	0.002	mg/kg	0.200	ND	93.0	70-130
2-Methylnaphthalene	0.181	0.002	"	0.200	ND	90.4	70-130
Acenaphthene	0.190	0.020	"	0.200	ND	95.0	70-130
Anthracene	0.161	0.020	"	0.200	0.001	79.9	70-130
Benzo (a) anthracene	0.189	0.005	"	0.200	ND	94.3	70-130
Benzo (a) pyrene	0.193	0.020	"	0.200	ND	96.5	70-130
Benzo (b) fluoranthene	0.181	0.020	"	0.200	ND	90.7	70-130
Benzo (g,h,i) perylene	0.195	0.020	"	0.200	ND	97.3	70-130

Origins Laboratory, Inc.



The results in this report apply to the samples analyzed in accordance with the chain of custody document. This analytical report must be reproduced in its entirety.

Eagle Environmental Consulting, LLC
8000 W 44th Ave
Wheat Ridge CO 80033

Andrew Newberry
Project Number: [none]
Project: Noble - NCLP PC #AA04-05

EPA 8270E (SW846) - Semivolatile Organic Compounds - Quality Control
Origins Laboratory, Inc.

Analyte	Result	Reporting Limit	Units	Spike Level	Source Result	%REC	%REC Limits	RPD	RPD Limit	Notes
---------	--------	-----------------	-------	-------------	---------------	------	-------------	-----	-----------	-------

Batch B3J1821 - EPA 3580

Matrix Spike (B3J1821-MS1)		Source: Y310437-01			Prepared: 10/18/2023 Analyzed: 10/26/2023					
Benzo (k) fluoranthene	0.170	0.020	mg/kg	0.200	ND	84.9	70-130			
Chrysene	0.183	0.020	"	0.200	ND	91.5	70-130			
Dibenz (a,h) anthracene	0.195	0.020	"	0.200	ND	97.7	70-130			
Fluoranthene	0.187	0.020	"	0.200	ND	93.5	70-130			
Fluorene	0.191	0.020	"	0.200	ND	95.4	70-130			
Indeno (1,2,3-cd) pyrene	0.178	0.020	"	0.200	ND	89.1	70-130			
Naphthalene	0.189	0.002	"	0.200	ND	94.6	70-130			
Phenanthrene	0.181	0.020	"	0.200	ND	90.6	70-130			
Pyrene	0.198	0.020	"	0.200	ND	99.1	70-130			
Surrogate: Fluorene-d10	200		ug/kg	200		101	60-130			
Surrogate: Anthracene-d10	200		"	200		98.9	60-130			
Surrogate: Pyrene-d10	210		"	200		106	60-130			
Surrogate: Benzo (a) pyrene-d12	200		"	200		101	60-130			

Matrix Spike Dup (B3J1821-MSD1)		Source: Y310437-01			Prepared: 10/18/2023 Analyzed: 10/26/2023					
1-Methylnaphthalene	0.190	0.002	mg/kg	0.200	ND	95.2	70-130	2.36	20	
2-Methylnaphthalene	0.191	0.002	"	0.200	ND	95.3	70-130	5.31	20	
Acenaphthene	0.196	0.020	"	0.200	ND	97.9	70-130	2.95	20	
Anthracene	0.172	0.020	"	0.200	0.001	85.3	70-130	6.57	20	
Benzo (a) anthracene	0.171	0.005	"	0.200	ND	85.3	70-130	10.0	20	
Benzo (a) pyrene	0.210	0.020	"	0.200	ND	105	70-130	8.27	20	
Benzo (b) fluoranthene	0.205	0.020	"	0.200	ND	103	70-130	12.2	20	
Benzo (g,h,i) perylene	0.199	0.020	"	0.200	ND	99.4	70-130	2.11	20	
Benzo (k) fluoranthene	0.174	0.020	"	0.200	ND	86.9	70-130	2.29	20	
Chrysene	0.185	0.020	"	0.200	ND	92.4	70-130	0.973	20	
Dibenz (a,h) anthracene	0.193	0.020	"	0.200	ND	96.6	70-130	1.12	20	
Fluoranthene	0.177	0.020	"	0.200	ND	88.3	70-130	5.73	20	

Origins Laboratory, Inc.



The results in this report apply to the samples analyzed in accordance with the chain of custody document. This analytical report must be reproduced in its entirety.

Eagle Environmental Consulting, LLC
8000 W 44th Ave
Wheat Ridge CO 80033

Andrew Newberry
Project Number: [none]
Project: Noble - NCLP PC #AA04-05

EPA 8270E (SW846) - Semivolatile Organic Compounds - Quality Control
Origins Laboratory, Inc.

Analyte	Result	Reporting Limit	Units	Spike Level	Source Result	%REC	%REC Limits	RPD	RPD Limit	Notes
Batch B3J1821 - EPA 3580										
Matrix Spike Dup (B3J1821-MSD1)			Source: Y310437-01		Prepared: 10/18/2023 Analyzed: 10/26/2023					
Fluorene	0.192	0.020	mg/kg	0.200	ND	95.9	70-130	0.532	20	
Indeno (1,2,3-cd) pyrene	0.175	0.020	"	0.200	ND	87.7	70-130	1.62	20	
Naphthalene	0.197	0.002	"	0.200	ND	98.6	70-130	4.07	20	
Phenanthrene	0.192	0.020	"	0.200	ND	96.1	70-130	5.80	20	
Pyrene	0.231	0.020	"	0.200	ND	115	70-130	15.2	20	
Surrogate: Fluorene-d10	200		ug/kg	200		99.3	60-130			
Surrogate: Anthracene-d10	200		"	200		97.7	60-130			
Surrogate: Pyrene-d10	250		"	200		125	60-130			
Surrogate: Benzo (a) pyrene-d12	200		"	200		99.9	60-130			

Origins Laboratory, Inc.



The results in this report apply to the samples analyzed in accordance with the chain of custody document. This analytical report must be reproduced in its entirety.

Eagle Environmental Consulting, LLC
8000 W 44th Ave
Wheat Ridge CO 80033

Andrew Newberry
Project Number: [none]
Project: Noble - NCLP PC #AA04-05

Classical Chemistry Parameters - Quality Control Origins Laboratory, Inc.

Analyte	Result	Reporting Limit	Units	Spike Level	Source Result	%REC	%REC Limits	RPD	RPD Limit	Notes
---------	--------	-----------------	-------	-------------	---------------	------	-------------	-----	-----------	-------

Batch B3J1806 - Saturated Paste Metals

Blank (B3J1806-BLK1)

Prepared: 10/18/2023 Analyzed: 10/19/2023

Calcium PPM	ND	10.0	mg/L
SAR	ND	0.0100	SAR
Magnesium PPM	ND	10.0	mg/L
Sodium PPM	ND	10.0	"

Duplicate (B3J1806-DUP1)

Source: Y310437-01

Prepared: 10/18/2023 Analyzed: 10/19/2023

SAR	ND	0.0100	SAR	2.04			200
Calcium PPM	27.4	10.0	mg/L	29.2		6.64	50
Magnesium PPM	4.54	10.0	"	4.75		4.52	50
Sodium PPM	44.6	10.0	"	45.0		1.00	50

Batch B3J1810 - DTPA Sorbitol Preparation

Blank (B3J1810-BLK1)

Prepared: 10/18/2023 Analyzed: 10/19/2023

Boron	ND	0.100	mg/L
-------	----	-------	------

Duplicate (B3J1810-DUP1)

Source: Y310437-01

Prepared: 10/18/2023 Analyzed: 10/19/2023

Boron	0.677	0.100	mg/L	0.687		1.38	50
-------	-------	-------	------	-------	--	------	----

Origins Laboratory, Inc.



The results in this report apply to the samples analyzed in accordance with the chain of custody document. This analytical report must be reproduced in its entirety.

Eagle Environmental Consulting, LLC
8000 W 44th Ave
Wheat Ridge CO 80033

Andrew Newberry
Project Number: [none]
Project: Noble - NCLP PC #AA04-05

Saturated Paste - Quality Control Origins Laboratory, Inc.

Analyte	Result	Reporting Limit	Units	Spike Level	Source Result	%REC	%REC Limits	RPD	RPD Limit	Notes
Batch B3J1813 - Saturated Paste pH/EC										
Blank (B3J1813-BLK1)					Prepared: 10/18/2023 Analyzed: 10/19/2023					
Specific Conductance (EC)	ND	0.00500	mmhos/cm							
Duplicate (B3J1813-DUP1)					Source: Y310437-01 Prepared: 10/18/2023 Analyzed: 10/19/2023					
pH	8.19		pH Units		8.21			0.244	25	
Specific Conductance (EC)	0.366	0.00500	mmhos/cm		0.378			3.23	25	

Origins Laboratory, Inc.



The results in this report apply to the samples analyzed in accordance with the chain of custody document. This analytical report must be reproduced in its entirety.

Eagle Environmental Consulting, LLC
8000 W 44th Ave
Wheat Ridge CO 80033

Andrew Newberry
Project Number: [none]
Project: Noble - NCLP PC #AA04-05

Total Metals by 7196A - Quality Control GEL Laboratories, LLC

Analyte	Result	Reporting Limit	Units	Spike Level	Source Result	%REC	%REC Limits	RPD	RPD Limit	Notes
Batch 2510704 - SW846 3060A										
BLANK (1205550314-BLK)					Prepared: 10/19/2023 Analyzed: 10/19/2023					
Hexavalent Chromium	ND	0.329	mg/kg				-			U
LCS (1205550315-BKS)					Prepared: 10/19/2023 Analyzed: 10/19/2023					
Hexavalent Chromium	3.18	0.324	mg/kg	3.24		98.4	80-120			
DUP (1205550318 D)					Prepared: 10/19/2023 Analyzed: 10/19/2023					
Source: 641711001										
Hexavalent Chromium	ND	0.310	mg/kg dry		<0.124		0-50	N/A	50	U
MS (1205550319 S)					Prepared: 10/19/2023 Analyzed: 10/19/2023					
Source: 641711001										
Hexavalent Chromium	2.31	0.310	mg/kg dry	3.10	<0.124	73.4	75-125			
ILCS (1205550320-ILCS)					Prepared: 10/19/2023 Analyzed: 10/19/2023					
Hexavalent Chromium	5.96	0.302	mg/kg	6.17		96.6	80-120			

Origins Laboratory, Inc.



The results in this report apply to the samples analyzed in accordance with the chain of custody document. This analytical report must be reproduced in its entirety.

Eagle Environmental Consulting, LLC
8000 W 44th Ave
Wheat Ridge CO 80033

Andrew Newberry
Project Number: [none]
Project: Noble - NCLP PC #AA04-05

Notes and Definitions

Ua Sample is Non-Detect.

U Result not detected above the detection limit

S-04 The surrogate recovery for this sample is outside of established control limits due to a sample matrix effect.

QM-07 The spike recovery was outside acceptance limits for the MS and/or MSD. The batch was accepted based on acceptable LCS recovery.

ND Analyte NOT DETECTED at or above the reporting limit

RPD Relative Percent Difference

All soil results are reported on a wet weight basis.

Calculated results may use J-flag data (instead of reported "ND") as part of calculation to provide a more accurate result.

Origins Laboratory, Inc.



The results in this report apply to the samples analyzed in accordance with the chain of custody document. This analytical report must be reproduced in its entirety.

Jordan A. Bynon, Project Manager



November 21, 2023

Eagle Environmental Consulting, LLC

Andrew Newberry

8000 W 44th Ave

Wheat Ridge CO 80033

Project Name - Noble - NCLP PC #AA04-05

Project Number - [none]

Attached are your analytical results for Noble - NCLP PC #AA04-05 received by Origins Laboratory, Inc. November 02, 2023. This project is associated with Origins project number Y311075-01.

The analytical results in the following report were analyzed under the guidelines of EPA Methods. These methods are identified as follows; "SW" are defined in SW-846, "EPA" are defined in 40CFR part 136 and "SM" are defined in the most current revision of Standard Methods For the Examination of Water and Wastewater.

The analytical results apply specifically to the samples and analyses specified per the attached Chain of Custody. As such, this report shall not be reproduced except in full, without the written approval of Origin's laboratory.

Unless otherwise noted, the analytical results for all soil samples are reported on a wet weight basis. All analytical analyses were performed under NELAP guidelines unless noted by a data qualifier.

Any holding time exceedances, deviations from the method specifications or deviations from Origins Laboratory's Standard Operating Procedures are outlined in the case narrative.

Thank you for selecting Origins for your analytical needs. Please contact us with any questions concerning this report, or if we can help with anything at all.

Origins Laboratory, Inc.
303.433.1322
o-squad@oelabinc.com



1725 Elk Place, Denver, CO 80211 | Phone: 303.433.1322 | Fax: 303.265.9645

Eagle Environmental Consulting, LLC

8000 W 44th Ave

Wheat Ridge CO 80033

Andrew Newberry

Project Number: [none]

Project: Noble - NCLP PC #AA04-05

CROSS REFERENCE REPORT

Sample ID	Laboratory ID	Matrix	Date Sampled	Date Received
Background-01@2'	Y311075-01	Soil	October 16, 2023 13:37	11/02/2023 15:45

Origins Laboratory, Inc.



The results in this report apply to the samples analyzed in accordance with the chain of custody document. This analytical report must be reproduced in its entirety.

Eagle Environmental Consulting, LLC
8000 W 44th Ave
Wheat Ridge CO 80033

Andrew Newberry
Project Number: [none]
Project: Noble - NCLP PC #AA04-05

www.originslaboratory.com

311075

ORIGINS LABORATORY, INC

Client: Eagle Environmental Consulting

Project Manager: Andrew Newberry

Address: 8000 W 44th Ave

Project Name: NCLP PC #AA04-05

Telephone Number: 303-433-0479

Project Number: —

Email Address: andrew.newberry@eagleenv.com

Samples Collected By: SL

1725 Elk Place | Denver, CO 80211 | Phone: 303.433.1322 | Fax: 303.265.9645

Sample ID Description	Date Sampled	Time Sampled	# of Containers	Preservative				Matrix			Analysis	Sample Instructions	
				Unpreserved	HCl	HNO ₃	Other	Groundwater	Soil	Air Summa Canister #			
Battery acid - 0103	10/16/23	1537	1	X					X			+ Arsenic - 60208	NCLP Model 1
													2
													3
													4
													5
													6
													7
													8
													9
													10

Relinquished by: Blake Ulrich Date: 11-2-23 Time: 1545

Relinquished by: — Date: — Time: —

Received By: — Date: 11/2/23 Time: 1545

Received By: — Date: — Time: —

Turnaround Time: Same Day ☐ 24 Hr ☐ 48 Hr ☐ 72 Hr ☒ Standard

Temp Received: 3.5 Date Results Needed: Noble

* Bill to Job

Origins Laboratory, Inc.

J. Bynon

The results in this report apply to the samples analyzed in accordance with the chain of custody document. This analytical report must be reproduced in its entirety.

Eagle Environmental Consulting, LLC
8000 W 44th Ave
Wheat Ridge CO 80033

Andrew Newberry
Project Number: [none]
Project: Noble - NCLP PC #AA04-05

Origins Laboratory

F-012207-01-R1
Effective Date: 01/09/12

Sample Receipt Checklist

Origins Work Order: 4311075

Client: Eagle

Client Project ID: NCLP PC #AA04-05

Checklist Completed by: EHS

Shipped Via: F10
(UPS, FedEx, Hand Delivered, Pick-up, etc.)

Date/time completed: 11/2/23

Airbill #: N/A

Matrix(s) Received: (Check all that apply): ☒ Soil/Solid ☐ Water ☐ Other: _____

Cooler Number/Temperature: 1135 °C 1 °C 1 °C (Describe) _____ °C

Thermometer ID: 7004

Requirement Description	Yes	No	N/A	Comments (if any)
If samples require cooling, was the temperature between 0°C to ≤ 6°C ⁽¹⁾ ?	<input checked="" type="checkbox"/>	<input type="checkbox"/>	<input type="checkbox"/>	
Is there ice present (document if blue ice is used)	<input checked="" type="checkbox"/>	<input type="checkbox"/>	<input type="checkbox"/>	
Are custody seals present on cooler? (if so, document in comments if they are signed and dated, broken or intact)	<input checked="" type="checkbox"/>	<input type="checkbox"/>	<input type="checkbox"/>	
Are custody seals present on each sample container? (if so, document in comments if they are signed and dated, broken or intact)	<input checked="" type="checkbox"/>	<input type="checkbox"/>	<input type="checkbox"/>	
Were all samples received intact ⁽¹⁾ ?	<input checked="" type="checkbox"/>	<input type="checkbox"/>	<input type="checkbox"/>	
Was adequate sample volume provided ⁽¹⁾ ?	<input checked="" type="checkbox"/>	<input type="checkbox"/>	<input type="checkbox"/>	
Are short holding time analytes or samples with HTs due within 48 hours present ⁽¹⁾ ?	<input checked="" type="checkbox"/>	<input type="checkbox"/>	<input type="checkbox"/>	
Is a chain-of-custody (COC) present and filled out completely ⁽¹⁾ ?	<input checked="" type="checkbox"/>	<input type="checkbox"/>	<input type="checkbox"/>	
Does the COC agree with the number and type of sample bottles received ⁽¹⁾ ?	<input checked="" type="checkbox"/>	<input type="checkbox"/>	<input type="checkbox"/>	
Do the sample IDs on the bottle labels match the COC ⁽¹⁾ ?	<input checked="" type="checkbox"/>	<input type="checkbox"/>	<input type="checkbox"/>	
Is the COC properly relinquished by the client with date and time recorded ⁽¹⁾ ?	<input checked="" type="checkbox"/>	<input type="checkbox"/>	<input type="checkbox"/>	
For volatiles in water – is there headspace (> ¼ inch bubble) present? If yes, contact client and note in narrative.	<input checked="" type="checkbox"/>	<input type="checkbox"/>	<input type="checkbox"/>	
Are samples preserved that require preservation and was it checked ⁽¹⁾ ? (note ID of confirmation instrument used in comments) / (preservation is not confirmed for subcontracted analyses in order to insure sample integrity) (pH < 2 for samples preserved with HNO ₃ , HCL, H ₂ SO ₄) / (pH > 10 for samples preserved with NaAsO ₂ +NaOH, ZnAc+NaOH)	<input checked="" type="checkbox"/>	<input type="checkbox"/>	<input type="checkbox"/>	
Additional Comments (if any):				

⁽¹⁾ If NO, then contact the client before proceeding with analysis and note date/time and person contacted as well as the corrective action to be taken in the additional comments (above) and the case narrative.

Reviewed by: JB (Project Manager)

Date/Time Reviewed: 11-16-23

Origins Laboratory, Inc.

J. Bynon

The results in this report apply to the samples analyzed in accordance with the chain of custody document. This analytical report must be reproduced in its entirety.

Eagle Environmental Consulting, LLC
8000 W 44th Ave
Wheat Ridge CO 80033

Andrew Newberry
Project Number: [none]
Project: Noble - NCLP PC #AA04-05

Background-01@2'

10/16/2023 1:37:00PM

Analyte	Result	Reporting	Units	Dilution	Batch	Analyst	Prepared	Analyzed	Notes
		Limit							

Origins Laboratory, Inc.
Y311075-01 (Soil)

Table 915 metals by EPA 6020B

Arsenic	1.78	0.0884	mg/kg	10	B3K0730	CIH	11/07/2023	11/09/2023
---------	------	--------	-------	----	---------	-----	------------	------------

Origins Laboratory, Inc.



The results in this report apply to the samples analyzed in accordance with the chain of custody document. This analytical report must be reproduced in its entirety.

Eagle Environmental Consulting, LLC
8000 W 44th Ave
Wheat Ridge CO 80033

Andrew Newberry
Project Number: [none]
Project: Noble - NCLP PC #AA04-05

Metals by EPA 6000/7000 Series Methods - Quality Control

Origins Laboratory, Inc.

Analyte	Result	Reporting Limit	Units	Spike Level	Source Result	%REC	%REC Limits	RPD	RPD Limit	Notes
---------	--------	-----------------	-------	-------------	---------------	------	-------------	-----	-----------	-------

Batch B3K0730 - EPA 3050B

Blank (B3K0730-BLK1)

Prepared: 11/07/2023 Analyzed: 11/09/2023

Arsenic	ND	0.000100	mg/kg
Barium	ND	0.0100	"
Cadmium	ND	0.000100	"
Copper	ND	0.0100	"
Lead	ND	0.0100	"
Nickel	ND	0.0100	"
Selenium	ND	0.000100	"
Silver	ND	0.000100	"
Zinc	ND	0.100	"

LCS (B3K0730-BS1)

Prepared: 11/07/2023 Analyzed: 11/09/2023

Arsenic	0.0479	0.000100	mg/kg	0.0500	95.8	80-120
Barium	5.07	0.0100	"	5.00	101	80-120
Cadmium	0.0522	0.000100	"	0.0500	104	80-120
Copper	0.478	0.0100	"	0.500	95.6	80-120
Lead	0.0504	0.0100	"	0.0500	101	80-120
Nickel	0.0484	0.0100	"	0.0500	96.7	80-120
Selenium	0.0517	0.000100	"	0.0500	103	80-120
Silver	0.0486	0.000100	"	0.0500	97.2	80-120
Zinc	0.438	0.100	"	0.500	87.6	80-120

Matrix Spike (B3K0730-MS1)

Source: Y311073-01

Prepared: 11/07/2023 Analyzed: 11/09/2023

Arsenic	8.74	0.0970	mg/kg	4.85	3.98	98.3	75-125
Barium	561	9.70	"	485	65.6	102	75-125
Cadmium	5.09	0.0970	"	4.85	0.124	102	75-125
Copper	54.3	9.70	"	48.5	6.29	99.1	75-125
Lead	11.3	9.70	"	4.85	7.12	85.6	75-125

Origins Laboratory, Inc.



The results in this report apply to the samples analyzed in accordance with the chain of custody document. This analytical report must be reproduced in its entirety.

Eagle Environmental Consulting, LLC
8000 W 44th Ave
Wheat Ridge CO 80033

Andrew Newberry
Project Number: [none]
Project: Noble - NCLP PC #AA04-05

Metals by EPA 6000/7000 Series Methods - Quality Control
Origins Laboratory, Inc.

Analyte	Result	Reporting Limit	Units	Spike Level	Source Result	%REC	%REC Limits	RPD	RPD Limit	Notes
Batch B3K0730 - EPA 3050B										
Matrix Spike (B3K0730-MS1)		Source: Y311073-01			Prepared: 11/07/2023 Analyzed: 11/09/2023					
Nickel	12.2	9.70	mg/kg	4.85	8.52	74.8	75-125			QM-07
Selenium	4.72	0.0970	"	4.85	0.0723	95.8	75-125			
Silver	4.62	0.0970	"	4.85	0.0265	94.7	75-125			
Zinc	74.2	97.0	"	48.5	29.9	91.4	75-125			
Matrix Spike Dup (B3K0730-MSD1)		Source: Y311073-01			Prepared: 11/07/2023 Analyzed: 11/09/2023					
Arsenic	9.04	0.0986	mg/kg	4.93	3.98	103	75-125	3.31	20	
Barium	579	9.86	"	493	65.6	104	75-125	3.23	20	
Cadmium	5.25	0.0986	"	4.93	0.124	104	75-125	3.10	20	
Copper	56.9	9.86	"	49.3	6.29	103	75-125	4.60	20	
Lead	11.3	9.86	"	4.93	7.12	85.7	75-125	0.676	20	
Nickel	12.7	9.86	"	4.93	8.52	84.2	75-125	4.25	20	
Selenium	5.17	0.0986	"	4.93	0.0723	103	75-125	9.16	20	
Silver	4.72	0.0986	"	4.93	0.0265	95.2	75-125	2.19	20	
Zinc	76.6	98.6	"	49.3	29.9	94.7	75-125	3.19	20	

Origins Laboratory, Inc.



The results in this report apply to the samples analyzed in accordance with the chain of custody document. This analytical report must be reproduced in its entirety.

Eagle Environmental Consulting, LLC

8000 W 44th Ave

Wheat Ridge CO 80033

Andrew Newberry

Project Number: [none]

Project: Noble - NCLP PC #AA04-05

Notes and Definitions

QM-07 The spike recovery was outside acceptance limits for the MS and/or MSD. The batch was accepted based on acceptable LCS recovery.

ND Analyte NOT DETECTED at or above the reporting limit

RPD Relative Percent Difference

All soil results are reported at a wet weight basis.

Origins Laboratory, Inc.



The results in this report apply to the samples analyzed in accordance with the chain of custody document. This analytical report must be reproduced in its entirety.

Jordan A. Bynon, Project Manager