



April 26, 2024

Mr. Drew Stormo  
HSE Advisor  
Occidental Petroleum Corporation  
501 N Division Blvd  
Platteville, Colorado 80651

Subject: **Form 4 Sundry Notice – Final Reclamation  
Kerr-McGee Oil & Gas Onshore LP (Operator: 47120)  
CPC-SEC.4 4 42-4, Location ID: 406594  
SENE S4-T1N-R68W  
Weld County, Colorado**

Dear Mr. Stormo:

Ensolum, LLC (Ensolum) is contracted by Kerr McGee Oil & Gas Onshore LP (Kerr-McGee) to complete final reclamation services at plugged and abandoned (P&A) well sites located in Weld County, Colorado. The reclamation inspections were conducted in accordance with Colorado Energy and Carbon Management Commission (ECMC) Rule 1004.

### **FINAL RECLAMATION ASSESSMENT FINDINGS**

The former CPC-SEC.4 4 42-4 well (API: 05-123-08861) was P&A'd on June 24, 1996, as identified in the Well Abandonment and Plug Report, Document Number 32584. On April 19, 2024, Ensolum conducted a final reclamation inspection for the former CPC-SEC.4 4 42-4 well pad (Location ID: 406594) and it was determined that the site is compliant with final reclamation requirements per ECMC Rule 1004.

During the inspection it was observed that the former CPC-SEC.4 4 42-4 well is located within an active residential development known as NorthSkye, under the operational control of Toll Brothers and Lennar. The associated tank battery located 0.25-miles north of the P&A'd well site, has since been reclaimed and is also located within the residential development. All associated road base and equipment related to oil and gas activities have been removed from the well location. Ensolum personnel located the P&A wellhead location using a handheld Trimble DA2 Global Positioning System (GPS) unit and latitude and longitude coordinates obtained from the ECMC online database. A general site location map is included as Figure 1; and the Site Map displaying the location of the reclaimed site on aerial imagery is included as Figure 2. Photographs of the P&A location were taken facing each cardinal direction from the P&A wellhead location. The photographic log is included as Attachment 1.

The previous land use for the former CPC-SEC.4 4 42-4 well is defined as agriculture per ECMC GIS aerial imagery. The land use has changed and is now an active construction site for residential development. Based on rule 1004.d, a Form 4 Sundry Notice requesting final reclamation status has been prepared for the submittal to the ECMC. This letter will be included as an attachment to the electronic Form 4 submittal.

If you have any questions or need additional information, please do not hesitate to contact us.

Sincerely,

**Ensolum, LLC**



Trevor Hartwig  
Project Biologist  
303-817-2989  
thartwig@ensolum.com



Tanna Lyon  
Senior Scientist/Biologist  
970-509-0947  
tlyon@ensolum.com

Attachments:

Figure 1 - Site Location Map

Figure 2 - Site Map

Attachment 1 – Photographic Log

Figure1 – Site Location Map

---

Path: C:\Users\peter.Rodriguez\OneDrive - ENSOLUM, LLC\Desktop\GIS\File Path Structure\12 - Denver\Kerr-McGee Oil & Gas Onshore\_LP\23 Apr Map Series1 - Project\23 Apr Map Series.aprx

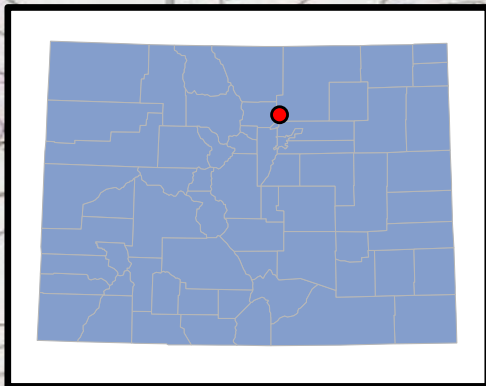
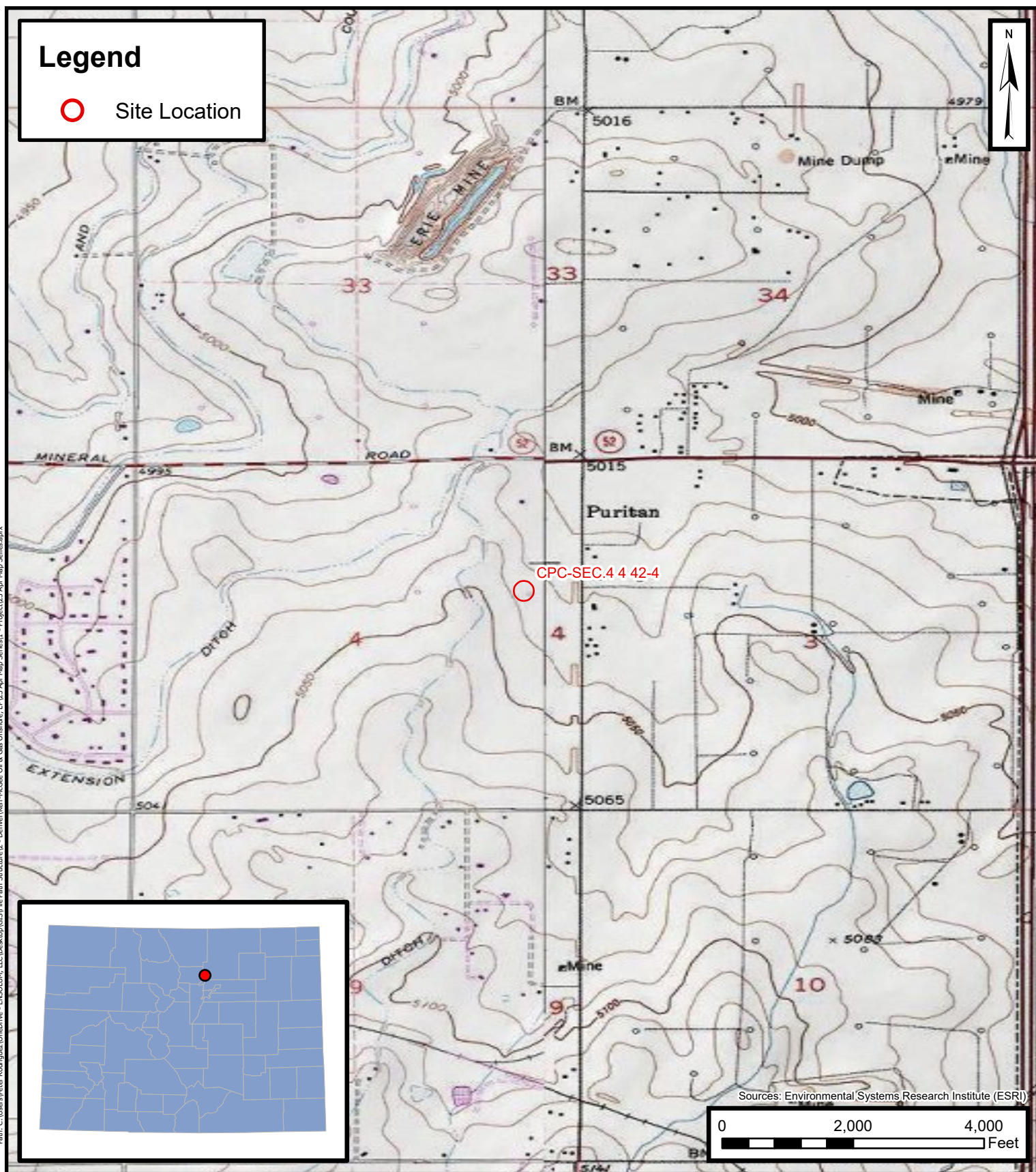

## Site Location Map

CPC-SEC.4 4 42-4  
Kerr-McGee Oil & Gas Onshore LP  
SENE S4-T1N-R68W  
Weld County, Colorado

Project Number: 09A1417756

FIGURE

1



Figure 2 – Site Map

---

# Legend

● Plugged & Abandoned



CPC-SEC.4 4 42-4  
API: 05-123-08861



0 150 300  
Feet

Sources: Bing Maps



## Site Map

CPC-SEC.4 4 42-4  
Kerr-McGee Oil & Gas Onshore LP  
SENE S4-T1N-R68W  
Weld County, Colorado  
Project Number: 09A1417756

FIGURE  
2

ATTACHMENT 1

Photographic Log

---



# RECLAMATION PHOTOGRAPHIC LOG

Kerr McGee Oil & Gas  
Onshore LP - 47120

**CPC-SEC.4 4 42-4**  
Weld County, Colorado

Location ID: 406594  
API: 05-123-08861

Date: April 19, 2024

**Photo No. 1 - North**

P&A Well Stake Lat/Long:  
40.082147, -105.001296



View facing north as required in the Colorado Energy & Carbon Management Commission (ECMC) Rule 1004.

# RECLAMATION PHOTOGRAPHIC LOG

Kerr McGee Oil & Gas  
Onshore LP - 47120

**CPC-SEC.4 4 42-4**  
Weld County, Colorado

Location ID: 406594  
API: 05-123-08861

Date: April 19, 2024

**Photo No. 2 - South**

P&A Well Stake Lat/Long:  
40.082147, -105.001296



View facing south as required in the Colorado Energy & Carbon Management Commission (ECMC) Rule 1004.



# RECLAMATION PHOTOGRAPHIC LOG

Kerr McGee Oil & Gas  
Onshore LP - 47120

**CPC-SEC.4 4 42-4**  
Weld County, Colorado

Location ID: 406594  
API: 05-123-08861

Date: April 19, 2024

**Photo No. 3 - East**

P&A Well Stake Lat/Long:  
40.082147, -105.001296



View facing east as required in the Colorado Energy & Carbon Management Commission (ECMC) Rule 1004.

# RECLAMATION PHOTOGRAPHIC LOG

Kerr McGee Oil & Gas  
Onshore LP - 47120

**CPC-SEC.4 4 42-4**  
Weld County, Colorado

Location ID: 406594  
API: 05-123-08861

Date: April 19, 2024

**Photo No. 4 - West**

P&A Well Stake Lat/Long:  
40.082147, -105.001296

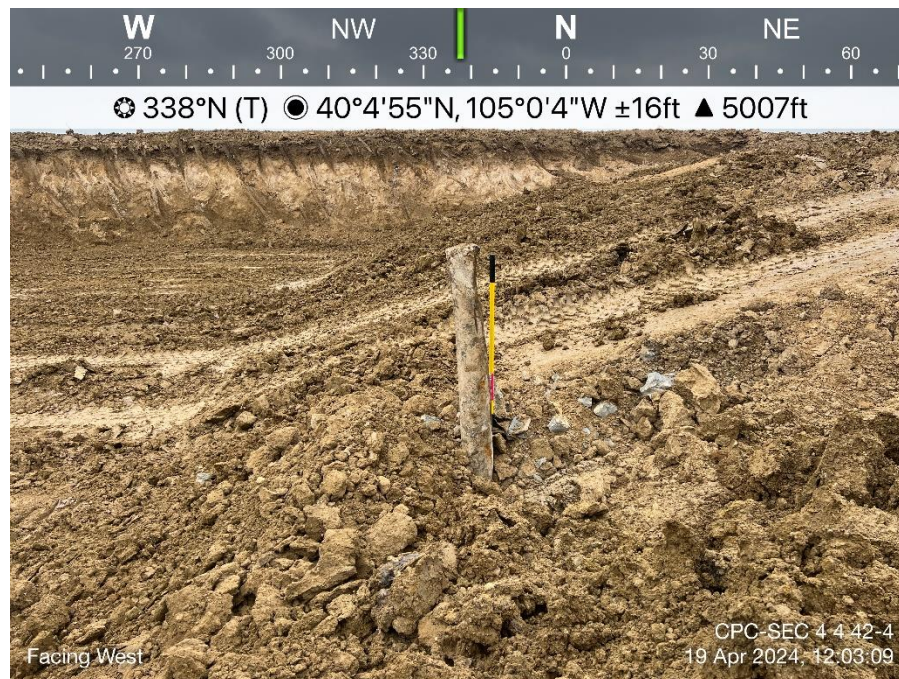

View facing west as required in the Colorado Energy & Carbon Management Commission (ECMC) Rule 1004.



# RECLAMATION PHOTOGRAPHIC LOG

Kerr McGee Oil & Gas  
Onshore LP - 47120

**CPC-SEC.4 4 42-4**  
Weld County, Colorado

Location ID: 406594  
API: 05-123-08861

Date: April 19, 2024

**Photo No. 5 – Overall Site**

P&A Well Stake Lat/Long:  
40.082147, -105.001296



Overall site view

CPC-SEC 4 4 42-4  
19 Apr 2024 12:03:33

Overall site view as required in the Colorado Energy & Carbon Management Commission (ECMC) Rule 1004.

# RECLAMATION PHOTOGRAPHIC LOG

Kerr McGee Oil & Gas  
Onshore LP - 47120

**CPC-SEC.4 4 42-4**  
Weld County, Colorado

Location ID: 406594  
API: 05-123-08861

Date: April 19, 2024

**Photo No. 6 –  
Overall Reclaimed Tank Battery**

P&A Well Stake Lat/Long:  
40.082147, -105.001296

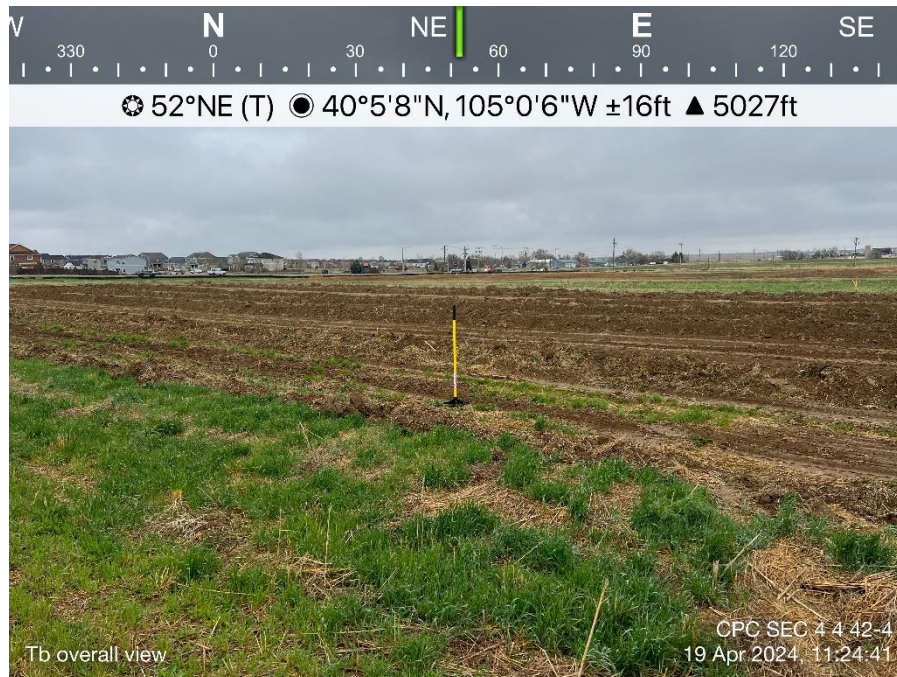

Tb overall view

CPC SEC 4 4 42-4  
19 Apr 2024 11:24:41

Overall reclaimed tank battery view as required in the Colorado Energy & Carbon Management Commission (ECMC) Rule 1004.