

HYDROLOGY MAP
5 MINUTES TO MIDNIGHT 8-34HZ
HORIZONTAL MULTI-WELL PAD

NE1/4 SE1/4 & SE1/4 NE1/4 SECTION 34, TOWNSHIP 4 NORTH, RANGE 63 WEST, 6TH P.M., WELD COUNTY, COLORADO

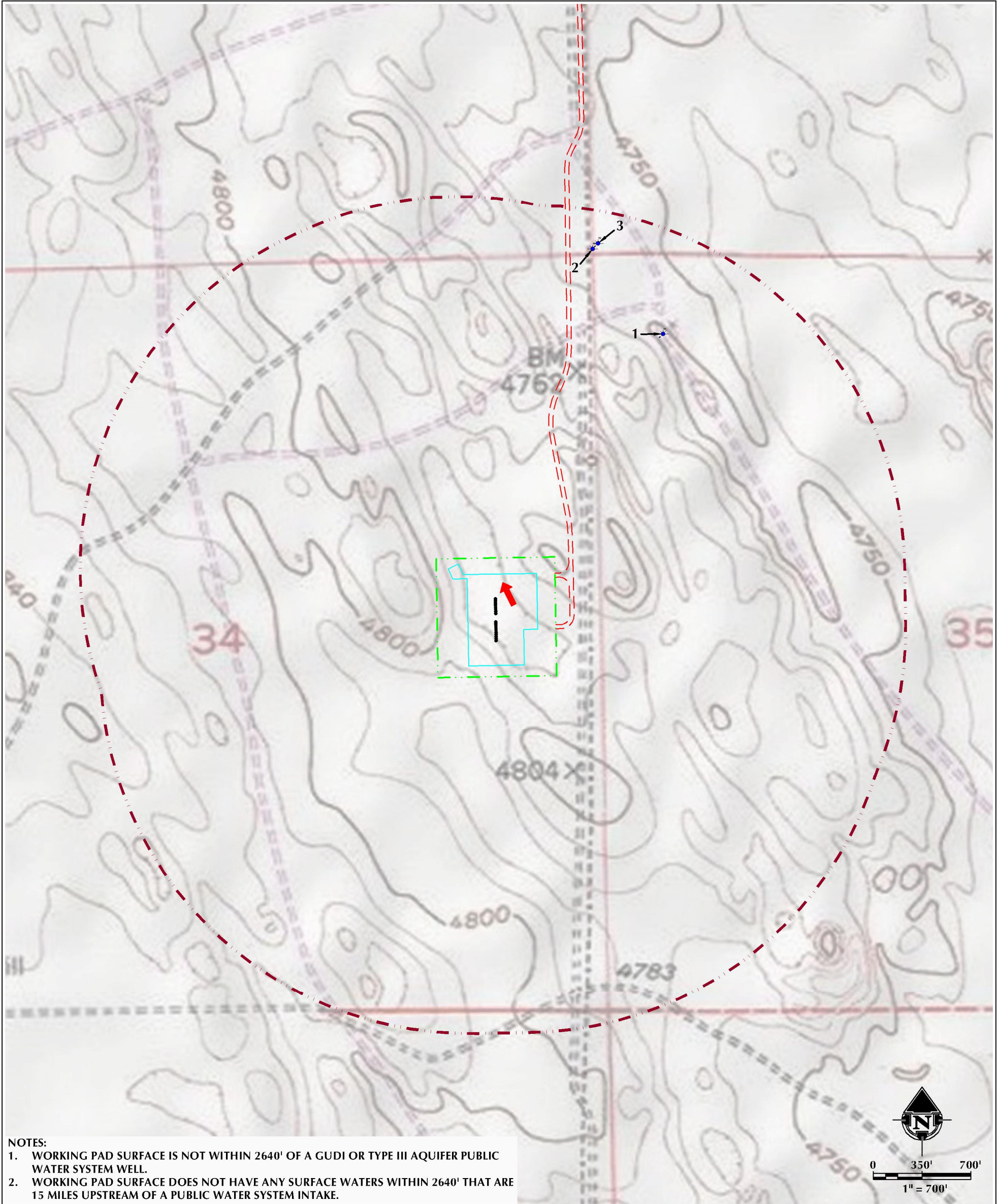

- NOTES:
- WORKING PAD SURFACE IS NOT WITHIN 2640' OF A GUDI OR TYPE III AQUIFER PUBLIC WATER SYSTEM WELL.
 - WORKING PAD SURFACE DOES NOT HAVE ANY SURFACE WATERS WITHIN 2640' THAT ARE 15 MILES UPSTREAM OF A PUBLIC WATER SYSTEM INTAKE.

- EXISTING WATER WELL (PERMIT #173925, WELL CONSTRUCTED) IS $\pm 1943'$ NE.
- EXISTING WATER WELL (PERMIT #155846, WELL CONSTRUCTED) IS $\pm 2363'$ N.
- EXISTING WATER WELL (PERMIT #89547-VE, PERMIT ISSUED) IS $\pm 2409'$ N.

- LEGEND**
- | | | | |
|--|----------------------------------|--|---|
| | PROPOSED WELL | | PROPOSED OIL & GAS LOCATION |
| | WATER WELL | | WORKING PAD SURFACE |
| | PROPOSED ACCESS ROAD | | 100-YEAR FLOODPLAIN (PRELIMINARY, 2020) |
| | DITCH/CANAL/DRAINAGE | | 100-YEAR FLOODWAY (PRELIMINARY, 2020) |
| | DOWNGRADIENT | | 100-YEAR FLOODPLAIN (EFFECTIVE, 2016) |
| | 2640' WORKING PAD SURFACE BUFFER | | NWI RIVERINE/POND/WETLAND |
| | | | NWI RIPARIAN AREA |

ALL MEASUREMENTS ARE MADE
FROM NEAREST EDGE OF THE
WORKING PAD SURFACE



609 CONSULTING, LLC
LOVELAND OFFICE
6706 South Franklin Avenue
Loveland, Colorado 80538
Phone: 970-776-1331
SHERIDAN OFFICE
1095 Saberton Avenue
Sheridan, Wyoming 82801
Phone: 307-674-6069

DATE SURVEYED: 9/27/23
DATE: 11/20/23
DRAFTER: AMPZ
REVISED:

DATA SOURCES & NOTES:
- TOPOGRAPHIC MAP IS COURTESY OF USGS.
- WATER WELLS COURTESY OF COLORADO DIVISION OF WATER RESOURCES.
- MANY FEATURES ON THIS MAP COME FROM PUBLICLY AVAILABLE DATA AND SURFACE WATER LYING OUTSIDE THE SURFACE PROPERTY MAY HAVE BEEN OBTAINED FROM AERIAL IMAGERY. THE ACCURACY AND COMPLETENESS OF SAID DATA HAS NOT BEEN VERIFIED BY 609 CONSULTING, LLC. EXISTING CONDITIONS MAY DIFFER FROM WHAT IS SHOWN.

PREPARED FOR:
Kerr-McGee Oil & Gas Onshore LP