

K:\ANDAKO\2017\197_CERVO_RANCH_T4N_R63WDWG04_5 MINUTES TO MIDNIGHT.dwg, 11/20/2023 6:23:49 AM, glemmes

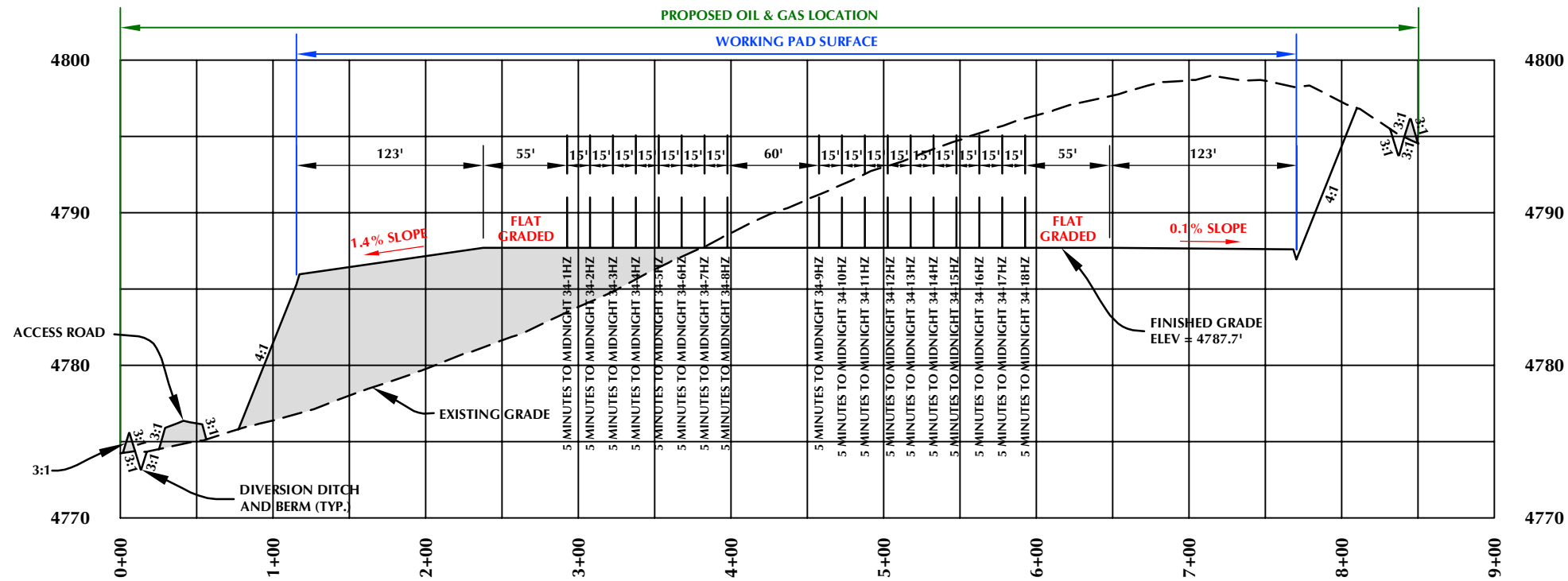

CROSS SECTION A-A'

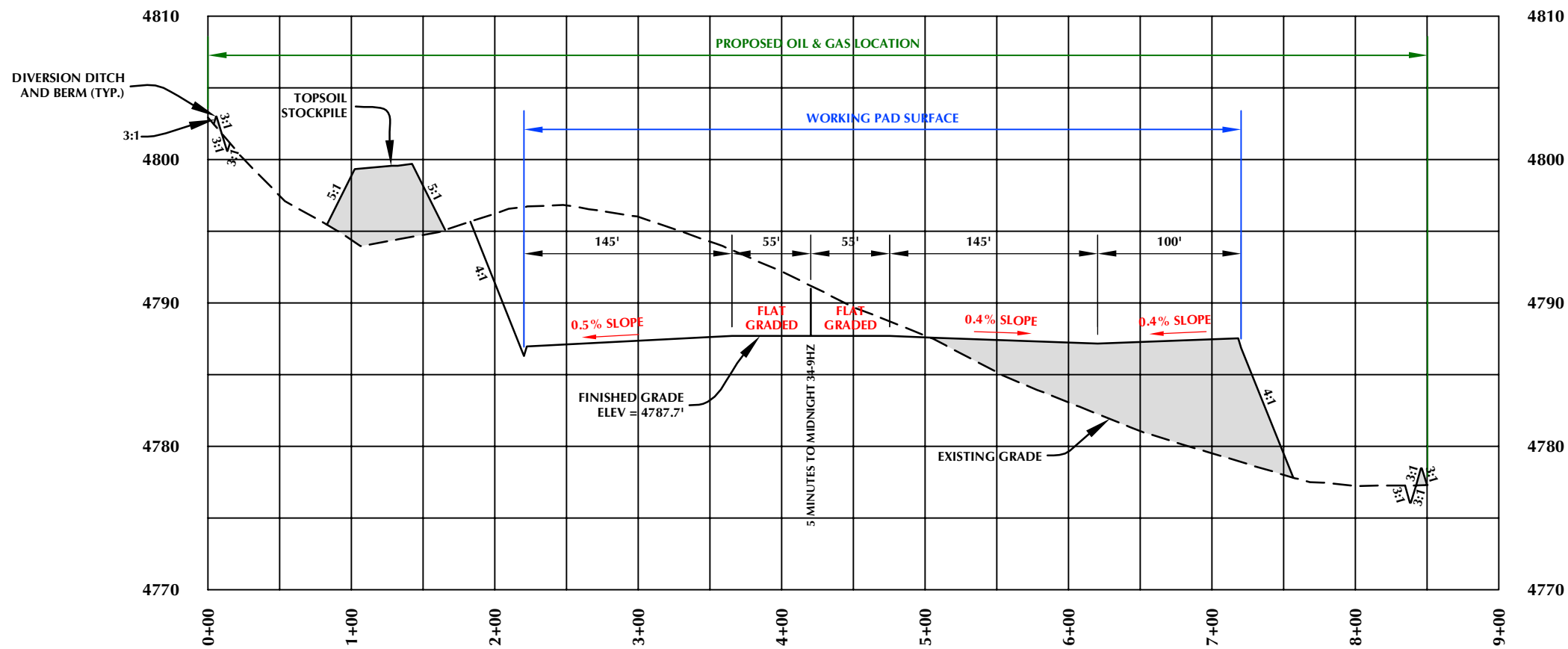

CROSS SECTION B-B'

5 MINUTES TO MIDNIGHT 8-34HZ

5 MINUTES TO MIDNIGHT 34-1HZ, 5 MINUTES TO MIDNIGHT 34-2HZ,
5 MINUTES TO MIDNIGHT 34-3HZ, 5 MINUTES TO MIDNIGHT 34-4HZ,
5 MINUTES TO MIDNIGHT 34-5HZ, 5 MINUTES TO MIDNIGHT 34-6HZ,
5 MINUTES TO MIDNIGHT 34-7HZ, 5 MINUTES TO MIDNIGHT 34-8HZ,
5 MINUTES TO MIDNIGHT 34-9HZ, 5 MINUTES TO MIDNIGHT 34-10HZ,
5 MINUTES TO MIDNIGHT 34-11HZ, 5 MINUTES TO MIDNIGHT 34-12HZ,
5 MINUTES TO MIDNIGHT 34-13HZ, 5 MINUTES TO MIDNIGHT 34-14HZ,
5 MINUTES TO MIDNIGHT 34-15HZ, 5 MINUTES TO MIDNIGHT 34-16HZ,
5 MINUTES TO MIDNIGHT 34-17HZ & 5 MINUTES TO MIDNIGHT 34-18HZ
LOCATED IN SECTION 34, T4N, R63W, 6TH P.M.
WELD COUNTY, COLORADO

CONSTRUCTION LAYOUT DRAWING - CROSS SECTIONS

Kerr-McGee Oil &
Gas Onshore LP
1099 18th Street
Denver, Colorado 80202



LOVELAND OFFICE
6706 North Franklin Avenue
Loveland, Colorado 80538
Phone 970-776-4331
SHERIDAN OFFICE
1095 Saberton Avenue
Sheridan, Wyoming 82801
Phone 307-674-0609

HORIZONTAL 0 50' 100' 1" = 100'
VERTICAL 0 5' 10' 1" = 10'

SCALE: 1"=100' DATE: 11/20/23 SHEET NO:

REVISED:

1

1 OF 1

NE1/4 SE1/4 & SE1/4 NE1/4 SECTION 34, TOWNSHIP 4 NORTH, RANGE 63 WEST, 6TH P.M., WELD COUNTY, COLORADO

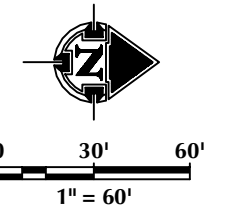

**Kerr-McGee Oil &
Gas Onshore LP**
1099 18th Street
Denver, Colorado 80202

NOTE:





1. RIG PROFILE IS APPROXIMATE AND SUBJECT TO MODIFICATION DUE TO SPECIFIC CIRCUMSTANCES.

5 MINUTES TO MIDNIGHT 8-34HZ

	CAPACITY
SPORT	4,000 GAL CAPACITY
D	4,000 GAL CAPACITY
	4,500 GAL CAPACITY
	6,000 GAL CAPACITY
	2,200 GAL DEF TANK
	16,000 GAL DIESEL TANK
	3,600 BBL CAPACITY
(WATER)	500 BBL CAPACITY
K	500 BBL CAPACITY

EQUIPMENT	CAPACITY
ACID TRANSPORT	4,000 GAL CAPACITY
HCR SYNTHETIC ACID TRANSPORT	4,000 GAL CAPACITY
FRICTION REDUCER ISO	4,500 GAL CAPACITY
BIOCIDE ISO	6,000 GAL CAPACITY
DEF TANK	2,200 GAL DEF TANK
DIESEL TANK	16,000 GAL DIESEL TANK
ROUND WATER TANK	3,600 BBL CAPACITY
STORAGE TANK (OPEN TOP, CLOSED TOP, WATER)	500 BBL CAPACITY
WATER RECYCLE TANK	500 BBL CAPACITY

LEGEND

-  PROPOSED WELL
-  EXISTING WELL
-  PROPOSED OIL & GAS LOCATION
-  PROPOSED WORKING PAD SURFACE
-  PROPOSED 2' CONTOUR



LOVELAND OFFICE
6706 North Franklin Avenue
Loveland, Colorado 80538
Phone 970-776-4331

SHERIDAN OFFICE
1095 Saberton Avenue
Sheridan, Wyoming 82801
Phone 307-674-0609

**Kerr-McGee Oil &
Gas Onshore LP**
1099 18th Street
Denver, Colorado 80202

SCALE: 1" = 60'
DATE SURVEYED: 9/27/23
DATE: 11/20/23
DRAFTER: SRS
REVISED:

NOTE:

1. COMPLETION AND STIMULATION LAYOUT IS APPROXIMATE AND SUBJECT TO MODIFICATION DUE TO SPECIFIC CIRCUMSTANCES.

PRELIMINARY FLOWBACK EQUIPMENT LAYOUT DRAWING

5 MINUTES TO MIDNIGHT 8-34HZ

NE1/4 SE1/4 & SE1/4 NE1/4 SECTION 34, TOWNSHIP 4 NORTH, RANGE 63 WEST, 6TH P.M., WELD COUNTY, COLORADO

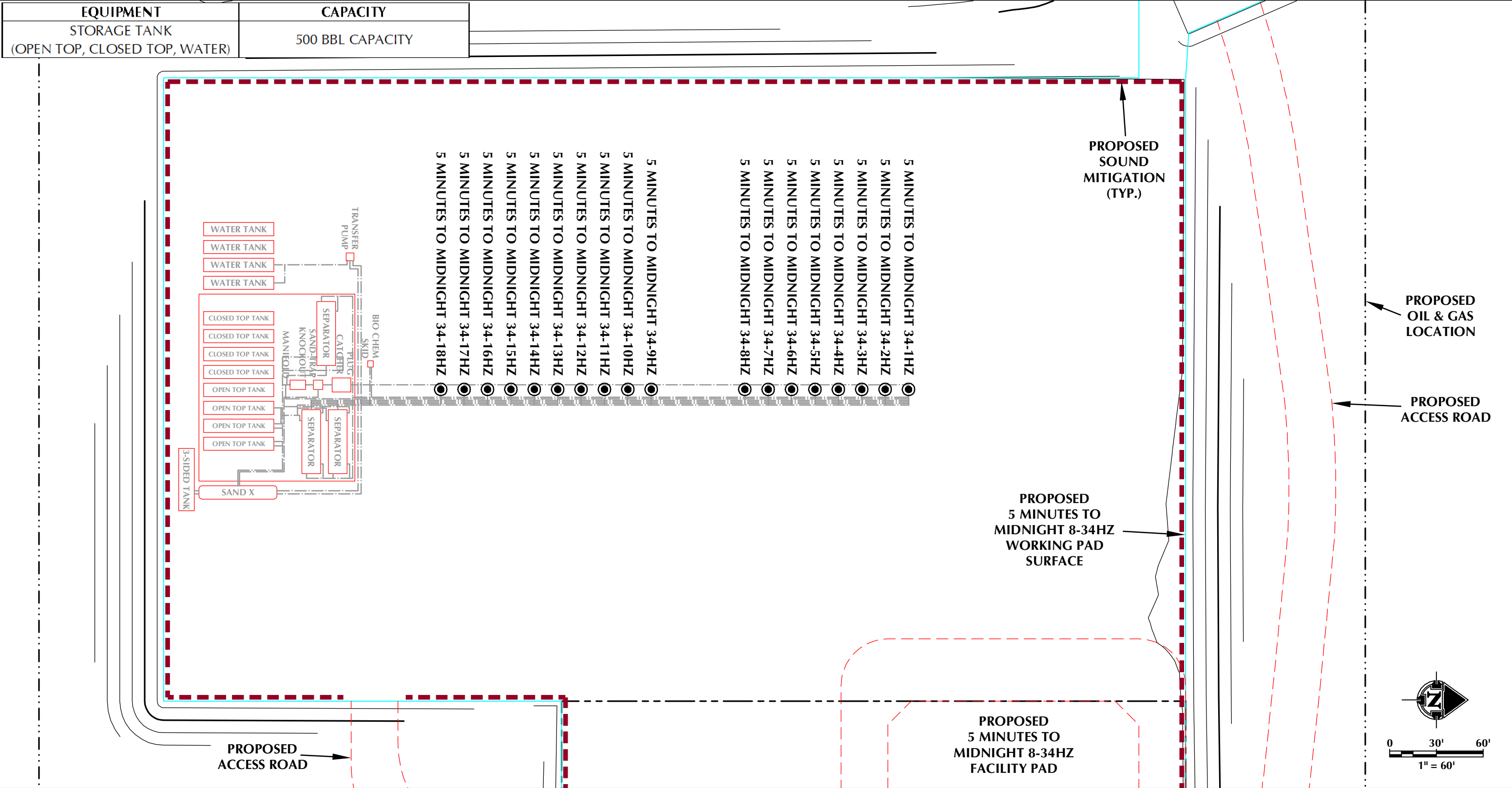

LEGEND

- PROPOSED WELL
- EXISTING WELL
- PROPOSED OIL & GAS LOCATION
- PROPOSED WORKING PAD SURFACE
- PROPOSED 2' CONTOUR
- - - PROPOSED PIPELINE

LOVELAND OFFICE
6706 North Franklin Avenue
Loveland, Colorado 80538
Phone 970-776-4331

SHERIDAN OFFICE
1095 Saberton Avenue
Sheridan, Wyoming 82801
Phone 307-674-0609

CONSULTING, LLC

Kerr-McGee Oil & Gas Onshore LP

1099 18th Street
Denver, Colorado 80202

SCALE: 1" = 60'

DATE SURVEYED: 9/27/23

DATE: 11/20/23

DRAFTER: SRS

REVISED:

NOTE:

-WELLHEADS WILL REMAIN PERMANENTLY AFTER FLOWBACK IS COMPLETE. ALL OTHER EQUIPMENT DISPLAYED IS TEMPORARY AND WILL BE REMOVED FOLLOWING FLOWBACK OPERATIONS.

K:\ANDARQ\2017\2017_197_CERVO_BRANCH_TN_R63W\DWG\4_5 MINUTES TO MIDNIGHT.dwg, 11/19/2023 1:54:55 PM, sandberg

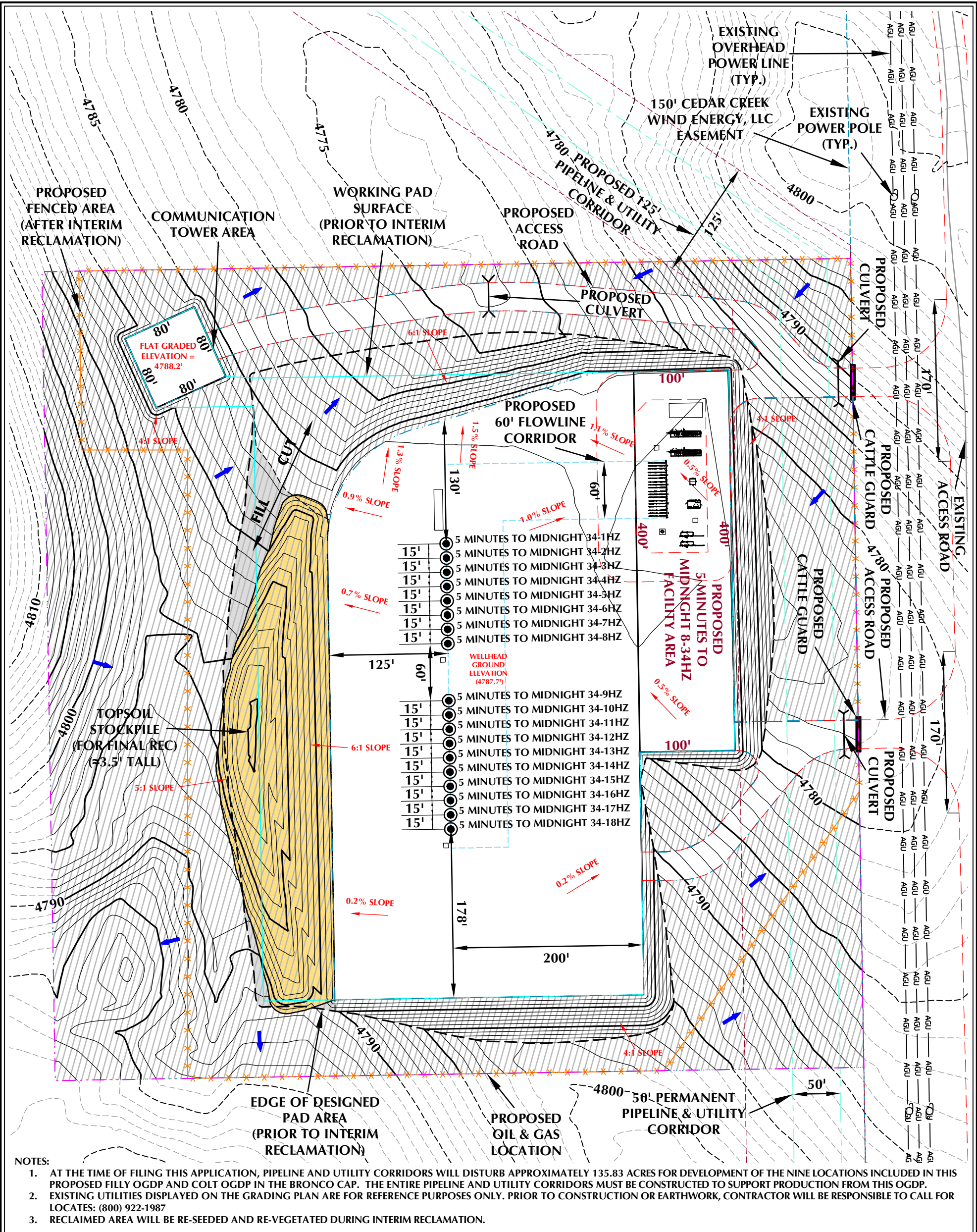

- NOTES:
- AT THE TIME OF FILING THIS APPLICATION, PIPELINE AND UTILITY CORRIDORS WILL DISTURB APPROXIMATELY 135.83 ACRES FOR DEVELOPMENT OF THE NINE LOCATIONS INCLUDED IN THIS PROPOSED FILLY OGDG AND COLT OGDG IN THE BRONCO CAP. THE ENTIRE PIPELINE AND UTILITY CORRIDORS MUST BE CONSTRUCTED TO SUPPORT PRODUCTION FROM THIS OGDG.
 - EXISTING UTILITIES DISPLAYED ON THE GRADING PLAN ARE FOR REFERENCE PURPOSES ONLY. PRIOR TO CONSTRUCTION OR EARTHWORK, CONTRACTOR WILL BE RESPONSIBLE TO CALL FOR LOCATES: (800) 922-1987
 - RECLAIMED AREA WILL BE RE-SEEDING AND RE-VEGETATED DURING INTERIM RECLAMATION.

5 MINUTES TO MIDNIGHT 8-34HZ FACILITY LAYOUT DRAWING

QUANTITIES AND DESIGN PARAMETERS

SHRINKAGE FACTOR = 1.00
SWELL FACTOR = 1.00
PROPOSED OIL & GAS LOCATION = 16.60 ACRES
AREA RECLAIMED DURING INTERIM RECLAMATION = 10.15 ACRES
TOTAL PAD AREA AFTER INTERIM RECLAMATION = 6.45 ACRES
TOTAL FENCED AREA AFTER INTERIM RECLAMATION = 13.53 ACRES

PAD QUANTITIES

TOTAL CUT = 10,585 C.Y.
TOTAL FILL = 10,585 C.Y.
TOTAL TOPSOIL @ 6" DEPTH FROM CONSTRUCTION PHASE = 6,947 C.Y.
TOPSOIL USED FOR INTERIM REC = 1,748 C.Y.
TOPSOIL STORED FOR FINAL REC = 5,199 C.Y.

LAND USE: RANGELAND

Kerr-McGee Oil & Gas Onshore LP
1099 18th Street
Denver, Colorado 80202



LOVELAND OFFICE
6706 North Franklin Avenue
Loveland, Colorado 80538
Phone 970-776-4331

SHERIDAN OFFICE
1095 Saberton Avenue
Sheridan, Wyoming 82801
Phone 307-674-0609

- LEGEND
- EXISTING WELL LOCATION
 - PROPOSED WELL LOCATION
 - EXISTING CONTOURS (1' INTERVAL)
 - PROPOSED CONTOURS (1' INTERVAL)
 - EPL
 - EXISTING PIPELINE
 - PROPOSED FLOWLINE
 - EXISTING FENCE
 - RECLAMATION AREA
 - PLANNED FLOW DIRECTION
 - WORKING PAD SURFACE (WPS)



HORIZONTAL 0 50' 100' 1" = 100'

1' CONTOURS

SCALE: 1"=100' DATE: 11/20/23 SHEET NO:

REVISED: SRS 12/13/23 1 1 OF 2

DISTANCE FROM WORKING PAD SURFACE TO:

BUILDING	±2096' N
RESIDENTIAL BUILDING UNIT (RBU)	5280'+ NE
HIGH OCCUPANCY BUILDING UNIT (HOBU)	5280'+ SE
DESIGNATED OUTSIDE ACTIVITY AREA	5280'+ SW
PUBLIC ROAD	5280'+ N
ABOVE GROUND UTILITY	±187' E
RAILROAD	5280'+ N
PROPERTY LINE	±378' E
SCHOOL FACILITY	5280'+ NW
CHILD CARE CENTER	5280'+ NW
DISPROPORTIONATELY IMPACTED (DI) COMMUNITY	±0'
RBU, HOBU, OR SCHOOL FACILITY WITHIN A DI COMMUNITY	5280'+ NE

DISTANCE FROM NEAREST WELL TO:

TEST SEPARATOR	±253' NE
TEMPORARY SAND TANK	±229' E
TEMPORARY ECD	±270' E
TEMPORARY PURGE FLARE	±185' E
WORKING PAD SURFACE	±178' N

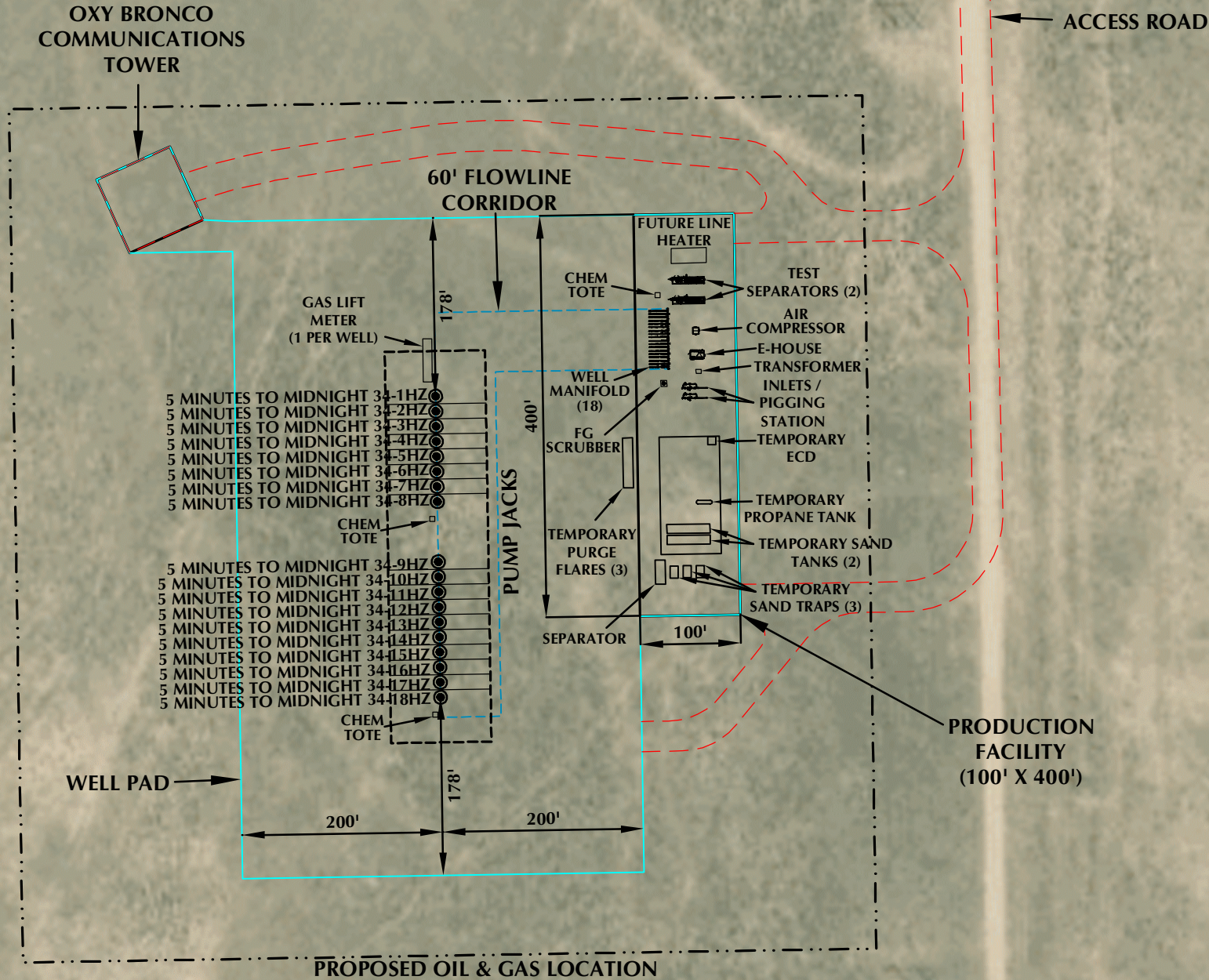

LEGEND:		
PROPOSED WELL	PROPOSED OIL & GAS LOCATION	
ROAD PROPOSED	PROPOSED FLOWLINE CORRIDOR	
WORKING PAD SURFACE		

- NOTES:**
- EQUIPMENT PLACEMENT IS APPROXIMATE AND SUBJECT TO MINOR MODIFICATION DUE TO SPECIFIC CIRCUMSTANCES.
 - FLOWLINE CORRIDOR IS APPROXIMATE AND SUBJECT TO MINOR MODIFICATION DUE TO SPECIFIC CIRCUMSTANCES.

FACILITY COORDINATES:
LAT: 40.269049° LONG: -104.416128° (NAD83)

DATA SOURCES:
- AERIAL COURTESY OF NAIP.



LOVELAND OFFICE
6706 North Franklin Avenue
Loveland, Colorado 80538
Phone 970-776-4331

SHERIDAN OFFICE
1095 Saberton Avenue
Sheridan, Wyoming 82801
Phone 307-674-0609

**Kerr-McGee Oil &
Gas Onshore LP**
1099 18th Street
Denver, Colorado 80202

SCALE: 1" = 150'
DATE SURVEYED: 9/27/23
DATE: 11/20/23
DRAFTER: AMPZ
REVISED: 12/13/23

FACILITY LAYOUT DRAWING
5 MINUTES TO MIDNIGHT 8-34HZ
LOCATED IN SECTION 34, T4N, R63W, 6TH P.M.
WELD COUNTY, COLORADO

