



FORM F-106

JOHN H. HILL - Leppla Estate #2  
Weld County, Colorado

RECEIVED

N

OCT 17 1974



00060489

R. 68W

GOLD. OIL &amp; GAS CONS. COMM.

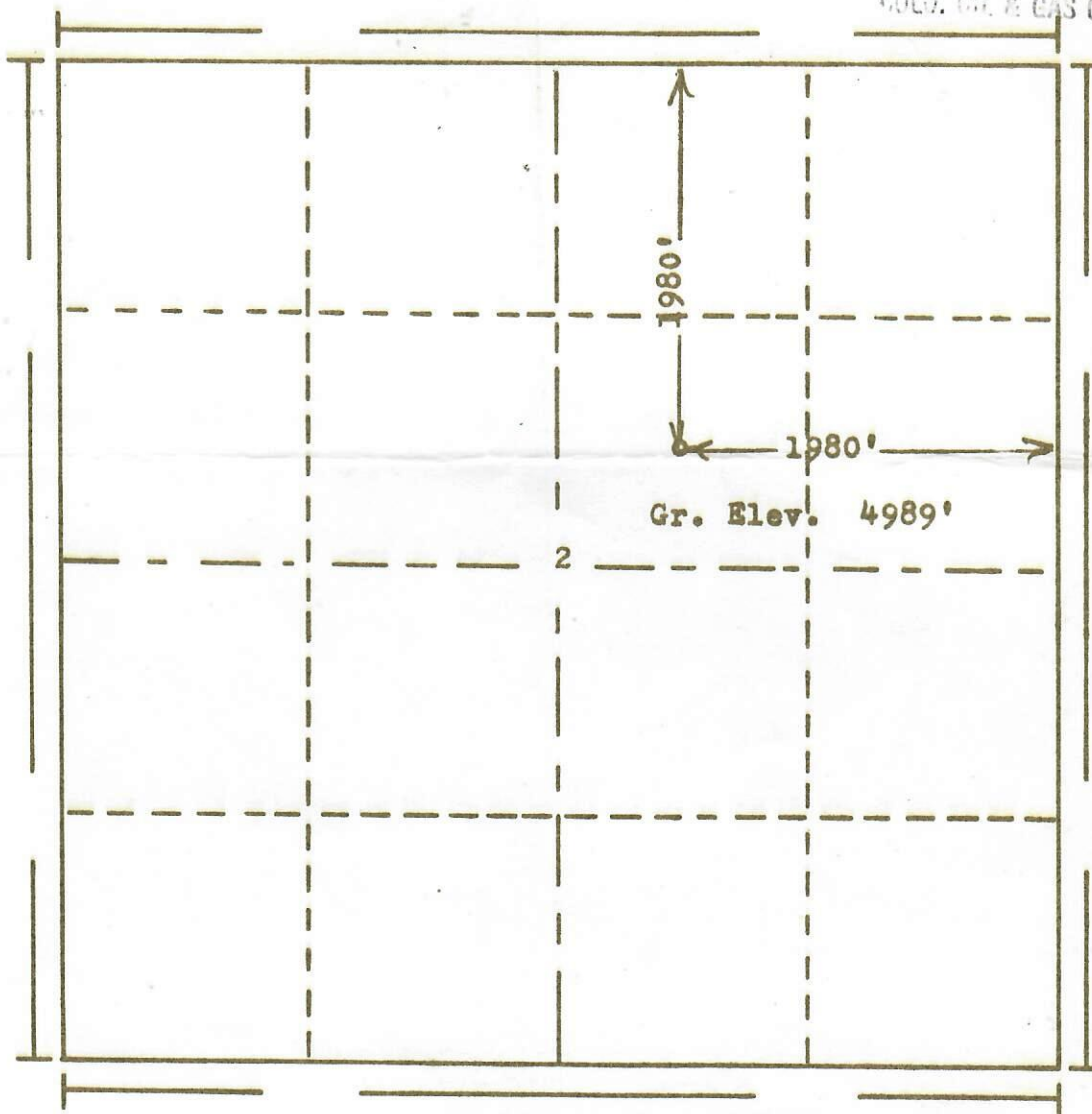

Scale... 1" = 1000'

Powers Elevation Company, Inc. of Denver, Colorado  
has in accordance with a request from Mr. Marshon  
for John H. Hill

determined the location of No.2 Leppla Estate  
to be CSW NE Section 2 Township 1N  
Range 68W of the 6th Principal Meridian  
Weld County, Colorado

I hereby certify that this plat is an  
accurate representation of a correct  
survey showing the location of

Date: 10-7-74

B. J. Hill  
Licensed Land Surveyor No. 2853  
State of Colorado

74-742