

## Tank Battery Closure Checklist

### COGCC Rule 911.a.(4) Environmental Site Closure Assessment Field Form

Additional attachments (optional):		Pit Closure —		Wellhead Closure —		Flowline Closure —		Partially Buried Vault Closure 08/24/23
Site Name & COGCC Facility Number: CPC Ferguson Chewy UPRC T5N-R64W-S23 L01 Tank Battery, Location ID: 450362		Date: 08/24/23		Remediation Project #: 22142				
Associated Wells: 05-123-12468		Age of Site: Years		Number of Photos Attached: 6				
Location: (GPS coordinates of southeaster berm) 40.383631 / -104.517004		Estimated Facility Size (acres):						

General Condition of Site: (General observations regarding housekeeping, corrosion, waste management, etc.)

Good Condition

USCS Soil Type: Clayey SAND      Estimated Depth to Groundwater: Approx. 10-20'

Hydrocarbon Impacted Soils / Spills: (Note estimated size and if impact appears to be surficial or extends to an unknown depth)  
None observed.

Salt Crusted Soils or Impacted Vegetation: (Note estimated size and if impact appears to be surficial or extends to an unknown depth)  
None observed.

### Tanks

Tank Contents	Crude (3)								
Size (barrels)	300								
Age	Years								
Construction Material	Steel								
Tank type (AST/DRV, etc.)	AST								
Visual Integrity of Tank	Good								
Condition of tank footprint	Good - No Odor/Staining								
PID Readings	N/A								
Soil impacts present at valves or hatches?	None observed.								
PID Readings	0.4	0.2	1.7						
Sample taken? Location/ Sample ID#	TB-SS-01	TB-SS-02	TB-SS-03						
Photo Number(s)	See photolog								

Other observations regarding tanks:

### Separators

Separator size	Unknown								
Vertical or Horizontal	Horizontal								
Age	Years								
Soil impacts present at valves or hatches?	None observed.								
PID Readings	2.3	11.9							
Sample taken? Location/ Sample ID#	TB-SS-08	TB-SS-09							
Photo Number(s)	See photolog								

Other observations regarding separators

### Third Party Equipment

Type	Meter House								
Age	Years								

Third Party	DCP								
Removal Date	TBD								
Sample taken?	TB-SS-04	TB-SS-05							
PID Readings	4.9	3.8							
Photo Number(s)	See photolog								
<b>Other Facility Equipment</b>									
Equipment type	VOC Burner (2)								
Equipment Condition	Good								
Age	Years								
Soil impacts	None observed.								
PID Readings	0.5		0.2						
Sample taken?	TB-SS-06		TB-SS-07						
Photo Number(s)	See photolog								
Other observations regarding other facility or third party equipment:									
<b>Summary</b>									
Was impacted soil identified?									
<input checked="" type="checkbox"/> No      Yes - less than 10 cubic yards      Yes - more than 10 cubic yards									
Total number of samples field screened: 9					Total number of samples collected: 4				
Highest PID Reading: 11.9					Total number of samples submitted to lab for analysis: 4				
If more than 10 cubic yards of impacted soil were observed:									
Vertical extent:					Estimated spill volume:				
N/A									
Lateral extent:					Volume of soil removed:				
Is additional investigation required?									
Was groundwater encountered during the investigation?									
<input checked="" type="checkbox"/> No      Yes - not impacted or in contact with impacted soils      Yes - groundwater impacted and/or in contact with impacted soils									
Measured depth to groundwater:					Was remedial groundwater removal conducted?      Yes      No				
Date Groundwater was encountered:					Commencement date of removal:				
Sheen on groundwater?      Yes      No					Volume of groundwater removed prior to sampling:				
Free product observed?      Yes      No					Volume of groundwater removed post sampling:				
Total number of samples collected:					Total Volume of groundwater removed:				
Total number of samples submitted to lab for analysis:									

## Buried or Partially Buried Vessel Closure Checklist

### COGCC Rule 911.a.(4) Environmental Site Closure Assessment Field Form

Additional attachments (optional):		Pit Closure <u>    </u>		Wellhead Closure <u>    </u>		Flowline Closure <u>    </u>		Tank Battery Closure 08/24/23	
Site Name & COGCC Facility Number: CPC Ferguson Chewy UP		Date: RC T5N-R64W-S23 L01 Tank Battery, Location ID: 450362					08/24/23		Remediation Project #: 22142
Associated Wells: 05-123-12468		Age of Site: Years					Number of Photos Attached: 1		
Location: (GPS coordinates of vault or southeastern tank berm for multiple)							40.383631 / -104.517004		Estimated Facility Size (acres):

General Condition of Site: (General observations regarding housekeeping, corrosion, waste management, etc.)

Good Condition

USCS Soil Type: Clayey SAND      Estimated Depth to Groundwater: Approx. 10-20'

Hydrocarbon Impacted Soils / Spills: (Note estimated size and if impact appears to be surficial or extends to an unknown depth)

Slight hydrocarbon odor observed within excavation, no staining.

Salt Crusted Soils or Impacted Vegetation: (Note estimated size and if impact appears to be surficial or extends to an unknown depth)

None observed.

#### Buried or Partially Buried Vessels

Tank Contents	Produced Water								
Size (barrels)	50								
Age	Years								
Construction Material	Concrete								
Visual Integrity of Tank	Good - Per Crew								
Condition of tank contents	Slight HC odor observed								
PID Readings	N/A								
Condition of Tank Lines	Good - No Odor/Staining								
PID Readings	1.1	0.2	0.3	0.1	0.2	0.3	0.6	151.4	6.8
Sample taken? Location/Sample ID#	WV-SS-01	WV-SS-02	WV-SS-03	WV-SS-04	WV-SS-05	WV-SS-06	WV-SS-07	WV-SS-08	WV-FS-01
Photo Number(s)	See photolog								

0.2  
WV-FS-02

Other observations regarding partially buried vessels:

#### Summary

Was impacted soil identified?	No	<b>Yes - less than 10 cubic yards</b>	Yes - more than 10 cubic yards
Total number of samples field screened:	10		
Highest PID Reading:	151.4		
Total number of samples submitted to lab for analysis: 10			
If more than 10 cubic yards of impacted soil were observed:			
Vertical extent:	N/A		Estimated spill volume:
Lateral extent:	N/A		Volume of soil removed:
Is additional investigation required?			
Was groundwater encountered during the investigation?	<input checked="" type="checkbox"/> No      Yes - not impacted or in contact with impacted soils      Yes - groundwater impacted and/or in contact with impacted soils		
Measured depth to groundwater:	Was remedial groundwater removal conducted?      Yes      No		
Date Groundwater was encountered:	Commencement date of removal:		
Sheen on groundwater?	Yes      No		Volume of groundwater removed prior to sampling:
Free product observed?	Yes      No		Volume of groundwater removed post sampling:
Total number of samples collected:	Total Volume of groundwater removed:		
Total number of samples submitted to lab for analysis:			



## **FIGURES**

**Figure 1: Topographic Site Location Map**

**Figure 2: Aerial Site Location Map**

**Figure 3: Soil Analytical Map**

**Figure 4: Polycyclic Aromatic Hydrocarbons Map**

**Figure 5: Metals in Soil Map**

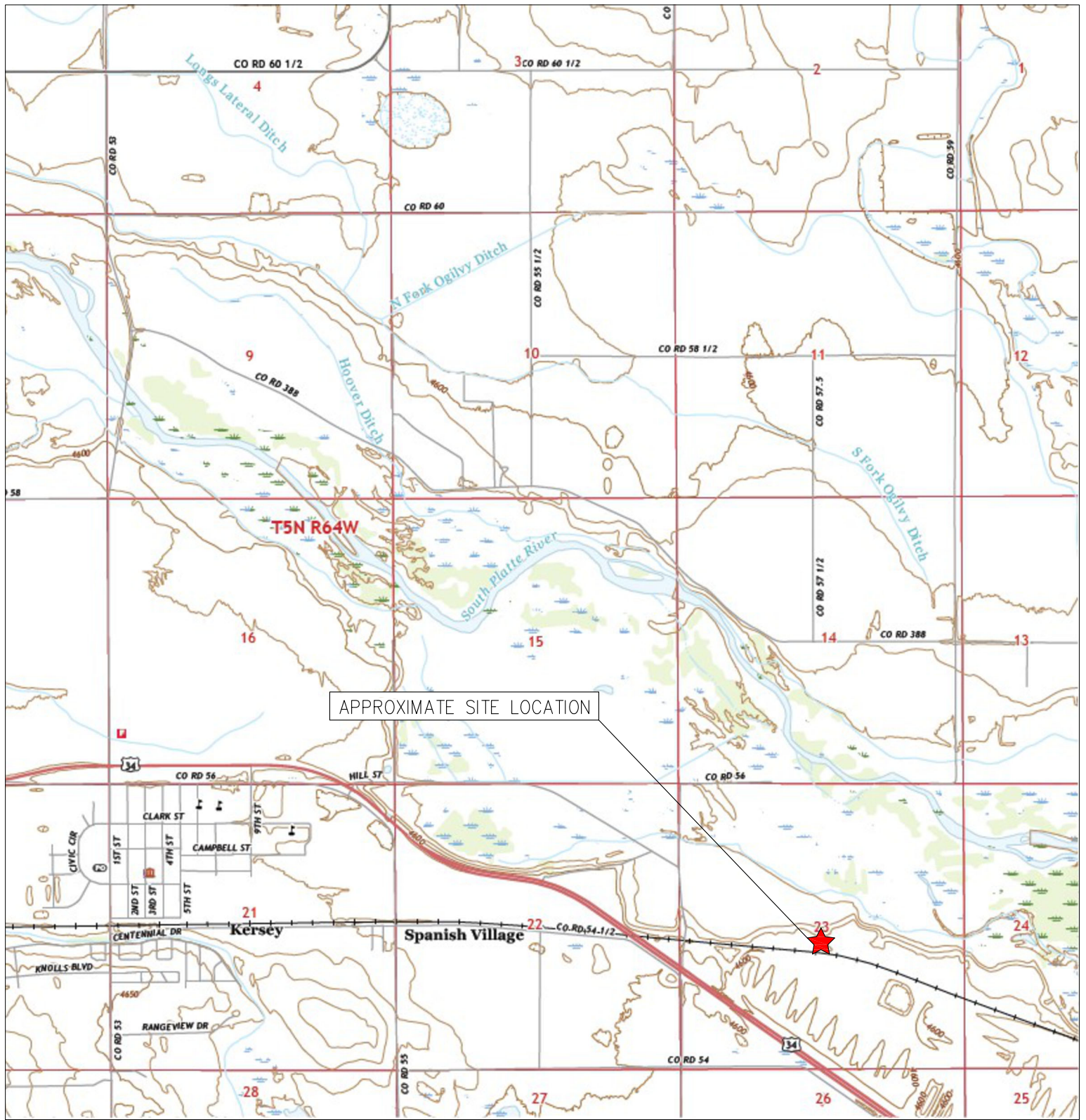

APPROXIMATE SITE LOCATION



TOPOGRAPHIC SITE LOCATION MAP  
 CPC FERGUSON CHEWY UPRC T5N-R64W-S23 L01 TANK BATTERY  
 CLOSURE ASSESSMENT  
 40.383631 / -104.517004  
 NW¼ SE¼ SEC.23 T5N R64W 6PM  
 WELD COUNTY, COLORADO  
 LOCATION ID 450362  
 REMEDIATION # 22142



**EAGLE**  
 ENVIRONMENTAL  
 CONSULTING, LLC

8000 W 44th Ave, Wheat Ridge, CO 80033  
 Ph: 303-433-0479 • F: 303-325-5449

SOURCE: USGS 7.5 MINUTE TOPOGRAPHIC MAP,  
 KLUG RANCH, CO QUADRANGLE 2022

FIGURE NO. 1



**LEGEND**

- FORMER CPC FERGUSON CHEVY UPRC T5N-R64W-S23 L01 TANK BATTERY (DECOMMISSIONED)
- SEPARATOR CONTAINMENT AREA (DECOMMISSIONED)
- WATER VAULTS LOCATION (REMOVED)

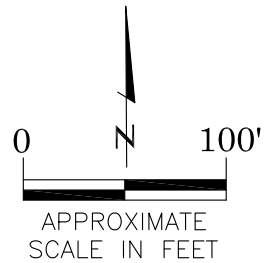

**AERIAL SITE LOCATION MAP**  
 CPC FERGUSON CHEVY UPRC T5N-R64W-S23 L01 TANK BATTERY  
 CLOSURE ASSESSMENT  
 40.383631 / -104.517004  
 NW¼ SE¼ SEC.23 T5N R64W 6PM  
 WELD COUNTY, COLORADO  
 LOCATION ID 450362  
 REMEDIATION # 22142

FIGURE NO.  
2

DRAWN BY:  
GEC



EAGLE

ENVIRONMENTAL  
CONSULTING, LLC

8000 W 44th Ave, Wheat Ridge, CO 80033  
Ph: 303-433-0479 • F: 303-325-5449

**LEGEND**

- INITIAL ASSESSMENT BOUNDARIES
- APPROXIMATE LOCATION OF SOIL SAMPLES FIELD SCREENED, ONLY, WITH PHOTOIONIZATION DETECTOR
- APPROXIMATE LOCATION OF SOIL SAMPLES SUBMITTED FOR LABORATORY ANALYSIS

**PARAMETERS**

SAMPLE LOCATION
DATE
DEPTH (FEET)
B = BENZENE (mg/kg)
T = TOLUENE (mg/kg)
E = ETHYLBENZENE (mg/kg)
X = TOTAL XYLENES (mg/kg)
N = NAPHTHALENE (mg/kg)
G = TPH-GRO (mg/kg)
D = TPH-DRO (mg/kg)
R = TPH-RRO (mg/kg)
1,2,4-TMB = 1,2,4 TRIMETHYLBENZENE (mg/kg)
1,3,5-TMB = 1,3,5 TRIMETHYLBENZENE (mg/kg)
Brn= BORON (mg/L)
EC = SPECIFIC CONDUCTANCE (mmhos/cm)
SAR= SODIUM ADSORPTION RATIO
pH = pH (pH UNITS)

mg/kg = MILLIGRAMS PER KILOGRAM  
 mg/L = MILLIGRAMS PER LITER  
 mmhos/cm = MILLIMHOS PER CENTIMETER

(BRL) = ALL VALUES BELOW REGULATORY LIMITS

TPH-GRO = TOTAL PETROLEUM HYDROCARBONS - GASOLINE RANGE ORGANICS  
 TPH-DRO = TOTAL PETROLEUM HYDROCARBONS - DIESEL RANGE ORGANICS  
 TPH-RRO = TOTAL PETROLEUM HYDROCARBONS - RESIDUAL RANGE ORGANICS

NOTES:  
 VALUES PRESENTED WITH A LESS THAN SYMBOL (<) DID NOT CONTAIN CONCENTRATIONS AT OR ABOVE LABORATORY DETECTION LIMITS

VALUES PRESENTED IN **BOLD** ARE OUTSIDE ECOM TABLE 915-1 REGULATORY RANGE

ECMC = ENERGY & CARBON MANAGEMENT COMMISSION

SOIL ANALYTICAL MAP  
 CPC FERGUSON CHEWY UPRC  
 T5N-R64W-S23 L01 TANK BATTERY  
 CLOSURE ASSESSMENT  
 40.383631 / -104.517004  
 NW¼ SE¼ SEC.23 T5N R64W 6PM  
 WELD COUNTY, COLORADO  
 LOCATION ID 450362  
 REMEDIATION # 22142

FIGURE NO.  
3

DRAWN BY:  
GEC



**EAGLE**  
 ENVIRONMENTAL  
 CONSULTING, LLC  
 8000 W 44th Ave, Wheat Ridge, CO 80033  
 Ph: 303-433-0479 • F: 303-325-5449

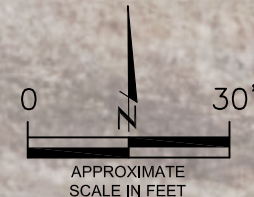
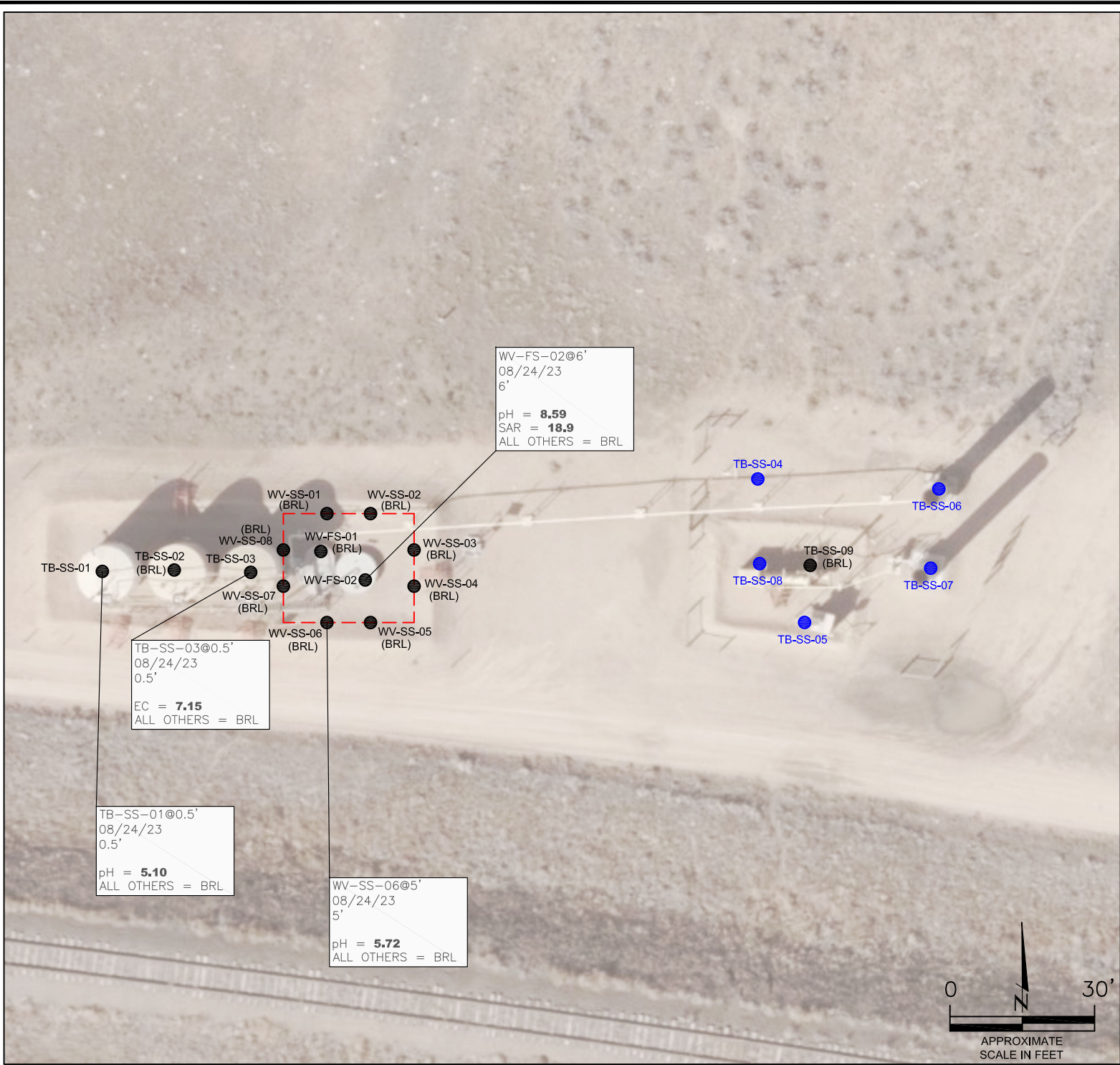

WV-SS-08@5'  
08/24/23  
5'

1-Methylnaphthalene = **0.016\***  
2-Methylnaphthalene = **0.031\***  
Acenaphthene = <0.020  
Anthracene = <0.020  
Benzo(a)anthracene = <0.005  
Benzo(a)pyrene = <0.020  
Benzo(b)fluoranthene = <0.020  
Benzo(k)fluoranthene = <0.020  
Chrysene = <0.020  
Dibenzo(a,h)anthracene = <0.020  
Fluoranthene = <0.020  
Fluorene = <0.020  
Indeno(1,2,3-CD)pyrene = <0.020  
Pyrene = <0.020

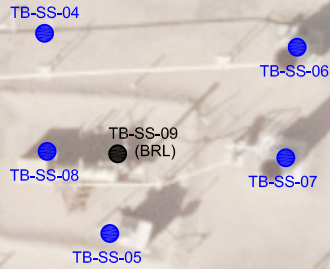
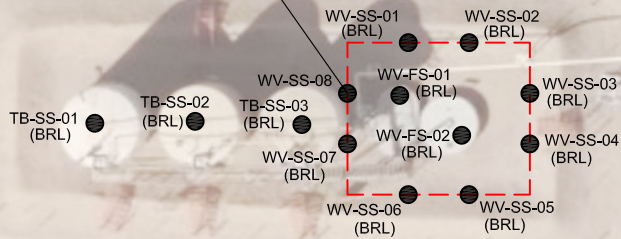

**LEGEND**

- - - INITIAL ASSESSMENT BOUNDARIES
- SS-02 APPROXIMATE LOCATION OF SOIL SAMPLES FIELD SCREENED, ONLY, WITH PHOTOIONIZATION DETECTOR
- SS-02 APPROXIMATE LOCATION OF SOIL SAMPLES SUBMITTED FOR LABORATORY ANALYSIS

**PARAMETERS**

SAMPLE LOCATION  
DATE SAMPLE COLLECTED  
APPROXIMATE DEPTH

POLYCYCLIC AROMATIC HYDROCARBONS (PAHs) (mg/kg)

mg/kg = MILLIGRAMS PER KILOGRAM

**NOTES:**

VALUES PRESENTED WITH A LESS THAN SYMBOL (<) DID NOT CONTAIN CONCENTRATIONS AT OR ABOVE LABORATORY DETECTION LIMITS

VALUES PRESENTED IN **BOLD** EXCEED ECMC TABLE 915-1 REGULATORY LIMITS

VALUES PRESENTED WITH AN ASTERISK (\*) EXCEED ECMC TABLE 915-1 GROUNDWATER SOIL SCREENING LEVELS, ONLY.

ECMC = ENERGY & CARBON MANAGEMENT COMMISSION

**POLYCYCLIC AROMATIC HYDROCARBONS MAP**

CPC FERGUSON CHEWY UPRC  
T5N-R64W-S23 L01 TANK BATTERY  
CLOSURE ASSESSMENT  
40.383631 / -104.517004  
NW¼ SE¼ SEC.23 T5N R64W 6PM  
WELD COUNTY, COLORADO  
LOCATION ID 450362  
REMEDATION # 22142

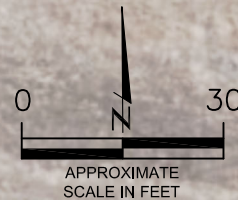

FIGURE NO.  
4

DRAWN BY:  
GEC



**EAGLE**  
ENVIRONMENTAL  
CONSULTING, LLC  
8000 W 44th Ave, Wheat Ridge, CO 80033  
Ph: 303-433-0479 • F: 303-325-5449

**LEGEND**

- INITIAL ASSESSMENT BOUNDARIES
- APPROXIMATE LOCATION OF SOIL SAMPLES FIELD SCREENED, ONLY, WITH PHOTOIONIZATION DETECTOR
- APPROXIMATE LOCATION OF SOIL SAMPLES SUBMITTED FOR LABORATORY ANALYSIS

**PARAMETERS**

SAMPLE LOCATION	DATE SAMPLE COLLECTED	APPROXIMATE DEPTH
Arsenic =	(mg/kg)	
Barium =	(mg/kg)	
Cadmium =	(mg/kg)	
Chromium (VI) =	(mg/kg)	
Copper =	(mg/kg)	
Lead =	(mg/kg)	
Nickel =	(mg/kg)	
Selenium =	(mg/kg)	
Silver =	(mg/kg)	
Zinc =	(mg/kg)	

mg/kg = MILLIGRAMS PER KILOGRAM

(NS) – NOT SAMPLED

**NOTES:**  
 VALUES PRESENTED WITH A LESS THAN SYMBOL (<) DID NOT CONTAIN CONCENTRATIONS AT/OR ABOVE LABORATORY REPORTING LIMITS AND/OR MINIMUM DETECTION LIMITS.

VALUES PRESENTED IN **BOLD** EXCEED ECMC TABLE 915-1 REGULATORY LIMITS.

\*VALUES EXCEED ECMC TABLE 915-1 PROTECTION OF GROUNDWATER SOIL SCREENING LEVELS, ONLY.

\*\*ACHIEVABLE PRACTICAL QUANTITATIVE LIMITS FOR HEXAVALENT CHROMIUM (Cr VI) IN SOILS IS IN THE RANGE OF 0.1 TO 1 mg/kg.

\*\*\*ARSENIC IS NATURALLY OCCURRING IN COLORADO.

ECMC = ENERGY & CARBON MANAGEMENT COMMISSION

WV-SS-08@5'  
 08/24/23  
 5'

Arsenic = **1.71\*\*\***  
 Barium = 49.3  
 Cadmium = 0.0880  
 Chromium (VI) = <0.244\*\*  
 Copper = <8.80  
 Lead = <8.80  
 Nickel = <8.80  
 Selenium = <0.0880  
 Silver = <0.0880  
 Zinc = <88.0

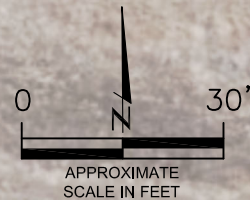
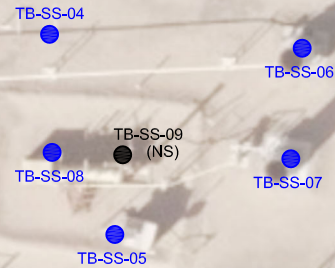
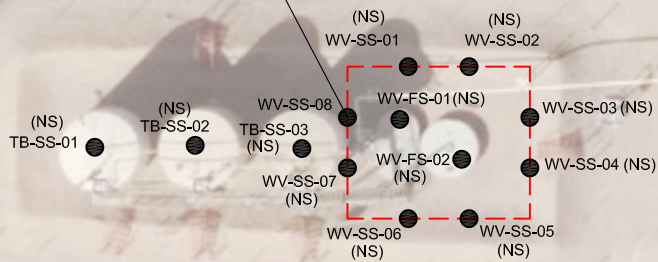

**METALS IN SOIL MAP**  
 CPC FERGUSON CHEWY UPRC T5N-R64W-S23 L01  
 TANK BATTERY  
 CLOSURE ASSESSMENT  
 40.383631 / -104.517004  
 NW¼ SE¼ SEC.23 T5N R64W 6PM  
 WELD COUNTY, COLORADO  
 LOCATION ID 450362  
 REMEDIATION # 22142

FIGURE NO.  
5

DRAWN BY:  
GEC



**EAGLE ENVIRONMENTAL CONSULTING, LLC**  
 8000 W 44th Ave, Wheat Ridge, CO 80033  
 Ph: 303-433-0479 • F: 303-325-5449



## **TABLES**

**Table 1: Photoionization Detector Reading Summary**

**Table 2: Soil Analytical Results Summary**

**TABLE 1**  
**PHOTOIONIZATION DETECTOR READING SUMMARY**  
**CPC FERGUSON CHEWY UPRC T5N-R64W-S23 L01**  
**CLOSURE ASSESSMENT**  
**40.383631 / -104.517004**  
**NW¼ SE¼ SEC.23 T5N R64W 6PM**  
**WELD COUNTY, COLORADO**  
**LOCATION ID 450362**  
**REM. # 22142**

Sample Location (Latitude/Longitude)	Date	Approximate Depth (feet)	PID Reading (ppm-v)	Lab Submission (Y/N)
WV-SS-01 @ 5' (40.383679 / -104.517034)	08/24/23	5	1.1	Y
WV-SS-02 @ 5' (40.383678 / -104.517007)	08/24/23	5	0.2	Y
WV-SS-03 @ 5' (40.383667 / -104.516984)	08/24/23	5	0.3	Y
WV-SS-04 @ 5' (40.383653 / -104.516981)	08/24/23	5	0.1	Y
WV-SS-05 @ 5' (40.383640 / -104.516999)	08/24/23	5	0.2	Y
WV-SS-06 @ 5' (40.383638 / -104.517037)	08/24/23	5	0.3	Y
WV-SS-07 @ 5' (40.383654 / -104.517046)	08/24/23	5	0.6	Y
WV-SS-08 @ 5' (40.383666 / -104.517052)	08/24/23	5	151.4	Y
WV-FS-01 @ 6' (40.383660 / -104.517036)	08/24/23	6	6.8	Y
WV-FS-02 @ 6' (40.383658 / -104.517010)	08/24/23	6	0.2	Y
TB-SS-01 @ 0.5' (40.383661 / -104.517172)	08/24/23	0.5	0.4	Y
TB-SS-02 @ 0.5' (40.383661 / -104.517116)	08/24/23	0.5	0.2	Y
TB-SS-03 @ 0.5' (40.383663 / -104.517062)	08/24/23	0.5	1.7	Y
TB-SS-04 @ 0.5' (40.383718 / -104.516702)	08/24/23	0.5	4.9	N
TB-SS-05 @ 0.5' (40.383625 / -104.516644)	08/24/23	0.5	3.8	N
TB-SS-06 @ 0.5' (40.383705 / -104.516574)	08/24/23	0.5	0.5	N
TB-SS-07 @ 0.5' (40.383657 / -104.516584)	08/24/23	0.5	0.2	N
TB-SS-08 @ 3' (40.383656 / -104.516715)	08/24/23	3	2.3	N
TB-SS-09 @ 3' (40.383654 / -104.516663)	08/24/23	3	11.9	Y
(Y/N) = Yes or No ppm-v = parts per million by volume PID = Photoionization Detector				



TABLE 2  
SOIL ANALYTICAL MAP  
CPC FERGUSON CHEWY UPRC T5N-R64W-S23 L01  
CLOSURE ASSESSMENT  
40.383631 / -104.517004  
NW¼ SE¼ SEC.23 T5N R64W 6PM  
WELD COUNTY, COLORADO  
LOCATION ID 450362  
REM. # 22142

Sample Location (Latitude / Longitude)	WV-SS-01 @ 5'	WV-SS-02 @ 5'	WV-SS-03 @ 5'	WV-SS-04 @ 5'	WV-SS-05 @ 5'
(40.383679 / -104.517034)	(40.383678 / -104.517007)	(40.383667 / -104.516984)	(40.383653 / -104.516981)	(40.383640 / -104.516999)	
Sample Date	8/24/2023	8/24/2023	8/24/2023	8/24/2023	8/24/2023
Sample Depth	5'	5'	5'	5'	5'
PID Reading (ppm-v)	1.1	0.2	0.3	0.1	0.2
Regulatory Limits					
Chemical of Concern	Units	ECMC Table 915-1 RSSLs	ECMC Table 915-1 GSSLs		
<b>VOCs</b>					
Benzene	mg/kg	1.2	0.0026	<0.00200	<0.00200
Toluene	mg/kg	490	0.69	<0.00200	<0.00200
Ethylbenzene	mg/kg	5.8	0.78	<0.00200	<0.00200
Total Xylenes	mg/kg	58	9.9	<0.00200	<0.00200
Naphthalene	mg/kg	2	0.0038	<0.00380	<0.00380
1,2,4-Trimethylbenzene	mg/kg	30	0.0081	<0.00200	<0.00200
1,3,5-Trimethylbenzene	mg/kg	27	0.0087	<0.00200	<0.00200
<b>TOTAL PETROLEUM HYDROCARBONS</b>					
TPH-GRO	mg/kg	500	--	<0.200	<0.200
TPH-DRO	mg/kg	500	--	<25.0	<25.0
TPH-RRO	mg/kg	500	--	<100	<100
<b>POLYCYCLIC AROMATIC HYDROCARBONS</b>					
1-Methyl-naphthalene	mg/kg	18	0.006	<0.002	<0.002
2-Methyl-naphthalene	mg/kg	24	0.019	<0.002	<0.002
Acenaphthene	mg/kg	360	0.55	<0.020	<0.020
Anthracene	mg/kg	1800	5.8	<0.020	<0.020
Benzo(a)-anthracene	mg/kg	1.1	0.011	<0.005	<0.005
Benzo(a)-pyrene	mg/kg	0.11	0.24	<0.020	<0.020
Benzo(b)-fluoranthene	mg/kg	1.1	0.3	<0.020	<0.020
Benzo(k)-fluoranthene	mg/kg	11	2.9	<0.020	<0.020
Chrysene	mg/kg	110	9	<0.020	<0.020
Dibenzo(a,h)-anthracene	mg/kg	0.11	0.096	<0.020	<0.020
Fluoranthene	mg/kg	240	8.9	<0.020	<0.020
Fluorene	mg/kg	240	0.54	<0.020	<0.020
Indeno(1,2,3-cd)-pyrene	mg/kg	1.1	0.98	<0.020	<0.020
Pyrene	mg/kg	180	1.3	<0.020	<0.020
<b>SOIL SUITABILITY (Inorganics)</b>					
Boron	mg/L	2	--	<0.0987	<0.100
pH	standard unit	6-8.3	--	6.76	7.56
Sodium Adsorption Ratio (SAR)	--	<6	--	0.306	0.368
Specific Conductance (EC)	mmhos/cm	<4	--	0.104	0.115
<b>METALS</b>					
Arsenic	mg/kg	0.68***	0.29***	NA	NA
Barium	mg/kg	15000	82	NA	NA
Cadmium	mg/kg	71	0.38	NA	NA
Copper	mg/kg	3100	46	NA	NA
Lead	mg/kg	400	14	NA	NA
Nickel	mg/kg	1500	26	NA	NA
Selenium	mg/kg	390	0.26	NA	NA
Silver	mg/kg	390	0.8	NA	NA
Zinc	mg/kg	23000	370	NA	NA
Hexavalent Chromium	mg/kg	0.3**	0.00067**	NA	NA
ECMC = Energy & Carbon Management Commission mg/kg = milligrams per kilogram mmhos/cm = millimhos per centimeter PID = Photoionization Detector ppm-v = parts per million by volume mg/L = milligrams per liter SAR = Sodium Adsorption Ratio Notes: Values presented with a less than symbol (<) did not contain concentrations at or above the laboratory reporting limit and/or minimum detection limit. Values presented in <b>BOLD</b> exceed ECMC Table 915-1 Regulatory Limits. Values presented with asterisk (*) exceed ECMC Table 915-1 GSSLs, only. **Achievable practical quantitative limits for Hexavalent Chromium in soils is in the range of 0.1 to 1 mg/kg. ***Arsenic is naturally occurring in Colorado.					

TABLE 2  
SOIL ANALYTICAL MAP  
CPC FERGUSON CHEWY UPRC TSN-R64W-S23 L01  
CLOSURE ASSESSMENT  
40.383631 / -104.517004  
NW¼ SE¼ SEC.23 T5N R64W 6PM  
WELD COUNTY, COLORADO  
LOCATION ID 450362  
REM. # 22142

Sample Location (Latitude / Longitude)		WV-SS-06 @ 5'	WV-SS-07 @ 5'	WV-SS-08 @ 5'	WV-FS-01 @ 6'	WV-FS-02 @ 6'
		(40.383638 / -104.517037)	(40.383654 / -104.517046)	(40.383666 / -104.517052)	(40.383660 / -104.517036)	(40.383658 / -104.517010)
Sample Date		8/24/2023	8/24/2023	8/24/2023	8/24/2023	8/24/2023
Sample Depth		5'	5'	5'	6'	6'
PID Reading (ppm-v)		0.3	0.6	151.4	6.8	0.2
Regulatory Limits						
Chemical of Concern	Units	ECMC Table 915-1 RSSLs	ECMC Table 915-1 GSSLs			
<b>VOCs</b>						
Benzene	mg/kg	1.2	0.0026	<0.00200	<0.00200	<0.00200
Toluene	mg/kg	490	0.69	<0.00200	<0.00200	0.00458
Ethylbenzene	mg/kg	5.8	0.78	<0.00200	<0.00200	0.00520
Total Xylenes	mg/kg	58	9.9	<0.00200	<0.00200	0.00954
Naphthalene	mg/kg	2	0.0038	<0.00380	<0.00380	<0.00380
1,2,4-Trimethylbenzene	mg/kg	30	0.0081	<0.00200	<0.00200	0.00660
1,3,5-Trimethylbenzene	mg/kg	27	0.0087	<0.00200	<0.00200	0.00308
<b>TOTAL PETROLEUM HYDROCARBONS</b>						
TPH-GRO	mg/kg	500	--	<0.200	<0.200	1.49
TPH-DRO	mg/kg	500	--	<25.0	<25.0	0.471
TPH-RRO	mg/kg	500	--	<100	<100	<25.0
<b>POLYCYCLIC AROMATIC HYDROCARBONS</b>						
1-Methyl-naphthalene	mg/kg	18	0.006	<0.002	<0.002	<b>0.016*</b>
2-Methyl-naphthalene	mg/kg	24	0.019	<0.002	<0.002	<b>0.031*</b>
Acenaphthene	mg/kg	360	0.55	<0.020	<0.020	<0.020
Anthracene	mg/kg	1800	5.8	<0.020	<0.020	<0.020
Benzo(a)-anthracene	mg/kg	1.1	0.011	<0.005	<0.005	<0.005
Benzo(a)-pyrene	mg/kg	0.11	0.24	<0.020	<0.020	<0.020
Benzo(b)-fluoranthene	mg/kg	1.1	0.3	<0.020	<0.020	<0.020
Benzo(k)-fluoranthene	mg/kg	11	2.9	<0.020	<0.020	<0.020
Chrysene	mg/kg	110	9	<0.020	<0.020	<0.020
Dibenzo(a,h)-anthracene	mg/kg	0.11	0.096	<0.020	<0.020	<0.020
Fluoranthene	mg/kg	240	8.9	<0.020	<0.020	<0.020
Fluorene	mg/kg	240	0.54	<0.020	<0.020	<0.020
Indeno(1,2,3-cd)-pyrene	mg/kg	1.1	0.98	<0.020	<0.020	<0.020
Pyrene	mg/kg	180	1.3	<0.020	<0.020	<0.020
<b>SOIL SUITABILITY (Inorganics)</b>						
Boron	mg/L	2	--	<0.0992	<0.0987	<0.0995
pH	standard unit	6-8.3	--	<b>5.72</b>	8.21	7.45
Sodium Adsorption Ratio (SAR)	--	<6	--	0.225	0.343	0.197
Specific Conductance (EC)	mmhos/cm	<4	--	0.222	0.430	0.223
<b>METALS</b>						
Arsenic	mg/kg	0.68***	0.29***	NA	NA	<b>1.71***</b>
Barium	mg/kg	15000	82	NA	NA	49.3
Cadmium	mg/kg	71	0.38	NA	NA	0.0880
Copper	mg/kg	3100	46	NA	NA	<8.80
Lead	mg/kg	400	14	NA	NA	<8.80
Nickel	mg/kg	1500	26	NA	NA	<8.80
Selenium	mg/kg	390	0.26	NA	NA	<0.0880
Silver	mg/kg	390	0.8	NA	NA	<0.0880
Zinc	mg/kg	23000	370	NA	NA	<88.0
Hexavalent Chromium	mg/kg	0.3**	0.00067**	NA	NA	<0.244**
ECMC = Energy & Carbon Management Commission mg/kg = milligrams per kilogram mmhos/cm = millimhos per centimeter PID = Photoionization Detector ppm-v = parts per million by volume mg/L = milligrams per liter SAR = Sodium Adsorption Ratio Notes: Values presented with a less than symbol (<) did not contain concentrations at or above the laboratory reporting limit and/or minimum detection limit. Values presented in <b>BOLD</b> exceed ECMC Table 915-1 Regulatory Limits. Values presented with asterisk (*) exceed ECMC Table 915-1 GSSLs, only. **Achievable practical quantitative limits for Hexavalent Chromium in soils is in the range of 0.1 to 1 mg/kg. ***Arsenic is naturally occurring in Colorado.						

TABLE 2  
SOIL ANALYTICAL MAP  
CPC FERGUSON CHEWY UPRC TSN-R64W-S23 L01  
CLOSURE ASSESSMENT  
40.383631 / -104.517004  
NW¼ SE¼ SEC.23 T5N R64W 6PM  
WELD COUNTY, COLORADO  
LOCATION ID 450362  
REM. # 22142

Sample Location (Latitude / Longitude)		TB-SS-01 @ 0.5' (40.383661 / -104.517172)		TB-SS-02 @ 0.5' (40.383661 / -104.517116)		TB-SS-03 @ 0.5' (40.383663 / -104.517062)		TB-SS-09 @ 3' (40.383654 / -104.516663)	
Sample Date		8/24/2023		8/24/2023		8/24/2023		8/24/2023	
Sample Depth		0.5'		0.5'		0.5'		3'	
PID Reading (ppm-v)		0.4		0.2		1.7		11.9	
Regulatory Limits									
Chemical of Concern	Units	ECMC Table 915-1 RSSLs	ECMC Table 915-1 GSSLs						
VOCs									
Benzene	mg/kg	1.2	0.0026	<0.00200	<0.00200	<0.00200	<0.00200	<0.00200	<0.00200
Toluene	mg/kg	490	0.69	<0.00200	<0.00200	<0.00200	<0.00200	<0.00200	<0.00200
Ethylbenzene	mg/kg	5.8	0.78	<0.00200	<0.00200	<0.00200	<0.00200	<0.00200	<0.00200
Total Xylenes	mg/kg	58	9.9	<0.00200	<0.00200	<0.00200	<0.00200	<0.00200	<0.00200
Naphthalene	mg/kg	2	0.0038	<0.00380	<0.00380	<0.00380	<0.00380	<0.00380	<0.00380
1,2,4-Trimethylbenzene	mg/kg	30	0.0081	<0.00200	<0.00200	<0.00200	<0.00200	<0.00200	<0.00200
1,3,5-Trimethylbenzene	mg/kg	27	0.0087	<0.00200	<0.00200	<0.00200	<0.00200	<0.00200	<0.00200
TOTAL PETROLEUM HYDROCARBONS									
TPH-GRO	mg/kg	500	--	<0.200	<0.200	<0.200	<0.200	<0.200	<0.200
TPH-DRO	mg/kg	500	--	<25.0	<25.0	<25.0	<25.0	<25.0	<25.0
TPH-RRO	mg/kg	500	--	<100	<100	<100	<100	<100	<100
POLYCYCLIC AROMATIC HYDROCARBONS									
1-Methyl-naphthalene	mg/kg	18	0.006	<0.002	<0.002	<0.002	<0.002	<0.002	<0.002
2-Methyl-naphthalene	mg/kg	24	0.019	<0.002	<0.002	<0.002	<0.002	<0.002	<0.002
Acenaphthene	mg/kg	360	0.55	<0.020	<0.020	<0.020	<0.020	<0.020	<0.020
Anthracene	mg/kg	1800	5.8	<0.020	<0.020	<0.020	<0.020	<0.020	<0.020
Benzo(a)-anthracene	mg/kg	1.1	0.011	<0.005	<0.005	<0.005	<0.005	<0.005	<0.005
Benzo(a)-pyrene	mg/kg	0.11	0.24	<0.020	<0.020	<0.020	<0.020	<0.020	<0.020
Benzo(b)-fluoranthene	mg/kg	1.1	0.3	<0.020	<0.020	<0.020	<0.020	<0.020	<0.020
Benzo(k)-fluoranthene	mg/kg	11	2.9	<0.020	<0.020	<0.020	<0.020	<0.020	<0.020
Chrysene	mg/kg	110	9	<0.020	<0.020	<0.020	<0.020	<0.020	<0.020
Dibenzo(a,h)-anthracene	mg/kg	0.11	0.096	<0.020	<0.020	<0.020	<0.020	<0.020	<0.020
Fluoranthene	mg/kg	240	8.9	<0.020	<0.020	<0.020	<0.020	<0.020	<0.020
Fluorene	mg/kg	240	0.54	<0.020	<0.020	<0.020	<0.020	<0.020	<0.020
Indeno(1,2,3-cd)-pyrene	mg/kg	1.1	0.98	<0.020	<0.020	<0.020	<0.020	<0.020	<0.020
Pyrene	mg/kg	180	1.3	<0.020	<0.020	<0.020	<0.020	<0.020	<0.020
SOIL SUITABILITY (Inorganics)									
Boron	mg/L	2	--	<0.0996	0.140	0.281	0.281	0.281	<0.102
pH	standard unit	6-8.3	--	5.10	8.03	7.65	7.65	7.65	6.18
Sodium Adsorption Ratio (SAR)	--	<6	--	0.288	0.466	1.24	1.24	1.24	0.216
Specific Conductance (EC)	mmhos/cm	<4	--	0.096	0.575	7.15	7.15	7.15	0.099
METALS									
Arsenic	mg/kg	0.68***	0.29***	NA	NA	NA	NA	NA	NA
Barium	mg/kg	15000	82	NA	NA	NA	NA	NA	NA
Cadmium	mg/kg	71	0.38	NA	NA	NA	NA	NA	NA
Copper	mg/kg	3100	46	NA	NA	NA	NA	NA	NA
Lead	mg/kg	400	14	NA	NA	NA	NA	NA	NA
Nickel	mg/kg	1500	26	NA	NA	NA	NA	NA	NA
Selenium	mg/kg	390	0.26	NA	NA	NA	NA	NA	NA
Silver	mg/kg	390	0.8	NA	NA	NA	NA	NA	NA
Zinc	mg/kg	23000	370	NA	NA	NA	NA	NA	NA
Hexavalent Chromium	mg/kg	0.3**	0.00067**	NA	NA	NA	NA	NA	NA
ECMC = Energy & Carbon Management Commission		NA - Not Analyzed		VOCs - Volatile Organic Compounds					
mg/kg = milligrams per kilogram									
mmhos/cm = millimhos per centimeter				RSSLs = Residential Soil Screening Levels					
PID = Photoionization Detector				GSSLs = Protection of Groundwater Soil Screening Levels					
ppm-v = parts per million by volume				TPH-GRO = Total Petroleum Hydrocarbons - Gasoline Range Organics					
mg/L = milligrams per liter				TPH-DRO = Total Petroleum Hydrocarbons - Diesel Range Organics					
SAR = Sodium Adsorption Ratio				TPH-RRO = Total Petroleum Hydrocarbons - Residual Range Organics					
Notes:									
Values presented with a less than symbol (<) did not contain concentrations at or above the laboratory reporting limit and/or minimum detection limit.									
Values presented in <b>BOLD</b> exceed ECMC Table 915-1 Regulatory Limits. Values presented with asterisk (*) exceed ECMC Table 915-1 GSSLs, only.									
**Achievable practical quantitative limits for Hexavalent Chromium in soils is in the range of 0.1 to 1 mg/kg.									
***Arsenic is naturally occurring in Colorado.									



## **ATTACHMENT A**

### **Photo Log**

CPC Ferguson Chewy UPRC  
T5N-R64W-S23 L01 Tank Battery  
Location ID 450362  
Remediation # 22142

Closure Assessment

August 2023



# Water Vault Excavation – 08/24/23

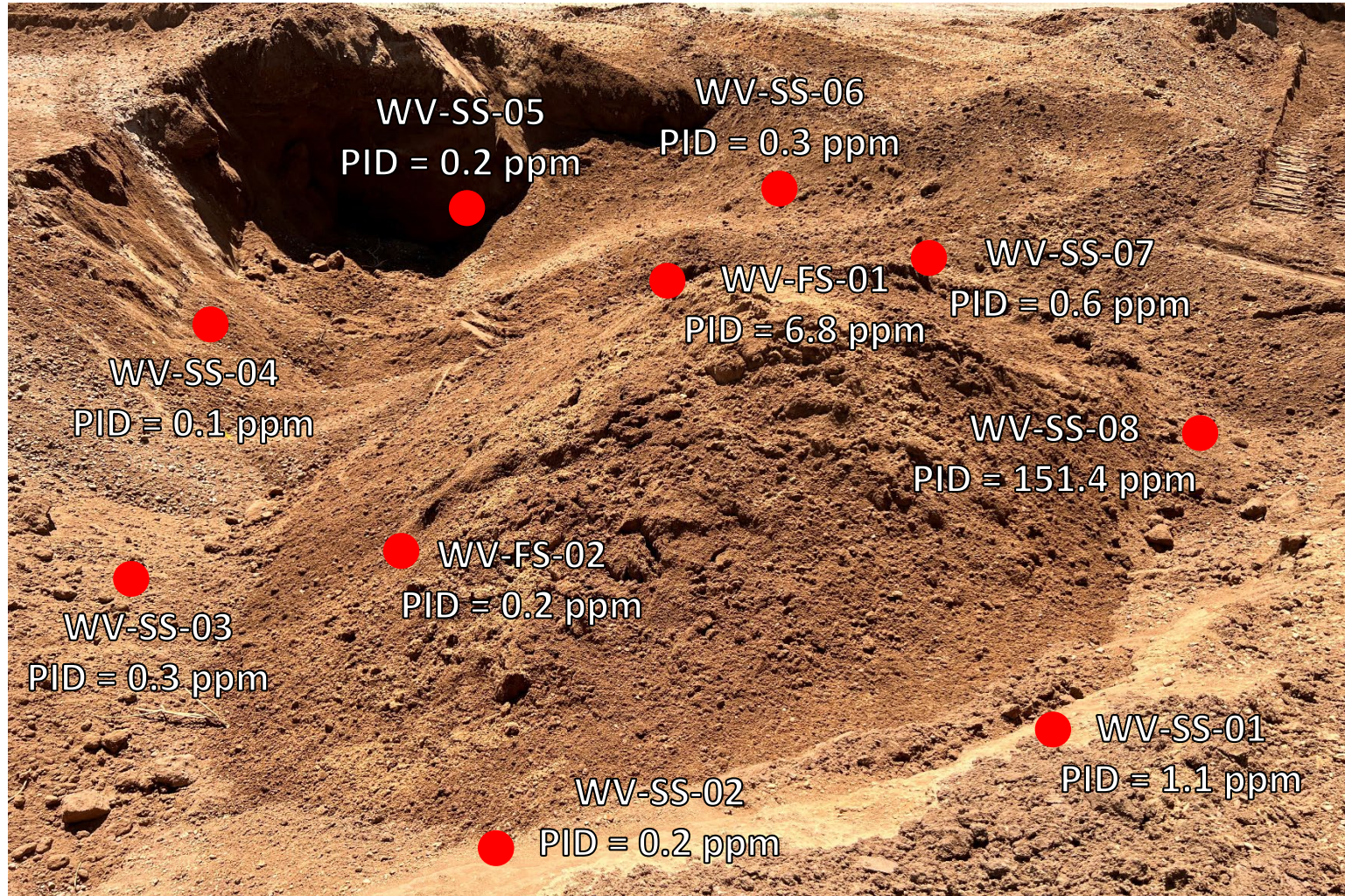

Looking south-southwest

No petroleum hydrocarbon staining observed. Slight petroleum hydrocarbon odor observed northern segment of western sidewall

# Tank Battery Decommissioning – 08/24/23



● TB-SS-03  
PID = 1.7 ppm

● TB-SS-02  
PID = 0.2 ppm

● TB-SS-01  
PID = 0.4 ppm

Looking east at former production tank footprints

No petroleum hydrocarbon staining or odor observed



● TB-SS-04  
PID = 4.9 ppm

Looking west at former meter house connection

No petroleum hydrocarbon staining or odor observed

# Tank Battery Decommissioning – 08/24/23



Looking south at former meter house connection

No petroleum hydrocarbon staining or odor observed

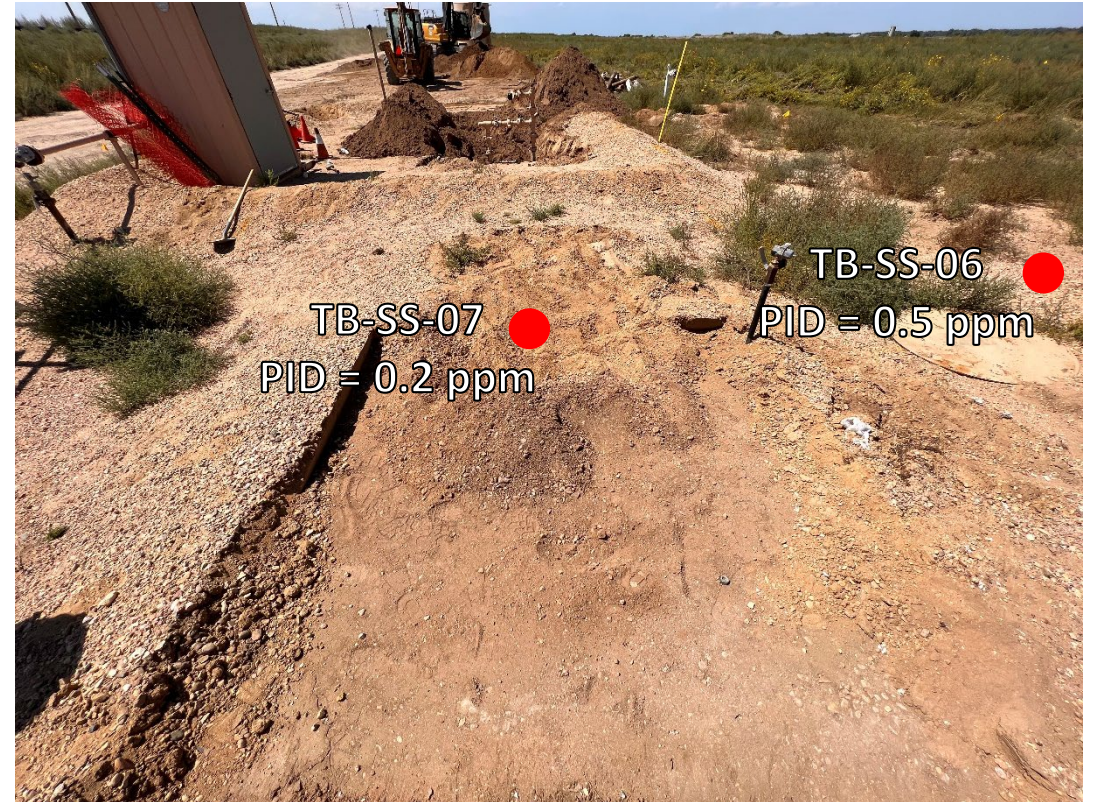

Looking west at former VOC burner footprints

No petroleum hydrocarbon staining or odor observed

# Tank Battery Decommissioning – 08/24/23



Looking east at former dump line to separator connection

No petroleum hydrocarbon staining or odor observed



Looking west at former flowline to separator connection

No petroleum hydrocarbon staining or odor observed



## **ATTACHMENT B**

### **Laboratory Analytical Report**

September 18, 2023

Eagle Environmental Consulting, LLC

Martin C Eckert III

8000 W 44th Ave

Wheat Ridge CO 80033

**Project Name - Noble - CPC Ferguson Chewy  
UPRC T5N-R64W-S23L01 TB**

**Project Number - [none]**

Attached are your analytical results for Noble - CPC Ferguson Chewy UPRC T5N-R64W-S23L01 TB received by Origins Laboratory, Inc. August 24, 2023. This project is associated with Origins project number Y308654-01.

The analytical results in the following report were analyzed under the guidelines of EPA Methods. These methods are identified as follows; "SW" are defined in SW-846, "EPA" are defined in 40CFR part 136 and "SM" are defined in the most current revision of Standard Methods For the Examination of Water and Wastewater.

The analytical results apply specifically to the samples and analyses specified per the attached Chain of Custody. As such, this report shall not be reproduced except in full, without the written approval of Origin's laboratory.

Unless otherwise noted, the analytical results for all soil samples are reported on a wet weight basis. All analytical analyses were performed under NELAP guidelines unless noted by a data qualifier.

Any holding time exceedances, deviations from the method specifications or deviations from Origins Laboratory's Standard Operating Procedures are outlined in the case narrative.

Thank you for selecting Origins for your analytical needs. Please contact us with any questions concerning this report, or if we can help with anything at all.

Origins Laboratory, Inc.  
303.433.1322  
o-squad@oelabinc.com



Eagle Environmental Consulting, LLC  
 8000 W 44th Ave  
 Wheat Ridge CO 80033

Martin C Eckert III  
 Project Number: [none]  
 Project: Noble - CPC Ferguson Chewy UPRC  
 T5N-R64W-S23L01 TB

CROSS REFERENCE REPORT

Sample ID	Laboratory ID	Matrix	Date Sampled	Date Received
TB-SS-01@0.5'	Y308654-01	Soil	August 24, 2023 10:15	08/24/2023 16:06
TB-SS-02@0.5'	Y308654-02	Soil	August 24, 2023 10:17	08/24/2023 16:06
TB-SS-03@0.5'	Y308654-03	Soil	August 24, 2023 10:19	08/24/2023 16:06
TB-SS-09@3'	Y308654-04	Soil	August 24, 2023 13:22	08/24/2023 16:06
WV-SS-01@5'	Y308654-05	Soil	August 24, 2023 12:50	08/24/2023 16:06
WV-SS-02@5'	Y308654-06	Soil	August 24, 2023 12:52	08/24/2023 16:06
WV-SS-03@5'	Y308654-07	Soil	August 24, 2023 12:54	08/24/2023 16:06
WV-SS-04@5'	Y308654-08	Soil	August 24, 2023 12:56	08/24/2023 16:06
WV-SS-05@5'	Y308654-09	Soil	August 24, 2023 12:58	08/24/2023 16:06
WV-SS-06@5'	Y308654-10	Soil	August 24, 2023 13:00	08/24/2023 16:06
WV-SS-07@5'	Y308654-11	Soil	August 24, 2023 13:02	08/24/2023 16:06
WV-SS-08@5'	Y308654-12	Soil	August 24, 2023 13:04	08/24/2023 16:06
WV-FS-01@6'	Y308654-13	Soil	August 24, 2023 13:06	08/24/2023 16:06
WV-FS-02@6'	Y308654-14	Soil	August 24, 2023 13:08	08/24/2023 16:06

Origins Laboratory, Inc.



Jen Pellegrini For Jordan A. Bynon, Project Manager

*The results in this report apply to the samples analyzed in accordance with the chain of custody document. This analytical report must be reproduced in its entirety.*

---

Eagle Environmental Consulting, LLC

8000 W 44th Ave

Wheat Ridge CO 80033

Martin C Eckert III

Project Number: [none]

Project: Noble - CPC Ferguson Chewy UPRC  
T5N-R64W-S23L01 TB

---

Chain of Custody Modification Request

On 9/7/2023, Grace Congdon from Eagle Environmental contacted Jordan Bynon via email regarding Y308654 requesting that Table 915 Metals be added to WV-SS-08@5'. Requested modifications to the chain of custody were made by Jordan Bynon on 9/7/2023.

Origins Laboratory, Inc.



Jen Pellegrini For Jordan A. Bynon, Project Manager

*The results in this report apply to the samples analyzed in accordance with the chain of custody document. This analytical report must be reproduced in its entirety.*

Eagle Environmental Consulting, LLC  
 8000 W 44th Ave  
 Wheat Ridge CO 80033

Martin C Eckert III  
 Project Number: [none]  
 Project: Noble - CPC Ferguson Chewy UPRC  
 T5N-R64W-S23L01 TB

www.originslaboratory.com  
 page 1 of 2  
**4308654**  
 Project Manager: Martin Eckert III  
 Project Name: CPC Ferguson Chewy UPRC T5N-R64W-S23L01 Tank Bulb  
 Project Number: \_\_\_\_\_  
 Samples Collected By: MMB  
 Client: Eagle Environmental Consulting  
 Address: 8000 W. 44th Ave.  
Wheat Ridge, CO 80033  
 Telephone Number: 303-433-0479  
 Email Address: mmc3@eagle-enviro.com

Sample ID Description	Date Sampled	Time Sampled	# of Containers	Preservative				Matrix			Analysis	Sample Instructions	Turnaround Time:					
				Unpreserved	HCl	HNO <sub>3</sub>	Other	Groundwater	Soil	Air Summa #			Other	Same Day	48 Hr	72 Hr		
TB-SS-01 @ 0.5'	08-24-23	1015	3	X					X			X	X	X	X	24 Hr		
TB-SS-02 @ 0.5'		1017							X			X	X	X	X			
TB-SS-03 @ 0.5'		1019							X			X	X	X	X			
TB-SS-09 @ 3'		1322							X			X	X	X	X			
WV-SS-01 @ 5'		1250							X			X	X	X	X			
WV-SS-02 @ 5'		1252							X			X	X	X	X			
WV-SS-03 @ 5'		1254							X			X	X	X	X			
WV-SS-04 @ 5'		1256							X			X	X	X	X			
WV-SS-05 @ 5'		1258							X			X	X	X	X			
WV-SS-06 @ 5'		1300							X			X	X	X	X			
Reinquinished By: <u>Bonny Butts</u>	Date: <u>08-24-23</u>	Time: <u>1000</u>	Received By: <u>[Signature]</u>	Date: <u>8/24/23</u>	Time: <u>1000</u>	Turnaround Time: <input type="checkbox"/> Same Day <input type="checkbox"/> 48 Hr <input checked="" type="checkbox"/> Standard	Date Results Needed: <u>Noble</u>			Temp Received: <u>4</u>			Reinquinished By: _____					

Origins Laboratory, Inc.

Jen Pellegrini For Jordan A. Bynon, Project Manager

The results in this report apply to the samples analyzed in accordance with the chain of custody document. This analytical report must be reproduced in its entirety.



Eagle Environmental Consulting, LLC  
 8000 W 44th Ave  
 Wheat Ridge CO 80033

Martin C Eckert III  
 Project Number: [none]  
 Project: Noble - CPC Ferguson Chewy UPRC  
 T5N-R64W-S23L01 TB

Origins Laboratory

F-012207-01-R1  
 Effective Date: 01/09/12

**Sample Receipt Checklist**

Origins Work Order: 43086054

Client: Eagle  
 Client Project ID: CPC Ferguson Chewy UPRC

Checklist Completed by: JSH  
 Date/time completed: 8/25/23

Shipped Via: TID  
 (UPS, FedEx, Hand Delivered, Pick-up, etc.)  
 Airbill #: N/A

Matrix(s) Received: (Check all that apply):  Soil/Solid  Water  Other: \_\_\_\_\_

Cooler Number/Temperature: 1 / 4 °C / \_\_\_\_\_ °C / \_\_\_\_\_ °C (Describe) \_\_\_\_\_ °C

Thermometer ID: 7004

Requirement Description	Yes	No	N/A	Comments (if any)
If samples require cooling, was the temperature between 0°C to ≤ 6°C <sup>(1)</sup> ?	<input checked="" type="checkbox"/>			
Is there ice present (document if blue ice is used)	<input checked="" type="checkbox"/>			
Are custody seals present on cooler? (if so, document in comments if they are signed and dated, broken or intact)			<input checked="" type="checkbox"/>	
Are custody seals present on each sample container? (if so, document in comments if they are signed and dated, broken or intact)			<input checked="" type="checkbox"/>	
Were all samples received intact <sup>(1)</sup> ?	<input checked="" type="checkbox"/>			
Was adequate sample volume provided <sup>(1)</sup> ?	<input checked="" type="checkbox"/>			
Are short holding time analytes or samples with HTs due within 48 hours present <sup>(1)</sup> ?		<input checked="" type="checkbox"/>		
Is a chain-of-custody (COC) present and filled out completely <sup>(1)</sup> ?	<input checked="" type="checkbox"/>			
Does the COC agree with the number and type of sample bottles received <sup>(1)</sup> ?	<input checked="" type="checkbox"/>			
Do the sample IDs on the bottle labels match the COC <sup>(1)</sup> ?	<input checked="" type="checkbox"/>			
Is the COC properly relinquished by the client with date and time recorded <sup>(1)</sup> ?	<input checked="" type="checkbox"/>			
For volatiles in water – is there headspace (> ¼ inch bubble) present? <b>If yes, contact client and note in narrative.</b>			<input checked="" type="checkbox"/>	
Are samples preserved that require preservation and was it checked <sup>(1)</sup> ? (note ID of confirmation instrument used in comments) / (preservation is not confirmed for subcontracted analyses in order to insure sample integrity)/(pH <2 for samples preserved with HNO <sub>3</sub> , HCL, H <sub>2</sub> SO <sub>4</sub> ) / (pH >10 for samples preserved with NaAsO <sub>2</sub> +NaOH, ZnAc+NaOH)			<input checked="" type="checkbox"/>	
Additional Comments (if any):				

<sup>(1)</sup>if NO, then contact the client before proceeding with analysis and note date/time and person contacted as well as the corrective action to in the additional comments (above) and the case narrative.

Reviewed by (Project Manager) [Signature] Date/Time Reviewed 8/28/23

Origins Laboratory, Inc.

Jefe Pellegrini

Jen Pellegrini For Jordan A. Bynon, Project Manager

The results in this report apply to the samples analyzed in accordance with the chain of custody document. This analytical report must be reproduced in its entirety.

Eagle Environmental Consulting, LLC  
 8000 W 44th Ave  
 Wheat Ridge CO 80033

Martin C Eckert III  
 Project Number: [none]  
 Project: Noble - CPC Ferguson Chewy UPRC  
 T5N-R64W-S23L01 TB

**TB-SS-01@0.5'**  
**8/24/2023 10:15:00AM**

Analyte	Result	Min Detection Limit	Reporting Limit	Units	Dilution	Batch	Prepared	Analyzed	Notes
---------	--------	---------------------	-----------------	-------	----------	-------	----------	----------	-------

**Origins Laboratory, Inc.**  
**Y308654-01 (Soil)**

**Boron (DTPA Sorbitol)**

Boron	ND		0.0996	mg/L	1	B3H3010	08/30/2023	09/01/2023	U
-------	----	--	--------	------	---	---------	------------	------------	---

**DRO/ORO by EPA 8015D**

Diesel (C10-C28)	ND		25.0	mg/kg	1	B3H2801	08/28/2023	09/01/2023	U
Residual Range Organics (C28-C40)	ND		100	"	"	"	"	"	U

Surrogate: <i>o</i> -Terphenyl	91.9 %		50-150			"	"	"	
--------------------------------	--------	--	--------	--	--	---	---	---	--

**GBTEX+TMBs by 8260D**

1,2,4-Trimethylbenzene	ND		0.00200	mg/kg	1	B3H2536	08/25/2023	08/28/2023	U
1,3,5-Trimethylbenzene	ND		0.00200	"	"	"	"	"	U
Benzene	ND		0.00200	"	"	"	"	"	U
Ethylbenzene	ND		0.00200	"	"	"	"	"	U
Naphthalene	ND		0.00380	"	"	"	"	"	U
Toluene	ND		0.00200	"	"	"	"	"	U
Xylenes, total	ND		0.00200	"	"	"	"	"	U
Gasoline Range Hydrocarbons	ND		0.200	"	"	"	"	"	U

Origins Laboratory, Inc.



*The results in this report apply to the samples analyzed in accordance with the chain of custody document. This analytical report must be reproduced in its entirety.*

Jen Pellegrini For Jordan A. Bynon, Project Manager

Eagle Environmental Consulting, LLC  
 8000 W 44th Ave  
 Wheat Ridge CO 80033

Martin C Eckert III  
 Project Number: [none]  
 Project: Noble - CPC Ferguson Chewy UPRC  
 T5N-R64W-S23L01 TB

**TB-SS-01@0.5'**  
**8/24/2023 10:15:00AM**

Analyte	Result	Min Detection Limit	Reporting Limit	Units	Dilution	Batch	Prepared	Analyzed	Notes
---------	--------	---------------------	-----------------	-------	----------	-------	----------	----------	-------

**Origins Laboratory, Inc.**  
**Y308654-01 (Soil)**

**GBTEX+TMBs by 8260D**

Surrogate: 1,2-Dichloroethane-d4	106 %		70-130			B3H25 36	08/25/2023	08/28/2023	
Surrogate: Toluene-d8	100 %		70-130			"	"	"	
Surrogate: 4-Bromofluorobenzene	90.3 %		70-130			"	"	"	

**Metals by Saturated Paste by EPA 6010**

Calcium	ND	0.499	meq/L	10	[CALC]		08/30/2023	09/01/2023	
Magnesium	ND	0.823	"	"	"		"	"	
Sodium	ND	0.435	"	"	"		"	"	

**PAH by EPA 8270E**

1-Methylnaphthalene	ND	0.002	mg/kg	1	B3H2820		08/28/2023	08/28/2023	U
2-Methylnaphthalene	ND	0.002	"	"	"		"	"	U
Acenaphthene	ND	0.020	"	"	"		"	"	U
Anthracene	ND	0.020	"	"	"		"	"	U
Benzo (a) anthracene	ND	0.005	"	"	"		"	"	U
Benzo (a) pyrene	ND	0.020	"	"	"		"	"	U
Benzo (b) fluoranthene	ND	0.020	"	"	"		"	"	U
Benzo (k) fluoranthene	ND	0.020	"	"	"		"	"	U
Chrysene	ND	0.020	"	"	"		"	"	U
Dibenz (a,h) anthracene	ND	0.020	"	"	"		"	"	U

Origins Laboratory, Inc.



The results in this report apply to the samples analyzed in accordance with the chain of custody document. This analytical report must be reproduced in its entirety.

Eagle Environmental Consulting, LLC  
 8000 W 44th Ave  
 Wheat Ridge CO 80033

Martin C Eckert III  
 Project Number: [none]  
 Project: Noble - CPC Ferguson Chewy UPRC  
 T5N-R64W-S23L01 TB

**TB-SS-01@0.5'**

**8/24/2023 10:15:00AM**

Analyte	Result	Min Detection Limit	Reporting Limit	Units	Dilution	Batch	Prepared	Analyzed	Notes
---------	--------	---------------------	-----------------	-------	----------	-------	----------	----------	-------

**Origins Laboratory, Inc.**  
**Y308654-01 (Soil)**

**PAH by EPA 8270E**

Fluoranthene	ND		0.020	mg/kg	1	B3H2820	08/28/2023	08/28/2023	U
Fluorene	ND		0.020	"	"	"	"	"	U
Indeno (1,2,3-cd) pyrene	ND		0.020	"	"	"	"	"	U
Pyrene	ND		0.020	"	"	"	"	"	U

Surrogate: Fluorene-d10	94.4 %		60-130			"	"	"	
Surrogate: Anthracene-d10	101 %		60-130			"	"	"	
Surrogate: Benzo (a) pyrene-d12	104 %		60-130			"	"	"	
Surrogate: Pyrene-d10	124 %		60-130			"	"	"	

**pH in Soil by 9045D**

pH	5.10			pH Units	1	B3H3016	08/30/2023	08/31/2023	
----	------	--	--	----------	---	---------	------------	------------	--

**SAR by 20B Saturated Paste**

SAR	0.288		0.0100	SAR	1	B3H3006	08/30/2023	09/01/2023	
-----	-------	--	--------	-----	---	---------	------------	------------	--

**Specific Conductance Mod. 9050A**

Specific Conductance (EC)	0.0963		0.00500	mmhos/cm	1	B3H3016	08/30/2023	08/31/2023	
---------------------------	--------	--	---------	----------	---	---------	------------	------------	--

Origins Laboratory, Inc.



The results in this report apply to the samples analyzed in accordance with the chain of custody document. This analytical report must be reproduced in its entirety.

Jen Pellegrini For Jordan A. Bynon, Project Manager

Eagle Environmental Consulting, LLC  
 8000 W 44th Ave  
 Wheat Ridge CO 80033

Martin C Eckert III  
 Project Number: [none]  
 Project: Noble - CPC Ferguson Chewy UPRC  
 T5N-R64W-S23L01 TB

**TB-SS-02@0.5'**  
**8/24/2023 10:17:00AM**

Analyte	Result	Min Detection Limit	Reporting Limit	Units	Dilution	Batch	Prepared	Analyzed	Notes
---------	--------	---------------------	-----------------	-------	----------	-------	----------	----------	-------

**Origins Laboratory, Inc.**  
**Y308654-02 (Soil)**

**Boron (DTPA Sorbitol)**

Boron	0.140		0.101	mg/L	1	B3H3010	08/30/2023	09/01/2023	
-------	-------	--	-------	------	---	---------	------------	------------	--

**DRO/ORO by EPA 8015D**

Diesel (C10-C28)	ND		25.0	mg/kg	1	B3H2801	08/28/2023	09/01/2023	U
Residual Range Organics (C28-C40)	ND		100	"	"	"	"	"	U

Surrogate: o-Terphenyl	92.1 %		50-150			"	"	"	
------------------------	--------	--	--------	--	--	---	---	---	--

**GBTEX+TMBs by 8260D**

1,2,4-Trimethylbenzene	ND		0.00200	mg/kg	1	B3H2536	08/25/2023	08/28/2023	U
1,3,5-Trimethylbenzene	ND		0.00200	"	"	"	"	"	U
Benzene	ND		0.00200	"	"	"	"	"	U
Ethylbenzene	ND		0.00200	"	"	"	"	"	U
Naphthalene	ND		0.00380	"	"	"	"	"	U
Toluene	ND		0.00200	"	"	"	"	"	U
Xylenes, total	ND		0.00200	"	"	"	"	"	U
Gasoline Range Hydrocarbons	ND		0.200	"	"	"	"	"	U

Origins Laboratory, Inc.



Jen Pellegrini For Jordan A. Bynon, Project Manager

*The results in this report apply to the samples analyzed in accordance with the chain of custody document. This analytical report must be reproduced in its entirety.*

Eagle Environmental Consulting, LLC  
 8000 W 44th Ave  
 Wheat Ridge CO 80033

Martin C Eckert III  
 Project Number: [none]  
 Project: Noble - CPC Ferguson Chewy UPRC  
 T5N-R64W-S23L01 TB

**TB-SS-02@0.5'**  
**8/24/2023 10:17:00AM**

Analyte	Result	Min Detection Limit	Reporting Limit	Units	Dilution	Batch	Prepared	Analyzed	Notes
---------	--------	---------------------	-----------------	-------	----------	-------	----------	----------	-------

**Origins Laboratory, Inc.**  
**Y308654-02 (Soil)**

**GBTEX+TMBs by 8260D**

Surrogate: 1,2-Dichloroethane-d4	107 %		70-130			B3H25 36	08/25/2023	08/28/2023	
Surrogate: Toluene-d8	98.8 %		70-130			"	"	"	
Surrogate: 4-Bromofluorobenzene	92.2 %		70-130			"	"	"	

**Metals by Saturated Paste by EPA 6010**

Calcium	<b>2.98</b>		0.499	meq/L	10	[CALC]	08/30/2023	09/01/2023	
Magnesium	<b>1.32</b>		0.823	"	"	"	"	"	
Sodium	<b>0.683</b>		0.435	"	"	"	"	"	

**PAH by EPA 8270E**

1-Methylnaphthalene	ND		0.002	mg/kg	1	B3H2820	08/28/2023	08/28/2023	U
2-Methylnaphthalene	ND		0.002	"	"	"	"	"	U
Acenaphthene	ND		0.020	"	"	"	"	"	U
Anthracene	ND		0.020	"	"	"	"	"	U
Benzo (a) anthracene	ND		0.005	"	"	"	"	"	U
Benzo (a) pyrene	ND		0.020	"	"	"	"	"	U
Benzo (b) fluoranthene	ND		0.020	"	"	"	"	"	U
Benzo (k) fluoranthene	ND		0.020	"	"	"	"	"	U
Chrysene	ND		0.020	"	"	"	"	"	U
Dibenz (a,h) anthracene	ND		0.020	"	"	"	"	"	U

Origins Laboratory, Inc.



The results in this report apply to the samples analyzed in accordance with the chain of custody document. This analytical report must be reproduced in its entirety.

Eagle Environmental Consulting, LLC  
 8000 W 44th Ave  
 Wheat Ridge CO 80033

Martin C Eckert III  
 Project Number: [none]  
 Project: Noble - CPC Ferguson Chewy UPRC  
 T5N-R64W-S23L01 TB

**TB-SS-02@0.5'**  
**8/24/2023 10:17:00AM**

Analyte	Result	Min Detection Limit	Reporting Limit	Units	Dilution	Batch	Prepared	Analyzed	Notes
---------	--------	---------------------	-----------------	-------	----------	-------	----------	----------	-------

**Origins Laboratory, Inc.**  
**Y308654-02 (Soil)**

**PAH by EPA 8270E**

Fluoranthene	ND		0.020	mg/kg	1	B3H2820	08/28/2023	08/28/2023	U
Fluorene	ND		0.020	"	"	"	"	"	U
Indeno (1,2,3-cd) pyrene	ND		0.020	"	"	"	"	"	U
Pyrene	ND		0.020	"	"	"	"	"	U

Surrogate: Fluorene-d10	97.6 %		60-130			"	"	"	
Surrogate: Anthracene-d10	105 %		60-130			"	"	"	
Surrogate: Benzo (a) pyrene-d12	92.6 %		60-130			"	"	"	
Surrogate: Pyrene-d10	103 %		60-130			"	"	"	

**pH in Soil by 9045D**

pH	8.03			pH Units	1	B3H3016	08/30/2023	08/31/2023	
----	------	--	--	----------	---	---------	------------	------------	--

**SAR by 20B Saturated Paste**

SAR	0.466		0.0100	SAR	1	B3H3006	08/30/2023	09/01/2023	
-----	-------	--	--------	-----	---	---------	------------	------------	--

**Specific Conductance Mod. 9050A**

Specific Conductance (EC)	0.575		0.00500	mmhos/cm	1	B3H3016	08/30/2023	08/31/2023	
---------------------------	-------	--	---------	----------	---	---------	------------	------------	--

Origins Laboratory, Inc.



The results in this report apply to the samples analyzed in accordance with the chain of custody document. This analytical report must be reproduced in its entirety.

Jen Pellegrini For Jordan A. Bynon, Project Manager

Eagle Environmental Consulting, LLC  
 8000 W 44th Ave  
 Wheat Ridge CO 80033

Martin C Eckert III  
 Project Number: [none]  
 Project: Noble - CPC Ferguson Chewy UPRC  
 T5N-R64W-S23L01 TB

**TB-SS-03@0.5'**  
**8/24/2023 10:19:00AM**

Analyte	Result	Min Detection Limit	Reporting Limit	Units	Dilution	Batch	Prepared	Analyzed	Notes
---------	--------	---------------------	-----------------	-------	----------	-------	----------	----------	-------

**Origins Laboratory, Inc.**  
**Y308654-03 (Soil)**

**Boron (DTPA Sorbitol)**

Boron	0.281		0.0998	mg/L	1	B3H3010	08/30/2023	09/01/2023	
-------	-------	--	--------	------	---	---------	------------	------------	--

**DRO/ORO by EPA 8015D**

Diesel (C10-C28)	ND		25.0	mg/kg	1	B3H2801	08/28/2023	09/01/2023	U
Residual Range Organics (C28-C40)	ND		100	"	"	"	"	"	U

Surrogate: o-Terphenyl	91.1 %		50-150			"	"	"	
------------------------	--------	--	--------	--	--	---	---	---	--

**GBTEX+TMBs by 8260D**

1,2,4-Trimethylbenzene	ND		0.00200	mg/kg	1	B3H2536	08/25/2023	08/28/2023	U
1,3,5-Trimethylbenzene	ND		0.00200	"	"	"	"	"	U
Benzene	ND		0.00200	"	"	"	"	"	U
Ethylbenzene	ND		0.00200	"	"	"	"	"	U
Naphthalene	ND		0.00380	"	"	"	"	"	U
Toluene	ND		0.00200	"	"	"	"	"	U
Xylenes, total	ND		0.00200	"	"	"	"	"	U
Gasoline Range Hydrocarbons	ND		0.200	"	"	"	"	"	U

Origins Laboratory, Inc.



Jen Pellegrini For Jordan A. Bynon, Project Manager

*The results in this report apply to the samples analyzed in accordance with the chain of custody document. This analytical report must be reproduced in its entirety.*

Eagle Environmental Consulting, LLC  
 8000 W 44th Ave  
 Wheat Ridge CO 80033

Martin C Eckert III  
 Project Number: [none]  
 Project: Noble - CPC Ferguson Chewy UPRC  
 T5N-R64W-S23L01 TB

**TB-SS-03@0.5'**  
**8/24/2023 10:19:00AM**

Analyte	Result	Min Detection Limit	Reporting Limit	Units	Dilution	Batch	Prepared	Analyzed	Notes
---------	--------	---------------------	-----------------	-------	----------	-------	----------	----------	-------

**Origins Laboratory, Inc.**  
**Y308654-03 (Soil)**

**GBTEX+TMBs by 8260D**

Surrogate: 1,2-Dichloroethane-d4	107 %		70-130			B3H25 36	08/25/2023	08/28/2023	
Surrogate: Toluene-d8	99.4 %		70-130			"	"	"	
Surrogate: 4-Bromofluorobenzene	91.3 %		70-130			"	"	"	

**Metals by Saturated Paste by EPA 6010**

Calcium	48.7		0.499	meq/L	10	[CALC]	08/30/2023	09/01/2023	
Magnesium	22.6		0.823	"	"	"	"	"	
Sodium	7.37		0.435	"	"	"	"	"	

**PAH by EPA 8270E**

1-Methylnaphthalene	ND		0.002	mg/kg	1	B3H2820	08/28/2023	08/28/2023	U
2-Methylnaphthalene	ND		0.002	"	"	"	"	"	U
Acenaphthene	ND		0.020	"	"	"	"	"	U
Anthracene	ND		0.020	"	"	"	"	"	U
Benzo (a) anthracene	ND		0.005	"	"	"	"	"	U
Benzo (a) pyrene	ND		0.020	"	"	"	"	"	U
Benzo (b) fluoranthene	ND		0.020	"	"	"	"	"	U
Benzo (k) fluoranthene	ND		0.020	"	"	"	"	"	U
Chrysene	ND		0.020	"	"	"	"	"	U
Dibenz (a,h) anthracene	ND		0.020	"	"	"	"	"	U

Origins Laboratory, Inc.



The results in this report apply to the samples analyzed in accordance with the chain of custody document. This analytical report must be reproduced in its entirety.

Jen Pellegrini For Jordan A. Bynon, Project Manager

Eagle Environmental Consulting, LLC  
 8000 W 44th Ave  
 Wheat Ridge CO 80033

Martin C Eckert III  
 Project Number: [none]  
 Project: Noble - CPC Ferguson Chewy UPRC  
 T5N-R64W-S23L01 TB

**TB-SS-03@0.5'**

**8/24/2023 10:19:00AM**

Analyte	Result	Min Detection Limit	Reporting Limit	Units	Dilution	Batch	Prepared	Analyzed	Notes
---------	--------	---------------------	-----------------	-------	----------	-------	----------	----------	-------

**Origins Laboratory, Inc.**  
**Y308654-03 (Soil)**

**PAH by EPA 8270E**

Fluoranthene	ND		0.020	mg/kg	1	B3H2820	08/28/2023	08/28/2023	U
Fluorene	ND		0.020	"	"	"	"	"	U
Indeno (1,2,3-cd) pyrene	ND		0.020	"	"	"	"	"	U
Pyrene	ND		0.020	"	"	"	"	"	U

Surrogate: Fluorene-d10	95.9 %		60-130			"	"	"	
Surrogate: Anthracene-d10	97.3 %		60-130			"	"	"	
Surrogate: Benzo (a) pyrene-d12	108 %		60-130			"	"	"	
Surrogate: Pyrene-d10	119 %		60-130			"	"	"	

**pH in Soil by 9045D**

pH	7.65			pH Units	1	B3H3016	08/30/2023	08/31/2023	
----	------	--	--	----------	---	---------	------------	------------	--

**SAR by 20B Saturated Paste**

SAR	1.24		0.0100	SAR	1	B3H3006	08/30/2023	09/01/2023	
-----	------	--	--------	-----	---	---------	------------	------------	--

**Specific Conductance Mod. 9050A**

Specific Conductance (EC)	7.15		0.00500	mmhos/cm	1	B3H3016	08/30/2023	08/31/2023	
---------------------------	------	--	---------	----------	---	---------	------------	------------	--

Origins Laboratory, Inc.



The results in this report apply to the samples analyzed in accordance with the chain of custody document. This analytical report must be reproduced in its entirety.

Jen Pellegrini For Jordan A. Bynon, Project Manager

Eagle Environmental Consulting, LLC  
 8000 W 44th Ave  
 Wheat Ridge CO 80033

Martin C Eckert III  
 Project Number: [none]  
 Project: Noble - CPC Ferguson Chewy UPRC  
 T5N-R64W-S23L01 TB

**TB-SS-09@3'**  
**8/24/2023 1:22:00PM**

Analyte	Result	Min Detection Limit	Reporting Limit	Units	Dilution	Batch	Prepared	Analyzed	Notes
---------	--------	---------------------	-----------------	-------	----------	-------	----------	----------	-------

**Origins Laboratory, Inc.**  
**Y308654-04 (Soil)**

**Boron (DTPA Sorbitol)**

Boron	ND		0.102	mg/L	1	B3H3010	08/30/2023	09/01/2023	U
-------	----	--	-------	------	---	---------	------------	------------	---

**DRO/ORO by EPA 8015D**

Diesel (C10-C28)	ND		25.0	mg/kg	1	B3H2801	08/28/2023	09/01/2023	U
Residual Range Organics (C28-C40)	ND		100	"	"	"	"	"	U

Surrogate: <i>o</i> -Terphenyl	92.9 %		50-150			"	"	"	
--------------------------------	--------	--	--------	--	--	---	---	---	--

**GBTEX+TMBs by 8260D**

1,2,4-Trimethylbenzene	ND		0.00200	mg/kg	1	B3H2536	08/25/2023	08/28/2023	U
1,3,5-Trimethylbenzene	ND		0.00200	"	"	"	"	"	U
Benzene	ND		0.00200	"	"	"	"	"	U
Ethylbenzene	ND		0.00200	"	"	"	"	"	U
Naphthalene	ND		0.00380	"	"	"	"	"	U
Toluene	ND		0.00200	"	"	"	"	"	U
Xylenes, total	ND		0.00200	"	"	"	"	"	U
Gasoline Range Hydrocarbons	ND		0.200	"	"	"	"	"	U

Origins Laboratory, Inc.



*The results in this report apply to the samples analyzed in accordance with the chain of custody document. This analytical report must be reproduced in its entirety.*

Jen Pellegrini For Jordan A. Bynon, Project Manager

Eagle Environmental Consulting, LLC  
 8000 W 44th Ave  
 Wheat Ridge CO 80033

Martin C Eckert III  
 Project Number: [none]  
 Project: Noble - CPC Ferguson Chewy UPRC  
 T5N-R64W-S23L01 TB

**TB-SS-09@3'**  
**8/24/2023 1:22:00PM**

Analyte	Result	Min Detection Limit	Reporting Limit	Units	Dilution	Batch	Prepared	Analyzed	Notes
---------	--------	---------------------	-----------------	-------	----------	-------	----------	----------	-------

**Origins Laboratory, Inc.**  
**Y308654-04 (Soil)**

**GBTEX+TMBs by 8260D**

Surrogate: 1,2-Dichloroethane-d4	106 %		70-130			B3H25 36	08/25/2023	08/28/2023	
Surrogate: Toluene-d8	102 %		70-130			"	"	"	
Surrogate: 4-Bromofluorobenzene	89.2 %		70-130			"	"	"	

**Metals by Saturated Paste by EPA 6010**

Calcium	ND	0.499	meq/L	10	[CALC]		08/30/2023	09/01/2023	
Magnesium	ND	0.823	"	"	"		"	"	
Sodium	ND	0.435	"	"	"		"	"	

**PAH by EPA 8270E**

1-Methylnaphthalene	ND	0.002	mg/kg	1	B3H2820		08/28/2023	08/28/2023	U
2-Methylnaphthalene	ND	0.002	"	"	"		"	"	U
Acenaphthene	ND	0.020	"	"	"		"	"	U
Anthracene	ND	0.020	"	"	"		"	"	U
Benzo (a) anthracene	ND	0.005	"	"	"		"	"	U
Benzo (a) pyrene	ND	0.020	"	"	"		"	"	U
Benzo (b) fluoranthene	ND	0.020	"	"	"		"	"	U
Benzo (k) fluoranthene	ND	0.020	"	"	"		"	"	U
Chrysene	ND	0.020	"	"	"		"	"	U
Dibenz (a,h) anthracene	ND	0.020	"	"	"		"	"	U

Origins Laboratory, Inc.



The results in this report apply to the samples analyzed in accordance with the chain of custody document. This analytical report must be reproduced in its entirety.

Eagle Environmental Consulting, LLC  
 8000 W 44th Ave  
 Wheat Ridge CO 80033

Martin C Eckert III  
 Project Number: [none]  
 Project: Noble - CPC Ferguson Chewy UPRC  
 T5N-R64W-S23L01 TB

**TB-SS-09@3'**  
**8/24/2023 1:22:00PM**

Analyte	Result	Min Detection Limit	Reporting Limit	Units	Dilution	Batch	Prepared	Analyzed	Notes
---------	--------	---------------------	-----------------	-------	----------	-------	----------	----------	-------

**Origins Laboratory, Inc.**  
**Y308654-04 (Soil)**

**PAH by EPA 8270E**

Fluoranthene	ND		0.020	mg/kg	1	B3H2820	08/28/2023	08/28/2023	U
Fluorene	ND		0.020	"	"	"	"	"	U
Indeno (1,2,3-cd) pyrene	ND		0.020	"	"	"	"	"	U
Pyrene	ND		0.020	"	"	"	"	"	U

Surrogate: Fluorene-d10	92.3 %		60-130			"	"	"	
Surrogate: Anthracene-d10	82.7 %		60-130			"	"	"	
Surrogate: Benzo (a) pyrene-d12	87.0 %		60-130			"	"	"	
Surrogate: Pyrene-d10	130 %		60-130			"	"	"	

**pH in Soil by 9045D**

pH	6.18			pH Units	1	B3H3016	08/30/2023	08/31/2023	
----	------	--	--	----------	---	---------	------------	------------	--

**SAR by 20B Saturated Paste**

SAR	0.216		0.0100	SAR	1	B3H3006	08/30/2023	09/01/2023	
-----	-------	--	--------	-----	---	---------	------------	------------	--

**Specific Conductance Mod. 9050A**

Specific Conductance (EC)	0.0985		0.00500	mmhos/cm	1	B3H3016	08/30/2023	08/31/2023	
---------------------------	--------	--	---------	----------	---	---------	------------	------------	--

Origins Laboratory, Inc.



The results in this report apply to the samples analyzed in accordance with the chain of custody document. This analytical report must be reproduced in its entirety.

Jen Pellegrini For Jordan A. Bynon, Project Manager

Eagle Environmental Consulting, LLC  
 8000 W 44th Ave  
 Wheat Ridge CO 80033

Martin C Eckert III  
 Project Number: [none]  
 Project: Noble - CPC Ferguson Chewy UPRC  
 T5N-R64W-S23L01 TB

**WV-SS-01@5'**

**8/24/2023 12:50:00PM**

Analyte	Result	Min Detection Limit	Reporting Limit	Units	Dilution	Batch	Prepared	Analyzed	Notes
---------	--------	---------------------	-----------------	-------	----------	-------	----------	----------	-------

**Origins Laboratory, Inc.**  
**Y308654-05 (Soil)**

**Boron (DTPA Sorbitol)**

Boron	ND		0.0987	mg/L	1	B3H3010	08/30/2023	09/01/2023	U
-------	----	--	--------	------	---	---------	------------	------------	---

**DRO/ORO by EPA 8015D**

Diesel (C10-C28)	ND		25.0	mg/kg	1	B3H2801	08/28/2023	09/01/2023	U
Residual Range Organics (C28-C40)	ND		100	"	"	"	"	"	U

Surrogate: <i>o</i> -Terphenyl	91.5 %		50-150			"	"	"	
--------------------------------	--------	--	--------	--	--	---	---	---	--

**GBTEX+TMBs by 8260D**

1,2,4-Trimethylbenzene	ND		0.00200	mg/kg	1	B3H2536	08/25/2023	08/28/2023	U
1,3,5-Trimethylbenzene	ND		0.00200	"	"	"	"	"	U
Benzene	ND		0.00200	"	"	"	"	"	U
Ethylbenzene	ND		0.00200	"	"	"	"	"	U
Naphthalene	ND		0.00380	"	"	"	"	"	U
Toluene	ND		0.00200	"	"	"	"	"	U
Xylenes, total	ND		0.00200	"	"	"	"	"	U
Gasoline Range Hydrocarbons	ND		0.200	"	"	"	"	"	U

Origins Laboratory, Inc.



*The results in this report apply to the samples analyzed in accordance with the chain of custody document. This analytical report must be reproduced in its entirety.*

Jen Pellegrini For Jordan A. Bynon, Project Manager

Eagle Environmental Consulting, LLC  
 8000 W 44th Ave  
 Wheat Ridge CO 80033

Martin C Eckert III  
 Project Number: [none]  
 Project: Noble - CPC Ferguson Chewy UPRC  
 T5N-R64W-S23L01 TB

**WV-SS-01@5'**

**8/24/2023 12:50:00PM**

Analyte	Result	Min Detection Limit	Reporting Limit	Units	Dilution	Batch	Prepared	Analyzed	Notes
---------	--------	---------------------	-----------------	-------	----------	-------	----------	----------	-------

**Origins Laboratory, Inc.**  
**Y308654-05 (Soil)**

**GBTEX+TMBs by 8260D**

Surrogate: 1,2-Dichloroethane-d4	105 %		70-130			B3H25 36	08/25/2023	08/28/2023	
Surrogate: Toluene-d8	100 %		70-130			"	"	"	
Surrogate: 4-Bromofluorobenzene	91.3 %		70-130			"	"	"	

**Metals by Saturated Paste by EPA 6010**

Calcium	ND		0.499	meq/L	10	[CALC]	08/30/2023	09/01/2023	
Magnesium	ND		0.823	"	"	"	"	"	
Sodium	ND		0.435	"	"	"	"	"	

**PAH by EPA 8270E**

1-Methylnaphthalene	ND		0.002	mg/kg	1	B3H2820	08/28/2023	08/28/2023	U
2-Methylnaphthalene	ND		0.002	"	"	"	"	"	U
Acenaphthene	ND		0.020	"	"	"	"	"	U
Anthracene	ND		0.020	"	"	"	"	"	U
Benzo (a) anthracene	ND		0.005	"	"	"	"	"	U
Benzo (a) pyrene	ND		0.020	"	"	"	"	"	U
Benzo (b) fluoranthene	ND		0.020	"	"	"	"	"	U
Benzo (k) fluoranthene	ND		0.020	"	"	"	"	"	U
Chrysene	ND		0.020	"	"	"	"	"	U
Dibenz (a,h) anthracene	ND		0.020	"	"	"	"	"	U

Origins Laboratory, Inc.



The results in this report apply to the samples analyzed in accordance with the chain of custody document. This analytical report must be reproduced in its entirety.

Jen Pellegrini For Jordan A. Bynon, Project Manager

Eagle Environmental Consulting, LLC  
 8000 W 44th Ave  
 Wheat Ridge CO 80033

Martin C Eckert III  
 Project Number: [none]  
 Project: Noble - CPC Ferguson Chewy UPRC  
 T5N-R64W-S23L01 TB

**WV-SS-01@5'**

**8/24/2023 12:50:00PM**

Analyte	Result	Min Detection Limit	Reporting Limit	Units	Dilution	Batch	Prepared	Analyzed	Notes
---------	--------	---------------------	-----------------	-------	----------	-------	----------	----------	-------

**Origins Laboratory, Inc.**  
**Y308654-05 (Soil)**

**PAH by EPA 8270E**

Fluoranthene	ND		0.020	mg/kg	1	B3H2820	08/28/2023	08/28/2023	U
Fluorene	ND		0.020	"	"	"	"	"	U
Indeno (1,2,3-cd) pyrene	ND		0.020	"	"	"	"	"	U
Pyrene	ND		0.020	"	"	"	"	"	U

Surrogate: Fluorene-d10	92.8 %		60-130			"	"	"	
Surrogate: Anthracene-d10	105 %		60-130			"	"	"	
Surrogate: Benzo (a) pyrene-d12	83.5 %		60-130			"	"	"	
Surrogate: Pyrene-d10	128 %		60-130			"	"	"	

**pH in Soil by 9045D**

pH	6.76			pH Units	1	B3H3016	08/30/2023	08/31/2023	
----	------	--	--	----------	---	---------	------------	------------	--

**SAR by 20B Saturated Paste**

SAR	0.306		0.0100	SAR	1	B3H3006	08/30/2023	09/01/2023	
-----	-------	--	--------	-----	---	---------	------------	------------	--

**Specific Conductance Mod. 9050A**

Specific Conductance (EC)	0.104		0.00500	mmhos/cm	1	B3H3016	08/30/2023	08/31/2023	
---------------------------	-------	--	---------	----------	---	---------	------------	------------	--

Origins Laboratory, Inc.



*The results in this report apply to the samples analyzed in accordance with the chain of custody document. This analytical report must be reproduced in its entirety.*

Jen Pellegrini For Jordan A. Bynon, Project Manager

Eagle Environmental Consulting, LLC  
 8000 W 44th Ave  
 Wheat Ridge CO 80033

Martin C Eckert III  
 Project Number: [none]  
 Project: Noble - CPC Ferguson Chewy UPRC  
 T5N-R64W-S23L01 TB

**WV-SS-02@5'**

**8/24/2023 12:52:00PM**

Analyte	Result	Min Detection Limit	Reporting Limit	Units	Dilution	Batch	Prepared	Analyzed	Notes
---------	--------	---------------------	-----------------	-------	----------	-------	----------	----------	-------

**Origins Laboratory, Inc.**  
**Y308654-06 (Soil)**

**Boron (DTPA Sorbitol)**

Boron	ND		0.100	mg/L	1	B3H3010	08/30/2023	09/01/2023	U
-------	----	--	-------	------	---	---------	------------	------------	---

**DRO/ORO by EPA 8015D**

Diesel (C10-C28)	ND		25.0	mg/kg	1	B3H2801	08/28/2023	09/01/2023	U
Residual Range Organics (C28-C40)	ND		100	"	"	"	"	"	U

Surrogate: <i>o</i> -Terphenyl	91.7 %		50-150			"	"	"	
--------------------------------	--------	--	--------	--	--	---	---	---	--

**GBTEX+TMBs by 8260D**

1,2,4-Trimethylbenzene	ND		0.00200	mg/kg	1	B3H2536	08/25/2023	08/28/2023	U
1,3,5-Trimethylbenzene	ND		0.00200	"	"	"	"	"	U
Benzene	ND		0.00200	"	"	"	"	"	U
Ethylbenzene	ND		0.00200	"	"	"	"	"	U
Naphthalene	ND		0.00380	"	"	"	"	"	U
Toluene	ND		0.00200	"	"	"	"	"	U
Xylenes, total	ND		0.00200	"	"	"	"	"	U
Gasoline Range Hydrocarbons	ND		0.200	"	"	"	"	"	U

Origins Laboratory, Inc.



*The results in this report apply to the samples analyzed in accordance with the chain of custody document. This analytical report must be reproduced in its entirety.*

Jen Pellegrini For Jordan A. Bynon, Project Manager

Eagle Environmental Consulting, LLC  
 8000 W 44th Ave  
 Wheat Ridge CO 80033

Martin C Eckert III  
 Project Number: [none]  
 Project: Noble - CPC Ferguson Chewy UPRC  
 T5N-R64W-S23L01 TB

**WV-SS-02@5'**

**8/24/2023 12:52:00PM**

Analyte	Result	Min Detection Limit	Reporting Limit	Units	Dilution	Batch	Prepared	Analyzed	Notes
---------	--------	---------------------	-----------------	-------	----------	-------	----------	----------	-------

**Origins Laboratory, Inc.**  
**Y308654-06 (Soil)**

**GBTEX+TMBs by 8260D**

Surrogate: 1,2-Dichloroethane-d4	105 %		70-130			B3H25 36	08/25/2023	08/28/2023	
Surrogate: Toluene-d8	98.6 %		70-130			"	"	"	
Surrogate: 4-Bromofluorobenzene	91.3 %		70-130			"	"	"	

**Metals by Saturated Paste by EPA 6010**

Calcium	ND		0.499	meq/L	10	[CALC]	08/30/2023	09/01/2023	
Magnesium	ND		0.823	"	"	"	"	"	
Sodium	ND		0.435	"	"	"	"	"	

**PAH by EPA 8270E**

1-Methylnaphthalene	ND		0.002	mg/kg	1	B3H2820	08/28/2023	08/28/2023	U
2-Methylnaphthalene	ND		0.002	"	"	"	"	"	U
Acenaphthene	ND		0.020	"	"	"	"	"	U
Anthracene	ND		0.020	"	"	"	"	"	U
Benzo (a) anthracene	ND		0.005	"	"	"	"	"	U
Benzo (a) pyrene	ND		0.020	"	"	"	"	"	U
Benzo (b) fluoranthene	ND		0.020	"	"	"	"	"	U
Benzo (k) fluoranthene	ND		0.020	"	"	"	"	"	U
Chrysene	ND		0.020	"	"	"	"	"	U
Dibenz (a,h) anthracene	ND		0.020	"	"	"	"	"	U

Origins Laboratory, Inc.



The results in this report apply to the samples analyzed in accordance with the chain of custody document. This analytical report must be reproduced in its entirety.

Eagle Environmental Consulting, LLC  
 8000 W 44th Ave  
 Wheat Ridge CO 80033

Martin C Eckert III  
 Project Number: [none]  
 Project: Noble - CPC Ferguson Chewy UPRC  
 T5N-R64W-S23L01 TB

**WV-SS-02@5'**

**8/24/2023 12:52:00PM**

Analyte	Result	Min Detection Limit	Reporting Limit	Units	Dilution	Batch	Prepared	Analyzed	Notes
---------	--------	---------------------	-----------------	-------	----------	-------	----------	----------	-------

**Origins Laboratory, Inc.**  
**Y308654-06 (Soil)**

**PAH by EPA 8270E**

Fluoranthene	ND		0.020	mg/kg	1	B3H2820	08/28/2023	08/28/2023	U
Fluorene	ND		0.020	"	"	"	"	"	U
Indeno (1,2,3-cd) pyrene	ND		0.020	"	"	"	"	"	U
Pyrene	ND		0.020	"	"	"	"	"	U

Surrogate: Fluorene-d10	96.2 %		60-130			"	"	"	
Surrogate: Anthracene-d10	97.7 %		60-130			"	"	"	
Surrogate: Benzo (a) pyrene-d12	94.4 %		60-130			"	"	"	
Surrogate: Pyrene-d10	124 %		60-130			"	"	"	

**pH in Soil by 9045D**

pH	7.56			pH Units	1	B3H3016	08/30/2023	08/31/2023	
----	------	--	--	----------	---	---------	------------	------------	--

**SAR by 20B Saturated Paste**

SAR	0.368		0.0100	SAR	1	B3H3006	08/30/2023	09/01/2023	
-----	-------	--	--------	-----	---	---------	------------	------------	--

**Specific Conductance Mod. 9050A**

Specific Conductance (EC)	0.115		0.00500	mmhos/cm	1	B3H3016	08/30/2023	08/31/2023	
---------------------------	-------	--	---------	----------	---	---------	------------	------------	--

Origins Laboratory, Inc.



The results in this report apply to the samples analyzed in accordance with the chain of custody document. This analytical report must be reproduced in its entirety.

Jen Pellegrini For Jordan A. Bynon, Project Manager

Eagle Environmental Consulting, LLC  
 8000 W 44th Ave  
 Wheat Ridge CO 80033

Martin C Eckert III  
 Project Number: [none]  
 Project: Noble - CPC Ferguson Chewy UPRC  
 T5N-R64W-S23L01 TB

**WV-SS-03@5'**

**8/24/2023 12:54:00PM**

Analyte	Result	Min Detection Limit	Reporting Limit	Units	Dilution	Batch	Prepared	Analyzed	Notes
---------	--------	---------------------	-----------------	-------	----------	-------	----------	----------	-------

**Origins Laboratory, Inc.**  
**Y308654-07 (Soil)**

**Boron (DTPA Sorbitol)**

Boron	ND		0.100	mg/L	1	B3H3011	08/30/2023	09/01/2023	U
-------	----	--	-------	------	---	---------	------------	------------	---

**DRO/ORO by EPA 8015D**

Diesel (C10-C28)	ND		25.0	mg/kg	1	B3H2801	08/28/2023	09/01/2023	U
Residual Range Organics (C28-C40)	ND		100	"	"	"	"	"	U

Surrogate: o-Terphenyl	93.7 %		50-150			"	"	"	
------------------------	--------	--	--------	--	--	---	---	---	--

**GBTEX+TMBs by 8260D**

1,2,4-Trimethylbenzene	ND		0.00200	mg/kg	1	B3H2536	08/25/2023	08/28/2023	U
1,3,5-Trimethylbenzene	ND		0.00200	"	"	"	"	"	U
Benzene	ND		0.00200	"	"	"	"	"	U
Ethylbenzene	ND		0.00200	"	"	"	"	"	U
Naphthalene	ND		0.00380	"	"	"	"	"	U
Toluene	ND		0.00200	"	"	"	"	"	U
Xylenes, total	ND		0.00200	"	"	"	"	"	U
Gasoline Range Hydrocarbons	ND		0.200	"	"	"	"	"	U

Origins Laboratory, Inc.



*The results in this report apply to the samples analyzed in accordance with the chain of custody document. This analytical report must be reproduced in its entirety.*

Jen Pellegrini For Jordan A. Bynon, Project Manager

Eagle Environmental Consulting, LLC  
 8000 W 44th Ave  
 Wheat Ridge CO 80033

Martin C Eckert III  
 Project Number: [none]  
 Project: Noble - CPC Ferguson Chewy UPRC  
 T5N-R64W-S23L01 TB

**WV-SS-03@5'**

**8/24/2023 12:54:00PM**

Analyte	Result	Min Detection Limit	Reporting Limit	Units	Dilution	Batch	Prepared	Analyzed	Notes
---------	--------	---------------------	-----------------	-------	----------	-------	----------	----------	-------

**Origins Laboratory, Inc.**  
**Y308654-07 (Soil)**

**GBTEX+TMBs by 8260D**

Surrogate: 1,2-Dichloroethane-d4	104 %		70-130			B3H25 36	08/25/2023	08/28/2023	
Surrogate: Toluene-d8	97.0 %		70-130			"	"	"	
Surrogate: 4-Bromofluorobenzene	93.6 %		70-130			"	"	"	

**Metals by Saturated Paste by EPA 6010**

Calcium	ND		0.499	meq/L	10	[CALC]	08/30/2023	09/01/2023	
Magnesium	ND		0.823	"	"	"	"	"	
Sodium	ND		0.435	"	"	"	"	"	

**PAH by EPA 8270E**

1-Methylnaphthalene	ND		0.002	mg/kg	1	B3H2820	08/28/2023	08/29/2023	U
2-Methylnaphthalene	ND		0.002	"	"	"	"	"	U
Acenaphthene	ND		0.020	"	"	"	"	"	U
Anthracene	ND		0.020	"	"	"	"	"	U
Benzo (a) anthracene	ND		0.005	"	"	"	"	"	U
Benzo (a) pyrene	ND		0.020	"	"	"	"	"	U
Benzo (b) fluoranthene	ND		0.020	"	"	"	"	"	U
Benzo (k) fluoranthene	ND		0.020	"	"	"	"	"	U
Chrysene	ND		0.020	"	"	"	"	"	U
Dibenz (a,h) anthracene	ND		0.020	"	"	"	"	"	U

Origins Laboratory, Inc.



The results in this report apply to the samples analyzed in accordance with the chain of custody document. This analytical report must be reproduced in its entirety.

Jen Pellegrini For Jordan A. Bynon, Project Manager

Eagle Environmental Consulting, LLC  
 8000 W 44th Ave  
 Wheat Ridge CO 80033

Martin C Eckert III  
 Project Number: [none]  
 Project: Noble - CPC Ferguson Chewy UPRC  
 T5N-R64W-S23L01 TB

**WV-SS-03@5'**

**8/24/2023 12:54:00PM**

Analyte	Result	Min Detection Limit	Reporting Limit	Units	Dilution	Batch	Prepared	Analyzed	Notes
---------	--------	---------------------	-----------------	-------	----------	-------	----------	----------	-------

**Origins Laboratory, Inc.**  
**Y308654-07 (Soil)**

**PAH by EPA 8270E**

Fluoranthene	ND		0.020	mg/kg	1	B3H2820	08/28/2023	08/29/2023	U
Fluorene	ND		0.020	"	"	"	"	"	U
Indeno (1,2,3-cd) pyrene	ND		0.020	"	"	"	"	"	U
Pyrene	ND		0.020	"	"	"	"	"	U

Surrogate: Fluorene-d10	96.8 %		60-130			"	"	"	
Surrogate: Anthracene-d10	101 %		60-130			"	"	"	
Surrogate: Benzo (a) pyrene-d12	84.1 %		60-130			"	"	"	
Surrogate: Pyrene-d10	120 %		60-130			"	"	"	

**pH in Soil by 9045D**

pH	7.15			pH Units	1	B3H3016	08/30/2023	08/31/2023	
----	------	--	--	----------	---	---------	------------	------------	--

**SAR by 20B Saturated Paste**

SAR	0.431		0.0100	SAR	1	B3H3006	08/30/2023	09/01/2023	
-----	-------	--	--------	-----	---	---------	------------	------------	--

**Specific Conductance Mod. 9050A**

Specific Conductance (EC)	0.0634		0.00500	mmhos/cm	1	B3H3016	08/30/2023	08/31/2023	
---------------------------	--------	--	---------	----------	---	---------	------------	------------	--

Origins Laboratory, Inc.



The results in this report apply to the samples analyzed in accordance with the chain of custody document. This analytical report must be reproduced in its entirety.

Jen Pellegrini For Jordan A. Bynon, Project Manager

Eagle Environmental Consulting, LLC  
 8000 W 44th Ave  
 Wheat Ridge CO 80033

Martin C Eckert III  
 Project Number: [none]  
 Project: Noble - CPC Ferguson Chewy UPRC  
 T5N-R64W-S23L01 TB

**WV-SS-04@5'**

**8/24/2023 12:56:00PM**

Analyte	Result	Min Detection Limit	Reporting Limit	Units	Dilution	Batch	Prepared	Analyzed	Notes
---------	--------	---------------------	-----------------	-------	----------	-------	----------	----------	-------

**Origins Laboratory, Inc.**  
**Y308654-08 (Soil)**

**Boron (DTPA Sorbitol)**

Boron	ND		0.100	mg/L	1	B3H3011	08/30/2023	09/01/2023	U
-------	----	--	-------	------	---	---------	------------	------------	---

**DRO/ORO by EPA 8015D**

Diesel (C10-C28)	ND		25.0	mg/kg	1	B3H2801	08/28/2023	09/01/2023	U
Residual Range Organics (C28-C40)	ND		100	"	"	"	"	"	U

Surrogate: <i>o</i> -Terphenyl	93.8 %		50-150			"	"	"	
--------------------------------	--------	--	--------	--	--	---	---	---	--

**GBTEX+TMBs by 8260D**

1,2,4-Trimethylbenzene	ND		0.00200	mg/kg	1	B3H2536	08/25/2023	08/28/2023	U
1,3,5-Trimethylbenzene	ND		0.00200	"	"	"	"	"	U
Benzene	ND		0.00200	"	"	"	"	"	U
Ethylbenzene	ND		0.00200	"	"	"	"	"	U
Naphthalene	ND		0.00380	"	"	"	"	"	U
Toluene	ND		0.00200	"	"	"	"	"	U
Xylenes, total	ND		0.00200	"	"	"	"	"	U
Gasoline Range Hydrocarbons	ND		0.200	"	"	"	"	"	U

Origins Laboratory, Inc.



*The results in this report apply to the samples analyzed in accordance with the chain of custody document. This analytical report must be reproduced in its entirety.*

Jen Pellegrini For Jordan A. Bynon, Project Manager

Eagle Environmental Consulting, LLC  
 8000 W 44th Ave  
 Wheat Ridge CO 80033

Martin C Eckert III  
 Project Number: [none]  
 Project: Noble - CPC Ferguson Chewy UPRC  
 T5N-R64W-S23L01 TB

**WV-SS-04@5'**

**8/24/2023 12:56:00PM**

Analyte	Result	Min Detection Limit	Reporting Limit	Units	Dilution	Batch	Prepared	Analyzed	Notes
---------	--------	---------------------	-----------------	-------	----------	-------	----------	----------	-------

**Origins Laboratory, Inc.**  
**Y308654-08 (Soil)**

**GBTEX+TMBs by 8260D**

Surrogate: 1,2-Dichloroethane-d4	105 %		70-130			B3H25 36	08/25/2023	08/28/2023	
Surrogate: Toluene-d8	98.5 %		70-130			"	"	"	
Surrogate: 4-Bromofluorobenzene	88.1 %		70-130			"	"	"	

**Metals by Saturated Paste by EPA 6010**

Calcium	ND		0.499	meq/L	10	[CALC]	08/30/2023	09/01/2023	
Magnesium	ND		0.823	"	"	"	"	"	
Sodium	ND		0.435	"	"	"	"	"	

**PAH by EPA 8270E**

1-Methylnaphthalene	ND		0.002	mg/kg	1	B3H2820	08/28/2023	08/29/2023	U
2-Methylnaphthalene	ND		0.002	"	"	"	"	"	U
Acenaphthene	ND		0.020	"	"	"	"	"	U
Anthracene	ND		0.020	"	"	"	"	"	U
Benzo (a) anthracene	ND		0.005	"	"	"	"	"	U
Benzo (a) pyrene	ND		0.020	"	"	"	"	"	U
Benzo (b) fluoranthene	ND		0.020	"	"	"	"	"	U
Benzo (k) fluoranthene	ND		0.020	"	"	"	"	"	U
Chrysene	ND		0.020	"	"	"	"	"	U
Dibenz (a,h) anthracene	ND		0.020	"	"	"	"	"	U

Origins Laboratory, Inc.



The results in this report apply to the samples analyzed in accordance with the chain of custody document. This analytical report must be reproduced in its entirety.

Jen Pellegrini For Jordan A. Bynon, Project Manager

Eagle Environmental Consulting, LLC  
 8000 W 44th Ave  
 Wheat Ridge CO 80033

Martin C Eckert III  
 Project Number: [none]  
 Project: Noble - CPC Ferguson Chewy UPRC  
 T5N-R64W-S23L01 TB

**WV-SS-04@5'**

**8/24/2023 12:56:00PM**

Analyte	Result	Min Detection Limit	Reporting Limit	Units	Dilution	Batch	Prepared	Analyzed	Notes
---------	--------	---------------------	-----------------	-------	----------	-------	----------	----------	-------

**Origins Laboratory, Inc.**  
**Y308654-08 (Soil)**

**PAH by EPA 8270E**

Fluoranthene	ND		0.020	mg/kg	1	B3H2820	08/28/2023	08/29/2023	U
Fluorene	ND		0.020	"	"	"	"	"	U
Indeno (1,2,3-cd) pyrene	ND		0.020	"	"	"	"	"	U
Pyrene	ND		0.020	"	"	"	"	"	U

Surrogate: Fluorene-d10	92.8 %		60-130			"	"	"	
Surrogate: Anthracene-d10	101 %		60-130			"	"	"	
Surrogate: Benzo (a) pyrene-d12	81.3 %		60-130			"	"	"	
Surrogate: Pyrene-d10	131 %		60-130			"	"	"	S-04

**pH in Soil by 9045D**

pH	7.42			pH Units	1	B3H3016	08/30/2023	08/31/2023	
----	------	--	--	----------	---	---------	------------	------------	--

**SAR by 20B Saturated Paste**

SAR	0.389		0.0100	SAR	1	B3H3006	08/30/2023	09/01/2023	
-----	-------	--	--------	-----	---	---------	------------	------------	--

**Specific Conductance Mod. 9050A**

Specific Conductance (EC)	0.110		0.00500	mmhos/cm	1	B3H3016	08/30/2023	08/31/2023	
---------------------------	-------	--	---------	----------	---	---------	------------	------------	--

Origins Laboratory, Inc.



The results in this report apply to the samples analyzed in accordance with the chain of custody document. This analytical report must be reproduced in its entirety.

Jen Pellegrini For Jordan A. Bynon, Project Manager

Eagle Environmental Consulting, LLC  
 8000 W 44th Ave  
 Wheat Ridge CO 80033

Martin C Eckert III  
 Project Number: [none]  
 Project: Noble - CPC Ferguson Chewy UPRC  
 T5N-R64W-S23L01 TB

**WV-SS-05@5'**

**8/24/2023 12:58:00PM**

Analyte	Result	Min Detection Limit	Reporting Limit	Units	Dilution	Batch	Prepared	Analyzed	Notes
---------	--------	---------------------	-----------------	-------	----------	-------	----------	----------	-------

**Origins Laboratory, Inc.**  
**Y308654-09 (Soil)**

**Boron (DTPA Sorbitol)**

Boron	ND		0.0995	mg/L	1	B3H3011	08/30/2023	09/01/2023	U
-------	----	--	--------	------	---	---------	------------	------------	---

**DRO/ORO by EPA 8015D**

Diesel (C10-C28)	ND		25.0	mg/kg	1	B3H2801	08/28/2023	09/01/2023	U
Residual Range Organics (C28-C40)	ND		100	"	"	"	"	"	U

Surrogate: <i>o</i> -Terphenyl	92.5 %		50-150			"	"	"	
--------------------------------	--------	--	--------	--	--	---	---	---	--

**GBTEX+TMBs by 8260D**

1,2,4-Trimethylbenzene	ND		0.00200	mg/kg	1	B3H2536	08/25/2023	08/28/2023	U
1,3,5-Trimethylbenzene	ND		0.00200	"	"	"	"	"	U
Benzene	ND		0.00200	"	"	"	"	"	U
Ethylbenzene	ND		0.00200	"	"	"	"	"	U
Naphthalene	ND		0.00380	"	"	"	"	"	U
Toluene	ND		0.00200	"	"	"	"	"	U
Xylenes, total	ND		0.00200	"	"	"	"	"	U
Gasoline Range Hydrocarbons	ND		0.200	"	"	"	"	"	U

Origins Laboratory, Inc.



Jen Pellegrini For Jordan A. Bynon, Project Manager

*The results in this report apply to the samples analyzed in accordance with the chain of custody document. This analytical report must be reproduced in its entirety.*

Eagle Environmental Consulting, LLC  
 8000 W 44th Ave  
 Wheat Ridge CO 80033

Martin C Eckert III  
 Project Number: [none]  
 Project: Noble - CPC Ferguson Chewy UPRC  
 T5N-R64W-S23L01 TB

**WV-SS-05@5'**

**8/24/2023 12:58:00PM**

Analyte	Result	Min Detection Limit	Reporting Limit	Units	Dilution	Batch	Prepared	Analyzed	Notes
---------	--------	---------------------	-----------------	-------	----------	-------	----------	----------	-------

**Origins Laboratory, Inc.**  
**Y308654-09 (Soil)**

**GBTEX+TMBs by 8260D**

Surrogate: 1,2-Dichloroethane-d4	107 %		70-130			B3H25 36	08/25/2023	08/28/2023	
Surrogate: Toluene-d8	97.9 %		70-130			"	"	"	
Surrogate: 4-Bromofluorobenzene	90.2 %		70-130			"	"	"	

**Metals by Saturated Paste by EPA 6010**

Calcium	ND	0.499	meq/L	10	[CALC]		08/30/2023	09/01/2023	
Magnesium	ND	0.823	"	"	"		"	"	
Sodium	ND	0.435	"	"	"		"	"	

**PAH by EPA 8270E**

1-Methylnaphthalene	ND	0.002	mg/kg	1	B3H2820		08/28/2023	08/29/2023	U
2-Methylnaphthalene	ND	0.002	"	"	"		"	"	U
Acenaphthene	ND	0.020	"	"	"		"	"	U
Anthracene	ND	0.020	"	"	"		"	"	U
Benzo (a) anthracene	ND	0.005	"	"	"		"	"	U
Benzo (a) pyrene	ND	0.020	"	"	"		"	"	U
Benzo (b) fluoranthene	ND	0.020	"	"	"		"	"	U
Benzo (k) fluoranthene	ND	0.020	"	"	"		"	"	U
Chrysene	ND	0.020	"	"	"		"	"	U
Dibenz (a,h) anthracene	ND	0.020	"	"	"		"	"	U

Origins Laboratory, Inc.



The results in this report apply to the samples analyzed in accordance with the chain of custody document. This analytical report must be reproduced in its entirety.

Jen Pellegrini For Jordan A. Bynon, Project Manager

Eagle Environmental Consulting, LLC  
 8000 W 44th Ave  
 Wheat Ridge CO 80033

Martin C Eckert III  
 Project Number: [none]  
 Project: Noble - CPC Ferguson Chewy UPRC  
 T5N-R64W-S23L01 TB

**WV-SS-05@5'**

**8/24/2023 12:58:00PM**

Analyte	Result	Min Detection Limit	Reporting Limit	Units	Dilution	Batch	Prepared	Analyzed	Notes
---------	--------	---------------------	-----------------	-------	----------	-------	----------	----------	-------

**Origins Laboratory, Inc.**  
**Y308654-09 (Soil)**

**PAH by EPA 8270E**

Fluoranthene	ND		0.020	mg/kg	1	B3H2820	08/28/2023	08/29/2023	U
Fluorene	ND		0.020	"	"	"	"	"	U
Indeno (1,2,3-cd) pyrene	ND		0.020	"	"	"	"	"	U
Pyrene	ND		0.020	"	"	"	"	"	U

Surrogate: Fluorene-d10	98.0 %		60-130			"	"	"	
Surrogate: Anthracene-d10	87.2 %		60-130			"	"	"	
Surrogate: Benzo (a) pyrene-d12	78.2 %		60-130			"	"	"	
Surrogate: Pyrene-d10	130 %		60-130			"	"	"	

**pH in Soil by 9045D**

pH	6.69			pH Units	1	B3H3016	08/30/2023	08/31/2023	
----	------	--	--	----------	---	---------	------------	------------	--

**SAR by 20B Saturated Paste**

SAR	0.343		0.0100	SAR	1	B3H3006	08/30/2023	09/01/2023	
-----	-------	--	--------	-----	---	---------	------------	------------	--

**Specific Conductance Mod. 9050A**

Specific Conductance (EC)	0.0755		0.00500	mmhos/cm	1	B3H3016	08/30/2023	08/31/2023	
---------------------------	--------	--	---------	----------	---	---------	------------	------------	--

Origins Laboratory, Inc.



The results in this report apply to the samples analyzed in accordance with the chain of custody document. This analytical report must be reproduced in its entirety.

Jen Pellegrini For Jordan A. Bynon, Project Manager

Eagle Environmental Consulting, LLC  
 8000 W 44th Ave  
 Wheat Ridge CO 80033

Martin C Eckert III  
 Project Number: [none]  
 Project: Noble - CPC Ferguson Chewy UPRC  
 T5N-R64W-S23L01 TB

**WV-SS-06@5'**  
**8/24/2023 1:00:00PM**

Analyte	Result	Min Detection Limit	Reporting Limit	Units	Dilution	Batch	Prepared	Analyzed	Notes
---------	--------	---------------------	-----------------	-------	----------	-------	----------	----------	-------

**Origins Laboratory, Inc.**  
**Y308654-10 (Soil)**

**Boron (DTPA Sorbitol)**

Boron	ND		0.0992	mg/L	1	B3H3011	08/30/2023	09/01/2023	U
-------	----	--	--------	------	---	---------	------------	------------	---

**DRO/ORO by EPA 8015D**

Diesel (C10-C28)	ND		25.0	mg/kg	1	B3H2801	08/28/2023	09/01/2023	U
Residual Range Organics (C28-C40)	ND		100	"	"	"	"	"	U

Surrogate: o-Terphenyl	95.1 %		50-150			"	"	"	
------------------------	--------	--	--------	--	--	---	---	---	--

**GBTEX+TMBs by 8260D**

1,2,4-Trimethylbenzene	ND		0.00200	mg/kg	1	B3H2536	08/25/2023	08/28/2023	U
1,3,5-Trimethylbenzene	ND		0.00200	"	"	"	"	"	U
Benzene	ND		0.00200	"	"	"	"	"	U
Ethylbenzene	ND		0.00200	"	"	"	"	"	U
Naphthalene	ND		0.00380	"	"	"	"	"	U
Toluene	ND		0.00200	"	"	"	"	"	U
Xylenes, total	ND		0.00200	"	"	"	"	"	U
Gasoline Range Hydrocarbons	ND		0.200	"	"	"	"	"	U

Origins Laboratory, Inc.



Jen Pellegrini For Jordan A. Bynon, Project Manager

*The results in this report apply to the samples analyzed in accordance with the chain of custody document. This analytical report must be reproduced in its entirety.*

Eagle Environmental Consulting, LLC  
 8000 W 44th Ave  
 Wheat Ridge CO 80033

Martin C Eckert III  
 Project Number: [none]  
 Project: Noble - CPC Ferguson Chewy UPRC  
 T5N-R64W-S23L01 TB

**WV-SS-06@5'**

**8/24/2023 1:00:00PM**

Analyte	Result	Min Detection Limit	Reporting Limit	Units	Dilution	Batch	Prepared	Analyzed	Notes
---------	--------	---------------------	-----------------	-------	----------	-------	----------	----------	-------

**Origins Laboratory, Inc.**  
**Y308654-10 (Soil)**

**GBTEX+TMBs by 8260D**

Surrogate: 1,2-Dichloroethane-d4	103 %		70-130			B3H25 36	08/25/2023	08/28/2023	
Surrogate: Toluene-d8	99.1 %		70-130			"	"	"	
Surrogate: 4-Bromofluorobenzene	92.7 %		70-130			"	"	"	

**Metals by Saturated Paste by EPA 6010**

Calcium	<b>0.844</b>		0.499	meq/L	10	[CALC]	08/30/2023	09/01/2023	
Magnesium	ND		0.823	"	"	"	"	"	
Sodium	ND		0.435	"	"	"	"	"	

**PAH by EPA 8270E**

1-Methylnaphthalene	ND		0.002	mg/kg	1	B3H2820	08/28/2023	08/29/2023	U
2-Methylnaphthalene	ND		0.002	"	"	"	"	"	U
Acenaphthene	ND		0.020	"	"	"	"	"	U
Anthracene	ND		0.020	"	"	"	"	"	U
Benzo (a) anthracene	ND		0.005	"	"	"	"	"	U
Benzo (a) pyrene	ND		0.020	"	"	"	"	"	U
Benzo (b) fluoranthene	ND		0.020	"	"	"	"	"	U
Benzo (k) fluoranthene	ND		0.020	"	"	"	"	"	U
Chrysene	ND		0.020	"	"	"	"	"	U
Dibenz (a,h) anthracene	ND		0.020	"	"	"	"	"	U

Origins Laboratory, Inc.



The results in this report apply to the samples analyzed in accordance with the chain of custody document. This analytical report must be reproduced in its entirety.

Jen Pellegrini For Jordan A. Bynon, Project Manager

Eagle Environmental Consulting, LLC  
 8000 W 44th Ave  
 Wheat Ridge CO 80033

Martin C Eckert III  
 Project Number: [none]  
 Project: Noble - CPC Ferguson Chewy UPRC  
 T5N-R64W-S23L01 TB

**WV-SS-06@5'**

**8/24/2023 1:00:00PM**

Analyte	Result	Min Detection Limit	Reporting Limit	Units	Dilution	Batch	Prepared	Analyzed	Notes
---------	--------	---------------------	-----------------	-------	----------	-------	----------	----------	-------

**Origins Laboratory, Inc.**  
**Y308654-10 (Soil)**

**PAH by EPA 8270E**

Fluoranthene	ND		0.020	mg/kg	1	B3H2820	08/28/2023	08/29/2023	U
Fluorene	ND		0.020	"	"	"	"	"	U
Indeno (1,2,3-cd) pyrene	ND		0.020	"	"	"	"	"	U
Pyrene	ND		0.020	"	"	"	"	"	U

Surrogate: Fluorene-d10	93.6 %		60-130			"	"	"	
Surrogate: Anthracene-d10	87.8 %		60-130			"	"	"	
Surrogate: Benzo (a) pyrene-d12	92.7 %		60-130			"	"	"	
Surrogate: Pyrene-d10	112 %		60-130			"	"	"	

**pH in Soil by 9045D**

pH	5.72			pH Units	1	B3H3016	08/30/2023	08/31/2023	
----	------	--	--	----------	---	---------	------------	------------	--

**SAR by 20B Saturated Paste**

SAR	0.225		0.0100	SAR	1	B3H3006	08/30/2023	09/01/2023	
-----	-------	--	--------	-----	---	---------	------------	------------	--

**Specific Conductance Mod. 9050A**

Specific Conductance (EC)	0.222		0.00500	mmhos/cm	1	B3H3016	08/30/2023	08/31/2023	
---------------------------	-------	--	---------	----------	---	---------	------------	------------	--

Origins Laboratory, Inc.



The results in this report apply to the samples analyzed in accordance with the chain of custody document. This analytical report must be reproduced in its entirety.

Jen Pellegrini For Jordan A. Bynon, Project Manager

Eagle Environmental Consulting, LLC  
 8000 W 44th Ave  
 Wheat Ridge CO 80033

Martin C Eckert III  
 Project Number: [none]  
 Project: Noble - CPC Ferguson Chewy UPRC  
 T5N-R64W-S23L01 TB

**WV-SS-07@5'**  
**8/24/2023 1:02:00PM**

Analyte	Result	Min Detection Limit	Reporting Limit	Units	Dilution	Batch	Prepared	Analyzed	Notes
---------	--------	---------------------	-----------------	-------	----------	-------	----------	----------	-------

**Origins Laboratory, Inc.**  
**Y308654-11 (Soil)**

**Boron (DTPA Sorbitol)**

Boron	ND		0.0987	mg/L	1	B3H3011	08/30/2023	09/01/2023	U
-------	----	--	--------	------	---	---------	------------	------------	---

**DRO/ORO by EPA 8015D**

Diesel (C10-C28)	ND		25.0	mg/kg	1	B3H2801	08/28/2023	09/01/2023	U
Residual Range Organics (C28-C40)	ND		100	"	"	"	"	"	U

Surrogate: <i>o</i> -Terphenyl	91.3 %		50-150			"	"	"	
--------------------------------	--------	--	--------	--	--	---	---	---	--

**GBTEX+TMBs by 8260D**

1,2,4-Trimethylbenzene	ND		0.00200	mg/kg	1	B3H2536	08/25/2023	08/28/2023	U
1,3,5-Trimethylbenzene	ND		0.00200	"	"	"	"	"	U
Benzene	ND		0.00200	"	"	"	"	"	U
Ethylbenzene	ND		0.00200	"	"	"	"	"	U
Naphthalene	ND		0.00380	"	"	"	"	"	U
Toluene	ND		0.00200	"	"	"	"	"	U
Xylenes, total	ND		0.00200	"	"	"	"	"	U
Gasoline Range Hydrocarbons	ND		0.200	"	"	"	"	"	U

Origins Laboratory, Inc.



Jen Pellegrini For Jordan A. Bynon, Project Manager

*The results in this report apply to the samples analyzed in accordance with the chain of custody document. This analytical report must be reproduced in its entirety.*

Eagle Environmental Consulting, LLC  
 8000 W 44th Ave  
 Wheat Ridge CO 80033

Martin C Eckert III  
 Project Number: [none]  
 Project: Noble - CPC Ferguson Chewy UPRC  
 T5N-R64W-S23L01 TB

**WV-SS-07@5'**  
**8/24/2023 1:02:00PM**

Analyte	Result	Min Detection Limit	Reporting Limit	Units	Dilution	Batch	Prepared	Analyzed	Notes
---------	--------	---------------------	-----------------	-------	----------	-------	----------	----------	-------

**Origins Laboratory, Inc.**  
**Y308654-11 (Soil)**

**GBTEX+TMBs by 8260D**

Surrogate: 1,2-Dichloroethane-d4	106 %		70-130			B3H25 36	08/25/2023	08/28/2023	
Surrogate: Toluene-d8	98.7 %		70-130			"	"	"	
Surrogate: 4-Bromofluorobenzene	90.2 %		70-130			"	"	"	

**Metals by Saturated Paste by EPA 6010**

Calcium	<b>2.47</b>		0.499	meq/L	10	[CALC]	08/30/2023	09/01/2023	
Magnesium	<b>0.940</b>		0.823	"	"	"	"	"	
Sodium	<b>0.448</b>		0.435	"	"	"	"	"	

**PAH by EPA 8270E**

1-Methylnaphthalene	ND		0.002	mg/kg	1	B3H2820	08/28/2023	08/29/2023	U
2-Methylnaphthalene	ND		0.002	"	"	"	"	"	U
Acenaphthene	ND		0.020	"	"	"	"	"	U
Anthracene	ND		0.020	"	"	"	"	"	U
Benzo (a) anthracene	ND		0.005	"	"	"	"	"	U
Benzo (a) pyrene	ND		0.020	"	"	"	"	"	U
Benzo (b) fluoranthene	ND		0.020	"	"	"	"	"	U
Benzo (k) fluoranthene	ND		0.020	"	"	"	"	"	U
Chrysene	ND		0.020	"	"	"	"	"	U
Dibenz (a,h) anthracene	ND		0.020	"	"	"	"	"	U

Origins Laboratory, Inc.



The results in this report apply to the samples analyzed in accordance with the chain of custody document. This analytical report must be reproduced in its entirety.

Eagle Environmental Consulting, LLC  
 8000 W 44th Ave  
 Wheat Ridge CO 80033

Martin C Eckert III  
 Project Number: [none]  
 Project: Noble - CPC Ferguson Chewy UPRC  
 T5N-R64W-S23L01 TB

**WV-SS-07@5'**

**8/24/2023 1:02:00PM**

Analyte	Result	Min Detection Limit	Reporting Limit	Units	Dilution	Batch	Prepared	Analyzed	Notes
---------	--------	---------------------	-----------------	-------	----------	-------	----------	----------	-------

**Origins Laboratory, Inc.**  
**Y308654-11 (Soil)**

**PAH by EPA 8270E**

Fluoranthene	ND		0.020	mg/kg	1	B3H2820	08/28/2023	08/29/2023	U
Fluorene	ND		0.020	"	"	"	"	"	U
Indeno (1,2,3-cd) pyrene	ND		0.020	"	"	"	"	"	U
Pyrene	ND		0.020	"	"	"	"	"	U

Surrogate: Fluorene-d10	96.7 %		60-130			"	"	"	
Surrogate: Anthracene-d10	106 %		60-130			"	"	"	
Surrogate: Benzo (a) pyrene-d12	103 %		60-130			"	"	"	
Surrogate: Pyrene-d10	125 %		60-130			"	"	"	

**pH in Soil by 9045D**

pH	8.21			pH Units	1	B3H3016	08/30/2023	08/31/2023	
----	------	--	--	----------	---	---------	------------	------------	--

**SAR by 20B Saturated Paste**

SAR	0.343		0.0100	SAR	1	B3H3006	08/30/2023	09/01/2023	
-----	-------	--	--------	-----	---	---------	------------	------------	--

**Specific Conductance Mod. 9050A**

Specific Conductance (EC)	0.430		0.00500	mmhos/cm	1	B3H3016	08/30/2023	08/31/2023	
---------------------------	-------	--	---------	----------	---	---------	------------	------------	--

Origins Laboratory, Inc.



The results in this report apply to the samples analyzed in accordance with the chain of custody document. This analytical report must be reproduced in its entirety.

Jen Pellegrini For Jordan A. Bynon, Project Manager

Eagle Environmental Consulting, LLC  
 8000 W 44th Ave  
 Wheat Ridge CO 80033

Martin C Eckert III  
 Project Number: [none]  
 Project: Noble - CPC Ferguson Chewy UPRC  
 T5N-R64W-S23L01 TB

**WV-SS-08@5'**  
**8/24/2023 1:04:00PM**

Analyte	Result	Min Detection Limit	Reporting Limit	Units	Dilution	Batch	Prepared	Analyzed	Notes
---------	--------	---------------------	-----------------	-------	----------	-------	----------	----------	-------

**Origins Laboratory, Inc.**  
**Y308654-12 (Soil)**

**Boron (DTPA Sorbitol)**

Boron	ND		0.0995	mg/L	1	B3H3011	08/30/2023	09/01/2023	U
-------	----	--	--------	------	---	---------	------------	------------	---

**DRO/ORO by EPA 8015D**

Diesel (C10-C28)	ND		25.0	mg/kg	1	B3H2801	08/28/2023	09/01/2023	U
Residual Range Organics (C28-C40)	ND		100	"	"	"	"	"	U

Surrogate: o-Terphenyl	95.8 %		50-150			"	"	"	
------------------------	--------	--	--------	--	--	---	---	---	--

**GBTEX+TMBs by 8260D**

1,2,4-Trimethylbenzene	0.00660		0.00200	mg/kg	1	B3H2536	08/25/2023	08/28/2023	
1,3,5-Trimethylbenzene	0.00308		0.00200	"	"	"	"	"	
Benzene	ND		0.00200	"	"	"	"	"	U
Ethylbenzene	ND		0.00200	"	"	"	"	"	U
Naphthalene	ND		0.00380	"	"	"	"	"	U
Toluene	ND		0.00200	"	"	"	"	"	U
Xylenes, total	ND		0.00200	"	"	"	"	"	U
Gasoline Range Hydrocarbons	1.49		0.200	"	"	"	"	"	

Origins Laboratory, Inc.



Jen Pellegrini For Jordan A. Bynon, Project Manager

*The results in this report apply to the samples analyzed in accordance with the chain of custody document. This analytical report must be reproduced in its entirety.*

Eagle Environmental Consulting, LLC  
 8000 W 44th Ave  
 Wheat Ridge CO 80033

Martin C Eckert III  
 Project Number: [none]  
 Project: Noble - CPC Ferguson Chewy UPRC  
 T5N-R64W-S23L01 TB

**WV-SS-08@5'**  
**8/24/2023 1:04:00PM**

Analyte	Result	Min Detection Limit	Reporting Limit	Units	Dilution	Batch	Prepared	Analyzed	Notes
---------	--------	---------------------	-----------------	-------	----------	-------	----------	----------	-------

**Origins Laboratory, Inc.**  
**Y308654-12 (Soil)**

**GBTEX+TMBs by 8260D**

Surrogate: 1,2-Dichloroethane-d4	108 %		70-130			B3H25 36	08/25/2023	08/28/2023	
Surrogate: Toluene-d8	102 %		70-130			"	"	"	
Surrogate: 4-Bromofluorobenzene	94.1 %		70-130			"	"	"	

**Metals by Saturated Paste by EPA 6010**

Calcium	0.932		0.499	meq/L	10	[CALC]	08/30/2023	09/01/2023	
Magnesium	ND		0.823	"	"	"	"	"	
Sodium	ND		0.435	"	"	"	"	"	

**PAH by EPA 8270E**

1-Methylnaphthalene	0.016		0.002	mg/kg	1	B3H2820	08/28/2023	08/29/2023	
2-Methylnaphthalene	0.031		0.002	"	"	"	"	"	
Acenaphthene	ND		0.020	"	"	"	"	"	U
Anthracene	ND		0.020	"	"	"	"	"	U
Benzo (a) anthracene	ND		0.005	"	"	"	"	"	U
Benzo (a) pyrene	ND		0.020	"	"	"	"	"	U
Benzo (b) fluoranthene	ND		0.020	"	"	"	"	"	U
Benzo (k) fluoranthene	ND		0.020	"	"	"	"	"	U
Chrysene	ND		0.020	"	"	"	"	"	U
Dibenz (a,h) anthracene	ND		0.020	"	"	"	"	"	U

Origins Laboratory, Inc.



The results in this report apply to the samples analyzed in accordance with the chain of custody document. This analytical report must be reproduced in its entirety.

Jen Pellegrini For Jordan A. Bynon, Project Manager

Eagle Environmental Consulting, LLC  
 8000 W 44th Ave  
 Wheat Ridge CO 80033

Martin C Eckert III  
 Project Number: [none]  
 Project: Noble - CPC Ferguson Chewy UPRC  
 T5N-R64W-S23L01 TB

**WV-SS-08@5'**  
**8/24/2023 1:04:00PM**

Analyte	Result	Min Detection Limit	Reporting Limit	Units	Dilution	Batch	Prepared	Analyzed	Notes
---------	--------	---------------------	-----------------	-------	----------	-------	----------	----------	-------

**Origins Laboratory, Inc.**  
**Y308654-12 (Soil)**

**PAH by EPA 8270E**

Fluoranthene	ND		0.020	mg/kg	1	B3H2820	08/28/2023	08/29/2023	U
Fluorene	ND		0.020	"	"	"	"	"	U
Indeno (1,2,3-cd) pyrene	ND		0.020	"	"	"	"	"	U
Pyrene	ND		0.020	"	"	"	"	"	U

Surrogate: Fluorene-d10	97.0 %		60-130			"	"	"	
Surrogate: Anthracene-d10	93.8 %		60-130			"	"	"	
Surrogate: Benzo (a) pyrene-d12	104 %		60-130			"	"	"	
Surrogate: Pyrene-d10	121 %		60-130			"	"	"	

**pH in Soil by 9045D**

pH	7.45			pH Units	1	B3H3016	08/30/2023	08/31/2023	
----	------	--	--	----------	---	---------	------------	------------	--

**SAR by 20B Saturated Paste**

SAR	0.197		0.0100	SAR	1	B3H3006	08/30/2023	09/01/2023	
-----	-------	--	--------	-----	---	---------	------------	------------	--

**Specific Conductance Mod. 9050A**

Specific Conductance (EC)	0.223		0.00500	mmhos/cm	1	B3H3016	08/30/2023	08/31/2023	
---------------------------	-------	--	---------	----------	---	---------	------------	------------	--

**Table 915 metals by EPA 6020B**

Origins Laboratory, Inc.



The results in this report apply to the samples analyzed in accordance with the chain of custody document. This analytical report must be reproduced in its entirety.

Jen Pellegrini For Jordan A. Bynon, Project Manager

Eagle Environmental Consulting, LLC  
 8000 W 44th Ave  
 Wheat Ridge CO 80033

Martin C Eckert III  
 Project Number: [none]  
 Project: Noble - CPC Ferguson Chewy UPRC  
 T5N-R64W-S23L01 TB

**WV-SS-08@5'**

**8/24/2023 1:04:00PM**

Analyte	Result	Min Detection Limit	Reporting Limit	Units	Dilution	Batch	Prepared	Analyzed	Notes
---------	--------	---------------------	-----------------	-------	----------	-------	----------	----------	-------

**Origins Laboratory, Inc.**  
**Y308654-12 (Soil)**

**Table 915 metals by EPA 6020B**

Arsenic	1.71		0.0880	mg/kg	10	B310822	09/08/2023	09/11/2023	
Barium	49.3		8.80	"	"	"	"	"	
Cadmium	0.0880		0.0880	"	"	"	"	"	U
Copper	ND		8.80	"	"	"	"	"	U
Lead	ND		8.80	"	"	"	"	"	U
Nickel	ND		8.80	"	"	"	"	"	U
Selenium	ND		0.0880	"	"	"	"	"	U
Silver	ND		0.0880	"	"	"	"	"	U
Zinc	ND		88.0	"	"	"	"	"	U

**Total Metals by 7196A**

Chromium, Hexavalent	ND	0.244	0.5	mg/Kg	1	L704340	08/24/2023	09/14/2023	
----------------------	----	-------	-----	-------	---	---------	------------	------------	--

Origins Laboratory, Inc.



Jen Pellegrini For Jordan A. Bynon, Project Manager

*The results in this report apply to the samples analyzed in accordance with the chain of custody document. This analytical report must be reproduced in its entirety.*

Eagle Environmental Consulting, LLC  
 8000 W 44th Ave  
 Wheat Ridge CO 80033

Martin C Eckert III  
 Project Number: [none]  
 Project: Noble - CPC Ferguson Chewy UPRC  
 T5N-R64W-S23L01 TB

**WV-FS-01@6'**  
**8/24/2023 1:06:00PM**

Analyte	Result	Min Detection Limit	Reporting Limit	Units	Dilution	Batch	Prepared	Analyzed	Notes
---------	--------	---------------------	-----------------	-------	----------	-------	----------	----------	-------

**Origins Laboratory, Inc.**  
**Y308654-13 (Soil)**

**Boron (DTPA Sorbitol)**

Boron	0.194		0.100	mg/L	1	B3H3011	08/30/2023	09/01/2023	
-------	-------	--	-------	------	---	---------	------------	------------	--

**DRO/ORO by EPA 8015D**

Diesel (C10-C28)	ND		25.0	mg/kg	1	B3H2801	08/28/2023	09/01/2023	U
Residual Range Organics (C28-C40)	ND		100	"	"	"	"	"	U

Surrogate: o-Terphenyl	103 %		50-150			"	"	"	
------------------------	-------	--	--------	--	--	---	---	---	--

**GBTEX+TMBs by 8260D**

1,2,4-Trimethylbenzene	0.00330		0.00200	mg/kg	1	B3H2536	08/25/2023	08/28/2023	
1,3,5-Trimethylbenzene	ND		0.00200	"	"	"	"	"	U
Benzene	ND		0.00200	"	"	"	"	"	U
Ethylbenzene	0.00520		0.00200	"	"	"	"	"	
Naphthalene	ND		0.00380	"	"	"	"	"	U
Toluene	0.00458		0.00200	"	"	"	"	"	
Xylenes, total	0.00954		0.00200	"	"	"	"	"	
Gasoline Range Hydrocarbons	0.471		0.200	"	"	"	"	"	

Surrogate: 1,2-Dichloroethane-d4	109 %		70-130			"	"	"	
----------------------------------	-------	--	--------	--	--	---	---	---	--

Origins Laboratory, Inc.



The results in this report apply to the samples analyzed in accordance with the chain of custody document. This analytical report must be reproduced in its entirety.

Jen Pellegrini For Jordan A. Bynon, Project Manager

Eagle Environmental Consulting, LLC  
 8000 W 44th Ave  
 Wheat Ridge CO 80033

Martin C Eckert III  
 Project Number: [none]  
 Project: Noble - CPC Ferguson Chewy UPRC  
 T5N-R64W-S23L01 TB

**WV-FS-01@6'**  
**8/24/2023 1:06:00PM**

Analyte	Result	Min Detection Limit	Reporting Limit	Units	Dilution	Batch	Prepared	Analyzed	Notes
---------	--------	---------------------	-----------------	-------	----------	-------	----------	----------	-------

**Origins Laboratory, Inc.**  
**Y308654-13 (Soil)**

**GBTEX+TMBs by 8260D**

Surrogate: Toluene-d8	100 %		70-130			B3H25 36	08/25/2023	08/28/2023	
Surrogate: 4-Bromofluorobenzene	89.5 %		70-130			"	"	"	

**Metals by Saturated Paste by EPA 6010**

Calcium	<b>2.64</b>		0.499	meq/L	10	[CALC]	08/30/2023	09/01/2023	
Magnesium	ND		0.823	"	"	"	"	"	
Sodium	<b>0.641</b>		0.435	"	"	"	"	"	

**PAH by EPA 8270E**

1-Methylnaphthalene	ND		0.002	mg/kg	1	B3H2820	08/28/2023	08/29/2023	U
2-Methylnaphthalene	ND		0.002	"	"	"	"	"	U
Acenaphthene	ND		0.020	"	"	"	"	"	U
Anthracene	ND		0.020	"	"	"	"	"	U
Benzo (a) anthracene	ND		0.005	"	"	"	"	"	U
Benzo (a) pyrene	ND		0.020	"	"	"	"	"	U
Benzo (b) fluoranthene	ND		0.020	"	"	"	"	"	U
Benzo (k) fluoranthene	ND		0.020	"	"	"	"	"	U
Chrysene	ND		0.020	"	"	"	"	"	U
Dibenz (a,h) anthracene	ND		0.020	"	"	"	"	"	U
Fluoranthene	ND		0.020	"	"	"	"	"	U

Origins Laboratory, Inc.



The results in this report apply to the samples analyzed in accordance with the chain of custody document. This analytical report must be reproduced in its entirety.

Eagle Environmental Consulting, LLC  
 8000 W 44th Ave  
 Wheat Ridge CO 80033

Martin C Eckert III  
 Project Number: [none]  
 Project: Noble - CPC Ferguson Chewy UPRC  
 T5N-R64W-S23L01 TB

**WV-FS-01@6'**

**8/24/2023 1:06:00PM**

Analyte	Result	Min Detection Limit	Reporting Limit	Units	Dilution	Batch	Prepared	Analyzed	Notes
---------	--------	---------------------	-----------------	-------	----------	-------	----------	----------	-------

**Origins Laboratory, Inc.**  
**Y308654-13 (Soil)**

**PAH by EPA 8270E**

Fluorene	ND		0.020	mg/kg	1	B3H2820	08/28/2023	08/29/2023	U
Indeno (1,2,3-cd) pyrene	ND		0.020	"	"	"	"	"	U
Pyrene	ND		0.020	"	"	"	"	"	U

Surrogate: Fluorene-d10	96.5 %		60-130			"	"	"	
Surrogate: Anthracene-d10	90.4 %		60-130			"	"	"	
Surrogate: Benzo (a) pyrene-d12	102 %		60-130			"	"	"	
Surrogate: Pyrene-d10	123 %		60-130			"	"	"	

**pH in Soil by 9045D**

pH	8.27			pH Units	1	B3H3016	08/30/2023	08/31/2023	
----	------	--	--	----------	---	---------	------------	------------	--

**SAR by 20B Saturated Paste**

SAR	0.514		0.0100	SAR	1	B3H3006	08/30/2023	09/01/2023	
-----	-------	--	--------	-----	---	---------	------------	------------	--

**Specific Conductance Mod. 9050A**

Specific Conductance (EC)	0.406		0.00500	mmhos/cm	1	B3H3016	08/30/2023	08/31/2023	
---------------------------	-------	--	---------	----------	---	---------	------------	------------	--

Origins Laboratory, Inc.



The results in this report apply to the samples analyzed in accordance with the chain of custody document. This analytical report must be reproduced in its entirety.

Jen Pellegrini For Jordan A. Bynon, Project Manager

Eagle Environmental Consulting, LLC  
 8000 W 44th Ave  
 Wheat Ridge CO 80033

Martin C Eckert III  
 Project Number: [none]  
 Project: Noble - CPC Ferguson Chewy UPRC  
 T5N-R64W-S23L01 TB

**WV-FS-02@6'**

**8/24/2023 1:08:00PM**

Analyte	Result	Min Detection Limit	Reporting Limit	Units	Dilution	Batch	Prepared	Analyzed	Notes
---------	--------	---------------------	-----------------	-------	----------	-------	----------	----------	-------

**Origins Laboratory, Inc.**  
**Y308654-14 (Soil)**

**Boron (DTPA Sorbitol)**

Boron	ND		0.101	mg/L	1	B3H3011	08/30/2023	09/01/2023	U
-------	----	--	-------	------	---	---------	------------	------------	---

**DRO/ORO by EPA 8015D**

Diesel (C10-C28)	ND		25.0	mg/kg	1	B3H2801	08/28/2023	09/01/2023	U
Residual Range Organics (C28-C40)	ND		100	"	"	"	"	"	U

Surrogate: <i>o</i> -Terphenyl	91.3 %		50-150			"	"	"	
--------------------------------	--------	--	--------	--	--	---	---	---	--

**GBTEX+TMBs by 8260D**

1,2,4-Trimethylbenzene	ND		0.00200	mg/kg	1	B3H2536	08/25/2023	08/28/2023	U
1,3,5-Trimethylbenzene	ND		0.00200	"	"	"	"	"	U
Benzene	ND		0.00200	"	"	"	"	"	U
Ethylbenzene	ND		0.00200	"	"	"	"	"	U
Naphthalene	ND		0.00380	"	"	"	"	"	U
Toluene	ND		0.00200	"	"	"	"	"	U
Xylenes, total	ND		0.00200	"	"	"	"	"	U
Gasoline Range Hydrocarbons	ND		0.200	"	"	"	"	"	U

Origins Laboratory, Inc.



Jen Pellegrini For Jordan A. Bynon, Project Manager

*The results in this report apply to the samples analyzed in accordance with the chain of custody document. This analytical report must be reproduced in its entirety.*

Eagle Environmental Consulting, LLC  
 8000 W 44th Ave  
 Wheat Ridge CO 80033

Martin C Eckert III  
 Project Number: [none]  
 Project: Noble - CPC Ferguson Chewy UPRC  
 T5N-R64W-S23L01 TB

**WV-FS-02@6'**  
**8/24/2023 1:08:00PM**

Analyte	Result	Min Detection Limit	Reporting Limit	Units	Dilution	Batch	Prepared	Analyzed	Notes
---------	--------	---------------------	-----------------	-------	----------	-------	----------	----------	-------

**Origins Laboratory, Inc.**  
**Y308654-14 (Soil)**

**GBTEX+TMBs by 8260D**

Surrogate: 1,2-Dichloroethane-d4	104 %		70-130			B3H25 36	08/25/2023	08/28/2023	
Surrogate: Toluene-d8	98.3 %		70-130			"	"	"	
Surrogate: 4-Bromofluorobenzene	92.0 %		70-130			"	"	"	

**Metals by Saturated Paste by EPA 6010**

Calcium	ND		0.499	meq/L	10	[CALC]	08/30/2023	09/01/2023	
Magnesium	ND		0.823	"	"	"	"	"	
Sodium	5.14		0.435	"	"	"	"	"	

**PAH by EPA 8270E**

1-Methylnaphthalene	ND		0.002	mg/kg	1	B3H2820	08/28/2023	08/29/2023	U
2-Methylnaphthalene	ND		0.002	"	"	"	"	"	U
Acenaphthene	ND		0.020	"	"	"	"	"	U
Anthracene	ND		0.020	"	"	"	"	"	U
Benzo (a) anthracene	ND		0.005	"	"	"	"	"	U
Benzo (a) pyrene	ND		0.020	"	"	"	"	"	U
Benzo (b) fluoranthene	ND		0.020	"	"	"	"	"	U
Benzo (k) fluoranthene	ND		0.020	"	"	"	"	"	U
Chrysene	ND		0.020	"	"	"	"	"	U
Dibenz (a,h) anthracene	ND		0.020	"	"	"	"	"	U

Origins Laboratory, Inc.



The results in this report apply to the samples analyzed in accordance with the chain of custody document. This analytical report must be reproduced in its entirety.

Eagle Environmental Consulting, LLC  
 8000 W 44th Ave  
 Wheat Ridge CO 80033

Martin C Eckert III  
 Project Number: [none]  
 Project: Noble - CPC Ferguson Chewy UPRC  
 T5N-R64W-S23L01 TB

**WV-FS-02@6'**

**8/24/2023 1:08:00PM**

Analyte	Result	Min Detection Limit	Reporting Limit	Units	Dilution	Batch	Prepared	Analyzed	Notes
---------	--------	---------------------	-----------------	-------	----------	-------	----------	----------	-------

**Origins Laboratory, Inc.**  
**Y308654-14 (Soil)**

**PAH by EPA 8270E**

Fluoranthene	ND		0.020	mg/kg	1	B3H2820	08/28/2023	08/29/2023	U
Fluorene	ND		0.020	"	"	"	"	"	U
Indeno (1,2,3-cd) pyrene	ND		0.020	"	"	"	"	"	U
Pyrene	ND		0.020	"	"	"	"	"	U

Surrogate: Fluorene-d10	98.1 %		60-130			"	"	"	
Surrogate: Anthracene-d10	79.8 %		60-130			"	"	"	
Surrogate: Benzo (a) pyrene-d12	88.1 %		60-130			"	"	"	
Surrogate: Pyrene-d10	94.4 %		60-130			"	"	"	

**pH in Soil by 9045D**

pH	8.59			pH Units	1	B3H3016	08/30/2023	08/31/2023	
----	------	--	--	----------	---	---------	------------	------------	--

**SAR by 20B Saturated Paste**

SAR	18.9		0.0100	SAR	1	B3H3006	08/30/2023	09/01/2023	
-----	------	--	--------	-----	---	---------	------------	------------	--

**Specific Conductance Mod. 9050A**

Specific Conductance (EC)	0.646		0.00500	mmhos/cm	1	B3H3016	08/30/2023	08/31/2023	
---------------------------	-------	--	---------	----------	---	---------	------------	------------	--

Origins Laboratory, Inc.



The results in this report apply to the samples analyzed in accordance with the chain of custody document. This analytical report must be reproduced in its entirety.

Jen Pellegrini For Jordan A. Bynon, Project Manager

Eagle Environmental Consulting, LLC  
 8000 W 44th Ave  
 Wheat Ridge CO 80033

Martin C Eckert III  
 Project Number: [none]  
 Project: Noble - CPC Ferguson Chewy UPRC  
 T5N-R64W-S23L01 TB

**Volatile Organic Compounds by GC/MS SW846 8260D - Quality Control**  
**Origins Laboratory, Inc.**

Analyte	Result	Reporting Limit	Units	Spike Level	Source Result	%REC	%REC Limits	RPD	RPD Limit	Notes
---------	--------	-----------------	-------	-------------	---------------	------	-------------	-----	-----------	-------

Batch B3H2536 - EPA 5030 (soil)

Blank (B3H2536-BLK1)

Prepared: 08/25/2023 Analyzed: 08/27/2023

1,2,4-Trimethylbenzene	ND	0.00200	mg/kg							U
1,3,5-Trimethylbenzene	ND	0.00200	"							U
Benzene	ND	0.00200	"							U
Ethylbenzene	ND	0.00200	"							U
Naphthalene	ND	0.00380	"							U
Toluene	ND	0.00200	"							U
Xylenes, total	ND	0.00200	"							U
Gasoline Range Hydrocarbons	ND	0.200	"							U
Surrogate: 1,2-Dichloroethane-d4	0.13		"	0.125	104		70-130			
Surrogate: Toluene-d8	0.13		"	0.125	102		70-130			
Surrogate: 4-Bromofluorobenzene	0.12		"	0.125	93.6		70-130			

Origins Laboratory, Inc.



Jen Pellegrini For Jordan A. Bynon, Project Manager

*The results in this report apply to the samples analyzed in accordance with the chain of custody document. This analytical report must be reproduced in its entirety.*

Eagle Environmental Consulting, LLC  
 8000 W 44th Ave  
 Wheat Ridge CO 80033

Martin C Eckert III  
 Project Number: [none]  
 Project: Noble - CPC Ferguson Chewy UPRC  
 T5N-R64W-S23L01 TB

**Volatile Organic Compounds by GC/MS SW846 8260D - Quality Control**  
**Origins Laboratory, Inc.**

Analyte	Result	Reporting Limit	Units	Spike Level	Source Result	%REC	%REC Limits	RPD	RPD Limit	Notes
---------	--------	-----------------	-------	-------------	---------------	------	-------------	-----	-----------	-------

**Batch B3H2536 - EPA 5030 (soil)**

**LCS (B3H2536-BS1)**

Prepared: 08/25/2023 Analyzed: 08/27/2023

1,2,4-Trimethylbenzene	0.0937	0.00200	mg/kg	0.100		93.7	70-130			
1,3,5-Trimethylbenzene	0.0967	0.00200	"	0.100		96.7	70-130			
Benzene	0.0950	0.00200	"	0.100		95.0	70-130			
Ethylbenzene	0.0951	0.00200	"	0.100		95.1	70-130			
Naphthalene	0.102	0.00380	"	0.100		102	70-130			
Toluene	0.0991	0.00200	"	0.100		99.1	70-130			
o-Xylene	0.0938	0.00200	"	0.100		93.8	70-130			
m,p-Xylene	0.191	0.00400	"	0.200		95.3	70-130			
Surrogate: 1,2-Dichloroethane-d4	0.13		"	0.125		102	70-130			
Surrogate: Toluene-d8	0.12		"	0.125		99.8	70-130			
Surrogate: 4-Bromofluorobenzene	0.13		"	0.125		103	70-130			

Origins Laboratory, Inc.



Jen Pellegrini For Jordan A. Bynon, Project Manager

*The results in this report apply to the samples analyzed in accordance with the chain of custody document. This analytical report must be reproduced in its entirety.*

Eagle Environmental Consulting, LLC  
 8000 W 44th Ave  
 Wheat Ridge CO 80033

Martin C Eckert III  
 Project Number: [none]  
 Project: Noble - CPC Ferguson Chewy UPRC  
 T5N-R64W-S23L01 TB

**Volatile Organic Compounds by GC/MS SW846 8260D - Quality Control**  
**Origins Laboratory, Inc.**

Analyte	Result	Reporting Limit	Units	Spike Level	Source Result	%REC	%REC Limits	RPD	RPD Limit	Notes
---------	--------	-----------------	-------	-------------	---------------	------	-------------	-----	-----------	-------

Batch B3H2536 - EPA 5030 (soil)

Matrix Spike (B3H2536-MS1)	Source: Y308621-01		Prepared: 08/25/2023 Analyzed: 08/27/2023							
1,2,4-Trimethylbenzene	0.0934	0.00200	mg/kg	0.100	ND	93.4	70-130			
1,3,5-Trimethylbenzene	0.0944	0.00200	"	0.100	ND	94.4	70-130			
Benzene	0.0944	0.00200	"	0.100	ND	94.4	70-130			
Ethylbenzene	0.0945	0.00200	"	0.100	0.000420	94.1	70-130			
Naphthalene	0.0973	0.00380	"	0.100	0.000520	96.7	70-130			
Toluene	0.0973	0.00200	"	0.100	ND	97.3	70-130			
o-Xylene	0.101	0.00200	"	0.100	ND	101	70-130			
m,p-Xylene	0.199	0.00400	"	0.200	ND	99.6	70-130			
Surrogate: 1,2-Dichloroethane-d4	0.13		"	0.125		103	70-130			
Surrogate: Toluene-d8	0.12		"	0.125		98.7	70-130			
Surrogate: 4-Bromofluorobenzene	0.13		"	0.125		106	70-130			

Origins Laboratory, Inc.



Jen Pellegrini For Jordan A. Bynon, Project Manager

The results in this report apply to the samples analyzed in accordance with the chain of custody document. This analytical report must be reproduced in its entirety.

Eagle Environmental Consulting, LLC  
 8000 W 44th Ave  
 Wheat Ridge CO 80033

Martin C Eckert III  
 Project Number: [none]  
 Project: Noble - CPC Ferguson Chewy UPRC  
 T5N-R64W-S23L01 TB

**Volatile Organic Compounds by GC/MS SW846 8260D - Quality Control**  
**Origins Laboratory, Inc.**

Analyte	Result	Reporting Limit	Units	Spike Level	Source Result	%REC	%REC Limits	RPD	RPD Limit	Notes
---------	--------	-----------------	-------	-------------	---------------	------	-------------	-----	-----------	-------

Batch B3H2536 - EPA 5030 (soil)

Matrix Spike Dup (B3H2536-MSD1)	Source: Y308621-01			Prepared: 08/25/2023 Analyzed: 08/27/2023						
1,2,4-Trimethylbenzene	0.100	0.00200	mg/kg	0.100	ND	100	70-130	7.04	20	
1,3,5-Trimethylbenzene	0.100	0.00200	"	0.100	ND	100	70-130	6.22	20	
Benzene	0.102	0.00200	"	0.100	ND	102	70-130	8.03	20	
Ethylbenzene	0.0934	0.00200	"	0.100	0.000420	93.0	70-130	1.19	20	
Naphthalene	0.126	0.00380	"	0.100	0.000520	125	70-130	25.5	20	QR-02
Toluene	0.103	0.00200	"	0.100	ND	103	70-130	5.81	20	
o-Xylene	0.104	0.00200	"	0.100	ND	104	70-130	2.71	20	
m,p-Xylene	0.198	0.00400	"	0.200	ND	99.2	70-130	0.382	20	
Surrogate: 1,2-Dichloroethane-d4	0.13		"	0.125		106	70-130			
Surrogate: Toluene-d8	0.12		"	0.125		97.0	70-130			
Surrogate: 4-Bromofluorobenzene	0.13		"	0.125		100	70-130			

Origins Laboratory, Inc.



Jen Pellegrini For Jordan A. Bynon, Project Manager

*The results in this report apply to the samples analyzed in accordance with the chain of custody document. This analytical report must be reproduced in its entirety.*

Eagle Environmental Consulting, LLC  
 8000 W 44th Ave  
 Wheat Ridge CO 80033

Martin C Eckert III  
 Project Number: [none]  
 Project: Noble - CPC Ferguson Chewy UPRC  
 T5N-R64W-S23L01 TB

**Volatile Organic Compounds by GC/MS SW846 8260D - Quality Control**  
**Origins Laboratory, Inc.**

Analyte	Result	Reporting Limit	Units	Spike Level	Source Result	%REC	%REC Limits	RPD	RPD Limit	Notes
<b>Batch B3H2801 - EPA 3550B</b>										
<b>Blank (B3H2801-BLK1)</b>										
					Prepared: 08/28/2023 Analyzed: 09/01/2023					
Diesel (C10-C28)	ND	25.0	mg/kg							U
Residual Range Organics (C28-C40)	ND	100	"							U
Surrogate: o-Terphenyl	24		"	24.9		96.2	50-150			

Origins Laboratory, Inc.



Jen Pellegrini For Jordan A. Bynon, Project Manager

*The results in this report apply to the samples analyzed in accordance with the chain of custody document. This analytical report must be reproduced in its entirety.*

Eagle Environmental Consulting, LLC  
 8000 W 44th Ave  
 Wheat Ridge CO 80033

Martin C Eckert III  
 Project Number: [none]  
 Project: Noble - CPC Ferguson Chewy UPRC  
 T5N-R64W-S23L01 TB

**Extractable Petroleum Hydrocarbons by 8015D - Quality Control**  
**Origins Laboratory, Inc.**

Analyte	Result	Reporting Limit	Units	Spike Level	Source Result	%REC	%REC Limits	RPD	RPD Limit	Notes
---------	--------	-----------------	-------	-------------	---------------	------	-------------	-----	-----------	-------

**Batch B3H2801 - EPA 3550B**

**LCS (B3H2801-BS1)**

Prepared: 08/28/2023 Analyzed: 09/01/2023

Diesel (C10-C28)	963	50.0	mg/kg	1000		96.3	70-130			
Residual Range Organics (C28-C40)	946	200	"	1000		94.6	70-130			
Surrogate: o-Terphenyl	47		"	49.8		93.9	50-150			

Origins Laboratory, Inc.



Jen Pellegrini For Jordan A. Bynon, Project Manager

*The results in this report apply to the samples analyzed in accordance with the chain of custody document. This analytical report must be reproduced in its entirety.*

Eagle Environmental Consulting, LLC  
 8000 W 44th Ave  
 Wheat Ridge CO 80033

Martin C Eckert III  
 Project Number: [none]  
 Project: Noble - CPC Ferguson Chewy UPRC  
 T5N-R64W-S23L01 TB

**Extractable Petroleum Hydrocarbons by 8015D - Quality Control**  
**Origins Laboratory, Inc.**

Analyte	Result	Reporting Limit	Units	Spike Level	Source Result	%REC	%REC Limits	RPD	RPD Limit	Notes
---------	--------	-----------------	-------	-------------	---------------	------	-------------	-----	-----------	-------

**Batch B3H2801 - EPA 3550B**

<b>Matrix Spike (B3H2801-MS1)</b>	<b>Source: Y308650-01</b>			<b>Prepared: 08/28/2023 Analyzed: 09/01/2023</b>						
Diesel (C10-C28)	968	50.0	mg/kg	1000	ND	96.8	70-130			
Residual Range Organics (C28-C40)	969	200	"	1000	ND	96.9	70-130			
<i>Surrogate: o-Terphenyl</i>	46		"	49.8		92.0	50-150			

Origins Laboratory, Inc.



Jen Pellegrini For Jordan A. Bynon, Project Manager

*The results in this report apply to the samples analyzed in accordance with the chain of custody document. This analytical report must be reproduced in its entirety.*

Eagle Environmental Consulting, LLC  
 8000 W 44th Ave  
 Wheat Ridge CO 80033

Martin C Eckert III  
 Project Number: [none]  
 Project: Noble - CPC Ferguson Chewy UPRC  
 T5N-R64W-S23L01 TB

**Extractable Petroleum Hydrocarbons by 8015D - Quality Control**  
**Origins Laboratory, Inc.**

Analyte	Result	Reporting Limit	Units	Spike Level	Source Result	%REC	%REC Limits	RPD	RPD Limit	Notes
---------	--------	-----------------	-------	-------------	---------------	------	-------------	-----	-----------	-------

**Batch B3H2801 - EPA 3550B**

<b>Matrix Spike Dup (B3H2801-MSD1)</b>	<b>Source: Y308650-01</b>		<b>Prepared: 08/28/2023 Analyzed: 09/01/2023</b>							
Diesel (C10-C28)	1020	50.0	mg/kg	1000	ND	102	70-130	4.77	35	
Residual Range Organics (C28-C40)	995	200	"	1000	ND	99.5	70-130	2.69	35	
<i>Surrogate: o-Terphenyl</i>	54		"	49.8		109	50-150			

Origins Laboratory, Inc.



Jen Pellegrini For Jordan A. Bynon, Project Manager

*The results in this report apply to the samples analyzed in accordance with the chain of custody document. This analytical report must be reproduced in its entirety.*

Eagle Environmental Consulting, LLC  
 8000 W 44th Ave  
 Wheat Ridge CO 80033

Martin C Eckert III  
 Project Number: [none]  
 Project: Noble - CPC Ferguson Chewy UPRC  
 T5N-R64W-S23L01 TB

**Extractable Petroleum Hydrocarbons by 8015D - Quality Control**  
**Origins Laboratory, Inc.**

Analyte	Result	Reporting Limit	Units	Spike Level	Source Result	%REC	%REC Limits	RPD	RPD Limit	Notes
---------	--------	-----------------	-------	-------------	---------------	------	-------------	-----	-----------	-------

**Metals by EPA 6000/7000 Series Methods - Quality Control**  
**Origins Laboratory, Inc.**

Analyte	Result	Reporting Limit	Units	Spike Level	Source Result	%REC	%REC Limits	RPD	RPD Limit	Notes
---------	--------	-----------------	-------	-------------	---------------	------	-------------	-----	-----------	-------

**Batch B3I0822 - EPA 3050B**

**Blank (B3I0822-BLK1)**

Prepared: 09/08/2023 Analyzed: 09/11/2023

Arsenic	ND	0.000100	mg/kg							U
Barium	ND	0.0100	"							U
Cadmium	ND	0.000100	"							U
Copper	ND	0.0100	"							U
Lead	ND	0.0100	"							U
Nickel	ND	0.0100	"							U
Selenium	ND	0.000100	"							U
Silver	ND	0.000100	"							U
Zinc	ND	0.100	"							U

**LCS (B3I0822-BS1)**

Prepared: 09/08/2023 Analyzed: 09/11/2023

Arsenic	0.0511	0.000100	mg/kg	0.0500		102	80-120			
Barium	4.96	0.0100	"	5.00		99.1	80-120			
Cadmium	0.0497	0.000100	"	0.0500		99.4	80-120			
Copper	0.547	0.0100	"	0.500		109	80-120			
Lead	0.0488	0.0100	"	0.0500		97.5	80-120			
Nickel	0.0539	0.0100	"	0.0500		108	80-120			
Selenium	0.0471	0.000100	"	0.0500		94.2	80-120			
Silver	0.0517	0.000100	"	0.0500		103	80-120			
Zinc	0.507	0.100	"	0.500		101	80-120			

**Matrix Spike (B3I0822-MS1)**

Source: Y309007-01

Prepared: 09/08/2023 Analyzed: 09/11/2023

Origins Laboratory, Inc.



*The results in this report apply to the samples analyzed in accordance with the chain of custody document. This analytical report must be reproduced in its entirety.*

Jen Pellegrini For Jordan A. Bynon, Project Manager

Eagle Environmental Consulting, LLC  
 8000 W 44th Ave  
 Wheat Ridge CO 80033

Martin C Eckert III  
 Project Number: [none]  
 Project: Noble - CPC Ferguson Chewy UPRC  
 T5N-R64W-S23L01 TB

**Metals by EPA 6000/7000 Series Methods - Quality Control**  
**Origins Laboratory, Inc.**

Analyte	Result	Reporting Limit	Units	Spike Level	Source Result	%REC	%REC Limits	RPD	RPD Limit	Notes
---------	--------	-----------------	-------	-------------	---------------	------	-------------	-----	-----------	-------

**Batch B3I0822 - EPA 3050B**

<b>Matrix Spike (B3I0822-MS1)</b>		<b>Source: Y309007-01</b>			<b>Prepared: 09/08/2023 Analyzed: 09/11/2023</b>					
Arsenic	6.57	0.0920	mg/kg	4.60	1.29	115	75-125			
Barium	483	9.20	"	460	27.2	98.9	75-125			
Cadmium	4.67	0.0920	"	4.60	0.0518	100	75-125			
Copper	51.6	9.20	"	46.0	2.63	106	75-125			
Lead	8.27	9.20	"	4.60	3.56	102	75-125			U
Nickel	8.19	9.20	"	4.60	2.95	114	75-125			U
Selenium	4.29	0.0920	"	4.60	0.0687	91.6	75-125			
Silver	4.85	0.0920	"	4.60	0.00753	105	75-125			
Zinc	59.0	92.0	"	46.0	12.7	101	75-125			U

<b>Matrix Spike Dup (B3I0822-MSD1)</b>		<b>Source: Y309007-01</b>			<b>Prepared: 09/08/2023 Analyzed: 09/11/2023</b>					
Arsenic	5.86	0.0877	mg/kg	4.39	1.29	104	75-125	11.4	20	
Barium	468	8.77	"	439	27.2	100	75-125	3.09	20	
Cadmium	4.55	0.0877	"	4.39	0.0518	103	75-125	2.65	20	
Copper	50.0	8.77	"	43.9	2.63	108	75-125	3.04	20	
Lead	8.74	8.77	"	4.39	3.56	118	75-125	5.54	20	U
Nickel	7.80	8.77	"	4.39	2.95	111	75-125	4.84	20	U
Selenium	3.97	0.0877	"	4.39	0.0687	89.1	75-125	7.57	20	
Silver	4.71	0.0877	"	4.39	0.00753	107	75-125	2.99	20	
Zinc	57.9	87.7	"	43.9	12.7	103	75-125	1.94	20	U

Origins Laboratory, Inc.



Jen Pellegrini For Jordan A. Bynon, Project Manager

*The results in this report apply to the samples analyzed in accordance with the chain of custody document. This analytical report must be reproduced in its entirety.*

Eagle Environmental Consulting, LLC  
 8000 W 44th Ave  
 Wheat Ridge CO 80033

Martin C Eckert III  
 Project Number: [none]  
 Project: Noble - CPC Ferguson Chewy UPRC  
 T5N-R64W-S23L01 TB

**EPA 8270E (SW846) - Semivolatile Organic Compounds - Quality Control**  
**Origins Laboratory, Inc.**

Analyte	Result	Reporting Limit	Units	Spike Level	Source Result	%REC	%REC Limits	RPD	RPD Limit	Notes
---------	--------	-----------------	-------	-------------	---------------	------	-------------	-----	-----------	-------

**Batch B3H2820 - EPA 3580**

**Blank (B3H2820-BLK1)**

Prepared: 08/28/2023 Analyzed: 08/28/2023

1-Methylnaphthalene	ND	0.002	mg/kg							U
2-Methylnaphthalene	ND	0.002	"							U
Acenaphthene	ND	0.020	"							U
Anthracene	ND	0.020	"							U
Benzo (a) anthracene	ND	0.005	"							U
Benzo (a) pyrene	ND	0.020	"							U
Benzo (b) fluoranthene	ND	0.020	"							U
Benzo (g,h,i) perylene	ND	0.020	"							U
Benzo (k) fluoranthene	ND	0.020	"							U
Chrysene	ND	0.020	"							U
Dibenz (a,h) anthracene	ND	0.020	"							U
Fluoranthene	ND	0.020	"							U
Fluorene	ND	0.020	"							U
Indeno (1,2,3-cd) pyrene	ND	0.020	"							U
Naphthalene	ND	0.002	"							U
Phenanthrene	ND	0.020	"							U
Pyrene	ND	0.020	"							U
Surrogate: Fluorene-d10	190		ug/kg	200		96.5	60-130			
Surrogate: Anthracene-d10	200		"	200		99.3	60-130			
Surrogate: Benzo (a) pyrene-d12	190		"	200		93.3	60-130			
Surrogate: Pyrene-d10	220		"	200		109	60-130			

**LCS (B3H2820-BS1)**

Prepared: 08/28/2023 Analyzed: 08/28/2023

1-Methylnaphthalene	0.218	0.002	mg/kg	0.200		109	70-130			
2-Methylnaphthalene	0.200	0.002	"	0.200		100	70-130			
Acenaphthene	0.204	0.020	"	0.200		102	70-130			
Anthracene	0.200	0.020	"	0.200		99.9	70-130			

Origins Laboratory, Inc.



Jen Pellegrini For Jordan A. Bynon, Project Manager

*The results in this report apply to the samples analyzed in accordance with the chain of custody document. This analytical report must be reproduced in its entirety.*

Eagle Environmental Consulting, LLC  
 8000 W 44th Ave  
 Wheat Ridge CO 80033

Martin C Eckert III  
 Project Number: [none]  
 Project: Noble - CPC Ferguson Chewy UPRC  
 T5N-R64W-S23L01 TB

**EPA 8270E (SW846) - Semivolatile Organic Compounds - Quality Control**  
**Origins Laboratory, Inc.**

Analyte	Result	Reporting Limit	Units	Spike Level	Source Result	%REC	%REC Limits	RPD	RPD Limit	Notes
---------	--------	-----------------	-------	-------------	---------------	------	-------------	-----	-----------	-------

**Batch B3H2820 - EPA 3580**

**LCS (B3H2820-BS1)**

Prepared: 08/28/2023 Analyzed: 08/28/2023

Benzo (a) anthracene	0.190	0.005	mg/kg	0.200		94.9	70-130			
Benzo (a) pyrene	0.181	0.020	"	0.200		90.4	70-130			
Benzo (b) fluoranthene	0.180	0.020	"	0.200		89.9	70-130			
Benzo (g,h,i) perylene	0.198	0.020	"	0.200		98.8	70-130			
Benzo (k) fluoranthene	0.209	0.020	"	0.200		105	70-130			
Chrysene	0.203	0.020	"	0.200		101	70-130			
Dibenz (a,h) anthracene	0.199	0.020	"	0.200		99.5	70-130			
Fluoranthene	0.186	0.020	"	0.200		92.9	70-130			
Fluorene	0.201	0.020	"	0.200		100	70-130			
Indeno (1,2,3-cd) pyrene	0.203	0.020	"	0.200		102	70-130			
Naphthalene	0.207	0.002	"	0.200		104	70-130			
Phenanthrene	0.191	0.020	"	0.200		95.5	70-130			
Pyrene	0.213	0.020	"	0.200		106	70-130			
Surrogate: Fluorene-d10	200		ug/kg	200		98.5	60-130			
Surrogate: Anthracene-d10	190		"	200		93.4	60-130			
Surrogate: Benzo (a) pyrene-d12	200		"	200		100	60-130			
Surrogate: Pyrene-d10	200		"	200		99.7	60-130			

**Matrix Spike (B3H2820-MS1)**

Source: Y308654-01

Prepared: 08/28/2023 Analyzed: 08/28/2023

1-Methylnaphthalene	0.224	0.002	mg/kg	0.200	ND	112	70-130			
2-Methylnaphthalene	0.206	0.002	"	0.200	ND	103	70-130			
Acenaphthene	0.204	0.020	"	0.200	0.004	100	70-130			
Anthracene	0.185	0.020	"	0.200	ND	92.3	70-130			
Benzo (a) anthracene	0.193	0.005	"	0.200	0.001	96.1	70-130			
Benzo (a) pyrene	0.175	0.020	"	0.200	ND	87.3	70-130			
Benzo (b) fluoranthene	0.178	0.020	"	0.200	ND	89.2	70-130			
Benzo (g,h,i) perylene	0.200	0.020	"	0.200	ND	100	70-130			

Origins Laboratory, Inc.



Jen Pellegrini For Jordan A. Bynon, Project Manager

The results in this report apply to the samples analyzed in accordance with the chain of custody document. This analytical report must be reproduced in its entirety.

Eagle Environmental Consulting, LLC  
 8000 W 44th Ave  
 Wheat Ridge CO 80033

Martin C Eckert III  
 Project Number: [none]  
 Project: Noble - CPC Ferguson Chewy UPRC  
 T5N-R64W-S23L01 TB

**EPA 8270E (SW846) - Semivolatile Organic Compounds - Quality Control**  
**Origins Laboratory, Inc.**

Analyte	Result	Reporting Limit	Units	Spike Level	Source Result	%REC	%REC Limits	RPD	RPD Limit	Notes
---------	--------	-----------------	-------	-------------	---------------	------	-------------	-----	-----------	-------

**Batch B3H2820 - EPA 3580**

<b>Matrix Spike (B3H2820-MS1)</b>		<b>Source: Y308654-01</b>			<b>Prepared: 08/28/2023 Analyzed: 08/28/2023</b>					
Benzo (k) fluoranthene	0.205	0.020	mg/kg	0.200	ND	103	70-130			
Chrysene	0.206	0.020	"	0.200	ND	103	70-130			
Dibenz (a,h) anthracene	0.189	0.020	"	0.200	ND	94.5	70-130			
Fluoranthene	0.163	0.020	"	0.200	ND	81.3	70-130			
Fluorene	0.196	0.020	"	0.200	ND	97.9	70-130			
Indeno (1,2,3-cd) pyrene	0.198	0.020	"	0.200	0.004	96.8	70-130			
Naphthalene	0.209	0.002	"	0.200	ND	104	70-130			
Phenanthrene	0.188	0.020	"	0.200	0.0003	94.0	70-130			
Pyrene	0.251	0.020	"	0.200	ND	125	70-130			
Surrogate: Fluorene-d10	190		ug/kg	200		95.8	60-130			
Surrogate: Anthracene-d10	190		"	200		95.7	60-130			
Surrogate: Benzo (a) pyrene-d12	200		"	200		102	60-130			
Surrogate: Pyrene-d10	240		"	200		121	60-130			

<b>Matrix Spike Dup (B3H2820-MSD1)</b>		<b>Source: Y308654-01</b>			<b>Prepared: 08/28/2023 Analyzed: 08/28/2023</b>					
1-Methylnaphthalene	0.224	0.002	mg/kg	0.200	ND	112	70-130	0.0562	20	
2-Methylnaphthalene	0.200	0.002	"	0.200	ND	100	70-130	2.94	20	
Acenaphthene	0.199	0.020	"	0.200	0.004	97.1	70-130	2.86	20	
Anthracene	0.169	0.020	"	0.200	ND	84.3	70-130	8.98	20	
Benzo (a) anthracene	0.189	0.005	"	0.200	0.001	93.7	70-130	2.51	20	
Benzo (a) pyrene	0.178	0.020	"	0.200	ND	88.9	70-130	1.81	20	
Benzo (b) fluoranthene	0.179	0.020	"	0.200	ND	89.6	70-130	0.473	20	
Benzo (g,h,i) perylene	0.209	0.020	"	0.200	ND	105	70-130	4.37	20	
Benzo (k) fluoranthene	0.238	0.020	"	0.200	ND	119	70-130	14.7	20	
Chrysene	0.200	0.020	"	0.200	ND	99.8	70-130	3.21	20	
Dibenz (a,h) anthracene	0.193	0.020	"	0.200	ND	96.3	70-130	1.97	20	
Fluoranthene	0.161	0.020	"	0.200	ND	80.3	70-130	1.22	20	

Origins Laboratory, Inc.



Jen Pellegrini For Jordan A. Bynon, Project Manager

*The results in this report apply to the samples analyzed in accordance with the chain of custody document. This analytical report must be reproduced in its entirety.*

Eagle Environmental Consulting, LLC  
 8000 W 44th Ave  
 Wheat Ridge CO 80033

Martin C Eckert III  
 Project Number: [none]  
 Project: Noble - CPC Ferguson Chewy UPRC  
 T5N-R64W-S23L01 TB

**EPA 8270E (SW846) - Semivolatile Organic Compounds - Quality Control**  
**Origins Laboratory, Inc.**

Analyte	Result	Reporting Limit	Units	Spike Level	Source Result	%REC	%REC Limits	RPD	RPD Limit	Notes
---------	--------	-----------------	-------	-------------	---------------	------	-------------	-----	-----------	-------

Batch B3H2820 - EPA 3580

Matrix Spike Dup (B3H2820-MSD1)	Source: Y308654-01			Prepared: 08/28/2023 Analyzed: 08/28/2023						
Fluorene	0.191	0.020	mg/kg	0.200	ND	95.4	70-130	2.61	20	
Indeno (1,2,3-cd) pyrene	0.185	0.020	"	0.200	0.004	90.1	70-130	6.93	20	
Naphthalene	0.204	0.002	"	0.200	ND	102	70-130	2.47	20	
Phenanthrene	0.186	0.020	"	0.200	0.0003	92.7	70-130	1.44	20	
Pyrene	0.248	0.020	"	0.200	ND	124	70-130	0.977	20	
Surrogate: Fluorene-d10	190		ug/kg	200		96.0	60-130			
Surrogate: Anthracene-d10	200		"	200		97.7	60-130			
Surrogate: Benzo (a) pyrene-d12	210		"	200		103	60-130			
Surrogate: Pyrene-d10	230		"	200		117	60-130			

Origins Laboratory, Inc.



Jen Pellegrini For Jordan A. Bynon, Project Manager

*The results in this report apply to the samples analyzed in accordance with the chain of custody document. This analytical report must be reproduced in its entirety.*

Eagle Environmental Consulting, LLC  
 8000 W 44th Ave  
 Wheat Ridge CO 80033

Martin C Eckert III  
 Project Number: [none]  
 Project: Noble - CPC Ferguson Chewy UPRC  
 T5N-R64W-S23L01 TB

**Classical Chemistry Parameters - Quality Control**  
**Origins Laboratory, Inc.**

Analyte	Result	Reporting Limit	Units	Spike Level	Source Result	%REC	%REC Limits	RPD	RPD Limit	Notes
---------	--------	-----------------	-------	-------------	---------------	------	-------------	-----	-----------	-------

**Batch B3H3006 - Saturated Paste Metals**

**Blank (B3H3006-BLK1)**

Prepared: 08/30/2023 Analyzed: 09/01/2023

SAR	ND	0.0100	SAR							U
Calcium PPM	ND	10.0	mg/L							U
Magnesium PPM	ND	10.0	"							U
Sodium PPM	ND	10.0	"							U

**Duplicate (B3H3006-DUP1)**

Source: Y308650-01

Prepared: 08/30/2023 Analyzed: 09/01/2023

SAR	ND	0.0100	SAR		0.966				200	U
Calcium PPM	15.5	10.0	mg/L		13.8			12.0	50	
Magnesium PPM	17.8	10.0	"		16.5			7.63	50	
Sodium PPM	25.8	10.0	"		22.5			13.7	50	

**Batch B3H3010 - DTPA Sorbitol Preparation**

**Blank (B3H3010-BLK1)**

Prepared: 08/30/2023 Analyzed: 09/01/2023

Boron	ND	0.100	mg/L							U
-------	----	-------	------	--	--	--	--	--	--	---

**Duplicate (B3H3010-DUP1)**

Source: Y308654-01

Prepared: 08/30/2023 Analyzed: 09/01/2023

Boron	ND	0.102	mg/L		ND				50	U
-------	----	-------	------	--	----	--	--	--	----	---

**Batch B3H3011 - DTPA Sorbitol Preparation**

**Blank (B3H3011-BLK1)**

Prepared: 08/30/2023 Analyzed: 09/01/2023

Boron	ND	0.100	mg/L							U
-------	----	-------	------	--	--	--	--	--	--	---

**Duplicate (B3H3011-DUP1)**

Source: Y308654-07

Prepared: 08/30/2023 Analyzed: 09/01/2023

Boron	ND	0.0992	mg/L		ND				50	U
-------	----	--------	------	--	----	--	--	--	----	---

Origins Laboratory, Inc.



Jen Pellegrini For Jordan A. Bynon, Project Manager

*The results in this report apply to the samples analyzed in accordance with the chain of custody document. This analytical report must be reproduced in its entirety.*

Eagle Environmental Consulting, LLC  
 8000 W 44th Ave  
 Wheat Ridge CO 80033

Martin C Eckert III  
 Project Number: [none]  
 Project: Noble - CPC Ferguson Chewy UPRC  
 T5N-R64W-S23L01 TB

**Saturated Paste - Quality Control**  
**Origins Laboratory, Inc.**

Analyte	Result	Reporting Limit	Units	Spike Level	Source Result	%REC	%REC Limits	RPD	RPD Limit	Notes
<b>Batch B3H3016 - Saturated Paste pH/EC</b>										
<b>Blank (B3H3016-BLK1)</b>					Prepared: 08/30/2023 Analyzed: 08/31/2023					
Specific Conductance (EC)	ND	0.00500	mmhos/cm							U
<b>Duplicate (B3H3016-DUP1)</b>					<b>Source: Y308650-01</b> Prepared: 08/30/2023 Analyzed: 08/31/2023					
pH	8.34		pH Units		8.33			0.120	25	
Specific Conductance (EC)	0.370	0.00500	mmhos/cm		0.346			6.72	25	

Origins Laboratory, Inc.



Jen Pellegrini For Jordan A. Bynon, Project Manager

*The results in this report apply to the samples analyzed in accordance with the chain of custody document. This analytical report must be reproduced in its entirety.*

Eagle Environmental Consulting, LLC  
 8000 W 44th Ave  
 Wheat Ridge CO 80033

Martin C Eckert III  
 Project Number: [none]  
 Project: Noble - CPC Ferguson Chewy UPRC  
 T5N-R64W-S23L01 TB

**Total Metals by 7196A - Quality Control**  
**Waypoint Analytical, LLC.**

Analyte	Result	Reporting Limit	Units	Spike Level	Source Result	%REC	%REC Limits	RPD	RPD Limit	Notes
<b>Batch L704340 -</b>										
<b>DUP (L 88899-DUP)</b>		<b>Source: 88899</b>			Prepared: Analyzed: 09/14/2023					
Chromium, Hexavalent	ND	0.503	mg/Kg		<0.503		-	0	20	
<b>MS (L 88899-MS)</b>		<b>Source: 88899</b>			Prepared: Analyzed: 09/14/2023					
Chromium, Hexavalent	36.2	2.5	mg/Kg	40.1	<1.22	90	75-125			
<b>LCS (LCS)</b>		Prepared: Analyzed: 09/14/2023								
Chromium, Hexavalent	6.67	0.5	mg/Kg	8		83	75-125			
<b>LRB (LRB)</b>		Prepared: Analyzed: 09/14/2023								
Chromium, Hexavalent	ND	0.5	mg/Kg				-			

Origins Laboratory, Inc.



Jen Pellegrini For Jordan A. Bynon, Project Manager

*The results in this report apply to the samples analyzed in accordance with the chain of custody document. This analytical report must be reproduced in its entirety.*

Eagle Environmental Consulting, LLC  
8000 W 44th Ave  
Wheat Ridge CO 80033

Martin C Eckert III  
Project Number: [none]  
Project: Noble - CPC Ferguson Chewy UPRC  
T5N-R64W-S23L01 TB

### Notes and Definitions

U Sample is Non-Detect.

S-04 The surrogate recovery for this sample is outside of established control limits due to a sample matrix effect.

QR-02 The RPD result exceeded the QC control limits; however, both percent recoveries were acceptable. Sample results for the QC batch were accepted based on percent recoveries and completeness of QC data.

ND Analyte NOT DETECTED at or above the reporting limit

RPD Relative Percent Difference

All soil results are reported on a wet weight basis.

Calculated results may use J-flag data (instead of reported "ND") as part of calculation to provide a more accurate result.

Origins Laboratory, Inc.



Jen Pellegrini For Jordan A. Bynon, Project Manager

*The results in this report apply to the samples analyzed in accordance with the chain of custody document. This analytical report must be reproduced in its entirety.*