

Wellhead Closure Checklist						
COGCC Rule 911.a.(4) Environmental Site Closure Assessment Field Form						
Additional attachments (optional):		Pit Closure		Tank Battery Closure		Flowline Closure
Site Name & COGCC Facility Number: Borys C #22-20		Date: 05/22/23				Remediation Project #: 27645
Associated Wells: 05-123-25498		Age of Site: Years				Number of Photos Attached: 1
Location: (GPS coordinates of wellhead or southeastern most wellhead for multiple)					40.298370 / -104.540976	
General Condition of Site: (General observations regarding housekeeping, corrosion, waste management, etc.)						
Good Condition						
USCS Soil Type: Clayey SAND				Estimated Depth to Groundwater: Approx. 20-30'		
Hydrocarbon Impacted Soils / Spills: (Note estimated size and if impact appears to be surficial or extends to an unknown depth)						
None observed.						
Salt Crusted Soils or Impacted Vegetation: (Note estimated size and if impact appears to be surficial or extends to an unknown depth)						
None observed.						
Wellhead(s)						
Well API	05-123-25498					
Age	Years					
Condition of surface around wellhead	Good					
PID Readings	N/A - Excavated Upon Arrival					
Condition of subsurface (staining present)	Good - No Staining or Odor					
PID Readings	0.9	0.5	0.4	0.3	1.0	
Sample taken? Location/Sample ID#	WH-SS-01	WH-SS-02	WH-SS-03	WH-SS-04	WH-FS-01	
Photo Number(s)	See photolog					
Other observations regarding wellheads:						
Well casing cut/capped following assessment.						
Summary						
Was impacted soil identified?						
<input checked="" type="checkbox"/> No Yes - less than 10 cubic yards Yes - more than 10 cubic yards						
Total number of samples field screened: 5				Total number of samples collected: 5		
Highest PID Reading: 1.0				Total number of samples submitted to lab for analysis: 1		
If more than 10 cubic yards of impacted soil were observed:						
Vertical extent:				Estimated spill volume:		
Lateral extent: N/A				Volume of soil removed:		
Is additional investigation required?						
Was groundwater encountered during the investigation?						
<input checked="" type="checkbox"/> No Yes - not impacted or in contact with impacted soils Yes - groundwater impacted and/or in contact with impacted soils						
Measured depth to groundwater:				Was remedial groundwater removal conducted? Yes No		
Date Groundwater was encountered:				Commencement date of removal:		
Sheen on groundwater? Yes No				Volume of groundwater removed prior to sampling:		
Free product observed? Yes No				Volume of groundwater removed post sampling:		
Total number of samples collected:				Total Volume of groundwater removed:		
Total number of samples submitted to lab for analysis:						



FIGURES

Figure 1: Topographic Site Location Map

Figure 2: Aerial Site Location Map

Figure 3: Soil Analytical Map

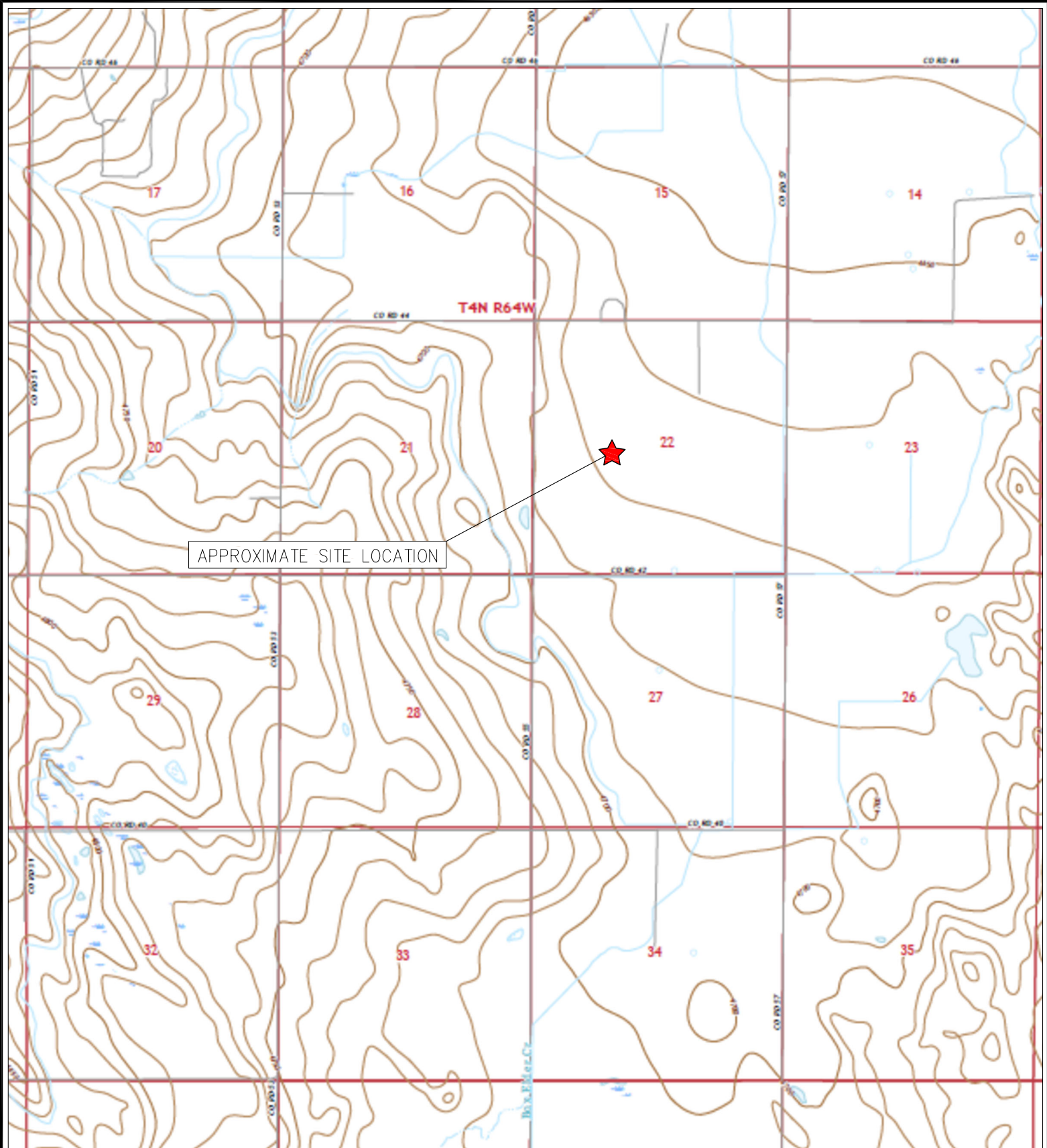

TOPOGRAPHIC SITE LOCATION MAP
 BORYS C #22-20
 CLOSURE ASSESSMENT
 40.298370 / -104.540976
 SE¼ NW¼ SEC.22 T4N R64W 6PM
 WELD COUNTY, COLORADO
 API # 05-123-25498
 REMEDIATION # 27645



EAGLE
 ENVIRONMENTAL
 CONSULTING, LLC



8000 W 44th Ave, Wheat Ridge, CO 80033
 Ph: 303-433-0479 • F: 303-325-5449

SOURCE: USGS 7.5 MINUTE TOPOGRAPHIC MAP
 VALLEY VIEW SCHOOL, CO QUADRANGLE 2022

FIGURE NO. 1



LEGEND

-  FORMER BORYS C #22-20 WELLHEAD (PLUGGED AND ABANDONED)
-  ASSOCIATED SEPARATOR
-  APPROXIMATE FLOWLINE LOCATION

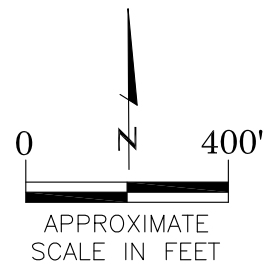

AERIAL SITE LOCATION MAP

BORYS C #22-20
CLOSURE ASSESSMENT
40.298370 / -104.540976
SE $\frac{1}{4}$ NW $\frac{1}{4}$ SEC.22 T4N R64W 6PM
WELD COUNTY, COLORADO
API # 05-123-25498
REMEDATION # 27645

FIGURE NO.

2

DRAWN BY:

GF



EAGLE
ENVIRONMENTAL
CONSULTING, LLC

8000 W 44th Ave, Wheat Ridge, CO 80033
Ph: 303-433-0479 • F: 303-325-5449

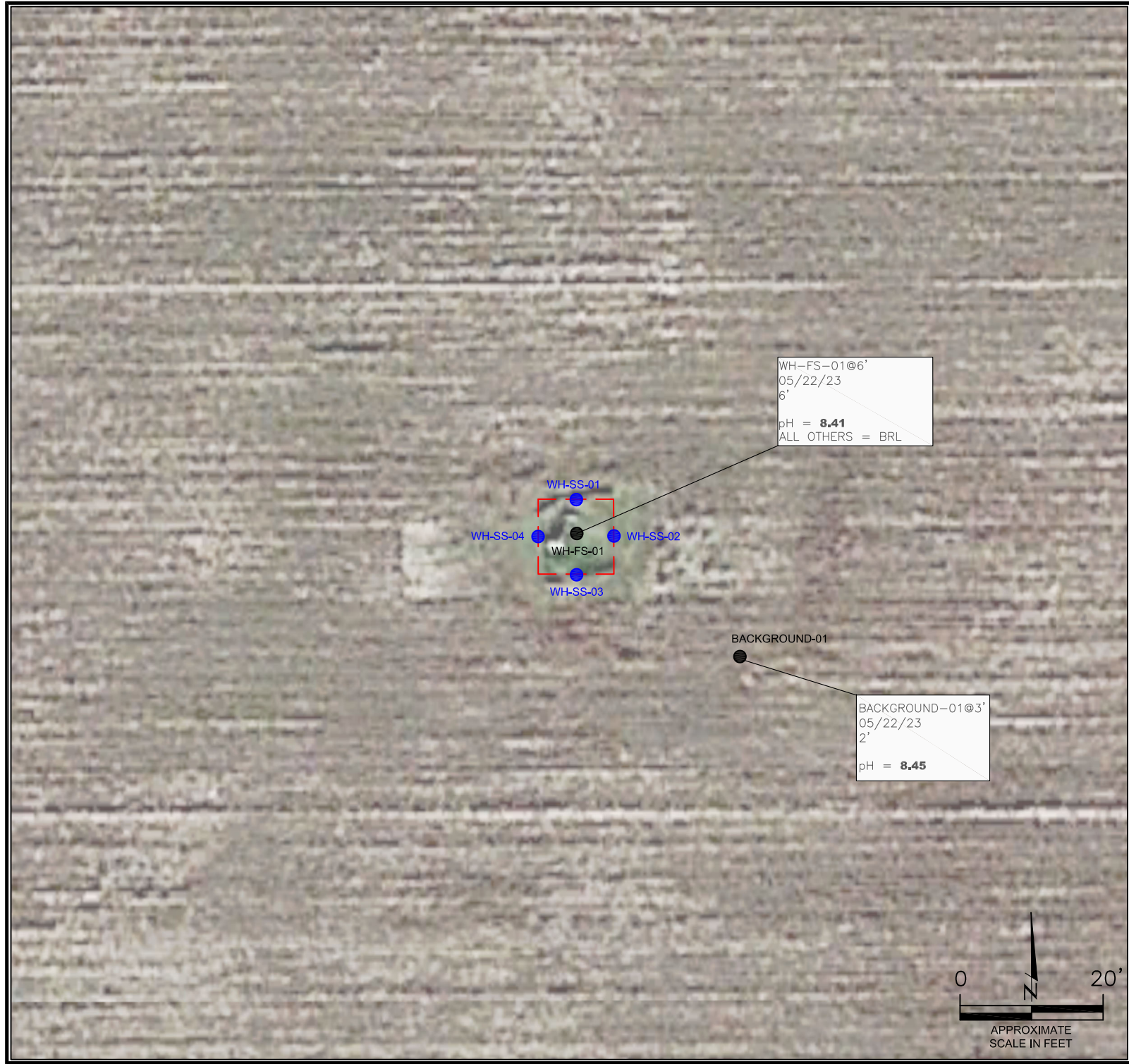

LEGEND

- WELLHEAD ASSESSMENT BOUNDARIES
- SS-02 APPROXIMATE LOCATION OF SOIL SAMPLES FIELD SCREENED, ONLY, WITH PHOTOIONIZATION DETECTOR
- SS-02 APPROXIMATE LOCATION OF SOIL SAMPLES SUBMITTED FOR LABORATORY ANALYSIS

PARAMETERS

SAMPLE LOCATION
DATE
DEPTH (FEET)
B = BENZENE (mg/kg)
T = TOLUENE (mg/kg)
E = ETHYLBENZENE (mg/kg)
X = TOTAL XYLENES (mg/kg)
N = NAPHTHALENE (mg/kg)
G = TPH-GRO (mg/kg)
D = TPH-DRO (mg/kg)
R = TPH-RRO (mg/kg)
1,2,4-TMB = 1,2,4 TRIMETHYLBENZENE (mg/kg)
1,3,5-TMB = 1,3,5 TRIMETHYLBENZENE (mg/kg)
Brn= BORON (mg/L)
EC = SPECIFIC CONDUCTANCE (mmhos/cm)
SAR= SODIUM ADSORPTION RATIO
pH = pH (pH UNITS)
POLYCYCLIC AROMATIC HYDROCARBONS (PAHs) (mg/kg)

mg/kg = MILLIGRAMS PER KILOGRAM
mg/L = MILLIGRAMS PER LITER
mmhos/cm = MILLIMHOS PER CENTIMETER

BRL = VALUES BELOW REGULATORY LIMITS

TPH-GRO = TOTAL PETROLEUM HYDROCARBONS - GASOLINE RANGE ORGANICS
TPH-DRO = TOTAL PETROLEUM HYDROCARBONS - DIESEL RANGE ORGANICS
TPH-RRO = TOTAL PETROLEUM HYDROCARBONS - RESIDUAL RANGE ORGANICS

NOTES:
VALUES PRESENTED IN **BOLD** EXCEED ECMC TABLE 915-1 REGULATORY LIMITS.

ECMC = ENERGY & CARBON MANAGEMENT COMMISSION

SOIL ANALYTICAL MAP
BORYS C #22-20
CLOSURE ASSESSMENT
40.298370 / -104.540976
SE¼ NW¼ SEC.22 T4N R64W 6PM
WELD COUNTY, COLORADO
API # 05-123-25498
REMEDATION # 27645

FIGURE NO.
3

DRAWN BY:
GF



EAGLE
ENVIRONMENTAL
CONSULTING, LLC
8000 W 44th Ave, Wheat Ridge, CO 80033
Ph: 303-433-0479 • F: 303-325-5449



TABLES

Table 1: Photoionization Detector Reading Summary

Table 2: Soil Analytical Results Summary

TABLE 1
PHOTOIONIZATION DETECTOR READING SUMMARY
BORYS C #22-20
CLOSURE ASSESSMENT
40.298370 / -104.540976
SE¼ NW¼ SEC.22 T4N R64W 6PM
WELD COUNTY, COLORADO
API # 05-123-25498
REMEDIAION # 27645

Sample Location (Latitude/Longitude)	Date	Approximate Depth (feet)	PID Reading (ppm-v)	Lab Submission (Y/N)
WH-SS-01 @ 5' (40.298384 / -104.540986)	05/22/23	5	0.9	N
WH-SS-02 @ 5' (40.298372 / -104.540964)	05/22/23	5	0.5	N
WH-SS-03 @ 5' (40.298357 / -104.540983)	05/22/23	5	0.4	N
WH-SS-04 @ 5' (40.298368 / -104.541002)	05/22/23	5	0.3	N
WH-FS-01 @ 6' (40.298370 / -104.540983)	05/22/23	6	1.0	Y
Background-01 @ 2' (40.298320 / -104.540901)	05/22/23	2	0.2	Y
(Y/N) = Yes or No ppm-v = parts per million by volume PID = Photoionization Detector				

TABLE 2
SOIL ANALYTICAL RESULTS SUMMARY
BORYS C #22-20
CLOSURE ASSESSMENT
40.298370 / -104.540976
SE¼ NW¼ SEC.22 T4N R64W 6PM
WELD COUNTY, COLORADO
API # 05-123-25498
REMEDATION # 27645

Sample Location				WH-FS-01 @ 6'	Background-01 @ 2'
(Latitude / Longitude)				(40.298370 / -104.540983)	(40.298320 / -104.540901)
Sample Date				5/22/2023	5/22/2023
Sample Depth				6'	2'
PID Reading (ppm-v)				1.0	0.2
Regulatory Limits					
Chemical of Concern	Units	ECMC Table 915-1 RSSLs	ECMC Table 915-1 GSSLs		
VOLATILE ORGANIC COMPOUNDS					
Benzene	mg/kg	1.2	0.0026	<0.00200	NA
Toluene	mg/kg	490	0.69	<0.00200	NA
Ethylbenzene	mg/kg	5.8	0.78	<0.00200	NA
Total Xylenes	mg/kg	58	9.9	<0.00200	NA
Naphthalene	mg/kg	2	0.0038	<0.00380	NA
1,2,4-Trimethylbenzene	mg/kg	30	0.0081	<0.00200	NA
1,3,5-Trimethylbenzene	mg/kg	27	0.0087	<0.00200	NA
TOTAL PETROLEUM HYDROCARBONS					
TPH-GRO	mg/kg	500	--	<0.200	NA
TPH-DRO	mg/kg	500	--	<25.0	NA
TPH-RRO	mg/kg	500	--	<100	NA
POLYCYCLIC AROMATIC HYDROCARBONS					
1-Methyl-naphthalene	mg/kg	18	0.006	<0.00201	NA
2-Methyl-naphthalene	mg/kg	24	0.019	<0.00201	NA
Acenaphthene	mg/kg	360	0.55	<0.00067	NA
Anthracene	mg/kg	1800	5.8	<0.00067	NA
Benzo(a)-anthracene	mg/kg	1.1	0.011	<0.00067	NA
Benzo(a)-pyrene	mg/kg	0.11	0.24	<0.00067	NA
Benzo(b)-fluoranthene	mg/kg	1.1	0.3	<0.00067	NA
Benzo(k)-fluoranthene	mg/kg	11	2.9	<0.00067	NA
Chrysene	mg/kg	110	9	<0.00067	NA
Dibenzo(a,h)-anthracene	mg/kg	0.11	0.096	<0.00067	NA
Fluoranthene	mg/kg	240	8.9	<0.00067	NA
Fluorene	mg/kg	240	0.54	<0.00067	NA
Indeno(1,2,3-cd)-pyrene	mg/kg	1.1	0.98	<0.00067	NA
Pyrene	mg/kg	180	1.3	<0.00067	NA
SOIL SUITABILITY (Inorganics)					
Boron	mg/L	2	--	0.320	NA
pH	standard unit	6-8.3	--	8.41	8.45
Sodium Adsorption Ratio (SAR)	--	<6	--	3.80	NA
Specific Conductance (EC)	mmhos/cm	<4	--	0.937	NA

ECMC = Energy & Carbon Management Commission

mg/kg = milligrams per kilogram

mmhos/cm = millimhos per centimeter

PID = Photoionization Detector

ppm-v = parts per million by volume

mg/L = milligrams per liter

NA = Not Analyzed

Notes:

Values presented with a less than symbol (<) did not contain concentrations at or above the laboratory reporting limit and/or minimum detection limit.

Values presented in **BOLD** exceed ECMC Table 915-1 Regulatory Limits.

RSSLs = Residential Soil Screening Levels

GSSLs = Protection of Groundwater Soil Screening Levels

TPH-GRO = Total Petroleum Hydrocarbons - Gasoline Range Organics

TPH-DRO = Total Petroleum Hydrocarbons - Diesel Range Organics

TPH-RRO = Total Petroleum Hydrocarbons - Residual Range Organics



ATTACHMENT A

Photo Log

Borys C #22-20
API # 05-123-25498
Remediation # 27645

Closure Assessment

May 2023



Wellhead Excavation – 05/22/23

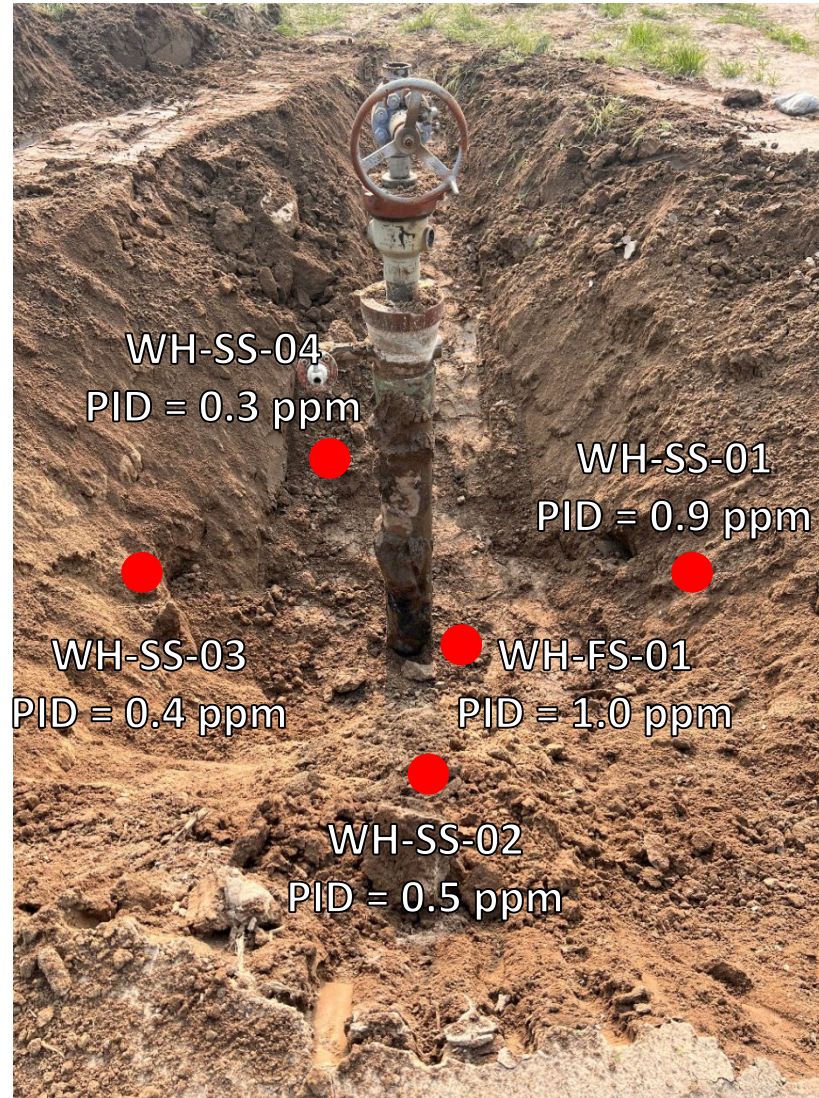

Looking west

No petroleum hydrocarbon staining or odor observed



ATTACHMENT B

Laboratory Analytical Reports



May 31, 2023

Eagle Environmental Consulting, LLC

Martin C Eckert III

8000 W 44th Ave

Wheat Ridge CO 80033

Project Name - Noble - Borys C #22-20

Project Number - [none]

Attached are your analytical results for Noble - Borys C #22-20 received by Origins Laboratory, Inc. May 22, 2023. This project is associated with Origins project number Y305556-01.

The analytical results in the following report were analyzed under the guidelines of EPA Methods. These methods are identified as follows; "SW" are defined in SW-846, "EPA" are defined in 40CFR part 136 and "SM" are defined in the most current revision of Standard Methods For the Examination of Water and Wastewater.

The analytical results apply specifically to the samples and analyses specified per the attached Chain of Custody. As such, this report shall not be reproduced except in full, without the written approval of Origin's laboratory.

Unless otherwise noted, the analytical results for all soil samples are reported on a wet weight basis. All analytical analyses were performed under NELAP guidelines unless noted by a data qualifier.

Any holding time exceedances, deviations from the method specifications or deviations from Origins Laboratory's Standard Operating Procedures are outlined in the case narrative.

Thank you for selecting Origins for your analytical needs. Please contact us with any questions concerning this report, or if we can help with anything at all.

Origins Laboratory, Inc.
303.433.1322
o-squad@oelabinc.com



1725 Elk Place, Denver, CO 80211 | Phone: 303.433.1322 | Fax: 303.265.9645

Eagle Environmental Consulting, LLC
8000 W 44th Ave
Wheat Ridge CO 80033

Martin C Eckert III
Project Number: [none]
Project: Noble - Borys C #22-20

CROSS REFERENCE REPORT

Sample ID	Laboratory ID	Matrix	Date Sampled	Date Received
WH-FS-01@6'	Y305556-01	Soil	May 22, 2023 8:28	05/22/2023 13:21

Origins Laboratory, Inc.



Jen Pellegrini For Jordan A. Bynon, Project Manager

The results in this report apply to the samples analyzed in accordance with the chain of custody document. This analytical report must be reproduced in its entirety.

Eagle Environmental Consulting, LLC
8000 W 44th Ave
Wheat Ridge CO 80033

Martin C Eckert III
Project Number: [none]
Project: Noble - Borys C #22-20

www.originslaboratory.com

305550

ORIGINS
LABORATORY, INC

page 1 of 1

Client: Eagle Environmental Consulting
Address: 8000 W 44th Ave
Telephone Number: 303-433-0479
Email Address: me3@eagle-enviro.com

Project Manager: Martin Eckert III
Project Name: Borys C #22-20
Project Number: —
Samples Collected By: IM

Sample ID Description	Date Sampled	Time Sampled	# of Containers	Preservative				Matrix			Analysis	Sample Instructions
				Unpreserved	HCl	HNO ₃	Other	Groundwater	Soil	Air Summa Canister #		
W11-ES-01 @ 6'	5/11/13	0838	3	X					X			EC SAR pH = 1
												Saturated quick prep 2
												3
												4
												5
												6
												7
												8
												9
												10

Turnaround Time:
Same Day ☐ 24 Hr ☐
48 Hr ☐ 72 Hr ☐
Standard ☒

Date Results Needed Noble

Temp Received- 5

Relinquished By: Bill to Cole

Origins Laboratory, Inc.

Jefe Pellegrini

Jen Pellegrini For Jordan A. Bynon, Project Manager

The results in this report apply to the samples analyzed in accordance with the chain of custody document. This analytical report must be reproduced in its entirety.

Eagle Environmental Consulting, LLC
8000 W 44th Ave
Wheat Ridge CO 80033

Martin C Eckert III
Project Number: [none]
Project: Noble - Borys C #22-20

Origins Laboratory

F-012207-01-R1
Effective Date: 01/09/12

Sample Receipt Checklist

Origins Work Order: 4305536

Client: Eagle Environ

Client Project ID: Borys C #22-20

Checklist Completed by: BT/LHS

Shipped Via: HL
(UPS, FedEx, Hand Delivered, Pick-up, etc.)

Date/time completed: 5/22/23

Airbill #: na

Matrix(s) Received: (Check all that apply): ☒ Soil/Solid ☐ Water ☐ Other: _____

Cooler Number/Temperature: 1/5 °C 1 °C 1 °C (Describe) °C

Thermometer ID: 7003

Requirement Description	Yes	No	N/A	Comments (if any)
If samples require cooling, was the temperature between 0°C to ≤ 6°C ⁽¹⁾ ?	<input checked="" type="checkbox"/>	<input type="checkbox"/>	<input type="checkbox"/>	
Is there ice present (document if blue ice is used)	<input checked="" type="checkbox"/>	<input type="checkbox"/>	<input type="checkbox"/>	
Are custody seals present on cooler? (if so, document in comments if they are signed and dated, broken or intact)	<input type="checkbox"/>	<input checked="" type="checkbox"/>	<input type="checkbox"/>	
Are custody seals present on each sample container? (if so, document in comments if they are signed and dated, broken or intact)	<input type="checkbox"/>	<input checked="" type="checkbox"/>	<input type="checkbox"/>	
Were all samples received intact ⁽¹⁾ ?	<input checked="" type="checkbox"/>	<input type="checkbox"/>	<input type="checkbox"/>	
Was adequate sample volume provided ⁽¹⁾ ?	<input checked="" type="checkbox"/>	<input type="checkbox"/>	<input type="checkbox"/>	
Are short holding time analytes or samples with HTs due within 48 hours present ⁽¹⁾ ?	<input type="checkbox"/>	<input checked="" type="checkbox"/>	<input type="checkbox"/>	
Is a chain-of-custody (COC) present and filled out completely ⁽¹⁾ ?	<input checked="" type="checkbox"/>	<input type="checkbox"/>	<input type="checkbox"/>	
Does the COC agree with the number and type of sample bottles received ⁽¹⁾ ?	<input checked="" type="checkbox"/>	<input type="checkbox"/>	<input type="checkbox"/>	
Do the sample IDs on the bottle labels match the COC ⁽¹⁾ ?	<input checked="" type="checkbox"/>	<input type="checkbox"/>	<input type="checkbox"/>	
Is the COC properly relinquished by the client with date and time recorded ⁽¹⁾ ?	<input checked="" type="checkbox"/>	<input type="checkbox"/>	<input type="checkbox"/>	
For volatiles in water – is there headspace (> ¼ inch bubble) present? If yes, contact client and note in narrative.	<input type="checkbox"/>	<input type="checkbox"/>	<input checked="" type="checkbox"/>	
Are samples preserved that require preservation and was it checked ⁽¹⁾ ? (note ID of confirmation instrument used in comments) / (preservation is not confirmed for subcontracted analyses in order to insure sample integrity)/(pH <2 for samples preserved with HNO ₃ , HCL, H ₂ SO ₄) / (pH >10 for samples preserved with NaAsO ₂ +NaOH, ZnAc+NaOH)	<input type="checkbox"/>	<input type="checkbox"/>	<input checked="" type="checkbox"/>	
Additional Comments (if any):				

⁽¹⁾ If NO, then contact the client before proceeding with analysis and note date/time and person contacted as well as the corrective action to in the additional comments (above) and the case narrative.

Reviewed by (Project Manager) [Signature]

Date/Time Reviewed 5/24/23

Origins Laboratory, Inc.

[Signature]

Jen Pellegrini For Jordan A. Bynon, Project Manager

The results in this report apply to the samples analyzed in accordance with the chain of custody document. This analytical report must be reproduced in its entirety.

Eagle Environmental Consulting, LLC
8000 W 44th Ave
Wheat Ridge CO 80033

Martin C Eckert III
Project Number: [none]
Project: Noble - Borys C #22-20

WH-FS-01@6'
5/22/2023 8:28:00AM

Analyte	Result	Min Detection Limit	Reporting Limit	Units	Dilution	Batch	Prepared	Analyzed	Notes
---------	--------	---------------------	-----------------	-------	----------	-------	----------	----------	-------

Origins Laboratory, Inc.
Y305556-01 (Soil)

Boron (DTPA Sorbitol)

Boron	0.320	0.101	mg/L	1	B3E2412	05/24/2023	05/25/2023	
-------	-------	-------	------	---	---------	------------	------------	--

DRO/ORO by EPA 8015D

Diesel (C10-C28)	ND	25.0	mg/kg	1	B3E2403	05/24/2023	05/24/2023	U
Residual Range Organics (C28-C40)	ND	100	"	"	"	"	"	U

Surrogate: o-Terphenyl	97.2 %	50-150			"	"	"	
------------------------	--------	--------	--	--	---	---	---	--

GBTEX+TMBs by 8260D

1,2,4-Trimethylbenzene	ND	0.00200	mg/kg	1	B3E2232	05/22/2023	05/24/2023	U
1,3,5-Trimethylbenzene	ND	0.00200	"	"	"	"	"	U
Benzene	ND	0.00200	"	"	"	"	"	U
Ethylbenzene	ND	0.00200	"	"	"	"	"	U
Naphthalene	ND	0.00380	"	"	"	"	"	U
Toluene	ND	0.00200	"	"	"	"	"	U
Xylenes, total	ND	0.00200	"	"	"	"	"	U
Gasoline Range Hydrocarbons	ND	0.200	"	"	"	"	"	U

Origins Laboratory, Inc.



The results in this report apply to the samples analyzed in accordance with the chain of custody document. This analytical report must be reproduced in its entirety.

Jen Pellegrini For Jordan A. Bynon, Project Manager

Eagle Environmental Consulting, LLC
8000 W 44th Ave
Wheat Ridge CO 80033

Martin C Eckert III
Project Number: [none]
Project: Noble - Borys C #22-20

WH-FS-01@6'

5/22/2023 8:28:00AM

Analyte	Result	Min Detection Limit	Reporting Limit	Units	Dilution	Batch	Prepared	Analyzed	Notes
---------	--------	---------------------	-----------------	-------	----------	-------	----------	----------	-------

Origins Laboratory, Inc.
Y305556-01 (Soil)

GBTEX+TMBs by 8260D

Surrogate: 1,2-Dichloroethane-d4	94.5 %		70-130			B3E22 32	05/22/2023	05/24/2023	
Surrogate: Toluene-d8	85.9 %		70-130			"	"	"	
Surrogate: 4-Bromofluorobenzene	106 %		70-130			"	"	"	

Metals by Saturated Paste by EPA 6010

Calcium	2.64		0.499	meq/L	10	[CALC]	05/24/2023	05/25/2023	
Magnesium	1.06		0.823	"	"	"	"	"	
Sodium	5.17		0.435	"	"	"	"	"	

PAH by 8270D SIM

1-Methylnaphthalene	ND	0.00109	0.00201	mg/Kg	1	L684102	05/25/2023	05/26/2023	
2-Methylnaphthalene	ND	0.00194	0.00201	"	"	"	"	"	
Acenaphthene	ND	0.000304	0.00067	"	"	"	"	"	
Anthracene	ND	0.000334	0.00067	"	"	"	"	"	
Benzo(a)anthracene	ND	0.000493	0.00067	"	"	"	"	"	
Benzo(a)pyrene	ND	0.000468	0.00067	"	"	"	"	"	
Benzo(b)fluoranthene	ND	0.000585	0.00067	"	"	"	"	"	
Benzo(k)fluoranthene	ND	0.000437	0.00067	"	"	"	"	"	
Chrysene	ND	0.000624	0.00067	"	"	"	"	"	
Dibenz(a,h)anthracene	ND	0.000614	0.00067	"	"	"	"	"	

Origins Laboratory, Inc.



The results in this report apply to the samples analyzed in accordance with the chain of custody document. This analytical report must be reproduced in its entirety.

Jen Pellegrini For Jordan A. Bynon, Project Manager

Eagle Environmental Consulting, LLC
8000 W 44th Ave
Wheat Ridge CO 80033

Martin C Eckert III
Project Number: [none]
Project: Noble - Borys C #22-20

WH-FS-01@6'

5/22/2023 8:28:00AM

Analyte	Result	Min Detection Limit	Reporting Limit	Units	Dilution	Batch	Prepared	Analyzed	Notes
---------	--------	---------------------	-----------------	-------	----------	-------	----------	----------	-------

Waypoint Analytical, LLC.
Y305556-01 (Soil)

PAH by 8270D SIM

Fluoranthene	ND	0.000394	0.00067	mg/Kg	1	L684102	05/25/2023	05/26/2023
Fluorene	ND	0.000286	0.00067	"	"	"	"	"
Indeno(1,2,3-cd)pyrene	ND	0.000627	0.00067	"	"	"	"	"
Pyrene	ND	0.000643	0.00067	"	"	"	"	"

Surrogate: 2-Fluorobiphenyl	58.9 %	33-115	"	"	"
Surrogate: 4-Terphenyl-d14	65.5 %	33-122	"	"	"
Surrogate: Nitrobenzene-d5	53.8 %	29-110	"	"	"

pH in Soil by 9045D

pH	8.41	pH Units	1	B3E2415	05/24/2023	05/25/2023
----	------	----------	---	---------	------------	------------

SAR by 20B Saturated Paste

SAR	3.80	SAR	1	B3E2409	05/24/2023	05/25/2023
-----	------	-----	---	---------	------------	------------

Specific Conductance Mod. 9050A

Specific Conductance (EC)	0.937	0.00500	mmhos/cm	1	B3E2415	05/24/2023	05/25/2023
---------------------------	-------	---------	----------	---	---------	------------	------------

Origins Laboratory, Inc.



The results in this report apply to the samples analyzed in accordance with the chain of custody document. This analytical report must be reproduced in its entirety.

Jen Pellegrini For Jordan A. Bynon, Project Manager

Eagle Environmental Consulting, LLC
8000 W 44th Ave
Wheat Ridge CO 80033

Martin C Eckert III
Project Number: [none]
Project: Noble - Borys C #22-20

Volatile Organic Compounds by GC/MS SW846 8260D - Quality Control
Origins Laboratory, Inc.

Analyte	Result	Reporting Limit	Units	Spike Level	Source Result	%REC	%REC Limits	RPD	RPD Limit	Notes
Batch B3E2232 - EPA 5030 (soil)										
Blank (B3E2232-BLK1)					Prepared: 05/24/2023 Analyzed: 05/24/2023					
1,2,4-Trimethylbenzene	ND	0.00200	mg/kg							U
1,3,5-Trimethylbenzene	ND	0.00200	"							U
Benzene	ND	0.00200	"							U
Ethylbenzene	ND	0.00200	"							U
Naphthalene	ND	0.00380	"							U
Toluene	ND	0.00200	"							U
Xylenes, total	ND	0.00200	"							U
Gasoline Range Hydrocarbons	ND	0.200	"							U
Surrogate: 1,2-Dichloroethane-d4	0.11		"	0.125	90.2		70-130			
Surrogate: Toluene-d8	0.11		"	0.125	88.3		70-130			
Surrogate: 4-Bromofluorobenzene	0.13		"	0.125	104		70-130			

Origins Laboratory, Inc.



Jen Pellegrini For Jordan A. Bynon, Project Manager

The results in this report apply to the samples analyzed in accordance with the chain of custody document. This analytical report must be reproduced in its entirety.

Eagle Environmental Consulting, LLC
8000 W 44th Ave
Wheat Ridge CO 80033

Martin C Eckert III
Project Number: [none]
Project: Noble - Borys C #22-20

Volatile Organic Compounds by GC/MS SW846 8260D - Quality Control
Origins Laboratory, Inc.

Analyte	Result	Reporting Limit	Units	Spike Level	Source Result	%REC	%REC Limits	RPD	RPD Limit	Notes
---------	--------	-----------------	-------	-------------	---------------	------	-------------	-----	-----------	-------

Batch B3E2232 - EPA 5030 (soil)

LCS (B3E2232-BS1)

Prepared: 05/24/2023 Analyzed: 05/24/2023

1,2,4-Trimethylbenzene	0.0942	0.00200	mg/kg	0.100		94.2	70-130			
1,3,5-Trimethylbenzene	0.0980	0.00200	"	0.100		98.0	70-130			
Benzene	0.100	0.00200	"	0.100		100	70-130			
Ethylbenzene	0.110	0.00200	"	0.100		110	70-130			
Naphthalene	0.0858	0.00380	"	0.100		85.8	70-130			
Toluene	0.103	0.00200	"	0.100		103	70-130			
o-Xylene	0.0975	0.00200	"	0.100		97.5	70-130			
m,p-Xylene	0.217	0.00400	"	0.200		109	70-130			
Surrogate: 1,2-Dichloroethane-d4	0.12		"	0.125		93.0	70-130			
Surrogate: Toluene-d8	0.11		"	0.125		86.6	70-130			
Surrogate: 4-Bromofluorobenzene	0.13		"	0.125		102	70-130			

Origins Laboratory, Inc.



Jen Pellegrini For Jordan A. Bynon, Project Manager

The results in this report apply to the samples analyzed in accordance with the chain of custody document. This analytical report must be reproduced in its entirety.

Eagle Environmental Consulting, LLC
8000 W 44th Ave
Wheat Ridge CO 80033

Martin C Eckert III
Project Number: [none]
Project: Noble - Borys C #22-20

Volatile Organic Compounds by GC/MS SW846 8260D - Quality Control
Origins Laboratory, Inc.

Analyte	Result	Reporting Limit	Units	Spike Level	Source Result	%REC	%REC Limits	RPD	RPD Limit	Notes
Batch B3E2232 - EPA 5030 (soil)										
Matrix Spike (B3E2232-MS1)		Source: Y305528-01			Prepared: 05/24/2023 Analyzed: 05/24/2023					
1,2,4-Trimethylbenzene	0.0908	0.00200	mg/kg	0.100	ND	90.8	70-130			
1,3,5-Trimethylbenzene	0.0952	0.00200	"	0.100	ND	95.2	70-130			
Benzene	0.0991	0.00200	"	0.100	ND	99.1	70-130			
Ethylbenzene	0.0952	0.00200	"	0.100	ND	95.2	70-130			
Naphthalene	0.0856	0.00380	"	0.100	ND	85.6	70-130			
Toluene	0.0817	0.00200	"	0.100	ND	81.7	70-130			
o-Xylene	0.0926	0.00200	"	0.100	ND	92.6	70-130			
m,p-Xylene	0.189	0.00400	"	0.200	ND	94.6	70-130			
Surrogate: 1,2-Dichloroethane-d4	0.12		"	0.125		95.4	70-130			
Surrogate: Toluene-d8	0.11		"	0.125		86.0	70-130			
Surrogate: 4-Bromofluorobenzene	0.13		"	0.125		105	70-130			

Origins Laboratory, Inc.



Jen Pellegrini For Jordan A. Bynon, Project Manager

The results in this report apply to the samples analyzed in accordance with the chain of custody document. This analytical report must be reproduced in its entirety.

Eagle Environmental Consulting, LLC
8000 W 44th Ave
Wheat Ridge CO 80033

Martin C Eckert III
Project Number: [none]
Project: Noble - Borys C #22-20

Volatile Organic Compounds by GC/MS SW846 8260D - Quality Control
Origins Laboratory, Inc.

Analyte	Result	Reporting Limit	Units	Spike Level	Source Result	%REC	%REC Limits	RPD	RPD Limit	Notes
Batch B3E2232 - EPA 5030 (soil)										
Matrix Spike Dup (B3E2232-MSD1)		Source: Y305528-01			Prepared: 05/24/2023 Analyzed: 05/24/2023					
1,2,4-Trimethylbenzene	0.0910	0.00200	mg/kg	0.100	ND	91.0	70-130	0.198	20	
1,3,5-Trimethylbenzene	0.0945	0.00200	"	0.100	ND	94.5	70-130	0.696	20	
Benzene	0.0998	0.00200	"	0.100	ND	99.8	70-130	0.664	20	
Ethylbenzene	0.0928	0.00200	"	0.100	ND	92.8	70-130	2.60	20	
Naphthalene	0.0901	0.00380	"	0.100	ND	90.1	70-130	5.19	20	
Toluene	0.0814	0.00200	"	0.100	ND	81.4	70-130	0.417	20	
o-Xylene	0.0910	0.00200	"	0.100	ND	91.0	70-130	1.76	20	
m,p-Xylene	0.184	0.00400	"	0.200	ND	91.9	70-130	2.82	20	
Surrogate: 1,2-Dichloroethane-d4	0.12		"	0.125		95.8	70-130			
Surrogate: Toluene-d8	0.11		"	0.125		84.6	70-130			
Surrogate: 4-Bromofluorobenzene	0.13		"	0.125		103	70-130			

Origins Laboratory, Inc.



Jen Pellegrini For Jordan A. Bynon, Project Manager

The results in this report apply to the samples analyzed in accordance with the chain of custody document. This analytical report must be reproduced in its entirety.

Eagle Environmental Consulting, LLC
8000 W 44th Ave
Wheat Ridge CO 80033

Martin C Eckert III
Project Number: [none]
Project: Noble - Borys C #22-20

Volatile Organic Compounds by GC/MS SW846 8260D - Quality Control

Origins Laboratory, Inc.

Analyte	Result	Reporting Limit	Units	Spike Level	Source Result	%REC	%REC Limits	RPD	RPD Limit	Notes
Batch B3E2403 - EPA 3550B										
Blank (B3E2403-BLK1)					Prepared: 05/24/2023 Analyzed: 05/24/2023					
Diesel (C10-C28)	ND	25.0	mg/kg							U
Residual Range Organics (C28-C40)	ND	100	"							U
Surrogate: o-Terphenyl	24		"	24.9		98.4	50-150			

Origins Laboratory, Inc.



Jen Pellegrini For Jordan A. Bynon, Project Manager

The results in this report apply to the samples analyzed in accordance with the chain of custody document. This analytical report must be reproduced in its entirety.

Eagle Environmental Consulting, LLC
8000 W 44th Ave
Wheat Ridge CO 80033

Martin C Eckert III
Project Number: [none]
Project: Noble - Borys C #22-20

Extractable Petroleum Hydrocarbons by 8015D - Quality Control
Origins Laboratory, Inc.

Analyte	Result	Reporting Limit	Units	Spike Level	Source Result	%REC	%REC Limits	RPD	RPD Limit	Notes
Batch B3E2403 - EPA 3550B										
LCS (B3E2403-BS1)					Prepared: 05/24/2023 Analyzed: 05/24/2023					
Diesel (C10-C28)	847	50.0	mg/kg	1000		84.7	70-130			
Residual Range Organics (C28-C40)	854	200	"	1000		85.4	70-130			
Surrogate: o-Terphenyl	48		"	49.8		96.8	50-150			

Origins Laboratory, Inc.



Jen Pellegrini For Jordan A. Bynon, Project Manager

The results in this report apply to the samples analyzed in accordance with the chain of custody document. This analytical report must be reproduced in its entirety.

Eagle Environmental Consulting, LLC
8000 W 44th Ave
Wheat Ridge CO 80033

Martin C Eckert III
Project Number: [none]
Project: Noble - Borys C #22-20

Extractable Petroleum Hydrocarbons by 8015D - Quality Control
Origins Laboratory, Inc.

Analyte	Result	Reporting Limit	Units	Spike Level	Source Result	%REC	%REC Limits	RPD	RPD Limit	Notes
---------	--------	-----------------	-------	-------------	---------------	------	-------------	-----	-----------	-------

Batch B3E2403 - EPA 3550B

Matrix Spike (B3E2403-MS1)		Source: Y305556-01			Prepared: 05/24/2023 Analyzed: 05/24/2023					
Diesel (C10-C28)	865	50.0	mg/kg	1000	ND	86.5	70-130			
Residual Range Organics (C28-C40)	881	200	"	1000	ND	88.1	70-130			
Surrogate: o-Terphenyl	47		"	49.8		94.9	50-150			

Origins Laboratory, Inc.



Jen Pellegrini For Jordan A. Bynon, Project Manager

The results in this report apply to the samples analyzed in accordance with the chain of custody document. This analytical report must be reproduced in its entirety.

Eagle Environmental Consulting, LLC
8000 W 44th Ave
Wheat Ridge CO 80033

Martin C Eckert III
Project Number: [none]
Project: Noble - Borys C #22-20

Extractable Petroleum Hydrocarbons by 8015D - Quality Control
Origins Laboratory, Inc.

Analyte	Result	Reporting Limit	Units	Spike Level	Source Result	%REC	%REC Limits	RPD	RPD Limit	Notes
Batch B3E2403 - EPA 3550B										
Matrix Spike Dup (B3E2403-MSD1)		Source: Y305556-01			Prepared: 05/24/2023 Analyzed: 05/24/2023					
Diesel (C10-C28)	827	50.0	mg/kg	1000	ND	82.7	70-130	4.52	35	
Residual Range Organics (C28-C40)	844	200	"	1000	ND	84.4	70-130	4.26	35	
Surrogate: o-Terphenyl	52		"	49.8		105	50-150			

Origins Laboratory, Inc.



Jen Pellegrini For Jordan A. Bynon, Project Manager

The results in this report apply to the samples analyzed in accordance with the chain of custody document. This analytical report must be reproduced in its entirety.

Eagle Environmental Consulting, LLC
8000 W 44th Ave
Wheat Ridge CO 80033

Martin C Eckert III
Project Number: [none]
Project: Noble - Borys C #22-20

Extractable Petroleum Hydrocarbons by 8015D - Quality Control

Origins Laboratory, Inc.

Analyte	Result	Reporting Limit	Units	Spike Level	Source Result	%REC	%REC Limits	RPD	RPD Limit	Notes
---------	--------	-----------------	-------	-------------	---------------	------	-------------	-----	-----------	-------

Classical Chemistry Parameters - Quality Control

Origins Laboratory, Inc.

Analyte	Result	Reporting Limit	Units	Spike Level	Source Result	%REC	%REC Limits	RPD	RPD Limit	Notes
---------	--------	-----------------	-------	-------------	---------------	------	-------------	-----	-----------	-------

Batch B3E2409 - Saturated Paste Metals

Blank (B3E2409-BLK1)

Prepared: 05/24/2023 Analyzed: 05/25/2023

Calcium PPM	ND	10.0	mg/L							U
SAR	0.00		SAR							U
Magnesium PPM	ND	10.0	mg/L							U
Sodium PPM	ND	10.0	"							U

Duplicate (B3E2409-DUP1)

Source: Y305512-10

Prepared: 05/24/2023 Analyzed: 05/25/2023

Calcium PPM	28.0	10.0	mg/L		28.7			2.33	50	
SAR	0.00		SAR		0.0985			200	200	U
Magnesium PPM	6.88	10.0	mg/L		7.00			1.73	50	U
Sodium PPM	2.20	10.0	"		2.27			3.13	50	U

Batch B3E2412 - DTPA Sorbitol Preparation

Blank (B3E2412-BLK1)

Prepared: 05/24/2023 Analyzed: 05/25/2023

Boron	ND	0.100	mg/L							U
-------	----	-------	------	--	--	--	--	--	--	---

Duplicate (B3E2412-DUP1)

Source: Y305529-01

Prepared: 05/24/2023 Analyzed: 05/25/2023

Boron	0.113	0.0993	mg/L		0.114			1.40	50	
-------	-------	--------	------	--	-------	--	--	------	----	--

Origins Laboratory, Inc.



The results in this report apply to the samples analyzed in accordance with the chain of custody document. This analytical report must be reproduced in its entirety.

Jen Pellegrini For Jordan A. Bynon, Project Manager

Eagle Environmental Consulting, LLC
8000 W 44th Ave
Wheat Ridge CO 80033

Martin C Eckert III
Project Number: [none]
Project: Noble - Borys C #22-20

Saturated Paste - Quality Control Origins Laboratory, Inc.

Analyte	Result	Reporting Limit	Units	Spike Level	Source Result	%REC	%REC Limits	RPD	RPD Limit	Notes
Batch B3E2415 - Saturated Paste pH/EC										
Blank (B3E2415-BLK1)					Prepared: 05/24/2023 Analyzed: 05/25/2023					
Specific Conductance (EC)	ND	0.00500	mmhos/cm							U
Duplicate (B3E2415-DUP1)					Source: Y305512-10 Prepared: 05/24/2023 Analyzed: 05/25/2023					
pH	7.92		pH Units		8.32			4.93	25	
Specific Conductance (EC)	0.321	0.00500	mmhos/cm		0.279			14.2	25	

Origins Laboratory, Inc.



Jen Pellegrini For Jordan A. Bynon, Project Manager

The results in this report apply to the samples analyzed in accordance with the chain of custody document. This analytical report must be reproduced in its entirety.

Eagle Environmental Consulting, LLC
8000 W 44th Ave
Wheat Ridge CO 80033

Martin C Eckert III
Project Number: [none]
Project: Noble - Borys C #22-20

PAH by 8270D SIM - Quality Control
Waypoint Analytical, LLC.

Analyte	Result	Reporting Limit	Units	Spike Level	Source Result	%REC	%REC Limits	RPD	RPD Limit	Notes
---------	--------	-----------------	-------	-------------	---------------	------	-------------	-----	-----------	-------

Batch L684102 - 3550B

MSD (L 97380-MSD-L684102)		Source: 97380			Prepared: 05/25/2023 Analyzed: 05/26/2023					
Dibenz(a,h)anthracene	0.0912	0.00067	mg/Kg	0.162	<0.000614	56.2	30-130	3.7	30	
Pyrene	0.0948	0.00067	"	0.162	<0.000643	58.5	30-130	13	30	
Indeno(1,2,3-cd)pyrene	0.0709	0.00067	"	0.162	<0.000627	43.7	30-130	5.6	30	
Fluoranthene	0.0951	0.00067	"	0.162	<0.000394	58.7	30-130	13.6	30	
Chrysene	0.0964	0.00067	"	0.162	<0.000624	59.5	30-130	15.8	30	
Benzo(k)fluoranthene	0.0962	0.00067	"	0.162	<0.000437	59.3	30-130	6.8	30	
Benzo(b)fluoranthene	0.0671	0.00067	"	0.162	<0.000585	41.4	30-130	0	30	
2-Methylnaphthalene	0.0661	0.00201	"	0.162	<0.00194	40.8	30-130	18.4	30	
1-Methylnaphthalene	0.081	0.00201	"	0.162	<0.00109	50	30-130	17.4	30	
Fluorene	0.0732	0.00067	"	0.162	<0.000286	45.1	30-130	16.8	30	
Benzo(a)pyrene	0.0893	0.00067	"	0.162	<0.000468	55.1	30-130	15.2	30	
Acenaphthene	0.0787	0.00067	"	0.162	<0.000304	48.5	30-130	17.2	30	
Anthracene	0.089	0.00067	"	0.162	<0.000334	54.9	30-130	14.5	30	
Benzo(a)anthracene	0.0788	0.00067	"	0.162	<0.000493	48.6	30-130	14.3	30	
Surrogate: Nitrobenzene-d5	40		"	0.325	138	40	29-110			
Surrogate: 2-Fluorobiphenyl	44.3		"	0.325	156	44.3	33-115			
Surrogate: 4-Terphenyl-d14	60.3		"	0.325	204	60.3	33-122			

MS (L 97380-MS-L684102)		Source: 97380			Prepared: 05/25/2023 Analyzed: 05/26/2023					
Benzo(k)fluoranthene	0.103	0.00067	mg/Kg	0.166	<0.000437	62	30-130			
Indeno(1,2,3-cd)pyrene	0.067	0.00067	"	0.166	<0.000627	40.3	30-130			
Fluorene	0.0867	0.00067	"	0.166	<0.000286	52.2	30-130			
Fluoranthene	0.109	0.00067	"	0.166	<0.000394	65.6	30-130			
Dibenz(a,h)anthracene	0.0878	0.00067	"	0.166	<0.000614	52.8	30-130			
Chrysene	0.113	0.00067	"	0.166	<0.000624	68	30-130			
Pyrene	0.108	0.00067	"	0.166	<0.000643	65	30-130			
Benzo(b)fluoranthene	0.0671	0.00067	"	0.166	<0.000585	40.4	30-130			

Origins Laboratory, Inc.



The results in this report apply to the samples analyzed in accordance with the chain of custody document. This analytical report must be reproduced in its entirety.

Jen Pellegrini For Jordan A. Bynon, Project Manager

Eagle Environmental Consulting, LLC
8000 W 44th Ave
Wheat Ridge CO 80033

Martin C Eckert III
Project Number: [none]
Project: Noble - Borys C #22-20

PAH by 8270D SIM - Quality Control
Waypoint Analytical, LLC.

Analyte	Result	Reporting Limit	Units	Spike Level	Source Result	%REC	%REC Limits	RPD	RPD Limit	Notes
---------	--------	-----------------	-------	-------------	---------------	------	-------------	-----	-----------	-------

Batch L684102 - 3550B

MS (L 97380-MS-L684102)		Source: 97380			Prepared: 05/25/2023 Analyzed: 05/26/2023					
1-Methylnaphthalene	0.0965	0.00201	mg/Kg	0.166	<0.00109	58.1	30-130			
2-Methylnaphthalene	0.0795	0.00201	"	0.166	<0.00194	47.8	30-130			
Acenaphthene	0.0936	0.00067	"	0.166	<0.000304	56.3	30-130			
Anthracene	0.103	0.00067	"	0.166	<0.000334	62	30-130			
Benzo(a)anthracene	0.091	0.00067	"	0.166	<0.000493	54.8	30-130			
Benzo(a)pyrene	0.104	0.00067	"	0.166	<0.000468	62.6	30-130			
Surrogate: Nitrobenzene-d5	48.3		"	0.331	138	48.3	29-110			
Surrogate: 2-Fluorobiphenyl	53.7		"	0.331	156	53.7	33-115			
Surrogate: 4-Terphenyl-d14	69.4		"	0.331	204	69.4	33-122			

LCS (LCS-L684102)		Prepared: 05/25/2023 Analyzed: 05/26/2023								
Dibenz(a,h)anthracene	0.122	0.00067	mg/Kg	0.167		73	30-130			
Benzo(k)fluoranthene	0.128	0.00067	"	0.167		76.6	30-130			
Indeno(1,2,3-cd)pyrene	0.0863	0.00067	"	0.167		51.6	30-130			
1-Methylnaphthalene	0.109	0.00201	"	0.167		65.2	30-130			
Fluoranthene	0.127	0.00067	"	0.167		76	30-130			
Chrysene	0.129	0.00067	"	0.167		77.2	30-130			
Pyrene	0.126	0.00067	"	0.167		75.4	30-130			
Benzo(a)pyrene	0.121	0.00067	"	0.167		72.4	30-130			
Benzo(a)anthracene	0.106	0.00067	"	0.167		63.4	30-130			
Anthracene	0.117	0.00067	"	0.167		70	30-130			
Acenaphthene	0.1	0.00067	"	0.167		59.8	30-130			
2-Methylnaphthalene	0.0879	0.00201	"	0.167		52.6	30-130			
Fluorene	0.0922	0.00067	"	0.167		55.2	30-130			
Benzo(b)fluoranthene	0.0905	0.00067	"	0.167		54.1	30-130			
Surrogate: Nitrobenzene-d5	51		"	0.333		51	29-110			
Surrogate: 2-Fluorobiphenyl	62.1		"	0.333		62.1	33-115			

Origins Laboratory, Inc.



The results in this report apply to the samples analyzed in accordance with the chain of custody document. This analytical report must be reproduced in its entirety.

Jen Pellegrini For Jordan A. Bynon, Project Manager

Eagle Environmental Consulting, LLC
8000 W 44th Ave
Wheat Ridge CO 80033

Martin C Eckert III
Project Number: [none]
Project: Noble - Borys C #22-20

PAH by 8270D SIM - Quality Control
Waypoint Analytical, LLC.

Analyte	Result	Reporting Limit	Units	Spike Level	Source Result	%REC	%REC Limits	RPD	RPD Limit	Notes
Batch L684102 - 3550B										
LCS (LCS-L684102)					Prepared: 05/25/2023 Analyzed: 05/26/2023					
Surrogate: 4-Terphenyl-d14	84.9		mg/Kg	0.333		84.9	33-122			
LRB (LRB-L684102)					Prepared: 05/25/2023 Analyzed: 05/26/2023					
Chrysene	ND	0.00067	mg/Kg				-			
Dibenz(a,h)anthracene	ND	0.00067	"				-			
Fluoranthene	ND	0.00067	"				-			
Fluorene	ND	0.00067	"				-			
Benzo(k)fluoranthene	ND	0.00067	"				-			
Indeno(1,2,3-cd)pyrene	ND	0.00067	"				-			
Benzo(b)fluoranthene	ND	0.00067	"				-			
Benzo(a)pyrene	ND	0.00067	"				-			
Benzo(a)anthracene	ND	0.00067	"				-			
Acenaphthene	ND	0.00067	"				-			
2-Methylnaphthalene	ND	0.00201	"				-			
1-Methylnaphthalene	ND	0.00201	"				-			
Pyrene	ND	0.00067	"				-			
Anthracene	ND	0.00067	"				-			
Surrogate: Nitrobenzene-d5	48.6		"	0.333		48.6	29-110			
Surrogate: 4-Terphenyl-d14	78.9		"	0.333		78.9	33-122			
Surrogate: 2-Fluorobiphenyl	57.6		"	0.333		57.6	33-115			

Origins Laboratory, Inc.



Jen Pellegrini For Jordan A. Bynon, Project Manager

The results in this report apply to the samples analyzed in accordance with the chain of custody document. This analytical report must be reproduced in its entirety.

Eagle Environmental Consulting, LLC
8000 W 44th Ave
Wheat Ridge CO 80033

Martin C Eckert III
Project Number: [none]
Project: Noble - Borys C #22-20

Notes and Definitions

U Sample is Non-Detect.

ND Analyte NOT DETECTED at or above the reporting limit

RPD Relative Percent Difference

All soil results are reported on a wet weight basis.

Origins Laboratory, Inc.



The results in this report apply to the samples analyzed in accordance with the chain of custody document. This analytical report must be reproduced in its entirety.

Jen Pellegrini For Jordan A. Bynon, Project Manager



June 06, 2023

Eagle Environmental Consulting, LLC

Martin C Eckert III

8000 W 44th Ave

Wheat Ridge CO 80033

Project Name - Noble - Borys C #22-20

Project Number - [none]

Attached are your analytical results for Noble - Borys C #22-20 received by Origins Laboratory, Inc. May 31, 2023. This project is associated with Origins project number Y306005-01.

The analytical results in the following report were analyzed under the guidelines of EPA Methods. These methods are identified as follows; "SW" are defined in SW-846, "EPA" are defined in 40CFR part 136 and "SM" are defined in the most current revision of Standard Methods For the Examination of Water and Wastewater.

The analytical results apply specifically to the samples and analyses specified per the attached Chain of Custody. As such, this report shall not be reproduced except in full, without the written approval of Origin's laboratory.

Unless otherwise noted, the analytical results for all soil samples are reported on a wet weight basis. All analytical analyses were performed under NELAP guidelines unless noted by a data qualifier.

Any holding time exceedances, deviations from the method specifications or deviations from Origins Laboratory's Standard Operating Procedures are outlined in the case narrative.

Thank you for selecting Origins for your analytical needs. Please contact us with any questions concerning this report, or if we can help with anything at all.

Origins Laboratory, Inc.
303.433.1322
o-squad@oelabinc.com



1725 Elk Place, Denver, CO 80211 | Phone: 303.433.1322 | Fax: 303.265.9645

Eagle Environmental Consulting, LLC

8000 W 44th Ave

Wheat Ridge CO 80033

Martin C Eckert III

Project Number: [none]

Project: Noble - Borys C #22-20

CROSS REFERENCE REPORT

Sample ID	Laboratory ID	Matrix	Date Sampled	Date Received
Background-01@3'	Y306005-01	Soil	May 22, 2008 8:30	05/31/2023 15:18

Origins Laboratory, Inc.



The results in this report apply to the samples analyzed in accordance with the chain of custody document. This analytical report must be reproduced in its entirety.

Eagle Environmental Consulting, LLC
8000 W 44th Ave
Wheat Ridge CO 80033

Martin C Eckert III
Project Number: [none]
Project: Noble - Borys C #22-20

Origins Laboratory

F-012207-01-R1
Effective Date: 01/09/12

Sample Receipt Checklist

Origins Work Order: 4300005

Client: Eagle

Client Project ID: Borys C #22-20

Checklist Completed by: EHS

Shipped Via: TD

(UPS, FedEx, Hand Delivered, Pick-up, etc.)

Date/time completed: 5/31/23

Airbill #: NA

Matrix(s) Received: (Check all that apply): ☒ Soil/Solid ☐ Water ☐ Other: _____

Cooler Number/Temperature: 111 °C / _____ °C / _____ °C (Describe)

Thermometer ID: 7004

Requirement Description	Yes	No	N/A	Comments (if any)
If samples require cooling, was the temperature between 0°C to ≤ 6°C ⁽¹⁾ ?	/			
Is there ice present (document if blue ice is used)	/			
Are custody seals present on cooler? (if so, document in comments if they are signed and dated, broken or intact)		/		
Are custody seals present on each sample container? (if so, document in comments if they are signed and dated, broken or intact)		/		
Were all samples received intact ⁽¹⁾ ?	/			
Was adequate sample volume provided ⁽¹⁾ ?	/			
Are short holding time analytes or samples with HTs due within 48 hours present ⁽¹⁾ ?		/		
Is a chain-of-custody (COC) present and filled out completely ⁽¹⁾ ?	/			
Does the COC agree with the number and type of sample bottles received ⁽¹⁾ ?	/			
Do the sample IDs on the bottle labels match the COC ⁽¹⁾ ?	/			
Is the COC properly relinquished by the client with date and time recorded ⁽¹⁾ ?	/			
For volatiles in water – is there headspace (> ¼ inch bubble) present? If yes, contact client and note in narrative.			/	
Are samples preserved that require preservation and was it checked ⁽¹⁾ ? (note ID of confirmation instrument used in comments) / (preservation is not confirmed for subcontracted analyses in order to insure sample integrity)/(pH <2 for samples preserved with HNO ₃ , HCL, H ₂ SO ₄) / (pH >10 for samples preserved with NaAsO ₂ +NaOH, ZnAc+NaOH)			/	
Additional Comments (if any):				

⁽¹⁾ If NO, then contact the client before proceeding with analysis and note date/time and person contacted as well as the corrective action to in the additional comments (above) and the case narrative.

Reviewed by (Project Manager) [Signature]

Date/Time Reviewed 6/2/23

Origins Laboratory, Inc.

[Signature]

The results in this report apply to the samples analyzed in accordance with the chain of custody document. This analytical report must be reproduced in its entirety.

Eagle Environmental Consulting, LLC
8000 W 44th Ave
Wheat Ridge CO 80033

Martin C Eckert III
Project Number: [none]
Project: Noble - Borys C #22-20

Background-01@3'

5/22/2008 8:30:00AM

Analyte	Result	Reporting	Units	Dilution	Batch	Analyst	Prepared	Analyzed	Notes
		Limit							

Origins Laboratory, Inc.
Y306005-01 (Soil)

pH in Soil by 9045D

pH	8.45	pH Units	1	B3F0230	HJD	06/02/2023	06/04/2023
----	------	----------	---	---------	-----	------------	------------

Origins Laboratory, Inc.



The results in this report apply to the samples analyzed in accordance with the chain of custody document. This analytical report must be reproduced in its entirety.

Eagle Environmental Consulting, LLC
8000 W 44th Ave
Wheat Ridge CO 80033

Martin C Eckert III
Project Number: [none]
Project: Noble - Borys C #22-20

Saturated Paste - Quality Control
Origins Laboratory, Inc.

Analyte	Result	Reporting Limit	Units	Spike Level	Source Result	%REC	%REC Limits	RPD	RPD Limit	Notes
---------	--------	-----------------	-------	-------------	---------------	------	-------------	-----	-----------	-------

Batch B3F0230 - Saturated Paste pH/EC

Duplicate (B3F0230-DUP1)

Source: Y305798-01

Prepared: 06/02/2023 Analyzed: 06/04/2023

pH	7.21		pH Units	7.08				1.82	25	
----	------	--	----------	------	--	--	--	------	----	--

Origins Laboratory, Inc.



The results in this report apply to the samples analyzed in accordance with the chain of custody document. This analytical report must be reproduced in its entirety.

Jordan A. Bynon, Project Manager

Eagle Environmental Consulting, LLC

8000 W 44th Ave

Wheat Ridge CO 80033

Martin C Eckert III

Project Number: [none]

Project: Noble - Borys C #22-20

Notes and Definitions

ND Analyte NOT DETECTED at or above the reporting limit

RPD Relative Percent Difference

All soil results are reported at a wet weight basis.

Origins Laboratory, Inc.



The results in this report apply to the samples analyzed in accordance with the chain of custody document. This analytical report must be reproduced in its entirety.