

*send to
 Colo O&G Comm*

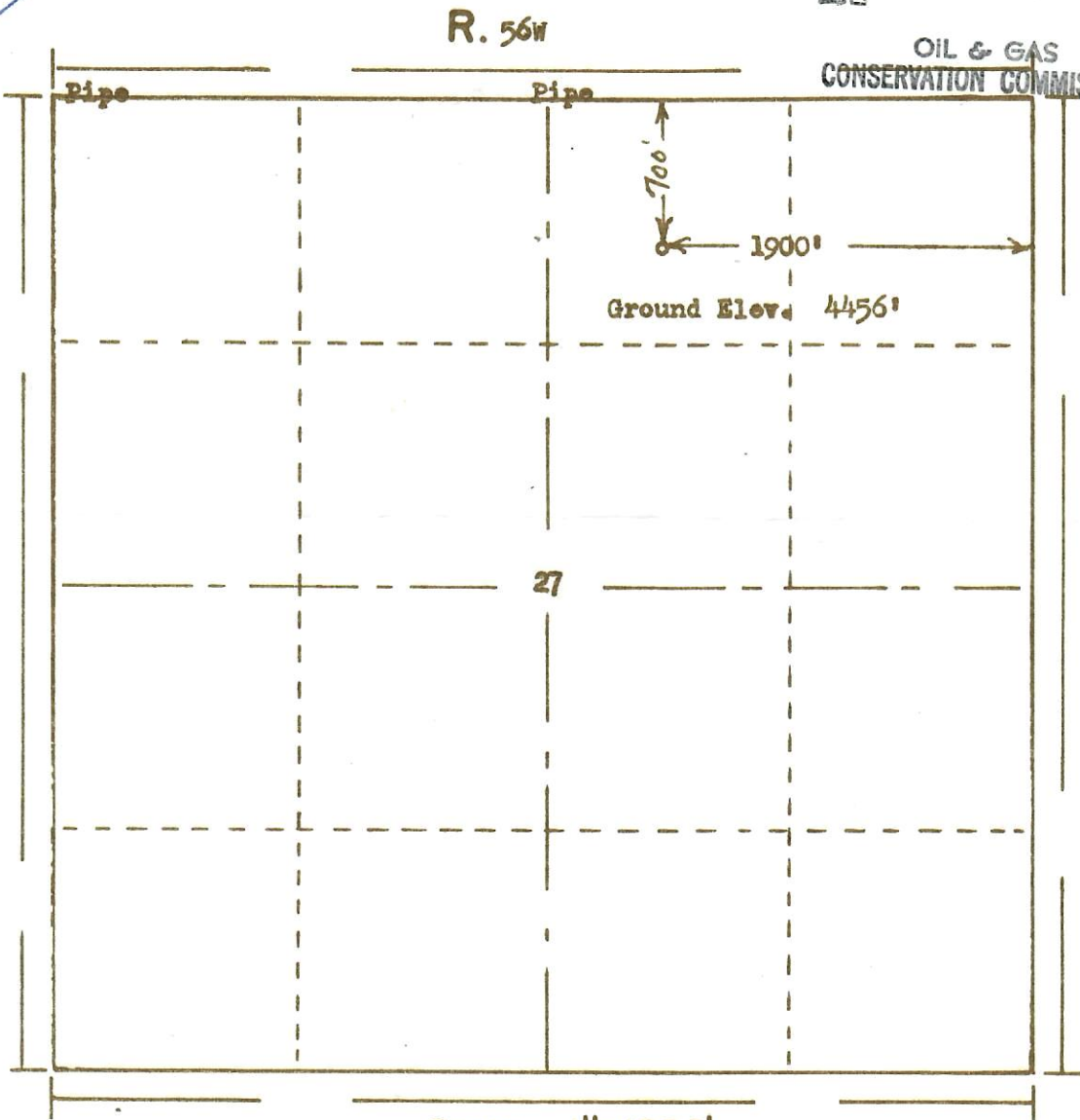

Scale ... 1" = 1000'

Powers Surveyors, Inc. of Denver, Colorado
has in accordance with a request from Mr. Palmer
for Walter Duncan determined the
Location of No. 1 Dunning
to be 1900' FE & 700' FE Section 27 Township 9N
Range 56W of the 6th Principal Meridian
Weld County, Colorado

65-280

I hereby certify that this plat is an
accurate representation of a correct
survey showing the location of

7-13-65

Bill G. Holloway
Licensed Land Surveyor No. 2353
State of Colorado