

Interim Reclamation and Stormwater Inspection

April 15, 2024

Operator: WOODBURY RESOURCES LLC- #10761

Location ID: 324766

Inspection Document #: 697505273

Jackson County, CO

Chris Binschus
Reclamation Specialist, ECMC



COLORADO

**Energy & Carbon Management
Commission**

Department of Natural Resources

Inspection Photos
Location Name: Fuqua 18-15 Pad
Location ID: 324766



Photo 1. Google Earth aerial imagery from 8/27/2019 illustrating the location and a portion of the access road. The disturbances east of the location were from the Operator and have been reclaimed- refer to Photo 7. There is a disturbance to the southwest of the location that will need further investigation by ECMC.

Inspection Photos
Location Name: Fuqua 18-15 Pad
Location ID: 324766



Photo 2. Photo taken from the entrance of location. Photo illustrates the Operator sign, which needs to be corrected due to an inaccurate Well API #.



Photo 3. Photo taken from the wellhead. See comments on Photo 2 regarding the Operator sign.



Inspection Photos
Location Name: Fuqua 18-15 Pad
Location ID: 324766



Photo 4. Photo taken from the northern interim reclamation area, facing East. Photo illustrates the area consists mostly of annual vegetation, which is not reflective of reference area conditions. Refer to Photo 7 documenting reference area vegetation.

Inspection Photos
Location Name: Fuqua 18-15 Pad
Location ID: 324766



Photo 5. Photo taken from the southeastern interim reclamation area, facing South. Photo illustrates the area consists mostly of unmanaged annual, weedy Russian thistle vegetation that is not reflective of reference area conditions. Refer to Photo 7 documenting reference area vegetation.

Inspection Photos
Location Name: Fuqua 18-15 Pad
Location ID: 324766



Photo 6. Photo taken from the southern interim reclamation area, facing East. Photo illustrates the area consists mostly of unmanaged annual, weedy Russian thistle vegetation that is not reflective of reference area conditions. Refer to Photo 7 documenting reference area vegetation.

Inspection Photos
Location Name: Fuqua 18-15 Pad
Location ID: 324766



Photo 7. Photo taken from the southeastern interim reclamation area near the southern tank battery. Photo illustrates a List B Colorado noxious weed, Canada thistle. Note- there were other areas along the southern interim area with Canada thistle.



Photo 8. Photo taken from the southern interim reclamation area, facing East. Photo illustrates the area consists mostly of unmanaged annual, weedy Russian thistle vegetation that is not reflective of reference area conditions.

Inspection Photos
Location Name: Fuqua 18-15 Pad
Location ID: 324766



Photo 7. Photo taken from the disturbance feature shown in Photo #1, facing East. Photo illustrates the Operator bulldozed the disturbance feature in response to a 2012 E&P waste release for a proposed controlled burn. The disturbance feature has reclaimed back to reference area conditions.



Inspection Photos
Location Name: Fuqua 18-15 Pad
Location ID: 324766

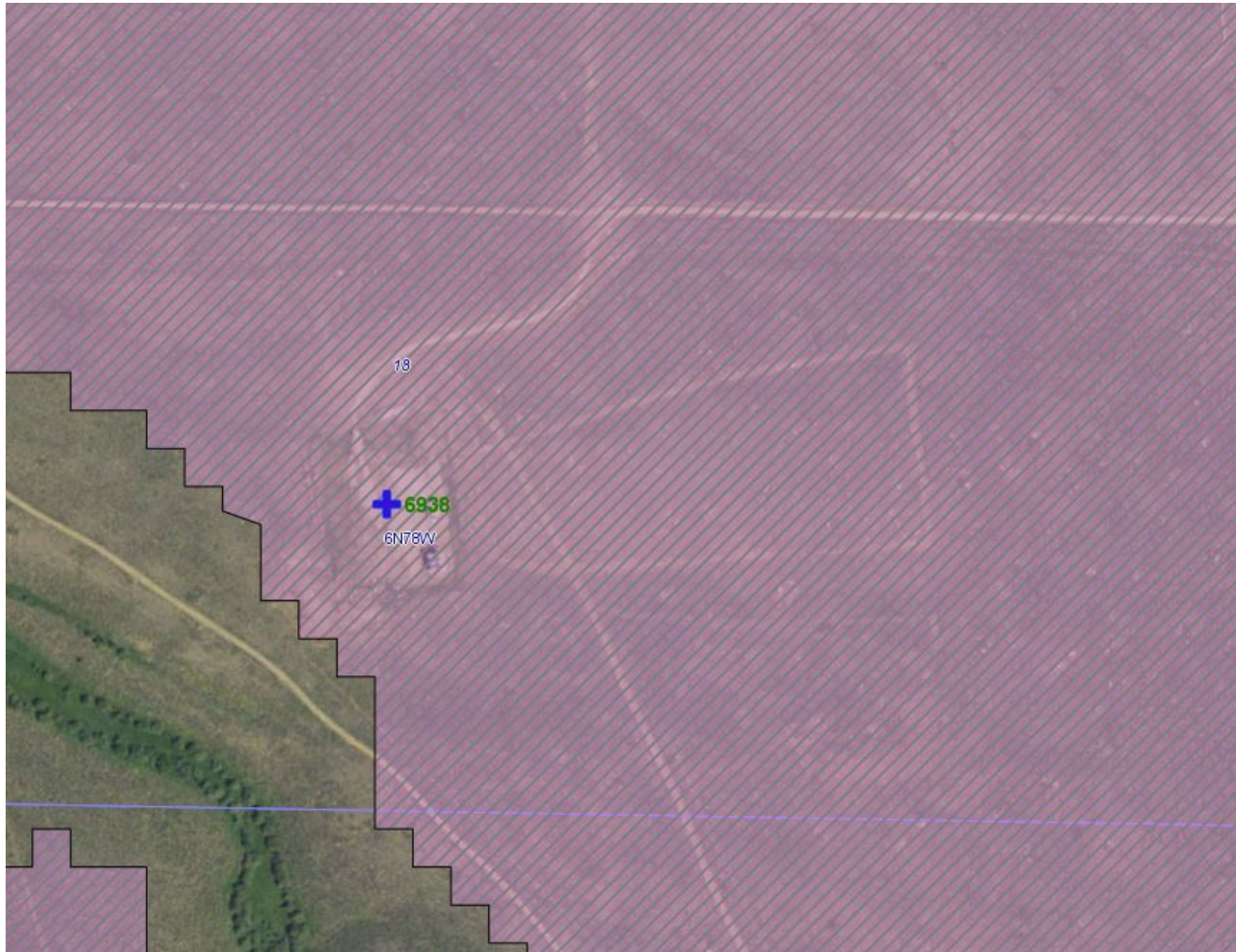

Photo 8. ECMC GIS aerial imagery illustrates the location falls within Greater Sage Grouse General Habitat Management Area.