







Legend

-  P&A'd Wellhead
-  Soil Sample Location
-  Soil Screening Location
-  Shallow Soil Vapor Point (SVP) Location
-  Approximate Location of Flowline (To Be Removed)
-  Approximate Location of Flowline (Removed)
-  Excavation Extent

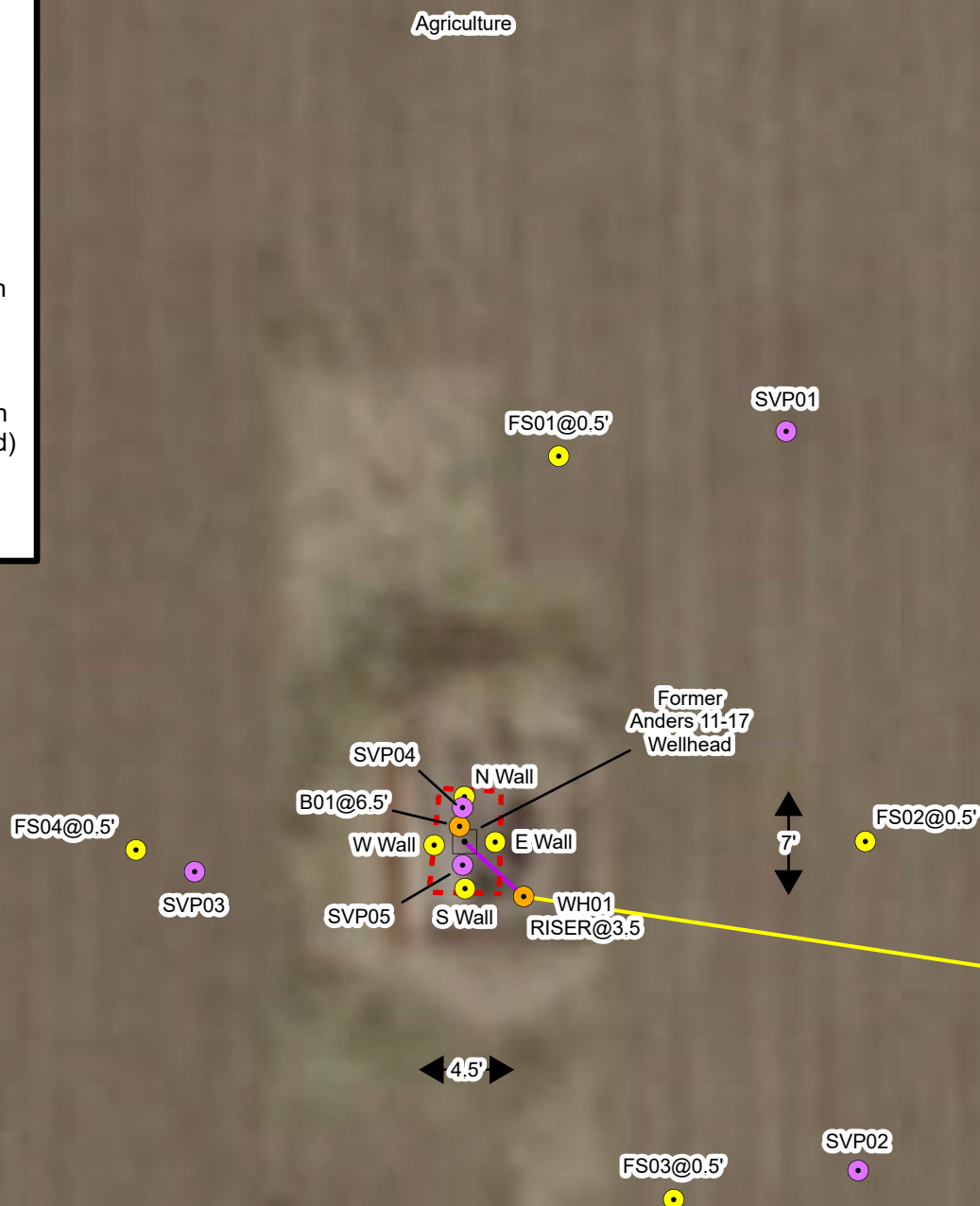

0 10 20
Feet

© 2023 Microsoft Corporation © 2023 Maxar © CNES (2023) Distribution
Airbus DS

Wellhead Excavation Site Map

Anders 11-17 Wellhead
Kerr-McGee Oil & Gas Onshore, LP
NESW SEC 17-T2N-R66W
Weld County, CO

Project Number: 09A1417319

FIGURE
1