

# GLADE GRADING PLAN

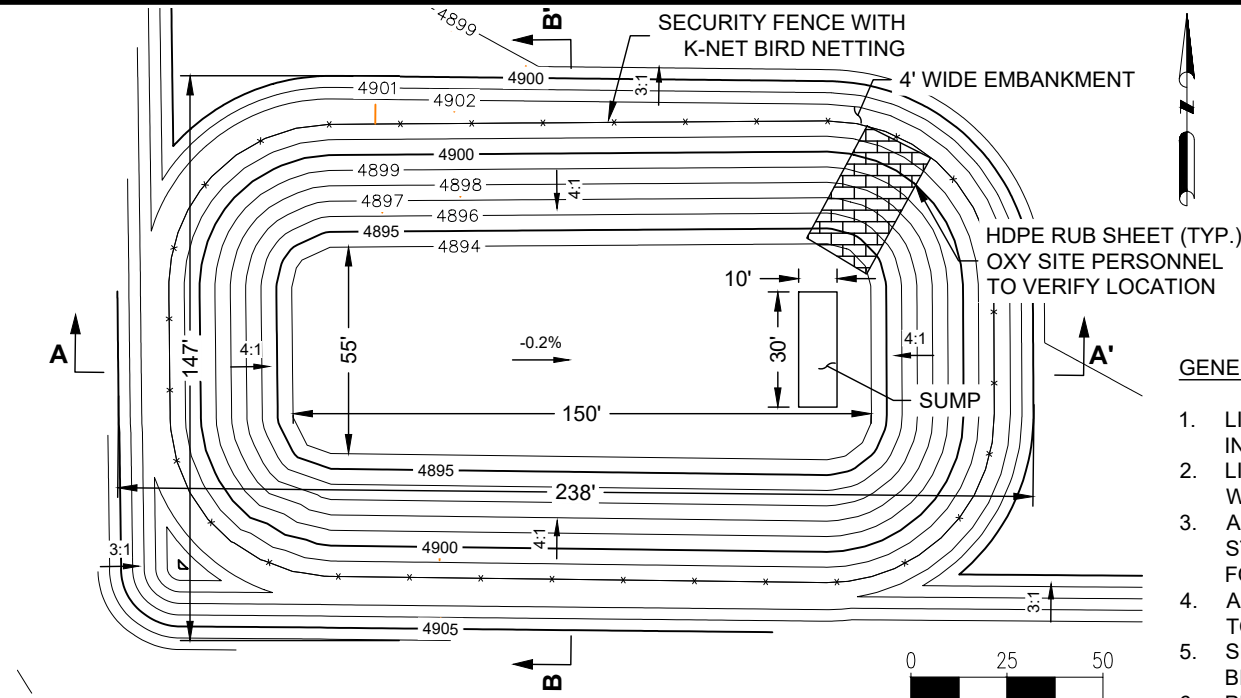

COOLING PIT - PLAN VIEW

SCALE: 1" = 50'



### GENERAL NOTES:

1. LINER MANUFACTURER AND INSTALLER TO BE DETERMINED BY OXY USA, INC.
2. LINER SHALL BE HDPE, 40 MIL MINIMUM THICKNESS WITH WATER TIGHT WELDED SEAMS OVER A NON-WOVEN FILTER FABRIC CUSHION.
3. ALL MATERIALS AND PROCEDURES SHALL COMPLY WITH ASTM STANDARDS AND LINER INSTALLATION STANDARD PROCEDURES AND FOLLOW ALL MANUFACTURERS INSTALLATION RECOMMENDATIONS.
4. ALL LINER SEAM WELDING ACTIVITIES SHALL BE PERFORMED ACCORDING TO MANUFACTURERS AND LINER SUPPLIERS RECOMMENDATIONS.
5. SECURITY FENCE IS TO BE INSTALLED TO SUPPORT THE NIXALITE K-NET BIRD NETTING.
6. PIT EXCAVATION MATERIAL TO BE STOCKPILED ON SITE AND USED FOR WORKING PAD RESTORATION AFTER DRILLING OPERATIONS ARE COMPLETED.

COOLING PIT STAGE STORAGE		
CONTOUR ELEVATION	VOLUME (CF)	VOLUME (BBL)
4,894.00	0	0
4894.2 (SUMP)	1,664.92	296.54
4,894.40	3,393.39	604.39
4,894.60	5,186.20	923.70
4,894.80	7,044.16	1,254.62
4,895.00	8,968.07	1,597.29
4,895.20	10,958.72	1,951.84
4,895.40	13,016.92	2,318.42
4,895.60	15,143.47	2,697.17
4,895.80	17,339.15	3,088.24
4,896.00	19,604.78	3,491.77
4,896.20	21,941.15	3,907.89
4,896.40	24,349.06	4,336.76
4,896.60	26,829.33	4,778.52
4,896.80	29,382.75	5,233.30
4,897.00	32,010.14	5,701.26
4,897.20	34,712.30	6,182.54
4,897.40	37,490.04	6,677.28
4,897.60	40,344.16	7,185.62
4,897.80	43,275.48	7,707.71
4,898.00	46,284.80	8,243.69
4,898.20	49,372.92	8,793.71
4,898.40	52,540.65	9,357.91
4,898.60	55,788.81	9,936.43
4,898.80	59,118.22	10,529.43
4,899.00	62,529.69	11,137.04
4,899.20	66,024.07	11,759.42
4,899.40	69,602.18	12,396.71
4,899.60	75,264.86	13,405.27
4,899.80	80,012.22	14,250.82
4,900.00 (MAX WATER ELEV.)	83,998.33	14,960.77
4,900.20	86,487.65	15,404.14
4,900.40	88,778.05	15,812.08
4,900.60	92,876.17	16,541.99
4,900.80	97,063.91	17,287.86
4,901.00	101,342.13	18,049.84
4,901.20	105,711.67	18,828.09
4,901.40	110,173.38	19,622.76
4,901.60	114,033.05	20,310.20
4,901.80	115,856.37	20,634.95
4,902.00 (TOP OF EMBANKMENT)	116,851.20	20,812.13

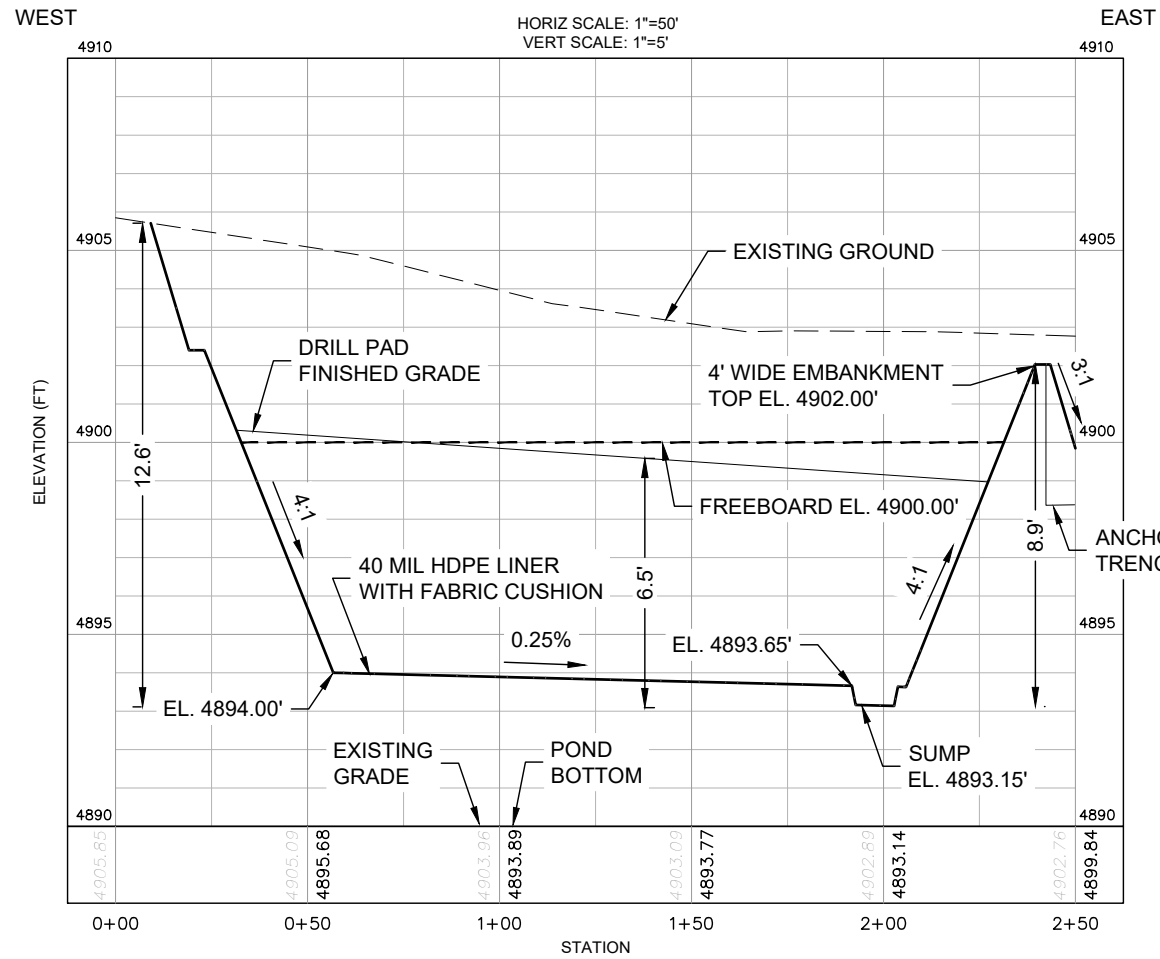

SECTION A - LOOKING NORTH

COOLING PIT - PROFILE VIEW

SCALE: 1" = 50'

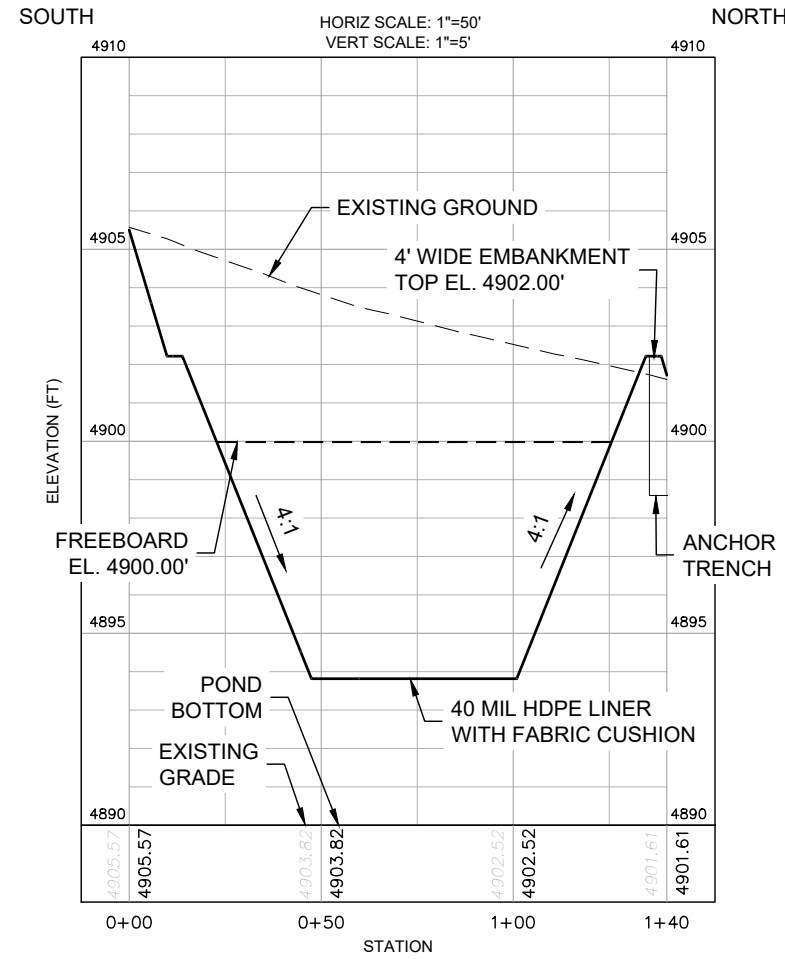

SECTION B - LOOKING WEST

COOLING PIT - PROFILE VIEW

SCALE: 1" = 50'



ASCENT GEOMATICS SOLUTIONS  
8620 WOLFF COURT  
WESTMINSTER, CO 80031  
(303) 928-7128



OXY USA INC  
1099 18TH STREET  
DENVER, CO 80202  
(720) 929-6000

SHEET NAME:  
COOLING PIT DETAIL  
SURFACE LOCATION  
NE 1/4 SE 1/4 SECTION 2,  
T3N, R66W, 6TH P.M.,  
WELD COUNTY, COLORADO

REV.	REVISION DESCRIPTION	DATE	BY
0	ISSUED FOR PERMIT	4/12/24	OS
1	ISSUED FOR PERMIT	5/19/24	OS

DRAWING DATE: 4/12/24

DRAFTED BY: OS

SHEET NO. 20 OF 23