

FIRST QUARTER 2024 SITE MONITORING DATA

THOMPSON 28-10

ECMC SPILL TRACKING # 483966
ECMC REMEDIATION # 25228

Prepared for:



2115 117th Avenue
Greeley, CO 80631

Prepared by:



6855 W. 119th Ave
Broomfield, CO 80020

TABLE 1
GROUNDWATER ELEVATION DATA
NOBLE ENERGY, INC. - THOMPSON 28-10 FACILITY



Monitoring Well ID	Date	Top of Casing Elevation (ft. AMSL)	Total Depth (ft. BTOC)	Depth to Water (ft.) ⁽¹⁾	Depth to LNAPL (ft.) ⁽¹⁾	LNAPL Thickness (ft.)	Groundwater Elevation* (ft. AMSL)
BH01	06/19/23	4741.45	19.21	9.30	ND	ND	4732.28
BH01	09/01/23	4741.45	19.18	8.83	ND	ND	4732.75
BH01	12/06/23	4741.45	19.21	9.19	ND	ND	4732.39
BH01	03/11/24	4741.45	19.13	11.31	ND	ND	4731.27
BH02	06/19/23	4742.57	18.92	9.97	ND	ND	4732.86
BH02	09/01/23	4742.57	18.90	9.76	ND	ND	4733.07
BH02	12/06/23	4742.57	18.85	10.27	ND	ND	4732.56
BH02	03/11/24	4742.57	18.62	12.51	ND	ND	4731.32
BH03	06/19/23	4740.56	18.83	8.76	ND	ND	4731.97
BH03	09/01/23	4740.56	18.51	8.08	ND	ND	4732.65
BH03	12/06/23	4740.56	18.50	8.50	ND	ND	4732.23
BH03	03/11/24	4740.56	18.48	10.60	ND	ND	4731.13
BH04	06/19/23	4740.18	18.66	8.52	ND	ND	4731.82
BH04	09/01/23	4740.18	18.61	7.95	ND	ND	4732.39
BH04	12/06/23	4740.18	18.44	9.02	ND	ND	4731.32
BH04	03/11/24	4740.18	18.22	10.22	ND	ND	4731.12
BH05	06/19/23	4741.49	19.22	9.02	ND	ND	4732.63
BH05	09/01/23	4741.49	19.20	8.40	ND	ND	4733.25
BH05	12/06/23	4741.49	18.89	9.16	ND	ND	4732.49
BH05	03/11/24	4741.49	18.93	11.34	ND	ND	4731.31
BH06	06/19/23	4740.28	18.33	8.36	ND	ND	4732.15
BH06	09/01/23	4740.28	18.25	7.78	ND	ND	4732.73
BH06	12/06/23	4740.28	18.24	8.18	ND	ND	4732.33
BH06	03/11/24	4740.28	18.18	10.31	ND	ND	4731.20

Notes:

⁽¹⁾ Depth to water measurements were collected from top of casing and adjusted using survey data to reflect depth of water from ground surface.

* Groundwater elevation was corrected for product thickness (when present) using the following calculation:

Groundwater elevation = (TOC Elevation - Measured Depth to Water)+(LNAPL Thickness in Well x LNAPL Relative Density)

LNAPL relative density was estimated to be 0.75

Definitions:

ft. = Feet
 AMSL = Above mean sea level
 BTOC = Below top of casing
 BGS = Below ground surface
 LNAPL = Light non-aqueous phase liquid
 ND = No LNAPL detected

TABLE 2
GROUNDWATER ANALYTICAL DATA
NOBLE ENERGY, INC. - THOMPSON 28-10 FACILITY

Monitoring Well ID	Date	Benzene (µg/L)	Toluene (µg/L)	Ethylbenzene (µg/L)	Total Xylenes (µg/L)	Naphthalene (µg/L)	1,2,4-TMB (µg/L)	1,3,5-TMB (µg/L)	2-M (µg/L)	TDS (mg/L)	Chloride Ion (mg/L)	Sulfate Ion (mg/L)
ECMC Standard ⁽¹⁾		5	560	700	1,400	140	67	67	3.6 ⁽²⁾	<1.25 x Background	250 or <1.25 x Background	250 or <1.25 x Background
BH01	06/19/23	<1.0	<1.0	<1.0	<2.0	<1.0	<1.0	<1.0	<0.500	993	246	266
BH01	09/01/23	<1.0	<1.0	<1.0	<2.0	<1.0	<1.0	<1.0	<0.500	1,260	257	208
BH01	12/06/23	<1.0	<1.0	<1.0	<2.0	<1.0	<1.0	<1.0	<0.500	806	220	197
BH01	03/11/24	<1.0	<1.0	<1.0	<2.0	<1.0	<1.0	<1.0	<0.500	865	197	152
⁽³⁾ BH02	06/19/23	<1.0	<1.0	<1.0	<2.0	<1.0	<1.0	<1.0	<0.500	1,020	289	270
⁽³⁾ BH02	09/01/23	<1.0	<1.0	<1.0	<2.0	<1.0	<1.0	<1.0	<0.500	1,630	345	328
⁽³⁾ BH02	12/06/23	<1.0	<1.0	<1.0	<2.0	<1.0	<1.0	<1.0	<0.500	755	208	159
⁽³⁾ BH02	03/11/24	<1.0	<1.0	<1.0	<2.0	<1.0	<1.0	<1.0	<0.500	844	185	151
BH03	06/19/23	<1.0	<1.0	<1.0	<2.0	<1.0	<1.0	<1.0	<0.500	855	204	241
BH03	09/01/23	<1.0	<1.0	<1.0	<2.0	<1.0	<1.0	<1.0	<0.500	1,120	260	156
BH03	12/06/23	<1.0	<1.0	<1.0	<2.0	<1.0	<1.0	<1.0	<0.500	863	215	219
BH03	03/11/24	<1.0	<1.0	<1.0	<2.0	<1.0	<1.0	<1.0	<0.500	910	202	152
BH04	06/19/23	<1.0	<1.0	<1.0	<2.0	<1.0	<1.0	<1.0	<0.500	804	210	236
BH04	09/01/23	<1.0	<1.0	<1.0	<2.0	<1.0	<1.0	<1.0	<0.500	1,180	256	168
BH04	12/06/23	<1.0	<1.0	<1.0	<2.0	<1.0	<1.0	<1.0	<0.500	770	205	180
BH04	03/11/24	<1.0	<1.0	<1.0	<2.0	<1.0	<1.0	<1.0	<0.500	864	198	149
BH05	06/19/23	<1.0	<1.0	<1.0	<2.0	<1.0	<1.0	<1.0	<0.500	991	291	270
BH05	09/01/23	<1.0	<1.0	<1.0	<2.0	<1.0	<1.0	<1.0	<0.500	1,210	232	214
BH05	12/06/23	<1.0	<1.0	<1.0	<2.0	<1.0	<1.0	<1.0	<0.500	717	208	156
BH05	03/11/24	<1.0	<1.0	<1.0	<2.0	<1.0	<1.0	<1.0	<0.500	898	196	168
⁽³⁾ BH06	06/19/23	<1.0	<1.0	<1.0	<2.0	<1.0	<1.0	<1.0	<0.500	1,020	280	299
⁽³⁾ BH06	09/01/23	<1.0	<1.0	<1.0	<2.0	<1.0	<1.0	<1.0	<0.500	1,300	243	263
⁽³⁾ BH06	12/06/23	<1.0	<1.0	<1.0	<2.0	<1.0	<1.0	<1.0	<0.500	763	216	161
⁽³⁾ BH06	03/11/24	<1.0	<1.0	<1.0	<2.0	<1.0	<1.0	<1.0	<0.500	778	196	155

Notes:

⁽¹⁾ Groundwater standards referenced from 2 CCR 404-1, Table 915-1 (January 15, 2021).

⁽²⁾ Groundwater standards referenced from USEPA Regional Screening Level (RSL) Resident Tapwater Table (TR=1E-06, HQ=0.1) November 2022.

⁽³⁾ Monitoring well used for inorganic background levels.

Definitions:

< = Analytical result is less than the indicated laboratory reporting limit
 ECMC = Energy and Carbon Management Commission
 USEPA = United States Environmental Protection Agency
 mg/L = Milligrams per liter
 µg/L = Micrograms per liter
 1,2,4 - TMB = 1,2,4 Trimethylbenzene
 1,3,5 - TMB = 1,3,5 Trimethylbenzene
 2-M = 2-Methylnaphthalene
 TDS = Total Dissolved Solids

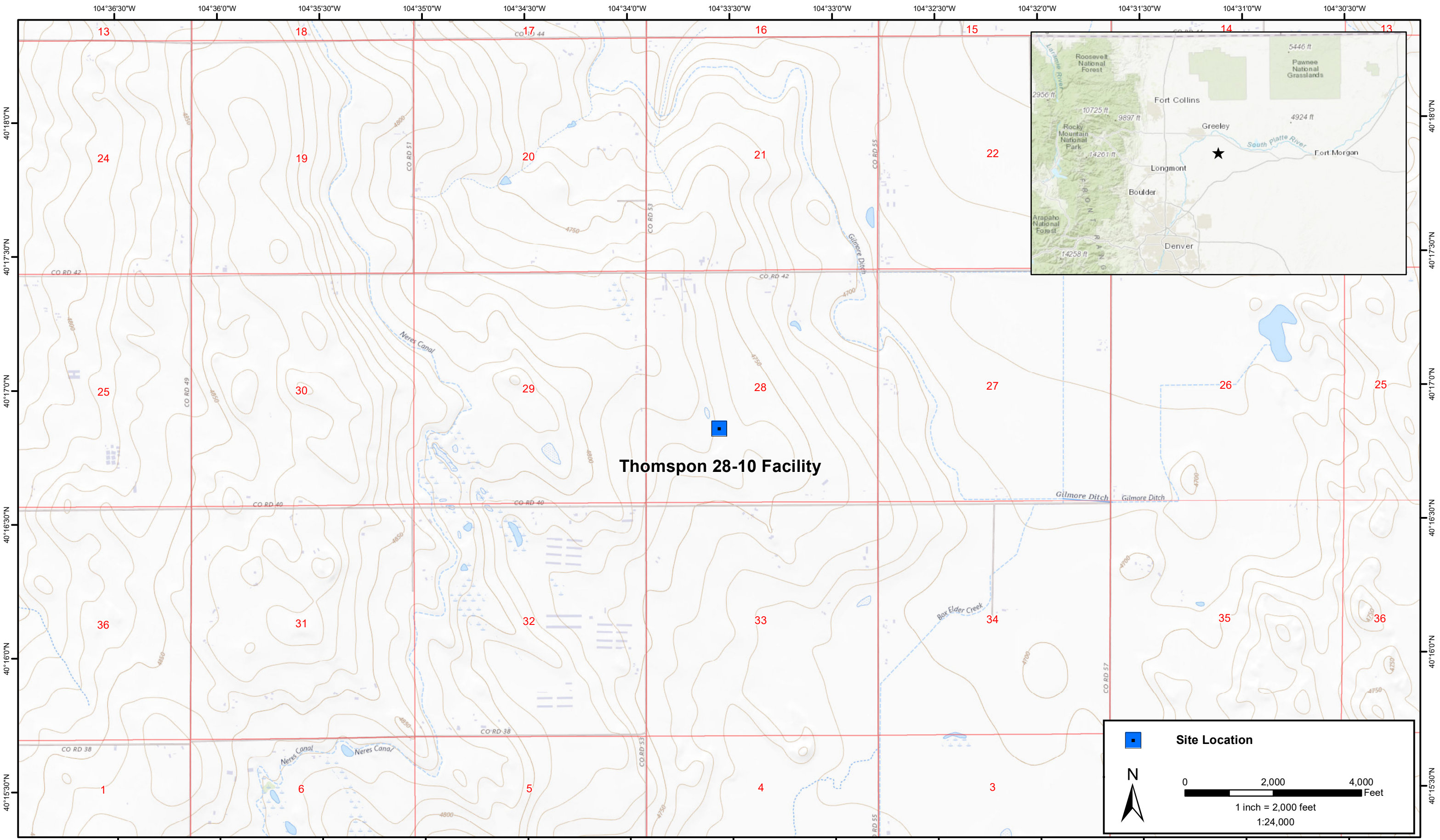

DATE:	March 2023
DESIGNED BY:	S. Vogt
DRAWN BY:	L. Reed



Tasman, Inc.
6855 W. 119th Ave
Broomfield, CO 80020



Noble Energy, Inc - DJ Basin
Thomson 28-10 Facility
NESW Sec 28 T4N-R64W
Weld County, Colorado

Site Location Map

Figure
1



Legend

-  Monitoring Well Location (Collected via Trimble GPS)
-  Excavation Extent (Collected via Trimble GPS)

Notes

- 1) All locations are approximate unless otherwise noted.
- 2) Buried infrastructure has been spatially projected.

GPS – Global Positioning System

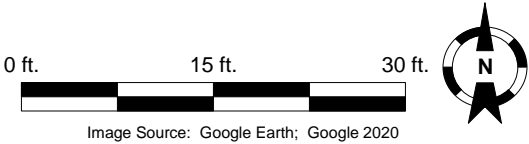



Image Source: Google Earth; Google 2020

DATE: 03/20/2024	 <div>Tasman, Inc. 6855 W 119th Avenue Broomfield, CO 80020</div>	Noble Energy, Inc. – DJ Basin Thompson 28-10 Facility NESW, Section 28, Township 4 North, Range 64 West Weld County, Colorado	Site Overview Map	FIGURE 2
DESIGNED BY: JW				
DRAWN BY: HM				





Summit Scientific

4653 Table Mountain Drive, Golden, Colorado 80403

303.277.9310

April 16, 2024

Jacob Whritenour

Tasman Geosciences

6855 W. 119th Ave.

Broomfield, CO 80020

RE: Noble - Thompson 28-10

Work Order #2403165

Enclosed are the results of analyses for samples received by Summit Scientific on 03/11/24 17:24. If you have any questions concerning this report, please feel free to contact me.

Sincerely,

A handwritten signature in black ink, appearing to read 'P. Shrewsbury', with a stylized, cursive script.

Paul Shrewsbury

President



Tasman Geosciences
6855 W. 119th Ave.
Broomfield CO, 80020

Project: Noble - Thompson 28-10
Project Number: UWRWE-A2396-ABN
Project Manager: Jacob Whritenour

Reported:
04/16/24 11:38

ANALYTICAL REPORT FOR SAMPLES

Sample ID	Laboratory ID	Matrix	Date Sampled	Date Received
BH01	2403165-01	Water	03/11/24 15:17	03/11/24 17:24
BH02	2403165-02	Water	03/11/24 14:53	03/11/24 17:24
BH03	2403165-03	Water	03/11/24 14:45	03/11/24 17:24
BH04	2403165-04	Water	03/11/24 14:55	03/11/24 17:24
BH05	2403165-05	Water	03/11/24 15:20	03/11/24 17:24
BH06	2403165-06	Water	03/11/24 15:02	03/11/24 17:24

Summit Scientific

The results in this report apply to the samples analyzed in accordance with the chain of custody document. This analytical report must be reproduced in its entirety.

Client: Noble/Tasman		Send Data To:		Send Invoice To:	
Address: 6855 W. 119th Ave.		Project Manager: Jake Whritenour		Company: Cherron	
City/State/Zip: Broomfield/CO/ 80020		E-Mail: Jwhritenour@tasman-geo.com		Project Name/Location: Thompson 28-10	
Phone: 3177445-0601		Project Name: Thompson 28-10		AFE#:	
Sampler Name: Luke Moran, Molly Parks		Project Number:		PO/Billing Codes:	
				Contact: Dan Peterson	

ID	Sample Description	Date Sampled	Time Sampled	# of containers	Preservative				Matrix				Analysis Requested						Special Instructions
					HCl	HNO3	None	Other	Water	Soil	Air-Canister #	Other	BTEXN	1,2,4 & 1,3,5-TMBs	TDS, Cl, SO4	PAHs *			
1	BH01	3/11/24	1517	6	3		3		X				X	X	X	X			
2	BH02		1453																
3	BH03		1445																
4	BH04		1455																
5	BH05		1520																
6	BH06		1502																
7																			
8																			
9																			
10																			
11																			
12																			
13																			
14																			
15																			

Relinquished by: Luke Moran	Date/Time: 3/11/24 1700	Received by: Tasman Lock Box	Date/Time: 3/11/24 1700	TAT Business Days	Field DO	PAHs; Notes: * 2-M
Relinquished by: Tasman Lock Box	Date/Time: 3/12/24 1754	Received by: [Signature]	Date/Time: 3/12/24 1754	Same Day	Field EC	
Relinquished by:	Date/Time:	Received by:	Date/Time:	1 Day	Field ORP	
				2 Days	Field pH	
				3 Days	Field Temp.	
Temperature Upon Receipt: 7.6	Corrected Temperature: 6	IR gun #: 1	HNO3 lot #:	Standard	X	Field Turb.

S₂

Sample Receipt Checklist

S2 Work Order# 2403165Client: Noble GasmanClient Project ID: Thompson 28-10Shipped Via: H.D./P.U./FedEx/UPS/USPS/Other ☐

Airbill #:

<input type="checkbox"/>	<input type="checkbox"/>	<input type="checkbox"/>	<input type="checkbox"/>	<input type="checkbox"/>
--------------------------	--------------------------	--------------------------	--------------------------	--------------------------

Matrix (Check all that apply)

Air

☐

Soil/Solid

☐

Water

☒

Other

☐

Temp (°C)

Thermometer #

	Yes	No	N/A	Comments (if any)
If samples require cooling, is the temperature < 6°C? ⁽¹⁾ NOTE: If samples are delivered the same day of sampling, this requirement is met if there is evidence that cooling has begun.	<input checked="" type="checkbox"/>	<input type="checkbox"/>	<input type="checkbox"/>	
If custody seals are present, are they intact? ⁽¹⁾	<input checked="" type="checkbox"/>	<input type="checkbox"/>	<input type="checkbox"/>	on 7.6
Are samples due within 48 hours present?	<input type="checkbox"/>	<input checked="" type="checkbox"/>	<input type="checkbox"/>	
Are water samples with short hold times present? Note the short hold analysis in the comments column - pH, Nitrate/Nitrite, Ferrous Iron (Fe ²⁺), Hexavalent Chromium (Cr ⁶⁺ , Cr VI), COD/BOD, Total Coliform, E. Coli, Total Residual Chlorine (TRC), Dissolved Oxygen	<input type="checkbox"/>	<input checked="" type="checkbox"/>	<input type="checkbox"/>	
Is a chain-of-custody (COC) form present and filled out Completely? ⁽¹⁾	<input checked="" type="checkbox"/>	<input type="checkbox"/>	<input type="checkbox"/>	
Is the COC properly relinquished by the client w/ date and time recorded? ⁽¹⁾	<input checked="" type="checkbox"/>	<input type="checkbox"/>	<input type="checkbox"/>	
Were all samples received intact? ⁽¹⁾	<input checked="" type="checkbox"/>	<input type="checkbox"/>	<input type="checkbox"/>	
Was adequate sample volume provided? ⁽¹⁾	<input checked="" type="checkbox"/>	<input type="checkbox"/>	<input type="checkbox"/>	
Does the COC agree with the number and type of sample bottles received? ⁽¹⁾	<input checked="" type="checkbox"/>	<input type="checkbox"/>	<input type="checkbox"/>	
Do the sample IDs on the bottle labels match the COC? ⁽¹⁾	<input checked="" type="checkbox"/>	<input type="checkbox"/>	<input type="checkbox"/>	
For volatiles in water – is there headspace present? If yes, contact client and note in narrative.	<input type="checkbox"/>	<input checked="" type="checkbox"/>	<input type="checkbox"/>	
Are samples preserved that require preservation (excluding cooling)? ⁽¹⁾ Note the type of preservative in the comments column – HCl, H ₂ SO ₄ , NaOH, HNO ₃ , etc.	<input checked="" type="checkbox"/>	<input type="checkbox"/>	<input type="checkbox"/>	HCl
If samples are acid preserved for metals, is the pH ≤ 2? ⁽¹⁾ Record the pH in Comments.	<input type="checkbox"/>	<input type="checkbox"/>	<input checked="" type="checkbox"/>	
If dissolved metals are requested, were samples field filtered?	<input type="checkbox"/>	<input type="checkbox"/>	<input checked="" type="checkbox"/>	
Additional Comments (if any):				

⁽¹⁾ If NO, then contact the client before proceeding with analysis and note in case narrative.

Custodian Printed Name

Date/Time

AB

3/11/24



Tasman Geosciences
6855 W. 119th Ave.
Broomfield CO, 80020

Project: Noble - Thompson 28-10
Project Number: UWRWE-A2396-ABN
Project Manager: Jacob Whritenour

Reported:
04/16/24 11:38

BH01
2403165-01 (Water)

Summit Scientific

Volatile Organic Compounds by EPA Method 8260B

Date Sampled: **03/11/24 15:17**

Analyte	Result	Reporting		Units	Dilution	Batch	Prepared	Analyzed	Method	Notes
		Limit								
Benzene	ND	1.0		ug/l	1	BHC0357	03/13/24	03/14/24	EPA 8260B	
Toluene	ND	1.0		"	"	"	"	"	"	
Ethylbenzene	ND	1.0		"	"	"	"	"	"	
Xylenes (total)	ND	2.0		"	"	"	"	"	"	
Naphthalene	ND	1.0		"	"	"	"	"	"	
1,2,4-Trimethylbenzene	ND	1.0		"	"	"	"	"	"	
1,3,5-Trimethylbenzene	ND	1.0		"	"	"	"	"	"	

Date Sampled: **03/11/24 15:17**

Analyte	Result	Reporting		Units	Dilution	Batch	Prepared	Analyzed	Method	Notes
		Limit								
Surrogate: 1,2-Dichloroethane-d4	9.92	74.4 %		23-173		"	"	"	"	
Surrogate: Toluene-d8	12.8	96.4 %		20-170		"	"	"	"	
Surrogate: 4-Bromofluorobenzene	10.6	79.9 %		21-167		"	"	"	"	

PAH by EPA Method 8270D SIM

Date Sampled: **03/11/24 15:17**

Analyte	Result	Reporting		Units	Dilution	Batch	Prepared	Analyzed	Method	Notes
		Limit								
2-Methylnaphthalene	ND	0.500		ug/l	1	BHC0362	03/13/24	03/15/24	EPA 8270D SIM	

Date Sampled: **03/11/24 15:17**

Analyte	Result	Reporting		Units	Dilution	Batch	Prepared	Analyzed	Method	Notes
		Limit								
Surrogate: 2-Methylnaphthalene-d10	1.65	82.7 %		40-150		"	"	"	"	
Surrogate: Fluoranthene-d10	1.75	87.4 %		40-150		"	"	"	"	

Anions by EPA Method 300.0

Summit Scientific

The results in this report apply to the samples analyzed in accordance with the chain of custody document. This analytical report must be reproduced in its entirety.



Tasman Geosciences
6855 W. 119th Ave.
Broomfield CO, 80020

Project: Noble - Thompson 28-10
Project Number: UWRWE-A2396-ABN
Project Manager: Jacob Whritenour

Reported:
04/16/24 11:38

BH01
2403165-01 (Water)

Summit Scientific

Anions by EPA Method 300.0

Date Sampled: **03/11/24 15:17**

Analyte	Result	Reporting		Units	Dilution	Batch	Prepared	Analyzed	Method	Notes
		Limit								
Chloride	197	12.0		mg/L	200	BHC0474	03/15/24	03/16/24	EPA 300.0	
Sulfate	152	60.0		"	"	"	"	"	"	

Total Dissolved Solids by SM2540C

Date Sampled: **03/11/24 15:17**

Analyte	Result	Reporting		Units	Dilution	Batch	Prepared	Analyzed	Method	Notes
		Limit								
Total Dissolved Solids	865	10.0		mg/L	1	BHC0353	03/13/24	03/13/24	SM2540C	

Summit Scientific

The results in this report apply to the samples analyzed in accordance with the chain of custody document. This analytical report must be reproduced in its entirety.



Tasman Geosciences
6855 W. 119th Ave.
Broomfield CO, 80020

Project: Noble - Thompson 28-10
Project Number: UWRWE-A2396-ABN
Project Manager: Jacob Whritenour

Reported:
04/16/24 11:38

BH02
2403165-02 (Water)

Summit Scientific

Volatile Organic Compounds by EPA Method 8260B

Date Sampled: **03/11/24 14:53**

Analyte	Result	Reporting	Units	Dilution	Batch	Prepared	Analyzed	Method	Notes
		Limit							
Benzene	ND	1.0	ug/l	1	BHC0357	03/13/24	03/14/24	EPA 8260B	
Toluene	ND	1.0	"	"	"	"	"	"	
Ethylbenzene	ND	1.0	"	"	"	"	"	"	
Xylenes (total)	ND	2.0	"	"	"	"	"	"	
Naphthalene	ND	1.0	"	"	"	"	"	"	
1,2,4-Trimethylbenzene	ND	1.0	"	"	"	"	"	"	
1,3,5-Trimethylbenzene	ND	1.0	"	"	"	"	"	"	

Date Sampled: **03/11/24 14:53**

Analyte	Result	Reporting	Units	Dilution	Batch	Prepared	Analyzed	Method	Notes
		Limit							
Surrogate: 1,2-Dichloroethane-d4	10.4	78.3 %	23-173		"	"	"	"	
Surrogate: Toluene-d8	12.8	96.4 %	20-170		"	"	"	"	
Surrogate: 4-Bromofluorobenzene	10.9	81.6 %	21-167		"	"	"	"	

PAH by EPA Method 8270D SIM

Date Sampled: **03/11/24 14:53**

Analyte	Result	Reporting	Units	Dilution	Batch	Prepared	Analyzed	Method	Notes
		Limit							
2-Methylnaphthalene	ND	0.500	ug/l	1	BHC0362	03/13/24	03/15/24	EPA 8270D SIM	

Date Sampled: **03/11/24 14:53**

Analyte	Result	Reporting	Units	Dilution	Batch	Prepared	Analyzed	Method	Notes
		Limit							
Surrogate: 2-Methylnaphthalene-d10	1.50	75.0 %	40-150		"	"	"	"	
Surrogate: Fluoranthene-d10	1.66	83.1 %	40-150		"	"	"	"	

Anions by EPA Method 300.0

Summit Scientific

The results in this report apply to the samples analyzed in accordance with the chain of custody document. This analytical report must be reproduced in its entirety.



Tasman Geosciences
6855 W. 119th Ave.
Broomfield CO, 80020

Project: Noble - Thompson 28-10
Project Number: UWRWE-A2396-ABN
Project Manager: Jacob Whritenour

Reported:
04/16/24 11:38

BH02
2403165-02 (Water)

Summit Scientific

Anions by EPA Method 300.0

Date Sampled: **03/11/24 14:53**

Analyte	Result	Reporting		Units	Dilution	Batch	Prepared	Analyzed	Method	Notes
		Limit								
Chloride	185	12.0		mg/L	200	BHC0474	03/15/24	03/16/24	EPA 300.0	
Sulfate	151	60.0		"	"	"	"	"	"	

Total Dissolved Solids by SM2540C

Date Sampled: **03/11/24 14:53**

Analyte	Result	Reporting		Units	Dilution	Batch	Prepared	Analyzed	Method	Notes
		Limit								
Total Dissolved Solids	844	10.0		mg/L	1	BHC0353	03/13/24	03/13/24	SM2540C	

Summit Scientific

The results in this report apply to the samples analyzed in accordance with the chain of custody document. This analytical report must be reproduced in its entirety.



Tasman Geosciences
6855 W. 119th Ave.
Broomfield CO, 80020

Project: Noble - Thompson 28-10
Project Number: UWRWE-A2396-ABN
Project Manager: Jacob Whritenour

Reported:
04/16/24 11:38

BH03
2403165-03 (Water)

Summit Scientific

Volatile Organic Compounds by EPA Method 8260B

Date Sampled: **03/11/24 14:45**

Analyte	Result	Reporting	Units	Dilution	Batch	Prepared	Analyzed	Method	Notes
		Limit							
Benzene	ND	1.0	ug/l	1	BHC0357	03/13/24	03/14/24	EPA 8260B	
Toluene	ND	1.0	"	"	"	"	"	"	
Ethylbenzene	ND	1.0	"	"	"	"	"	"	
Xylenes (total)	ND	2.0	"	"	"	"	"	"	
Naphthalene	ND	1.0	"	"	"	"	"	"	
1,2,4-Trimethylbenzene	ND	1.0	"	"	"	"	"	"	
1,3,5-Trimethylbenzene	ND	1.0	"	"	"	"	"	"	

Date Sampled: **03/11/24 14:45**

Analyte	Result	Reporting	Units	Dilution	Batch	Prepared	Analyzed	Method	Notes
		Limit							
Surrogate: 1,2-Dichloroethane-d4	10.2	76.6 %	23-173		"	"	"	"	
Surrogate: Toluene-d8	12.9	96.9 %	20-170		"	"	"	"	
Surrogate: 4-Bromofluorobenzene	10.5	78.5 %	21-167		"	"	"	"	

PAH by EPA Method 8270D SIM

Date Sampled: **03/11/24 14:45**

Analyte	Result	Reporting	Units	Dilution	Batch	Prepared	Analyzed	Method	Notes
		Limit							
2-Methylnaphthalene	ND	0.500	ug/l	1	BHC0362	03/13/24	03/15/24	EPA 8270D SIM	

Date Sampled: **03/11/24 14:45**

Analyte	Result	Reporting	Units	Dilution	Batch	Prepared	Analyzed	Method	Notes
		Limit							
Surrogate: 2-Methylnaphthalene-d10	1.45	72.5 %	40-150		"	"	"	"	
Surrogate: Fluoranthene-d10	1.58	79.2 %	40-150		"	"	"	"	

Anions by EPA Method 300.0

Summit Scientific

The results in this report apply to the samples analyzed in accordance with the chain of custody document. This analytical report must be reproduced in its entirety.



Tasman Geosciences
6855 W. 119th Ave.
Broomfield CO, 80020

Project: Noble - Thompson 28-10
Project Number: UWRWE-A2396-ABN
Project Manager: Jacob Whritenour

Reported:
04/16/24 11:38

BH03
2403165-03 (Water)

Summit Scientific

Anions by EPA Method 300.0

Date Sampled: **03/11/24 14:45**

Analyte	Result	Reporting		Units	Dilution	Batch	Prepared	Analyzed	Method	Notes
		Limit								
Chloride	202	12.0		mg/L	200	BHC0474	03/15/24	03/16/24	EPA 300.0	
Sulfate	152	60.0		"	"	"	"	"	"	

Total Dissolved Solids by SM2540C

Date Sampled: **03/11/24 14:45**

Analyte	Result	Reporting		Units	Dilution	Batch	Prepared	Analyzed	Method	Notes
		Limit								
Total Dissolved Solids	910	10.0		mg/L	1	BHC0353	03/13/24	03/13/24	SM2540C	

Summit Scientific

The results in this report apply to the samples analyzed in accordance with the chain of custody document. This analytical report must be reproduced in its entirety.



Tasman Geosciences
6855 W. 119th Ave.
Broomfield CO, 80020

Project: Noble - Thompson 28-10
Project Number: UWRWE-A2396-ABN
Project Manager: Jacob Whritenour

Reported:
04/16/24 11:38

BH04
2403165-04 (Water)

Summit Scientific

Volatile Organic Compounds by EPA Method 8260B

Date Sampled: **03/11/24 14:55**

Analyte	Result	Reporting	Units	Dilution	Batch	Prepared	Analyzed	Method	Notes
		Limit							
Benzene	ND	1.0	ug/l	1	BHC0357	03/13/24	03/14/24	EPA 8260B	
Toluene	ND	1.0	"	"	"	"	"	"	
Ethylbenzene	ND	1.0	"	"	"	"	"	"	
Xylenes (total)	ND	2.0	"	"	"	"	"	"	
Naphthalene	ND	1.0	"	"	"	"	"	"	
1,2,4-Trimethylbenzene	ND	1.0	"	"	"	"	"	"	
1,3,5-Trimethylbenzene	ND	1.0	"	"	"	"	"	"	

Date Sampled: **03/11/24 14:55**

Analyte	Result	Reporting	Units	Dilution	Batch	Prepared	Analyzed	Method	Notes
		Limit							
Surrogate: 1,2-Dichloroethane-d4	10.0	75.2 %	23-173		"	"	"	"	
Surrogate: Toluene-d8	12.9	96.6 %	20-170		"	"	"	"	
Surrogate: 4-Bromofluorobenzene	10.5	78.8 %	21-167		"	"	"	"	

PAH by EPA Method 8270D SIM

Date Sampled: **03/11/24 14:55**

Analyte	Result	Reporting	Units	Dilution	Batch	Prepared	Analyzed	Method	Notes
		Limit							
2-Methylnaphthalene	ND	0.500	ug/l	1	BHC0362	03/13/24	03/15/24	EPA 8270D SIM	

Date Sampled: **03/11/24 14:55**

Analyte	Result	Reporting	Units	Dilution	Batch	Prepared	Analyzed	Method	Notes
		Limit							
Surrogate: 2-Methylnaphthalene-d10	1.60	80.1 %	40-150		"	"	"	"	
Surrogate: Fluoranthene-d10	1.77	88.4 %	40-150		"	"	"	"	

Anions by EPA Method 300.0

Summit Scientific

The results in this report apply to the samples analyzed in accordance with the chain of custody document. This analytical report must be reproduced in its entirety.



Tasman Geosciences
6855 W. 119th Ave.
Broomfield CO, 80020

Project: Noble - Thompson 28-10
Project Number: UWRWE-A2396-ABN
Project Manager: Jacob Whritenour

Reported:
04/16/24 11:38

BH04
2403165-04 (Water)

Summit Scientific

Anions by EPA Method 300.0

Date Sampled: **03/11/24 14:55**

Analyte	Result	Reporting		Units	Dilution	Batch	Prepared	Analyzed	Method	Notes
		Limit								
Chloride	198	12.0		mg/L	200	BHC0474	03/15/24	03/16/24	EPA 300.0	
Sulfate	149	60.0		"	"	"	"	"	"	

Total Dissolved Solids by SM2540C

Date Sampled: **03/11/24 14:55**

Analyte	Result	Reporting		Units	Dilution	Batch	Prepared	Analyzed	Method	Notes
		Limit								
Total Dissolved Solids	864	10.0		mg/L	1	BHC0353	03/13/24	03/13/24	SM2540C	

Summit Scientific

The results in this report apply to the samples analyzed in accordance with the chain of custody document. This analytical report must be reproduced in its entirety.



Tasman Geosciences
6855 W. 119th Ave.
Broomfield CO, 80020

Project: Noble - Thompson 28-10
Project Number: UWRWE-A2396-ABN
Project Manager: Jacob Whritenour

Reported:
04/16/24 11:38

BH05
2403165-05 (Water)

Summit Scientific

Volatile Organic Compounds by EPA Method 8260B

Date Sampled: **03/11/24 15:20**

Analyte	Result	Reporting	Units	Dilution	Batch	Prepared	Analyzed	Method	Notes
		Limit							
Benzene	ND	1.0	ug/l	1	BHC0357	03/13/24	03/14/24	EPA 8260B	
Toluene	ND	1.0	"	"	"	"	"	"	
Ethylbenzene	ND	1.0	"	"	"	"	"	"	
Xylenes (total)	ND	2.0	"	"	"	"	"	"	
Naphthalene	ND	1.0	"	"	"	"	"	"	
1,2,4-Trimethylbenzene	ND	1.0	"	"	"	"	"	"	
1,3,5-Trimethylbenzene	ND	1.0	"	"	"	"	"	"	

Date Sampled: **03/11/24 15:20**

Analyte	Result	Reporting	Units	Dilution	Batch	Prepared	Analyzed	Method	Notes
		Limit							
Surrogate: 1,2-Dichloroethane-d4	9.98	74.9 %	23-173		"	"	"	"	
Surrogate: Toluene-d8	12.8	95.8 %	20-170		"	"	"	"	
Surrogate: 4-Bromofluorobenzene	10.7	80.6 %	21-167		"	"	"	"	

PAH by EPA Method 8270D SIM

Date Sampled: **03/11/24 15:20**

Analyte	Result	Reporting	Units	Dilution	Batch	Prepared	Analyzed	Method	Notes
		Limit							
2-Methylnaphthalene	ND	0.500	ug/l	1	BHC0362	03/13/24	03/15/24	EPA 8270D SIM	

Date Sampled: **03/11/24 15:20**

Analyte	Result	Reporting	Units	Dilution	Batch	Prepared	Analyzed	Method	Notes
		Limit							
Surrogate: 2-Methylnaphthalene-d10	1.66	83.2 %	40-150		"	"	"	"	
Surrogate: Fluoranthene-d10	1.95	97.3 %	40-150		"	"	"	"	

Anions by EPA Method 300.0

Summit Scientific

The results in this report apply to the samples analyzed in accordance with the chain of custody document. This analytical report must be reproduced in its entirety.



Tasman Geosciences
6855 W. 119th Ave.
Broomfield CO, 80020

Project: Noble - Thompson 28-10
Project Number: UWRWE-A2396-ABN
Project Manager: Jacob Whritenour

Reported:
04/16/24 11:38

BH05
2403165-05 (Water)

Summit Scientific

Anions by EPA Method 300.0

Date Sampled: **03/11/24 15:20**

Analyte	Result	Reporting		Units	Dilution	Batch	Prepared	Analyzed	Method	Notes
		Limit								
Chloride	196	12.0		mg/L	200	BHC0474	03/15/24	03/16/24	EPA 300.0	
Sulfate	168	60.0		"	"	"	"	"	"	

Total Dissolved Solids by SM2540C

Date Sampled: **03/11/24 15:20**

Analyte	Result	Reporting		Units	Dilution	Batch	Prepared	Analyzed	Method	Notes
		Limit								
Total Dissolved Solids	898	10.0		mg/L	1	BHC0353	03/13/24	03/13/24	SM2540C	

Summit Scientific

The results in this report apply to the samples analyzed in accordance with the chain of custody document. This analytical report must be reproduced in its entirety.



Tasman Geosciences
6855 W. 119th Ave.
Broomfield CO, 80020

Project: Noble - Thompson 28-10
Project Number: UWRWE-A2396-ABN
Project Manager: Jacob Whritenour

Reported:
04/16/24 11:38

BH06
2403165-06 (Water)

Summit Scientific

Volatile Organic Compounds by EPA Method 8260B

Date Sampled: **03/11/24 15:02**

Analyte	Result	Reporting	Units	Dilution	Batch	Prepared	Analyzed	Method	Notes
		Limit							
Benzene	ND	1.0	ug/l	1	BHC0357	03/13/24	03/14/24	EPA 8260B	
Toluene	ND	1.0	"	"	"	"	"	"	
Ethylbenzene	ND	1.0	"	"	"	"	"	"	
Xylenes (total)	ND	2.0	"	"	"	"	"	"	
Naphthalene	ND	1.0	"	"	"	"	"	"	
1,2,4-Trimethylbenzene	ND	1.0	"	"	"	"	"	"	
1,3,5-Trimethylbenzene	ND	1.0	"	"	"	"	"	"	

Date Sampled: **03/11/24 15:02**

Analyte	Result	Reporting	Units	Dilution	Batch	Prepared	Analyzed	Method	Notes
		Limit							
Surrogate: 1,2-Dichloroethane-d4	10.3	77.4 %	23-173		"	"	"	"	
Surrogate: Toluene-d8	12.7	95.1 %	20-170		"	"	"	"	
Surrogate: 4-Bromofluorobenzene	10.6	79.4 %	21-167		"	"	"	"	

PAH by EPA Method 8270D SIM

Date Sampled: **03/11/24 15:02**

Analyte	Result	Reporting	Units	Dilution	Batch	Prepared	Analyzed	Method	Notes
		Limit							
2-Methylnaphthalene	ND	0.500	ug/l	1	BHC0362	03/13/24	03/15/24	EPA 8270D SIM	

Date Sampled: **03/11/24 15:02**

Analyte	Result	Reporting	Units	Dilution	Batch	Prepared	Analyzed	Method	Notes
		Limit							
Surrogate: 2-Methylnaphthalene-d10	1.49	74.5 %	40-150		"	"	"	"	
Surrogate: Fluoranthene-d10	1.77	88.4 %	40-150		"	"	"	"	

Anions by EPA Method 300.0

Summit Scientific

The results in this report apply to the samples analyzed in accordance with the chain of custody document. This analytical report must be reproduced in its entirety.



Tasman Geosciences
6855 W. 119th Ave.
Broomfield CO, 80020

Project: Noble - Thompson 28-10
Project Number: UWRWE-A2396-ABN
Project Manager: Jacob Whritenour

Reported:
04/16/24 11:38

BH06
2403165-06 (Water)

Summit Scientific

Anions by EPA Method 300.0

Date Sampled: **03/11/24 15:02**

Analyte	Result	Reporting		Units	Dilution	Batch	Prepared	Analyzed	Method	Notes
		Limit								
Chloride	196	12.0		mg/L	200	BHC0474	03/15/24	03/16/24	EPA 300.0	
Sulfate	155	60.0		"	"	"	"	"	"	

Summit Scientific

The results in this report apply to the samples analyzed in accordance with the chain of custody document. This analytical report must be reproduced in its entirety.



Tasman Geosciences
6855 W. 119th Ave.
Broomfield CO, 80020

Project: Noble - Thompson 28-10
Project Number: UWRWE-A2396-ABN
Project Manager: Jacob Whritenour

Reported:
04/16/24 11:38

BH06 2403165-06
(Water)

Summit Scientific

Total Dissolved Solids by SM2540C

Date Sampled: **03/11/24 15:02**

Analyte	Result	Reporting		Units	Dilution	Batch	Prepared	Analyzed	Method	Notes
		Limit								
Total Dissolved Solids	778	10.0		mg/L	1	BHC0790	03/13/24	03/21/24	SM2540C	

Summit Scientific

The results in this report apply to the samples analyzed in accordance with the chain of custody document. This analytical report must be reproduced in its entirety.



Tasman Geosciences
6855 W. 119th Ave.
Broomfield CO, 80020

Project: Noble - Thompson 28-10
Project Number: UWRWE-A2396-ABN
Project Manager: Jacob Whritenour

Reported:
04/16/24 11:38

Volatile Organic Compounds by EPA Method 8260B - Quality Control

Summit Scientific

Analyte	Reporting			Spike	Source		%REC		RPD	
	Result	Limit	Units	Level	Result	%REC	Limits	RPD	Limit	Notes

Batch BHC0357 - EPA 5030 Water MS

Blank (BHC0357-BLK1)

Prepared & Analyzed: 03/13/24

Benzene	ND	1.0	ug/l							
Toluene	ND	1.0	"							
Ethylbenzene	ND	1.0	"							
Xylenes (total)	ND	2.0	"							
Naphthalene	ND	1.0	"							
1,2,4-Trimethylbenzene	ND	1.0	"							
1,3,5-Trimethylbenzene	ND	1.0	"							
Surrogate: 1,2-Dichloroethane-d4	10.9		"	13.3		82.0	23-173			
Surrogate: Toluene-d8	12.9		"	13.3		96.8	20-170			
Surrogate: 4-Bromofluorobenzene	11.5		"	13.3		86.5	21-167			

LCS (BHC0357-BS1)

Prepared & Analyzed: 03/13/24

Benzene	25.9	1.0	ug/l	33.3		77.6	51-132			
Toluene	26.4	1.0	"	33.3		79.2	51-138			
Ethylbenzene	34.6	1.0	"	33.3		104	58-146			
m,p-Xylene	70.6	2.0	"	66.7		106	57-144			
o-Xylene	34.8	1.0	"	33.3		104	53-146			
Naphthalene	26.9	1.0	"	33.3		80.7	70-130			
1,2,4-Trimethylbenzene	26.2	1.0	"	33.3		78.6	70-130			
1,3,5-Trimethylbenzene	25.6	1.0	"	33.3		76.9	70-130			
Surrogate: 1,2-Dichloroethane-d4	15.6		"	13.3		117	23-173			
Surrogate: Toluene-d8	14.8		"	13.3		111	20-170			
Surrogate: 4-Bromofluorobenzene	17.4		"	13.3		130	21-167			

Matrix Spike (BHC0357-MS1)

Source: 2403165-01

Prepared & Analyzed: 03/13/24

Benzene	29.8	1.0	ug/l	33.3	ND	89.3	34-141			
Toluene	30.0	1.0	"	33.3	ND	89.9	27-151			
Ethylbenzene	39.0	1.0	"	33.3	ND	117	29-160			
m,p-Xylene	78.6	2.0	"	66.7	ND	118	20-166			
o-Xylene	34.4	1.0	"	33.3	ND	103	33-159			
Naphthalene	26.8	1.0	"	33.3	ND	80.4	70-130			
1,2,4-Trimethylbenzene	30.5	1.0	"	33.3	ND	91.6	70-130			
1,3,5-Trimethylbenzene	30.4	1.0	"	33.3	ND	91.3	70-130			
Surrogate: 1,2-Dichloroethane-d4	13.2		"	13.3		99.2	23-173			
Surrogate: Toluene-d8	12.5		"	13.3		93.5	20-170			
Surrogate: 4-Bromofluorobenzene	18.8		"	13.3		141	21-167			

Summit Scientific

The results in this report apply to the samples analyzed in accordance with the chain of custody document. This analytical report must be reproduced in its entirety.



Tasman Geosciences
6855 W. 119th Ave.
Broomfield CO, 80020

Project: Noble - Thompson 28-10
Project Number: UWRWE-A2396-ABN
Project Manager: Jacob Whritenour

Reported:
04/16/24 11:38

Volatile Organic Compounds by EPA Method 8260B - Quality Control
Summit Scientific

Analyte	Reporting			Spike	Source		%REC		RPD	
	Result	Limit	Units	Level	Result	%REC	Limits	RPD	Limit	Notes

Batch BHC0357 - EPA 5030 Water MS

Matrix Spike Dup (BHC0357-MSD1)		Source: 2403165-01			Prepared & Analyzed: 03/13/24					
Benzene	29.5	1.0	ug/l	33.3	ND	88.5	34-141	0.844	30	
Toluene	29.6	1.0	"	33.3	ND	88.7	27-151	1.31	30	
Ethylbenzene	33.2	1.0	"	33.3	ND	99.6	29-160	15.9	30	
m,p-Xylene	69.3	2.0	"	66.7	ND	104	20-166	12.6	30	
o-Xylene	32.8	1.0	"	33.3	ND	98.6	33-159	4.46	30	
Naphthalene	27.5	1.0	"	33.3	ND	82.5	70-130	2.61	30	
1,2,4-Trimethylbenzene	25.8	1.0	"	33.3	ND	77.3	70-130	16.9	30	
1,3,5-Trimethylbenzene	26.3	1.0	"	33.3	ND	78.9	70-130	14.6	30	
<hr/>										
Surrogate: 1,2-Dichloroethane-d4	10.2		"	13.3		76.3	23-173			
Surrogate: Toluene-d8	12.8		"	13.3		96.1	20-170			
Surrogate: 4-Bromofluorobenzene	12.1		"	13.3		90.5	21-167			

Summit Scientific

The results in this report apply to the samples analyzed in accordance with the chain of custody document. This analytical report must be reproduced in its entirety.



Tasman Geosciences
6855 W. 119th Ave.
Broomfield CO, 80020

Project: Noble - Thompson 28-10
Project Number: UWRWE-A2396-ABN
Project Manager: Jacob Whritenour

Reported:
04/16/24 11:38

PAH by EPA Method 8270D SIM - Quality Control

Summit Scientific

Analyte	Reporting			Spike	Source		%REC		RPD	
	Result	Limit	Units	Level	Result	%REC	Limits	RPD	Limit	Notes

Batch BHC0362 - EPA 5030 Water MS

Blank (BHC0362-BLK1)

Prepared: 03/13/24 Analyzed: 03/15/24

1-Methylnaphthalene	ND	0.500	ug/l							
2-Methylnaphthalene	ND	0.500	"							
Surrogate: 2-Methylnaphthalene-d10	1.92		"	2.00		95.8	40-150			
Surrogate: Fluoranthene-d10	1.91		"	2.00		95.5	40-150			

LCS (BHC0362-BS1)

Prepared: 03/13/24 Analyzed: 03/15/24

1-Methylnaphthalene	1.72	0.500	ug/l	2.00		85.8	30-120			
2-Methylnaphthalene	1.87	0.500	"	2.00		93.7	0-200			
Surrogate: 2-Methylnaphthalene-d10	1.97		"	2.00		98.7	40-150			
Surrogate: Fluoranthene-d10	1.94		"	2.00		96.8	40-150			

LCS Dup (BHC0362-BSD1)

Prepared: 03/13/24 Analyzed: 03/15/24

1-Methylnaphthalene	1.42	0.500	ug/l	2.00		71.2	30-120	18.6	30	
2-Methylnaphthalene	1.53	0.500	"	2.00		76.6	0-200	20.0	200	
Surrogate: 2-Methylnaphthalene-d10	1.72		"	2.00		86.0	40-150			
Surrogate: Fluoranthene-d10	1.78		"	2.00		88.8	40-150			

Summit Scientific

The results in this report apply to the samples analyzed in accordance with the chain of custody document. This analytical report must be reproduced in its entirety.



Tasman Geosciences
6855 W. 119th Ave.
Broomfield CO, 80020

Project: Noble - Thompson 28-10
Project Number: UWRWE-A2396-ABN
Project Manager: Jacob Whritenour

Reported:
04/16/24 11:38

Anions by EPA Method 300.0 - Quality Control
Summit Scientific

Analyte	Reporting			Spike	Source		%REC		RPD	
	Result	Limit	Units	Level	Result	%REC	Limits	RPD	Limit	Notes

Batch BHC0474 - General Preparation

Blank (BHC0474-BLK1)

Prepared & Analyzed: 03/15/24

Chloride	ND	0.0600	mg/L
Sulfate	ND	0.300	"

LCS (BHC0474-BS1)

Prepared & Analyzed: 03/15/24

Chloride	3.00	0.0600	mg/L	3.00	99.8	90-110
Sulfate	15.0	0.300	"	15.0	100	90-110

Duplicate (BHC0474-DUP1)

Source: 2403151-01

Prepared & Analyzed: 03/15/24

Chloride	55.8	12.0	mg/L	59.4	6.25	20
Sulfate	663	60.0	"	676	1.91	20

Matrix Spike (BHC0474-MS1)

Source: 2403151-01

Prepared & Analyzed: 03/15/24

Chloride	654	12.0	mg/L	600	59.4	99.1	80-120
Sulfate	3680	60.0	"	3000	676	100	80-120

Matrix Spike (BHC0474-MS2)

Source: 2403169-01

Prepared & Analyzed: 03/15/24

Chloride	646	12.0	mg/L	600	47.8	99.7	80-120
Sulfate	3290	60.0	"	3000	316	99.0	80-120

Summit Scientific

The results in this report apply to the samples analyzed in accordance with the chain of custody document. This analytical report must be reproduced in its entirety.



Tasman Geosciences
6855 W. 119th Ave.
Broomfield CO, 80020

Project: Noble - Thompson 28-10
Project Number: UWRWE-A2396-ABN
Project Manager: Jacob Whritenour

Reported:
04/16/24 11:38

Total Dissolved Solids by SM2540C - Quality Control
Summit Scientific

Analyte	Reporting			Spike	Source	%REC		RPD		
	Result	Limit	Units	Level	Result	%REC	Limits	RPD	Limit	Notes

Batch BHC0353 - General Preparation

Blank (BHC0353-BLK1)

Prepared & Analyzed: 03/13/24

Total Dissolved Solids ND 10.0 mg/L

Duplicate (BHC0353-DUP1)

Source: 2403141-01

Prepared & Analyzed: 03/13/24

Total Dissolved Solids 1310 10.0 mg/L 1330 1.06 20

Batch BHC0790 - General Preparation

Blank (BHC0790-BLK1)

Prepared & Analyzed: 03/21/24

Total Dissolved Solids ND 10.0 mg/L

Duplicate (BHC0790-DUP1)

Source: 2403165-06RE1

Prepared & Analyzed: 03/21/24

Total Dissolved Solids 782 10.0 mg/L 778 0.423 20

Summit Scientific

The results in this report apply to the samples analyzed in accordance with the chain of custody document. This analytical report must be reproduced in its entirety.



Tasman Geosciences
6855 W. 119th Ave.
Broomfield CO, 80020

Project: Noble - Thompson 28-10

Project Number: UWRWE-A2396-ABN
Project Manager: Jacob Whritenour

Reported:
04/16/24 11:38

Notes and Definitions

DET	Analyte DETECTED
ND	Analyte NOT DETECTED at or above the reporting limit
NR	Not Reported
dry	Sample results reported on a dry weight basis
RPD	Relative Percent Difference