

# Chevron DJ Basin

DRAKE 03N

Drake Pad

North American Datum 1983 , US State Plane 1983, Colorado Northern Zone

Ground Elevation: 4737.0

+N/-S	+E/-W	Northing	Easting	Latitude	Longitude
0.0	0.0	1358528.26	3256485.50	40.313909	-104.580232

P272 - RKB 28.5' Well @ 4765.5ft (P272 - RKB 28.5')



Drake Pad  
DRAKE 03N  
Drake 03N Final Surveys  
14:35, March 21 2024

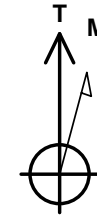

Azimuths to True North  
Magnetic North: 7.68°

Magnetic Field  
Strength: 51682.7nT  
Dip Angle: 66.55°  
Date: 11/08/2023  
Model: HRGM

### ANNOTATIONS

MD	TVD	Annotation
8062.0	6939.2	LPL - 545' FNL & 518' FEL
18927.0	6790.8	BHL - 556' FNL & 206' FEL

### FINAL SURVEY

**Projected Bottom Hole Location**  
**18927.0' MD / 6790.8' TVD**  
**90.58° INC / 89.84° AZM**  
**556' FNL / 206' FEL**

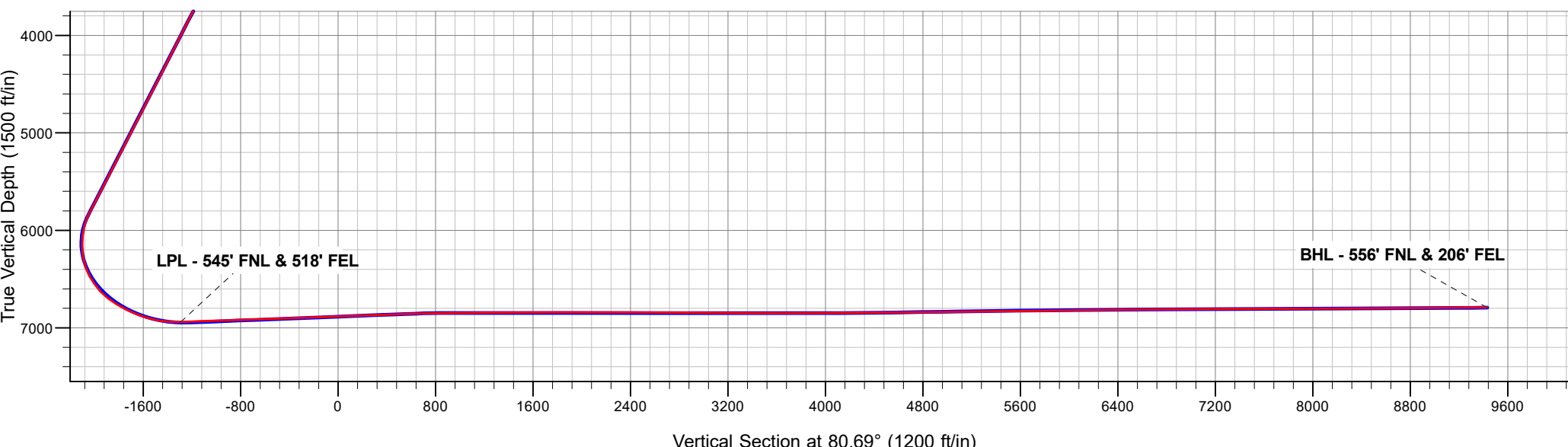
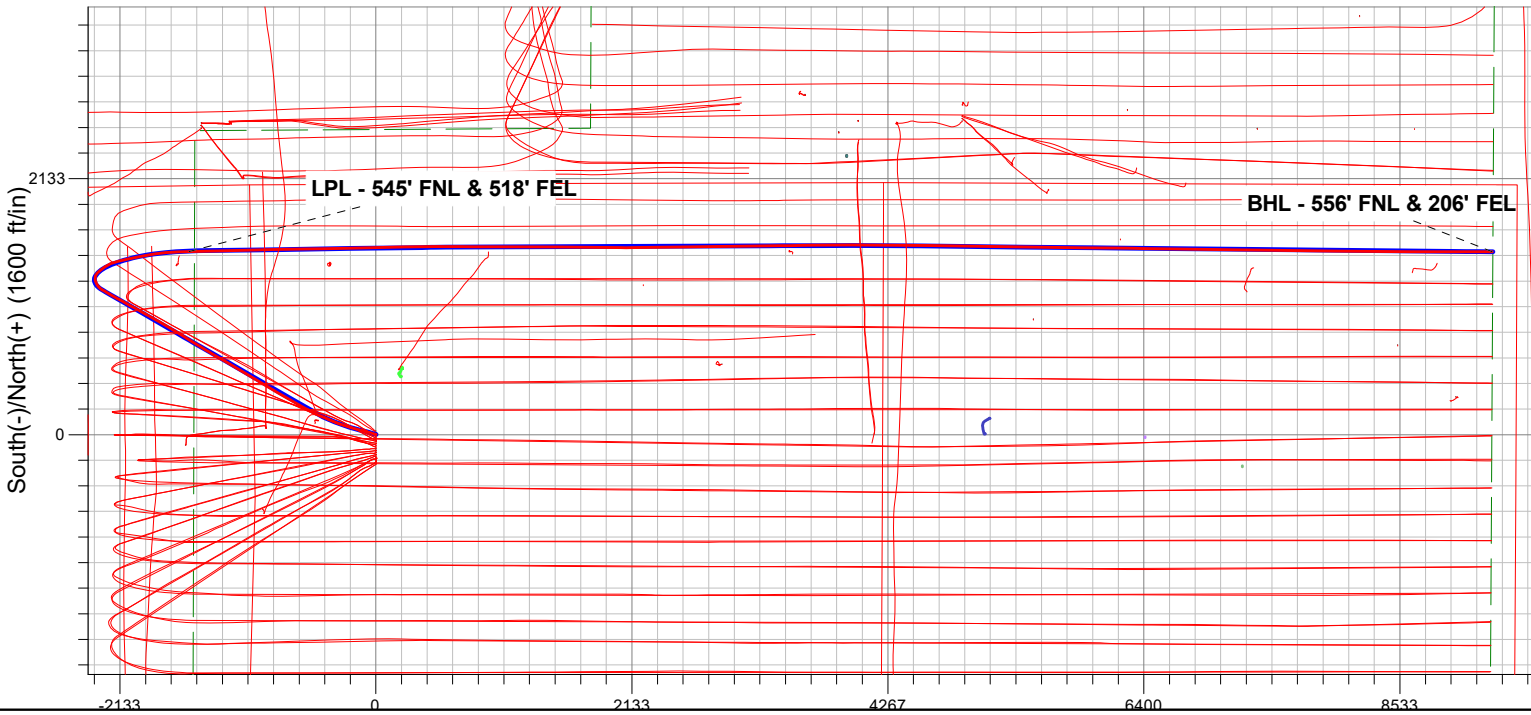

# **Chevron DJ Basin**

**SEC.17-T4N-R64W**

**Drake Pad**

**DRAKE 03N**

**Drake 03N**

**Design: Drake 03N Final Surveys**

## **Survey Report - Geographic**

**21 March, 2024**

# Ensign

## Survey Report - Geographic

<b>Company:</b> Chevron DJ Basin	<b>Local Co-ordinate Reference:</b> Well DRAKE 03N
<b>Project:</b> SEC.17-T4N-R64W	<b>TVD Reference:</b> Well @ 4765.5ft (P272 - RKB 28.5')
<b>Site:</b> Drake Pad	<b>MD Reference:</b> Well @ 4765.5ft (P272 - RKB 28.5')
<b>Well:</b> DRAKE 03N	<b>North Reference:</b> True
<b>Wellbore:</b> Drake 03N	<b>Survey Calculation Method:</b> Minimum Curvature
<b>Design:</b> Drake 03N Final Surveys	<b>Database:</b> US_EDM

<b>Project</b> SEC.17-T4N-R64W, Weld County, Colorado			
<b>Map System:</b> US State Plane 1983	<b>System Datum:</b> Mean Sea Level		
<b>Geo Datum:</b> North American Datum 1983			
<b>Map Zone:</b> Colorado Northern Zone		Using geodetic scale factor	

<b>Site</b> Drake Pad			
<b>Site Position:</b>	<b>Northing:</b> 1,358,393.41 usft	<b>Latitude:</b> 40.313539	
<b>From:</b> Lat/Long	<b>Easting:</b> 3,256,487.58 usft	<b>Longitude:</b> -104.580230	
<b>Position Uncertainty:</b> 0.0 ft	<b>Slot Radius:</b> 13-3/16 "	<b>Grid Convergence:</b> 0.59 °	

<b>Well</b> DRAKE 03N			
<b>Well Position</b>	<b>+N/-S</b> 0.0 ft	<b>Northing:</b> 1,358,528.27 usft	<b>Latitude:</b> 40.313909
	<b>+E/-W</b> 0.0 ft	<b>Easting:</b> 3,256,485.51 usft	<b>Longitude:</b> -104.580233
<b>Position Uncertainty</b> 0.0 ft		<b>Wellhead Elevation:</b> ft	<b>Ground Level:</b> 4,737.0 ft

<b>Wellbore</b> Drake 03N					
Magnetics	Model Name	Sample Date	Declination (°)	Dip Angle (°)	Field Strength (nT)
	HRGM	11/08/2023	7.68	66.55	51,682.69945034

<b>Design</b> Drake 03N Final Surveys					
<b>Audit Notes:</b>					
<b>Version:</b> 1.0	<b>Phase:</b> ACTUAL	<b>Tie On Depth:</b> 0.0			
Vertical Section:	Depth From (TVD) (ft)	+N/-S (ft)	+E/-W (ft)	Direction (°)	
	0.0	0.0	0.0	80.69	

<b>Survey Program</b> Date 03/21/2024					
From (ft)	To (ft)	Survey (Wellbore)	Tool Name	Description	
158.5	18,927.0	Survey #1 (Drake 03N)	MWD	MWD - Standard	

<b>Survey</b>										
Measured Depth (ft)	Inclination (°)	Azimuth (°)	Vertical Depth (ft)	+N/-S (ft)	+E/-W (ft)	Map Northing (usft)	Map Easting (usft)	Latitude	Longitude	
0.0	0.00	0.00	0.0	0.0	0.0	1,358,528.27	3,256,485.51	40.313909	-104.580233	
158.5	0.09	81.70	158.5	0.0	0.1	1,358,528.28	3,256,485.63	40.313909	-104.580232	
249.5	0.44	282.97	249.5	0.1	-0.1	1,358,528.37	3,256,485.36	40.313910	-104.580233	
340.5	2.29	289.65	340.5	0.8	-2.2	1,358,529.04	3,256,483.30	40.313911	-104.580241	
458.5	4.40	291.94	458.3	3.3	-8.6	1,358,531.46	3,256,476.86	40.313918	-104.580264	
545.5	5.36	290.71	544.9	6.0	-15.5	1,358,534.07	3,256,469.93	40.313926	-104.580288	
632.5	7.30	288.60	631.4	9.2	-24.6	1,358,537.17	3,256,460.86	40.313934	-104.580321	
719.5	9.32	284.73	717.5	12.7	-36.6	1,358,540.60	3,256,448.77	40.313944	-104.580364	
806.5	11.70	284.03	803.0	16.7	-52.0	1,358,544.37	3,256,433.36	40.313955	-104.580419	
892.5	13.81	284.20	886.9	21.3	-70.4	1,358,548.82	3,256,414.90	40.313968	-104.580485	
977.5	14.51	284.20	969.3	26.4	-90.6	1,358,553.71	3,256,394.69	40.313982	-104.580557	
1,066.5	15.92	284.56	1,055.2	32.2	-113.2	1,358,559.28	3,256,372.01	40.313998	-104.580638	

# Ensign

## Survey Report - Geographic

<b>Company:</b>	Chevron DJ Basin	<b>Local Co-ordinate Reference:</b>	Well DRAKE 03N
<b>Project:</b>	SEC.17-T4N-R64W	<b>TVD Reference:</b>	Well @ 4765.5ft (P272 - RKB 28.5')
<b>Site:</b>	Drake Pad	<b>MD Reference:</b>	Well @ 4765.5ft (P272 - RKB 28.5')
<b>Well:</b>	DRAKE 03N	<b>North Reference:</b>	True
<b>Wellbore:</b>	Drake 03N	<b>Survey Calculation Method:</b>	Minimum Curvature
<b>Design:</b>	Drake 03N Final Surveys	<b>Database:</b>	US_EDM

Survey									
Measured Depth (ft)	Inclination (°)	Azimuth (°)	Vertical Depth (ft)	+N/-S (ft)	+E/-W (ft)	Map Northing (usft)	Map Easting (usft)	Latitude	Longitude
1,153.5	18.11	284.38	1,138.4	38.5	-137.8	1,358,565.38	3,256,347.29	40.314015	-104.580727
1,242.5	20.31	285.61	1,222.4	46.1	-166.1	1,358,572.68	3,256,318.94	40.314036	-104.580828
1,329.5	22.77	286.84	1,303.3	55.1	-196.8	1,358,581.30	3,256,288.19	40.314061	-104.580938
1,414.5	23.92	287.37	1,381.4	65.0	-229.0	1,358,590.87	3,256,255.90	40.314088	-104.581054
1,501.5	25.32	288.25	1,460.5	76.1	-263.5	1,358,601.61	3,256,221.28	40.314118	-104.581177
1,589.5	25.68	290.36	1,539.9	88.6	-299.2	1,358,613.76	3,256,185.41	40.314153	-104.581306
1,675.5	24.71	291.24	1,617.7	101.6	-333.4	1,358,626.40	3,256,151.05	40.314188	-104.581428
1,689.5	24.97	292.29	1,630.4	103.8	-338.9	1,358,628.53	3,256,145.57	40.314194	-104.581448
1,809.0	25.68	293.16	1,738.4	123.5	-386.0	1,358,647.79	3,256,098.22	40.314248	-104.581617
1,903.0	25.18	292.56	1,823.3	139.2	-423.2	1,358,663.08	3,256,060.87	40.314291	-104.581750
1,998.0	25.36	292.95	1,909.2	154.9	-460.6	1,358,678.38	3,256,023.32	40.314335	-104.581884
2,093.0	27.85	293.21	1,994.2	171.6	-499.8	1,358,694.65	3,255,984.01	40.314380	-104.582025
2,188.0	28.54	297.45	2,077.9	190.8	-540.3	1,358,713.44	3,255,943.28	40.314433	-104.582170
2,283.0	28.32	299.42	2,161.5	212.3	-580.1	1,358,734.55	3,255,903.29	40.314492	-104.582313
2,377.0	28.49	299.59	2,244.1	234.3	-619.0	1,358,756.17	3,255,864.15	40.314553	-104.582452
2,472.0	28.21	298.73	2,327.7	256.3	-658.4	1,358,777.74	3,255,824.53	40.314613	-104.582594
2,567.0	28.59	300.11	2,411.3	278.5	-697.7	1,358,799.53	3,255,784.96	40.314674	-104.582735
2,661.0	28.48	299.70	2,493.9	300.9	-736.7	1,358,821.51	3,255,745.80	40.314735	-104.582874
2,755.0	27.88	300.46	2,576.7	323.2	-775.1	1,358,843.35	3,255,707.16	40.314796	-104.583012
2,850.0	28.15	302.26	2,660.6	346.4	-813.2	1,358,866.18	3,255,668.83	40.314860	-104.583149
2,945.0	28.51	300.75	2,744.2	369.9	-851.6	1,358,889.33	3,255,630.15	40.314925	-104.583286
3,039.0	28.33	301.15	2,826.9	392.9	-890.0	1,358,911.94	3,255,591.55	40.314988	-104.583424
3,133.0	28.09	300.65	2,909.7	415.8	-928.1	1,358,934.36	3,255,553.19	40.315051	-104.583561
3,228.0	28.62	299.95	2,993.4	438.5	-967.1	1,358,956.71	3,255,514.00	40.315113	-104.583700
3,323.0	27.86	301.43	3,077.0	461.5	-1,005.7	1,358,979.25	3,255,475.11	40.315176	-104.583839
3,418.0	28.04	300.87	3,161.0	484.5	-1,043.8	1,359,001.88	3,255,436.77	40.315239	-104.583976
3,513.0	27.95	300.68	3,244.8	507.3	-1,082.1	1,359,024.30	3,255,398.22	40.315302	-104.584113
3,608.0	27.81	300.52	3,328.8	529.9	-1,120.4	1,359,046.51	3,255,359.76	40.315364	-104.584250
3,702.0	27.72	300.12	3,412.0	552.0	-1,158.2	1,359,068.22	3,255,321.73	40.315425	-104.584386
3,797.0	26.99	299.70	3,496.4	573.8	-1,196.0	1,359,089.60	3,255,283.67	40.315484	-104.584521
3,891.0	27.87	300.22	3,579.8	595.4	-1,233.5	1,359,110.83	3,255,245.94	40.315544	-104.584656
3,986.0	27.97	301.17	3,663.7	618.1	-1,271.8	1,359,133.14	3,255,207.46	40.315606	-104.584793
4,080.0	27.54	301.03	3,746.9	640.7	-1,309.2	1,359,155.36	3,255,169.74	40.315668	-104.584928
4,175.0	28.53	300.41	3,830.8	663.5	-1,347.6	1,359,177.77	3,255,131.12	40.315731	-104.585065
4,270.0	28.69	301.23	3,914.2	686.9	-1,386.7	1,359,200.67	3,255,091.82	40.315795	-104.585205
4,364.0	28.14	301.01	3,996.9	710.0	-1,425.0	1,359,223.39	3,255,053.29	40.315858	-104.585343
4,459.0	27.92	301.66	4,080.7	733.2	-1,463.1	1,359,246.20	3,255,014.92	40.315922	-104.585479
4,554.0	27.64	300.63	4,164.8	756.1	-1,501.0	1,359,268.71	3,254,976.80	40.315985	-104.585615
4,649.0	27.84	301.79	4,248.8	779.0	-1,538.8	1,359,291.23	3,254,938.75	40.316047	-104.585751
4,744.0	28.06	302.21	4,332.8	802.6	-1,576.6	1,359,314.43	3,254,900.74	40.316112	-104.585886
4,839.0	28.68	301.95	4,416.4	826.6	-1,614.8	1,359,338.01	3,254,862.25	40.316178	-104.586023
4,934.0	28.11	300.67	4,499.9	850.0	-1,653.4	1,359,361.08	3,254,823.42	40.316242	-104.586162
5,029.0	28.19	301.64	4,583.7	873.2	-1,691.8	1,359,383.87	3,254,784.83	40.316306	-104.586299
5,123.0	28.04	301.58	4,666.6	896.5	-1,729.5	1,359,406.69	3,254,746.87	40.316370	-104.586435
5,218.0	28.54	299.33	4,750.3	919.3	-1,768.3	1,359,429.10	3,254,707.82	40.316432	-104.586574
5,313.0	27.71	299.38	4,834.0	941.2	-1,807.4	1,359,450.65	3,254,668.57	40.316493	-104.586714
5,408.0	28.05	299.34	4,918.0	963.0	-1,846.1	1,359,472.02	3,254,629.63	40.316552	-104.586853
5,503.0	27.93	299.93	5,001.9	985.0	-1,884.8	1,359,493.66	3,254,590.65	40.316613	-104.586992
5,598.0	27.91	298.87	5,085.8	1,006.9	-1,923.6	1,359,515.10	3,254,551.68	40.316673	-104.587131
5,692.0	28.04	299.72	5,168.9	1,028.5	-1,962.0	1,359,536.27	3,254,513.00	40.316732	-104.587268
5,787.0	28.39	299.02	5,252.6	1,050.5	-2,001.2	1,359,557.89	3,254,473.64	40.316793	-104.587409
5,881.0	27.90	298.58	5,335.5	1,071.8	-2,040.0	1,359,578.85	3,254,434.56	40.316851	-104.587548
5,976.0	27.25	297.88	5,419.7	1,092.6	-2,078.8	1,359,599.25	3,254,395.61	40.316908	-104.587687
6,071.0	27.82	299.46	5,503.9	1,113.7	-2,117.3	1,359,619.92	3,254,356.87	40.316966	-104.587825
6,165.0	27.94	298.83	5,587.0	1,135.1	-2,155.7	1,359,640.92	3,254,318.26	40.317025	-104.587963

# Ensign

## Survey Report - Geographic

<b>Company:</b>	Chevron DJ Basin	<b>Local Co-ordinate Reference:</b>	Well DRAKE 03N
<b>Project:</b>	SEC.17-T4N-R64W	<b>TVD Reference:</b>	Well @ 4765.5ft (P272 - RKB 28.5')
<b>Site:</b>	Drake Pad	<b>MD Reference:</b>	Well @ 4765.5ft (P272 - RKB 28.5')
<b>Well:</b>	DRAKE 03N	<b>North Reference:</b>	True
<b>Wellbore:</b>	Drake 03N	<b>Survey Calculation Method:</b>	Minimum Curvature
<b>Design:</b>	Drake 03N Final Surveys	<b>Database:</b>	US_EDM

### Survey

Measured Depth (ft)	Inclination (°)	Azimuth (°)	Vertical Depth (ft)	+N/-S (ft)	+E/-W (ft)	Map Northing (usft)	Map Easting (usft)	Latitude	Longitude
6,260.0	27.66	298.94	5,671.0	1,156.5	-2,194.5	1,359,661.92	3,254,279.24	40.317084	-104.588102
6,355.0	28.01	299.65	5,755.0	1,178.2	-2,233.2	1,359,683.22	3,254,240.34	40.317143	-104.588241
6,450.0	27.85	300.06	5,839.0	1,200.4	-2,271.8	1,359,704.97	3,254,201.52	40.317204	-104.588379
6,545.0	22.16	314.59	5,925.1	1,224.1	-2,303.8	1,359,728.37	3,254,169.26	40.317269	-104.588494
6,639.0	18.31	329.40	6,013.4	1,249.3	-2,323.9	1,359,753.34	3,254,148.84	40.317338	-104.588566
6,734.0	16.18	341.75	6,104.1	1,274.7	-2,335.7	1,359,778.64	3,254,136.83	40.317408	-104.588608
6,829.0	14.87	356.57	6,195.7	1,299.5	-2,340.6	1,359,803.34	3,254,131.69	40.317476	-104.588626
6,923.0	16.10	22.05	6,286.4	1,323.6	-2,336.4	1,359,827.53	3,254,135.62	40.317542	-104.588611
7,018.0	19.10	41.33	6,377.0	1,347.5	-2,321.2	1,359,851.59	3,254,150.60	40.317608	-104.588556
7,114.0	26.37	52.42	6,465.5	1,372.4	-2,293.8	1,359,876.71	3,254,177.65	40.317676	-104.588458
7,209.0	31.80	54.46	6,548.5	1,399.8	-2,256.7	1,359,904.53	3,254,214.48	40.317751	-104.588325
7,303.0	36.47	66.69	6,626.4	1,425.3	-2,210.8	1,359,930.50	3,254,260.10	40.317821	-104.588161
7,398.0	46.70	77.46	6,697.4	1,444.1	-2,150.9	1,359,949.87	3,254,319.81	40.317873	-104.587946
7,493.0	52.51	77.68	6,759.0	1,459.6	-2,080.3	1,359,966.17	3,254,390.27	40.317916	-104.587693
7,588.0	57.85	78.17	6,813.2	1,475.9	-2,004.1	1,359,983.25	3,254,466.33	40.317960	-104.587419
7,683.0	63.37	79.10	6,859.8	1,492.2	-1,922.9	1,360,000.38	3,254,547.28	40.318005	-104.587128
7,778.0	70.50	81.24	6,897.0	1,507.1	-1,836.9	1,360,016.14	3,254,633.18	40.318046	-104.586820
7,873.0	77.67	85.09	6,923.0	1,517.9	-1,746.2	1,360,027.89	3,254,723.70	40.318076	-104.586495
7,967.0	85.01	88.82	6,937.2	1,522.8	-1,653.5	1,360,033.75	3,254,816.36	40.318089	-104.586162
8,062.0	92.61	88.63	6,939.2	1,524.9	-1,558.6	1,360,036.85	3,254,911.21	40.318095	-104.585822
<b>LPL - 545' FNL &amp; 518' FEL</b>									
8,156.0	92.43	88.57	6,935.0	1,527.2	-1,464.8	1,360,040.12	3,255,005.06	40.318101	-104.585485
8,251.0	92.28	88.58	6,931.1	1,529.6	-1,369.9	1,360,043.46	3,255,099.92	40.318108	-104.585145
8,346.0	92.13	88.93	6,927.5	1,531.6	-1,275.0	1,360,046.51	3,255,194.79	40.318113	-104.584805
8,441.0	92.59	88.43	6,923.6	1,533.8	-1,180.1	1,360,049.68	3,255,289.65	40.318119	-104.584464
8,536.0	92.29	88.23	6,919.5	1,536.6	-1,085.2	1,360,053.43	3,255,384.49	40.318127	-104.584124
8,630.0	92.35	88.44	6,915.7	1,539.3	-991.3	1,360,057.13	3,255,478.33	40.318135	-104.583788
8,725.0	92.26	89.22	6,911.9	1,541.2	-896.4	1,360,060.05	3,255,573.21	40.318140	-104.583447
8,820.0	92.49	89.10	6,907.9	1,542.6	-801.5	1,360,062.43	3,255,668.09	40.318144	-104.583107
8,915.0	92.56	89.13	6,903.8	1,544.1	-706.6	1,360,064.88	3,255,762.96	40.318148	-104.582767
9,010.0	92.40	88.85	6,899.7	1,545.8	-611.7	1,360,067.53	3,255,857.83	40.318152	-104.582426
9,104.0	92.63	88.80	6,895.5	1,547.7	-517.8	1,360,070.43	3,255,951.69	40.318158	-104.582090
9,199.0	92.56	88.53	6,891.2	1,549.9	-422.9	1,360,073.63	3,256,046.54	40.318164	-104.581749
9,294.0	92.82	89.42	6,886.8	1,551.6	-328.1	1,360,076.31	3,256,141.39	40.318168	-104.581409
9,388.0	92.58	88.79	6,882.3	1,553.1	-234.2	1,360,078.75	3,256,235.25	40.318172	-104.581072
9,483.0	92.49	88.51	6,878.1	1,555.3	-139.3	1,360,081.97	3,256,330.10	40.318179	-104.580732
9,577.0	92.56	88.69	6,874.0	1,557.6	-45.4	1,360,085.24	3,256,423.95	40.318185	-104.580396
9,672.0	92.61	88.64	6,869.7	1,559.8	49.5	1,360,088.43	3,256,518.79	40.318191	-104.580055
9,767.0	92.76	88.51	6,865.3	1,562.2	144.3	1,360,091.78	3,256,613.62	40.318197	-104.579715
9,861.0	92.44	88.60	6,861.0	1,564.5	238.2	1,360,095.12	3,256,707.46	40.318204	-104.579378
9,956.0	92.55	89.00	6,856.9	1,566.5	333.1	1,360,098.09	3,256,802.32	40.318209	-104.579038
10,051.0	92.42	89.95	6,852.7	1,567.4	428.0	1,360,099.94	3,256,897.21	40.318212	-104.578698
10,146.0	91.04	89.67	6,849.9	1,567.7	523.0	1,360,101.24	3,256,992.15	40.318213	-104.578357
10,241.0	90.68	90.09	6,848.4	1,567.9	617.9	1,360,102.43	3,257,087.13	40.318213	-104.578017
10,336.0	90.27	90.86	6,847.7	1,567.1	712.9	1,360,102.63	3,257,182.12	40.318211	-104.577676
10,431.0	90.38	90.89	6,847.1	1,565.7	807.9	1,360,102.16	3,257,277.11	40.318207	-104.577335
10,526.0	90.45	89.44	6,846.4	1,565.4	902.9	1,360,102.87	3,257,372.10	40.318206	-104.576995
10,621.0	90.53	89.90	6,845.6	1,565.9	997.9	1,360,104.40	3,257,467.08	40.318208	-104.576654
10,715.0	90.18	90.94	6,845.0	1,565.3	1,091.9	1,360,104.69	3,257,561.07	40.318206	-104.576317
10,810.0	90.62	90.00	6,844.4	1,564.5	1,186.9	1,360,104.90	3,257,656.06	40.318204	-104.575976
10,904.0	90.74	90.18	6,843.3	1,564.3	1,280.9	1,360,105.72	3,257,750.05	40.318203	-104.575639
10,999.0	90.55	90.25	6,842.2	1,564.0	1,375.9	1,360,106.35	3,257,845.04	40.318202	-104.575299
11,094.0	90.81	90.39	6,841.1	1,563.4	1,470.9	1,360,106.81	3,257,940.03	40.318201	-104.574958
11,189.0	90.03	90.07	6,840.4	1,563.1	1,565.9	1,360,107.41	3,258,035.02	40.318200	-104.574617
11,283.0	90.11	90.05	6,840.3	1,563.0	1,659.9	1,360,108.29	3,258,129.01	40.318199	-104.574280

# Ensign

## Survey Report - Geographic

<b>Company:</b>	Chevron DJ Basin	<b>Local Co-ordinate Reference:</b>	Well DRAKE 03N
<b>Project:</b>	SEC.17-T4N-R64W	<b>TVD Reference:</b>	Well @ 4765.5ft (P272 - RKB 28.5')
<b>Site:</b>	Drake Pad	<b>MD Reference:</b>	Well @ 4765.5ft (P272 - RKB 28.5')
<b>Well:</b>	DRAKE 03N	<b>North Reference:</b>	True
<b>Wellbore:</b>	Drake 03N	<b>Survey Calculation Method:</b>	Minimum Curvature
<b>Design:</b>	Drake 03N Final Surveys	<b>Database:</b>	US_EDM

Survey									
Measured Depth (ft)	Inclination (°)	Azimuth (°)	Vertical Depth (ft)	+N/-S (ft)	+E/-W (ft)	Map Northing (usft)	Map Easting (usft)	Latitude	Longitude
11,378.0	90.01	90.77	6,840.2	1,562.3	1,754.9	1,360,108.59	3,258,224.00	40.318198	-104.573940
11,473.0	89.92	91.22	6,840.2	1,560.6	1,849.9	1,360,107.93	3,258,318.99	40.318193	-104.573599
11,567.0	89.72	90.48	6,840.5	1,559.2	1,943.8	1,360,107.51	3,258,412.99	40.318189	-104.573262
11,662.0	89.68	90.45	6,841.0	1,558.5	2,038.8	1,360,107.72	3,258,507.98	40.318187	-104.572921
11,757.0	89.82	89.15	6,841.4	1,558.8	2,133.8	1,360,109.04	3,258,602.97	40.318188	-104.572581
11,851.0	89.70	89.55	6,841.8	1,559.9	2,227.8	1,360,111.08	3,258,696.94	40.318191	-104.572244
11,946.0	89.65	89.27	6,842.4	1,560.8	2,322.8	1,360,113.04	3,258,791.91	40.318193	-104.571903
12,040.0	89.34	89.23	6,843.2	1,562.1	2,416.8	1,360,115.25	3,258,885.88	40.318197	-104.571566
12,134.0	89.72	89.28	6,844.0	1,563.3	2,510.8	1,360,117.45	3,258,979.85	40.318200	-104.571229
12,228.0	89.58	89.43	6,844.5	1,564.4	2,604.8	1,360,119.48	3,259,073.82	40.318203	-104.570892
12,322.0	89.53	89.25	6,845.3	1,565.4	2,698.8	1,360,121.54	3,259,167.79	40.318206	-104.570555
12,416.0	89.74	89.24	6,845.9	1,566.7	2,792.8	1,360,123.75	3,259,261.76	40.318209	-104.570218
12,511.0	89.43	89.13	6,846.5	1,568.0	2,887.8	1,360,126.09	3,259,356.72	40.318213	-104.569877
12,606.0	89.68	89.15	6,847.3	1,569.5	2,982.7	1,360,128.50	3,259,451.68	40.318217	-104.569536
12,701.0	89.12	89.09	6,848.3	1,570.9	3,077.7	1,360,130.94	3,259,546.64	40.318221	-104.569196
12,795.0	89.85	89.10	6,849.1	1,572.4	3,171.7	1,360,133.40	3,259,640.60	40.318225	-104.568859
12,890.0	90.15	89.27	6,849.1	1,573.7	3,266.7	1,360,135.74	3,259,735.57	40.318229	-104.568518
12,984.0	89.90	89.66	6,849.1	1,574.6	3,360.7	1,360,137.59	3,259,829.54	40.318231	-104.568181
13,079.0	90.12	89.38	6,849.1	1,575.4	3,455.7	1,360,139.37	3,259,924.52	40.318233	-104.567840
13,174.0	90.20	89.15	6,848.8	1,576.6	3,550.7	1,360,141.57	3,260,019.49	40.318236	-104.567500
13,268.0	90.23	89.33	6,848.4	1,577.9	3,644.7	1,360,143.80	3,260,113.46	40.318240	-104.567163
13,363.0	90.20	89.28	6,848.1	1,579.0	3,739.7	1,360,145.93	3,260,208.43	40.318243	-104.566822
13,457.0	90.07	89.14	6,847.9	1,580.3	3,833.7	1,360,148.20	3,260,302.40	40.318246	-104.566485
13,552.0	90.16	89.64	6,847.7	1,581.3	3,928.7	1,360,150.20	3,260,397.38	40.318249	-104.566144
13,647.0	90.61	90.12	6,847.0	1,581.5	4,023.7	1,360,151.38	3,260,492.36	40.318250	-104.565804
13,742.0	90.73	90.11	6,845.9	1,581.4	4,118.6	1,360,152.18	3,260,587.35	40.318249	-104.565463
13,836.0	90.90	90.68	6,844.6	1,580.7	4,212.6	1,360,152.51	3,260,681.33	40.318247	-104.565126
13,931.0	90.85	90.71	6,843.1	1,579.6	4,307.6	1,360,152.34	3,260,776.32	40.318244	-104.564785
14,026.0	90.77	90.87	6,841.8	1,578.2	4,402.6	1,360,152.01	3,260,871.30	40.318240	-104.564445
14,121.0	90.85	90.83	6,840.5	1,576.8	4,497.6	1,360,151.59	3,260,966.29	40.318237	-104.564104
14,215.0	90.73	90.80	6,839.2	1,575.5	4,591.6	1,360,151.23	3,261,060.27	40.318233	-104.563767
14,405.0	90.72	91.28	6,836.8	1,572.0	4,781.5	1,360,149.75	3,261,250.24	40.318223	-104.563086
14,500.0	90.77	91.12	6,835.5	1,570.1	4,876.5	1,360,148.75	3,261,345.23	40.318218	-104.562745
14,594.0	90.78	90.76	6,834.2	1,568.5	4,970.5	1,360,148.18	3,261,439.21	40.318213	-104.562408
14,689.0	90.86	90.69	6,832.9	1,567.3	5,065.4	1,360,147.96	3,261,534.20	40.318210	-104.562068
14,783.0	90.91	89.76	6,831.4	1,566.9	5,159.4	1,360,148.57	3,261,628.18	40.318209	-104.561731
14,878.0	90.78	90.76	6,830.0	1,566.5	5,254.4	1,360,149.12	3,261,723.16	40.318208	-104.561390
14,973.0	90.94	90.63	6,828.6	1,565.4	5,349.4	1,360,148.96	3,261,818.15	40.318205	-104.561049
15,067.0	90.92	90.88	6,827.1	1,564.1	5,443.4	1,360,148.69	3,261,912.13	40.318201	-104.560712
15,162.0	90.91	90.87	6,825.6	1,562.7	5,538.4	1,360,148.23	3,262,007.11	40.318197	-104.560372
15,257.0	90.79	91.02	6,824.2	1,561.1	5,633.3	1,360,147.65	3,262,102.10	40.318193	-104.560031
15,351.0	90.79	90.44	6,822.9	1,559.9	5,727.3	1,360,147.42	3,262,196.08	40.318189	-104.559694
15,446.0	90.75	90.94	6,821.6	1,558.8	5,822.3	1,360,147.26	3,262,291.07	40.318186	-104.559354
15,636.0	90.75	90.51	6,819.1	1,556.4	6,012.3	1,360,146.83	3,262,481.04	40.318179	-104.558672
15,731.0	90.91	90.74	6,817.7	1,555.3	6,107.3	1,360,146.78	3,262,576.03	40.318177	-104.558332
15,826.0	90.92	90.58	6,816.2	1,554.2	6,202.2	1,360,146.67	3,262,671.01	40.318173	-104.557991
15,921.0	90.88	90.91	6,814.7	1,553.0	6,297.2	1,360,146.42	3,262,766.00	40.318170	-104.557651
16,015.0	90.62	90.80	6,813.5	1,551.6	6,391.2	1,360,145.99	3,262,859.98	40.318166	-104.557314
16,110.0	90.76	90.61	6,812.3	1,550.4	6,486.2	1,360,145.81	3,262,954.97	40.318163	-104.556973
16,205.0	90.78	90.77	6,811.1	1,549.3	6,581.2	1,360,145.65	3,263,049.96	40.318160	-104.556632
16,299.0	90.87	90.87	6,809.7	1,547.9	6,675.1	1,360,145.28	3,263,143.94	40.318156	-104.556295
16,394.0	90.28	90.81	6,808.8	1,546.5	6,770.1	1,360,144.87	3,263,238.93	40.318152	-104.555955
16,489.0	90.25	90.66	6,808.3	1,545.3	6,865.1	1,360,144.64	3,263,333.93	40.318149	-104.555614
16,583.0	90.30	90.85	6,807.9	1,544.1	6,959.1	1,360,144.38	3,263,427.92	40.318145	-104.555277
16,677.0	90.26	91.26	6,807.4	1,542.4	7,053.1	1,360,143.62	3,263,521.91	40.318140	-104.554940

# Ensign

## Survey Report - Geographic

<b>Company:</b>	Chevron DJ Basin	<b>Local Co-ordinate Reference:</b>	Well DRAKE 03N
<b>Project:</b>	SEC.17-T4N-R64W	<b>TVD Reference:</b>	Well @ 4765.5ft (P272 - RKB 28.5')
<b>Site:</b>	Drake Pad	<b>MD Reference:</b>	Well @ 4765.5ft (P272 - RKB 28.5')
<b>Well:</b>	DRAKE 03N	<b>North Reference:</b>	True
<b>Wellbore:</b>	Drake 03N	<b>Survey Calculation Method:</b>	Minimum Curvature
<b>Design:</b>	Drake 03N Final Surveys	<b>Database:</b>	US_EDM

Survey									
Measured Depth (ft)	Inclination (°)	Azimuth (°)	Vertical Depth (ft)	+N/-S (ft)	+E/-W (ft)	Map Northing (usft)	Map Easting (usft)	Latitude	Longitude
16,772.0	90.28	91.05	6,807.0	1,540.4	7,148.1	1,360,142.69	3,263,616.90	40.318135	-104.554599
16,866.0	90.23	91.06	6,806.5	1,538.7	7,242.1	1,360,141.94	3,263,710.90	40.318130	-104.554262
16,961.0	90.46	90.73	6,806.0	1,537.2	7,337.0	1,360,141.44	3,263,805.89	40.318126	-104.553922
17,055.0	90.18	90.81	6,805.4	1,536.0	7,431.0	1,360,141.15	3,263,899.88	40.318122	-104.553585
17,150.0	90.16	90.77	6,805.2	1,534.7	7,526.0	1,360,140.82	3,263,994.88	40.318119	-104.553244
17,340.0	90.39	90.96	6,804.2	1,531.8	7,716.0	1,360,139.93	3,264,184.86	40.318111	-104.552563
17,435.0	90.30	90.87	6,803.7	1,530.3	7,811.0	1,360,139.40	3,264,279.86	40.318106	-104.552222
17,529.0	90.31	90.19	6,803.2	1,529.4	7,905.0	1,360,139.50	3,264,373.85	40.318104	-104.551885
17,624.0	90.45	90.31	6,802.5	1,529.0	8,000.0	1,360,140.07	3,264,468.84	40.318103	-104.551544
17,719.0	90.52	90.22	6,801.7	1,528.5	8,095.0	1,360,140.62	3,264,563.83	40.318101	-104.551204
17,814.0	90.50	90.64	6,800.9	1,527.8	8,190.0	1,360,140.89	3,264,658.82	40.318099	-104.550863
17,909.0	90.44	90.17	6,800.1	1,527.2	8,285.0	1,360,141.20	3,264,753.82	40.318097	-104.550522
18,003.0	90.62	90.21	6,799.2	1,526.8	8,379.0	1,360,141.87	3,264,847.81	40.318097	-104.550185
18,098.0	90.48	90.13	6,798.3	1,526.6	8,474.0	1,360,142.57	3,264,942.79	40.318096	-104.549845
18,193.0	90.51	90.13	6,797.5	1,526.4	8,568.9	1,360,143.34	3,265,037.78	40.318095	-104.549504
18,288.0	90.47	89.97	6,796.7	1,526.3	8,663.9	1,360,144.24	3,265,132.77	40.318095	-104.549163
18,382.0	90.55	90.42	6,795.9	1,525.9	8,757.9	1,360,144.90	3,265,226.76	40.318094	-104.548826
18,476.0	90.45	90.42	6,795.0	1,525.3	8,851.9	1,360,145.18	3,265,320.75	40.318092	-104.548489
18,571.0	90.49	90.27	6,794.3	1,524.7	8,946.9	1,360,145.60	3,265,415.74	40.318090	-104.548149
18,666.0	90.58	90.27	6,793.4	1,524.2	9,041.9	1,360,146.13	3,265,510.73	40.318089	-104.547808
18,760.0	90.55	90.02	6,792.4	1,524.0	9,135.9	1,360,146.87	3,265,604.72	40.318088	-104.547471
18,855.0	90.58	89.84	6,791.5	1,524.1	9,230.9	1,360,147.97	3,265,699.71	40.318088	-104.547130
18,927.0	90.58	89.84	6,790.8	1,524.3	9,302.9	1,360,148.92	3,265,771.69	40.318089	-104.546872
<b>BHL - 556' FNL &amp; 206' FEL</b>									

Design Annotations				
Measured Depth (ft)	Vertical Depth (ft)	Local Coordinates		Comment
		+N/-S (ft)	+E/-W (ft)	
8,062.0	6,939.2	1,524.9	-1,558.6	LPL - 545' FNL & 518' FEL
18,927.0	6,790.8	1,524.3	9,302.9	BHL - 556' FNL & 206' FEL

Checked By: \_\_\_\_\_ Approved By: \_\_\_\_\_ Date: \_\_\_\_\_