

## Legend

- P&A'd Wellhead
- Soil Sample
- Soil Screening
- Background Soil Sample
- Groundwater Sample
- Former Meter House
- Former Drain Line
- Former Drip Containment
- Former Gas Line
- Former Oil Dump
- Former Water Dump
- Former Earthen Berm
- Former Infrastructure
- Excavation Extent

### Notes

BBL: Barrel  
 AST: Above Ground Storage Tank  
 PWV: Produced Water Vessel  
 ECD: Emission Control Device

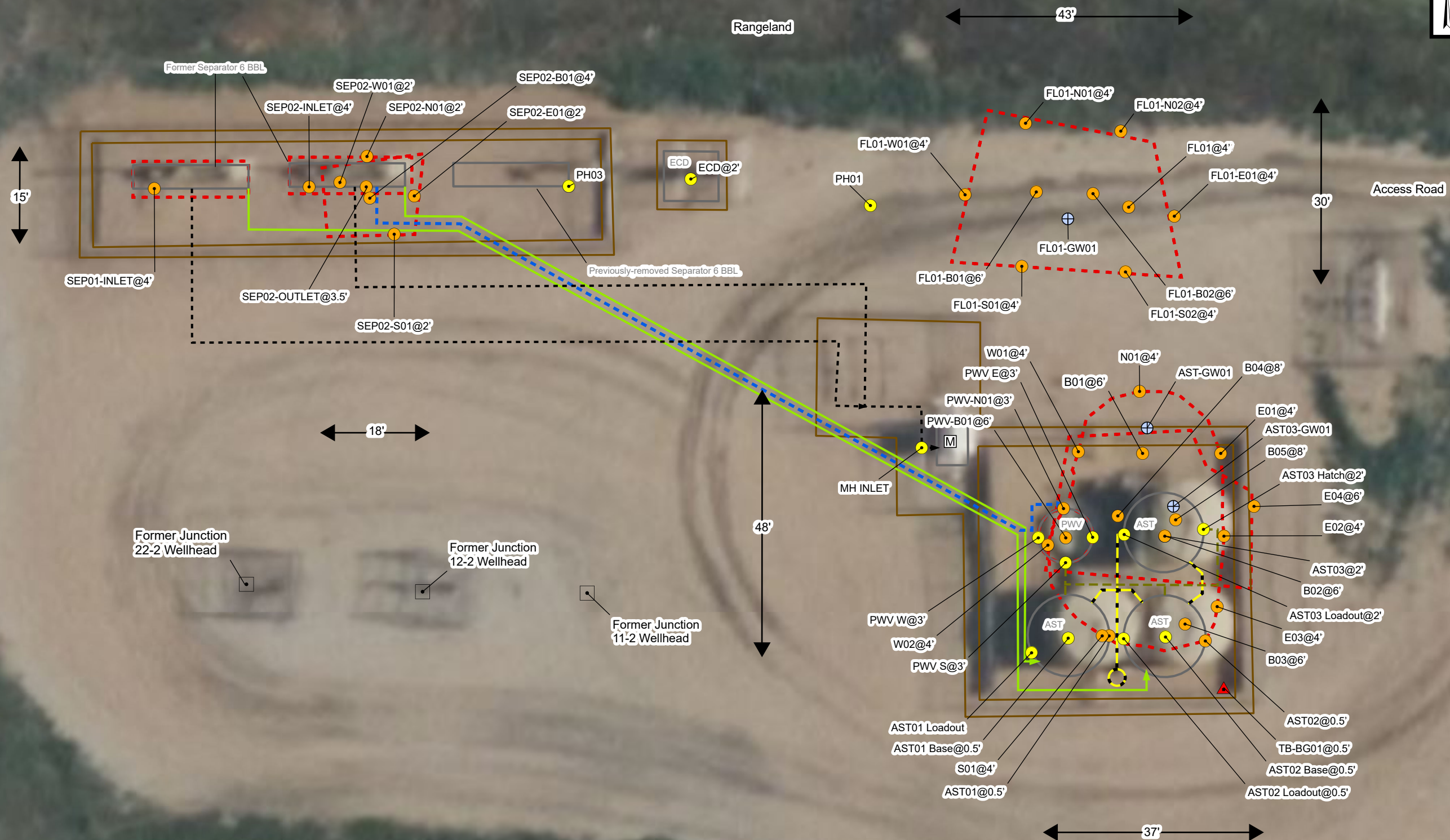

0 7,551,743 5,103,485 Feet

Sources: Environmental Systems Research Institute (ESRI)

## Excavation Site Map (3/30/2023-7/24/2023)

Junction 11, 12, 22-2 O SA Facility  
 Kerr-McGee Oil & Gas Onshore, LP  
 NWSW SEC 2-T2N-R68W  
 Weld County, CO  
 Project Number: 09A1417263