



FORM F-106

81-575



00271365

RECEIVED

APR 23 1981

COLO. OIL & GAS CONSV. COMM.

R. 56W

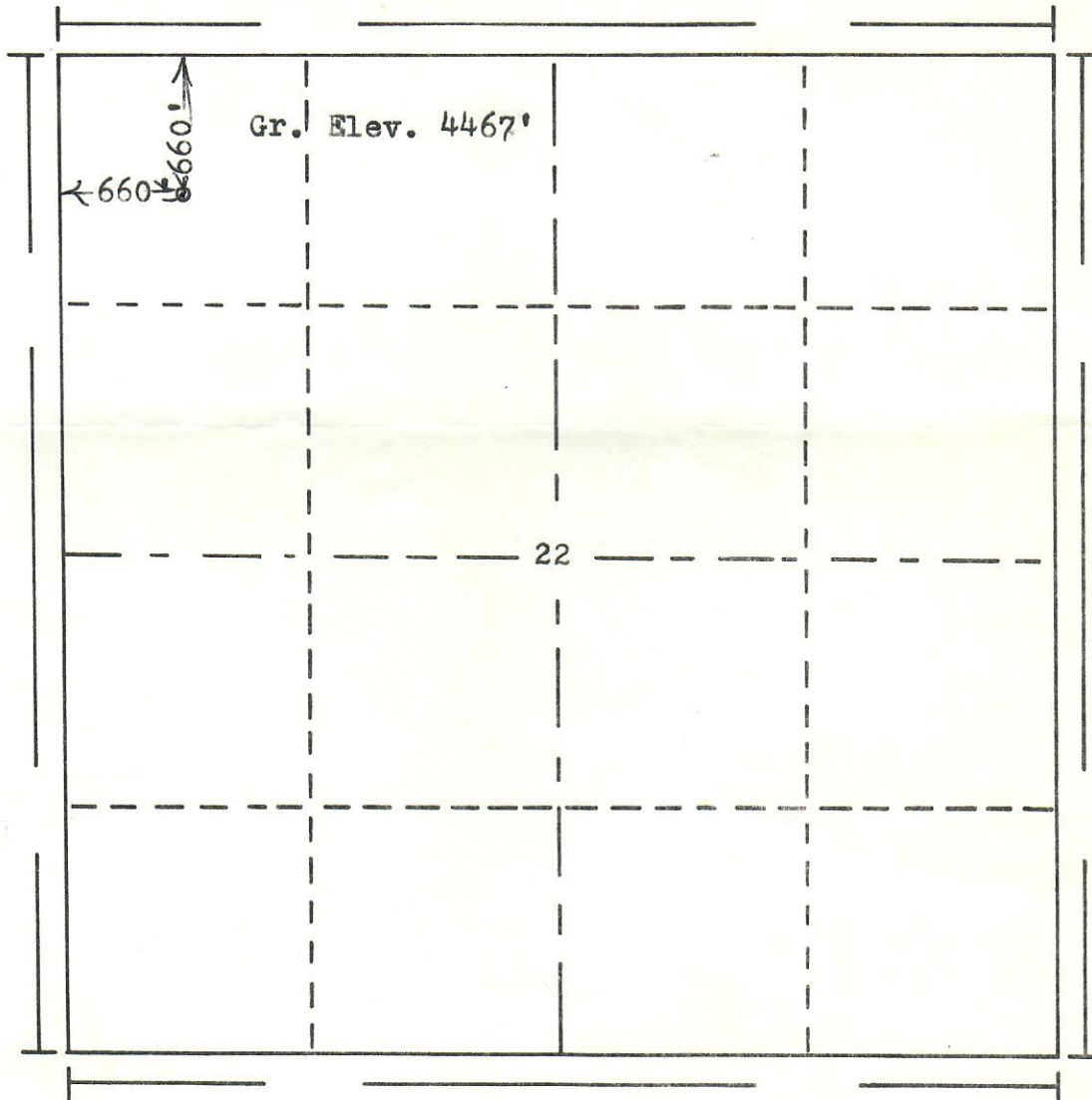
T.
9
N

Scale... 1" = 1000'

Powers Elevation of Denver, Colorado

has in accordance with a request from Stephanie
for R.E. Hibbert & Exeter Drlg. & Exploration Co.

determined the location of No.1 Albert Miller
to be 660'FN & 660'FW Section 22 Township 9N
Range 56W of the 6th Principal Meridian
Weld County, Colorado

I hereby certify that this plat is an
accurate representation of a correct
survey showing the location of

Date: 4-8-81

Barry J. Hickey
Licensed Land Surveyor No. 2853
State of Colorado