

Horn-Libsack 1

NESE Sec. 27-T4N-R65W

API #: 123-10219

Remediation Project #: 33451

Form 19 Data Package

March 2024

Prepared by Tasman, Inc.



On behalf of Crestone Peak Resources Operating, LLC



FIELD NOTES & PHOTO LOG

Decommissioning Form

Tasman Inc.



SITE NAME: Horn-Libsack 1								DATE: 3/28/2024	REM. PROJECT #: 33451	WEATHER: 55 F Sunny
SITE DIRECTIONS: County Rd 40 and County Rd 45 - N 0.46mi, SW 0.24mi INTO								CLIENT: Crestone Peak Resources Operating, LLC		
LEGALS AND LAT/LONG: 40.280634 , -104.643602								TASMAN PERSONNEL: Sean Clarke		
SOIL TYPES: SM - silty sand								SURFACE GRADIENT: East		
SURROUNDING LAND USE: Rangeland								CROP: N/A		
SOIL SAMPLING								FACILITY INFRASTRUCTURE		
Date/Time	Soil Sample ID	PID (ppm)	Visual	Olfactory	Photo? (Y/N)	USCS	Lab (Y/N)	EQUIPMENT	Quantity	
								Above Ground Storage Tank (AST)		
3/28/2024 15:25	1-WH-B01@11'	18.7	HC Staining	Slight HC Od	Y	SM	Y	Produced Water Vessel (PWV)		
3/28/2024 15:30	1-WH-N01@10'	2.6	No Staining	No Odor	Y	SM	Y	Separator (SEP)		
3/28/2024 15:35	1-WH-S01@10'	10.6	HC Staining	Slight HC Od	Y	SM	Y	Emission Control Device (ECD)		
3/28/2024 15:40	1-WH-E01@10'	4.1	No Staining	No Odor	Y	SM	Y	Dump Line (DL)		
3/28/2024 15:45	1-WH-E02@10'	4.5	No Staining	No Odor	Y	SM	Y	Wellhead (WH)	1	
3/28/2024 15:50	1-WH-W01@10'	2.9	No Staining	No Odor	Y	SM	Y	Flowline (FL)	1	
3/28/2024 15:55	1-WH-W02@10'	26.4	HC Staining	Slight HC Od	Y	SM	Y	FL Method of Closure	Removal	
3/28/2024 16:00	1-FL-B01@4'	1776	HC Staining	Strong HC O	Y	SM	Y	FL Footage Removed		
3/28/2024 16:05	SP-CS01	396.8	HC Staining	HC Odor	Y	SM	Y	Footaged Abandoned in Place		
								Other:		
								Soil Loads Removed		
								IMPACTED SOIL IDENTIFIED? Yes		
								ESTIMATED VOLUME OF IMPACTS:		
								Date	Number	CY
								Total Removed	0	0
								Disposal Facility:		
								Groundwater Recovery		
								DATE GW ENCOUNTERED:	DEPTH:	
								GROUNDWATER IN CONTACT WITH IMPACTED SOIL?		
								LNAPL OR SHEEN OBSERVED ON GW?		
GROUNDWATER SAMPLING								Date	BBLS	
Date/Time	Groundwater Sample ID	Depth Collected	Turbid?	Sheen?	Odor?	Photo?				
3/28/2024 16:05	WH-GW01	10'	Medium Turbid	Light Sheen	Light HC Odo	Yes				
								Total Removed	0	
								Disposal Facility:		

							
Equipment ID:		Equipment Type:		Equipment ID:		Equipment Type:	
Material:	Volume:	Contents:		Material:	Volume:	Contents:	
Notes/Conditions: Soil and groundwater sample locations.				Notes/Conditions: Soil sample locations.			

FIGURES

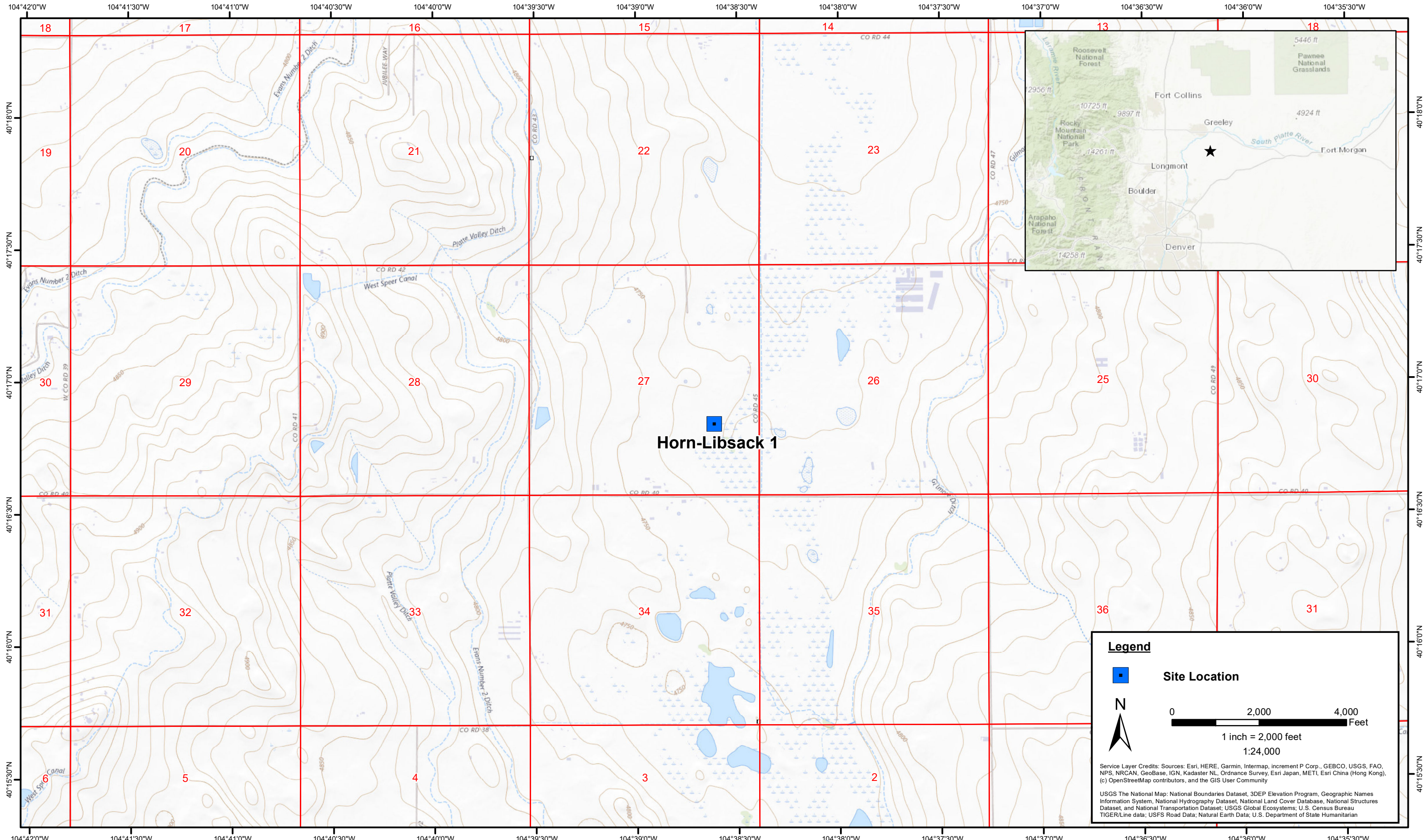

DATE:	March 2024
DESIGNED BY:	S. Vogt
DRAWN BY:	J. Woffinden



Tasman, Inc.
 6855 W. 119th Ave
 Broomfield, CO 80020

Crestone Peak Resources Operating, LLC
Horn-Libsack 1
 NESE Sec. 27-T4N-R65W
 Weld County, Colorado

Site Location Map

Figure
1



Legend

- Soil sample location – Submitted for Laboratory Analysis (Collected via Trimble GPS)
- Soil sample location – High PIDs/ Hydrocarbon Staining/Hydrocarbon Odor (Collected via Trimble GPS)
- Groundwater sample location
- Excavation extent (Collected via Trimble GPS)
- Stockpile location (Collected via Trimble GPS)
- Flowline Location

Notes

Site infrastructure has been removed.

All locations are approximate unless otherwise noted.

GPS – Global Positioning System

PID – Photoionization Detector

0 ft. 10 ft. 20 ft.

Image Source: Google Earth

DATE:	March 29, 2024
DESIGNED BY:	S. Vogt
DRAWN BY:	B. LeVasseur



Tasman, Inc.
 6855 W119th Ave.
 Broomfield, CO 80020

Crestone Peak Resources Operating, LLC
Horn-Libsack 1
 NESE Sec. 27-T4N-R65W
 Weld County, Colorado

Soil Sample Location Map

Figure 2