

Photographic Log
Ferguson No.2 (OWP) #F-12
ECMC Form 27 Sampling
Colorado Energy & Carbon Management Commission



Photo 1: SS01 collected adjacent to Ferguson No. 2 (OWP) F-12 wellhead, 6/17/2021.



Photo 2: SS02 collected at Ferguson No. 2 (OWP) F-12 pumping unit, 6/17/2021.

Photographic Log
Ferguson No.2 (OWP) #F-12
ECMC Form 27 Sampling

Colorado Energy & Carbon Management Commission



☉ 222°SW (T) ☉ 37°3'59"N, 108°7'49"W ±36ft ▲ 6842ft



Photo 3: SS03 collected from a flowline segment between wellhead and former meter house at the Ferguson No. 2 (OWP) F-12, 6/17/2021.

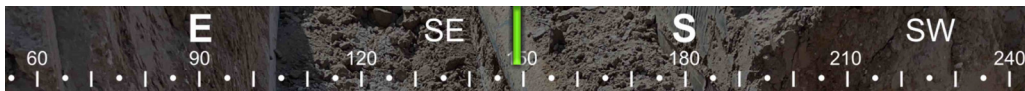

☉ 149°SE (T) ☉ 37°4'0"N, 108°7'49"W ±9ft ▲ 6579ft



Photo 4: SS04 collected a flowline segment at the Ferguson No. 2 (OWP) F-12, 6/17/2021.



☀ 203°SW (T) ● 37°4'1"N, 108°7'48"W ±19ft ▲ 6577ft



Photo 5: SS05 collected from a flowline segment at the Ferguson No. 2 (OWP) F-12, 6/17/2021.



☀ 226°SW (T) ● 37°4'0"N, 108°7'48"W ±13ft ▲ 6582ft



Photo 6: SS06 collected beneath former meter house at the Ferguson No. 2 (OWP) F-12, 6/17/2021.

Photographic Log
Ferguson No.2 (OWP) #F-12
ECMC Form 27 Sampling
Colorado Energy & Carbon Management Commission

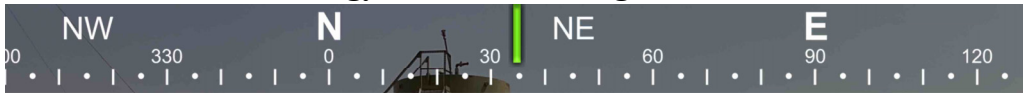

☉ 35°NE (T) ● 37°4'0"N, 108°7'49"W ±13ft ▲ 6579ft



Photo 7: SS07 collected from a flowline segment at the Ferguson No. 2 (OWP) F-12, 6/17/2021.



☉ 237°SW (T) ● 37°4'2"N, 108°7'48"W ±55ft ▲ 6602ft



Photo 8: SS08 collected adjacent to AST manway at the Ferguson No. 2 (OWP) F-12, 6/17/2021.

Photographic Log
Ferguson No.2 (OWP) #F-12
ECMC Form 27 Sampling

Colorado Energy & Carbon Management Commission

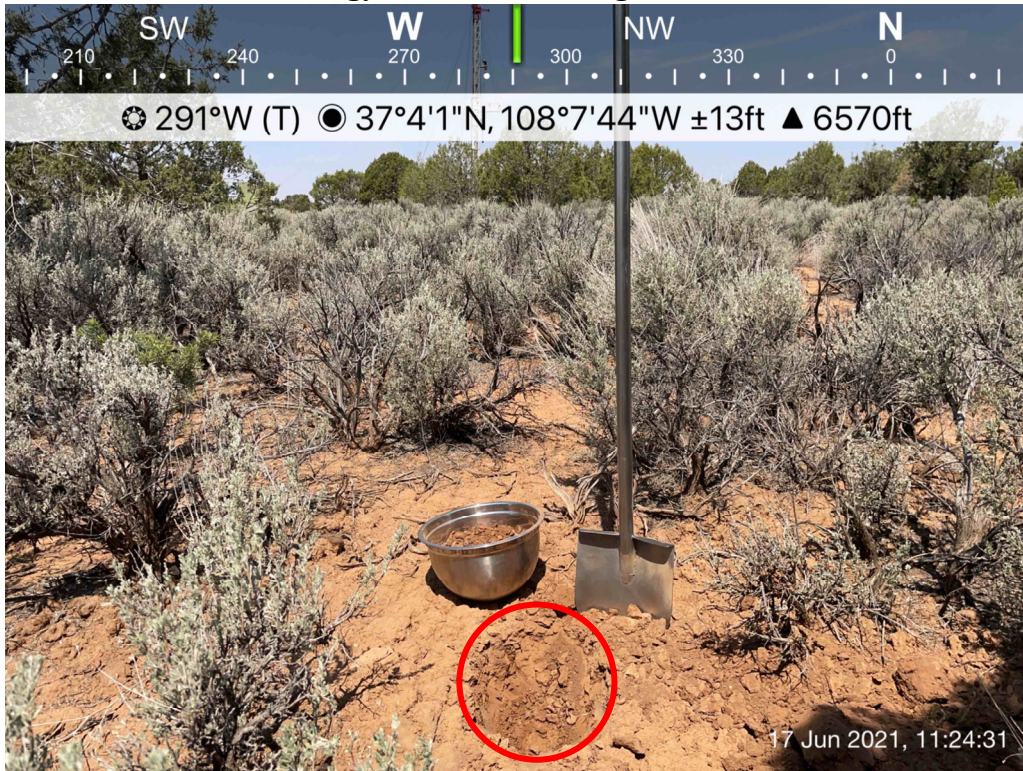

Photo 9: SS09 collected as a background sample in an undisturbed area off-location at the Ferguson No. 2 (OWP) F-12, 6/17/2021.

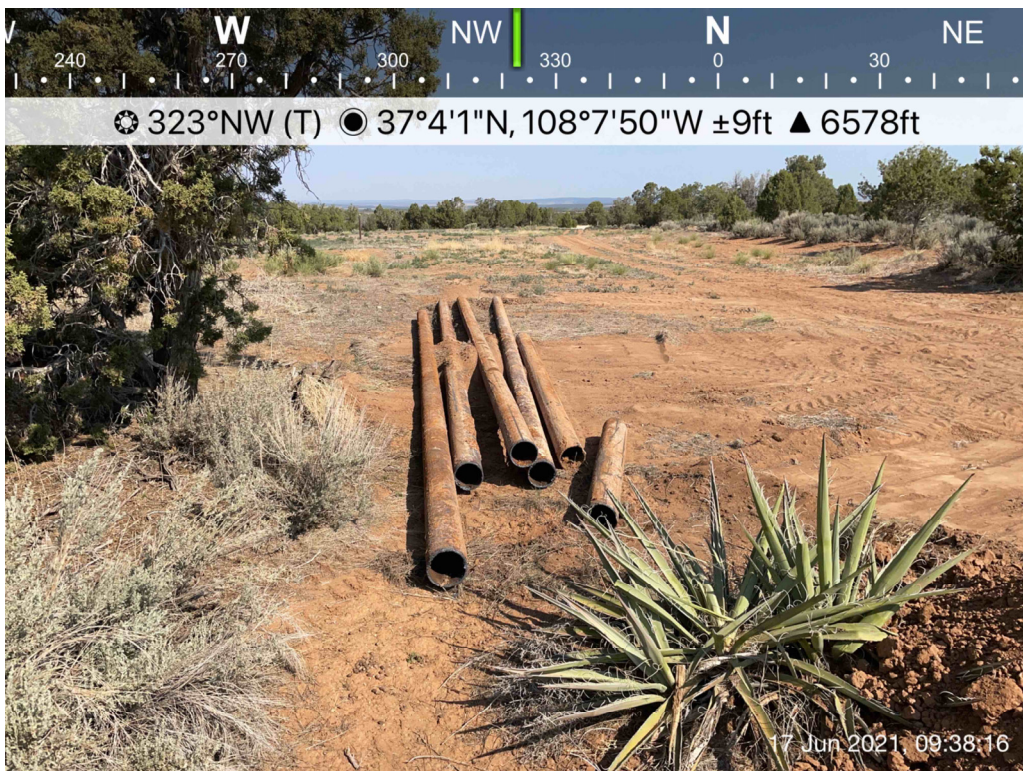

Photo 10: Removed flowlines at the Ferguson No. 2 (OWP) F-12, 6/17/2021.

Photographic Log
Ferguson No.2 (OWP) #F-12
ECMC Form 27 Sampling
Colorado Energy & Carbon Management Commission



Photo 11: Flowline excavation area, 9/18/2023.



Photo 12: SS10 collected from east sidewall of flowline excavation area, 9/18/2023.

Photographic Log
Ferguson No.2 (OWP) #F-12
ECMC Form 27 Sampling
Colorado Energy & Carbon Management Commission

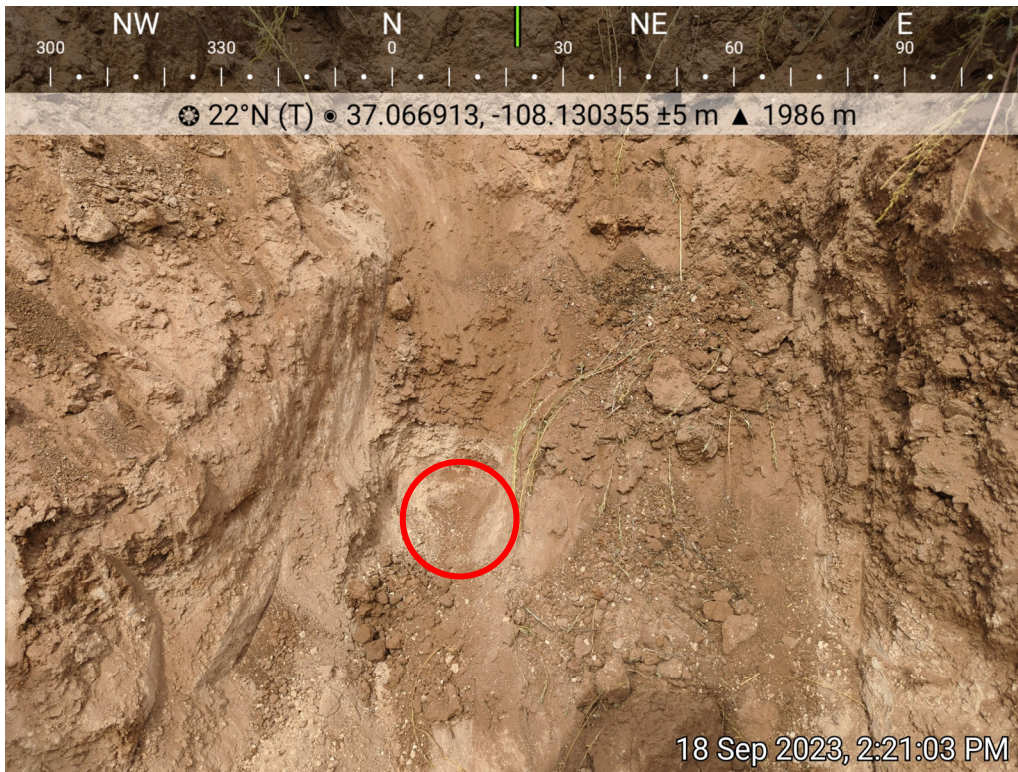

Photo 13: SS11 collected from north sidewall of flowline excavation area, 9/18/2023.



Photo 14: SS12 collected from south sidewall of flowline excavation area, 9/18/2023

Photographic Log
Ferguson No.2 (OWP) #F-12
ECMC Form 27 Sampling
Colorado Energy & Carbon Management Commission



Photo 15: SS13 collected from west sidewall of flowline excavation area, 9/18/2023.



Photo 16: SS14 collected from base of flowline excavation area, 9/18/2023.

Photographic Log
Ferguson No.2 (OWP) #F-12
ECMC Form 27 Sampling
Colorado Energy & Carbon Management Commission



Photo 17: AST excavation area, 9/18/2023.



Photo 18: SS15 collected from pothole in the center of AST excavation area, 9/18/2023.

Photographic Log
Ferguson No.2 (OWP) #F-12
ECMC Form 27 Sampling

Colorado Energy & Carbon Management Commission



☉ 147°SE (T) ● 37°4'0"N, 108°7'49"W ±13ft ▲ 6556ft



Photo 19: Wellhead excavation area, 9/20/2023.



☉ 29°NE (T) ● 37°4'0"N, 108°7'49"W ±13ft ▲ 6579ft



Photo 20: SS09 collected from base of wellhead excavation area, 9/20/2023.