

WGS84  $\pm 12\text{ft}$  40.10775, -104.98226  $\wedge^{\text{ft}}_{\pm 10\text{ft}}$  4980  $\triangle^{\circ, \text{T}}_{\pm 12}$  NW316

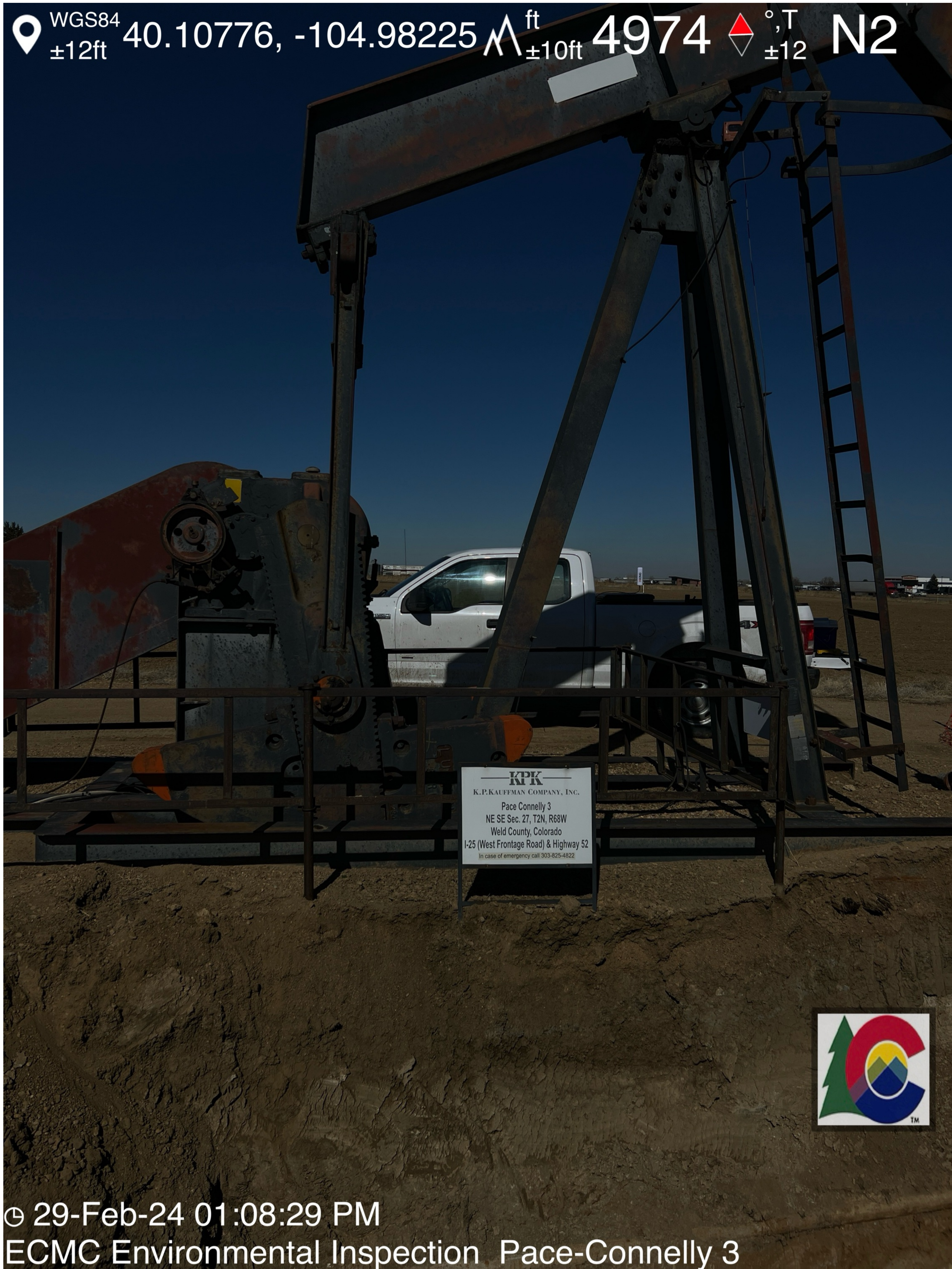

© 29-Feb-24 01:08:23 PM  
ECMC Environmental Inspection Pace-Connolly 3

WGS84  $\pm 12\text{ft}$  40.10776, -104.98225  $\wedge^{\text{ft}}_{\pm 10\text{ft}}$  4974  $\diamond^{\circ, \text{T}}_{\pm 12}$  N2



**KPK**  
K.P. KAUFFMAN COMPANY, INC.  
Pace Connelly 3  
NE SE Sec. 27, T2N, R68W  
Weld County, Colorado  
I-25 (West Frontage Road) & Highway 52  
In case of emergency call 303-825-4822



© 29-Feb-24 01:08:29 PM  
ECMC Environmental Inspection Pace-Connelly 3



WGS84 40.10777, -104.98226  $\Delta$  ft 4973  $\pm$ 15ft  $\pm$ 12ft °,T NW336  
© 29-Feb-24 01:08:36 PM  
ECMC Environmental Inspection Pace-Connelly 3



WGS84 40.10777, -104.98227  $\wedge^{\text{ft}}$   $\pm 12\text{ft}$  4974  $\triangle^{\circ, \text{T}}$   $\pm 12$  NE32



© 29-Feb-24 01:08:44 PM  
ECMC Environmental Inspection Pace-Connolly 3





WGS84 40.10777, -104.98228  $\Delta$   $\pm 16$ ft 4974  $\Delta$   $\pm 12$ ft E90



© 29-Feb-24 01:09:34 PM  
ECMC Environmental Inspection Pace-Connolly 3



WGS84  $\pm 16\text{ft}$  40.10780, -104.98222  $\wedge^{\text{ft}}$   $\pm 11\text{ft}$  4978  $\triangle^{\circ, \text{T}}$   $\pm 12$  E82



© 29-Feb-24 01:10:05 PM  
ECMC Environmental Inspection Pace-Connolly 3

WGS84 40.10785, -104.98213  $\Delta$  ft 4974  $\pm$ 11ft  $\angle$  °,T NE70  $\pm$ 12



© 29-Feb-24 01:11:17 PM  
ECMC-Environmental Inspection Pace-Connelly 3



WGS84  $\pm 16\text{ft}$  40.10785, -104.98213  $\wedge^{\text{ft}}_{\pm 11\text{ft}}$  4975  $\triangle^{\circ, \text{T}}_{\pm 12}$  SE140



© 29-Feb-24 01:11:22 PM  
EOMC Environmental Inspection Pace-Connelly 3

WGS84 40.10786, -104.98208  $\Delta$  ft 4973 S186  
±16ft ±11ft



© 29-Feb-24 01:11:39 PM  
ECMC Environmental Inspection Race-Connelly 3

WGS84 40.10786, -104.98209  $\Delta$   $\pm 16\text{ft}$   $\Delta$   $\pm 11\text{ft}$  4970  $\Delta$   $\pm 12$  °,T SW222



© 29-Feb-24 01:11:44 PM  
ECMC Environmental Inspection Pace-Connolly 3

WGS84 40.10783, -104.98204  $\Delta$ <sup>ft</sup><sub>±11ft</sub> 4972  $\angle$ <sup>°</sup><sub>±12</sub> SW253



© 29-Feb-24 01:11:59 PM  
ECMC Environmental Inspection Pace-Connolly 3

WGS84 40.10969, -104.97988  $\Delta$   $\pm 443\text{ft}$   $\wedge$   $\pm 8\text{ft}$  4974  $\triangle$   $\pm 12$  °T W279



© 29-Feb-24 01:12:39 PM  
ECMC Environmental Inspection Pace-Connolly 3

WGS84 40.10969, -104.97988 4974 °T ±12 NW295  
±443ft ±8ft



© 29-Feb-24 01:12:42 PM  
ECMC Environmental Inspection Pace-Connolly 3

WGS84  $\pm 16\text{ft}$  40.10777, -104.98218  $\wedge^{\text{ft}}_{\pm 11\text{ft}}$  4976  $\triangle^{\circ, T}_{\pm 12}$  NW343



© 29-Feb-24 01:13:28 PM  
ECMC Environmental Inspection Pace-Connolly 3

WGS84 40.10778, -104.98219  $\Delta$   $\pm 16$ ft 4974  $\pm 11$ ft  $\nabla$   $\pm 12$ ft NW303



© 29-Feb-24 01:14:08 PM  
ECMC Environmental Inspection Pace-Connelly 3