



Form PS-102

R. 58W



00080164

N

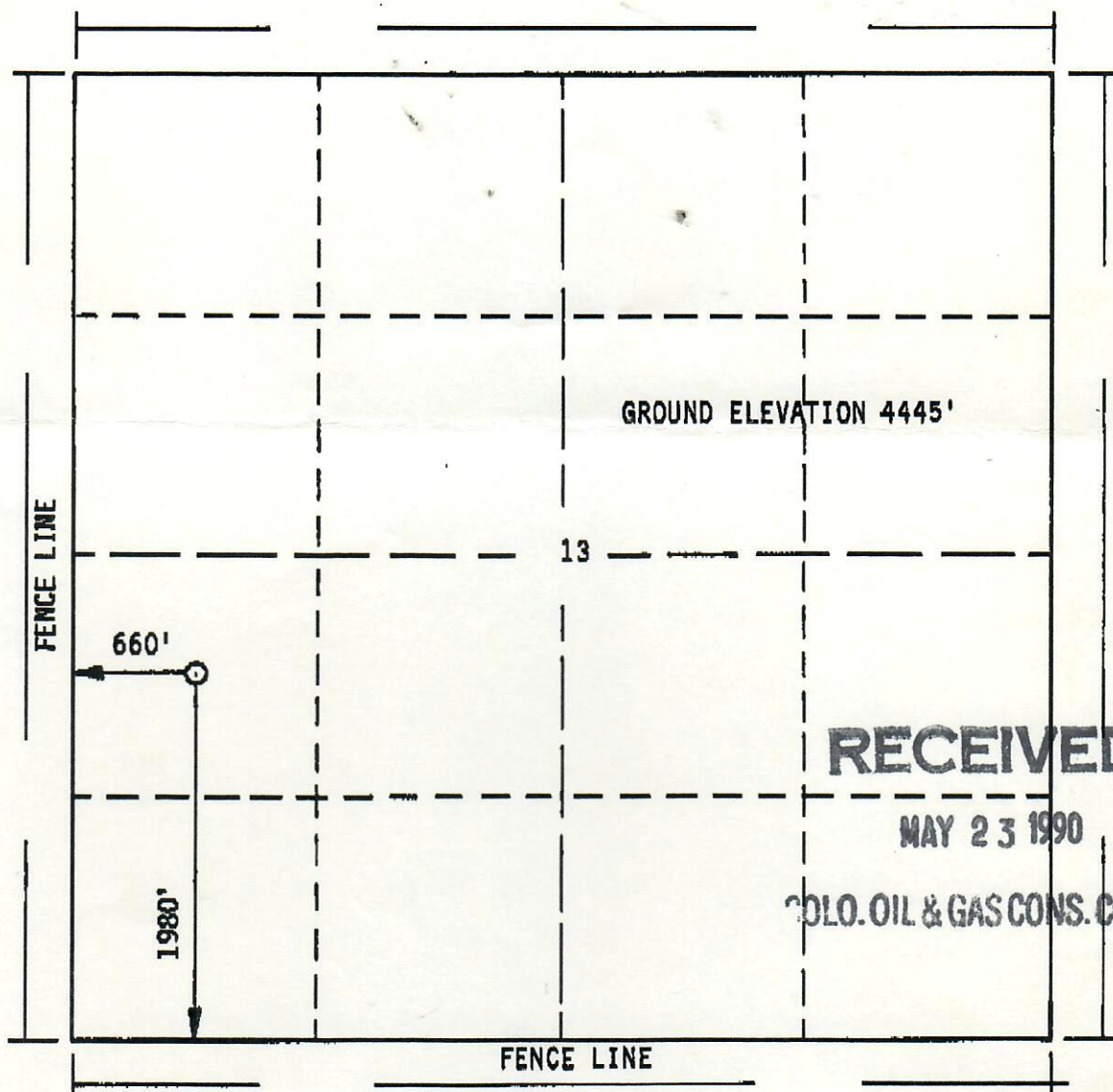
T.
2N

Scale: 1"=1000'

Powers Elevation, Inc. of Denver, Colorado has in accordance with a
request from MIKE ASHER for CAZA EXPLORATION CO.

determined the location of #1 ANDERSON

to be 1980' fs1, 660' fw1

Section 13 , Township 2 NORTH
Meridian,

Range 58 WEST OF THE SIXTH PRINCIPAL

MORGAN

County, STATE OF COLORADO

I hereby certify that this plat is an
accurate representation of a corner
survey showing the location of

#1 ANDERSON

Date: MAY 17, 1990

Licensed Land Surveyor No. 20693
State of COLORADO

