

# CULTURAL ITEMS MAP

BARRACUDA PAD  
BISON OIL & GAS IV

Q: SW/4  
SECTION: 33  
TOWNSHIP: 7N  
RANGE: 62W  
6TH. P.M.  
WELD COUNTY, CO

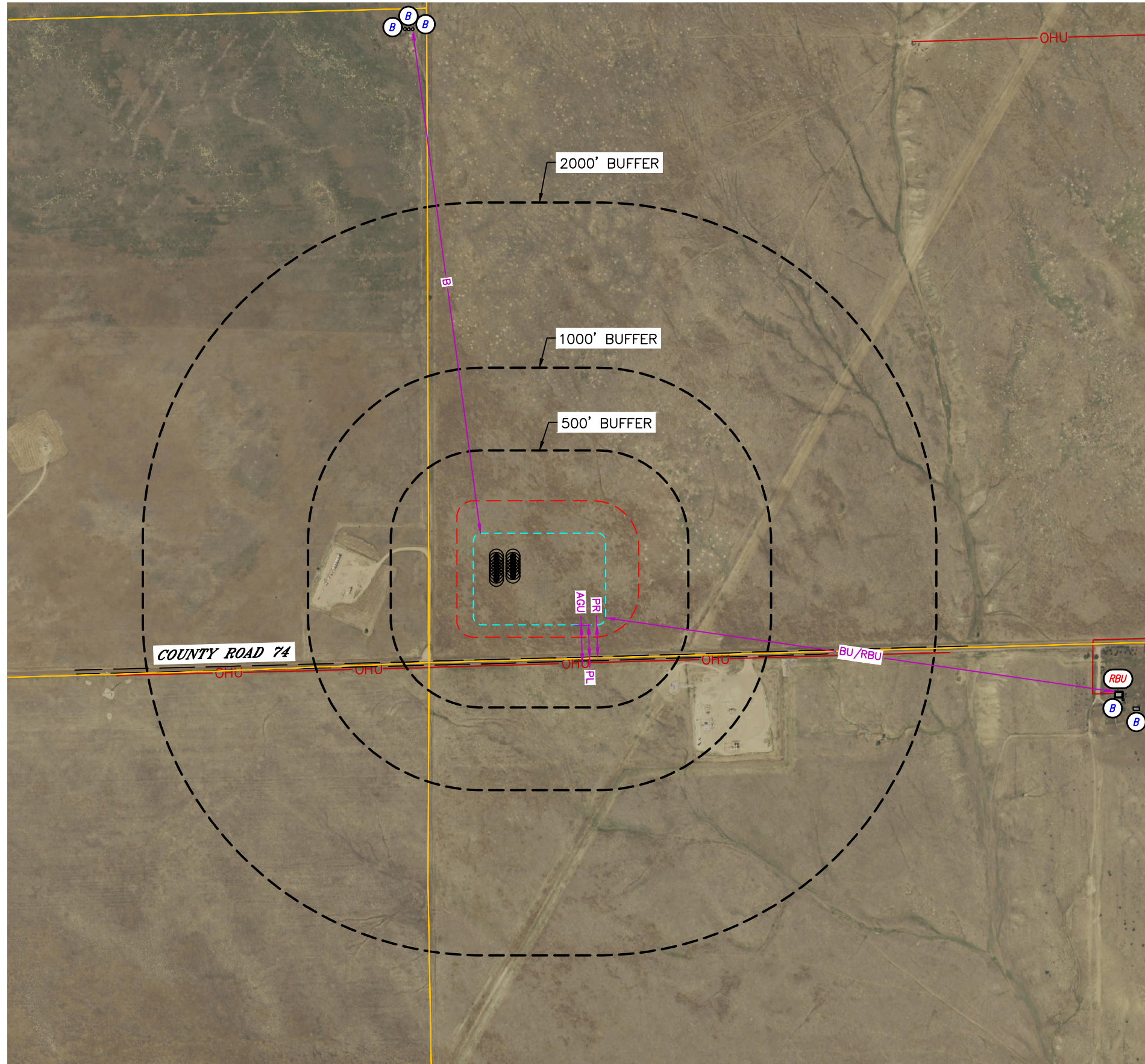

	MEASURED FROM THE NEAREST	PROPOSED WELL HEAD	EDGE OF WORKING PAD
B	BUILDING	±3218' NW	±3066' NW
BU	BUILDING UNIT	±3708' SE	±3114' SE
RBU	RESIDENTIAL BUILDING UNIT	±3708' SE	±3114' SE
HOB	HIGH OCCUPANCY BUILDING UNIT	5280'+ N	5280'+ N
S	SCHOOL FACILITY	5280'+ N	5280'+ N
DOAA	DESIGNATED OUTSIDE ACTIVITY AREA	5280'+ SW	5280'+ SW
DIC	DISPROPORTIONATELY IMPACTED COMMUNITY BOUNDARY	5280'+ NW	5280'+ NW
DIC/BU/RBU/HOB/S	BUILDING UNIT/RESIDENTIAL BUILDING UNIT/HIGH OCCUPANCY BUILDING UNIT/ SCHOOL FACILITY WITHIN DISPROPORTIONATELY IMPACTED COMMUNITY BOUNDARY	5280'+ NW	5280'+ NW
CC	CHILD CARE CENTER	5280'+ N	5280'+ N
PR	PUBLIC ROAD (COUNTY ROAD 74)	±484'S	±193'S
AGU	ABOVE GROUND UTILITY	±521'S	±228'S
RR	RAILROAD	5280'+ SW	5280'+ SW
PL	PROPERTY LINE	±411'W	±200'S

WORKING PAD RADII	0-500 FEET	501-1000 FEET	1001-2000 FEET
BUILDING	0	0	0
BUILDING UNIT	0	0	0
RESIDENTIAL BUILDING UNIT	0	0	0
HIGH OCCUPANCY BUILDING UNIT	0	0	0
SCHOOL PROPERTIES	0	0	0
SCHOOL FACILITIES	0	0	0
DESIGNATED OUTDOOR ACTIVITY AREA	0	0	0

- LEGEND
- PARCEL LINE
  - WORKING PAD SURFACE
  - OIL AND GAS LOCATION
  - PROPOSED WELL
  - BUILDING
  - BUILDING UNIT
  - RESIDENTIAL BUILDING UNIT

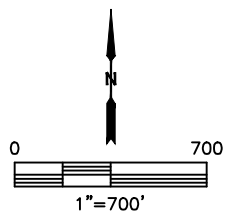



Lat40°, Inc. 6250 W. 10th Street, Unit 2, Greeley, CO 970-515-5294

# CULTURAL ITEMS MAP

**BARRACUDA PAD**  
**BISON OIL & GAS IV**

Q: SW/4  
SECTION: 33  
TOWNSHIP: 7N  
RANGE: 62W  
6TH. P.M.  
WELD COUNTY, CO

MEASURED FROM THE NEAREST	WHITETAIL FED 7-62 33-9-1	WHITETAIL FED 7-62 33-9-2	WHITETAIL FED 7-62 33-9-3	WHITETAIL FED 7-62 33-9-4	WHITETAIL FED 7-62 33-9-5	WHITETAIL FED 7-62 33-9-6	WHITETAIL FED 7-62 33-9-7
BUILDING	±3353'NW	±3334'NW	±3314'NW	±3294'NW	±3275'NW	±3255'NW	±3235'NW
BUILDING UNIT	±3708'SE	±3711'SE	±3715'SE	±3719'SE	±3723'SE	±3728'SE	±3732'SE
PUBLIC ROAD (COUNTY ROAD 74)	±501'S	±521'S	±541'S	±561'S	±581'S	±601'S	±621'S
ABOVE GROUND UTILITY	±538'S	±558'S	±578'S	±598'S	±618'S	±638'S	±658'S
RAILROAD	5280'+SW	5280'+SW	5280'+SW	5280'+SW	5280'+SW	5280'+SW	5280'+SW
PROPERTY LINE	±510'S	±511'W	±511'W	±511'W	±511'W	±511'W	±511'W

MEASURED FROM THE NEAREST	BARRACUDA 7-62 33-31-1	BARRACUDA 7-62 33-31-2	BARRACUDA 7-62 33-31-3	BARRACUDA 7-62 33-31-4	BARRACUDA 7-62 33-31-5	BARRACUDA 7-62 33-31-6	BARRACUDA 7-62 33-31-7	BARRACUDA 7-62 33-31-8
BUILDING	±3218'NW	±3238'NW	±3258'NW	±3277'NW	±3297'NW	±3317'NW	±3337'NW	±3356'NW
BUILDING UNIT	±3830'SE	±3825'SE	±3821'SE	±3817'SE	±3813'SE	±3810'SE	±3806'SE	±3802'SE
PUBLIC ROAD (COUNTY ROAD 74)	±624'S	±604'S	±584'S	±564'S	±544'S	±524'S	±504'S	±484'S
ABOVE GROUND UTILITY	±661'S	±641'S	±621'S	±601'S	±581'S	±561'S	±541'S	±521'S
RAILROAD	5280'+SW	5280'+SW	5280'+SW	5280'+SW	5280'+SW	5280'+SW	5280'+SW	5280'+SW
PROPERTY LINE	±411'W	±411'W	±411'W	±411'W	±411'W	±411'W	±411'W	±411'W

