

Inspection Photos

API: 061-06296

Operator: STRACHAN EXPLORATION INC

Inspection Date: 2/27/2024



Inspection Photos

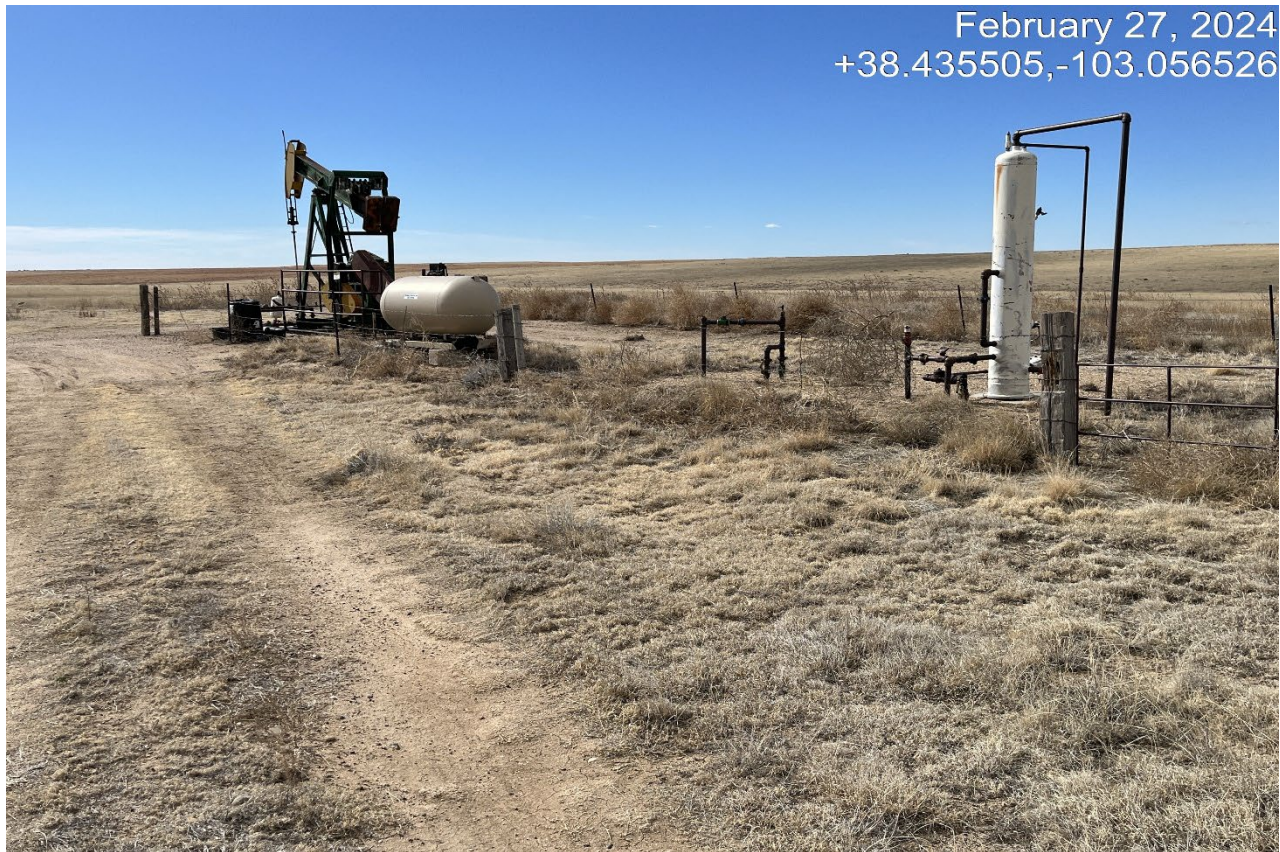

Photo 1. Facing toward the wellsite.



Inspection Photos



Photo 2. Facing east toward the tank battery.



Inspection Photos



Photo 3. The fence around the tank battery is inadequate to prevent livestock entry and is not maintained. Previous corrective action was not completed.



Inspection Photos



Photo 4. The 4 ft shovel shows loose wires are low only about 2 ft. which livestock can step over and into the fenced area.



Inspection Photos



Photo 5. The berm at the open top tank has been rebuilt for containment.

