



RECEIVED

DEC 17 1968

R. 56W

COLO. OIL & GAS CONS. COMM.

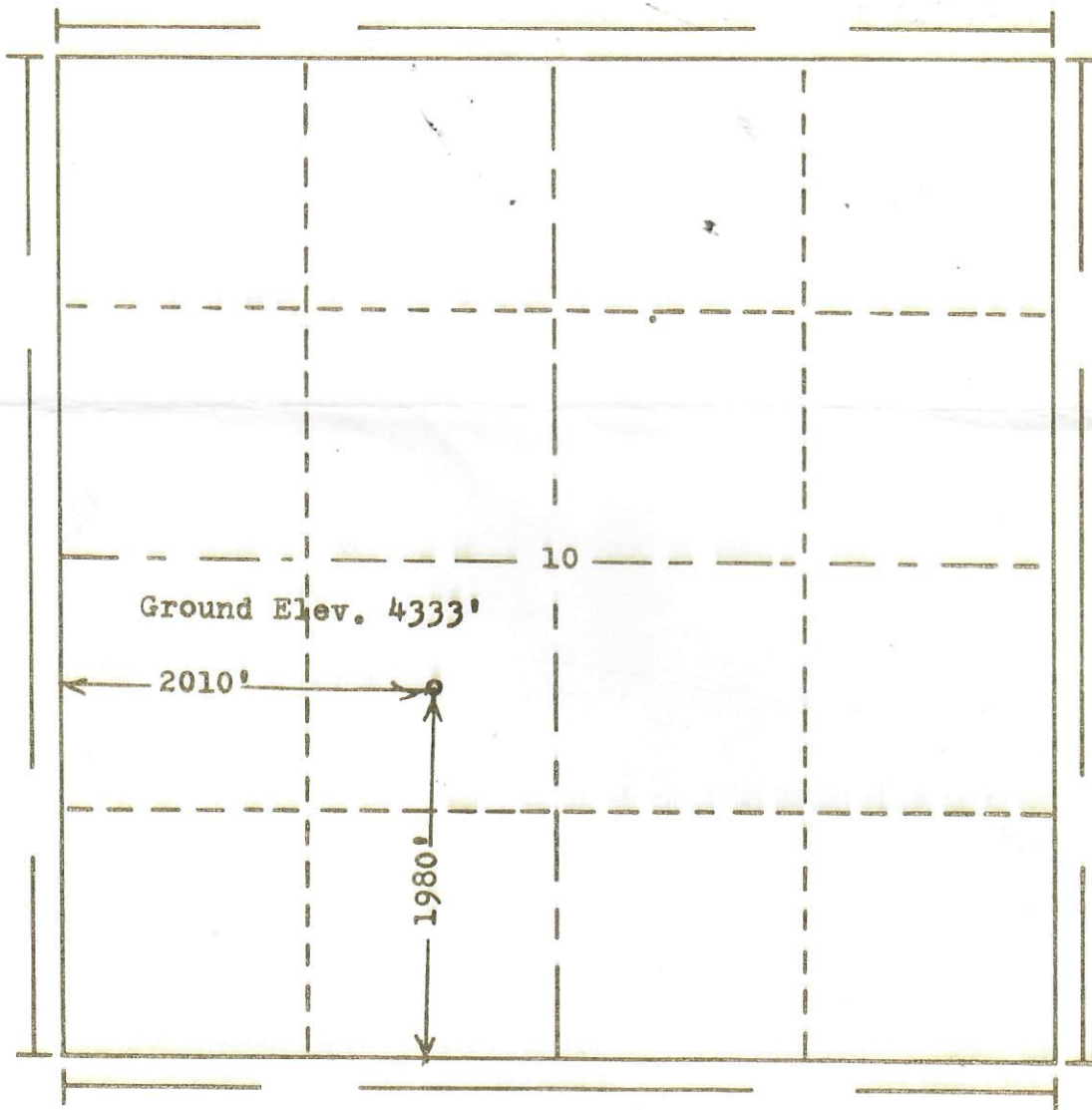

T.
2
N

Scale... 1" = 1000'

Powers Elevation Company, Inc. of Denver, Colorado
has in accordance with a request from Mary Abel
for Exeter Drlg. Co. & Hank Allen

determined the location of No.1 Peterson
to be CNE SW Section 10 Township 2N
Range 56W of the 6th Principal Meridian
Morgan County, Colorado

I hereby certify that this plat is an
accurate representation of a correct
survey showing the location of

Date: 12-11-68

B. G. Hollman
Licensed Land Surveyor No. 2853
State of Colorado

68 541

68-541