



Form PS-102

R. 55W

RECEIVED

NOV 8 1985

COLO. OIL & GAS CONS. COMM.

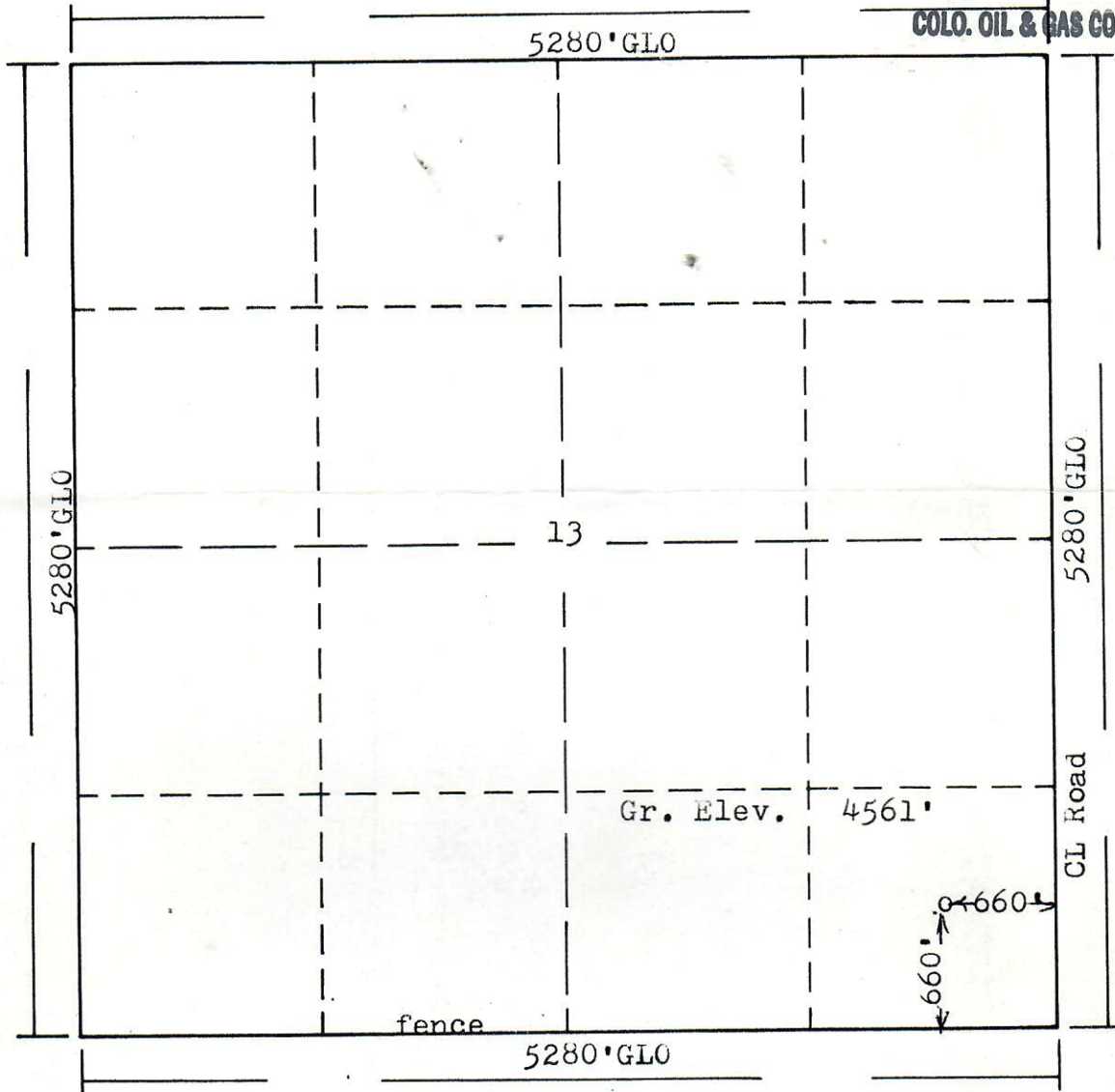

N

T.
2
N

Scale: 1"=1000'

Powers Elevation of Denver, Colorado has in accordance with a request from Mr. Gear for Cimarron Oil Co., Inc. determined the location of No.2 Cimarron-Jubilee to be CSE SE Section 13, Township 2N Range 55W of the 6th Principal Meridian, Morgan County, Colorado

I hereby certify that this plat is an accurate representation of a correct survey showing the location of

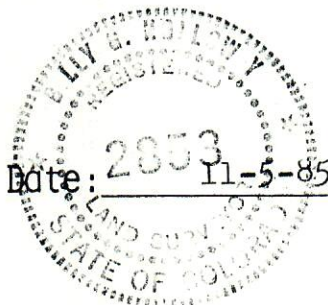

00075594

R. L. E. Riley
Licensed Land Surveyor No. 2853
State of Colorado

A