



00048029

RECEIVED

DEC 4-1967

COLO. OIL & GAS CONS. COMM.

R. 54 W

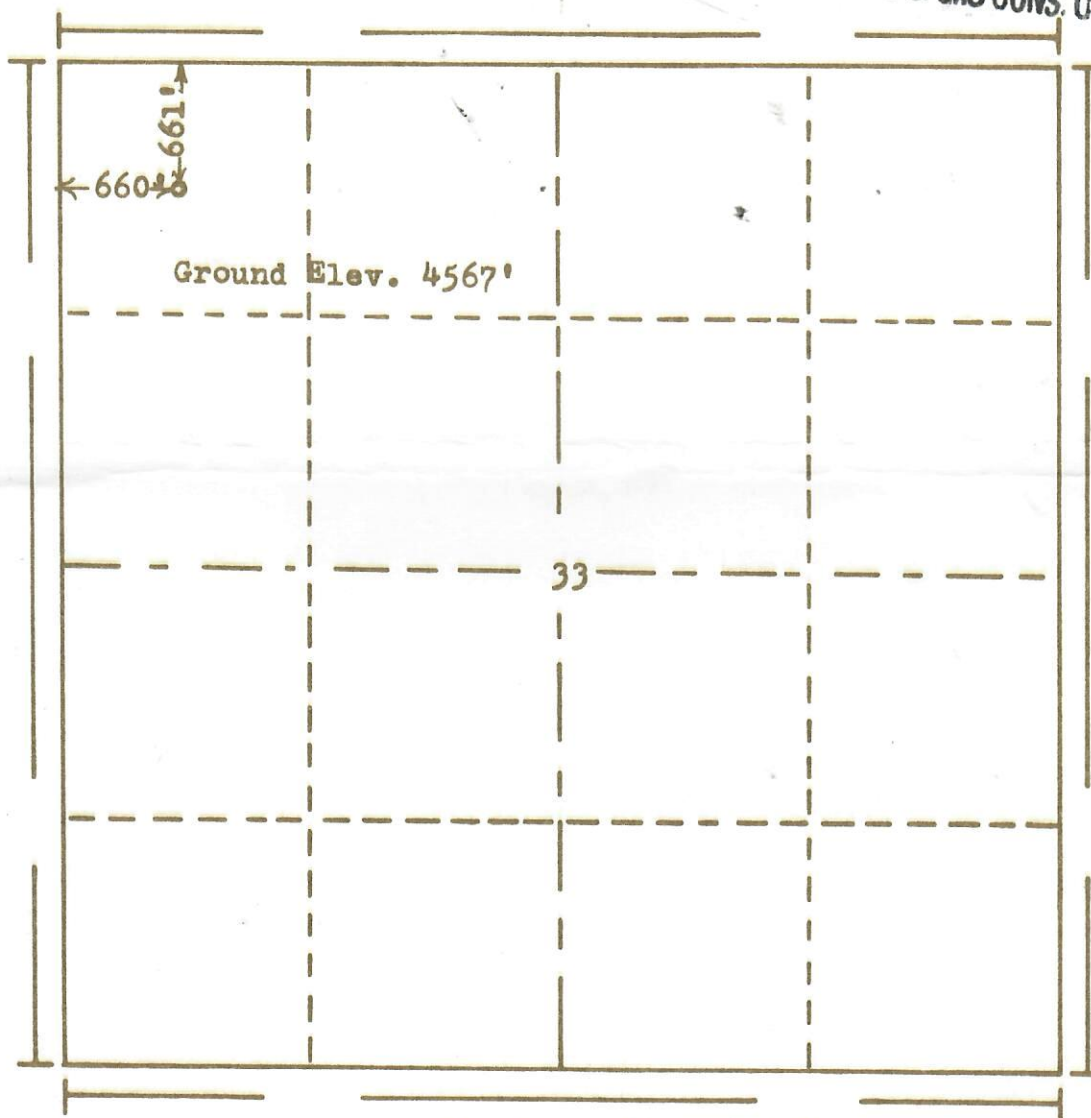

Scale... 1" = 1000'

Powers Elevation Company, Inc. of Denver, Colorado
has in accordance with a request from Mr. Foster
for Enbrook Oil & Gas Co.
determined the location of No. 1 Tuttle
to be C NW NW Section 33 Township 2 North
Range 54 West of the 6th Principal Meridian
Washington County, Colorado

I hereby certify that this plat is an
accurate representation of a correct
survey showing the location of

Date: 11-28-67

Bill G. Hocking
Licensed Land Surveyor No. 2853
State of Colorado