

HYDROLOGY MAP

CLOVER 2-29HZ

HORIZONTAL MULTI-WELL PAD

NW1/4 NE1/4 SECTION 29, TOWNSHIP 2 NORTH, RANGE 67 WEST, 6TH P.M., WELD COUNTY, COLORADO

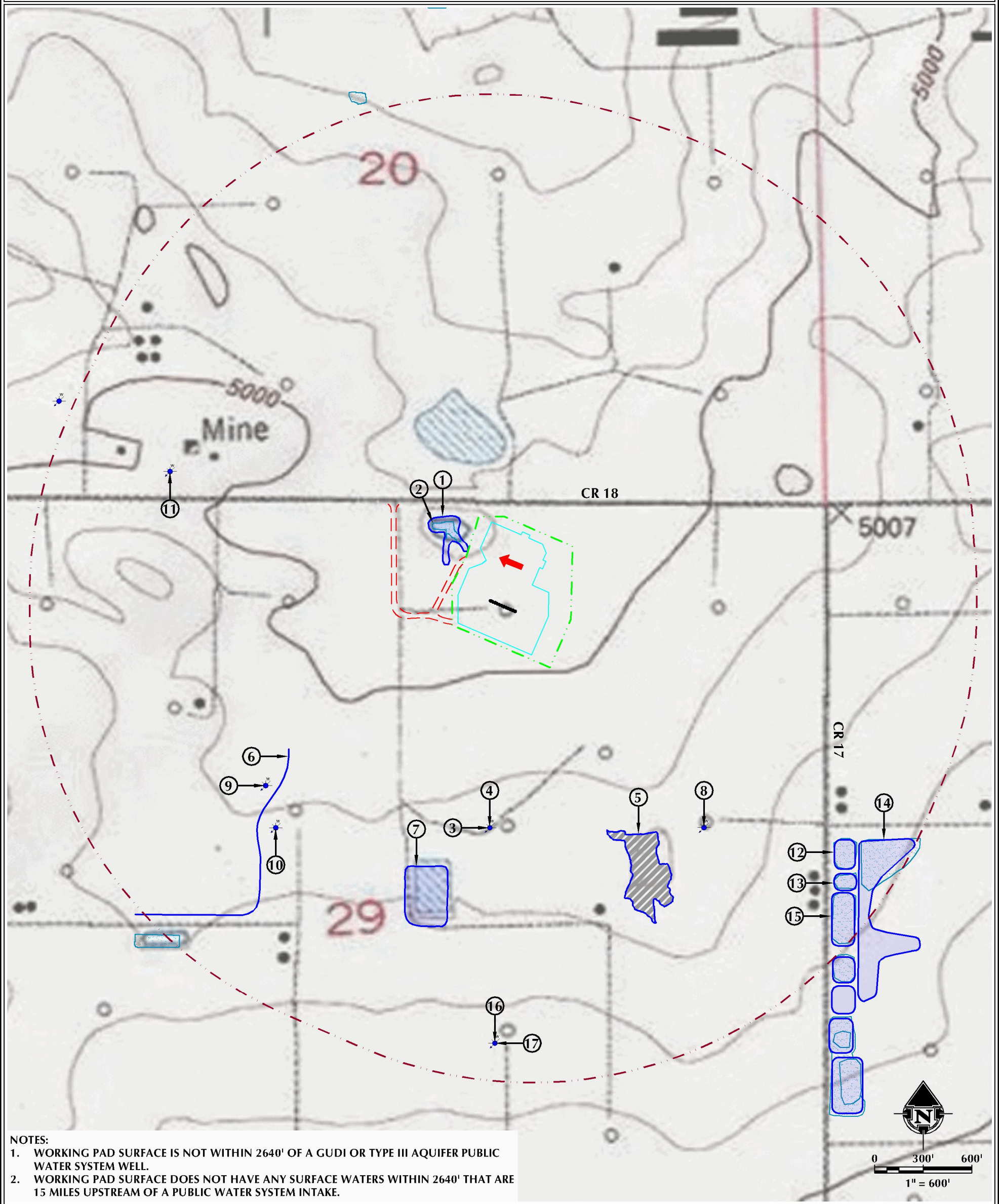

NOTES:

- WORKING PAD SURFACE IS NOT WITHIN 2640' OF A GUDI OR TYPE III AQUIFER PUBLIC WATER SYSTEM WELL.
- WORKING PAD SURFACE DOES NOT HAVE ANY SURFACE WATERS WITHIN 2640' THAT ARE 15 MILES UPSTREAM OF A PUBLIC WATER SYSTEM INTAKE.

- | | |
|---|--|
| 1. POND IS ±77' W. | 13. POND IS ±2318' SE. |
| 2. NW1/RIVERINE/POND/WETLAND AREAS ARE ±130' W, ±2196' SE, ±2326' SE, ±2337' SE, ±2386' SE AND ±2580' SW. | 14. POND IS ±2333' SE. |
| 3. EXISTING WATER WELL (PERMIT#53977-MH, PERMIT ISSUED) IS ±1097' S. | 15. POND IS ±2378' SE. |
| 4. EXISTING WATER WELL (PERMIT#52579-MH, PERMIT ISSUED) IS ±1097' S. | 16. EXISTING WATER WELL (PERMIT#295639, WELL CONSTRUCTED) IS ±2407' S. |
| 5. DELINEATED WETLANDS ARE: ±1178' SE. | 17. EXISTING WATER WELL (PERMIT#52593-MH, WELL CONSTRUCTED) IS ±2407' S. |
| 6. DRAINAGE SWALE ±1303' SW. | |
| 7. POND IS ±1413' S. | |
| 8. EXISTING WATER WELL (PERMIT#54035-MH, PERMIT ISSUED) IS ±1506' SE. | |
| 9. EXISTING WATER WELL (PERMIT#62167-MH, PERMIT ISSUED) IS ±1554' SW. | |
| 10. EXISTING WATER WELL (PERMIT#40152-MH, PERMIT ISSUED) IS ±1691' SW. | |
| 11. EXISTING WATER WELL (PERMIT#13725-R, WELL CONSTRUCTED) IS ±1930' NW. | |
| 12. POND IS ±2203' SE. | |

LEGEND		PROPOSED OIL & GAS LOCATION	
	PROPOSED WELL		
	WATER WELL		WORKING PAD SURFACE
	PROPOSED ACCESS ROAD		100-YEAR FLOODPLAIN (PRELIMINARY, 2020)
	DITCH/CANAL/DRAINAGE/SWALE		100-YEAR FLOODWAY (PRELIMINARY, 2020)
	DOWNGRADIENT		100-YEAR FLOODPLAIN (EFFECTIVE, 2016)
	2640' WORKING PAD SURFACE BUFFER		NWI RIVERINE/POND/WETLAND
			NWI RIPARIAN AREA

ALL MEASUREMENTS ARE MADE FROM NEAREST EDGE OF THE WORKING PAD SURFACE

609 CONSULTING, LLC

LOVELAND OFFICE
6706 South Franklin Avenue
Loveland, Colorado 80538
Phone: 970-776-4331

SHERIDAN OFFICE
1095 Saberton Avenue
Sheridan, Wyoming 82801
Phone: 307-674-6069

DATE SURVEYED: 5/2/23

DATE: 6/5/23

DRAFTER: GLK

REVISED:

DATA SOURCES & NOTES:

- TOPOGRAPHIC MAP IS COURTESY OF USGS.

- WATER WELLS COURTESY OF COLORADO DIVISION OF WATER RESOURCES.

- MANY FEATURES ON THIS MAP COME FROM PUBLICLY AVAILABLE DATA AND SURFACE WATER LYING OUTSIDE THE SURFACE PROPERTY MAY HAVE BEEN OBTAINED FROM AERIAL IMAGERY. THE ACCURACY AND COMPLETENESS OF SAID DATA HAS NOT BEEN VERIFIED BY 609 CONSULTING, LLC. EXISTING CONDITIONS MAY DIFFER FROM WHAT IS SHOWN.

PREPARED FOR:

Kerr-McGee Oil & Gas Onshore LP