

PDC Energy Inc. DJ Basin

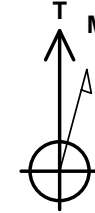

HEN 09N
 Hen Pad
 North American Datum 1983 , US State Plane 1983, Colorado Northern Zone
 Ground Elevation: 4779.0
 +N/-S +E/-W Northing Easting Latitude Longitude
 0.0 0.0 1363716.82 3258632.25 40.328090 -104.572340
 P272 - RKB 28.5' WELL @ 4807.5ft (P272 - RKB 28.5')

Hen Pad
 HEN 09N
 HEN 09N Final Surveys
 14:39, November 28 2023



Azimuths to True North
 Magnetic North: 7.68°

Magnetic Field
 Strength: 51705.5nT
 Dip Angle: 66.58°
 Date: 08/28/2023
 Model: HRGM

ANNOTATIONS

MD	TVD	Annotation
7368.0	6826.1	LPL - 2033' FNL & 2398' FEL
14855.0	6783.2	BHL - 2046' FNL & 205' FEL

FINAL SURVEY

Projected Bottom Hole Location
 14855' MD / 6783.2' TVD
 89.53° INC / 92.29° AZM
 2046' FNL / 205' FEL

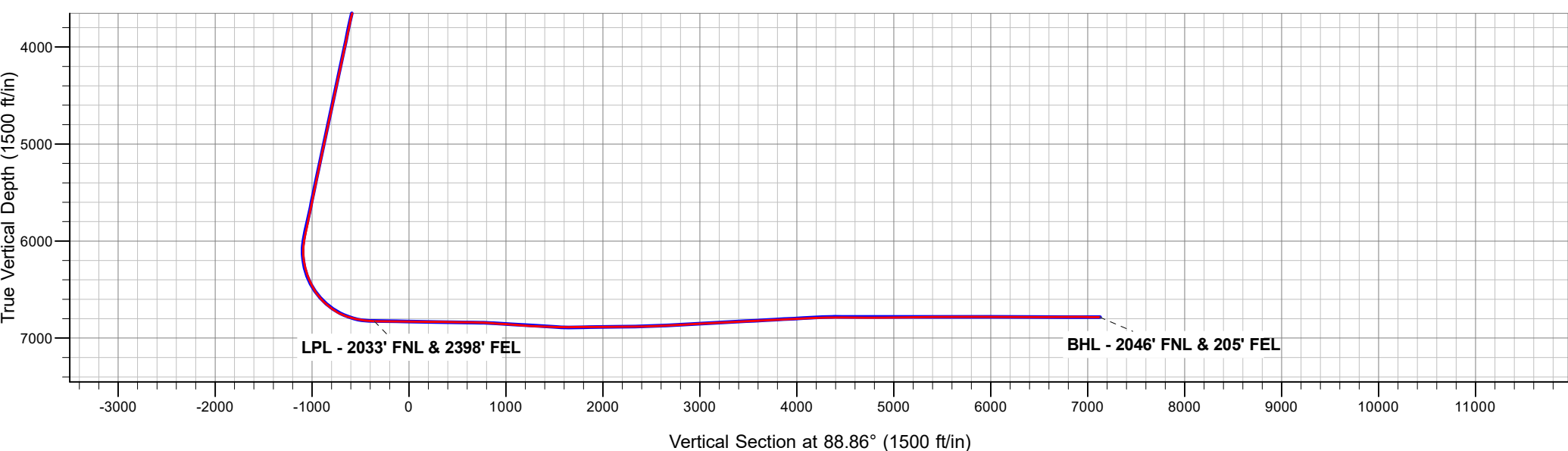
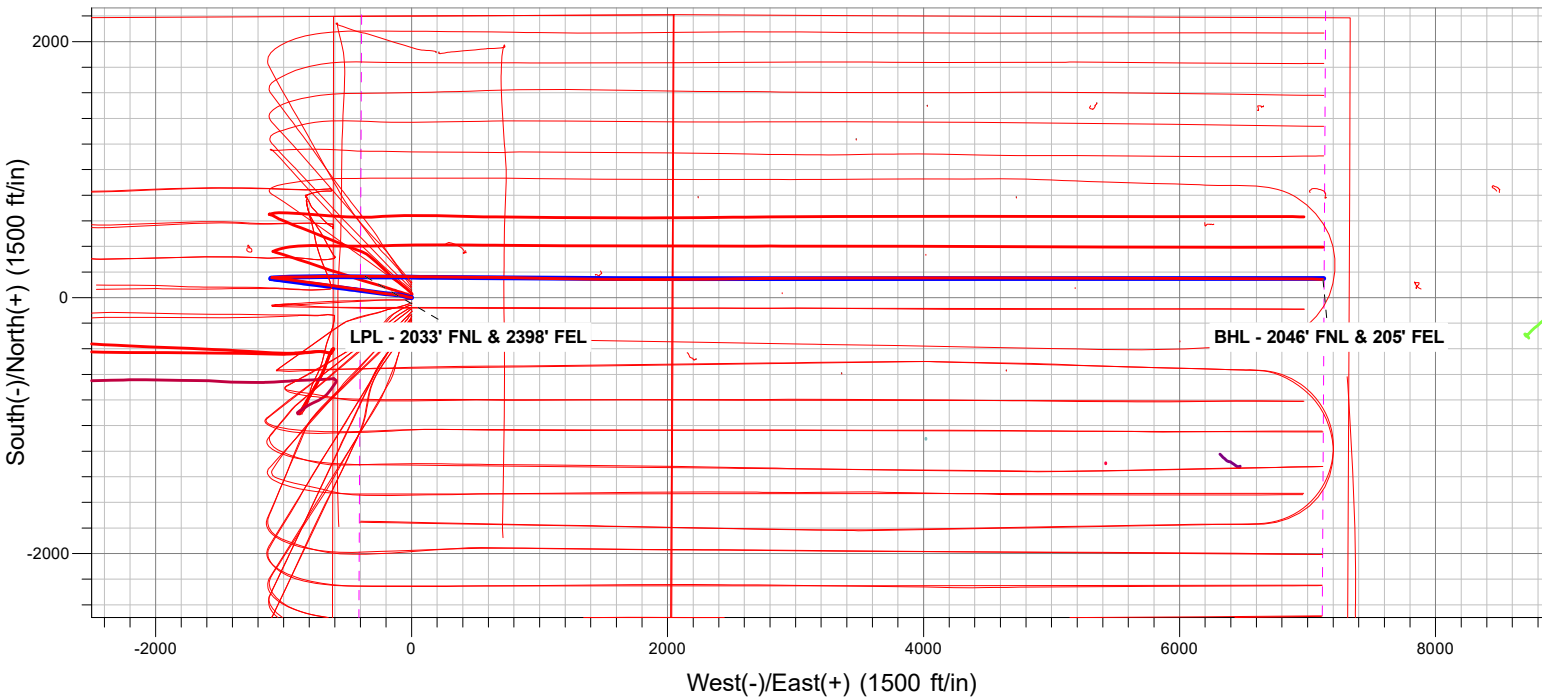

PDC Energy Inc. DJ Basin

SEC.8-T4N-R64W

Hen Pad

HEN 09N

HEN 09N

Design: HEN 09N Final Surveys

Survey Report - Geographic

28 November, 2023

Ensign

Survey Report - Geographic

Company: PDC Energy Inc. DJ Basin	Local Co-ordinate Reference: Well HEN 09N
Project: SEC.8-T4N-R64W	TVD Reference: WELL @ 4807.5ft (P272 - RKB 28.5')
Site: Hen Pad	MD Reference: WELL @ 4807.5ft (P272 - RKB 28.5')
Well: HEN 09N	North Reference: True
Wellbore: HEN 09N	Survey Calculation Method: Minimum Curvature
Design: HEN 09N Final Surveys	Database: US_EDM

Project SEC.8-T4N-R64W, Weld County, Colorado			
Map System: US State Plane 1983	System Datum: Mean Sea Level		
Geo Datum: North American Datum 1983			
Map Zone: Colorado Northern Zone	Using geodetic scale factor		

Site Hen Pad			
Site Position:	Northing: 1,363,685.50 usft	Latitude: 40.328004	
From: Lat/Long	Easting: 3,258,631.47 usft	Longitude: -104.572344	
Position Uncertainty: 0.0 ft	Slot Radius: 13-3/16 "	Grid Convergence: 0.60 °	

Well HEN 09N			
Well Position	+N/-S 0.0 ft	Northing: 1,363,716.82 usft	Latitude: 40.328090
	+E/-W 0.0 ft	Easting: 3,258,632.25 usft	Longitude: -104.572340
Position Uncertainty 0.0 ft		Wellhead Elevation: ft	Ground Level: 4,779.0 ft

Wellbore HEN 09N					
Magnetics	Model Name	Sample Date	Declination (°)	Dip Angle (°)	Field Strength (nT)
	HRGM	08/28/2023	7.68	66.58	51,705.54554342

Design HEN 09N Final Surveys					
Audit Notes:					
Version: 1.0	Phase: ACTUAL	Tie On Depth: 0.0			
Vertical Section:	Depth From (TVD) (ft)	+N/-S (ft)	+E/-W (ft)	Direction (°)	
	0.0	0.0	0.0	88.86	

Survey Program Date 11/28/2023					
From (ft)	To (ft)	Survey (Wellbore)	Tool Name	Description	
159.5	14,855.0	Survey #1 (HEN 09N)	MWD+IFR1+SAG+MS	OWSG MWD + IFR1 + Sag + Multi-Station Corre	

Survey										
Measured Depth (ft)	Inclination (°)	Azimuth (°)	Vertical Depth (ft)	+N/-S (ft)	+E/-W (ft)	Map Northing (usft)	Map Easting (usft)	Latitude	Longitude	
0.0	0.00	0.00	0.0	0.0	0.0	1,363,716.82	3,258,632.25	40.328090	-104.572340	
159.5	0.53	4.70	159.5	0.7	0.1	1,363,717.56	3,258,632.31	40.328092	-104.572340	
249.5	0.09	307.40	249.5	1.2	0.0	1,363,718.01	3,258,632.28	40.328093	-104.572340	
340.5	0.35	246.75	340.5	1.1	-0.3	1,363,717.95	3,258,631.97	40.328093	-104.572341	
456.5	0.79	269.78	456.5	1.0	-1.4	1,363,717.79	3,258,630.84	40.328093	-104.572345	
545.5	1.06	252.90	545.5	0.7	-2.8	1,363,717.53	3,258,629.45	40.328092	-104.572350	
629.5	2.02	273.47	629.4	0.6	-5.0	1,363,717.37	3,258,627.23	40.328092	-104.572358	
715.5	3.87	278.57	715.3	1.1	-9.4	1,363,717.85	3,258,622.84	40.328093	-104.572374	
801.5	5.72	281.91	801.0	2.4	-16.5	1,363,719.09	3,258,615.76	40.328097	-104.572399	
888.5	7.30	283.32	887.5	4.6	-26.1	1,363,721.16	3,258,606.12	40.328103	-104.572434	
977.5	7.91	281.38	975.7	7.1	-37.6	1,363,723.55	3,258,594.59	40.328110	-104.572475	
1,066.5	8.53	284.72	1,063.8	10.0	-50.0	1,363,726.30	3,258,582.17	40.328118	-104.572520	

Ensign

Survey Report - Geographic

Company:	PDC Energy Inc. DJ Basin	Local Co-ordinate Reference:	Well HEN 09N
Project:	SEC.8-T4N-R64W	TVD Reference:	WELL @ 4807.5ft (P272 - RKB 28.5')
Site:	Hen Pad	MD Reference:	WELL @ 4807.5ft (P272 - RKB 28.5')
Well:	HEN 09N	North Reference:	True
Wellbore:	HEN 09N	Survey Calculation Method:	Minimum Curvature
Design:	HEN 09N Final Surveys	Database:	US_EDM

Survey									
Measured Depth (ft)	Inclination (°)	Azimuth (°)	Vertical Depth (ft)	+N/-S (ft)	+E/-W (ft)	Map Northing (usft)	Map Easting (usft)	Latitude	Longitude
1,151.5	8.79	286.83	1,147.8	13.5	-62.3	1,363,729.66	3,258,569.82	40.328127	-104.572564
1,237.5	9.85	283.49	1,232.7	17.1	-75.7	1,363,733.14	3,258,556.34	40.328137	-104.572612
1,322.5	10.73	278.04	1,316.3	19.9	-90.6	1,363,735.78	3,258,541.41	40.328145	-104.572665
1,407.5	11.61	276.46	1,399.7	22.0	-107.0	1,363,737.68	3,258,525.06	40.328150	-104.572724
1,495.5	13.19	275.05	1,485.6	23.9	-125.8	1,363,739.36	3,258,506.24	40.328156	-104.572791
1,582.5	13.37	274.53	1,570.3	25.5	-145.7	1,363,740.82	3,258,486.31	40.328160	-104.572863
1,655.5	12.66	274.53	1,641.4	26.8	-162.1	1,363,741.95	3,258,469.91	40.328164	-104.572922
1,729.0	12.74	275.19	1,713.1	28.2	-178.2	1,363,743.15	3,258,453.79	40.328167	-104.572979
1,827.0	12.47	276.50	1,808.8	30.4	-199.5	1,363,745.10	3,258,432.50	40.328173	-104.573056
1,924.0	11.95	278.04	1,903.6	33.0	-219.8	1,363,747.48	3,258,412.12	40.328181	-104.573129
2,022.0	12.28	278.34	1,999.4	35.9	-240.2	1,363,750.20	3,258,391.74	40.328189	-104.573202
2,119.0	12.16	278.58	2,094.2	38.9	-260.5	1,363,753.00	3,258,371.40	40.328197	-104.573274
2,216.0	12.35	278.97	2,189.0	42.1	-280.8	1,363,755.93	3,258,351.02	40.328205	-104.573347
2,314.0	12.27	280.37	2,284.7	45.6	-301.4	1,363,759.23	3,258,330.39	40.328215	-104.573421
2,408.0	11.43	278.95	2,376.7	48.8	-320.4	1,363,762.27	3,258,311.33	40.328224	-104.573490
2,505.0	12.45	279.61	2,471.6	52.0	-340.2	1,363,765.31	3,258,291.50	40.328233	-104.573561
2,602.0	12.25	279.38	2,566.4	55.5	-360.7	1,363,768.52	3,258,271.00	40.328242	-104.573634
2,699.0	12.44	279.80	2,661.1	58.9	-381.2	1,363,771.76	3,258,250.52	40.328252	-104.573707
2,796.0	12.33	277.41	2,755.9	62.0	-401.7	1,363,774.66	3,258,229.92	40.328260	-104.573781
2,893.0	12.44	278.74	2,850.6	65.0	-422.3	1,363,777.36	3,258,209.30	40.328268	-104.573855
2,990.0	12.40	278.09	2,945.4	68.0	-443.0	1,363,780.20	3,258,188.63	40.328277	-104.573929
3,087.0	12.22	278.16	3,040.1	70.9	-463.4	1,363,782.91	3,258,168.13	40.328285	-104.574002
3,184.0	12.10	278.34	3,134.9	73.9	-483.6	1,363,785.63	3,258,147.88	40.328293	-104.574075
3,282.0	11.88	277.56	3,230.8	76.7	-503.8	1,363,788.23	3,258,127.69	40.328301	-104.574147
3,378.0	11.76	278.39	3,324.8	79.4	-523.3	1,363,790.76	3,258,108.19	40.328308	-104.574217
3,476.0	11.28	279.94	3,420.8	82.5	-542.6	1,363,793.67	3,258,088.84	40.328317	-104.574286
3,574.0	11.12	276.90	3,516.9	85.3	-561.4	1,363,796.26	3,258,069.99	40.328324	-104.574354
3,671.0	12.16	275.84	3,611.9	87.5	-580.9	1,363,798.22	3,258,050.52	40.328330	-104.574424
3,767.0	12.42	278.64	3,705.7	90.1	-601.1	1,363,800.59	3,258,030.23	40.328337	-104.574496
3,864.0	12.37	279.24	3,800.5	93.3	-621.7	1,363,803.61	3,258,009.63	40.328346	-104.574570
3,961.0	12.23	277.83	3,895.2	96.4	-642.1	1,363,806.46	3,257,989.16	40.328355	-104.574643
4,057.0	12.03	278.04	3,989.1	99.1	-662.1	1,363,809.04	3,257,969.16	40.328362	-104.574715
4,154.0	12.22	279.30	4,083.9	102.2	-682.3	1,363,811.90	3,257,948.99	40.328371	-104.574787
4,251.0	12.23	279.06	4,178.7	105.5	-702.5	1,363,814.96	3,257,928.68	40.328380	-104.574860
4,349.0	12.37	278.57	4,274.5	108.7	-723.2	1,363,817.94	3,257,908.02	40.328388	-104.574934
4,446.0	12.36	278.56	4,369.2	111.8	-743.7	1,363,820.82	3,257,887.44	40.328397	-104.575008
4,543.0	12.35	278.41	4,464.0	114.9	-764.2	1,363,823.67	3,257,866.89	40.328405	-104.575081
4,641.0	12.35	276.83	4,559.7	117.6	-785.0	1,363,826.23	3,257,846.09	40.328413	-104.575156
4,738.0	12.05	276.61	4,654.5	120.0	-805.4	1,363,828.42	3,257,825.71	40.328419	-104.575229
4,836.0	12.16	276.60	4,750.4	122.4	-825.8	1,363,830.57	3,257,805.27	40.328426	-104.575302
4,935.0	11.84	276.03	4,847.2	124.7	-846.2	1,363,832.62	3,257,784.79	40.328432	-104.575375
5,032.0	12.36	276.61	4,942.0	126.9	-866.5	1,363,834.65	3,257,764.56	40.328438	-104.575448
5,130.0	12.30	278.93	5,037.8	129.7	-887.2	1,363,837.26	3,257,743.80	40.328446	-104.575522
5,227.0	11.84	274.82	5,132.6	132.2	-907.3	1,363,839.49	3,257,723.65	40.328453	-104.575594
5,325.0	12.07	277.59	5,228.5	134.4	-927.5	1,363,841.47	3,257,703.46	40.328459	-104.575667
5,424.0	11.94	277.14	5,325.3	137.0	-947.9	1,363,843.90	3,257,683.01	40.328466	-104.575740
5,521.0	11.65	277.40	5,420.3	139.5	-967.6	1,363,846.20	3,257,663.32	40.328473	-104.575811
5,617.0	11.88	277.47	5,514.3	142.0	-987.0	1,363,848.53	3,257,643.88	40.328480	-104.575880
5,714.0	11.33	278.17	5,609.3	144.7	-1,006.3	1,363,850.98	3,257,624.53	40.328487	-104.575949
5,811.0	12.00	278.89	5,704.3	147.6	-1,025.7	1,363,853.69	3,257,605.10	40.328495	-104.576019
5,910.0	12.03	277.32	5,801.1	150.5	-1,046.1	1,363,856.38	3,257,584.67	40.328503	-104.576092
6,006.0	12.07	277.40	5,895.0	153.1	-1,066.0	1,363,858.74	3,257,564.77	40.328510	-104.576164
6,103.0	9.71	275.09	5,990.3	155.1	-1,084.2	1,363,860.58	3,257,546.55	40.328516	-104.576229
6,199.0	2.72	282.40	6,085.6	156.3	-1,094.5	1,363,861.68	3,257,536.23	40.328519	-104.576266
6,297.0	7.40	91.20	6,183.4	156.7	-1,090.4	1,363,862.09	3,257,540.28	40.328520	-104.576251

Ensign

Survey Report - Geographic

Company:	PDC Energy Inc. DJ Basin	Local Co-ordinate Reference:	Well HEN 09N
Project:	SEC.8-T4N-R64W	TVD Reference:	WELL @ 4807.5ft (P272 - RKB 28.5')
Site:	Hen Pad	MD Reference:	WELL @ 4807.5ft (P272 - RKB 28.5')
Well:	HEN 09N	North Reference:	True
Wellbore:	HEN 09N	Survey Calculation Method:	Minimum Curvature
Design:	HEN 09N Final Surveys	Database:	US_EDM

Survey										
Measured Depth (ft)	Inclination (°)	Azimuth (°)	Vertical Depth (ft)	+N/-S (ft)	+E/-W (ft)	Map Northing (usft)	Map Easting (usft)	Latitude	Longitude	
6,394.0	14.58	88.96	6,278.6	156.8	-1,072.0	1,363,862.38	3,257,558.75	40.328520	-104.576185	
6,492.0	20.41	84.85	6,372.0	158.5	-1,042.6	1,363,864.45	3,257,588.11	40.328525	-104.576080	
6,590.0	26.74	84.86	6,461.8	162.1	-1,003.6	1,363,868.37	3,257,627.08	40.328535	-104.575940	
6,687.0	35.24	91.59	6,544.9	163.2	-953.8	1,363,870.07	3,257,676.88	40.328538	-104.575761	
6,785.0	44.38	92.31	6,620.1	161.1	-891.1	1,363,868.55	3,257,739.54	40.328532	-104.575536	
6,883.0	52.63	88.36	6,685.0	160.8	-817.8	1,363,869.05	3,257,812.85	40.328531	-104.575273	
6,980.0	61.50	87.32	6,737.7	163.9	-736.5	1,363,873.00	3,257,894.07	40.328540	-104.574982	
7,077.0	71.50	88.77	6,776.3	166.9	-647.7	1,363,876.92	3,257,982.82	40.328548	-104.574663	
7,173.0	77.36	90.27	6,802.1	167.6	-555.3	1,363,878.65	3,258,075.24	40.328550	-104.574332	
7,270.0	82.45	90.67	6,819.1	166.9	-459.9	1,363,878.86	3,258,170.70	40.328548	-104.573990	
7,368.0	89.33	89.67	6,826.1	166.6	-362.2	1,363,879.59	3,258,268.38	40.328547	-104.573639	
LPL - 2033' FNL & 2398' FEL										
7,467.0	89.56	90.66	6,827.0	166.3	-263.2	1,363,880.34	3,258,367.37	40.328547	-104.573284	
7,564.0	89.60	90.71	6,827.7	165.1	-166.2	1,363,880.20	3,258,464.36	40.328543	-104.572936	
7,661.0	89.29	90.10	6,828.7	164.4	-69.2	1,363,880.53	3,258,561.35	40.328541	-104.572588	
7,759.0	89.06	90.67	6,830.1	163.8	28.8	1,363,880.90	3,258,659.33	40.328540	-104.572237	
7,856.0	89.49	90.71	6,831.3	162.6	125.8	1,363,880.74	3,258,756.32	40.328536	-104.571889	
7,953.0	89.64	90.69	6,832.1	161.4	222.8	1,363,880.57	3,258,853.31	40.328533	-104.571541	
8,051.0	89.36	90.43	6,832.9	160.5	320.8	1,363,880.64	3,258,951.31	40.328531	-104.571190	
8,246.0	89.08	90.51	6,835.6	158.9	515.7	1,363,881.08	3,259,146.28	40.328526	-104.570491	
8,344.0	89.07	90.45	6,837.2	158.1	613.7	1,363,881.28	3,259,244.26	40.328524	-104.570139	
8,442.0	88.83	90.39	6,838.9	157.3	711.7	1,363,881.59	3,259,342.24	40.328522	-104.569788	
8,538.0	86.10	91.80	6,843.2	155.5	807.6	1,363,880.76	3,259,438.13	40.328517	-104.569444	
8,637.0	85.87	90.45	6,850.1	153.6	906.3	1,363,879.86	3,259,536.87	40.328512	-104.569090	
8,734.0	85.91	91.46	6,857.1	152.0	1,003.1	1,363,879.26	3,259,633.62	40.328507	-104.568743	
8,832.0	85.83	91.37	6,864.1	149.5	1,100.8	1,363,877.86	3,259,731.35	40.328500	-104.568392	
8,929.0	85.80	91.37	6,871.2	147.2	1,197.5	1,363,876.56	3,259,828.07	40.328494	-104.568045	
9,027.0	87.59	91.23	6,876.9	145.0	1,295.3	1,363,875.37	3,259,925.90	40.328488	-104.567695	
9,125.0	87.44	91.06	6,881.1	143.1	1,393.2	1,363,874.43	3,260,023.80	40.328483	-104.567344	
9,224.0	87.57	90.34	6,885.4	141.8	1,492.1	1,363,874.26	3,260,122.70	40.328479	-104.566989	
9,322.0	90.20	89.94	6,887.3	141.6	1,590.0	1,363,875.05	3,260,220.66	40.328479	-104.566637	
9,420.0	90.58	89.91	6,886.7	141.7	1,688.0	1,363,876.20	3,260,318.65	40.328479	-104.566286	
9,519.0	90.26	89.76	6,885.9	142.0	1,787.0	1,363,877.52	3,260,417.63	40.328480	-104.565931	
9,615.0	90.54	89.80	6,885.3	142.4	1,883.0	1,363,878.89	3,260,513.62	40.328481	-104.565587	
9,713.0	90.16	90.03	6,884.7	142.5	1,981.0	1,363,880.06	3,260,611.60	40.328481	-104.565235	
9,810.0	90.63	89.91	6,884.0	142.6	2,078.0	1,363,881.13	3,260,708.59	40.328481	-104.564887	
9,906.0	90.70	89.73	6,882.9	142.9	2,174.0	1,363,882.44	3,260,804.57	40.328482	-104.564543	
10,003.0	90.82	89.67	6,881.6	143.4	2,271.0	1,363,883.96	3,260,901.54	40.328483	-104.564195	
10,102.0	90.99	89.24	6,880.0	144.3	2,370.0	1,363,885.93	3,261,000.51	40.328486	-104.563840	
10,199.0	90.98	89.60	6,878.4	145.3	2,467.0	1,363,887.93	3,261,097.47	40.328489	-104.563492	
10,295.0	92.88	89.30	6,875.1	146.2	2,562.9	1,363,889.85	3,261,193.39	40.328491	-104.563148	
10,393.0	93.15	88.71	6,870.0	147.9	2,660.8	1,363,892.58	3,261,291.21	40.328496	-104.562797	
10,587.0	93.09	89.69	6,859.4	150.6	2,854.5	1,363,897.31	3,261,484.85	40.328503	-104.562102	
10,686.0	93.21	89.50	6,854.0	151.3	2,953.3	1,363,899.04	3,261,583.68	40.328505	-104.561748	
10,783.0	92.78	89.50	6,848.9	152.2	3,052.2	1,363,900.90	3,261,680.53	40.328507	-104.561401	
10,977.0	92.89	90.07	6,839.3	152.9	3,243.9	1,363,903.65	3,261,874.26	40.328509	-104.560706	
11,075.0	93.01	90.19	6,834.3	152.7	3,341.8	1,363,904.45	3,261,972.12	40.328509	-104.560355	
11,171.0	93.08	90.08	6,829.2	152.5	3,437.7	1,363,905.23	3,262,067.98	40.328508	-104.560011	
11,267.0	92.95	89.68	6,824.1	152.7	3,533.5	1,363,906.44	3,262,163.84	40.328508	-104.559667	
11,364.0	92.96	90.02	6,819.1	152.9	3,630.4	1,363,907.70	3,262,260.69	40.328509	-104.559320	
11,463.0	92.88	90.12	6,814.1	152.8	3,729.3	1,363,908.62	3,262,359.56	40.328509	-104.558965	
11,560.0	92.71	90.14	6,809.3	152.6	3,826.2	1,363,909.41	3,262,456.43	40.328508	-104.558617	
11,657.0	92.90	90.07	6,804.6	152.4	3,923.0	1,363,910.25	3,262,553.31	40.328508	-104.558270	
11,755.0	92.69	89.21	6,799.8	153.0	4,020.9	1,363,911.88	3,262,651.17	40.328509	-104.557919	
11,851.0	92.89	89.96	6,795.2	153.7	4,116.8	1,363,913.58	3,262,747.04	40.328511	-104.557575	

Ensign

Survey Report - Geographic

Company: PDC Energy Inc. DJ Basin	Local Co-ordinate Reference: Well HEN 09N
Project: SEC.8-T4N-R64W	TVD Reference: WELL @ 4807.5ft (P272 - RKB 28.5')
Site: Hen Pad	MD Reference: WELL @ 4807.5ft (P272 - RKB 28.5')
Well: HEN 09N	North Reference: True
Wellbore: HEN 09N	Survey Calculation Method: Minimum Curvature
Design: HEN 09N Final Surveys	Database: US_EDM

Survey

Measured Depth (ft)	Inclination (°)	Azimuth (°)	Vertical Depth (ft)	+N/-S (ft)	+E/-W (ft)	Map Northing (usft)	Map Easting (usft)	Latitude	Longitude
11,948.0	92.87	89.71	6,790.3	154.0	4,213.7	1,363,914.87	3,262,843.90	40.328512	-104.557228
12,045.0	90.30	89.84	6,787.6	154.4	4,310.6	1,363,916.27	3,262,940.85	40.328513	-104.556880
12,143.0	89.94	91.00	6,787.4	153.7	4,408.6	1,363,916.58	3,263,038.84	40.328511	-104.556528
12,239.0	89.44	89.97	6,787.9	152.8	4,504.6	1,363,916.77	3,263,134.83	40.328508	-104.556184
12,335.0	89.83	90.15	6,788.5	152.7	4,600.6	1,363,917.67	3,263,230.82	40.328508	-104.555840
12,432.0	89.72	90.32	6,788.9	152.3	4,697.6	1,363,918.29	3,263,327.81	40.328507	-104.555492
12,528.0	89.92	90.06	6,789.2	152.0	4,793.6	1,363,918.97	3,263,423.81	40.328506	-104.555148
12,626.0	90.73	89.86	6,788.6	152.1	4,891.6	1,363,920.07	3,263,521.79	40.328506	-104.554796
12,724.0	90.80	90.08	6,787.3	152.1	4,989.6	1,363,921.14	3,263,619.77	40.328506	-104.554445
12,821.0	90.93	89.75	6,785.9	152.3	5,086.6	1,363,922.30	3,263,716.75	40.328507	-104.554097
12,918.0	91.05	90.28	6,784.2	152.3	5,183.6	1,363,923.29	3,263,813.73	40.328507	-104.553749
13,017.0	90.66	90.16	6,782.7	151.9	5,282.6	1,363,923.95	3,263,912.71	40.328505	-104.553394
13,115.0	89.97	90.01	6,782.2	151.7	5,380.6	1,363,924.83	3,264,010.70	40.328505	-104.553042
13,213.0	90.15	90.07	6,782.1	151.7	5,478.6	1,363,925.78	3,264,108.69	40.328505	-104.552691
13,311.0	89.94	90.14	6,782.0	151.5	5,576.6	1,363,926.63	3,264,206.68	40.328504	-104.552339
13,409.0	89.76	90.08	6,782.3	151.3	5,674.6	1,363,927.47	3,264,304.67	40.328504	-104.551988
13,505.0	90.09	90.11	6,782.4	151.1	5,770.6	1,363,928.31	3,264,400.67	40.328503	-104.551644
13,602.0	90.18	90.52	6,782.2	150.6	5,867.6	1,363,928.79	3,264,497.66	40.328502	-104.551296
13,700.0	89.93	90.21	6,782.1	150.0	5,965.6	1,363,929.19	3,264,595.65	40.328500	-104.550944
13,797.0	90.03	90.41	6,782.1	149.5	6,062.6	1,363,929.68	3,264,692.65	40.328498	-104.550596
13,894.0	90.01	90.02	6,782.1	149.1	6,159.6	1,363,930.33	3,264,789.64	40.328497	-104.550248
13,990.0	90.09	90.47	6,782.0	148.7	6,255.6	1,363,930.93	3,264,885.64	40.328496	-104.549904
14,087.0	89.92	90.07	6,782.0	148.2	6,352.6	1,363,931.49	3,264,982.63	40.328495	-104.549556
14,183.0	89.74	90.00	6,782.3	148.2	6,448.6	1,363,932.43	3,265,078.62	40.328494	-104.549212
14,281.0	89.90	89.86	6,782.6	148.3	6,546.6	1,363,933.58	3,265,176.61	40.328495	-104.548860
14,377.0	89.98	90.20	6,782.7	148.2	6,642.6	1,363,934.53	3,265,272.60	40.328494	-104.548516
14,474.0	89.96	90.77	6,782.7	147.4	6,739.6	1,363,934.72	3,265,369.59	40.328492	-104.548168
14,572.0	90.33	90.29	6,782.5	146.5	6,837.5	1,363,934.84	3,265,467.59	40.328490	-104.547817
14,667.0	89.94	90.43	6,782.2	145.9	6,932.5	1,363,935.24	3,265,562.58	40.328488	-104.547476
14,765.0	89.73	90.99	6,782.5	144.7	7,030.5	1,363,935.05	3,265,660.58	40.328484	-104.547125
14,820.0	89.53	92.29	6,782.9	143.1	7,085.5	1,363,934.05	3,265,715.56	40.328480	-104.546927
14,855.0	89.53	92.29	6,783.2	141.7	7,120.5	1,363,933.02	3,265,750.55	40.328476	-104.546802

BHL - 2046' FNL & 205' FEL

Design Annotations

Measured Depth (ft)	Vertical Depth (ft)	Local Coordinates		Comment
		+N/-S (ft)	+E/-W (ft)	
7,368.0	6,826.1	166.6	-362.2	LPL - 2033' FNL & 2398' FEL
14,855.0	6,783.2	141.7	7,120.5	BHL - 2046' FNL & 205' FEL

Checked By: _____ Approved By: _____ Date: _____