

**DCP COAN AT-1-1 RELEASE
FOURTH QUARTER 2023
FORM 27 SUPPLEMENTAL GROUNDWATER MONITORING SUMMARY REPORT**

ATTACHMENTS

Tables

- 1 Fourth Quarter 2023 Summary of Groundwater Elevation Data
- 2 Fourth Quarter 2023 Summary of Table 915-1 Organic Concentrations in Groundwater
- 3 Historical Summary of Table 915-1 Organic Concentrations in Groundwater

Figures

- 1 Site Location Map
- 2 Site Over Map with Monitoring Well Locations
- 3 Groundwater Elevation Contour Map – November 2, 2023
- 4 Groundwater Analytical Results Map – November 2, 2023

Appendices

- A Laboratory Analytical Reports
 - Origins Laboratory Job #: Y311076 (Groundwater)

TABLE 1
FOURTH QUARTER 2023
SUMMARY OF GROUNDWATER ELEVATION DATA
COAN AT-1-1
WELD COUNTY, COLORADO

Location	Date	Depth to Groundwater (feet)	Depth to Product (feet)	Free Phase Hydrocarbon Thickness (feet)	Total Depth (feet)	TOC Elevation (feet amsl)	Groundwater Elevation (feet amsl)	Change in Groundwater Elevation Since Previous Event (1) (feet)
MW01	8/2/2023	34.75	ND		43.08	4,965.69	4,930.94	NC
MW01	11/2/2023	32.91	ND		43.08	4,965.69	4,932.78	1.84
MW02	8/2/2023	33.90	ND		41.80	4,964.75	4,930.85	NC
MW02	11/2/2023	31.75	ND		41.80	4,964.75	4,933.00	2.15
MW03	8/2/2023	34.50	ND		41.83	4965.02	4,930.52	NC
MW03	11/2/2023	32.56	ND		41.83	4965.02	4,932.46	1.94
MW04	8/2/2023	34.75	ND		40.91	4965.72	4,930.97	NC
MW04	11/2/2023	33.20	ND		40.91	4965.72	4,932.52	1.55
MW05	8/2/2023	34.15	ND		41.59	4965.50	4,931.35	NC
MW05	11/2/2023	32.43	ND		41.59	4965.50	4,933.07	1.72
Average Change in Groundwater Elevation (8/2/2023 to 11/2/2023)								1.84

Notes:

amsl = feet above mean sea level

TOC = top of casing

Groundwater elevation = TOC Elevation - Measured Depth to Water

NM = Not Measured

ND = Not Detected

NC = Not Calculated

TABLE 2
FOURTH QUARTER 2023 GROUNDWATER ANALYTICAL RESULTS
COAN AT-1-1
WELD COUNTY, COLORADO

Location Identification	Sample Date	Lab Report	Benzene (µg/l)	Toluene (µg/l)	Ethylbenzene (µg/l)	Total Xylenes (µg/l)	1,2,4-Trimethylbenzene (µg/l)	1,3,5-Trimethylbenzene (µg/l)	Naphthalene (µg/l)
ECMC Standards (µg/L) ⁽¹⁾			5	560	700	1,400	67	67	140
MW01	11/2/2023	Y311076	2.16	<1.00	<1.00	<1.00	<2.00	<2.00	<2.00
MW02	11/2/2023	Y311076	<1.00	<1.00	<1.00	<1.00	<2.00	<2.00	<2.00
MW03	11/2/2023	Y311076	9.86	<1.00	<1.00	<1.00	<2.00	<2.00	<2.00
MW04	11/2/2023	Y311076	<1.00	<1.00	<1.00	<1.00	<2.00	<2.00	<2.00
MW05	11/2/2023	Y311076	<1.00	<1.00	<1.00	<1.00	<2.00	<2.00	<2.00

Notes:

1). The environmental cleanup standards for groundwater that are applicable to this site are the Colorado Energy & Carbon Management Commission (ECMC) standards for contaminants in groundwater according to Table 915-1 of the ECMC 900 Series Rule for E&P Waste Management.

2). Standards are taken from the Colorado Department of Public Health and Environment - Water Quality Control Commission, 5 CCR 1002-41, Table A - Groundwater Organic Chemical Standards.

Bold red values indicate an exceedance of the ECMC groundwater standards for the Site.

µg/L = micrograms per liter.

TABLE 3
HISTORICAL GROUNDWATER ANALYTICAL RESULTS
COAN AT-1-1
WELD COUNTY, COLORADO

Location Identification	Sample Date	Lab Report	Benzene (µg/l)	Toluene (µg/l)	Ethylbenzene (µg/l)	Total Xylenes (µg/l)	1,2,4-Trimethylbenzene (µg/l)	1,3,5-Trimethylbenzene (µg/l)	Naphthalene (µg/l)
ECMC Standards (µg/L) ⁽¹⁾			5	560	700	1,400	67	67	140
MW01	6/19/2023	Y306460	34.2	<1.00	<1.00	<1.00	<2.00	<2.00	<2.00
MW01	8/2/2023	Y308071	4.20	<1.00	<1.00	<1.00	<2.00	<2.00	<2.00
MW01	11/2/2023	Y311076	2.16	<1.00	<1.00	<1.00	<2.00	<2.00	<2.00
MW02	8/2/2023	Y308071	<1.00	<1.00	<1.00	<1.00	<2.00	<2.00	<2.00
MW02	11/2/2023	Y311076	<1.00	<1.00	<1.00	<1.00	<2.00	<2.00	<2.00
MW03	8/2/2023	Y308071	26.5	<1.00	<1.00	<1.00	<2.00	<2.00	<2.00
MW03	11/2/2023	Y311076	9.86	<1.00	<1.00	<1.00	<2.00	<2.00	<2.00
MW04	8/2/2023	Y308071	<1.00	<1.00	<1.00	<1.00	<2.00	<2.00	<2.00
MW04	11/2/2023	Y311076	<1.00	<1.00	<1.00	<1.00	<2.00	<2.00	<2.00
MW05	8/2/2023	Y308071	<1.00	<1.00	<1.00	<1.00	<2.00	<2.00	<2.00
MW05	11/2/2023	Y311076	<1.00	<1.00	<1.00	<1.00	<2.00	<2.00	<2.00

Notes:

1). The environmental cleanup standards for groundwater that are applicable to this site are the Colorado Energy & Carbon Management Commission (ECMC) standards for contaminants in groundwater according to Table 915-1 of the ECMC 900 Series Rule for E&P Waste Management.

2). Standards are taken from the Colorado Department of Public Health and Environment - Water Quality Control Commission, 5 CCR 1002-41, Table A - Groundwater Organic Chemical Standards.

Bold red values indicate an exceedance of the ECMC groundwater standards for the Site.

µg/L = micrograms per liter.

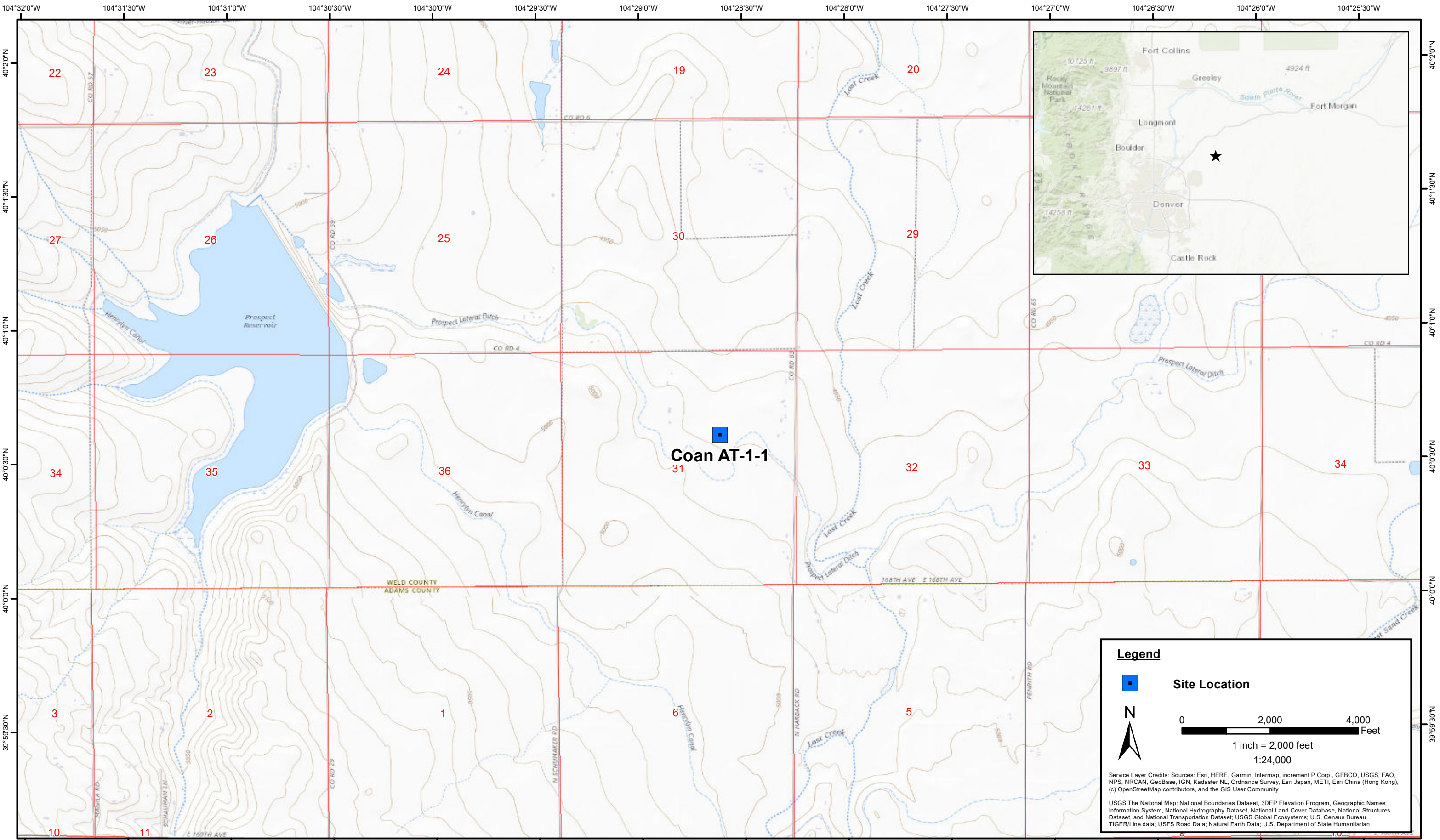

DATE:	April 2023
DESIGNED BY:	J. Watts
DRAWN BY:	J. Clonts



Tasman, Inc.
6855 W. 119th Ave
Broomfield, CO 80020

DCP Midstream
Coan AT-1-1
SWNE Sec. 31-T1N-R63W
Weld County, Colorado

Site Location Map

Figure
1



Legend

- Monitoring Well Location (Collected via Trimble GPS)
- Source Location
- Approximate DCP Gathering Lines
- Excavation Extent

Notes:

All locations are approximate unless otherwise noted.

GPS - Global Positioning System

N

0 10 20 Feet

Imagery Source: Google Earth; 2016 Google

DATE:	August 2023
DESIGNED BY:	J. Watts
DRAWN BY:	M. Kaczmarek



Tasman, Inc.
6855 W. 119th Ave
Broomfield, CO 80020

DCP Midstream
Coan AT-1-1
SWNE Sec. 31-T1N-R63W
Weld County, Colorado

Site Overview

Figure
2



DATE:	November 2023
DESIGNED BY:	J. Watts
DRAWN BY:	M. Kaczmarek



Tasman, Inc.
6855 W. 119th Ave
Broomfield, CO 80020

DCP Midstream
Coan AT-1-1
SWNE Sec. 31-T1N-R63W
Weld County, Colorado

Groundwater Elevation
Contour Map
(11/2/2023)

Figure
3





November 09, 2023

Tasman Geosciences

Jeb Watts

6855 West 119th Avenue

Broomfield CO 80020

Project Name - DCP - Coan AT-1-1

Project Number - [none]

Attached are your analytical results for DCP - Coan AT-1-1 received by Origins Laboratory, Inc. November 02, 2023. This project is associated with Origins project number Y311076-01.

The analytical results in the following report were analyzed under the guidelines of EPA Methods. These methods are identified as follows; "SW" are defined in SW-846, "EPA" are defined in 40CFR part 136 and "SM" are defined in the most current revision of Standard Methods For the Examination of Water and Wastewater.

The analytical results apply specifically to the samples and analyses specified per the attached Chain of Custody. As such, this report shall not be reproduced except in full, without the written approval of Origin's laboratory.

Unless otherwise noted, the analytical results for all soil samples are reported on a wet weight basis. All analytical analyses were performed under NELAP guidelines unless noted by a data qualifier.

Any holding time exceedances, deviations from the method specifications or deviations from Origins Laboratory's Standard Operating Procedures are outlined in the case narrative.

Thank you for selecting Origins for your analytical needs. Please contact us with any questions concerning this report, or if we can help with anything at all.

Origins Laboratory, Inc.
303.433.1322
o-squad@oelabinc.com



1725 Elk Place, Denver, CO 80211 | Phone: 303.433.1322 | Fax: 303.265.9645

Tasman Geosciences
6855 West 119th Avenue
Broomfield CO 80020

Jeb Watts
Project Number: [none]
Project: DCP - Coan AT-1-1

CROSS REFERENCE REPORT

Sample ID	Laboratory ID	Matrix	Date Sampled	Date Received
MW01	Y311076-01	Water	November 2, 2023 12:45	11/02/2023 15:16
MW02	Y311076-02	Water	November 2, 2023 12:21	11/02/2023 15:16
MW03	Y311076-03	Water	November 2, 2023 13:02	11/02/2023 15:16
MW04	Y311076-04	Water	November 2, 2023 11:39	11/02/2023 15:16
MW05	Y311076-05	Water	November 2, 2023 11:57	11/02/2023 15:16

Origins Laboratory, Inc.



The results in this report apply to the samples analyzed in accordance with the chain of custody document. This analytical report must be reproduced in its entirety.

Tasman Geosciences
6855 West 119th Avenue
Broomfield CO 80020

Jeb Watts
Project Number: [none]
Project: DCP - Coan AT-1-1

ORIGINS

LABORATORY, INC

www.originslaboratory.com

4311076

page 1 of 1

Client: Tasman / DCP

Address: 6855 W 119th Ave

Broomfield, CO 80020

Telephone Number: 303-467-1228

Email Address: jeb@tasman-geo.com / Stephen.watts@tasman-geo.com

Fax: 303.265.9645

Project Manager: Jeb Watts / Chandler Cole

Project Name: Coan AT-1-1

Project Number:

Samples Collected By: Brian Gable

chandler.E.Cole@pbb.com

Sample ID Description	Date Sampled	Time Sampled	# of Containers	Preservative				Matrix			Analysis	Sample Instructions	
				Unpreserved	HCl	HNO ₃	Other	Groundwater	Soil	Air Summa Canister #			Other
MW01	11/2/23	1245	3	X				X				1	
MW02		1221	3	X				X				2	
MW03		1302	3	X				X				3	
MW04		1139	3	X				X				4	
MW05		1157	3	X				X				5	
												6	
												7	
												8	
												9	
												10	

Relinquished By: *[Signature]* Date: 11/2/23 Time: 1516
Relinquished By: *[Signature]* Date: 11/2/23 Time: 1516

Received By: *[Signature]* Date: 11/2/23 Time: 1516
Received By: *[Signature]* Date: 11/2/23 Time: 1516

Turnaround Time: Same Day ☐ 24 Hr ☐ 48 Hr ☐ 72 Hr ☐ Standard ☒

Temp Received: 4.8 Date Results Needed

Origins Laboratory, Inc.

[Signature]

The results in this report apply to the samples analyzed in accordance with the chain of custody document. This analytical report must be reproduced in its entirety.

Tasman Geosciences
6855 West 119th Avenue
Broomfield CO 80020

Jeb Watts
Project Number: [none]
Project: DCP - Coan AT-1-1

Origins Laboratory

F-012207-01-R1
Effective Date: 01/09/12

Sample Receipt Checklist

Origins Work Order: 4311076 Client: Tasman
Client Project ID: Coan AT-1-1

Checklist Completed by: EHS Shipped Via: HO
Date/time completed: 11/2/23 (UPS, FedEx, Hand Delivered, Pick-up, etc.)
Airbill #: N/A

Matrix(s) Received: (Check all that apply): Soil/Solid ☒ Water ☐ Other: ☐
Cooler Number/Temperature: 1 4.8 °C 1 °C 1 °C (Describe) 1 °C
Thermometer ID: 1004

Requirement Description	Yes	No	N/A	Comments (if any)
If samples require cooling, was the temperature between 0°C to ≤ 6°C ⁽¹⁾ ?	<input checked="" type="checkbox"/>	<input type="checkbox"/>	<input type="checkbox"/>	
Is there ice present (document if blue ice is used)	<input checked="" type="checkbox"/>	<input type="checkbox"/>	<input type="checkbox"/>	
Are custody seals present on cooler? (if so, document in comments if they are signed and dated, broken or intact)	<input checked="" type="checkbox"/>	<input type="checkbox"/>	<input type="checkbox"/>	
Are custody seals present on each sample container? (if so, document in comments if they are signed and dated, broken or intact)	<input checked="" type="checkbox"/>	<input type="checkbox"/>	<input type="checkbox"/>	
Were all samples received intact ⁽¹⁾ ?	<input checked="" type="checkbox"/>	<input type="checkbox"/>	<input type="checkbox"/>	
Was adequate sample volume provided ⁽¹⁾ ?	<input checked="" type="checkbox"/>	<input type="checkbox"/>	<input type="checkbox"/>	
Are short holding time analytes or samples with HTs due within 48 hours present ⁽¹⁾ ?	<input checked="" type="checkbox"/>	<input type="checkbox"/>	<input type="checkbox"/>	
Is a chain-of-custody (COC) present and filled out completely ⁽¹⁾ ?	<input checked="" type="checkbox"/>	<input type="checkbox"/>	<input type="checkbox"/>	
Does the COC agree with the number and type of sample bottles received ⁽¹⁾ ?	<input checked="" type="checkbox"/>	<input type="checkbox"/>	<input type="checkbox"/>	
Do the sample IDs on the bottle labels match the COC ⁽¹⁾ ?	<input checked="" type="checkbox"/>	<input type="checkbox"/>	<input type="checkbox"/>	
Is the COC properly relinquished by the client with date and time recorded ⁽¹⁾ ?	<input checked="" type="checkbox"/>	<input type="checkbox"/>	<input type="checkbox"/>	
For volatiles in water – is there headspace (> ¼ inch bubble) present? If yes, contact client and note in narrative.	<input checked="" type="checkbox"/>	<input type="checkbox"/>	<input type="checkbox"/>	
Are samples preserved that require preservation and was it checked ⁽¹⁾ ? (note ID of confirmation instrument used in comments) / (preservation is not confirmed for subcontracted analyses in order to insure sample integrity)/(pH <2 for samples preserved with HNO ₃ , HCL, H ₂ SO ₄) / (pH >10 for samples preserved with NaAsO ₂ +NaOH, ZnAc+NaOH)	<input checked="" type="checkbox"/>	<input type="checkbox"/>	<input type="checkbox"/>	
Additional Comments (if any):				

⁽¹⁾If NO, then contact the client before proceeding with analysis and note date/time and person contacted as well as the corrective action to in the additional comments (above) and the case narrative.

Reviewed by (Project Manager) Jeb Date/Time Reviewed 11-6-23

Origins Laboratory, Inc.

J. Bynon

The results in this report apply to the samples analyzed in accordance with the chain of custody document. This analytical report must be reproduced in its entirety.

Tasman Geosciences
6855 West 119th Avenue
Broomfield CO 80020

Jeb Watts
Project Number: [none]
Project: DCP - Coan AT-1-1

MW01

11/2/2023 12:45:00PM

Analyte	Result	Reporting Limit	Units	Dilution	Batch	Analyst	Prepared	Analyzed	Notes
---------	--------	-----------------	-------	----------	-------	---------	----------	----------	-------

Origins Laboratory, Inc. Y311076-01 (Water)

BTEX+N+TMBs by 8260D

1,2,4-Trimethylbenzene	ND	2.00	ug/L	1	B3K0608	JSM	11/06/2023	11/06/2023	U
1,3,5-Trimethylbenzene	ND	2.00	"	"	"	JSM	"	"	U
Benzene	2.16	1.00	"	"	"	JSM	"	"	
Ethylbenzene	ND	1.00	"	"	"	JSM	"	"	U
Naphthalene	ND	2.00	"	"	"	JSM	"	"	U
Toluene	ND	1.00	"	"	"	JSM	"	"	U
Xylenes, total	ND	1.00	"	"	"	JSM	"	"	U

Surrogate: 1,2-Dichloroethane-d4	98.4 %	70-130	"	"	"
Surrogate: Toluene-d8	93.9 %	70-130	"	"	"
Surrogate: 4-Bromofluorobenzene	102 %	70-130	"	"	"

Origins Laboratory, Inc.



The results in this report apply to the samples analyzed in accordance with the chain of custody document. This analytical report must be reproduced in its entirety.

Tasman Geosciences
6855 West 119th Avenue
Broomfield CO 80020

Jeb Watts
Project Number: [none]
Project: DCP - Coan AT-1-1

MW02

11/2/2023 12:21:00PM

Analyte	Result	Reporting Limit	Units	Dilution	Batch	Analyst	Prepared	Analyzed	Notes
---------	--------	-----------------	-------	----------	-------	---------	----------	----------	-------

Origins Laboratory, Inc. Y311076-02 (Water)

BTEX+N+TMBs by 8260D

1,2,4-Trimethylbenzene	ND	2.00	ug/L	1	B3K0608	JSM	11/06/2023	11/06/2023	U
1,3,5-Trimethylbenzene	ND	2.00	"	"	"	JSM	"	"	U
Benzene	ND	1.00	"	"	"	JSM	"	"	U
Ethylbenzene	ND	1.00	"	"	"	JSM	"	"	U
Naphthalene	ND	2.00	"	"	"	JSM	"	"	U
Toluene	ND	1.00	"	"	"	JSM	"	"	U
Xylenes, total	ND	1.00	"	"	"	JSM	"	"	U

Surrogate: 1,2-Dichloroethane-d4	99.6 %	70-130	"	"	"
Surrogate: Toluene-d8	93.8 %	70-130	"	"	"
Surrogate: 4-Bromofluorobenzene	101 %	70-130	"	"	"

Origins Laboratory, Inc.



The results in this report apply to the samples analyzed in accordance with the chain of custody document. This analytical report must be reproduced in its entirety.

Tasman Geosciences
6855 West 119th Avenue
Broomfield CO 80020

Jeb Watts
Project Number: [none]
Project: DCP - Coan AT-1-1

MW03

11/2/2023 1:02:00PM

Analyte	Result	Reporting Limit	Units	Dilution	Batch	Analyst	Prepared	Analyzed	Notes
---------	--------	-----------------	-------	----------	-------	---------	----------	----------	-------

Origins Laboratory, Inc. Y311076-03 (Water)

BTEX+N+TMBs by 8260D

1,2,4-Trimethylbenzene	ND	2.00	ug/L	1	B3K0608	JSM	11/06/2023	11/06/2023	U
1,3,5-Trimethylbenzene	ND	2.00	"	"	"	JSM	"	"	U
Benzene	9.86	1.00	"	"	"	JSM	"	"	
Ethylbenzene	ND	1.00	"	"	"	JSM	"	"	U
Naphthalene	ND	2.00	"	"	"	JSM	"	"	U
Toluene	ND	1.00	"	"	"	JSM	"	"	U
Xylenes, total	ND	1.00	"	"	"	JSM	"	"	U

Surrogate: 1,2-Dichloroethane-d4	101 %	70-130	"	"	"
Surrogate: Toluene-d8	93.3 %	70-130	"	"	"
Surrogate: 4-Bromofluorobenzene	100 %	70-130	"	"	"

Origins Laboratory, Inc.



The results in this report apply to the samples analyzed in accordance with the chain of custody document. This analytical report must be reproduced in its entirety.

Tasman Geosciences
6855 West 119th Avenue
Broomfield CO 80020

Jeb Watts
Project Number: [none]
Project: DCP - Coan AT-1-1

MW04

11/2/2023 11:39:00AM

Analyte	Result	Reporting Limit	Units	Dilution	Batch	Analyst	Prepared	Analyzed	Notes
---------	--------	-----------------	-------	----------	-------	---------	----------	----------	-------

Origins Laboratory, Inc. Y311076-04 (Water)

BTEX+N+TMBs by 8260D

1,2,4-Trimethylbenzene	ND	2.00	ug/L	1	B3K0608	JSM	11/06/2023	11/07/2023	U
1,3,5-Trimethylbenzene	ND	2.00	"	"	"	JSM	"	"	U
Benzene	ND	1.00	"	"	"	JSM	"	"	U
Ethylbenzene	ND	1.00	"	"	"	JSM	"	"	U
Naphthalene	ND	2.00	"	"	"	JSM	"	"	U
Toluene	ND	1.00	"	"	"	JSM	"	"	U
Xylenes, total	ND	1.00	"	"	"	JSM	"	"	U

Surrogate: 1,2-Dichloroethane-d4	101 %	70-130	"	"	"
Surrogate: Toluene-d8	92.9 %	70-130	"	"	"
Surrogate: 4-Bromofluorobenzene	104 %	70-130	"	"	"

Origins Laboratory, Inc.



The results in this report apply to the samples analyzed in accordance with the chain of custody document. This analytical report must be reproduced in its entirety.

Tasman Geosciences
6855 West 119th Avenue
Broomfield CO 80020

Jeb Watts
Project Number: [none]
Project: DCP - Coan AT-1-1

MW05

11/2/2023 11:57:00AM

Analyte	Result	Reporting Limit	Units	Dilution	Batch	Analyst	Prepared	Analyzed	Notes
---------	--------	-----------------	-------	----------	-------	---------	----------	----------	-------

Origins Laboratory, Inc. Y311076-05 (Water)

BTEX+N+TMBs by 8260D

1,2,4-Trimethylbenzene	ND	2.00	ug/L	1	B3K0608	JSM	11/06/2023	11/07/2023	U
1,3,5-Trimethylbenzene	ND	2.00	"	"	"	JSM	"	"	U
Benzene	ND	1.00	"	"	"	JSM	"	"	U
Ethylbenzene	ND	1.00	"	"	"	JSM	"	"	U
Naphthalene	ND	2.00	"	"	"	JSM	"	"	U
Toluene	ND	1.00	"	"	"	JSM	"	"	U
Xylenes, total	ND	1.00	"	"	"	JSM	"	"	U

Surrogate: 1,2-Dichloroethane-d4	99.6 %	70-130	"	"	"
Surrogate: Toluene-d8	94.1 %	70-130	"	"	"
Surrogate: 4-Bromofluorobenzene	103 %	70-130	"	"	"

Origins Laboratory, Inc.



The results in this report apply to the samples analyzed in accordance with the chain of custody document. This analytical report must be reproduced in its entirety.

Tasman Geosciences
6855 West 119th Avenue
Broomfield CO 80020

Jeb Watts
Project Number: [none]
Project: DCP - Coan AT-1-1

Volatile Organic Compounds by GC/MS SW846 8260D - Quality Control
Origins Laboratory, Inc.

Analyte	Result	Reporting Limit	Units	Spike Level	Source Result	%REC	%REC Limits	RPD	RPD Limit	Notes
Batch B3K0608 - EPA 5030B (Water)										
Blank (B3K0608-BLK1)					Prepared: 11/06/2023 Analyzed: 11/06/2023					
1,2,4-Trimethylbenzene	ND	2.00	ug/L							U
1,3,5-Trimethylbenzene	ND	2.00	"							U
Benzene	ND	1.00	"							U
Ethylbenzene	ND	1.00	"							U
Naphthalene	ND	2.00	"							U
Toluene	ND	1.00	"							U
Xylenes, total	ND	1.00	"							U
Surrogate: 1,2-Dichloroethane-d4	63		"	62.5		101	70-130			
Surrogate: Toluene-d8	59		"	62.5		93.8	70-130			
Surrogate: 4-Bromofluorobenzene	63		"	62.5		101	70-130			

Origins Laboratory, Inc.



The results in this report apply to the samples analyzed in accordance with the chain of custody document. This analytical report must be reproduced in its entirety.

Tasman Geosciences
6855 West 119th Avenue
Broomfield CO 80020

Jeb Watts
Project Number: [none]
Project: DCP - Coan AT-1-1

Volatile Organic Compounds by GC/MS SW846 8260D - Quality Control
Origins Laboratory, Inc.

Analyte	Result	Reporting Limit	Units	Spike Level	Source Result	%REC	%REC Limits	RPD	RPD Limit	Notes
---------	--------	-----------------	-------	-------------	---------------	------	-------------	-----	-----------	-------

Batch B3K0608 - EPA 5030B (Water)

LCS (B3K0608-BS1)

Prepared: 11/06/2023 Analyzed: 11/06/2023

1,2,4-Trimethylbenzene	46.1	2.00	ug/L	50.0		92.2	70-130			
1,3,5-Trimethylbenzene	45.4	2.00	"	50.0		90.8	70-130			
Benzene	46.0	1.00	"	50.0		92.0	70-130			
Ethylbenzene	49.9	1.00	"	50.0		99.8	70-130			
m,p-Xylene	102	2.00	"	100		102	70-130			
Naphthalene	41.0	2.00	"	50.0		82.0	70-130			
o-Xylene	49.8	1.00	"	50.0		99.6	70-130			
Toluene	45.8	1.00	"	50.0		91.7	70-130			
Surrogate: 1,2-Dichloroethane-d4	63		"	62.5		100	70-130			
Surrogate: Toluene-d8	58		"	62.5		92.5	70-130			
Surrogate: 4-Bromofluorobenzene	66		"	62.5		106	70-130			

Origins Laboratory, Inc.



The results in this report apply to the samples analyzed in accordance with the chain of custody document. This analytical report must be reproduced in its entirety.

Tasman Geosciences
6855 West 119th Avenue
Broomfield CO 80020

Jeb Watts
Project Number: [none]
Project: DCP - Coan AT-1-1

Volatile Organic Compounds by GC/MS SW846 8260D - Quality Control
Origins Laboratory, Inc.

Analyte	Result	Reporting Limit	Units	Spike Level	Source Result	%REC	%REC Limits	RPD	RPD Limit	Notes
Batch B3K0608 - EPA 5030B (Water)										
Matrix Spike (B3K0608-MS1)	Source: Y311076-01				Prepared: 11/06/2023 Analyzed: 11/06/2023					
1,2,4-Trimethylbenzene	39.7	2.00	ug/L	50.0	0.390	78.5	70-130			
1,3,5-Trimethylbenzene	39.6	2.00	"	50.0	0.530	78.2	70-130			
Benzene	37.6	1.00	"	50.0	2.16	70.9	70-130			
Ethylbenzene	42.0	1.00	"	50.0	0.380	83.2	70-130			
m,p-Xylene	85.6	2.00	"	100	ND	85.6	70-130			
Naphthalene	31.6	2.00	"	50.0	0.240	62.8	70-130			QM-07
o-Xylene	41.5	1.00	"	50.0	ND	83.1	70-130			
Toluene	36.6	1.00	"	50.0	ND	73.3	70-130			
Surrogate: 1,2-Dichloroethane-d4	61		"	62.5		97.5	70-130			
Surrogate: Toluene-d8	62		"	62.5		99.8	70-130			
Surrogate: 4-Bromofluorobenzene	68		"	62.5		110	70-130			

Origins Laboratory, Inc.



The results in this report apply to the samples analyzed in accordance with the chain of custody document. This analytical report must be reproduced in its entirety.

Tasman Geosciences
6855 West 119th Avenue
Broomfield CO 80020

Jeb Watts
Project Number: [none]
Project: DCP - Coan AT-1-1

Volatile Organic Compounds by GC/MS SW846 8260D - Quality Control
Origins Laboratory, Inc.

Analyte	Result	Reporting Limit	Units	Spike Level	Source Result	%REC	%REC Limits	RPD	RPD Limit	Notes
Batch B3K0608 - EPA 5030B (Water)										
Matrix Spike Dup (B3K0608-MSD1)	Source: Y311076-01				Prepared: 11/06/2023 Analyzed: 11/06/2023					
1,2,4-Trimethylbenzene	57.1	2.00	ug/L	50.0	0.390	113	70-130	36.1	20	QR-02
1,3,5-Trimethylbenzene	56.6	2.00	"	50.0	0.530	112	70-130	35.4	20	QR-02
Benzene	61.2	1.00	"	50.0	2.16	118	70-130	47.7	20	QR-02
Ethylbenzene	61.2	1.00	"	50.0	0.380	122	70-130	37.1	20	QR-02
m,p-Xylene	124	2.00	"	100	ND	124	70-130	36.5	20	QR-02
Naphthalene	45.0	2.00	"	50.0	0.240	89.6	70-130	34.9	20	QR-03
o-Xylene	60.4	1.00	"	50.0	ND	121	70-130	37.1	20	QR-02
Toluene	56.2	1.00	"	50.0	ND	112	70-130	42.2	20	QR-02
Surrogate: 1,2-Dichloroethane-d4	62		"	62.5		100	70-130			
Surrogate: Toluene-d8	59		"	62.5		94.6	70-130			
Surrogate: 4-Bromofluorobenzene	67		"	62.5		107	70-130			

Origins Laboratory, Inc.



The results in this report apply to the samples analyzed in accordance with the chain of custody document. This analytical report must be reproduced in its entirety.

Tasman Geosciences
6855 West 119th Avenue
Broomfield CO 80020

Jeb Watts
Project Number: [none]
Project: DCP - Coan AT-1-1

Notes and Definitions

U Sample is Non-Detect.

QR-03 The RPD value for the sample duplicate or MS/MSD was outside of QC acceptance limits due to matrix interference. QC batch accepted based on LCS and/or LCSD recovery and/or RPD values.

QR-02 The RPD result exceeded the QC control limits; however, both percent recoveries were acceptable. Sample results for the QC batch were accepted based on percent recoveries and completeness of QC data.

QM-07 The spike recovery was outside acceptance limits for the MS and/or MSD. The batch was accepted based on acceptable LCS recovery.

ND Analyte NOT DETECTED at or above the reporting limit

RPD Relative Percent Difference

All soil results are reported at a wet weight basis.

Origins Laboratory, Inc.



The results in this report apply to the samples analyzed in accordance with the chain of custody document. This analytical report must be reproduced in its entirety.