

PDC Energy Inc. DJ Basin



HEN 05N
 Hen Pad
 North American Datum 1983 , US State Plane 1983, Colorado Northern Zone
 Ground Elevation: 4779.0
 +N/-S +E/-W Northing Easting Latitude Longitude
 0.0 0.0 1363775.10 3258631.64 40.328250 -104.572340
 P272 - RKB 28.5' Well @ 4807.5ft (P272 - RKB 28.5')

Hen Pad
 HEN 05N
 HEN 05N Final Surveys
 13:26, November 27 2023



Azimuths to True North
 Magnetic North: 7.68°

Magnetic Field
 Strength: 51708.9nT
 Dip Angle: 66.58°
 Date: 08/17/2023
 Model: HRGM

ANNOTATIONS

MD	TVD	Annotation
7564.0	6827.2	LPL - 1056' FNL & 2366' FEL
15020.0	6786.0	BHL - 1077' FNL & 205' FEL

FINAL SURVEY
Projected Bottom Hole Location
 15020' MD / 6786.0' TVD
 88.84° INC / 89.51° AZM
 1077' FNL / 205' FEL

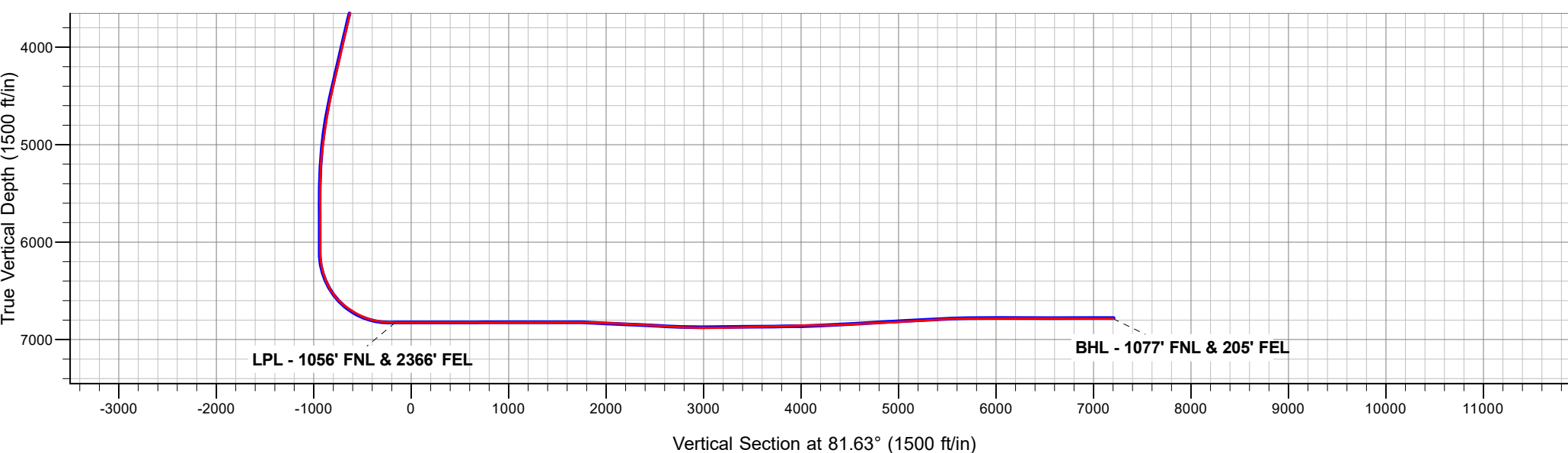
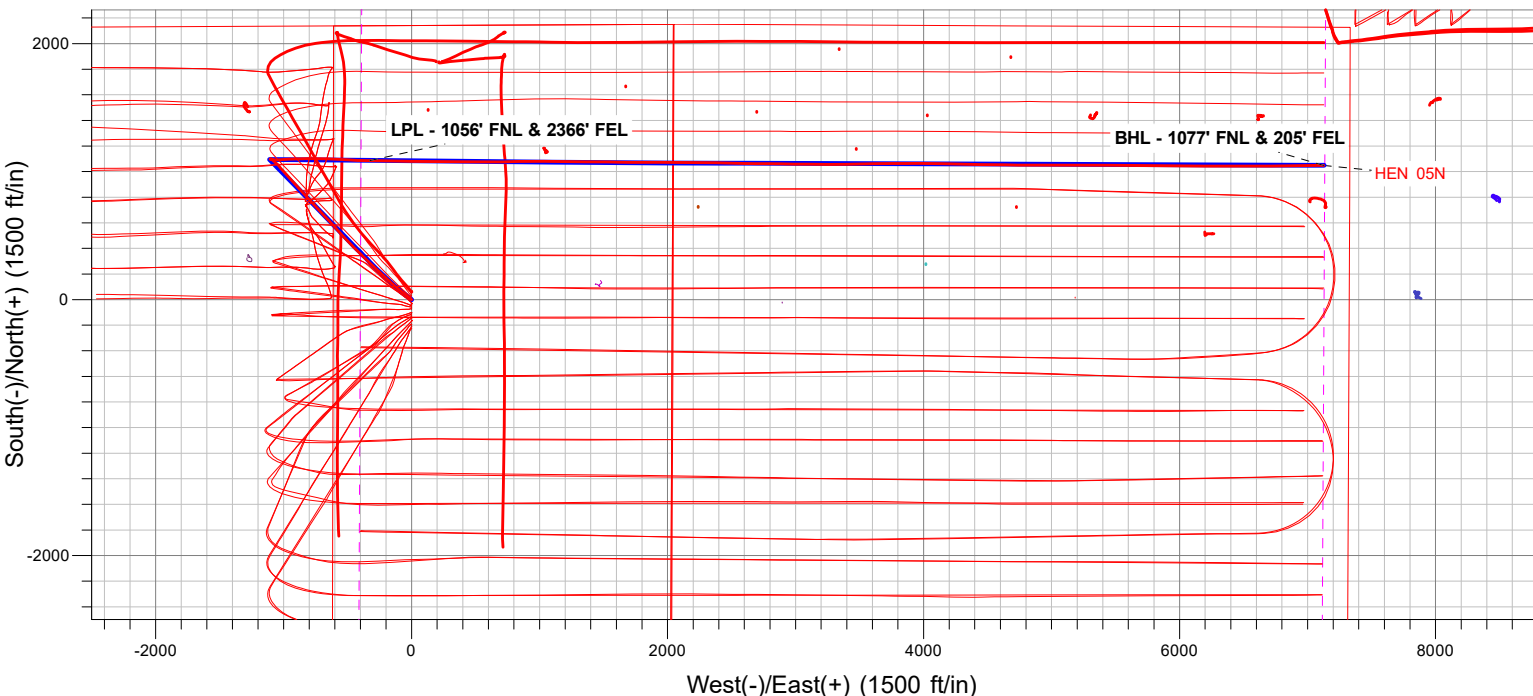

PDC Energy Inc. DJ Basin

SEC.8-T4N-R64W

Hen Pad

HEN 05N

HEN 05N

Design: HEN 05N Final Surveys

Survey Report - Geographic

27 November, 2023

Ensign

Survey Report - Geographic

Company: PDC Energy Inc. DJ Basin	Local Co-ordinate Reference: Well HEN 05N
Project: SEC.8-T4N-R64W	TVD Reference: Well @ 4807.5ft (P272 - RKB 28.5')
Site: Hen Pad	MD Reference: Well @ 4807.5ft (P272 - RKB 28.5')
Well: HEN 05N	North Reference: True
Wellbore: HEN 05N	Survey Calculation Method: Minimum Curvature
Design: HEN 05N Final Surveys	Database: US_EDM

Project SEC.8-T4N-R64W, Weld County, Colorado	
Map System: US State Plane 1983	System Datum: Mean Sea Level
Geo Datum: North American Datum 1983	
Map Zone: Colorado Northern Zone	Using geodetic scale factor

Site Hen Pad	
Site Position:	Northing: 1,363,685.50 usft
From: Lat/Long	Easting: 3,258,631.47 usft
Position Uncertainty: 0.0 ft	Slot Radius: 13-3/16 "
	Latitude: 40.328004
	Longitude: -104.572344
	Grid Convergence: 0.60 °

Well HEN 05N	
Well Position +N/-S 0.0 ft	Northing: 1,363,775.10 usft
+E/-W 0.0 ft	Easting: 3,258,631.64 usft
Position Uncertainty 0.0 ft	Wellhead Elevation: ft
	Latitude: 40.328250
	Longitude: -104.572340
	Ground Level: 4,779.0 ft

Wellbore HEN 05N					
Magnetics	Model Name	Sample Date	Declination (°)	Dip Angle (°)	Field Strength (nT)
	HRGM	08/17/2023	7.68	66.58	51,708.92347128

Design HEN 05N Final Surveys				
Audit Notes:				
Version: 1.0	Phase: ACTUAL			
	Tie On Depth: 0.0			
Vertical Section:	Depth From (TVD) (ft)	+N/-S (ft)	+E/-W (ft)	Direction (°)
	0.0	0.0	0.0	81.63

Survey Program		Date 11/27/2023
From (ft)	To (ft)	Survey (Wellbore)
159.5	15,020.0	Survey #1 (HEN 05N)
		Tool Name MWD
		Description MWD - Standard

Survey									
Measured Depth (ft)	Inclination (°)	Azimuth (°)	Vertical Depth (ft)	+N/-S (ft)	+E/-W (ft)	Map Northing (usft)	Map Easting (usft)	Latitude	Longitude
0.0	0.00	0.00	0.0	0.0	0.0	1,363,775.10	3,258,631.64	40.328250	-104.572340
159.5	1.58	305.46	159.5	1.3	-1.8	1,363,776.36	3,258,629.84	40.328254	-104.572347
249.5	1.85	308.80	249.4	2.9	-3.9	1,363,777.97	3,258,627.68	40.328258	-104.572354
340.5	2.11	310.21	340.4	4.9	-6.4	1,363,779.95	3,258,625.23	40.328264	-104.572363
456.5	1.14	287.98	456.3	6.6	-9.1	1,363,781.65	3,258,622.49	40.328268	-104.572373
545.5	1.67	295.09	545.3	7.5	-11.1	1,363,782.45	3,258,620.46	40.328271	-104.572380
629.5	2.73	310.56	629.2	9.3	-13.7	1,363,784.25	3,258,617.82	40.328276	-104.572390
715.5	4.92	314.08	715.1	13.2	-17.9	1,363,788.10	3,258,613.57	40.328286	-104.572405
801.5	6.95	311.44	800.6	19.2	-24.5	1,363,794.04	3,258,606.96	40.328303	-104.572428
888.5	9.85	307.40	886.6	27.2	-34.3	1,363,801.94	3,258,597.01	40.328325	-104.572463
977.5	11.34	308.28	974.1	37.2	-47.3	1,363,811.85	3,258,583.99	40.328352	-104.572510
1,066.5	13.19	308.80	1,061.1	49.0	-62.0	1,363,823.48	3,258,569.09	40.328385	-104.572563

Ensign

Survey Report - Geographic

Company:	PDC Energy Inc. DJ Basin	Local Co-ordinate Reference:	Well HEN 05N
Project:	SEC.8-T4N-R64W	TVD Reference:	Well @ 4807.5ft (P272 - RKB 28.5')
Site:	Hen Pad	MD Reference:	Well @ 4807.5ft (P272 - RKB 28.5')
Well:	HEN 05N	North Reference:	True
Wellbore:	HEN 05N	Survey Calculation Method:	Minimum Curvature
Design:	HEN 05N Final Surveys	Database:	US_EDM

Survey										
Measured Depth (ft)	Inclination (°)	Azimuth (°)	Vertical Depth (ft)	+N/-S (ft)	+E/-W (ft)	Map Northing (usft)	Map Easting (usft)	Latitude	Longitude	
1,151.5	14.33	310.56	1,143.6	61.9	-77.6	1,363,836.23	3,258,553.40	40.328420	-104.572619	
1,237.5	14.95	309.68	1,226.9	75.9	-94.2	1,363,850.06	3,258,536.64	40.328459	-104.572678	
1,322.5	15.83	310.56	1,308.8	90.5	-111.5	1,363,864.42	3,258,519.24	40.328498	-104.572740	
1,407.5	18.03	311.09	1,390.1	106.7	-130.2	1,363,880.41	3,258,500.35	40.328543	-104.572807	
1,495.5	19.87	311.44	1,473.3	125.5	-151.7	1,363,899.03	3,258,478.68	40.328595	-104.572884	
1,582.5	19.70	312.49	1,555.2	145.2	-173.6	1,363,918.49	3,258,456.58	40.328649	-104.572963	
1,658.5	18.99	312.67	1,626.9	162.2	-192.1	1,363,935.33	3,258,437.86	40.328695	-104.573029	
1,827.0	18.40	310.79	1,786.5	198.2	-232.4	1,363,970.86	3,258,397.20	40.328794	-104.573174	
1,924.0	20.92	312.88	1,877.9	220.0	-256.7	1,363,992.39	3,258,372.69	40.328854	-104.573261	
2,021.0	21.12	313.16	1,968.4	243.7	-282.1	1,364,015.86	3,258,347.00	40.328919	-104.573352	
2,118.0	19.42	313.75	2,059.4	266.8	-306.5	1,364,038.71	3,258,322.37	40.328982	-104.573440	
2,215.0	20.68	313.17	2,150.5	289.7	-330.7	1,364,061.32	3,258,297.99	40.329045	-104.573526	
2,313.0	21.35	314.43	2,242.0	314.0	-356.0	1,364,085.38	3,258,272.38	40.329112	-104.573617	
2,407.0	21.55	315.26	2,329.5	338.3	-380.4	1,364,109.37	3,258,247.75	40.329179	-104.573705	
2,505.0	21.65	313.87	2,420.6	363.6	-406.1	1,364,134.41	3,258,221.79	40.329248	-104.573797	
2,602.0	20.78	313.66	2,511.0	387.9	-431.4	1,364,158.42	3,258,196.19	40.329315	-104.573888	
2,699.0	20.69	315.44	2,601.8	412.0	-455.9	1,364,182.25	3,258,171.47	40.329381	-104.573975	
2,796.0	21.55	317.01	2,692.2	437.2	-480.1	1,364,207.24	3,258,147.04	40.329450	-104.574062	
2,893.0	21.30	316.25	2,782.5	463.0	-504.4	1,364,232.74	3,258,122.44	40.329521	-104.574149	
2,989.0	20.59	317.13	2,872.2	487.9	-528.0	1,364,257.46	3,258,098.64	40.329589	-104.574234	
3,086.0	20.06	317.25	2,963.2	512.6	-550.9	1,364,281.93	3,258,075.48	40.329657	-104.574316	
3,183.0	21.78	317.28	3,053.8	538.1	-574.4	1,364,307.12	3,258,051.72	40.329727	-104.574400	
3,282.0	22.37	318.35	3,145.5	565.6	-599.3	1,364,334.43	3,258,026.45	40.329803	-104.574490	
3,377.0	21.89	316.98	3,233.5	592.1	-623.4	1,364,360.63	3,258,002.08	40.329875	-104.574576	
3,475.0	22.43	317.31	3,324.3	619.2	-648.6	1,364,387.46	3,257,976.66	40.329950	-104.574666	
3,573.0	21.80	316.39	3,415.1	646.1	-673.8	1,364,414.12	3,257,951.15	40.330024	-104.574757	
3,670.0	22.85	316.71	3,504.8	672.9	-699.1	1,364,440.60	3,257,925.54	40.330097	-104.574848	
3,766.0	21.72	316.32	3,593.6	699.3	-724.2	1,364,466.75	3,257,900.21	40.330170	-104.574938	
3,863.0	22.09	317.31	3,683.6	725.7	-748.9	1,364,492.87	3,257,875.18	40.330242	-104.575027	
3,960.0	22.85	317.98	3,773.2	753.1	-773.9	1,364,520.01	3,257,849.92	40.330317	-104.575116	
4,056.0	22.78	317.59	3,861.7	780.6	-798.9	1,364,547.31	3,257,824.62	40.330393	-104.575206	
4,153.0	22.86	318.14	3,951.1	808.5	-824.2	1,364,574.94	3,257,799.09	40.330469	-104.575296	
4,250.0	22.15	317.52	4,040.8	836.1	-849.1	1,364,602.20	3,257,773.89	40.330545	-104.575386	
4,349.0	22.84	317.58	4,132.2	864.0	-874.7	1,364,629.88	3,257,748.03	40.330622	-104.575477	
4,446.0	21.57	317.35	4,222.0	891.0	-899.4	1,364,656.63	3,257,722.97	40.330696	-104.575566	
4,543.0	21.85	317.45	4,312.1	917.4	-923.7	1,364,682.79	3,257,698.41	40.330768	-104.575653	
4,640.0	21.69	317.08	4,402.2	943.9	-948.1	1,364,708.95	3,257,673.72	40.330841	-104.575741	
4,738.0	22.84	318.14	4,492.9	971.3	-973.2	1,364,736.12	3,257,648.41	40.330916	-104.575831	
4,836.0	19.13	317.91	4,584.4	997.4	-996.6	1,364,761.96	3,257,624.68	40.330988	-104.575915	
4,934.0	17.06	319.45	4,677.5	1,020.2	-1,016.7	1,364,784.59	3,257,604.33	40.331050	-104.575987	
5,031.0	16.50	319.87	4,770.4	1,041.6	-1,034.9	1,364,805.74	3,257,585.98	40.331109	-104.576052	
5,130.0	12.92	311.86	4,866.2	1,059.7	-1,052.2	1,364,823.70	3,257,568.48	40.331159	-104.576114	
5,227.0	13.22	312.41	4,960.7	1,074.4	-1,068.4	1,364,838.24	3,257,552.06	40.331199	-104.576172	
5,325.0	10.11	314.75	5,056.6	1,088.0	-1,082.8	1,364,851.71	3,257,537.54	40.331237	-104.576224	
5,423.0	6.79	307.34	5,153.5	1,097.6	-1,093.6	1,364,861.17	3,257,526.72	40.331263	-104.576263	
5,521.0	2.37	260.40	5,251.2	1,100.8	-1,100.2	1,364,864.28	3,257,520.08	40.331272	-104.576286	
5,617.0	1.61	218.05	5,347.2	1,099.4	-1,102.9	1,364,862.86	3,257,517.30	40.331268	-104.576296	
5,714.0	0.81	260.37	5,444.2	1,098.2	-1,104.5	1,364,861.65	3,257,515.80	40.331264	-104.576302	
5,811.0	1.35	170.60	5,541.1	1,097.0	-1,105.0	1,364,860.40	3,257,515.32	40.331261	-104.576303	
5,909.0	0.09	72.69	5,639.1	1,095.9	-1,104.7	1,364,859.29	3,257,515.60	40.331258	-104.576302	
6,006.0	0.19	5.59	5,736.1	1,096.0	-1,104.6	1,364,859.48	3,257,515.68	40.331259	-104.576302	
6,103.0	0.23	11.30	5,833.1	1,096.4	-1,104.5	1,364,859.83	3,257,515.73	40.331259	-104.576302	
6,199.0	0.06	268.64	5,929.1	1,096.6	-1,104.6	1,364,860.01	3,257,515.72	40.331260	-104.576302	
6,296.0	0.13	172.47	6,026.1	1,096.5	-1,104.6	1,364,859.90	3,257,515.68	40.331260	-104.576302	
6,393.0	1.97	112.95	6,123.1	1,095.7	-1,103.0	1,364,859.16	3,257,517.24	40.331258	-104.576297	

Ensign

Survey Report - Geographic

Company:	PDC Energy Inc. DJ Basin	Local Co-ordinate Reference:	Well HEN 05N
Project:	SEC.8-T4N-R64W	TVD Reference:	Well @ 4807.5ft (P272 - RKB 28.5')
Site:	Hen Pad	MD Reference:	Well @ 4807.5ft (P272 - RKB 28.5')
Well:	HEN 05N	North Reference:	True
Wellbore:	HEN 05N	Survey Calculation Method:	Minimum Curvature
Design:	HEN 05N Final Surveys	Database:	US_EDM

Survey										
Measured Depth (ft)	Inclination (°)	Azimuth (°)	Vertical Depth (ft)	+N/-S (ft)	+E/-W (ft)	Map Northing (usft)	Map Easting (usft)	Latitude	Longitude	
6,491.0	8.56	96.64	6,220.7	1,094.2	-1,094.2	1,364,857.75	3,257,526.06	40.331253	-104.576265	
6,590.0	16.54	96.27	6,317.2	1,091.8	-1,072.9	1,364,855.58	3,257,547.45	40.331247	-104.576188	
6,687.0	22.86	87.13	6,408.5	1,091.2	-1,040.3	1,364,855.36	3,257,580.03	40.331245	-104.576072	
6,785.0	31.96	85.36	6,495.4	1,094.3	-995.3	1,364,858.88	3,257,624.95	40.331254	-104.575910	
6,882.0	40.83	88.14	6,573.4	1,097.4	-937.9	1,364,862.60	3,257,682.32	40.331262	-104.575704	
6,979.0	51.07	87.68	6,640.8	1,100.0	-868.4	1,364,865.89	3,257,751.86	40.331269	-104.575455	
7,076.0	58.42	89.26	6,696.7	1,102.0	-789.2	1,364,868.78	3,257,830.95	40.331275	-104.575171	
7,173.0	61.47	91.37	6,745.3	1,101.6	-705.3	1,364,869.17	3,257,914.89	40.331274	-104.574870	
7,270.0	72.56	93.16	6,783.1	1,098.0	-616.2	1,364,866.52	3,258,004.00	40.331264	-104.574550	
7,368.0	79.76	94.61	6,806.6	1,091.5	-521.3	1,364,861.05	3,258,098.93	40.331246	-104.574210	
7,467.0	82.93	91.21	6,821.5	1,086.6	-423.6	1,364,857.12	3,258,196.69	40.331233	-104.573860	
7,564.0	90.31	90.61	6,827.2	1,085.0	-326.9	1,364,856.60	3,258,293.45	40.331228	-104.573513	
LPL - 1056' FNL & 2366' FEL										
7,661.0	90.54	90.16	6,826.5	1,084.4	-229.9	1,364,856.96	3,258,390.44	40.331227	-104.573165	
7,758.0	89.61	91.34	6,826.3	1,083.1	-132.9	1,364,856.71	3,258,487.43	40.331223	-104.572817	
7,855.0	90.26	91.07	6,826.4	1,081.1	-35.9	1,364,855.68	3,258,584.42	40.331217	-104.572469	
7,953.0	90.37	91.04	6,825.9	1,079.3	62.1	1,364,854.90	3,258,682.41	40.331213	-104.572118	
8,149.0	90.05	90.04	6,825.2	1,077.4	258.1	1,364,855.11	3,258,878.40	40.331207	-104.571415	
8,344.0	90.04	90.07	6,825.0	1,077.2	453.1	1,364,856.96	3,259,073.38	40.331207	-104.570715	
8,441.0	89.36	90.83	6,825.5	1,076.5	550.0	1,364,857.21	3,259,170.38	40.331205	-104.570367	
8,538.0	89.89	90.75	6,826.2	1,075.1	647.0	1,364,856.89	3,259,267.37	40.331201	-104.570020	
8,637.0	91.09	87.92	6,825.3	1,076.3	746.0	1,364,859.07	3,259,366.33	40.331204	-104.569665	
8,734.0	90.40	88.18	6,824.1	1,079.6	843.0	1,364,863.39	3,259,463.22	40.331213	-104.569317	
8,831.0	90.26	90.35	6,823.5	1,080.8	939.9	1,364,865.64	3,259,560.18	40.331217	-104.568969	
8,928.0	90.19	90.19	6,823.1	1,080.4	1,036.9	1,364,866.20	3,259,657.17	40.331215	-104.568621	
9,027.0	89.61	91.05	6,823.3	1,079.3	1,135.9	1,364,866.17	3,259,756.17	40.331213	-104.568266	
9,125.0	89.83	91.09	6,823.8	1,077.5	1,233.9	1,364,865.36	3,259,854.16	40.331208	-104.567915	
9,224.0	90.46	90.05	6,823.5	1,076.5	1,332.9	1,364,865.41	3,259,953.15	40.331205	-104.567560	
9,322.0	89.93	90.44	6,823.2	1,076.1	1,430.9	1,364,866.02	3,260,051.14	40.331204	-104.567208	
9,420.0	90.21	90.89	6,823.1	1,074.9	1,528.9	1,364,865.91	3,260,149.14	40.331200	-104.566857	
9,519.0	89.82	90.53	6,823.0	1,073.7	1,627.9	1,364,865.72	3,260,248.13	40.331197	-104.566501	
9,614.0	87.64	90.32	6,825.1	1,073.0	1,722.9	1,364,866.00	3,260,343.10	40.331195	-104.566161	
9,713.0	87.88	90.00	6,829.0	1,072.7	1,821.8	1,364,866.76	3,260,442.02	40.331194	-104.565806	
9,810.0	87.36	90.20	6,833.0	1,072.5	1,918.7	1,364,867.61	3,260,538.93	40.331194	-104.565458	
9,906.0	87.02	89.73	6,837.8	1,072.6	2,014.6	1,364,868.67	3,260,634.80	40.331194	-104.565115	
10,003.0	87.68	90.05	6,842.2	1,072.8	2,111.5	1,364,869.87	3,260,731.68	40.331195	-104.564767	
10,101.0	86.92	90.63	6,846.9	1,072.2	2,209.4	1,364,870.31	3,260,829.57	40.331193	-104.564416	
10,198.0	86.42	92.09	6,852.5	1,069.9	2,306.2	1,364,869.03	3,260,926.39	40.331187	-104.564069	
10,295.0	86.43	90.81	6,858.5	1,067.5	2,402.9	1,364,867.59	3,261,023.18	40.331180	-104.563722	
10,393.0	86.58	91.19	6,864.5	1,065.7	2,500.7	1,364,866.91	3,261,120.99	40.331175	-104.563371	
10,490.0	87.25	91.37	6,869.7	1,063.6	2,597.6	1,364,865.76	3,261,217.84	40.331169	-104.563023	
10,587.0	86.98	90.44	6,874.6	1,062.1	2,694.4	1,364,865.24	3,261,314.71	40.331165	-104.562676	
10,685.0	89.68	90.65	6,877.5	1,061.1	2,792.4	1,364,865.33	3,261,412.66	40.331162	-104.562325	
10,783.0	89.66	90.75	6,878.0	1,059.9	2,890.4	1,364,865.16	3,261,510.65	40.331159	-104.561973	
10,881.0	89.56	90.03	6,878.7	1,059.3	2,988.4	1,364,865.52	3,261,608.64	40.331157	-104.561622	
10,977.0	90.77	91.39	6,878.4	1,058.1	3,084.4	1,364,865.33	3,261,704.63	40.331154	-104.561277	
11,075.0	91.43	90.04	6,876.5	1,056.8	3,182.3	1,364,865.13	3,261,802.61	40.331150	-104.560926	
11,171.0	91.94	89.62	6,873.7	1,057.1	3,278.3	1,364,866.42	3,261,898.55	40.331151	-104.560582	
11,267.0	91.09	90.28	6,871.2	1,057.2	3,374.3	1,364,867.51	3,261,994.51	40.331151	-104.560238	
11,364.0	92.36	88.07	6,868.3	1,058.6	3,471.2	1,364,869.92	3,262,091.42	40.331155	-104.559890	
11,462.0	92.03	88.88	6,864.5	1,061.2	3,569.1	1,364,873.55	3,262,189.28	40.331162	-104.559539	
11,560.0	90.67	89.65	6,862.2	1,062.5	3,667.0	1,364,875.83	3,262,287.22	40.331166	-104.559188	
11,657.0	91.73	90.17	6,860.2	1,062.6	3,764.0	1,364,877.00	3,262,384.18	40.331166	-104.558840	
11,755.0	91.98	88.80	6,857.0	1,063.5	3,862.0	1,364,878.90	3,262,482.10	40.331168	-104.558488	
11,851.0	91.22	90.28	6,854.3	1,064.3	3,957.9	1,364,880.68	3,262,578.04	40.331171	-104.558144	

Ensign

Survey Report - Geographic

Company:	PDC Energy Inc. DJ Basin	Local Co-ordinate Reference:	Well HEN 05N
Project:	SEC.8-T4N-R64W	TVD Reference:	Well @ 4807.5ft (P272 - RKB 28.5')
Site:	Hen Pad	MD Reference:	Well @ 4807.5ft (P272 - RKB 28.5')
Well:	HEN 05N	North Reference:	True
Wellbore:	HEN 05N	Survey Calculation Method:	Minimum Curvature
Design:	HEN 05N Final Surveys	Database:	US_EDM

Survey

Measured Depth (ft)	Inclination (°)	Azimuth (°)	Vertical Depth (ft)	+N/-S (ft)	+E/-W (ft)	Map Northing (usft)	Map Easting (usft)	Latitude	Longitude
11,948.0	90.35	91.40	6,853.0	1,062.9	4,054.9	1,364,880.27	3,262,675.03	40.331167	-104.557796
12,045.0	90.63	90.52	6,852.2	1,061.2	4,151.9	1,364,879.66	3,262,772.02	40.331162	-104.557449
12,143.0	92.49	91.85	6,849.5	1,059.2	4,249.8	1,364,878.66	3,262,869.96	40.331156	-104.557097
12,239.0	92.84	90.18	6,845.0	1,057.5	4,345.7	1,364,877.96	3,262,965.85	40.331152	-104.556753
12,334.0	92.85	91.46	6,840.3	1,056.1	4,440.6	1,364,877.60	3,263,060.73	40.331148	-104.556413
12,431.0	92.61	91.09	6,835.7	1,054.0	4,537.4	1,364,876.45	3,263,157.60	40.331142	-104.556066
12,528.0	92.90	90.70	6,831.0	1,052.5	4,634.3	1,364,875.95	3,263,254.49	40.331138	-104.555718
12,626.0	92.53	90.35	6,826.4	1,051.6	4,732.2	1,364,876.08	3,263,352.37	40.331135	-104.555367
12,724.0	92.98	89.88	6,821.7	1,051.4	4,830.1	1,364,876.91	3,263,450.25	40.331135	-104.555016
12,821.0	93.13	90.10	6,816.5	1,051.4	4,926.9	1,364,877.94	3,263,547.10	40.331135	-104.554669
12,918.0	93.22	90.20	6,811.1	1,051.1	5,023.8	1,364,878.70	3,263,643.95	40.331134	-104.554321
13,016.0	93.48	89.80	6,805.4	1,051.1	5,121.6	1,364,879.72	3,263,741.77	40.331134	-104.553970
13,114.0	93.60	90.37	6,799.4	1,051.0	5,219.4	1,364,880.60	3,263,839.57	40.331133	-104.553620
13,213.0	93.72	90.57	6,793.0	1,050.2	5,318.2	1,364,880.82	3,263,938.37	40.331131	-104.553265
13,311.0	92.63	90.36	6,787.6	1,049.4	5,416.1	1,364,881.05	3,264,036.21	40.331129	-104.552914
13,409.0	91.10	90.20	6,784.4	1,048.9	5,514.0	1,364,881.60	3,264,134.15	40.331128	-104.552563
13,505.0	90.50	90.73	6,783.1	1,048.1	5,610.0	1,364,881.82	3,264,230.13	40.331125	-104.552219
13,601.0	89.86	90.62	6,782.8	1,047.0	5,706.0	1,364,881.70	3,264,326.13	40.331122	-104.551874
13,700.0	90.40	90.23	6,782.6	1,046.3	5,805.0	1,364,882.00	3,264,425.12	40.331120	-104.551519
13,797.0	90.08	90.23	6,782.1	1,045.9	5,902.0	1,364,882.62	3,264,522.12	40.331119	-104.551171
13,894.0	90.25	90.38	6,781.9	1,045.4	5,999.0	1,364,883.12	3,264,619.11	40.331118	-104.550824
13,989.0	89.66	90.97	6,781.9	1,044.2	6,094.0	1,364,883.00	3,264,714.10	40.331114	-104.550483
14,086.0	90.29	90.42	6,782.0	1,043.1	6,191.0	1,364,882.84	3,264,811.10	40.331111	-104.550135
14,182.0	89.53	90.50	6,782.1	1,042.3	6,287.0	1,364,883.07	3,264,907.09	40.331109	-104.549791
14,281.0	89.83	89.92	6,782.7	1,041.9	6,386.0	1,364,883.74	3,265,006.09	40.331108	-104.549436
14,377.0	89.97	89.51	6,782.9	1,042.4	6,482.0	1,364,885.22	3,265,102.07	40.331109	-104.549091
14,474.0	90.83	89.31	6,782.2	1,043.4	6,579.0	1,364,887.24	3,265,199.04	40.331112	-104.548743
14,571.0	89.14	89.94	6,782.2	1,044.0	6,676.0	1,364,888.89	3,265,296.02	40.331113	-104.548395
14,667.0	90.11	89.19	6,782.8	1,044.8	6,772.0	1,364,890.62	3,265,391.99	40.331115	-104.548051
14,765.0	88.78	89.85	6,783.8	1,045.6	6,869.9	1,364,892.46	3,265,489.97	40.331118	-104.547700
14,862.0	89.92	89.26	6,784.9	1,046.4	6,966.9	1,364,894.23	3,265,586.94	40.331120	-104.547352
14,959.0	89.95	89.36	6,785.0	1,047.5	7,063.9	1,364,896.42	3,265,683.91	40.331123	-104.547004
14,985.0	88.84	89.51	6,785.3	1,047.8	7,089.9	1,364,896.94	3,265,709.90	40.331123	-104.546911
15,020.0	88.84	89.51	6,786.0	1,048.1	7,124.9	1,364,897.61	3,265,744.88	40.331124	-104.546785

BHL - 1077' FNL & 205' FEL

Design Annotations

Measured Depth (ft)	Vertical Depth (ft)	Local Coordinates		Comment
		+N/-S (ft)	+E/-W (ft)	
7,564.0	6,827.2	1,085.0	-326.9	LPL - 1056' FNL & 2366' FEL
15,020.0	6,786.0	1,048.1	7,124.9	BHL - 1077' FNL & 205' FEL

Checked By: _____ Approved By: _____ Date: _____